

MIRAGE-Z

SHOWER AND TUB DOOR INSTALLATION INSTRUCTIONS

IMPORTANT

DreamLine® reserves the right to alter, modify or redesign products at any time without prior notice. For the latest up-to-date technical drawings, manuals, warranty information or additional details please refer to your model's web page on **DreamLine.com**

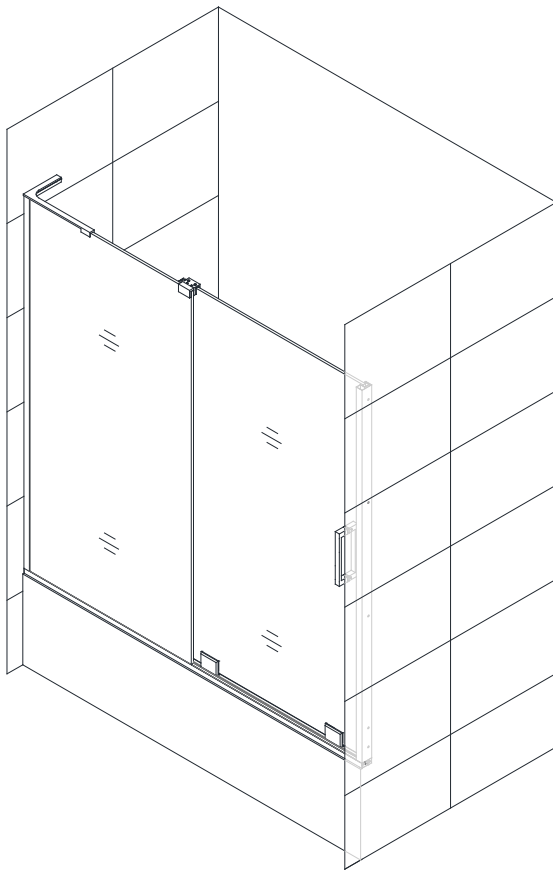

MODEL #s

SHDR-1960584-##

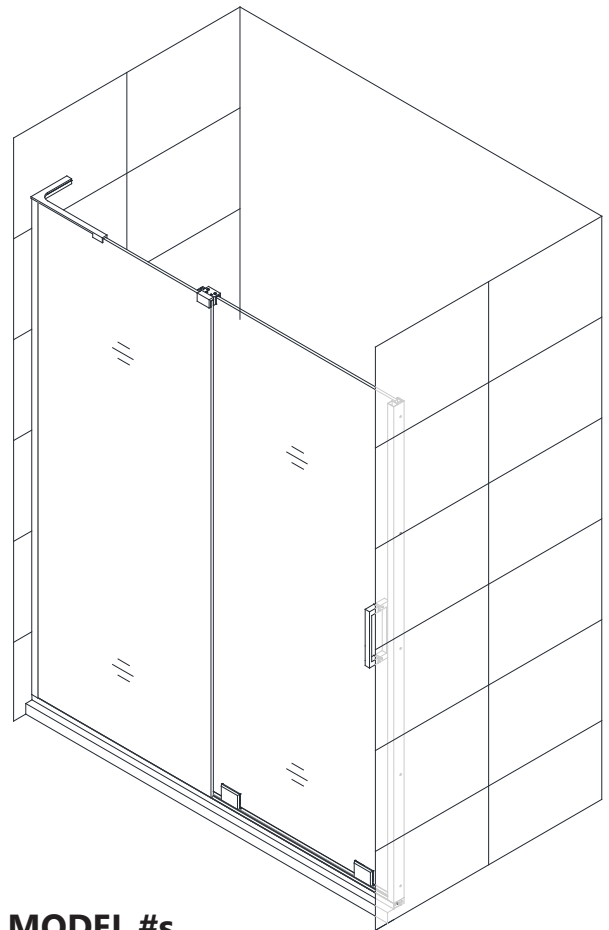

MODEL #s

SHDR-1948724-##

SHDR-1954724-##

SHDR-1960724-##

##=finish
01- Chrome
04- Brushed Nickel

Right-Hand door installation shown



Questions?

Please Call **DreamLine Customer Support: 1-855-831-2126**
Hours of Operation M-F 8AM - 7PM EST and Saturday 9AM - 5PM EST

Support@DreamLine.com



For more information about DreamLine® Shower Doors, Tub Doors & Enclosures, please visit **DreamLine.com**



This model is treated with DreamLine's exclusive ClearMax™ Glass technology. This is a specially formulated coating that prevents the buildup of soap and water spots.

Install the surface with the ClearMax™ label towards the inside of the shower. Please note that depending on the model, the glass may be coated on either one or both surfaces.

For best results, squeegee the glass after each use and dry with a soft cloth.

Table of Contents

Section title	Page #
Preparation	3
Model Diagram	4
Tools	5
Detailed Diagram of Door Components	6
Parts List	7
Installation Steps	8-28
Safe Stop™ Bumpers Installation	11-12
L-Bar Installation	15-16
Bottom Roller Assembly	18-19
Guide Block Assembly	20
Vinyl Seals	26
Product maintenance	28

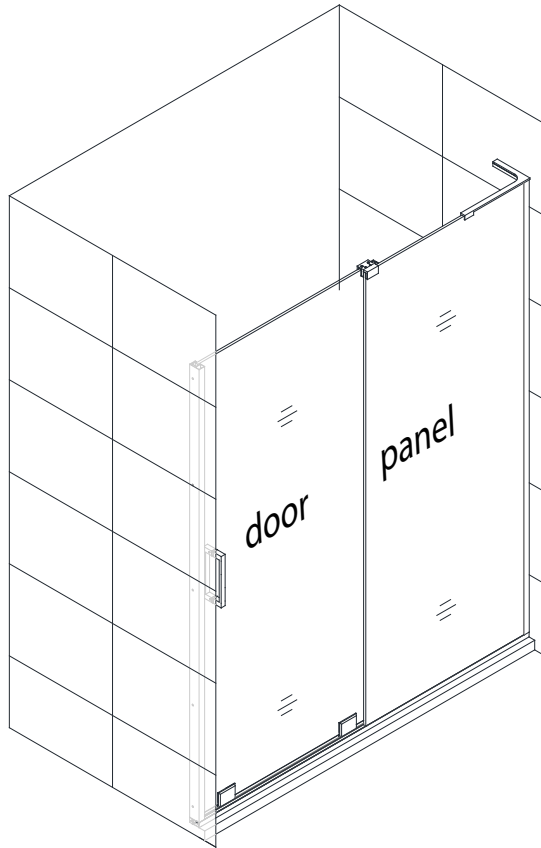

Left-Hand door installation

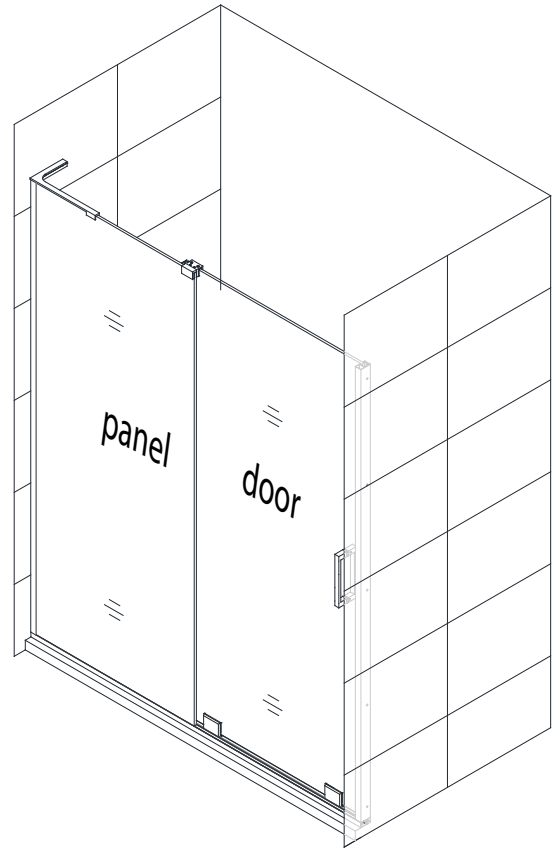

Right-Hand door installation



This model is reversible for either Left or Right-hand door installation. The Right-hand door installation is shown an example throughout this instruction manual. For a Left-hand door installation, simply reverse the orientation of the parts shown and use the correct L-Bar™ for the installation.

Preparation

1. Prior to installation, examine all boxes and packages for shipping damage and compare the piece count with your packing slip. After opening all boxes and packages read this introduction carefully. Check that all of the needed parts are included in the package by checking off the components on the "Detailed Diagram of Shower Door Components". If the unit has been damaged, has a finishing defect, or has missing parts, please contact our customer support department within **3 business days** of the delivery date. **Please note that DreamLine® will not replace any damaged products or missing parts free of charge after 3 business days or if the product has been installed.** Contact DreamLine® if you have any questions, and please provide an order number, job name or other proof of purchase to help identify the original order.
2. **Please note that you should consult your local building codes with questions on installation compliance standards. Building and plumbing codes may vary by location, and DreamLine® is not responsible for code compliance standards for your project and will not accept any returns.**
3. If this unit is going to be installed in a new construction, please install all of the required plumbing and drainage before installing the shower. Use a competent and licensed (if required by local code) plumber for all plumbing installation
4. Make sure that prior to beginning the installation, the surfaces are leveled and solid and will be able to support the total weight of the unit. Also make sure the walls are at right angles. Irregular installation surface level, radius corners or improper angle of side walls will result in serious problems for your installation. Please, note that some adjustments and drilling might be necessary during the installation process.
5. Protect all primary surfaces of the product during installation. Never set your glass down directly onto a tile floor. Leave corner protectors in place until necessary to remove them. Always use a piece of wood or cardboard to protect the bottom edge and corners of the glass prior to and during installation.
6. This unit must be installed upon a finished threshold and against finished walls.
7. This model can be adjusted **up to 3/8" on the panel side only** for out-of-plumb conditions within the u-channel. Verify that the walls are plumb before proceeding with the installation.
8. **This model requires that you drill into the threshold for proper installation.**
9. This model requires a minimum **1-1/2"** of flat threshold space for installation.
10. **This model requires two installers.**
11. **Professional installation recommended.**
12. **This model ships with both the LEFT and RIGHT hand L-Bar™ for support. Use the correct L-Bar based on the handing of the installation.**



NOTE: DO NOT attach the handle to the door glass or the towel bar to the panel glass until instructed.

DO NOT use the handle or towel bar to lift the glass during installation. This may result in damage to the glass and/or serious injury. Always use an assistant or a professional grade glass suction cup when handling heavy glass.



NOTE: This model is available in either a shower height or a tub height. This manual will describe the installation steps showing a shower height model. Please follow the same sequence of installation steps for the tub height model installation.

Model Diagram

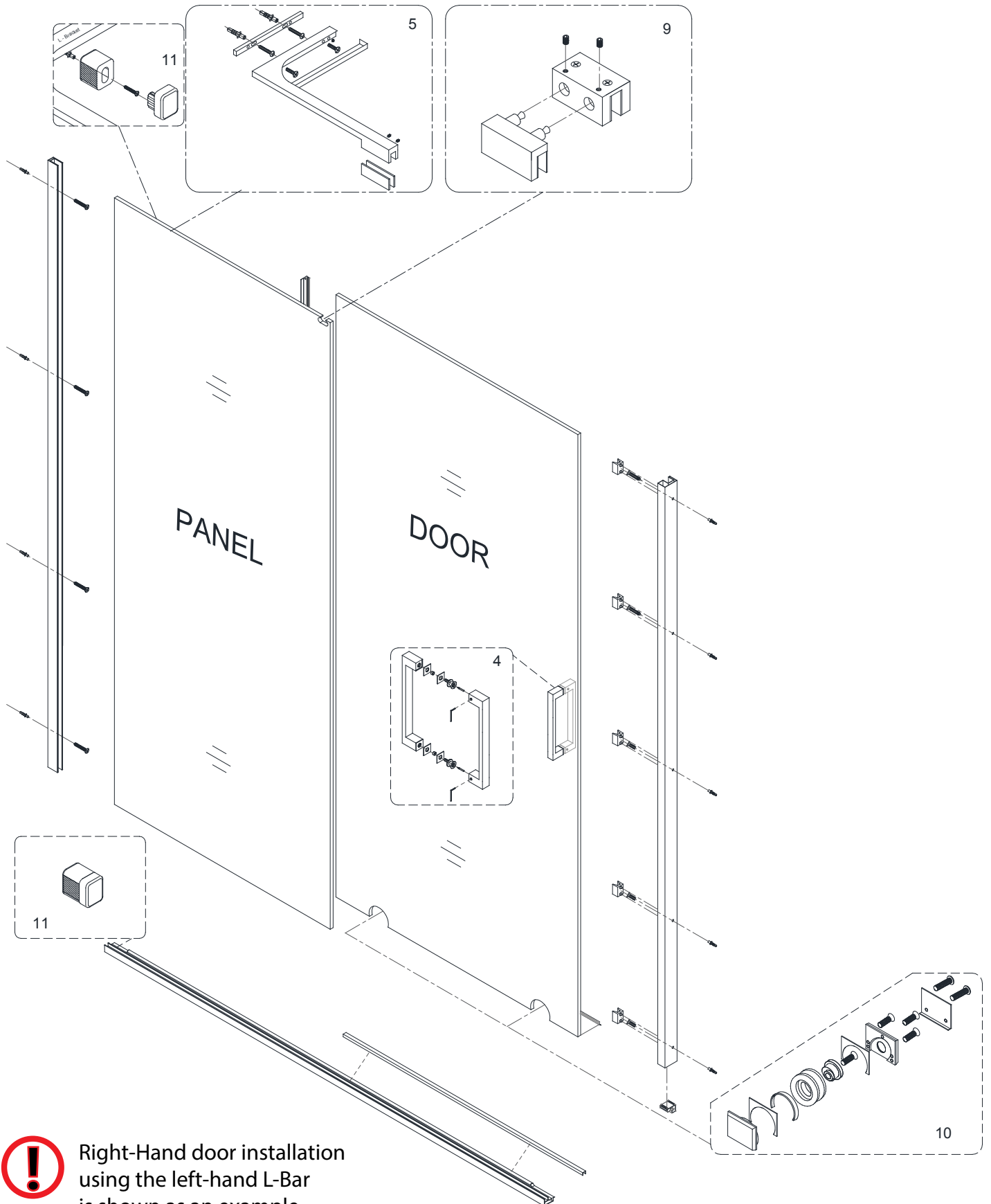

Right-Hand door installation
using the left-hand L-Bar
is shown as an example
through out this manual

Tools

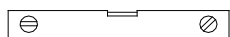

Level

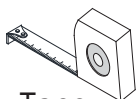

Tape Measure



Pencil



Phillips Screwdriver



Drill bit
Ø1/8"
(3mm)



Drill bit
Ø5/16"
(8mm)



Power Drill

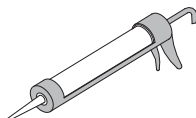

Silicone

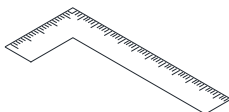

Carpenter's Square

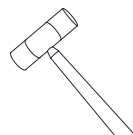

Soft Head Hammer

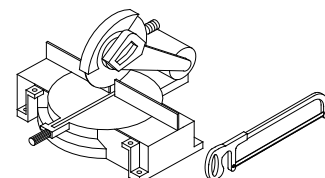

Miter saw and Hacksaw

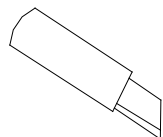

Razor Knife

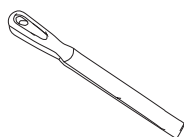

Metal File

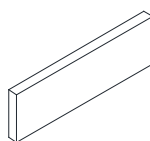

1/4" wood or plastic shim

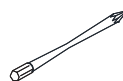

Phillips extender driver bit

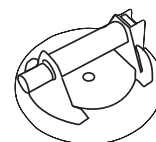

Professional-grade Glass suction cup

Tip: Measure the finished opening before proceeding with the installation to be sure that the correct model size has been ordered.

Tip: Prior to installation, cover the shower/tub drain with tape to prevent losing screws or small parts.

Tip: Set screw gun clutch to low setting when installing screws and bolts to prevent stripping the heads.

Threshold must be level.

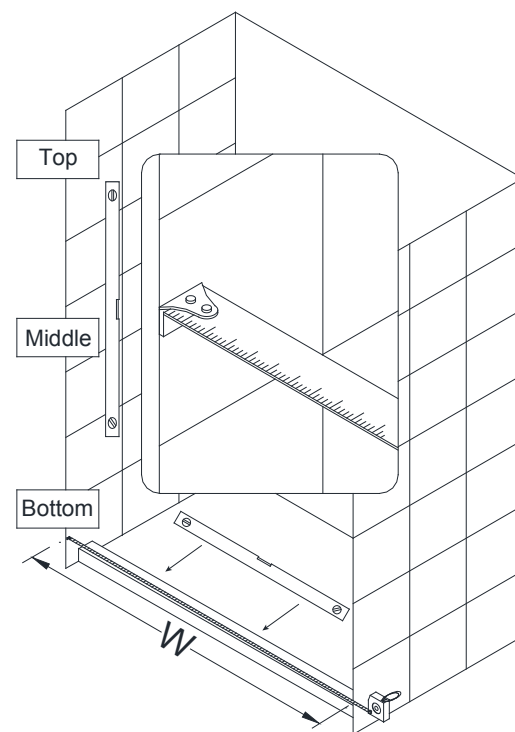
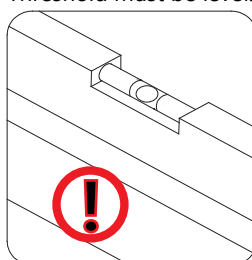

NOTE: Unpack your unit carefully and inspect it. Lay it out and identify all parts using the detailed diagram and packing list in this manual as a reference. Before discarding the carton, check for small hardware bags that may have fallen to the bottom of the box. If any parts are damaged or missing, please contact DreamLine® for replacement. The shipping boxes may contain extra parts not used in your model configuration.

NOTE: Retain these installation instructions for future reference.

Detailed Diagram of shower door components

L-Bar™ (Left)

L-Bar™ (Right)

NOTE: The left hand L-Bar™ installation is shown as an example throughout this manual. Follow the same steps for installing the Right-hand L-Bar™.

12" L-Bar™ for 48" model
18" L-Bar™ for 60" models

CLEARMAX™

The glass surface with the ClearMax™ label must be installed to face inside of the shower

1. L-Bar™ (Left) (Right-hand L-Bar™ for 60" models)

2. L-Bar™ (Right)

3. Panel

4. Door

5. L-Bar™ (Left) (Right-hand L-Bar™ for 60" models)

6. L-Bar™ (Left) (Right-hand L-Bar™ for 60" models)

7. L-Bar™ (Left) (Right-hand L-Bar™ for 60" models)

8. L-Bar™ (Left) (Right-hand L-Bar™ for 60" models)

9. L-Bar™ (Left) (Right-hand L-Bar™ for 60" models)

10. L-Bar™ (Left) (Right-hand L-Bar™ for 60" models)

11. L-Bar™ (Left) (Right-hand L-Bar™ for 60" models)

12. L-Bar™ (Left) (Right-hand L-Bar™ for 60" models)

13. L-Bar™ (Left) (Right-hand L-Bar™ for 60" models)

14. L-Bar™ (Left) (Right-hand L-Bar™ for 60" models)

15. L-Bar™ (Left) (Right-hand L-Bar™ for 60" models)

16. L-Bar™ (Left) (Right-hand L-Bar™ for 60" models)

17. L-Bar™ (Left) (Right-hand L-Bar™ for 60" models)

18. L-Bar™ (Left) (Right-hand L-Bar™ for 60" models)

19. L-Bar™ (Left) (Right-hand L-Bar™ for 60" models)

20. L-Bar™ (Left) (Right-hand L-Bar™ for 60" models)

21. L-Bar™ (Left) (Right-hand L-Bar™ for 60" models)

22. L-Bar™ (Left) (Right-hand L-Bar™ for 60" models)

23. L-Bar™ (Left) (Right-hand L-Bar™ for 60" models)

12" L-Bar™ for 48" model
18" L-Bar™ for 60" models

 **The glass surface
with the ClearMax™
label must be
installed to face
inside of the shower**

Parts List

ITEM#	PART NUMBER		DESCRIPTION	QTY
01	4872	010260001	Stationary Panel Glass	1pc
	6058	010260002		
	6072	010260003		
02	4872	010260004	Door Glass	1pc
	6058	010260005		
	6072	010260006		
03	48"	04170011-1269 / 04170041-1269	Bottom Guide Rail	1pc
	60"	04170011-1574 / 04170041-1574		
04	07221042 / 07224042		Handle (203mm centers)	1pc
05*	07121058 / 07121059 07124058 / 07124059		L-Bar™ (Left and Right) (12" or 18")	1 set of 2 (L/R)
06	07550045		Ø8mm (5/16") Plastic Wall Anchor	15pcs
07	092108		Countersunk screw ST4.2x40	12pcs
08	091105		Truss Head screw ST4.2x30	3pcs
09	07011102 / 07014102		Top Guide Block	1pc
10	07311019 / 07314019		Bottom Roller Assembly	2pcs
11	07021154 / 07024154		SafeStop™ Bumper	2pcs
12	48"	07121080 / 07124080	Bottom Rail insert	1pc
	60"	07121081 / 07124081		
14	07550091		0.5mm Bottom Spacer Strip	1pc
15	098002 / 098003		Allen Wrench: 2.5mm and 3mm	1each
16	091107		Truss Head screw ST4.2x40	3pcs
17	72"	07121085 / 07124085	Wall profile A (for panel glass)	1pc
	58"	07121086 / 07124086		
18	48"	63023000-0503	Deflector (w/adhesive)	1pc
	60"	63023000-0648		
19	72"	063002100-1804	Anti-Water Side Strip x1804mm / (71")	1pc
	58"	063002100-1447		
20	098008		Roller Adjustment tool	1pc
21	07551075		U-Channel support	1pc
22	72"	07121087 / 07124087	Wall profile B (for door glass)	1pc
	58"	07121088 / 07124088		
23	07550074		PVC Bumper inserts	5pcs

BOLD digit indicates finish color: **1**= Chrome, **4**= Brushed Nickel

* The 12" L-Bar™ (#05) is used with the 48" model. The 18" L-Bar™ (#05) is used with the 60" models (shower and tub)

Installation steps

1. Measure the finished opening at the top, middle and bottom.
The bottom width dimension will be "**W**".
Also check the threshold for level and the walls for plumb.

! **NOTE** that this model will provide up to 3/8" of adjustment for out-of-plumb conditions within the U-Channel on the **stationary panel side only**. (**Fig 1**)

This model requires a minimum threshold width of 1-1/2"

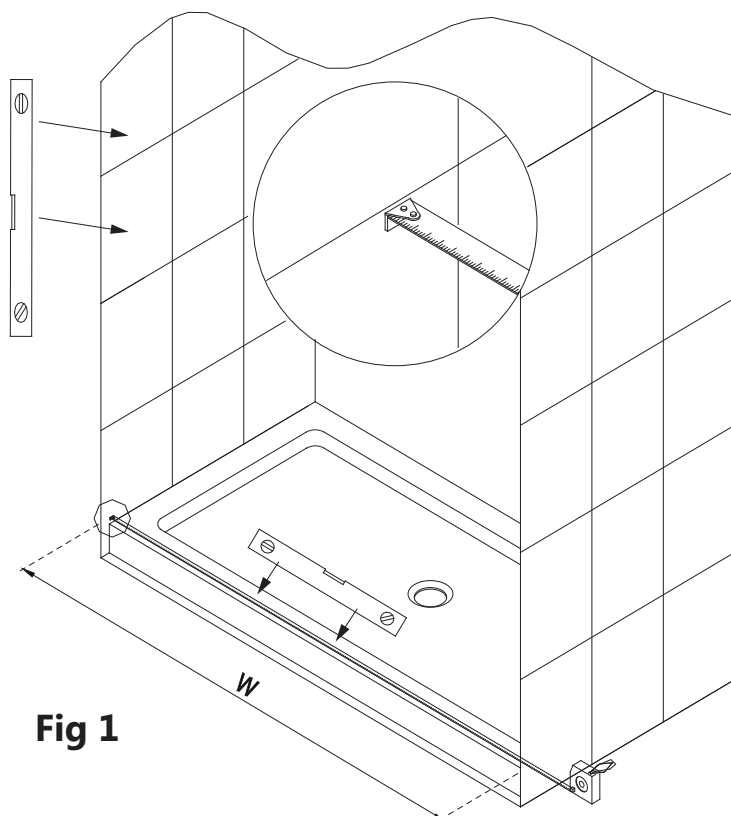

Fig 1

2. Subtract **1/16"** from the "**W**" dimension.
(**W** (-) 1/16" = **L**) "**L**" = finished cut length.
Use a miter saw or hack saw to cut your **Bottom Guide Rail (#03)** to the finished cut length "**L**". Use a metal file to file off any burrs from the cut end of the Bottom Rail. (**Fig 2**)

! **NOTE:** Only cut from the end of the bottom rail that will be installed on the door side of the opening.

NOTE: The **Bottom Guide Rail (#03)** is made 2" larger than the model size:
(48" model = 50" bottom rail, 60" model = 62" bottom rail).
The rail is milled at both ends to accommodate the bottom bumper for the panel side. This milling will be cut off on the door-end when the bottom rail is cut to size to fit the finished opening.

NOTE: If it is necessary to drill new attachment holes into the bottom guide rail after cutting to size: drill a **Ø3/16"** hole throughout and then a **Ø5/16"** hole through the top layer only. (Refer to the existing holes in the rail for example)

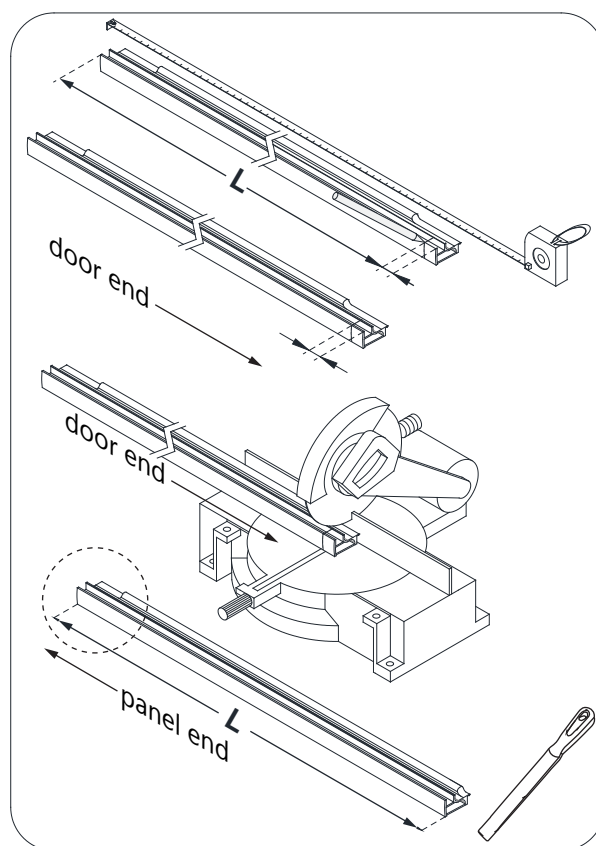

! **Bottom Rail cut for right-hand door installation shown as an example**

Fig 2

3. Attach the **U-Channel Support Block (#21)** to the door end of the **Bottom Guide Rail (#03)**. (Fig 3)

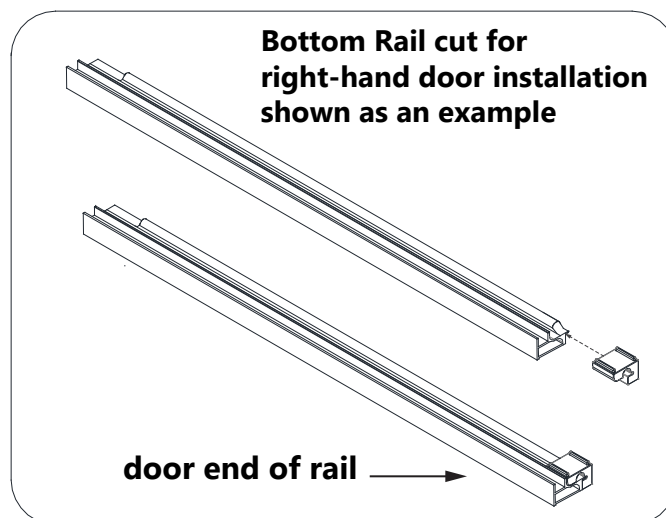

Fig 3

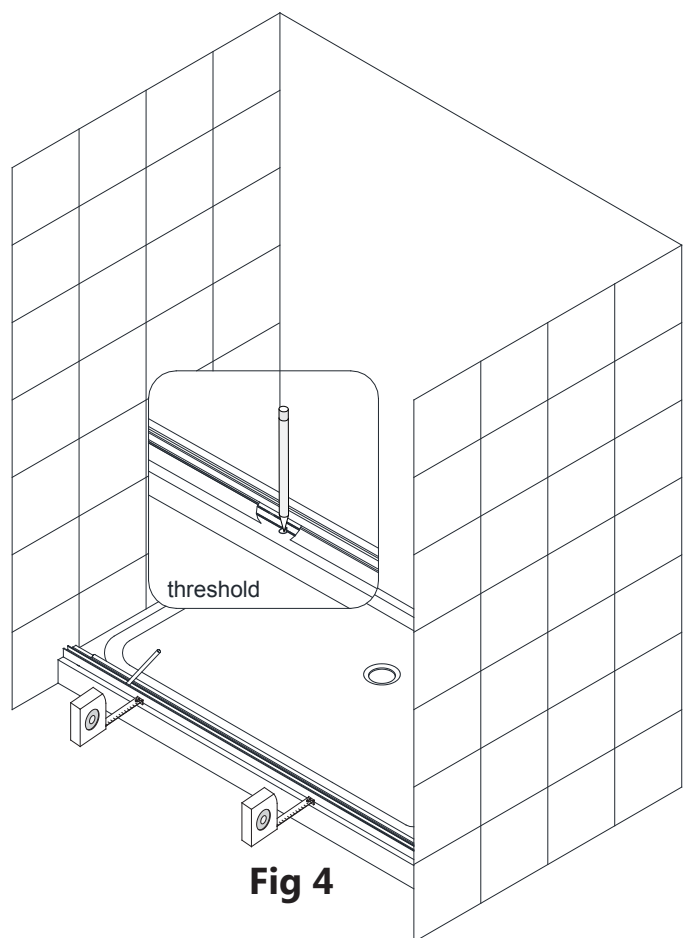

Fig 4

4. Place the **Bottom Guide Rail (#03)** onto the threshold and mark its position. Use a tape measure to keep the **Bottom Guide Rail (#03)** parallel with the outside edge of the threshold. (Fig 4)

5. Mark the position of the holes on the threshold through the holes in the **Bottom Guide Rail (#03)**.

***NOTE:** Use a power drill to make the holes using:

- **Ø1/8"** drill bit (for installation into an acrylic threshold)
- **Ø5/16"** drill bit (using anchors into a tile threshold)**

Apply silicone to the underside of the **Bottom Guide Rail (#03)** and attach it to the threshold using:

▪ **ST4.2 x 30mm Truss Head screws (#16)** for an acrylic threshold.

OR

▪ **ST4.2 x 40mm Truss Head screws (#21)** (with **anchors for tile).

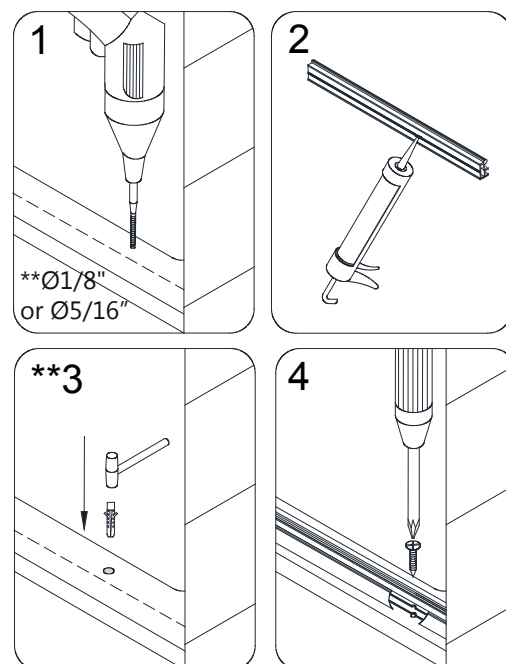

**Use anchors for installation into a tile threshold only

Fig 5

(Fig 5)

6. Position the **Wall Profile A (panel side) (#17)** against the wall, on top of the **Bottom Guide Rail (#03)**, and flush with the outside of the **Bottom Guide Rail (#03)**. Adjust to plumb using a level. Mark the **Wall Profile A (panel side) (#17)** position on the wall. (**Fig 6**)

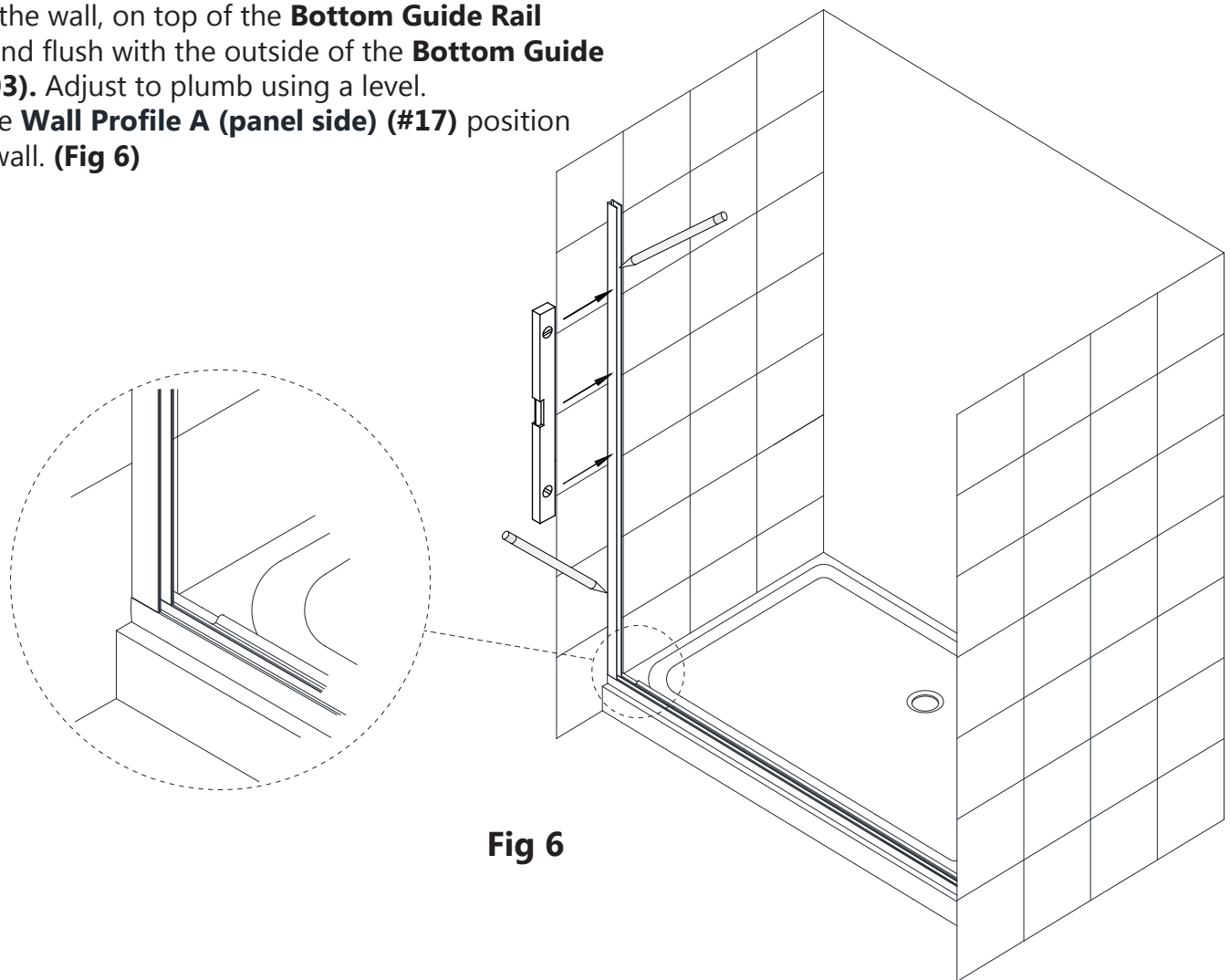

Fig 6

7. Mark the hole locations for drilling through the holes in the **Wall Profile A (panel side) (#17)**. Remove the **Wall Profile A (panel side) (#17)** and drill $\text{Ø}5/16''$ (6mm) holes into the wall. Insert the **Wall Anchors (#06)**. Apply a bead of silicone to the wall or to the back of the **Wall Profile A (panel side) (#17)**.

Attach the **Wall Profile A (panel side) (#17)** to the wall using the **ST4.2 x 40 screws (#07)**. (**Fig 7**)

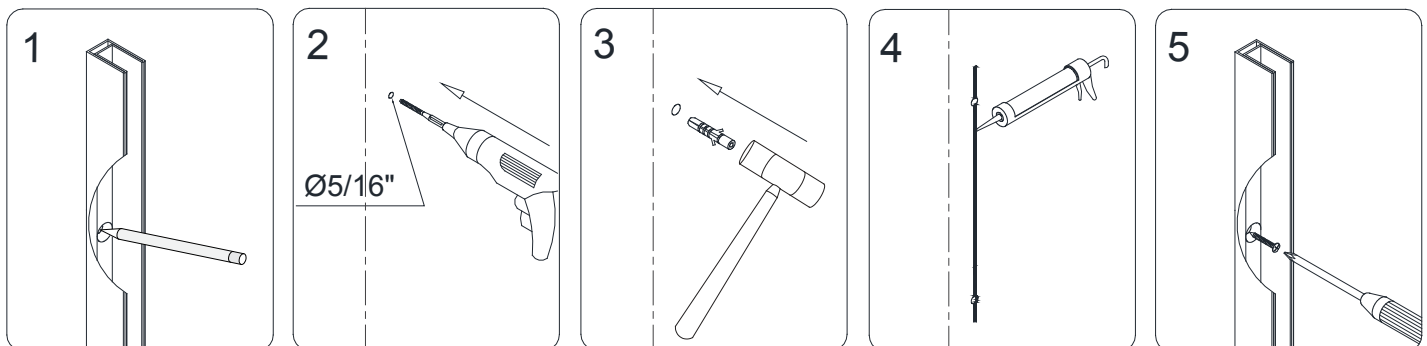
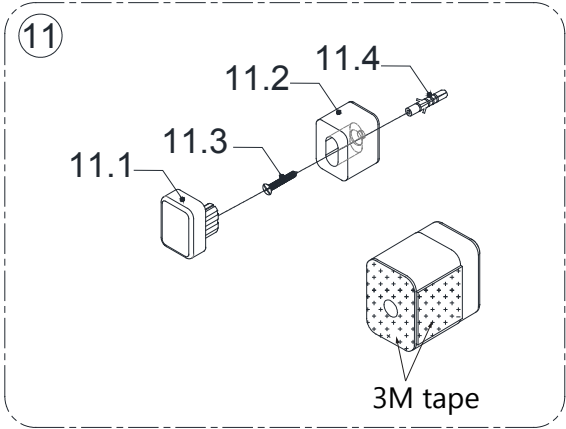

Fig 7

NOTE: The top **Safe Stop™ Bumper (#11)** must be screwed to the wall beneath the **L-Bar™ (#05)** and against the **Wall Profile/U-Channel (#17)**. The bottom **Safe Stop™ Bumper (#11)** is installed with **3M tape** only. Attaching the bottom **Safe Stop™ Bumper (#11)** with a screw is optional.

(Fig 8, Fig 9a and Fig 9b)



Safe Stop™ Bumper #11 parts list

11.1	Bumper insert	1pc
11.2	Bumper base	1pc
11.3	ST4.2x40	1pc
11.4	Wall Anchor	1pc

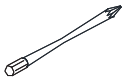
 Phillips extender driver bit recommended for screw installation

8. To install the top **Safe Stop™ Bumper (#11)**: Remove the **Bumper Insert (#11.1)** and hold the **Bumper Base (#11.2)** in place 1" below the top and against the **Wall Profile/U-Channel (#17)** (**Fig #7.1**) to mark the position on the wall and to mark the hole for drilling. Drill a **Ø5/16"** hole and insert a **Wall Anchor (#11.4)**. Clean the area with an alcohol swab. Remove the **3M tape** backing from the **Safe Stop™ Bumper (#11)**. Install the **Bumper Base (#11.2)** with the **ST4.2 x 40 Screw (#11.3)** and replace the **Bumper Insert (#11.1)**. (**Fig 8**)

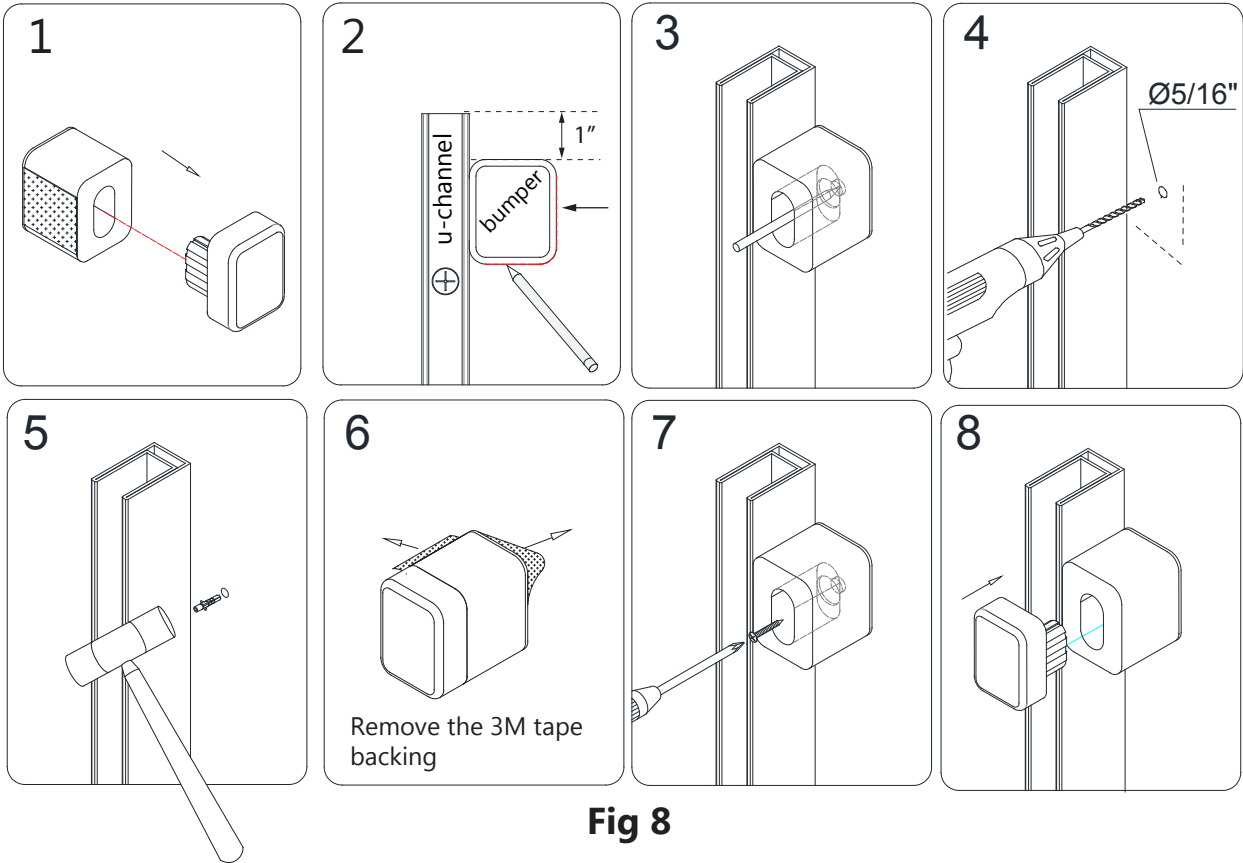

Fig 8

9. To install the bottom **Safe Stop™ Bumper (#11)**: First, clean the area with an alcohol swab. Remove the **3M tape** backing from the **Safe Stop™ Bumper (#11)** and install the **Safe Stop™ Bumper (#11)** onto the **Bottom Rail (#03)** firmly against the wall and the **Wall Profile/U-Channel (#17)**. (Fig 9a and Fig 9b)

! **NOTE:** Drilling a $\varnothing 5/16''$ hole and using an anchor to attach the bottom **Safe Stop™ Bumper (#11)** is optional.

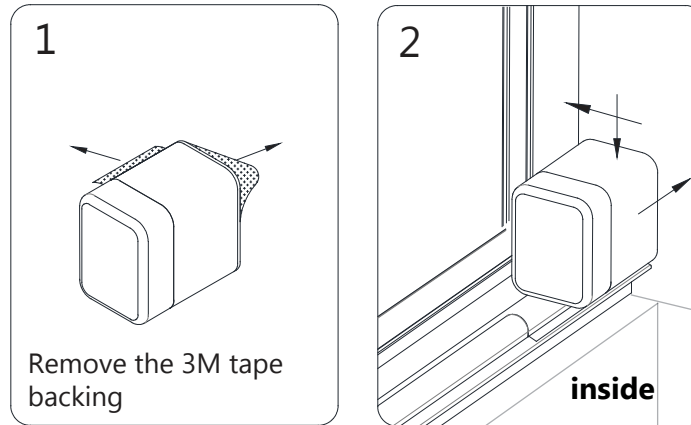

Fig 9a

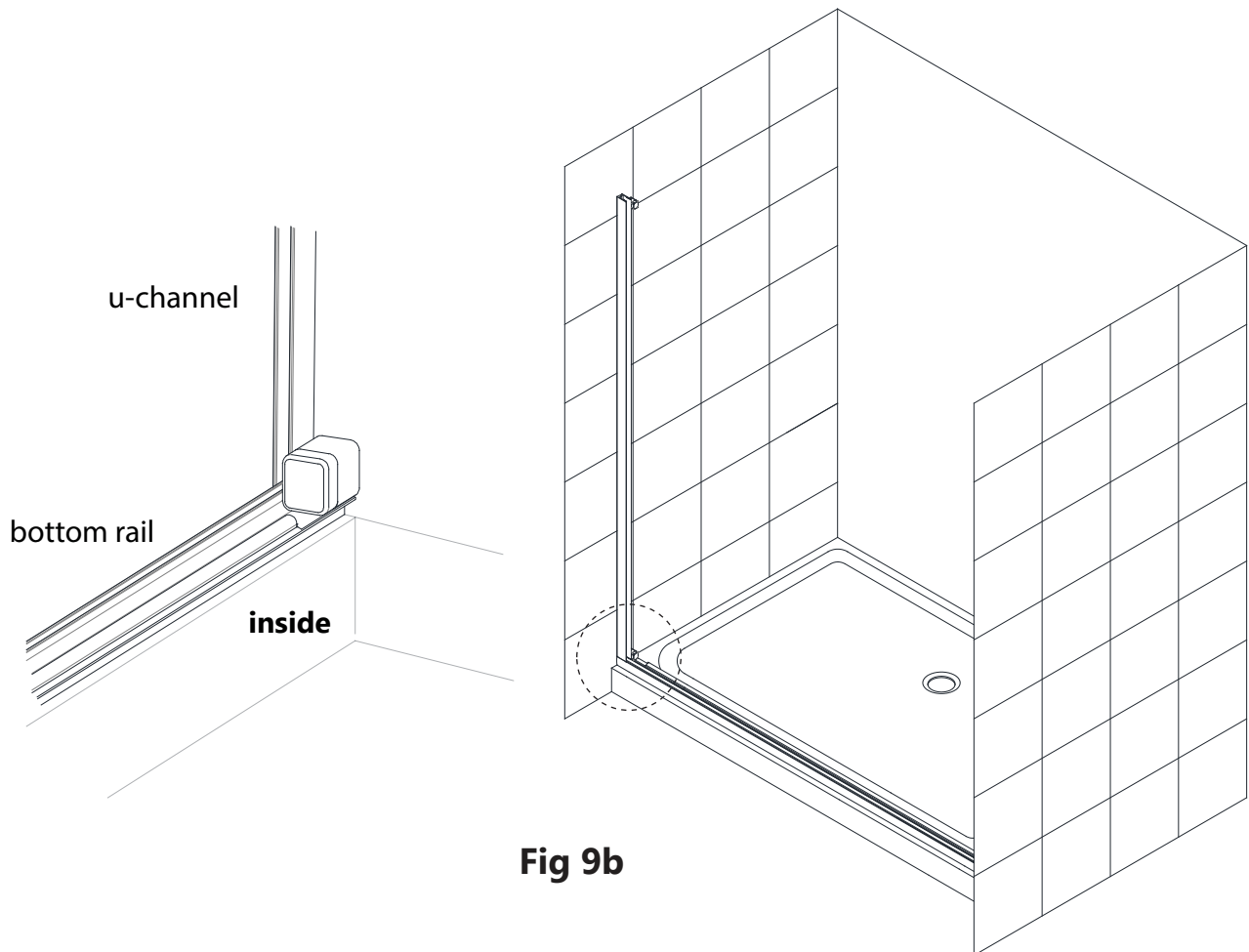

Fig 9b

10. Apply silicone into the **Wall Profile/U-Channel (#17)** and into the **Bottom Guide Rail (#03)** equal to the width of the panel glass. **(Fig 10)**

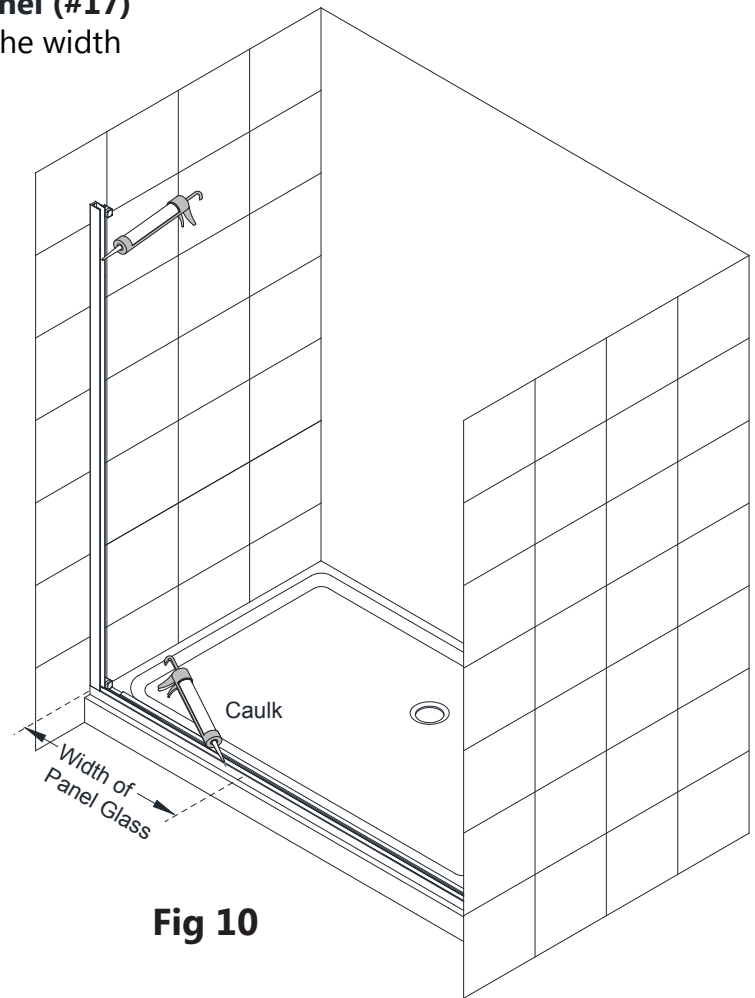

Fig 10

11. Cut the **0.5mm Bottom Spacer Strip (#14)** into four to five 2" pieces and place them into the **Bottom Guide Rail (#03)** (after the silicone) to protect the bottom edge and corners of the **Stationary Panel Glass (#01)**. **(Fig 11)**

! **DO NOT** install one long continuous strip into the bottom rail.

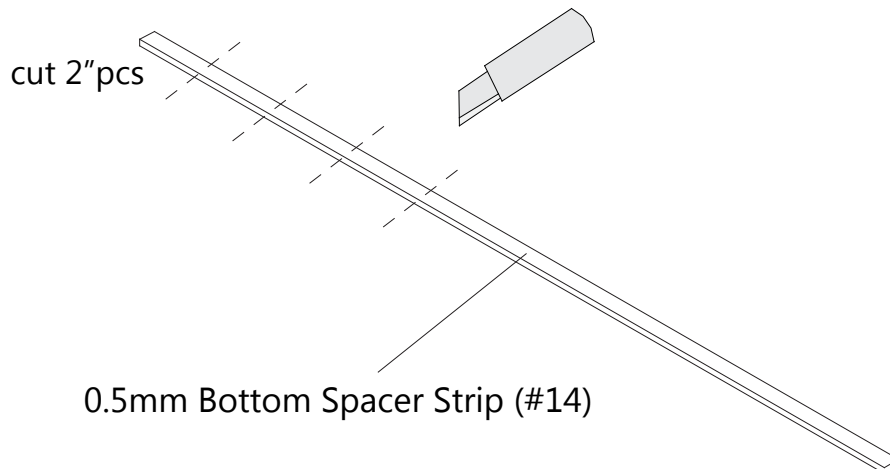

Fig 11

12. After applying silicone into the **Bottom Guide Rail (#03)**, add the 2" pieces of the **0.5mm Bottom Spacer Strip (#14)** into the **Bottom Guide Rail (#03)** to protect the bottom edge and corners of the **Stationary Panel Glass (#01)**. (Fig 12)

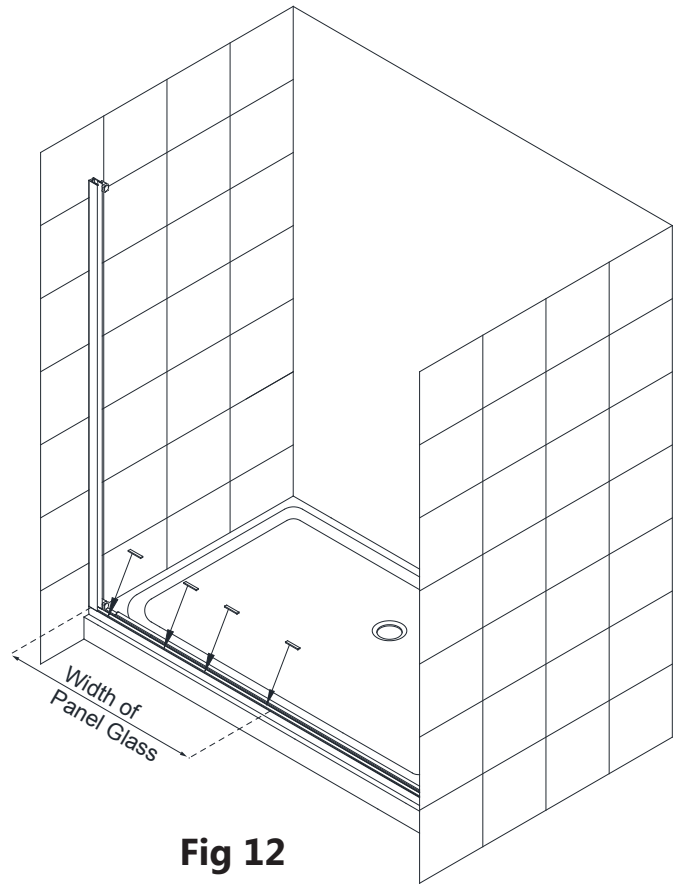

Fig 12

13. Install the **Stationary Panel Glass (#01)** into the **Wall Profile/U-Channel (#17)** and **Bottom Guide Rail (#03)**. (Fig 13)



NOTE: The panel-side **Wall Profile/U-Channel (#17)** will allow for up to 3/8" of out-of-plumb adjustment. Use a level to confirm that the **Stationary Panel Glass (#01)** is installed plumb and level.

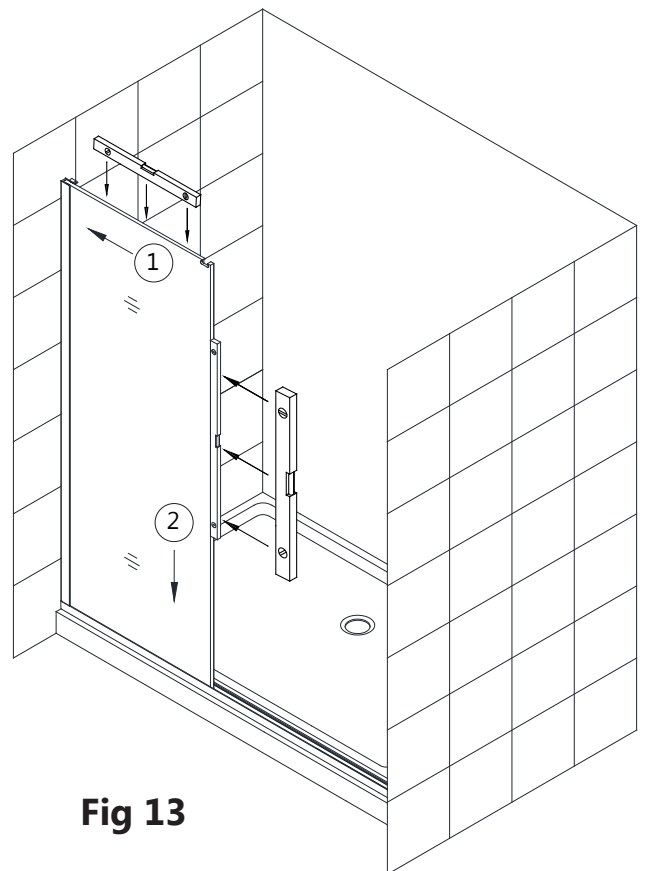
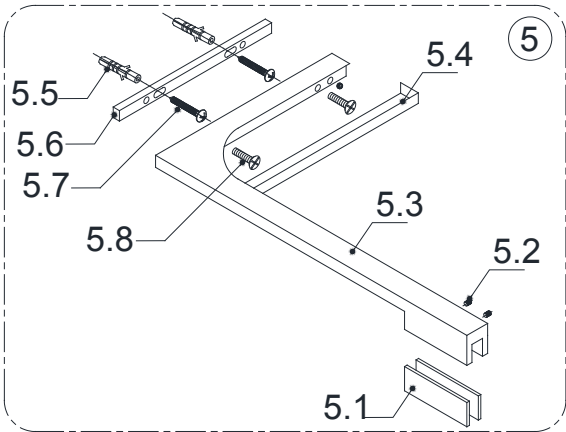

Fig 13

Right-hand door installation shown

14. After the **Stationary Panel Glass (#01)** is installed into the **Wall Profile/U-Channel (#17)**, install the appropriate (Left or Right) **L-Bar™ (#05)** as described in the following steps. **(Fig 14)**

Left **L-Bar™** installation shown as an example



L-Bar parts list

5.1	Rubber pad	2pcs
5.2	M5 rubber tip set screw	2pcs
5.3	L-Bar	1pc
5.4	Decorative cover	1pc
5.5	Wall Anchor	2pcs
5.6	Wall plate	1pc
5.7	ST4.2x40	2pcs
5.8	M5x14.5 Screw	2pcs

Fig 14

12" L-Bar™ for 48" model
18" L-Bar™ for 60" models

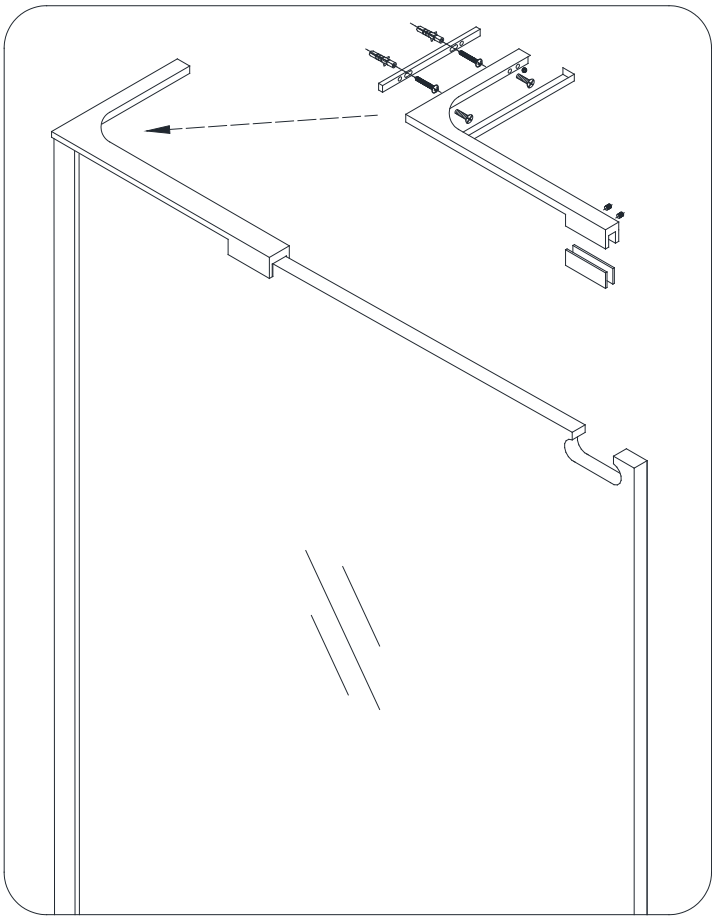

Left L-Bar installation shown as an example

15. Use a level and position the **L-Bar™ (#05)** onto the **Stationary Panel Glass (#01)** as shown and mark the position on the wall. Remove the **Wall Plate (#5.6)** and mark the holes for drilling. Drill two **Ø5/16" (8mm)** holes and insert the **Wall Anchors (#06)**. Attach the **Wall Plate (#5.6)** using **ST4.2 x 40 (#5.7)** screws. (**Fig 15**)

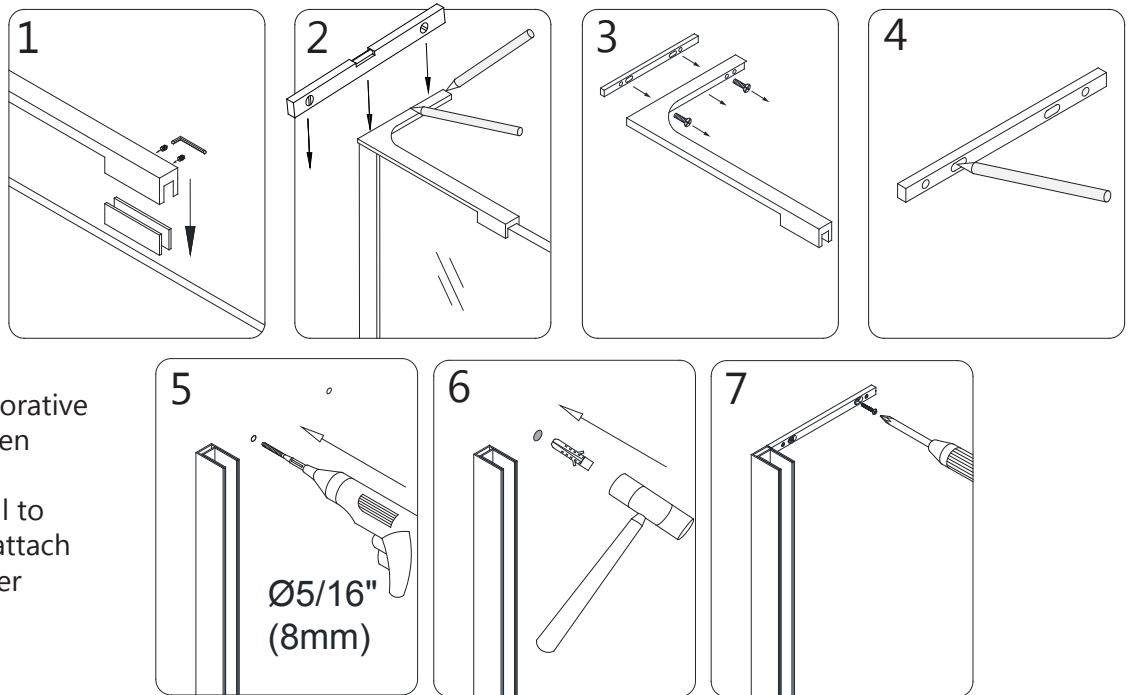

TIP: Leave the decorative cover attached when marking the L-Bar position on the wall to allow space to re-attach the cover plate after installation.

Fig 15

16. Attach the **L-Bar™ (#5.3)** to the **Wall Plate (#5.6)** and adjust the angle (+/-) 3/16" (4mm) if necessary using the set screws (**Fig 16.3 and 16.4**). Secure the **L-Bar™ (#05)** to the top of the **Stationary Panel Glass (#01)** using the clear gasket and rubber-tipped set screws. Firmly tighten the set screws and re-attach the **Decorative Cover (#5.4)**. (**Fig 16**)

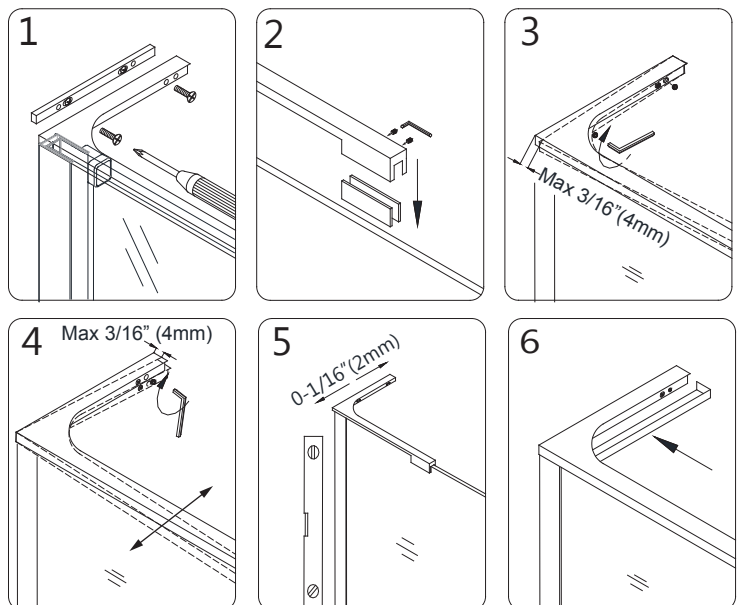
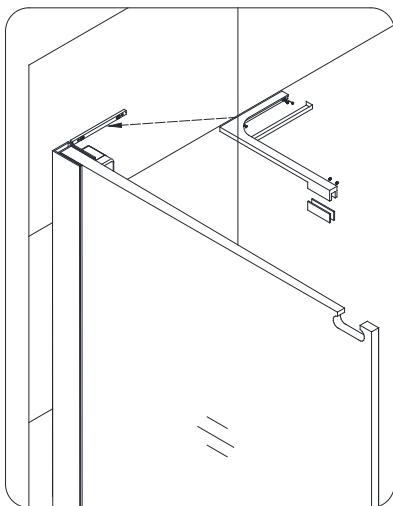
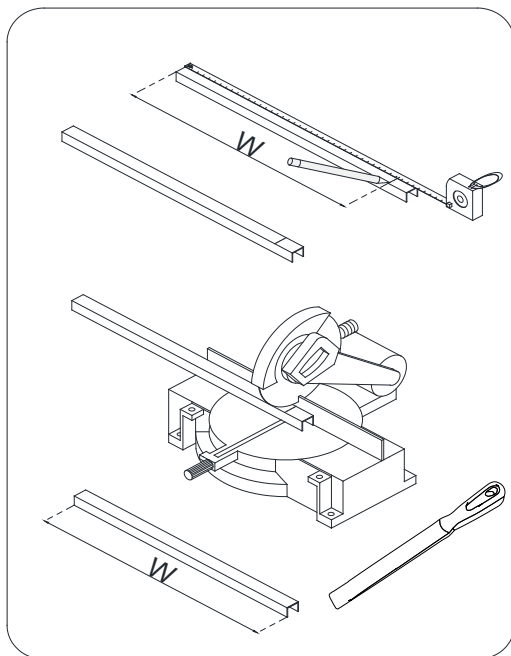

Fig 16

17. Measure from the edge of the installed **Stationary Panel Glass (#01)** to the wall and cut the **Bottom Rail Insert (#12)** to this dimension: **W (-) 1/16"**. Use a metal file to file off any burrs from the cut end. Apply silicone into the **Bottom Guide Rail (#03)** and install the **Bottom Rail Insert (#12)**.
(Fig 17)



Trim the insert to: **W (-) 1/16"**

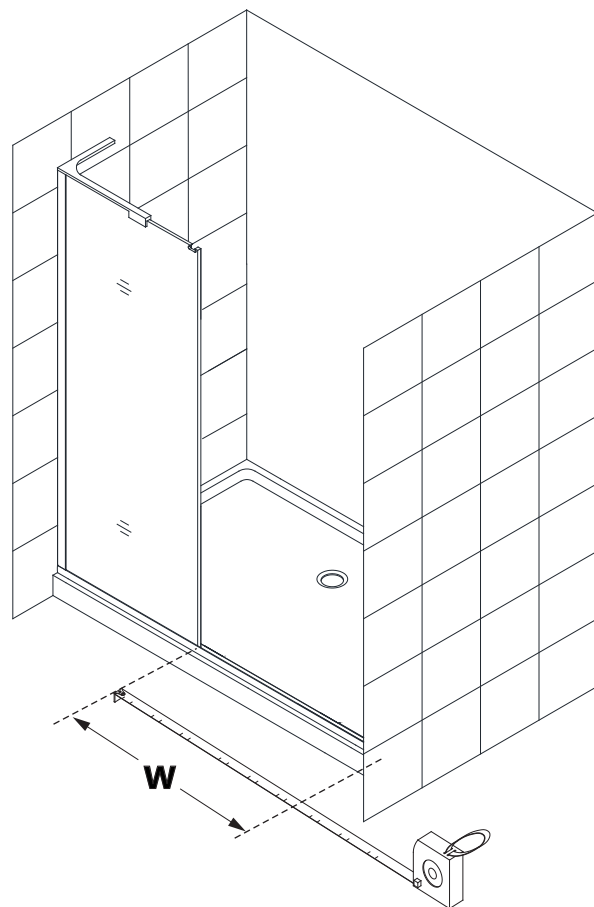
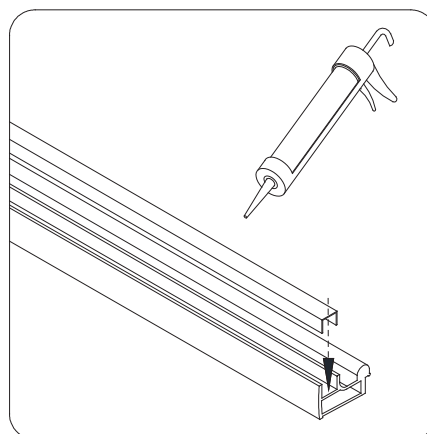
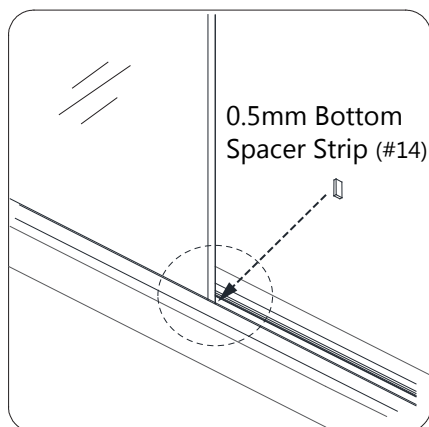

Fig 17



NOTE: Insert a small section (1/4" +/-) of the leftover **0.5mm Bottom Spacer Strip (#14)** between the end of the **Bottom Rail Insert (#12)** and the **Stationary Panel Glass (#01)** to prevent glass-to-metal contact.

Bottom Roller Assembly (#10)

Parts List

10.1	Roller body (exterior)	1pc
10.2	Rubber pad 1	2pcs
10.3	Rubber pad 2	1pc
10.4	Bearing	1pc
10.5	Adjustment disk	1pc
10.6	M5x14 Allen Bolt	4pcs
10.7	Cover plate	1pc
10.8	Decorative cover plate	1pc
10.9	M5x16 Allen Bolt	2pcs

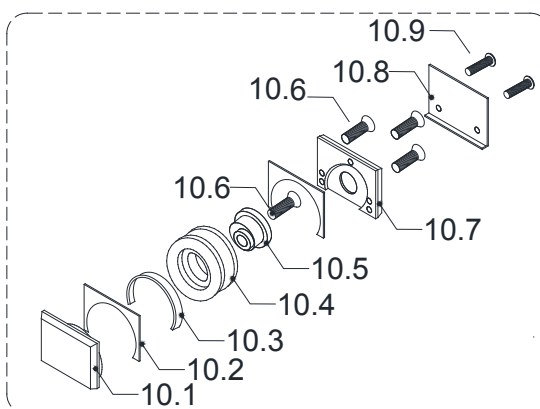

NOTE: It is **not** necessary to completely disassemble the wheel assembly during installation



NOTE: DO NOT install the handle onto the door glass until instructed. **DO NOT** lift the glass using the handle. This could result in damage to the glass and /or serious personal injury. Always use an assistant or a professional grade glass suction cup when handling heavy glass.

18. Remove the **M5 x 16 Allen Bolts (#10.9)** and the **Cover Plate (#10.7)**.

Remove the three **M5 x 14 Allen Bolts (#10.6)** and attach the **Roller Assemblies (#10)** to the **Door Glass (#02)**. Make certain that the bolts are facing the inside of the shower and that the roller assemblies are installed squarely onto the glass. (**Fig 18a and Fig 18b**)

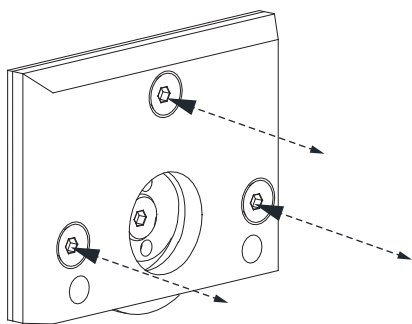

Fig 18a

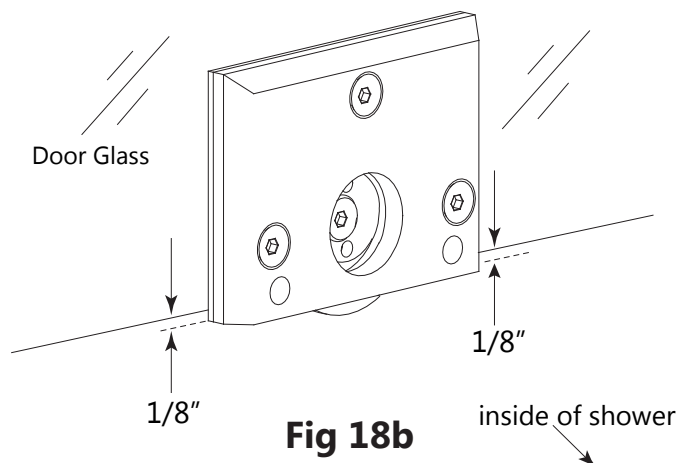

Fig 18b



NOTE: Have an assistant available to hold the door glass in position during the next steps until the door is secured in position with the **Guide Block Assembly (#09)**.

19. Set the **Door Glass (#02)** with the attached **Bottom Roller Assemblies (#10)** onto the **Bottom Guide Rail (#03)**. Have an assistant support the **Door Glass (#02)** for the next few steps. **(Fig 19)**



NOTE: Use caution to prevent the door glass from making contact with the installed panel glass or the wall during installation.

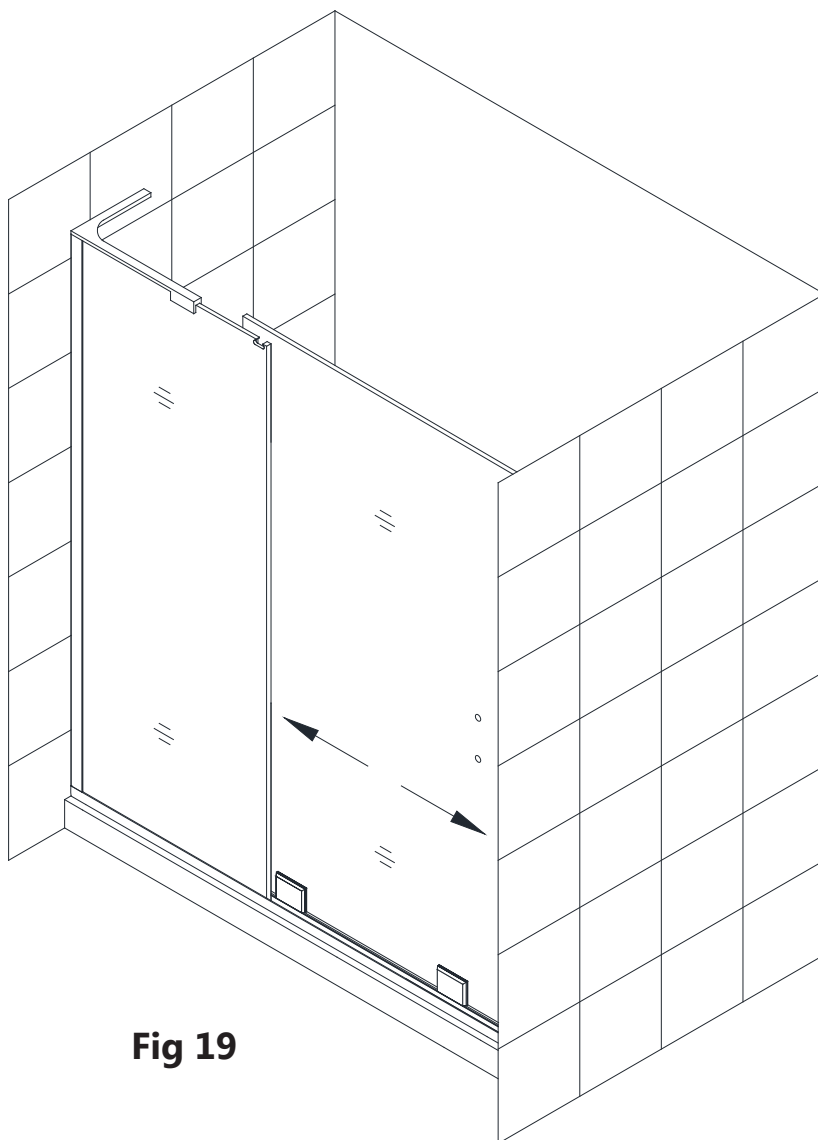
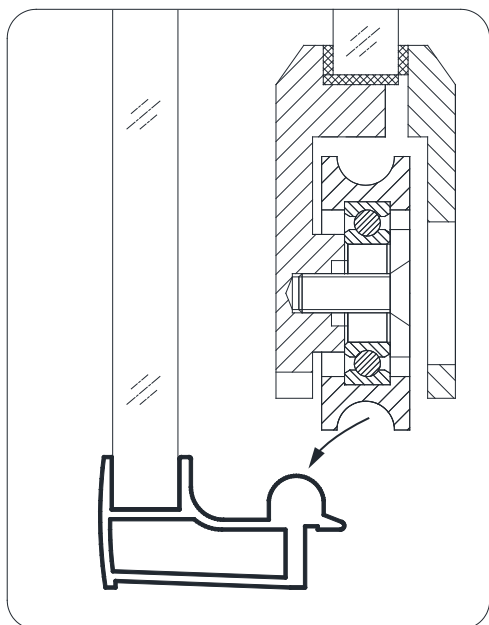

Fig 19

Guide Block Assembly (#09)

Parts List

9.1	Exterior Slider Bracket (for panel)	1pc
9.2	Gasket	2pcs
9.3	Rubber sleeve	2pcs
9.4	Shaft	2pcs
9.5	Sliding pad	1pc
9.6	Sliding Guide Block (for door)	1pc
9.7	M5x10 set screw	2pcs
9.8	M4x4 flat head screw	2pcs

20. Loosen the **M5x10 set screws (#9.7)** to separate the bracket. Attach the **Exterior Slider Bracket (#9.1)** through the notch of the installed **Stationary Panel Glass (#01)** as shown in **Fig 20a.1** using the **Gasket (#9.2)** and **Rubber Sleeves (#9.3)**.

Next, while holding the **Door Glass (#02)** in place, position the **Sliding Guide Block (#9.6)** onto the **Door Glass (#02)**, align and attach the two halves of the **Guide Block (#09)** with the **M5 x 10 set screws (#9.6)** using **Allen Wrench (#15)** (**Fig 20a and Fig 20b**)

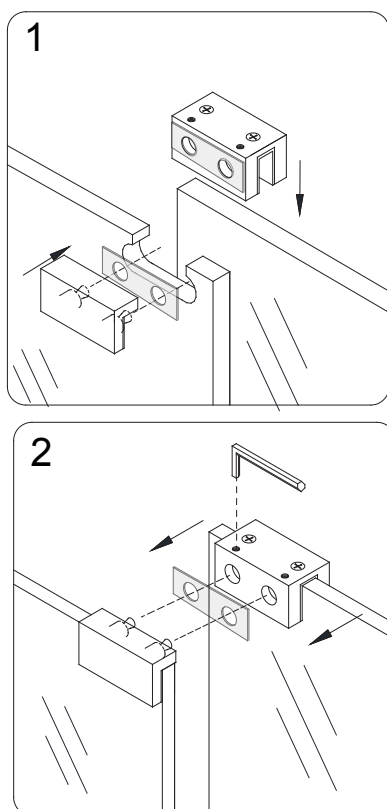
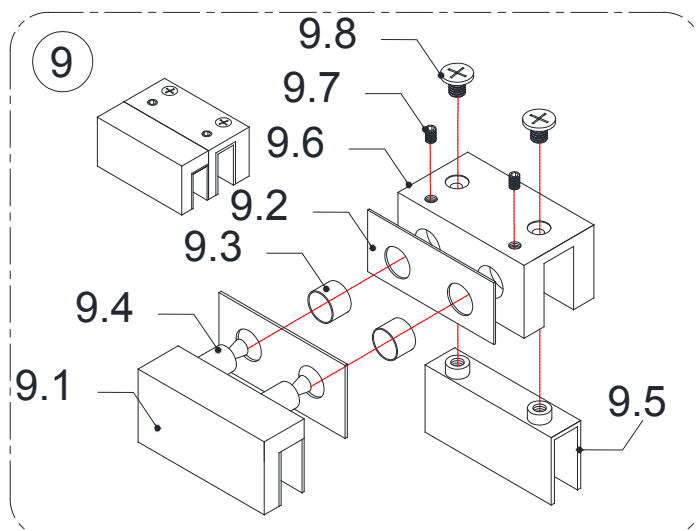

Fig 20a



NOTE: It is **not** necessary to completely disassemble the guide block assembly during installation

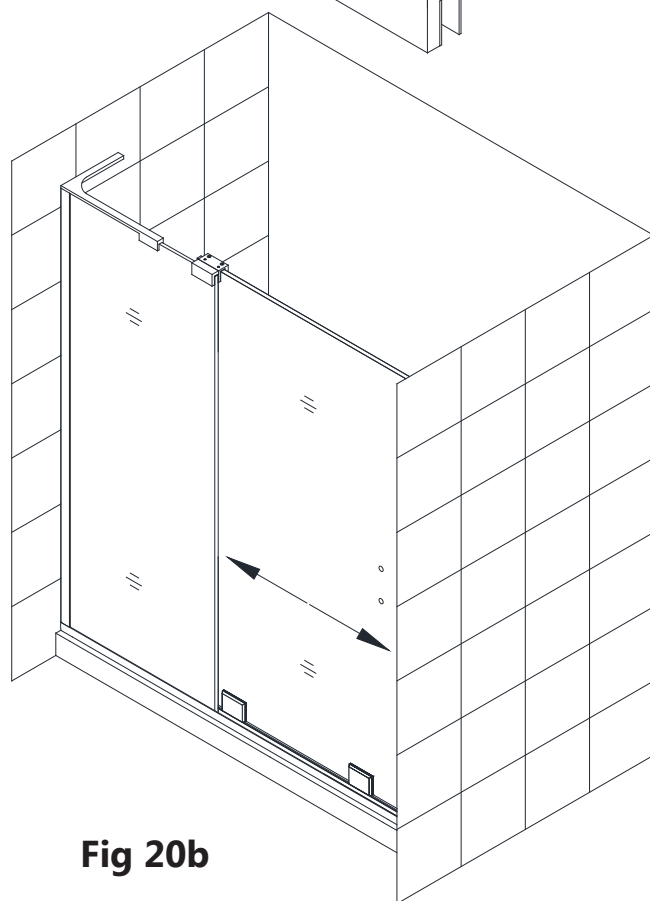
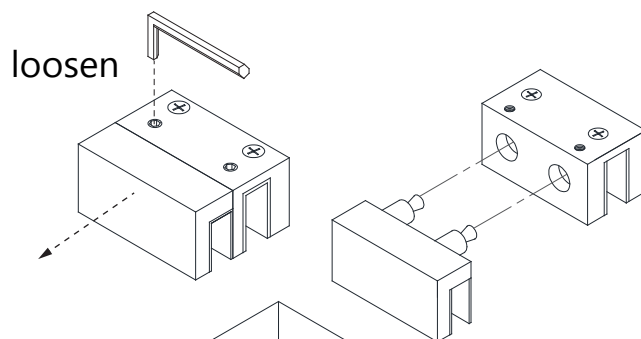

Fig 20b

21. Install the **Handle (#04)** through the holes in the **Door Glass (#02)**. Be sure that the pvc gaskets and sleeves are in place. **(Fig 21)**

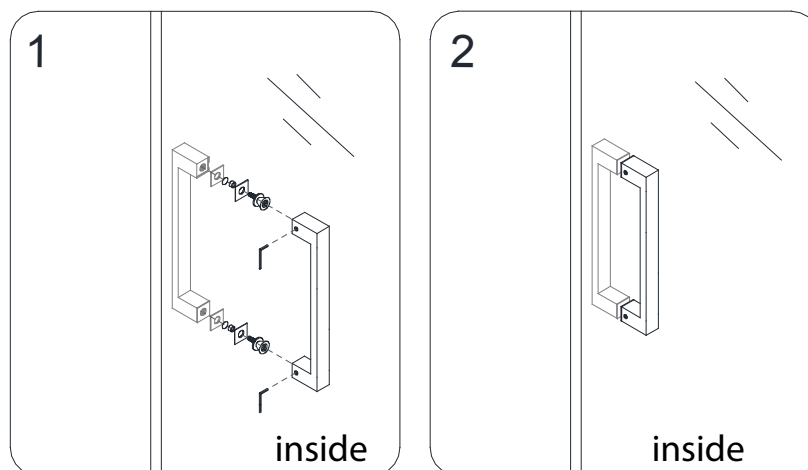

Fig 21

22. Position the **Wall Profile B (door side) (#22)** against the wall and onto the **U-Channel Support Block (#21)** on the door-side of the opening. **(Fig 22)**

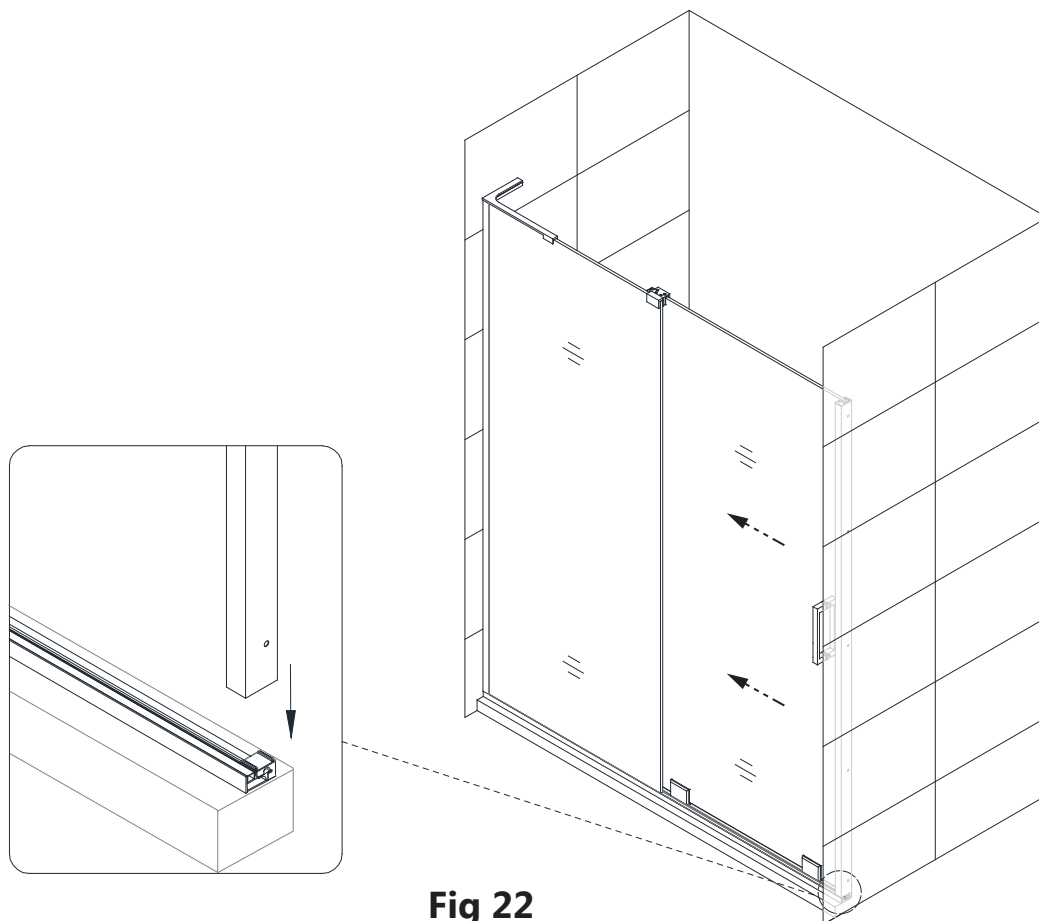

Fig 22

23. Partially insert at least two of the **PVC Bumper Inserts (#23)** into **Wall Profile B (door side) (#22)** for accurate alignment. Close the door into the profile. Use a level to hold the **Wall Profile B (door side) (#22)** plumb and mark the position of the **Wall Profile B (door side) (#22)** on the wall. (**Fig 23**)



Partially insert at least two of the **PVC Bumper Inserts (#23)** at the top and bottom of the **Wall Profile B** for accurate alignment with the door glass. **Do not cover the holes that need to be marked on the wall.** Failure to use these inserts when aligning the **Wall Profile B** may result in misalignment with the **Door Glass**.

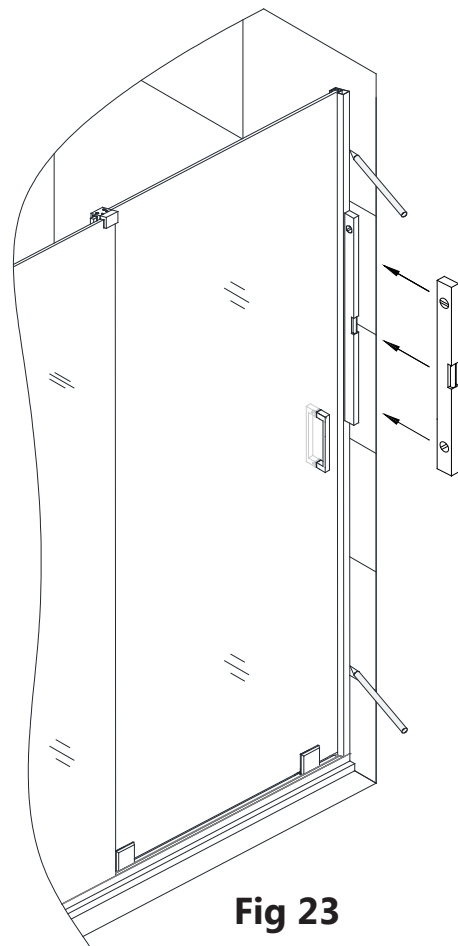
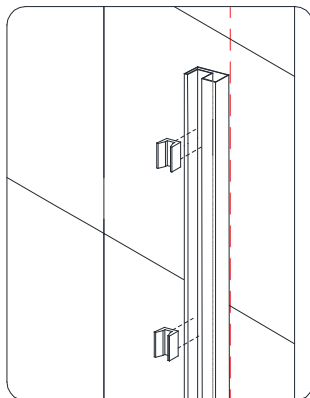

Fig 23

24. Remove the **PVC Bumper Inserts (#23)**. Mark the holes for drilling through the larger holes in the **Wall Profile B (door side) (#22)**. (**Fig 24**)

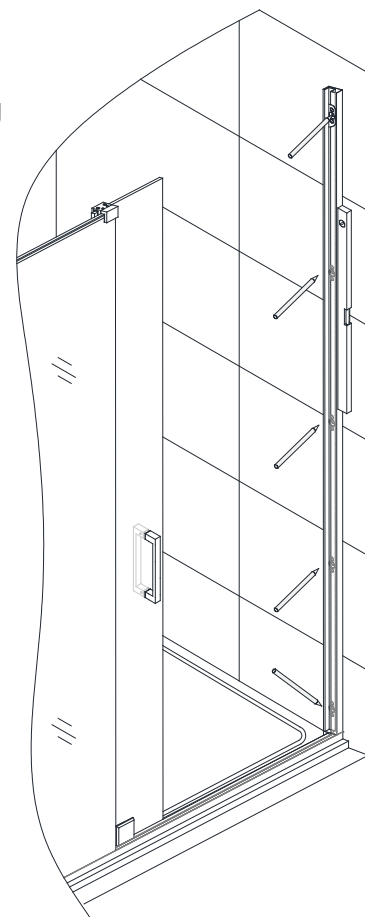
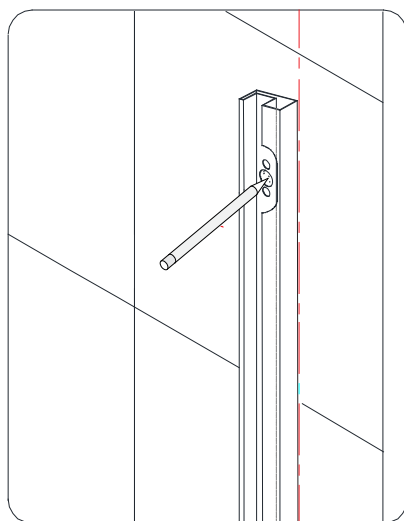

Fig 24

25. Remove the **Wall Profile B (door side) (#22)** and drill **Ø5/16" (6mm)** holes into the wall. Insert the **Wall Anchors (#06)**.
 Apply a bead of silicone to the back of the **Wall Profile B (door side) (#22)**.
 Attach the **Wall Profile B (door side) (#22)** to the wall using the **ST4.2 x 40 Screws (#07)**.
 Use a 1/4" thick wooden or plastic shim to fully press the **PVC Bumper Inserts (#23)** into the smaller holes in **Wall Profile B (door side) (#22)**.
(Fig 25)

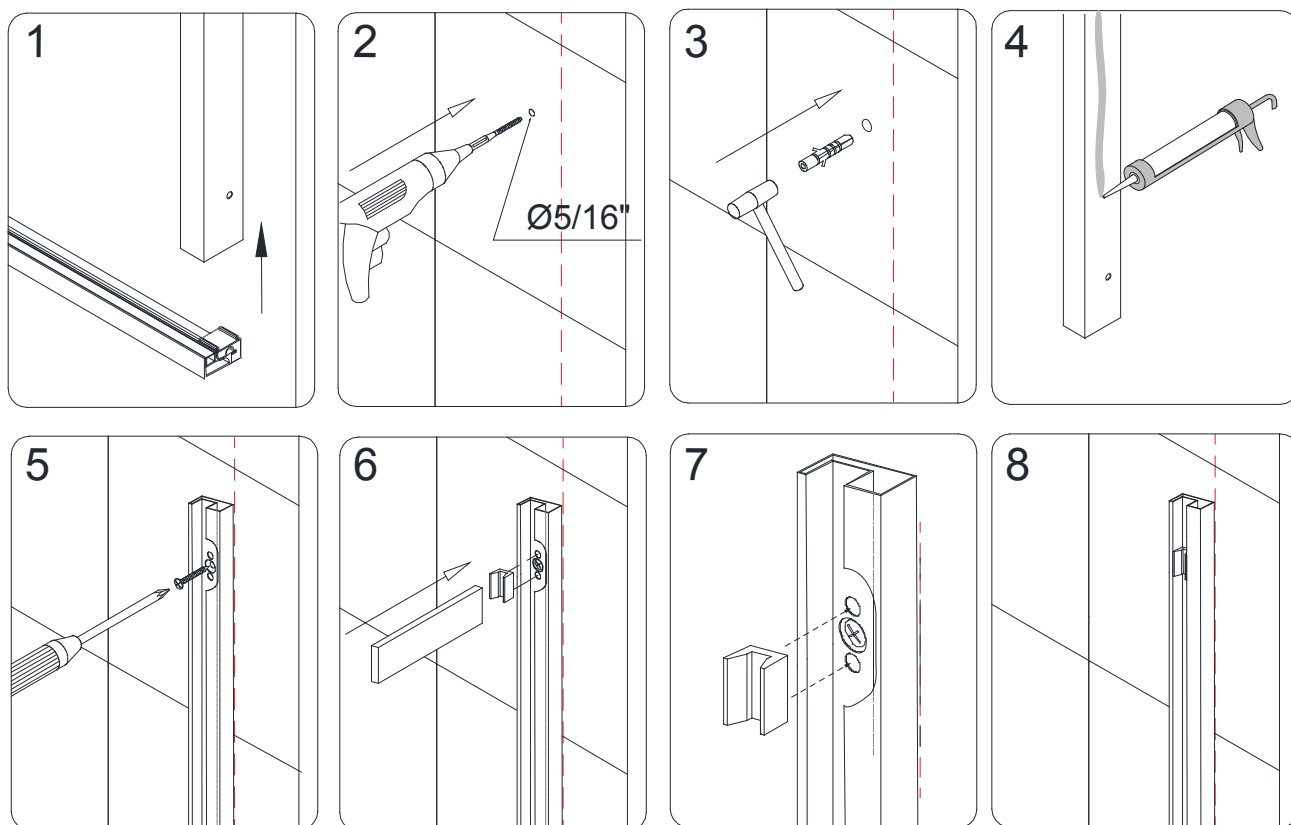

Fig 25

TIP: Use a 1/4" thick wood or plastic shim to fully press the **PVC Bumper Inserts (#23)** into the **Wall Profile B (door side) (#22)** (Fig 25.6)

26. The door should operate smoothly and create a good seal within the **Wall Profile B (door side) (#22)** when in the fully closed position.

If necessary, adjust the **Bottom Rollers (#10)** to tilt the door slightly for a tight fit into the **PVC Bumper Inserts (#23)**.

To adjust the rollers: Loosen the center **M5 x 14 Allen Bolts (#10.6)** and then rotate the **Adjustment Disk (#10.5)** using the **Roller Adjustment Tool (#20)** as shown below.

Use shims or an assistant to hold the **Door Glass (#02)** in the desired position and re-tighten the allen bolt.

Only adjust one roller at a time. (Fig 26a and Fig 26b)



Use shims beneath the door glass during adjustment to prevent the door glass from making contact with the bottom rail.

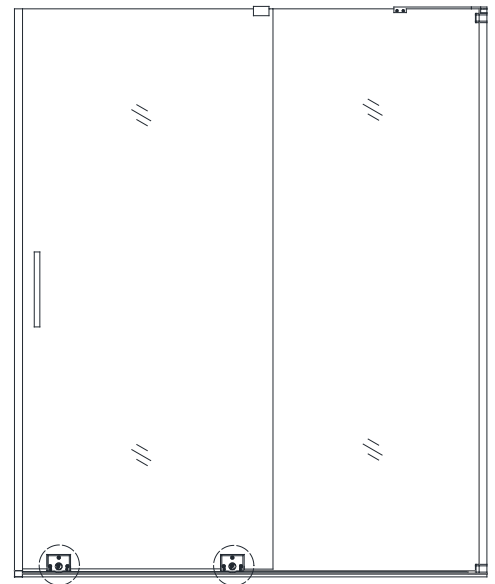

Right-hand door installation
as viewed from the inside

Fig 26a

1 loosen

2 rotate

3 tighten

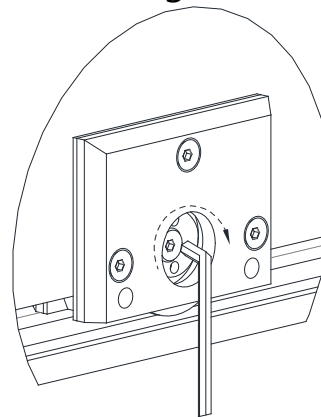
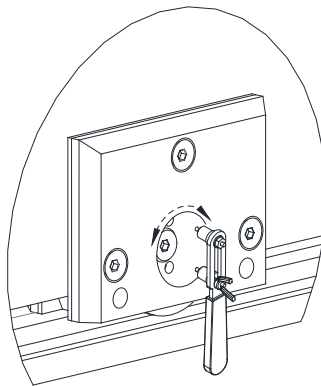
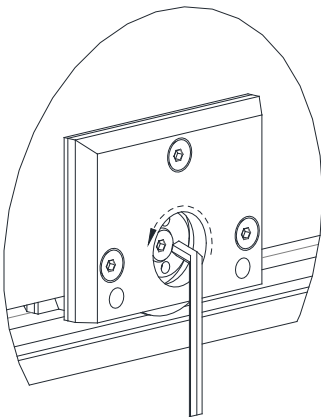

Amount of adjustment:

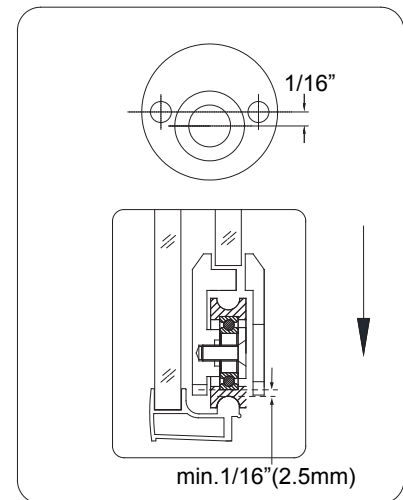
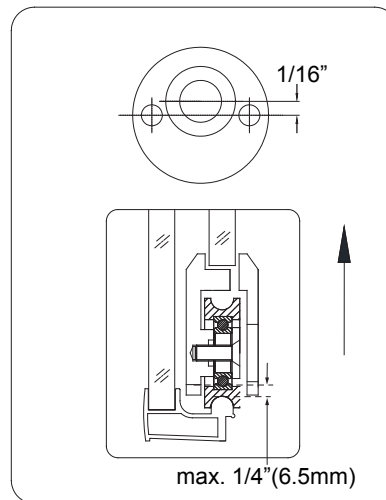
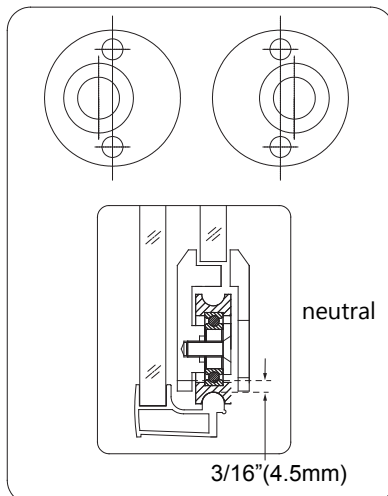

Fig 26b

27. Attach the roller **Cover Plate (#10.8)**, leaving approximately **1/16"** of **clearance** beneath the bottom rail. Re-adjust the plate if it makes contact with the bottom rail. **(Fig 27)**

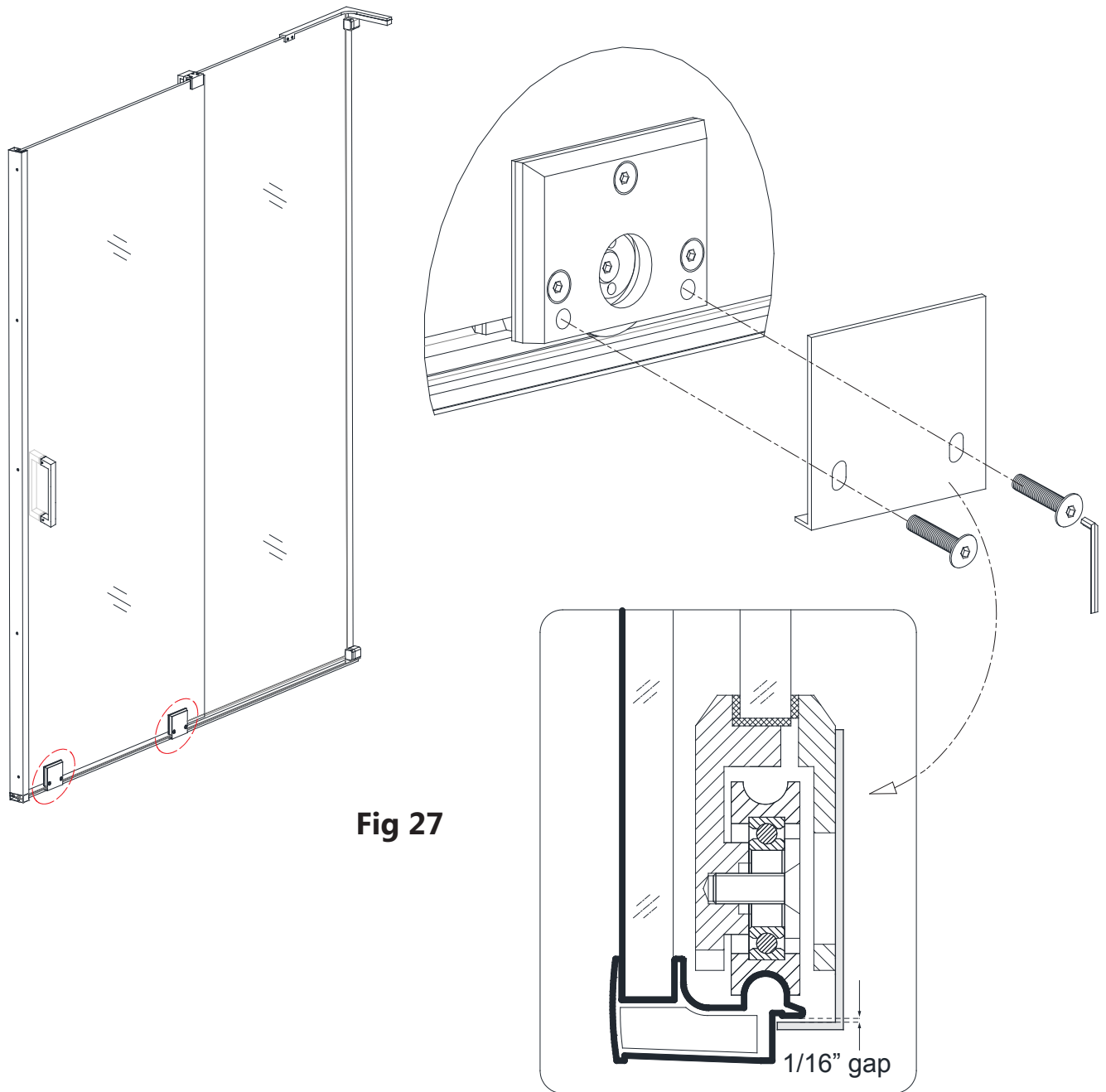

Fig 27

28. Remove the paper strip from the adhesive backing on the **Bottom Deflectors (#18)** and attach all three deflectors to the bottom edge of the **Door Glass (#02)** as shown. Based on the opening conditions, the **Bottom Deflector (#18)** on the closing side of the Door may need to be trimmed during installation to fit up to the **Wall Profile B (#22)**.

Attach the **Anti-Water Side Strip (#19)** to the edge of the **Door Glass (#02)**.

Notch the top to fit around the **L-Bar™** and notch the bottom to fit around the **Bottom Deflector (#18)**.
(Fig 28)

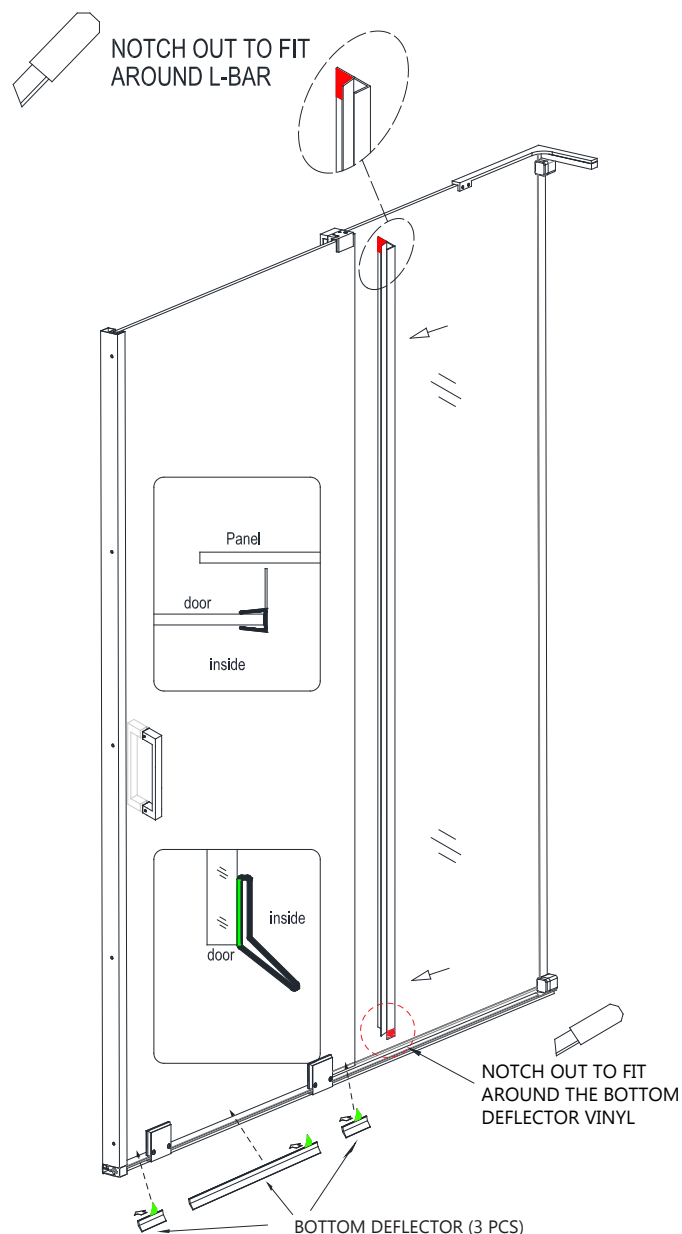

Fig 28

Right-hand door installation
as viewed from the inside



This deflector may need to be trimmed during installation to fit up to the **Wall Profile B** based on the opening conditions.

29. Apply a good quality, mildew-resistant silicone along both vertical channels and the bottom rail from inside the shower. **(Fig 29)**



Allow 24 hours for the silicone to cure before using the shower.

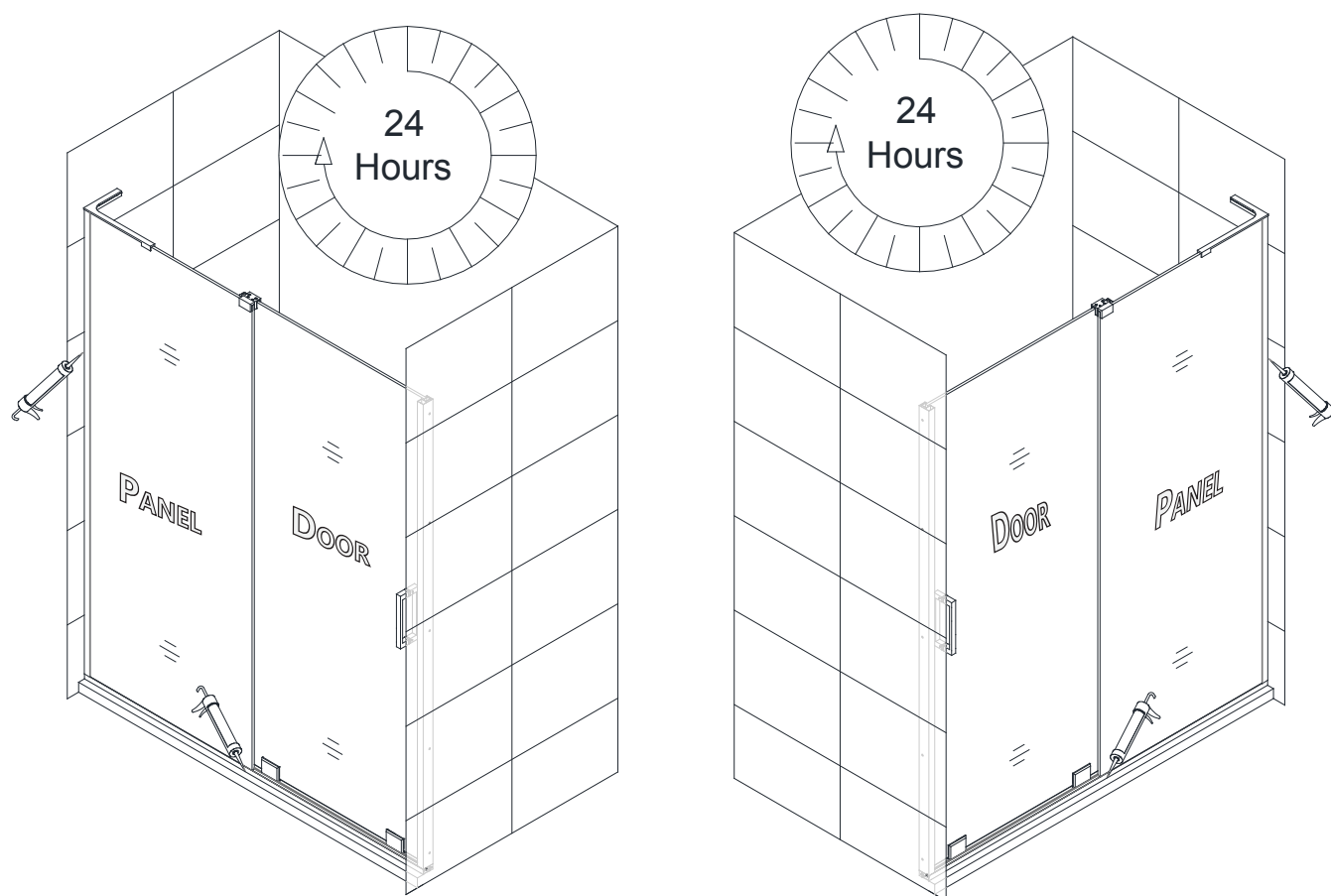

Fig 29

Product Maintenance

BASES and BACKWALLS: To ensure long-lasting life for your acrylic back walls, wipe them off after each use with a soft cloth. To clean the acrylic back walls use non-abrasive sprays or cream based cleaners. Avoid the use of aerosol spray cleaners. Never use abrasive cleansers, metal brushes or scrapers that could scratch or dull the surface.

GLASS: To ensure long-lasting life for your glass shower products, wipe them off after each use with a soft cloth. Rinse and wipe off the glass using either a soft cloth or a squeegee to prevent soap buildup and water spots (Hard water can etch the surface of the glass over time if left to dry). To prevent scratching the surface: never use abrasive cleaners or cleaning products that contain scouring agents. Never use bristle brushes or abrasive sponges that may scratch the surface.

HARDWARE: To ensure a long-lasting finish, wipe off the metal parts after each use with a soft cloth. Do not use abrasive cleaners or cleaning products containing ammonia, bleach or acid. If accidentally used, rinse the surface as soon as possible to prevent damage to the finish (peeling or corrosion). After cleaning the polished finishes, rinse thoroughly and wipe dry with a soft cloth.

Clean stainless steel surfaces at least once a week. When applying stainless steel cleaner or polish to stainless steel hardware, work with (not across) the grain. Never use an abrasive sponge or cloth, steel wool or wired brush as these may permanently scratch the surfaces.

NOTE: To maximize the life of your door, it is important to regularly inspect the glass and all hardware for misalignment, proper attachment, and/or damage. Contact DreamLine® with any questions or concerns.

DreamLine® shower doors and enclosures are designed not to leak when installed properly and the flow of water is not pointed directly at the vinyl seals.



TEL: 866-731-2244
FAX: 866-857-3638
DREAMLINE.COM

For more information on DreamLine® Shower Doors and Enclosures please visit **DreamLine.com**