

ASSEMBLY INSTRUCTIONS

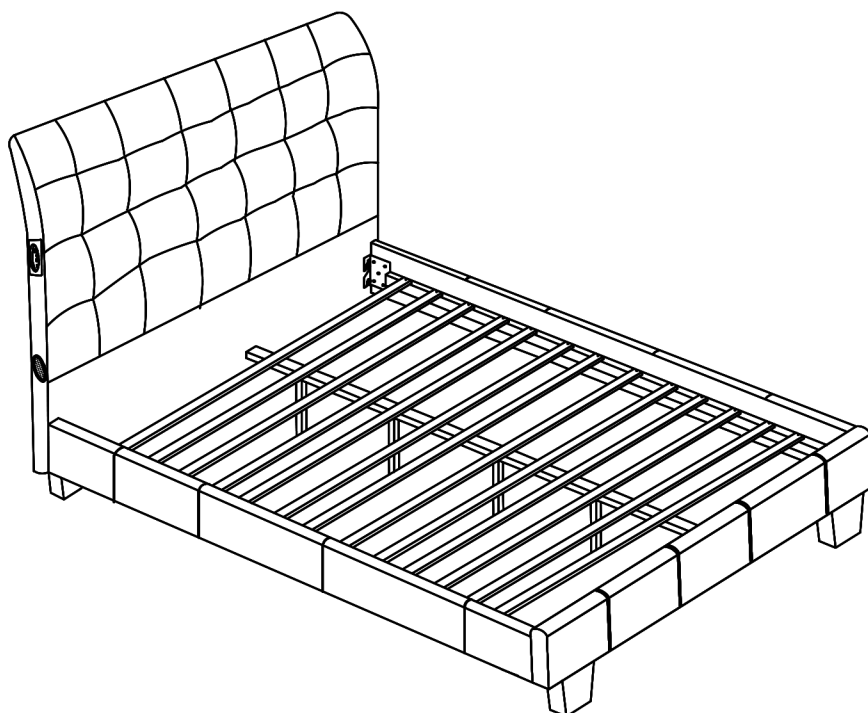

TOOLS REQUIRED



Allen Wrench

(Included)



**Phillips
Screwdriver**

(Not Included)



**2 - People
Recommended**

ASSEMBLY RATING



EASY ————— DIFFICULT

The Assembly Rating is a 5-point system showing the level of effort needed to assemble a specific product.



CHECK BEFORE STARTING

☐

Are you missing anything?

Double-check all parts, hardware and accessories listed on Page 6 are accounted for.

☐

Check out our Quick Tips!

We recommend reviewing the pre-assembly handouts. Even experts need a refresher now and then!

☐

Should we send any replacements?

Are there any irregularities or flaws in the parts? We can send replacements!

☐

Prep Time!

Please review the assembly instructions and all diagrams prior to assembling. Arrange parts as recommended on Page 7 and group identical hardware together to make assembling easier.

PRE ASSEMBLY INTRODUCTION

We understand building ready-to-assemble furniture can be a challenging experience for some. To help avoid confusion, we have provided some helpful tips that may speed up the process.

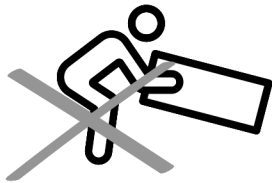

Teamwork

ALWAYS have at least two people to help with transporting and assembling the product to avoid potential injury and/or damage.

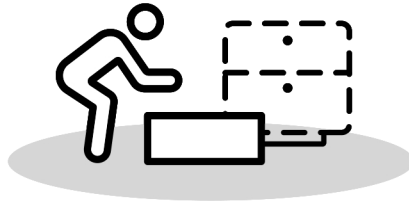
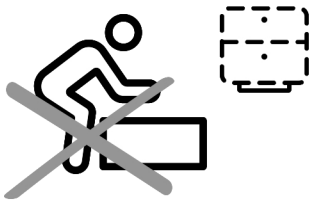

Suitable Location

Assembling near the area of the intended location is highly recommended.



Sufficient Space

Make sure you have enough space to move around during the assembly.

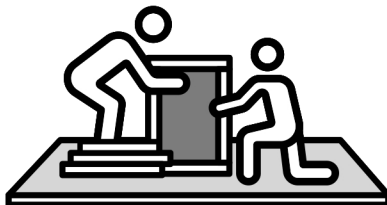

Avoid Scratches

Use cardboard, blankets or a carpeted area while assembling furniture to prevent scratches.

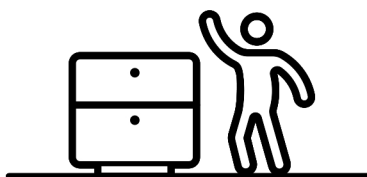
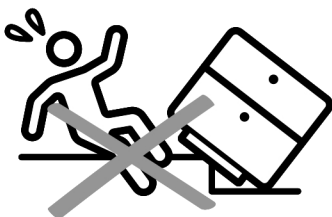

Flat Surface

Make sure the furniture rests on a flat and level surface with each leg evenly touching the floor.

ASSEMBLY AND CARE ADVICE



**FAILURE TO FOLLOW THE GUIDELINES BELOW MAY
RESULT IN INJURY AND/OR PROPERTY DAMAGE.**



Position each part correctly
and insert screws or bolts into
their respective holes.

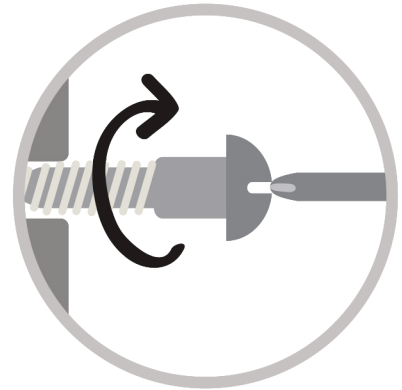

Turn clockwise to tighten and
only tighten when step is
completed or when instructed
to do so.



Save the instructions and store
any supplied tools for later
maintenance.

Use the appropriate hand tools
or power tools for assembly.
Select steps, such as tightening
screws and/or bolts, may require
hand tools to avoid causing
damage during assembly.

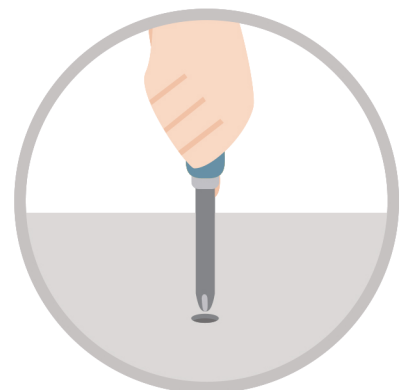

After two weeks, check and
tighten any loose hardware and
repeat again every six months
thereafter.

IT IS THE USER'S RESPONSIBILITY TO MAINTAIN THE FURNITURE. THE HARDWARE MAY LOOSEN OVER TIME AND MAY CAUSE THE FURNITURE TO BE WOBBLY AND UNABLE TO SUPPORT ITS INTENDED WEIGHT CAPACITY. THIS MAY LEAD TO COLLAPSE AND MAY CAUSE SERIOUS INJURY.

BED



- Please keep instructions for future reference.
- Check the quantity and irregularity of parts and hardware before you start.

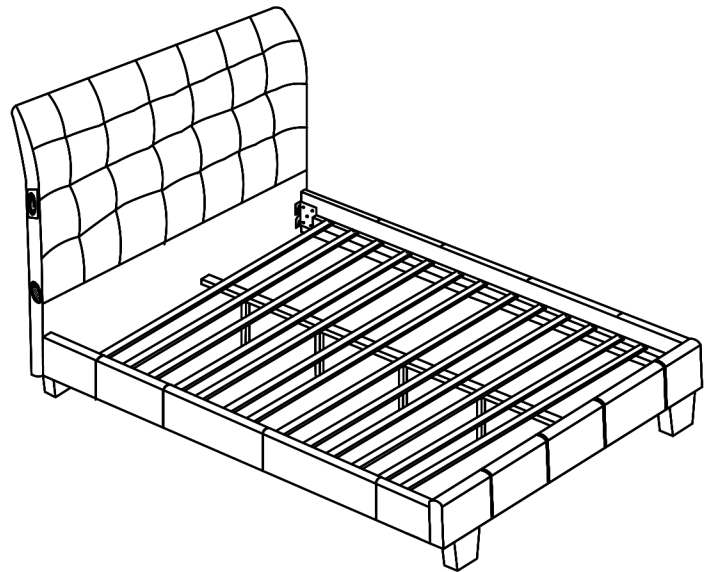

PARTS

#1 1pc

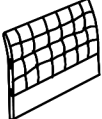

HeadBoard

#2 2pcs



Side Rail

#3 1pc

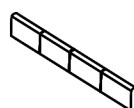

FootBoard

#4 1pc



Support Rail

#5 4pcs



HB/FB Leg

#6 1set



Slat (13pcs)

#7 4pcs Ø5/16"



Support Leg 240x30x30mm

HARDWARE

#A 8pcs



Bolt
Ø5/16" x 1-1/2"

#B 8pcs

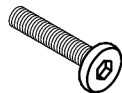

Bolt
Ø5/16" x 3"

#C 16pcs



Lock Washer
Ø5/16"

#D 16pcs



Flat Washer
Ø5/16"x19mm

#E 26pcs



Screw
#8x38mm

#F 1pc



Allen Wrench 5mm

#G 1pc



Cable A

#H 1pc



Cable B

#I 1pc



Power line

Exploded View

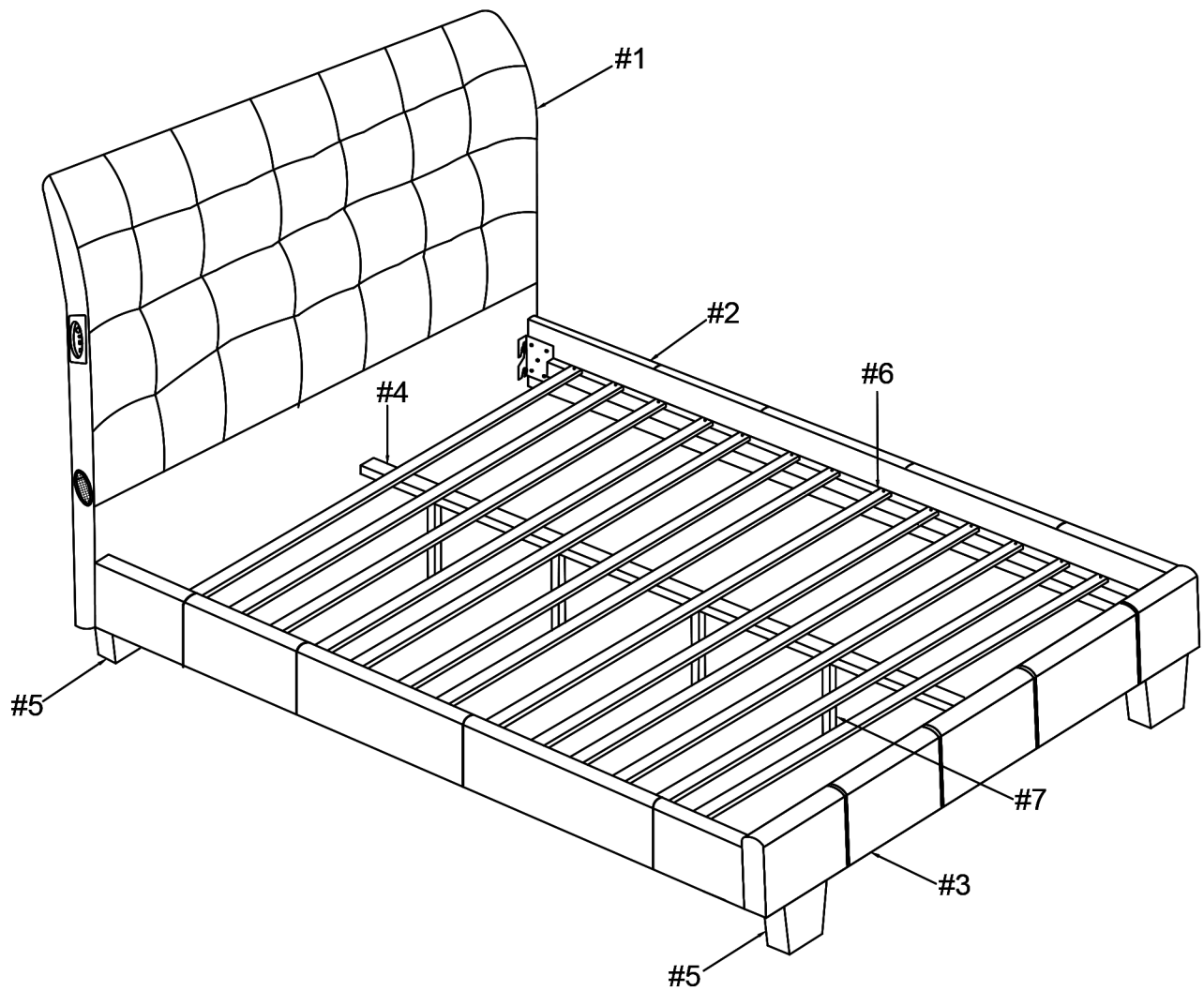

ASSEMBLY INSTRUCTIONS

1

Part #1 x1pc
Part #5 x2pcs
Hardware #B x4pcs
Hardware #C x4pcs
Hardware #D x4pcs

Align legs (#5) to headboard (#1), then secure by using bolts (#B) with washers (#C,D).

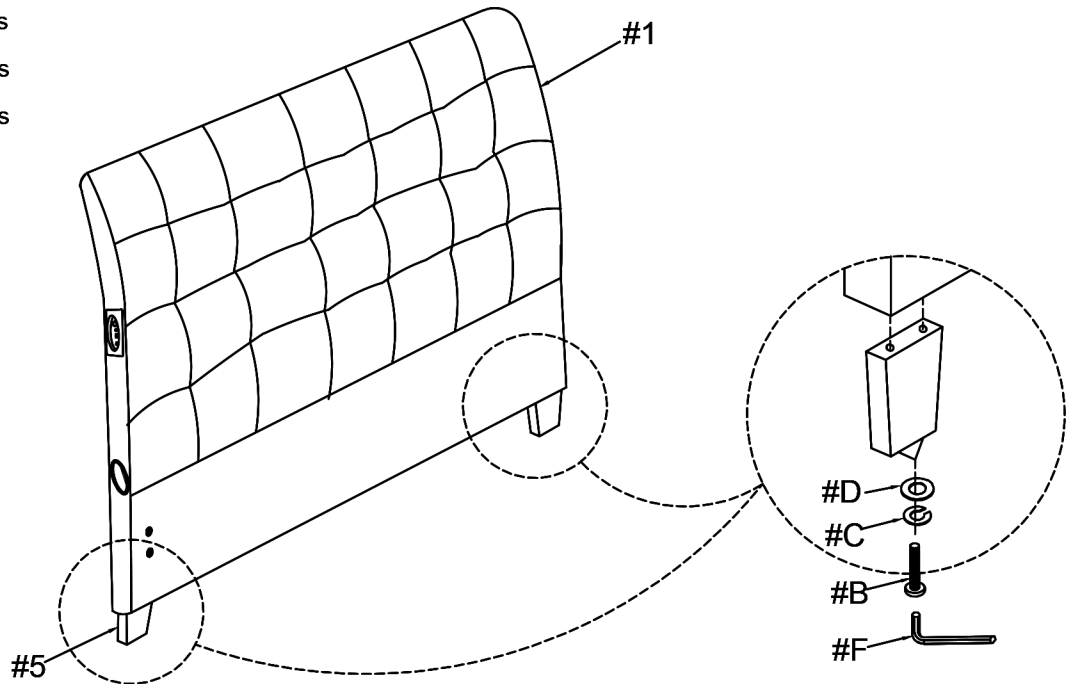

2

Part #3 x1pc
Part #5 x2pcs
Hardware #B x4pcs
Hardware #C x4pcs
Hardware #D x4pcs

Align legs (#5) to footboard (#3), then secure by using bolts (#B) with washers (#C,D).

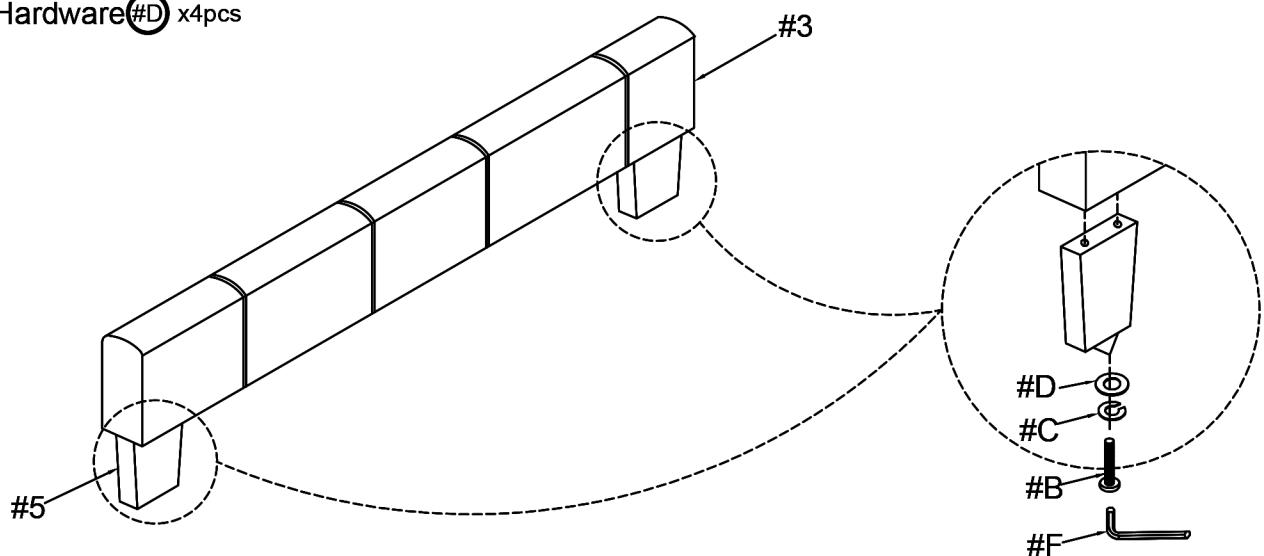

ASSEMBLY INSTRUCTIONS

3

Align side rails (#2) to the headboard (#1) and footboard (#3), then secure by using bolts (#A) with washers (#C,D).

Part #2 x2pcs

Hardware #A x8pcs

Hardware #C x8pcs

Hardware #D x8pcs

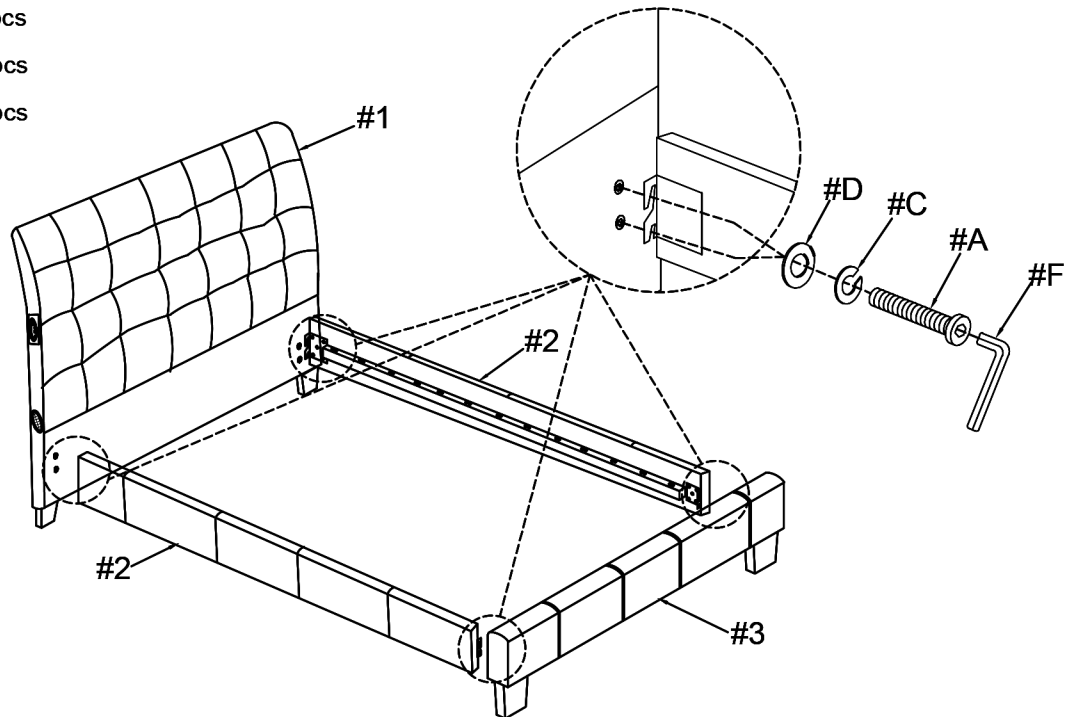

4

Part #4 x1pc

Part #6 x1set

Part #7 x4pcs

Align center support slat (#4) to the slat kit (#6), then secure by using support legs (#7). Adjust the levelers on the support legs (#7) according to the ground level.

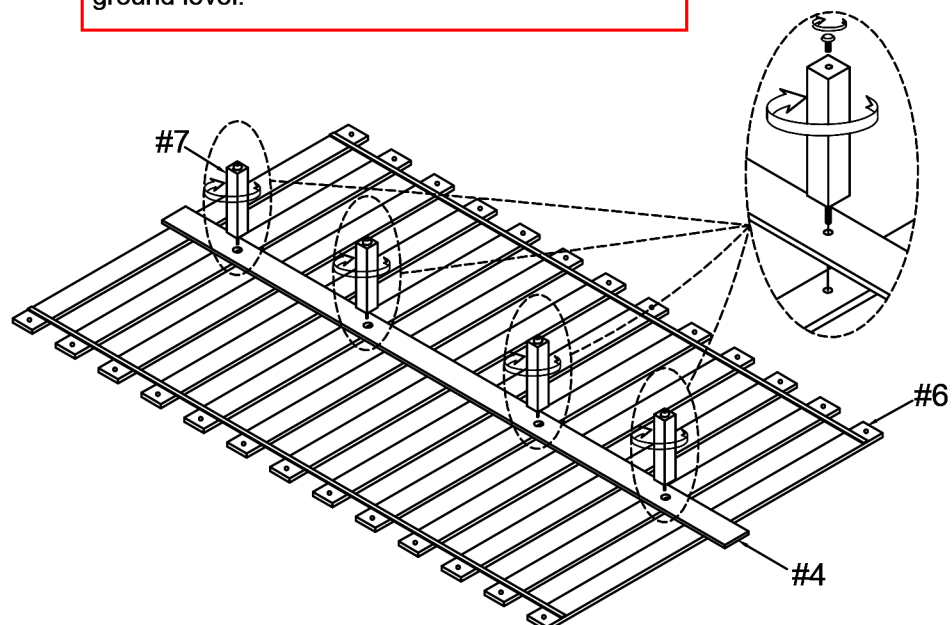

ASSEMBLY INSTRUCTIONS

5

Align slats to the side rails, then secure by using screws (#E).

Hardware **#E** x26pcs

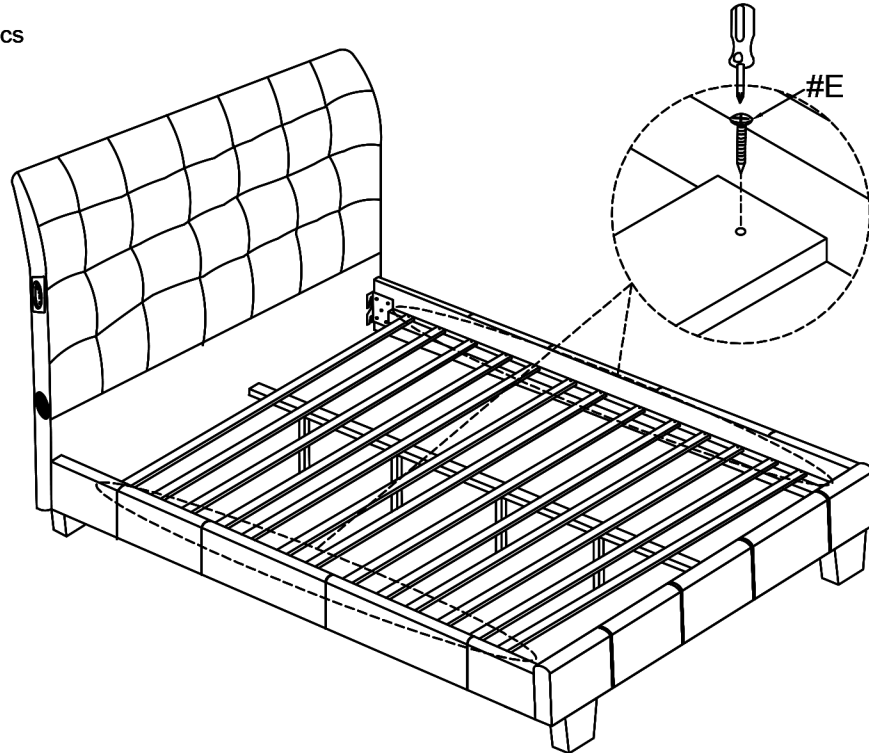

6

Hardware **#G** x1pc

Hardware **#H** x1pc

Hardware **#I** x1pc

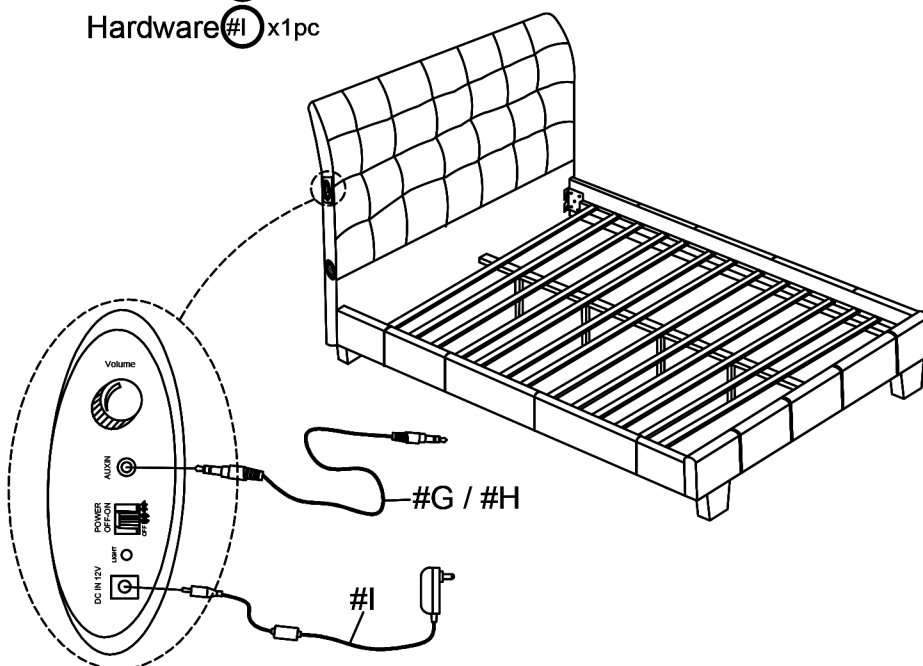

ASSEMBLY COMPLETED



Please ensure the furniture rests on an even and flat surface. If the product wobbles or feels loose, double-check all bolts and/or screws are properly tightened and secured.



Keep this handy!

Please retain this instruction manual and any order-related information for future reference.



Lift, don't drag!

To avoid damage to product please always LIFT the product when transporting or adjusting the placement.