

ASSEMBLY INSTRUCTIONS

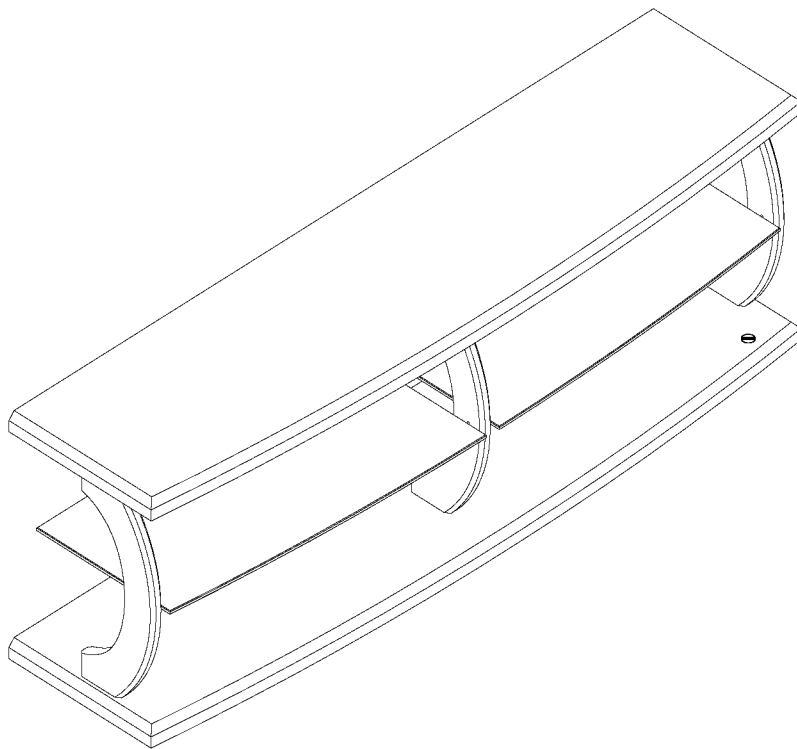

TOOLS REQUIRED



Allen Wrench
(Included)

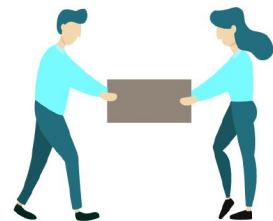

**2 - Persons
Recommended**

ASSEMBLY RATING



EASY —————> DIFFICULT

The Assembly Rating is a 5-point system showing the level of effort needed to assemble a specific product.



CHECK BEFORE STARTING



Are you missing anything?

Double-check all parts, hardware and accessories listed on Page 6 are accounted for.



Check out our Quick Tips!

We recommend reviewing the pre-assembly handouts. Even experts need a refresher now and then!



Should we send any replacements?

Are there any irregularities or flaws in the parts? We can send replacements!



Prep Time!

Please review the assembly instructions and all diagrams prior to assembling. Set up your workspace by laying the parts and hardware out separately, then begin!

PRE ASSEMBLY INTRODUCTION

We understand building ready-to-assemble furniture can be a challenging experience for some. To help avoid confusion, we have provided some helpful tips that may speed up the process.



Teamwork

ALWAYS have at least two people to help with transporting and assembling the product to avoid potential injury and/or damage.

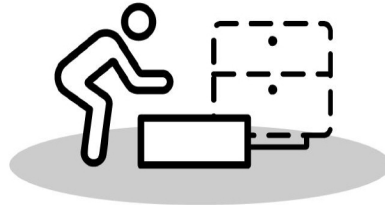
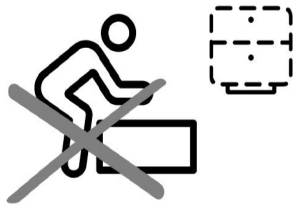

Suitable Location

Assembling near the area of the intended location is highly recommended.



Sufficient Space

Make sure you have enough space to move around during the assembly.



Avoid Scratches

Use cardboard, blankets or a carpeted area while assembling furniture to prevent scratches.

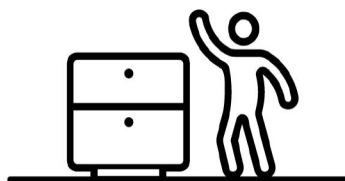
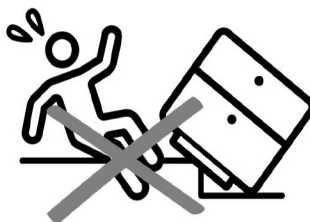

Flat Surface

Make sure the furniture rests on a flat and level surface with each leg evenly touching the floor.

ASSEMBLY AND CARE ADVICE



**FAILURE TO FOLLOW THE GUIDELINES BELOW MAY
RESULT IN INJURY AND/OR PROPERTY DAMAGE.**



Position each part correctly
and insert screws or bolts into
their respective holes.

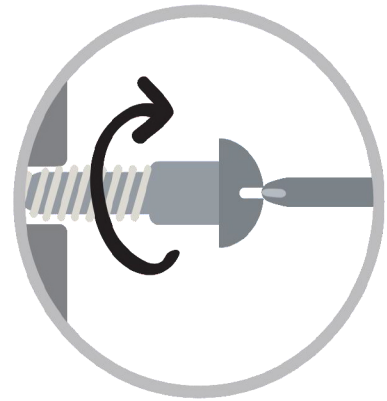

Turn clockwise to tighten and
only tighten when step is
completed or when instructed
to do so.



Use the appropriate hand tools
or power tools for assembly.
Select steps, such as tightening
screws and/or bolts, may require
hand tools to avoid causing
damage during assembly.



Save the instructions and store
any supplied tools for later
maintenance.

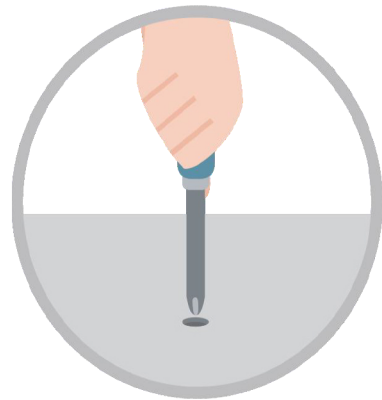

After two weeks, check and
tighten any loose hardware and
repeat again every six months
thereafter.

IT IS THE USER'S RESPONSIBILITY TO MAINTAIN THE FURNITURE. THE HARDWARE MAY LOOSEN OVER TIME AND MAY CAUSE THE FURNITURE TO BE WOBBLY AND UNABLE TO SUPPORT ITS INTENDED WEIGHT CAPACITY. THIS MAY LEAD TO COLLAPSE AND MAY CAUSE SERIOUS INJURY.

TV STAND



- Please keep instructions for future reference.
- Check the quantity and irregularity of parts and hardware before you start.

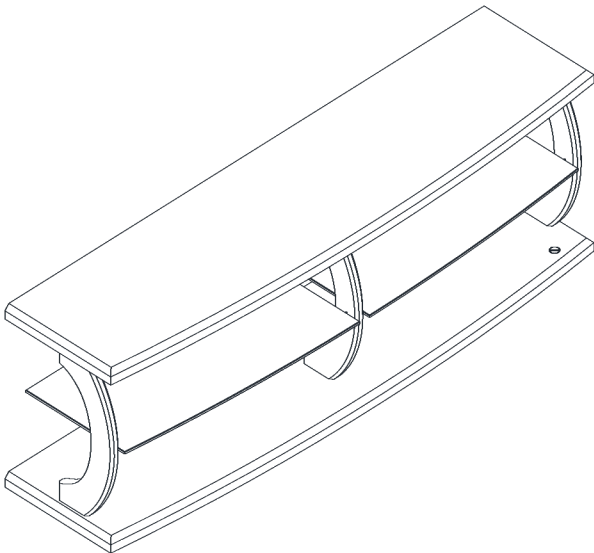

PARTS

#1 1pc

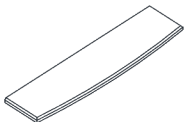

Top Panel

#2 2pcs



Side Leg (L & R)

#3 1pc



Center Leg

#4 2pcs



Back Panel

#5 2pcs

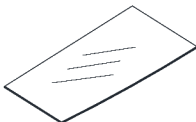

Glass Shelf

#6 1pc

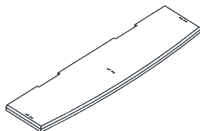

Bottom Panel

#7 1pc

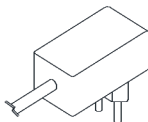

Adapter

HARDWARE

#A 14pcs

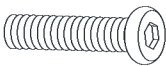

Bolt ø 1/4" x 1-3/4"

#B 18pcs



Bolt ø 1/4" x 3/4"

#C 14pcs



Lock Washer ø 1/4"

#D 14pcs

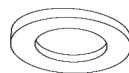

Flat Washer ø 1/4"

#E 1pc



Allen Wrench

#F 3pcs

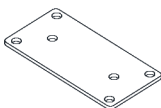

Bracket

#G 8pcs

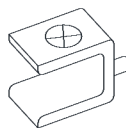

Glass Shelf Support

ASSEMBLY INSTRUCTIONS

1

- Part #2 x2pcs
- Part #3 x1pc
- Hardware #B x6pcs
- Hardware #F x3pcs

Align bracket (#F) to the holes of the side and center legs (#2,3). Secure by using bolts (#B).

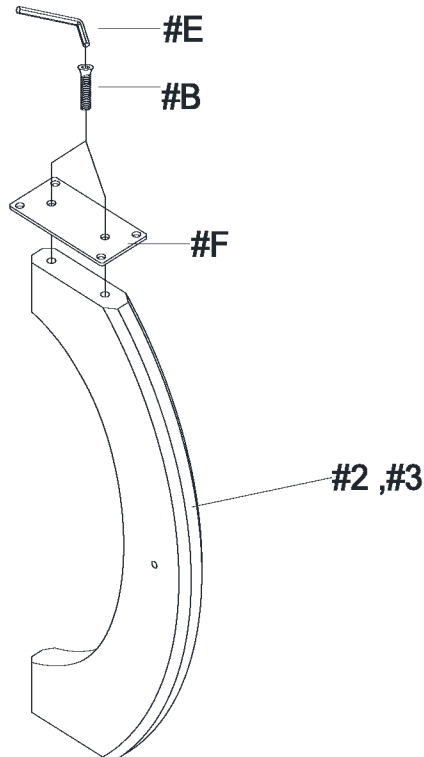

2

- Part #1 x1pc
- Part #2 x2pcs
- Part #3 x1pc
- Part #4 x2pcs
- Hardware #A x4pcs
- Hardware #B x12pcs
- Hardware #C x4pcs
- Hardware #D x4pcs

2) Align side legs (#2) and center legs (#3) to the holes of the top panel (#1), then secure by using bolts (#B).

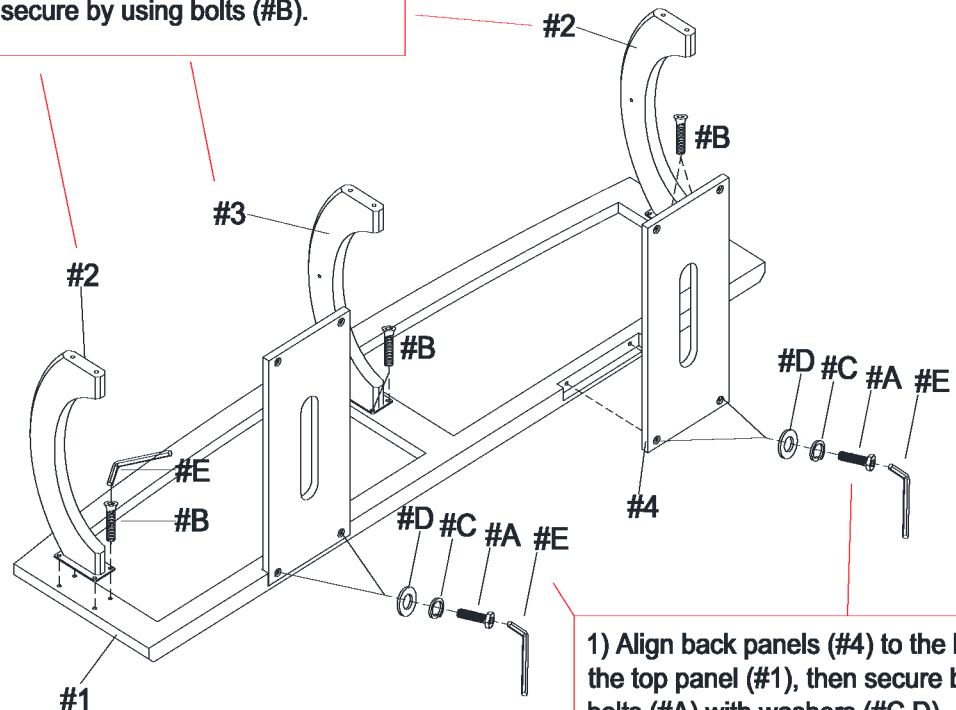

1) Align back panels (#4) to the holes of the top panel (#1), then secure by using bolts (#A) with washers (#C,D).

ASSEMBLY INSTRUCTIONS

3

2) Secure side/center legs (#2,3) to the holes of the bottom panel (#6), then secure by using bolts (#A) with washers (#C,D).

Part #6 x1pc
Hardware #A x10pcs
Hardware #C x10pcs
Hardware #D x10pcs

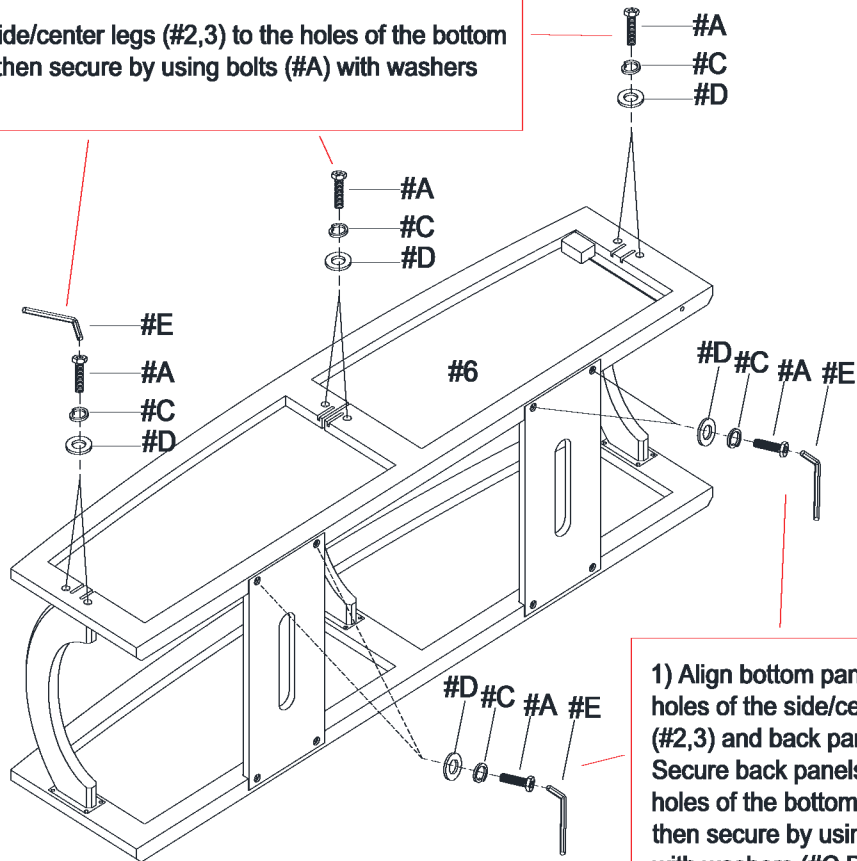

1) Align bottom panel (#6) to the holes of the side/center legs (#2,3) and back panels (#4). Secure back panels (#4) to the holes of the bottom panel (#6), then secure by using bolts (#A) with washers (#C,D).

4

Insert glass shelf supports (#G) to the holes of the side/center legs (#2,3) and back panels (#4), then insert glass shelves (#5) through the shelf supports (#G).

Part #5 x2pcs
Hardware #G x8pcs

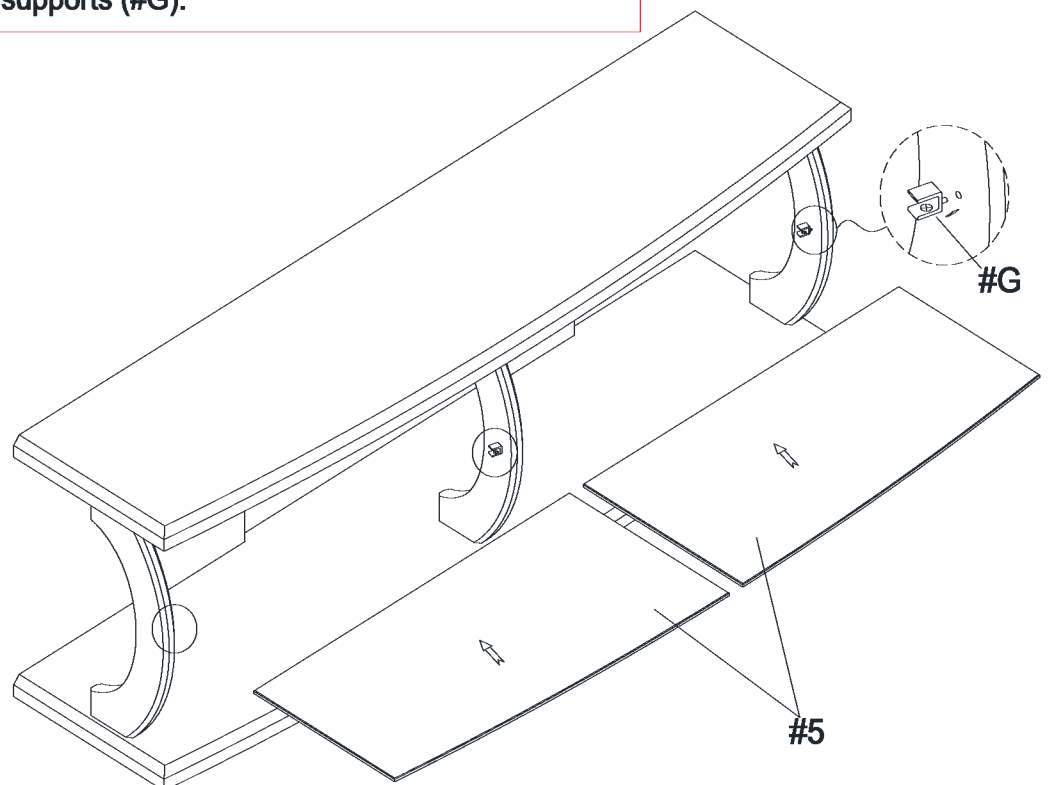

ASSEMBLY INSTRUCTIONS

5

Part #7 x1pc

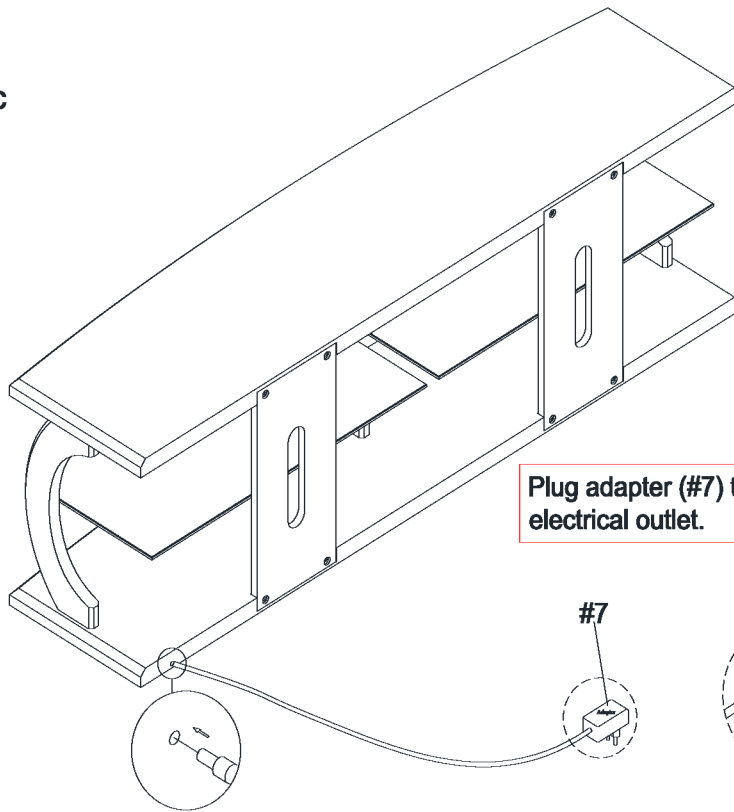

Plug adapter (#7) to the TV-stand and electrical outlet.

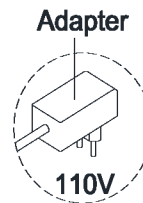

6

Screw the shelf supports (#G) to tighten and secure the glass shelves.

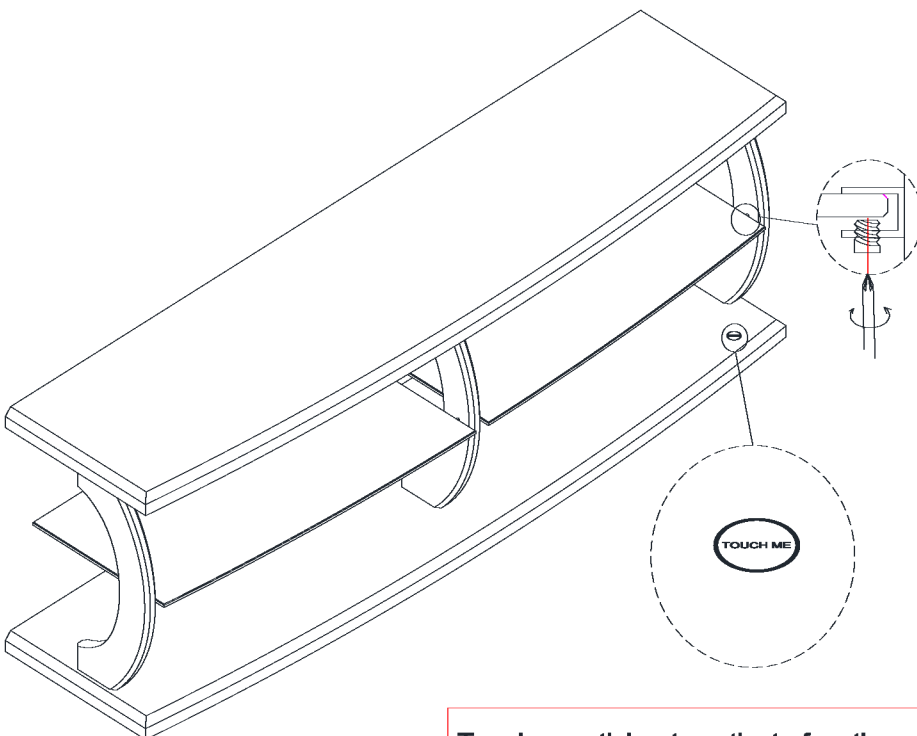

Touch me sticker to activate functions.

ASSEMBLY COMPLETED



Please ensure the furniture rests on an even and flat surface. If the product wobbles or feels loose, double-check all bolts and/or screws are properly tightened and secured.



Keep this handy!

Please retain this instruction manual and any order-related information for future reference.