

ASSEMBLY INSTRUCTIONS

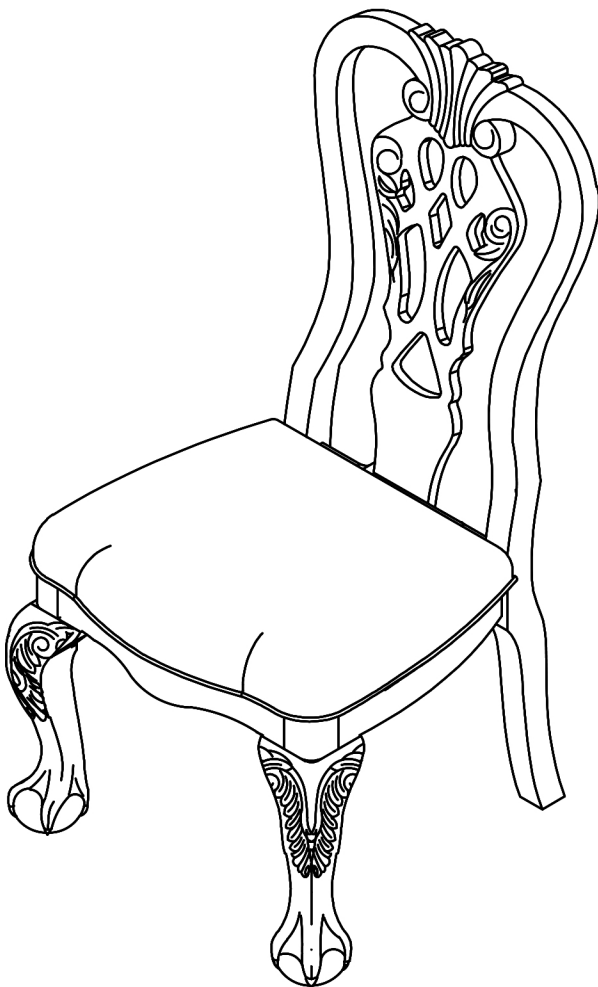

TOOLS REQUIRED



Allen Wrench

(Included)



2 - People
Recommended

ASSEMBLY RATING

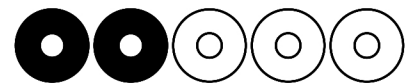

EASY —————> DIFFICULT

The Assembly Rating is a 5-point system showing the level of effort needed to assemble a specific product.



CHECK BEFORE STARTING

☐

Are you missing anything?

Double-check all parts, hardware and accessories listed on Page 6 are accounted for.

☐

Check out our Quick Tips!

We recommend reviewing the pre-assembly handouts. Even experts need a refresher now and then!

☐

Should we send any replacements?

Are there any irregularities or flaws in the parts? We can send replacements!

☐

Prep Time!

Please review the assembly instructions and all diagrams prior to assembling. Arrange parts as recommended on Page 7 and group identical hardware together to make assembling easier.

PRE ASSEMBLY INTRODUCTION

We understand building ready-to-assemble furniture can be a challenging experience for some. To help avoid confusion, we have provided some helpful tips that may speed up the process.

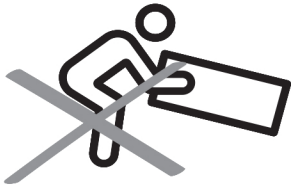

Teamwork

ALWAYS have at least two people to help with transporting and assembling the product to avoid potential injury and/or damage.

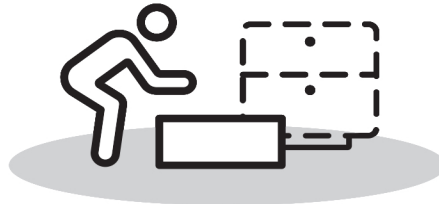
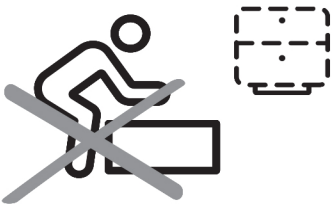

Suitable Location

Assembling near the area of the intended location is highly recommended.



Sufficient Space

Make sure you have enough space to move around during the assembly.



Avoid Scratches

Use cardboard, blankets or a carpeted area while assembling furniture to prevent scratches.

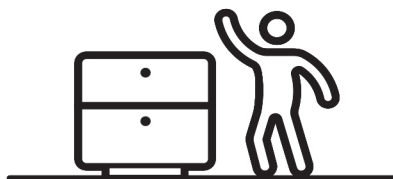
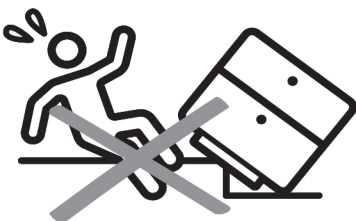

Flat Surface

Make sure the furniture rests on a flat and level surface with each leg evenly touching the floor.

ASSEMBLY AND CARE ADVICE



**FAILURE TO FOLLOW THE GUIDELINES BELOW MAY
RESULT IN INJURY AND/OR PROPERTY DAMAGE.**



Position each part correctly
and insert screws or bolts into
their respective holes.



Use the appropriate hand tools
or power tools for assembly.
Select steps, such as tightening
screws and/or bolts, may require
hand tools to avoid causing
damage during assembly.



Save the instructions and store
any supplied tools for later
maintenance.

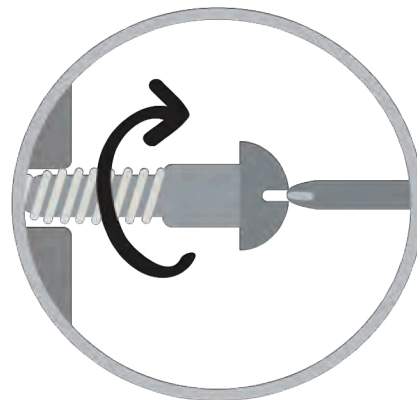

Turn clockwise to tighten and
only tighten when step is
completed or when instructed
to do so.

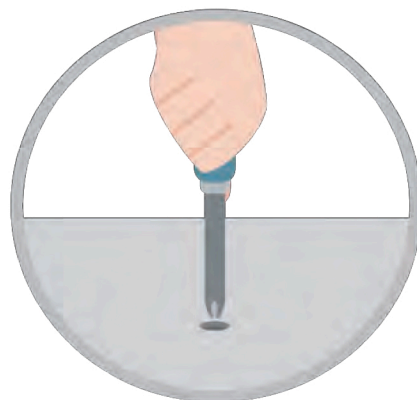

After two weeks, check and
tighten any loose hardware and
repeat again every six months
thereafter.

**IT IS THE USER'S RESPONSIBILITY TO MAINTAIN THE FURNITURE. THE HARDWARE MAY LOOSEN
OVER TIME AND MAY CAUSE THE FURNITURE TO BE WOBBLY AND UNABLE TO SUPPORT ITS
INTENDED WEIGHT CAPACITY. THIS MAY LEAD TO COLLAPSE AND MAY CAUSE SERIOUS INJURY.**

CHAIR



- Please keep instructions for future reference.
- Check the quantity and irregularity of parts and hardware before you start.

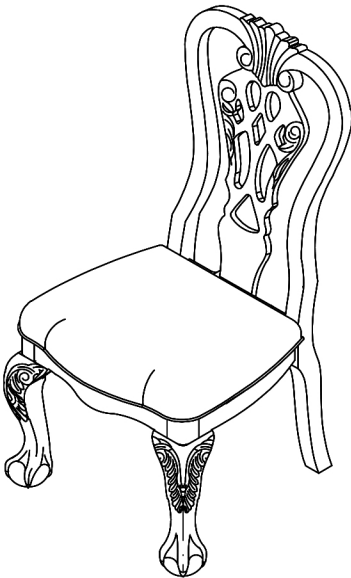

PARTS

#1 1pc x2



Chair Back

#2 1pc x2



Cushion Seat

#3 2pcs x2



Front Leg

HARDWARE

#A 1pc x2



#B 4pcs x2



#C 4pcs x2



#D 9pcs x2



Look Washer

#E 9pcs x2



#F 1pc x2

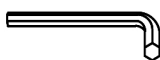

Allen Wrench M4

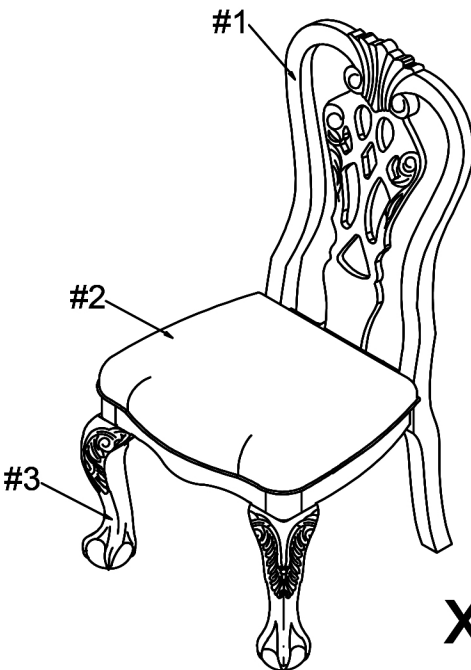

ASSEMBLY INSTRUCTIONS

1

Part #1 x1pc

Part #2 x1pc

Hardware #A x1pc

Hardware #D x1pc

Hardware #E x1pc

1. Place the backrest w/legs (#1) onto a protected surface.

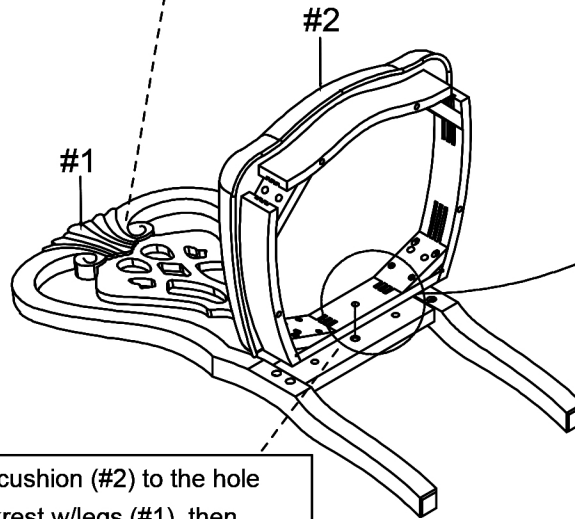

3. Align the seat cushion (#2) to the hole along the backrest w/legs (#1), then insert the bolt assembly into the center hole and secure using the Allen wrench.

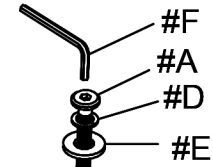

x2

2. Prepare a bolt assembly by inserting a lock washer (#D) onto the bolt (#A) then a flat washer (#E) onto that same bolt (#A).

2

Hardware #C x4pcs

Hardware #D x4pcs

Hardware #E x4pcs

Prepare 4 bolt assemblies by inserting a lock washer (#D) onto the bolt (#C) then a flat washer (#E) onto that same bolt (#C).

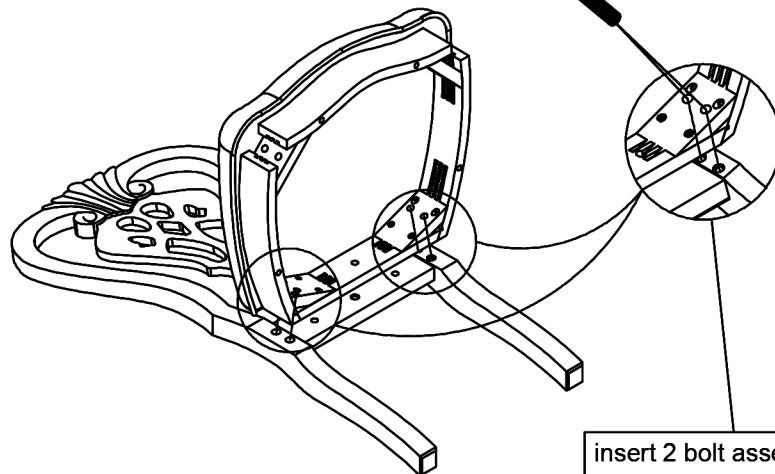

x2

insert 2 bolt assemblies into each back corner of the seat (#2) secure using the Allen wrench

ASSEMBLY INSTRUCTIONS

3

Part #3 x2pcs

Hardware #B x4pcs

Hardware #E x4pcs

Hardware #D x4pcs

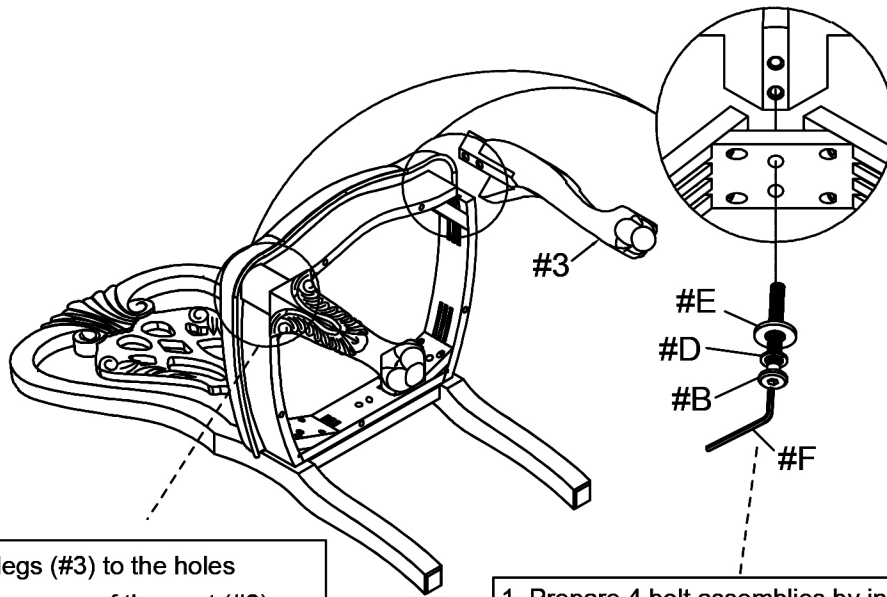

2. Align the front legs (#3) to the holes along the front corners of the seat (#2), then insert 2 bolt assemblies into each corner and secure using the Allen wrench.

1. Prepare 4 bolt assemblies by inserting a lock washer (#D) onto the bolt (#B) then a flat washer (#E) onto that same bolt (#B).

4

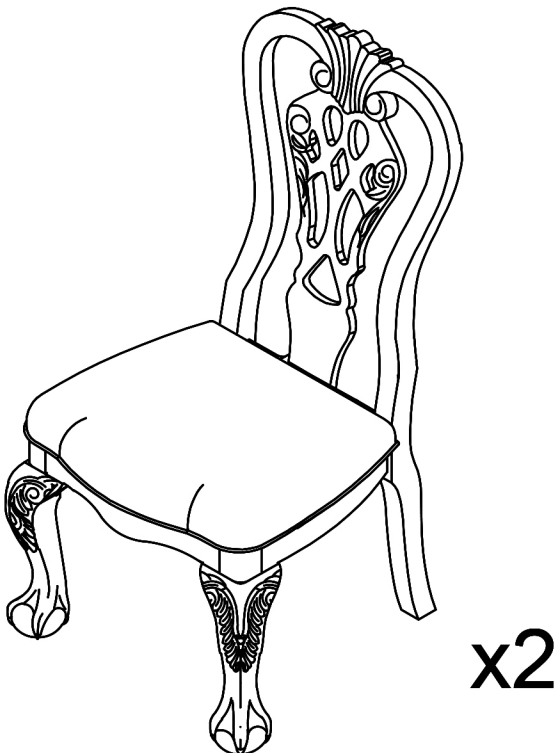

ASSEMBLY COMPLETED



Please ensure the furniture rests on an even and flat surface. If the product wobbles or feels loose, double-check all bolts and/or screws are properly tightened and secured.



Keep this handy!

Please retain this instruction manual and any order-related information for future reference.



Lift, don't drag!

To avoid damage to product please always LIFT the product when transporting or adjusting the placement.