

ASSEMBLY INSTRUCTIONS

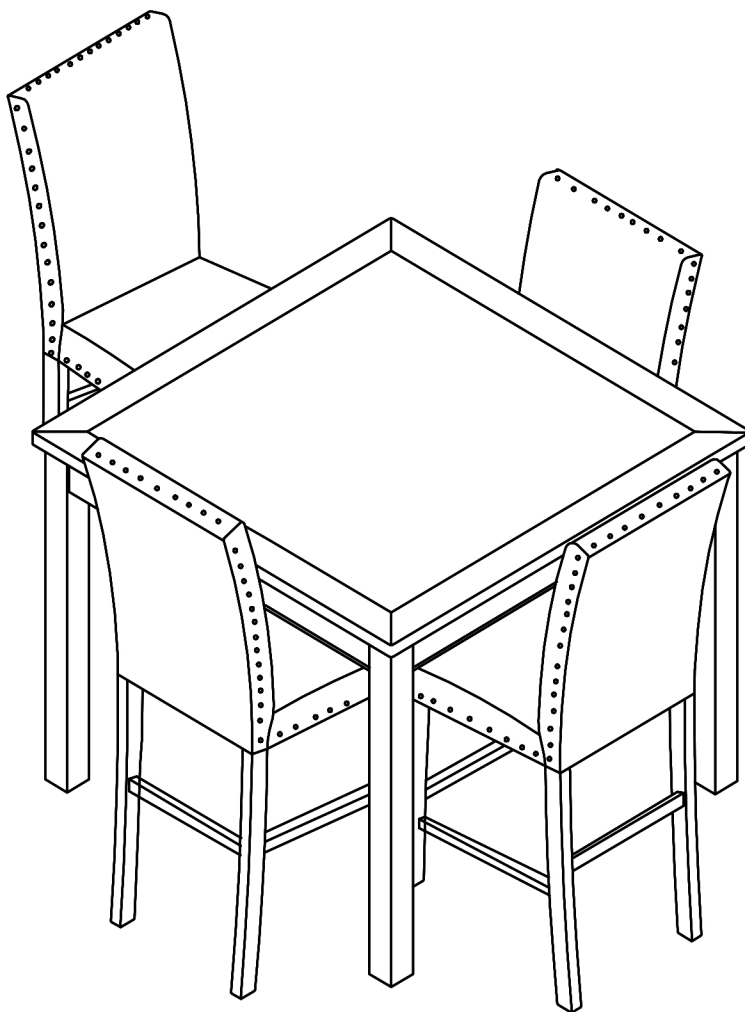

TOOLS REQUIRED



Allen Wrench

(Included)



2 - People
Recommended

ASSEMBLY RATING



EASY —————> DIFFICULT

The Assembly Rating is a 5-point system showing the level of effort needed to assemble a specific product.



CHECK BEFORE STARTING



Are you missing anything?

Double-check all parts, hardware and accessories listed on Page 6 are accounted for.



Should we send any replacements?

Are there any irregularities or flaws in the parts? We can send replacements!



Check out our Quick Tips!

We recommend reviewing the pre-assembly handouts. Even experts need a refresher now and then!



Prep Time!

Please review the assembly instructions and all diagrams prior to assembling. Arrange parts as recommended on Page 7 and group identical hardware together to make assembling easier.

PRE ASSEMBLY INTRODUCTION

We understand building ready-to-assemble furniture can be a challenging experience for some. To help avoid confusion, we have provided some helpful tips that may speed up the process.

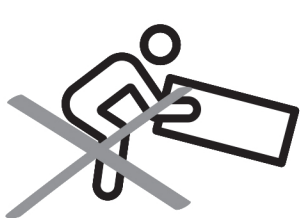

Teamwork

ALWAYS have at least two people to help with transporting and assembling the product to avoid potential injury and/or damage.



Suitable Location

Assembling near the area of the intended location is highly recommended.



Sufficient Space

Make sure you have enough space to move around during the assembly.



Avoid Scratches

Use cardboard, blankets or a carpeted area while assembling furniture to prevent scratches.

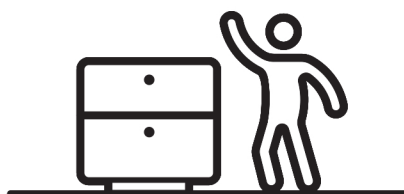

Flat Surface

Make sure the furniture rests on a flat and level surface with each leg evenly touching the floor.

ASSEMBLY AND CARE ADVICE



**FAILURE TO FOLLOW THE GUIDELINES BELOW MAY
RESULT IN INJURY AND/OR PROPERTY DAMAGE.**



Position each part correctly
and insert screws or bolts into
their respective holes.

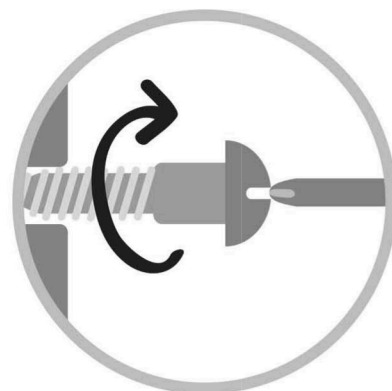

Turn clockwise to tighten and
only tighten when step is
completed or when instructed
to do so.



Use the appropriate hand tools
or power tools for assembly.
Select steps, such as tightening
screws and/or bolts, may require
hand tools to avoid causing
damage during assembly.



Save the instructions and store
any supplied tools for later
maintenance.

After two weeks, check and
tighten any loose hardware and
repeat again every six months
thereafter.

IT IS THE USER'S RESPONSIBILITY TO MAINTAIN THE FURNITURE. THE HARDWARE MAY LOOSEN OVER TIME AND MAY CAUSE THE FURNITURE TO BE WOBBLY AND UNABLE TO SUPPORT ITS INTENDED WEIGHT CAPACITY. THIS MAY LEAD TO COLLAPSE AND MAY CAUSE SERIOUS INJURY.

TABLE



- Please keep instructions for future reference.
- Check the quantity and irregularity of parts and hardware before you start.

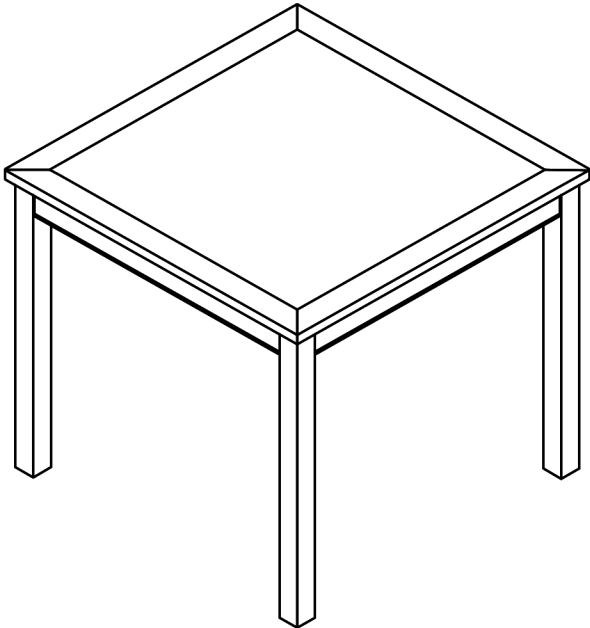

PARTS

#1 1pc

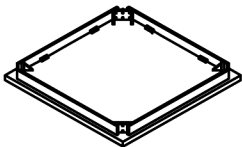

Table Top

#2 4pcs



Table Leg

HARDWARE

#A 1pc

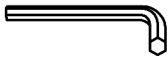

Allen Wrench M5

#B 8pcs



Bolt Ø5/16" x 2"

#C 8pcs



Lock Washer

#D 8pcs



Flat Washer

ASSEMBLY INSTRUCTIONS

1

Part #1 x1pc

Part #2 x4pcs

Hardware #B x8pcs

Hardware #C x8pcs

Hardware #D x8pcs

Prepare 8 bolts assembly by inserting lock washer (#C), then flat washer (#D) onto bolts (#B). Align legs (#2) to the holes of the table top (#1). Secure by using bolts (#B).

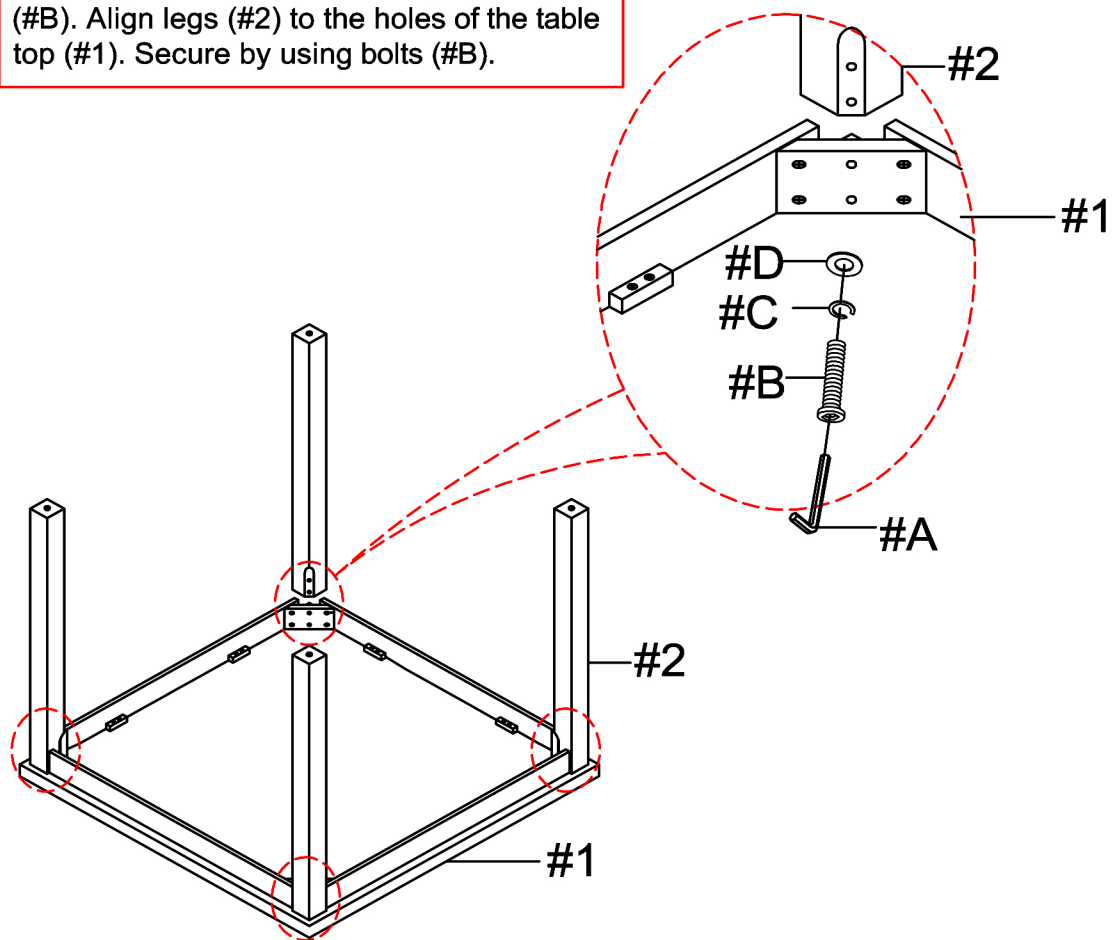

2

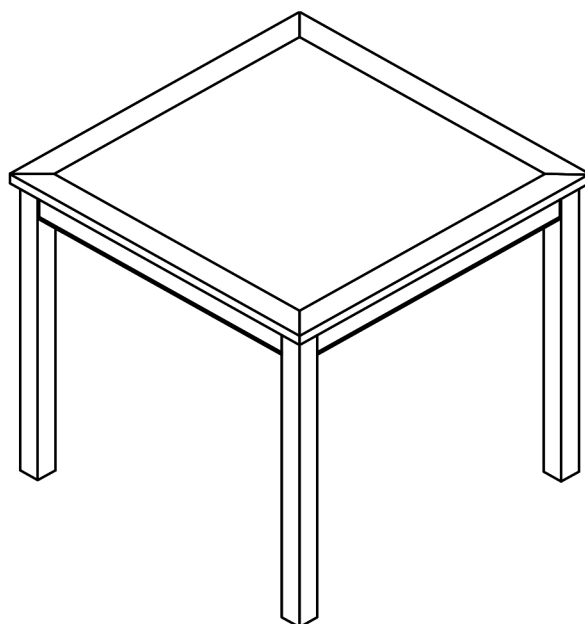

CHAIR

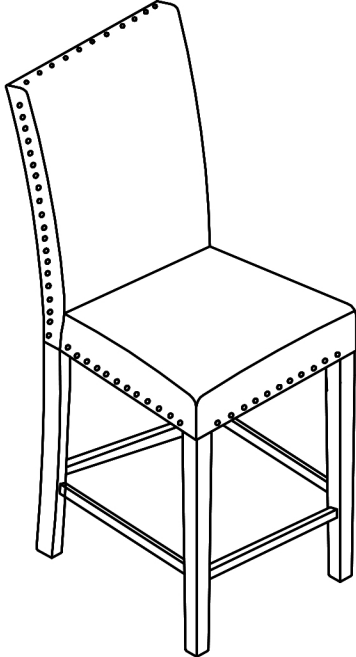
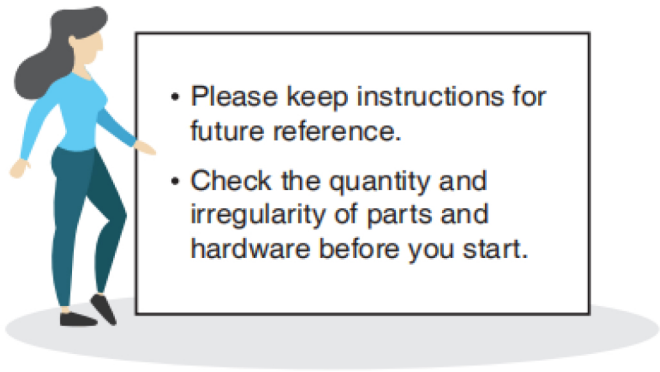

PARTS

#1 1pc x 4

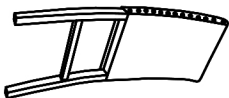

Backrest w/Legs

#2 4pcs x 4

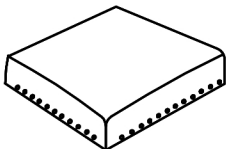

Seat Cushion

#3 2pcs x 4



Front Leg (L & R)

#4 1pc x 4

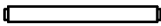

Front Stretcher

#5 2pcs x 4

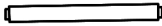

Side Stretcher (L & R)

HARDWARE

#A 1pc x 4

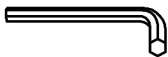

Allen Wrench M5

#B 4pcs x 4



Bolt Ø5/16" x 3-1/2"

#C 4pcs x 4



Bolt 5/16" x 2-1/2"

#D 2pcs x 4



Bolt Ø5/16" x 2"

#E 10pcs x 4



Lock Washer

#F 10pcs x 4



Flat Washer

#G 6pcs x 4



Screw M8*1-1/4"

ASSEMBLY INSTRUCTIONS

Prepare 2 bolts assembly by inserting lock washer (#E), then flat washer (#F) onto bolts (#D). Align seat (#2) to the holes of the chair back (#1). Secure middle two holes by using bolts (#D).

1

- Part (#1) x 1pc
- Part (#2) x 1pc
- Hardware (#D) x 2pcs
- Hardware (#E) x 2pcs
- Hardware (#F) x 2pcs

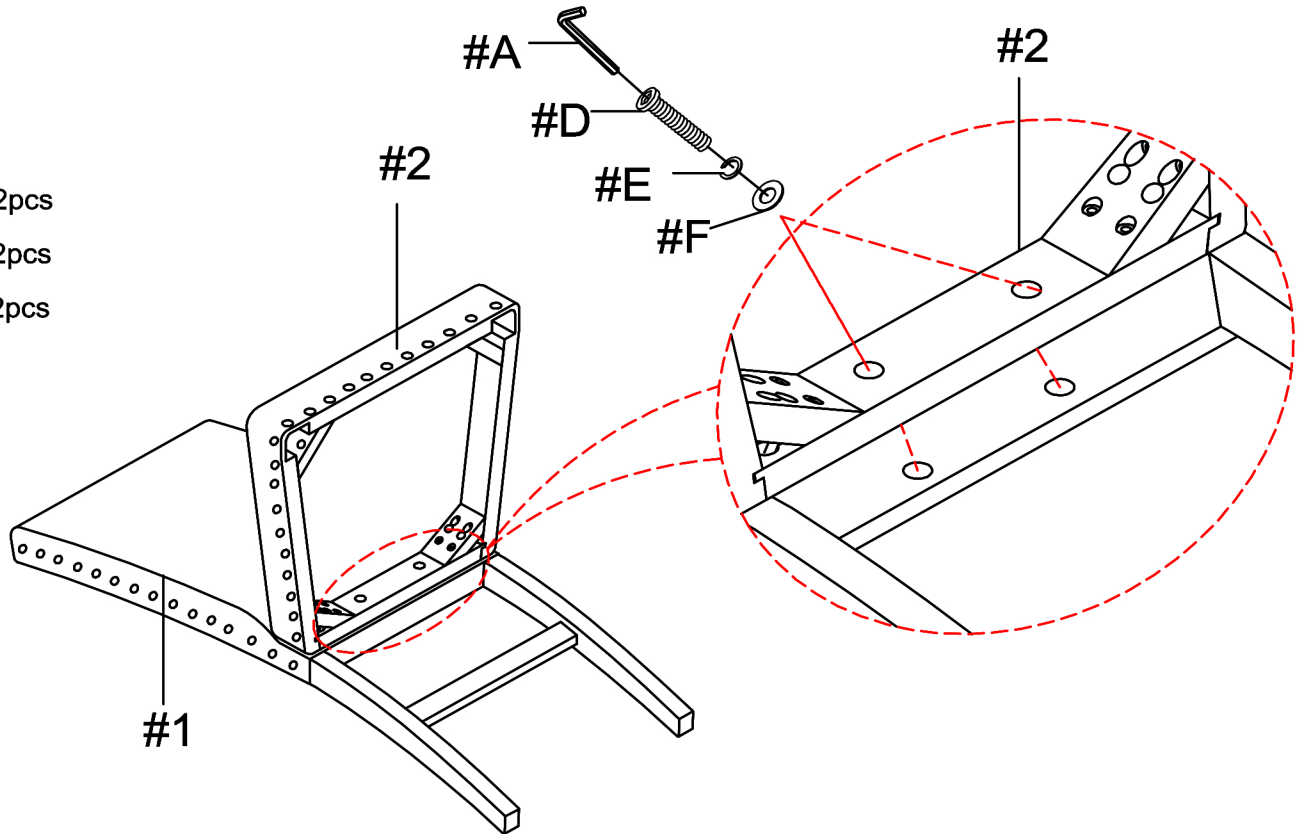

2

- Hardware (#B) x 4pcs
- Hardware (#E) x 4pcs
- Hardware (#F) x 4pcs

Prepare 4 bolts assembly by inserting lock washer (#E), then flat bolts (#F) onto bolts (#B). Secure corner holes of the seat (#2) to chair back (#1) by using bolts (#B).

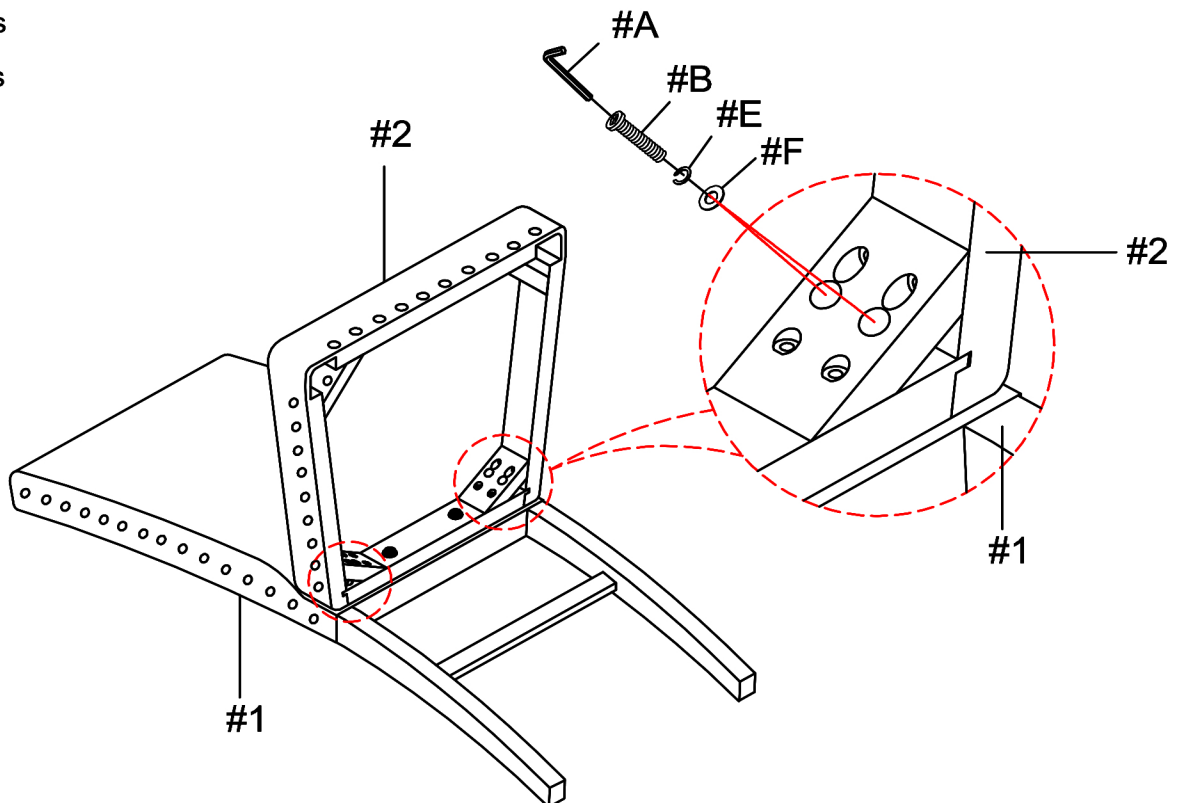

ASSEMBLY INSTRUCTIONS

- 1) Align front legs (#3R/L) to the holes of the seat (#2)
- 2) Align stretchers (#4,5R/L) to the gaps on the legs of the chair.

3

Part (#3) x2pcs

Part (#4) x1pc

Part (#5) x2pcs

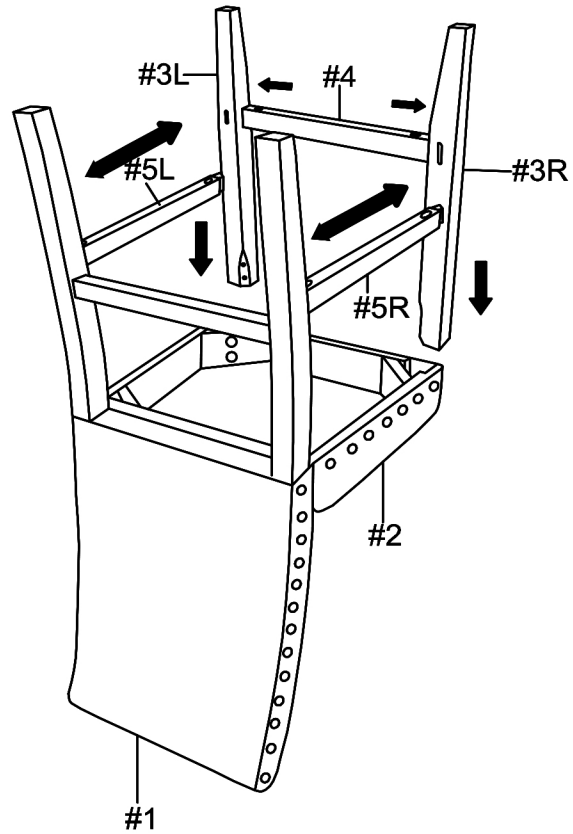

4

Hardware (#C) x 4pcs

Hardware (#E) x 4pcs

Hardware (#F) x 4pcs

- Prepare 4 bolts assembly by inserting lock washer (#E), then flat washer (#F) onto bolts (#C). Secure front legs (#3R/L) by using bolts (#C).

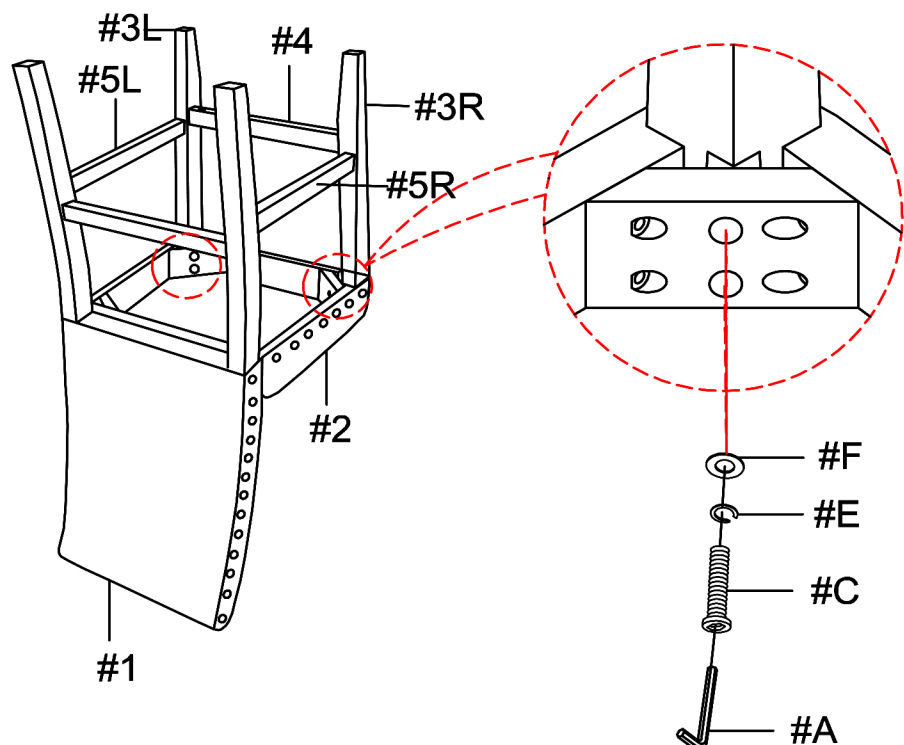

ASSEMBLY INSTRUCTIONS

5

Secure all stretchers to the chair legs by using screws (#G).

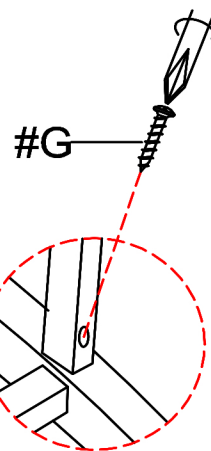

Hardware (#G) x 6pcs

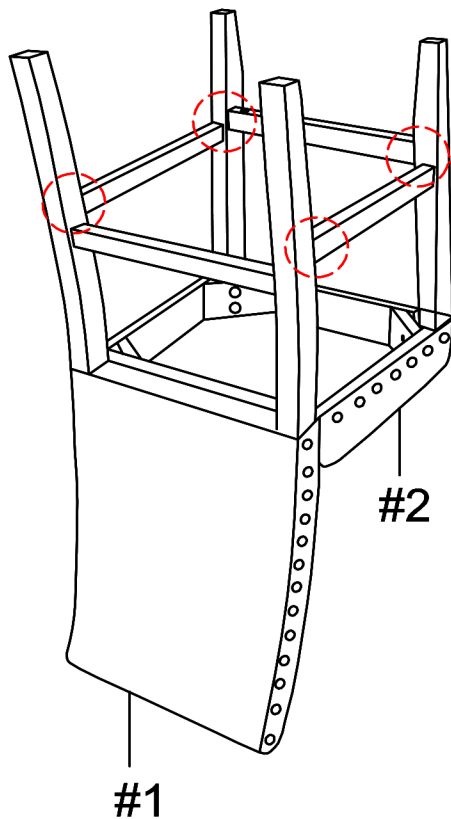

6

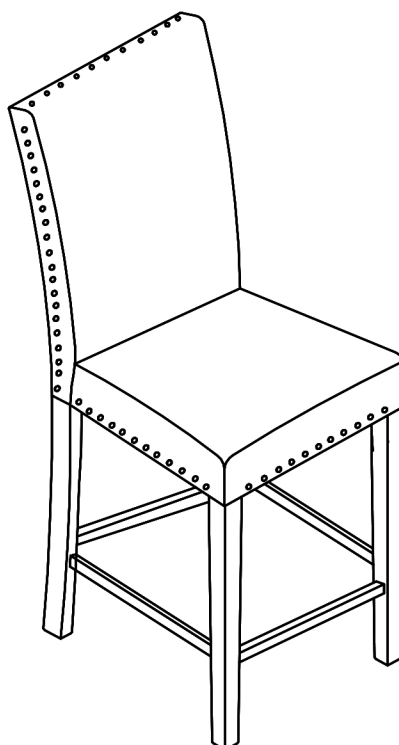

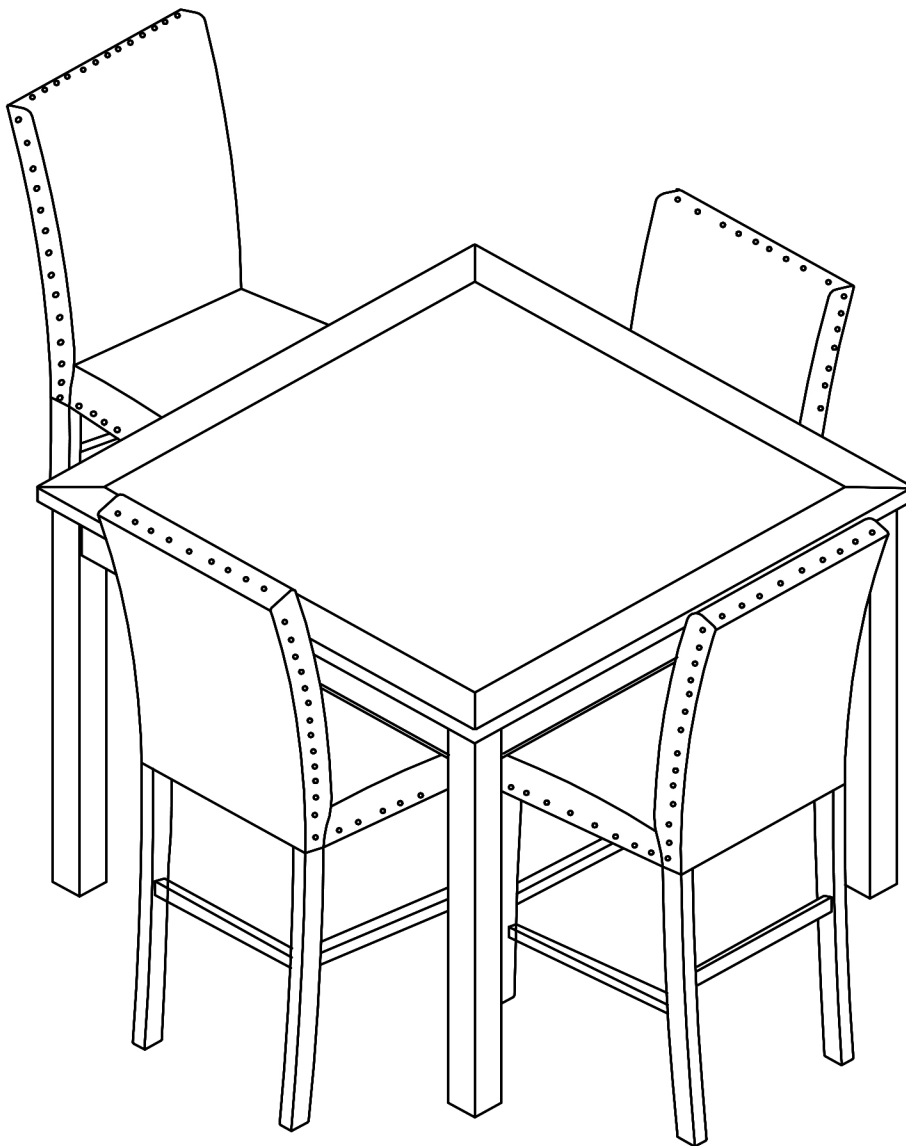

ASSEMBLY COMPLETED



Please ensure the furniture rests on an even and flat surface. If the product wobbles or feels loose, double-check all bolts and/or screws are properly tightened and secured.



Keep this handy!

Please retain this instruction manual and any order-related information for future reference.



Lift, don't drag!

To avoid damage to product please always LIFT the product when transporting or adjusting the placement.