

ASSEMBLY INSTRUCTIONS

TOOLS REQUIRED

No Tools Required For Assembly

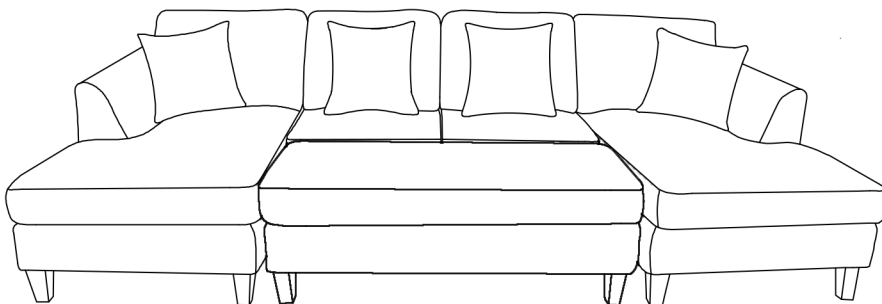

**2 - People
Recommended**

ASSEMBLY RATING



EASY ————— DIFFICULT

The Assembly Rating is a 5-point system showing the level of effort needed to assemble a specific product.



CHECK BEFORE STARTING

☐

Are you missing anything?

Double-check all parts, hardware and accessories listed on Page 6 are accounted for.

☐

Check out our Quick Tips!

We recommend reviewing the pre-assembly handouts. Even experts need a refresher now and then!

☐

Should we send any replacements?

Are there any irregularities or flaws in the parts? We can send replacements!

☐

Prep Time!

Please review the assembly instructions and all diagrams prior to assembling. Arrange parts as recommended on Page 7 and group identical hardware together to make assembling easier.

PRE ASSEMBLY INTRODUCTION

We understand building ready-to-assemble furniture can be a challenging experience for some. To help avoid confusion, we have provided some helpful tips that may speed up the process.

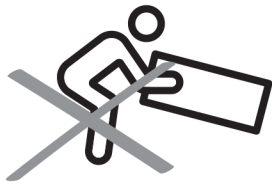

Teamwork

ALWAYS have at least two people to help with transporting and assembling the product to avoid potential injury and/or damage.

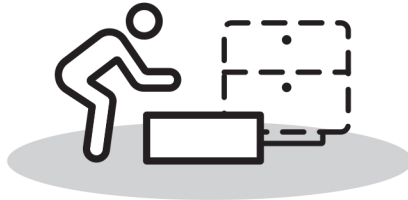

Suitable Location

Assembling near the area of the intended location is highly recommended.



Sufficient Space

Make sure you have enough space to move around during the assembly.

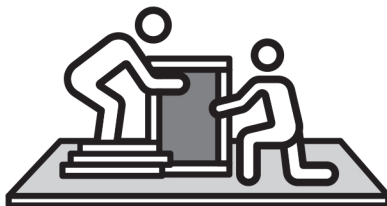

Avoid Scratches

Use cardboard, blankets or a carpeted area while assembling furniture to prevent scratches.

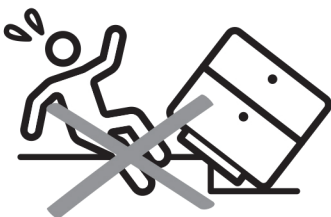

Flat Surface

Make sure the furniture rests on a flat and level surface with each leg evenly touching the floor.

ASSEMBLY AND CARE ADVICE



**FAILURE TO FOLLOW THE GUIDELINES BELOW MAY
RESULT IN INJURY AND/OR PROPERTY DAMAGE.**



Position each part correctly
and insert screws or bolts into
their respective holes.

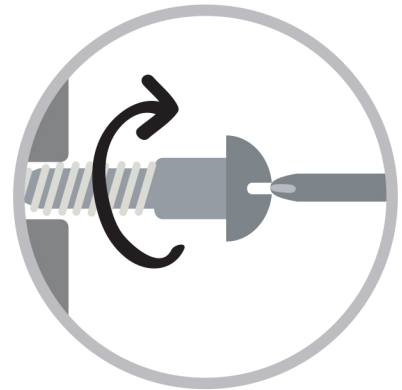

Turn clockwise to tighten and
only tighten when step is
completed or when instructed
to do so.



Use the appropriate hand tools
or power tools for assembly.
Select steps, such as tightening
screws and/or bolts, may require
hand tools to avoid causing
damage during assembly.



Save the instructions and store
any supplied tools for later
maintenance.

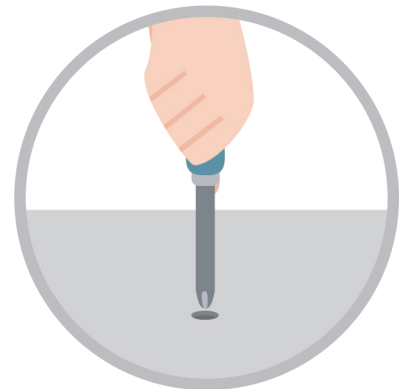

After two weeks, check and
tighten any loose hardware and
repeat again every six months
thereafter.

IT IS THE USER'S RESPONSIBILITY TO MAINTAIN THE FURNITURE. THE HARDWARE MAY LOOSEN OVER TIME AND MAY CAUSE THE FURNITURE TO BE WOBBLY AND UNABLE TO SUPPORT ITS INTENDED WEIGHT CAPACITY. THIS MAY LEAD TO COLLAPSE AND MAY CAUSE SERIOUS INJURY.

SOFA



- Please keep instructions for future reference.
- Check the quantity and irregularity of parts and hardware before you start.

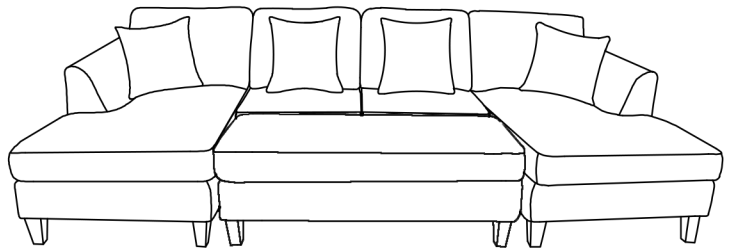

PARTS

#1 1pc



Left Seat Frame

#2 1pc



Left Seat Cushion

#3 1pc



Left Back Cushion

#4 1pc



Right Seat Frame

#5 1pc



Right Seat Cushion

#6 1pc



Right Back Cushion

#7 2pcs



Chair Frame

#8 2pcs

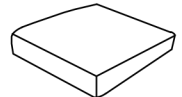

Chair Seat

#9 2pcs



Chair Back

#10 1pc

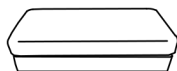

Ottoman

#11 4pcs



Pillow

#12 22pcs



Leg

#13 22pcs



Plastic Washer

Exploded View

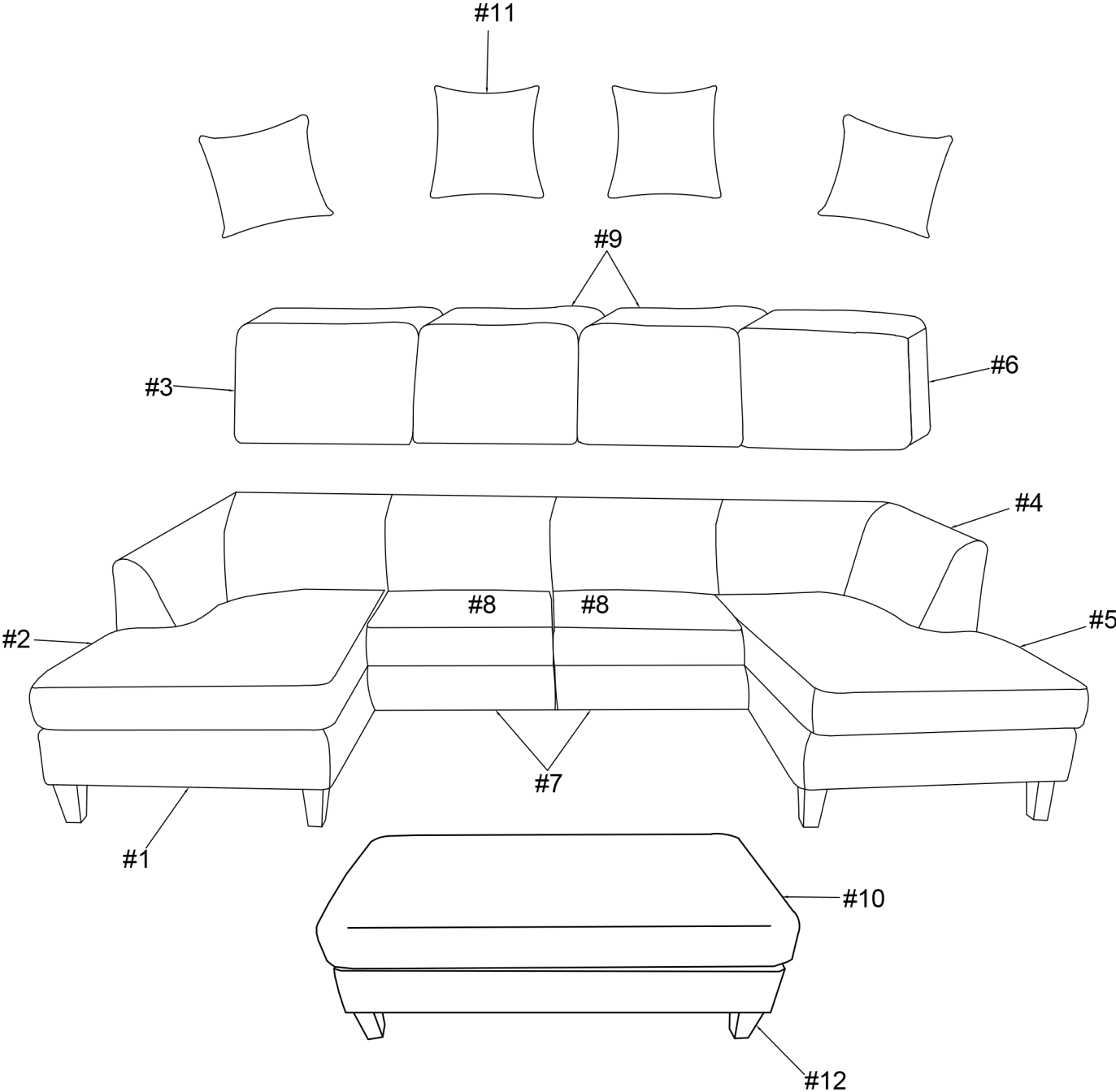

ASSEMBLY INSTRUCTIONS

1

Remove parts from the bottom compartment of the left seat frame (#1).

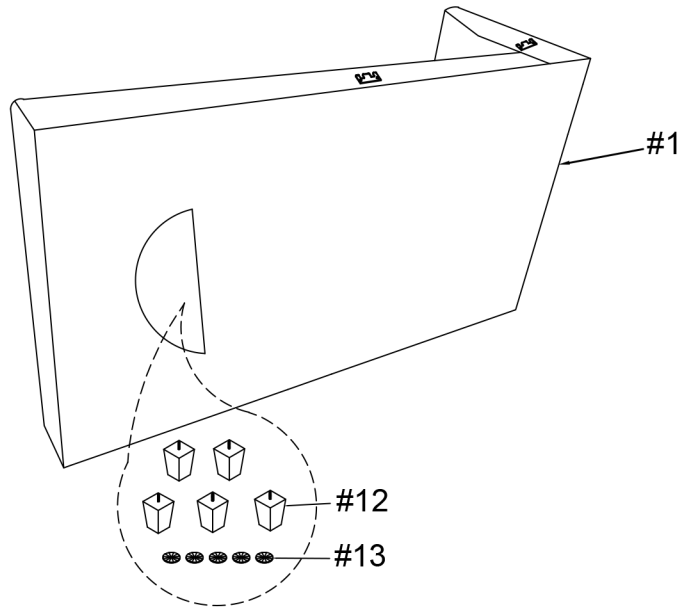

2

Part #1 x1pc
Part #12 x5pcs
Part #13 x5pcs

Align and attach legs (#12) with washers (#13) to left seat frame (#1).

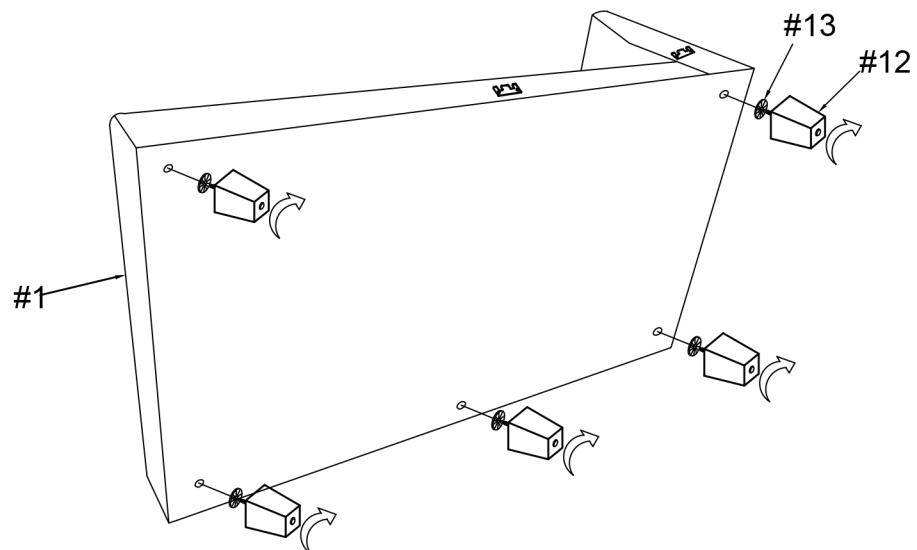

ASSEMBLY INSTRUCTIONS

3

Part #2 x1pc

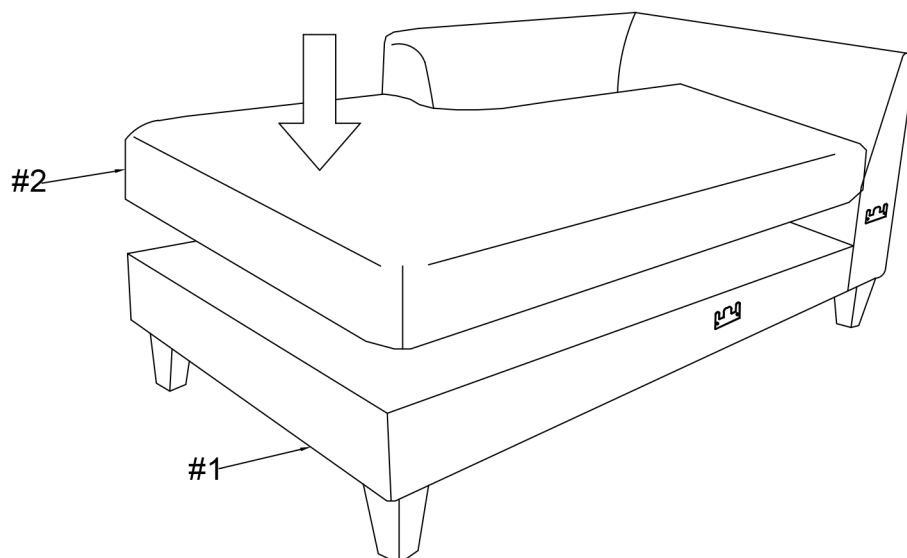

4

Part #3 x1pc

Part #11 x1pc

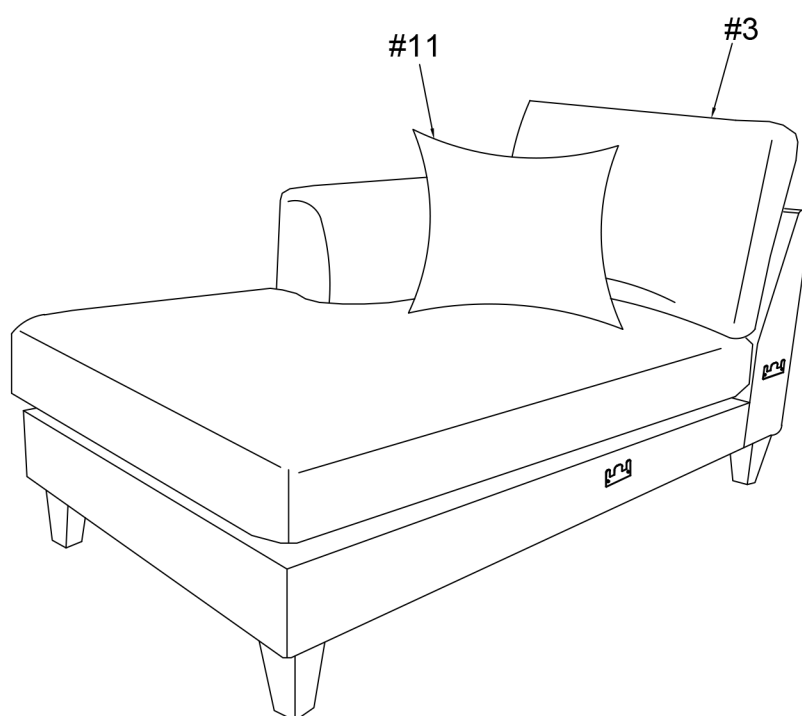

ASSEMBLY INSTRUCTIONS

5

Remove parts from the bottom compartment of the right seat frame (#4).

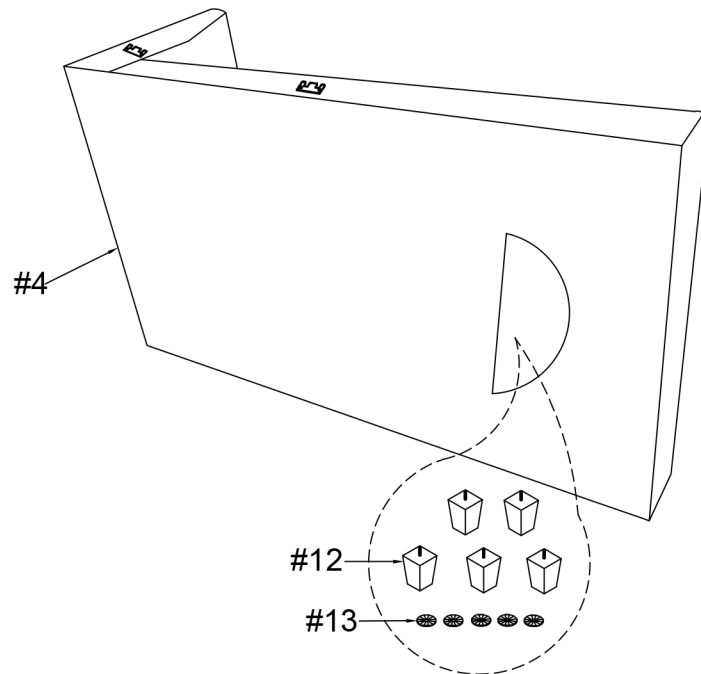

6

- Part #4 x1pc
- Part #12 x5pcs
- Part #13 x5pcs

Attach legs (#12) with washers (#13) to right seat frame (#4).

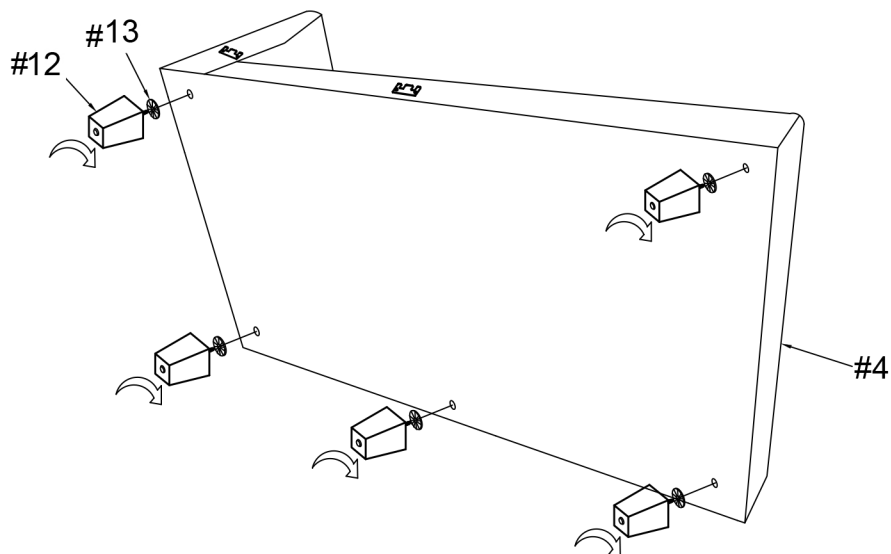

ASSEMBLY INSTRUCTIONS

7

Part #5 x1pc

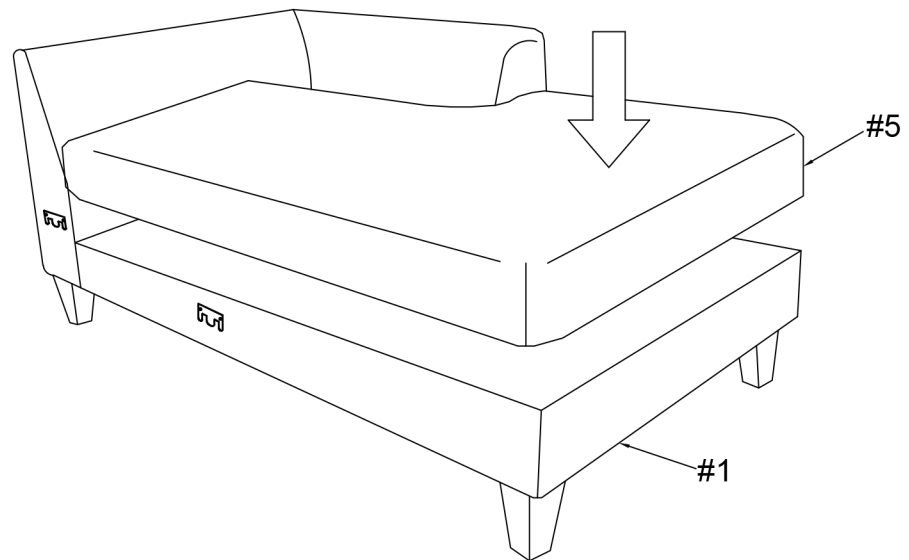

8

Part #6 x1pc

Part #11 x1pc

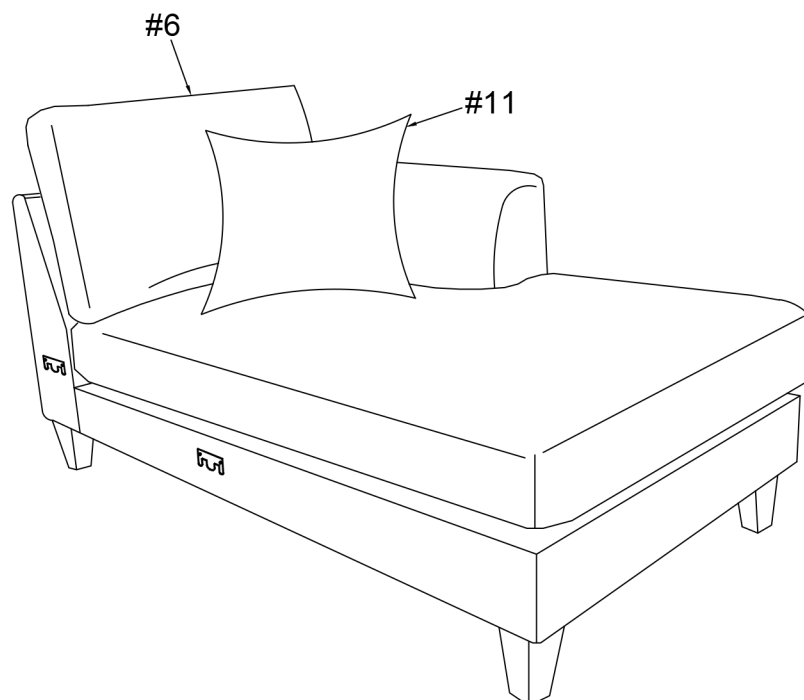

ASSEMBLY INSTRUCTIONS

9

Remove parts from bottom compartment of chair frame (#7).

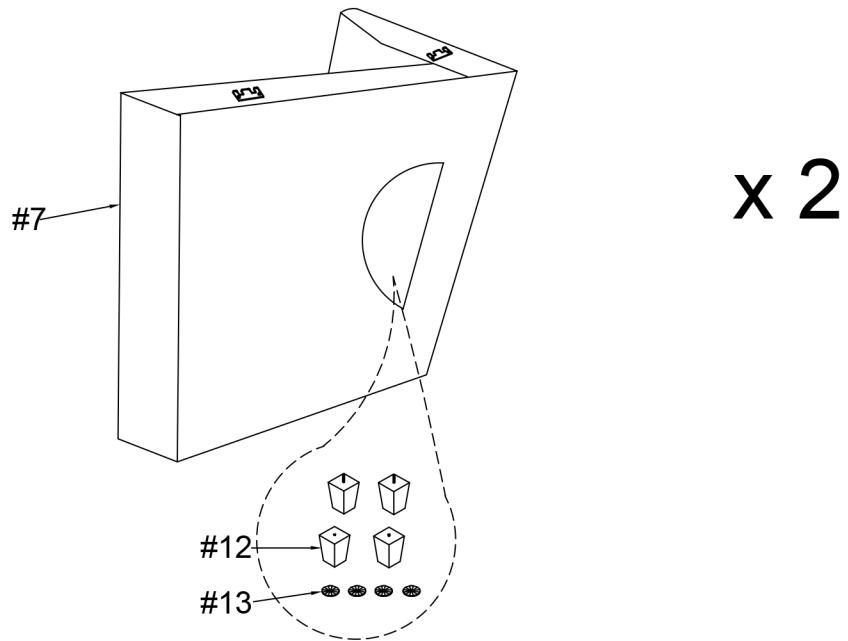

10

Part #7 x1pc
Part #12 x4pcs
Part #13 x4pcs

Attach legs (#12) with washers (#13) to the chair frame (#7).

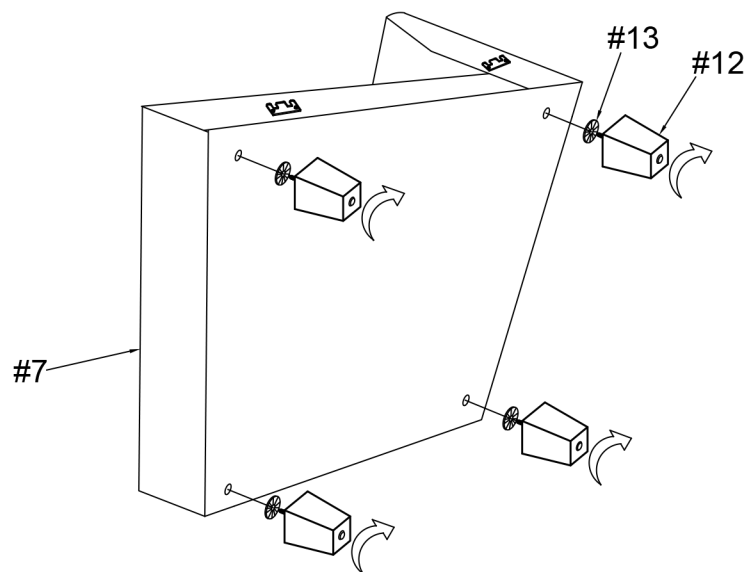

ASSEMBLY INSTRUCTIONS

11

Part  #8 x1pc

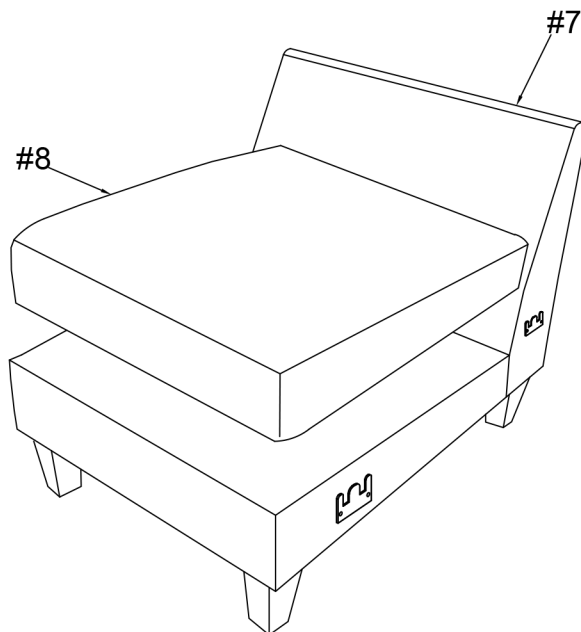

12

Part  #9 x1pc
Part  #11 x1pc

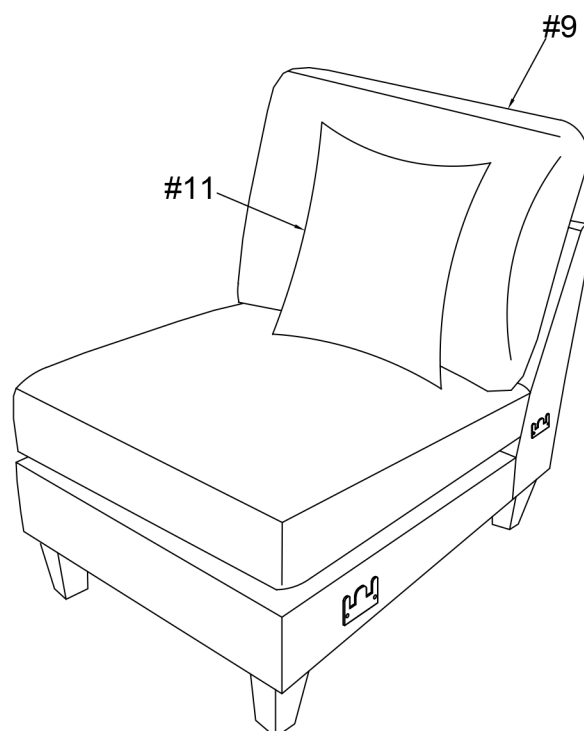

ASSEMBLY INSTRUCTIONS

13

Remove parts from the bottom compartment of the ottoman (#10).

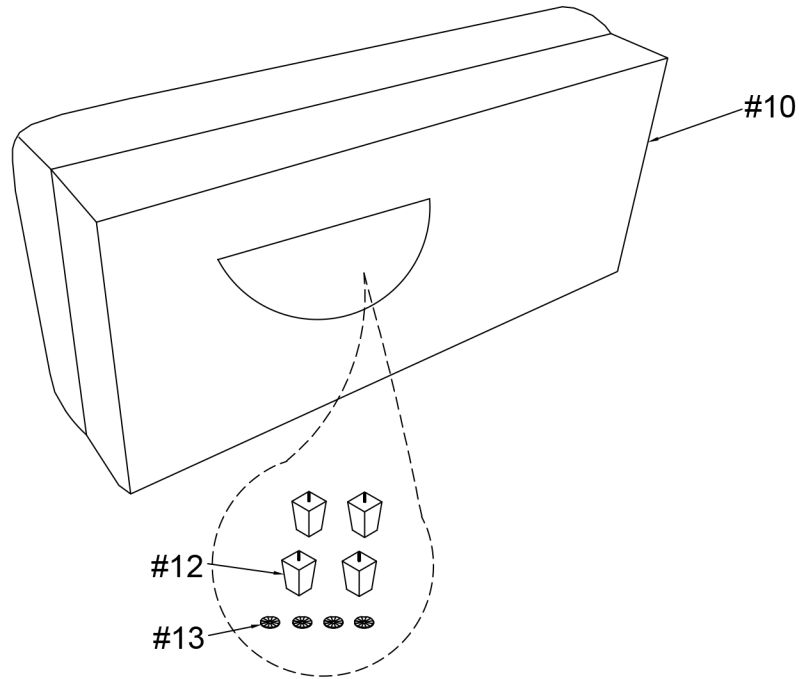

14

Part #10 x1pc
Part #12 x4pcs
Part #13 x4pcs

Attach legs (#12) with washers (#13) to the ottoman (#10).

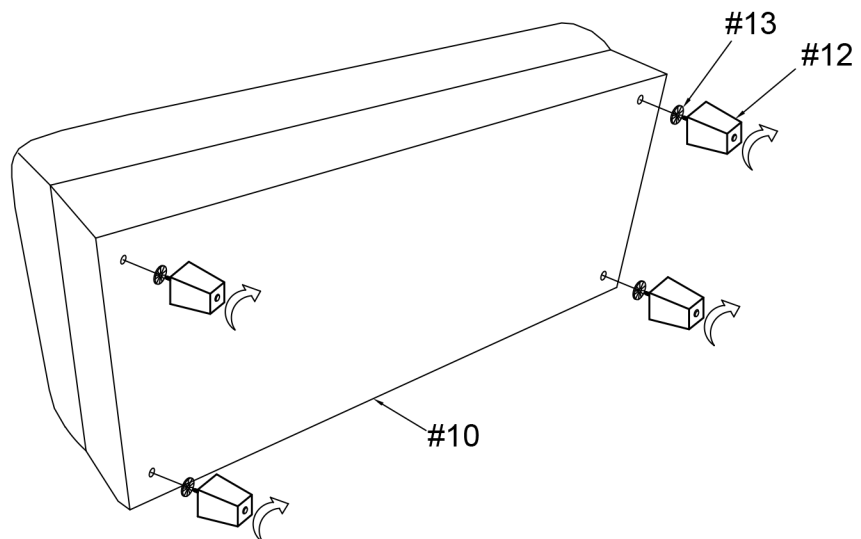

ASSEMBLY INSTRUCTIONS

15

Align and hook the metal brackets of the sectional pieces together.

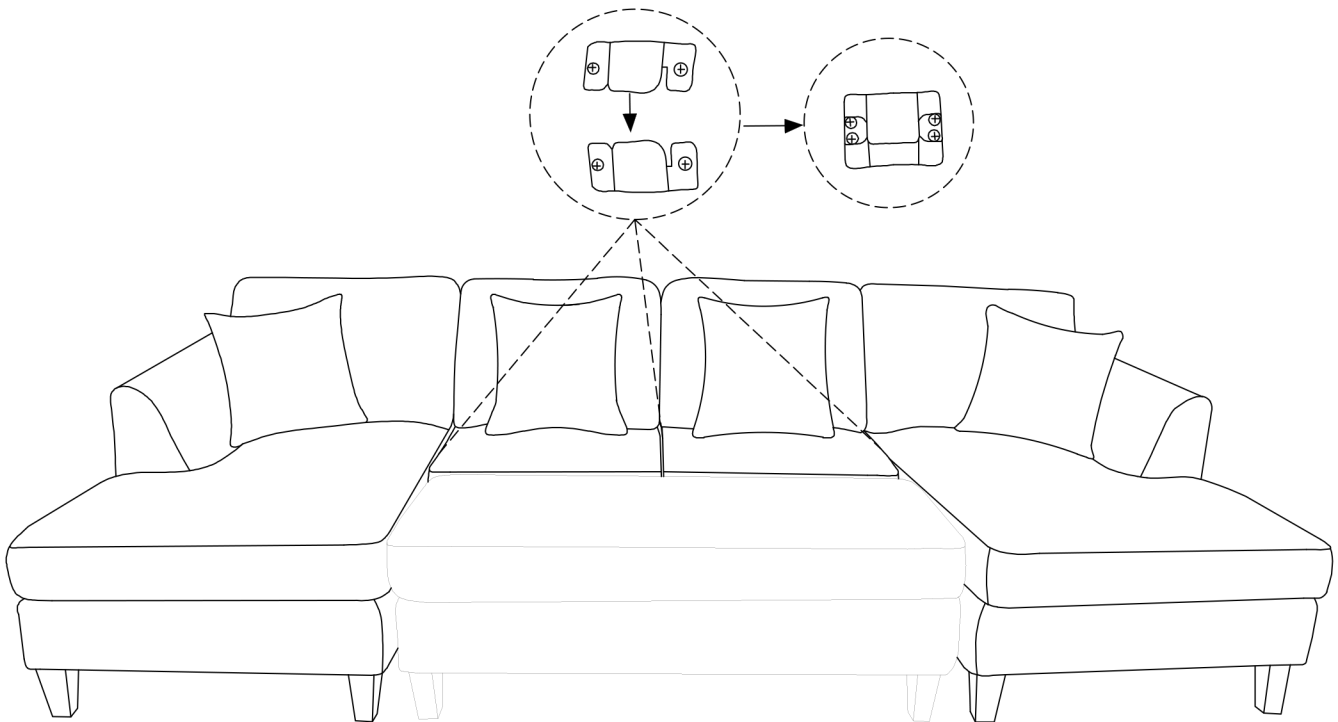

ASSEMBLY COMPLETED



Please ensure the furniture rests on an even and flat surface. If the product wobbles or feels loose, double-check all bolts and/or screws are properly tightened and secured.



Keep this handy!

Please retain this instruction manual and any order-related information for future reference.



Lift, don't drag!

To avoid damage to product please always LIFT the product when transporting or adjusting the placement.