

Grid Sink Drain

#TG01-AG (Aged Copper), #G15-HN (Nickel), #TG01-PC (Polished Copper), #TG01-SG (Satin Gold)

SINKOLOGY®

1.5" Grid Sink Drain – No Overflow

The SinkSense® grid drain makes pairing the right sink simple - and is easy to install. Designed to fit our sinks and match beautifully, this solid drain enhances water flow and drainage. Our lifetime warranty guarantees the durability of this drain for as long as you own it.

FEATURES

- **2.125" x 2.125" x 8"**
- Fits 1.5" standard-sized no-overflow sinks
- Grid-style design enhances water flow and drainage
- Protected by our lifetime warranty

AVAILABLE COLORS / FINISHES



Aged Copper (#TG01-AG)



Nickel (#G15-HN)



Polished Copper (#TG01-PC)



Satin Gold (#TG01-SG)

DIMENSIONS

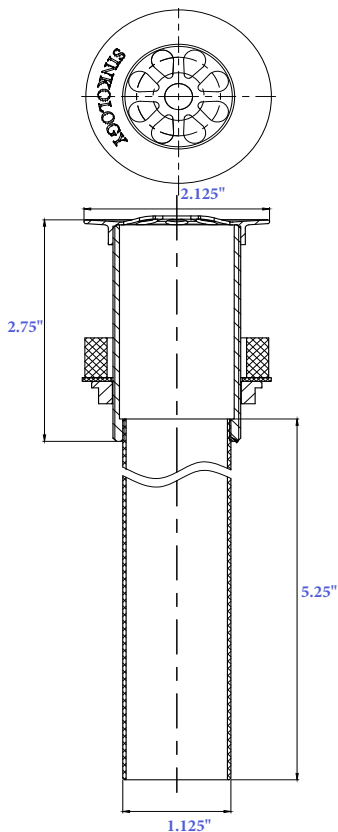

RECOMMENDED PRODUCTS

Sinkology Copper or Nickel Bath Sinks without an Overflow Hole

LIFETIME WARRANTY

All Sinkology products are fully backed with a lifetime warranty - the Sinkology Everyday Promise™.



INSTALLATION

Sinkology® bath drains feature a no-overflow design and should only be installed into bathroom sinks without overflow holes. If your sink has an overflow, you will need to purchase an overflow sink drain, available at most retailers.

Sink drain installation instructions are available on the BILT® App. Download the BILT App today and search "Sinkology" to find install instructions specifically for your product and installation type or scan the QR Code for easy access.

SCAN FOR BILT 3D INSTRUCTIONS



POWERED BY BILT INTELLIGENT INSTRUCTIONS®

SINKOLOGY®