



Liberty Furniture
INDUSTRIES, INC

ASSEMBLY INSTRUCTION

ITEM#: **244 - CB5692**

DESCRIPTION: **BUFFET**

Thank you for purchasing this quality product. Be sure to check all packing material carefully for small parts which may have come loose inside the carton during shipment. Identify and count all parts and compare with the parts List Below:

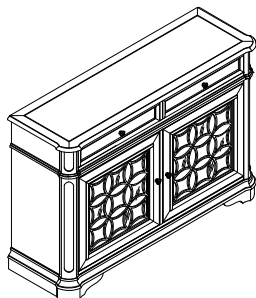

OPTIONAL ANTIQUE
MIRRORED GLASS

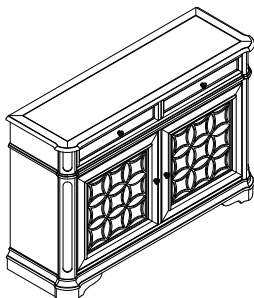

OPTIONAL
WOOD DOOR

PART LIST:

①		②	
BUFFET:1PC		WOOD PANEL: 2PCS	

HARDWARE LIST

NO.	Drawing	Description	Q'ty
A		Furniture Tipping Restraint	1 Set

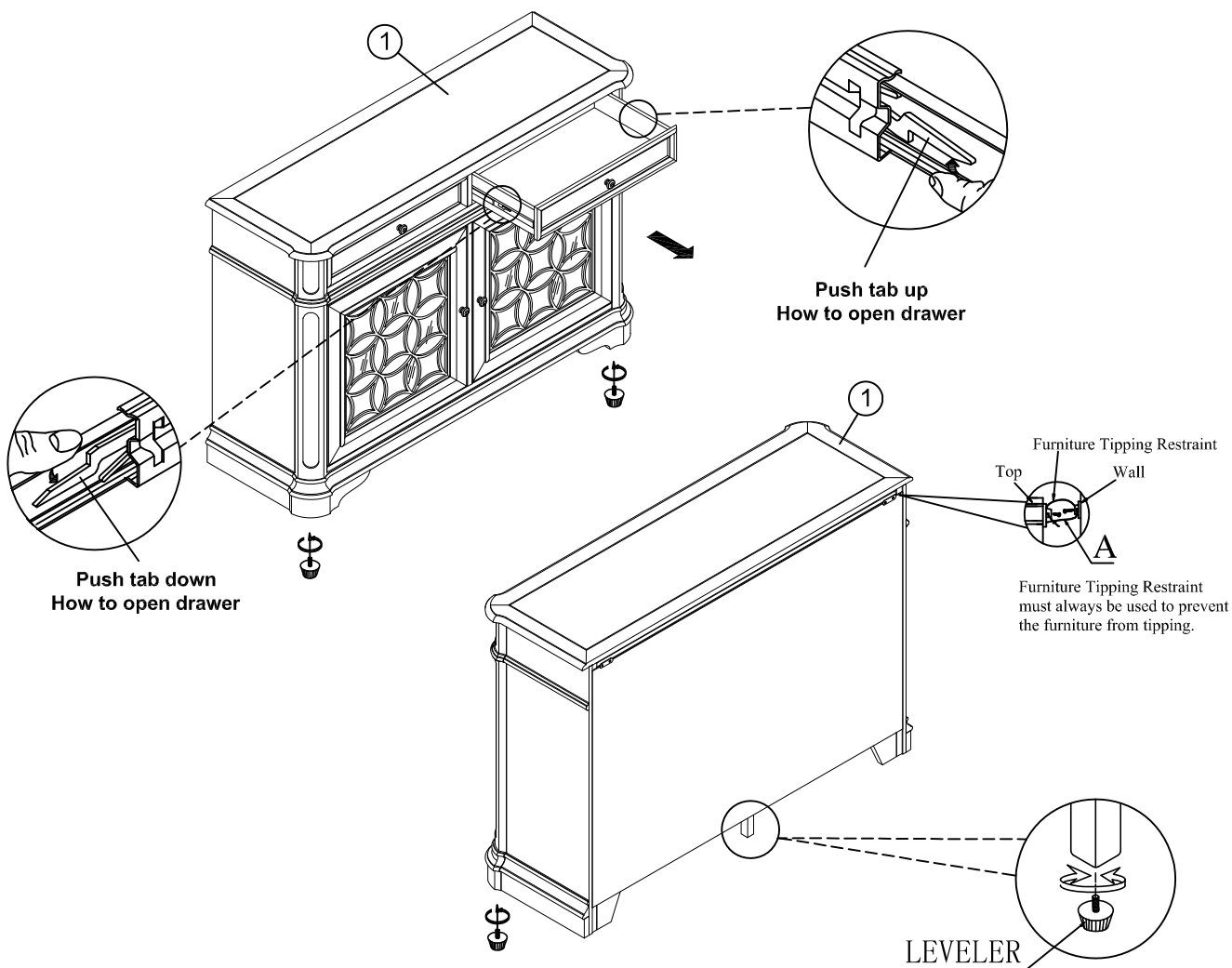

CLEANING INSTRUCTION

Clean the Buffet surface with a furniture polish and a soft cloth.

Made in VietNam

ASSEMBLY INSTRUCTION

DESCRIPTION: BUFFET

ITEM#: 244 - CB5692

OPTIONAL WOOD PANEL

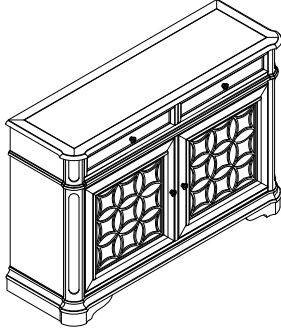

NOTE:

- Optional wood door panel is located inside the door, behind the mirrored panel. To install, unscrew the back panel and switch out the mirrored panel and place the wood panel in front. Attach the back panel with screws and tighten.

STEP 1: Open the door back panel

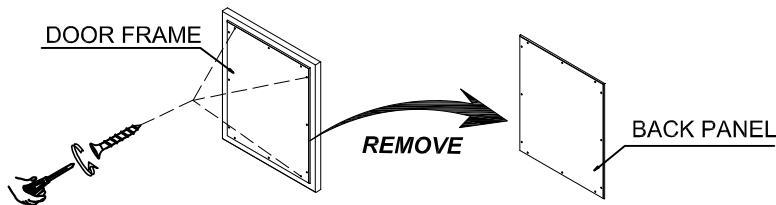

STEP 2: Remove antique mirrored glass

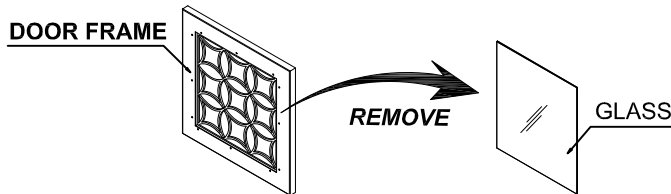

STEP 3: Insert wood panel

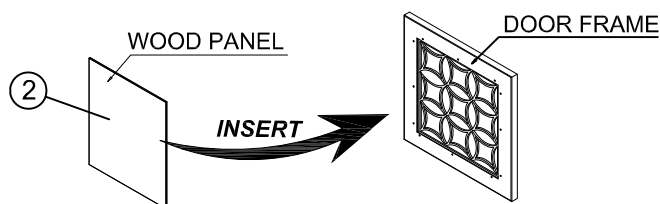

STEP 4: Attach the door back panel with decorative screw

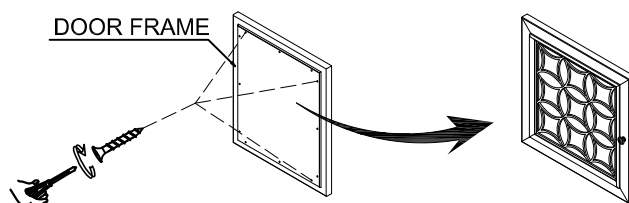

CLEANING INSTRUCTION

Clean the Buffet surface with a furniture polish and a soft cloth.