

PSCC2291,5,8

Pedestal 3-Tier T Type Ironwork Towel Rack

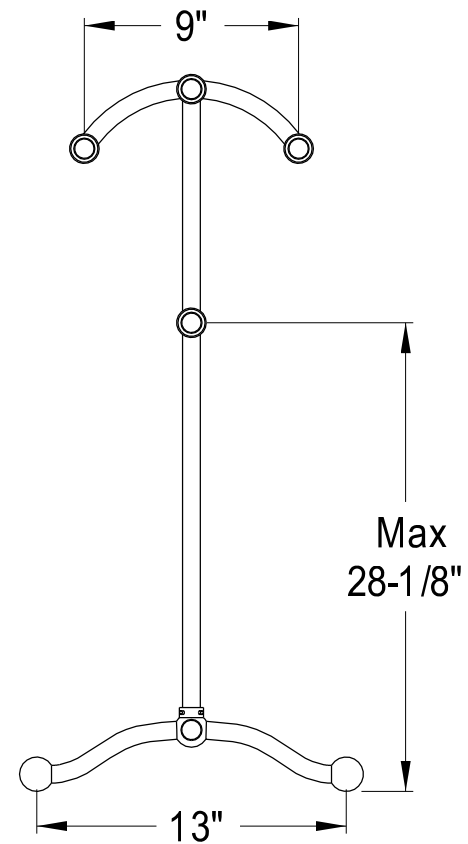

Pedestal 3-Tier T Type Towel Rack Installation

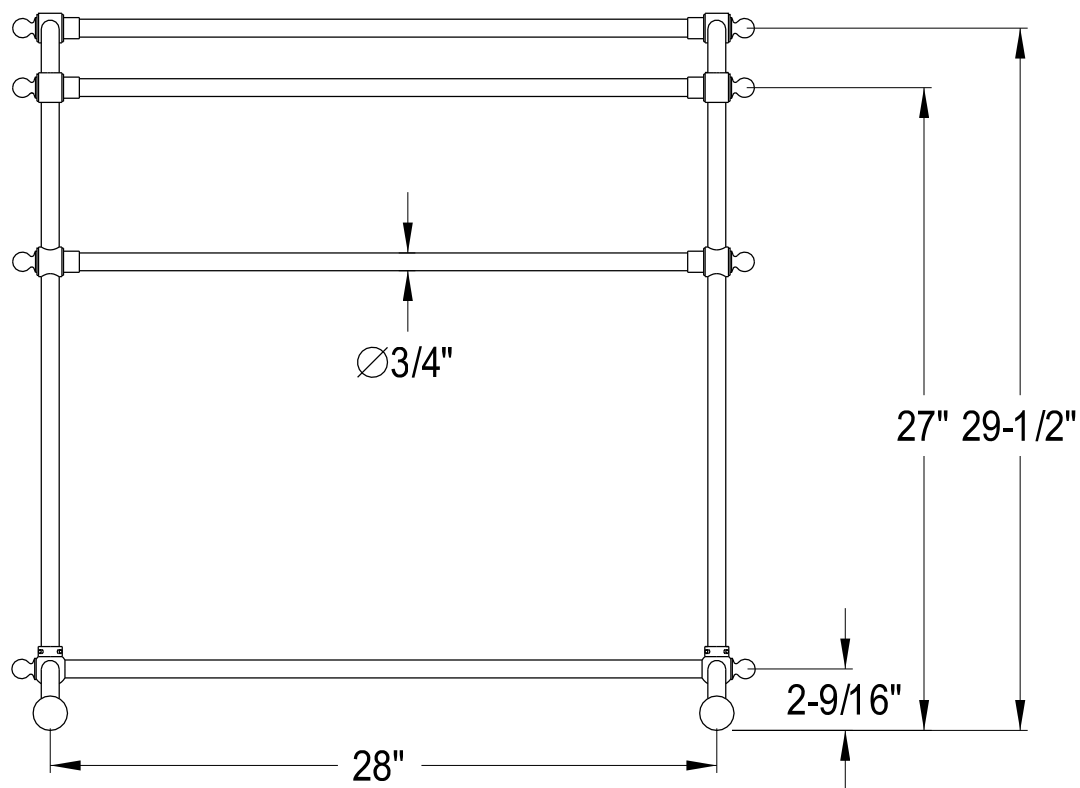
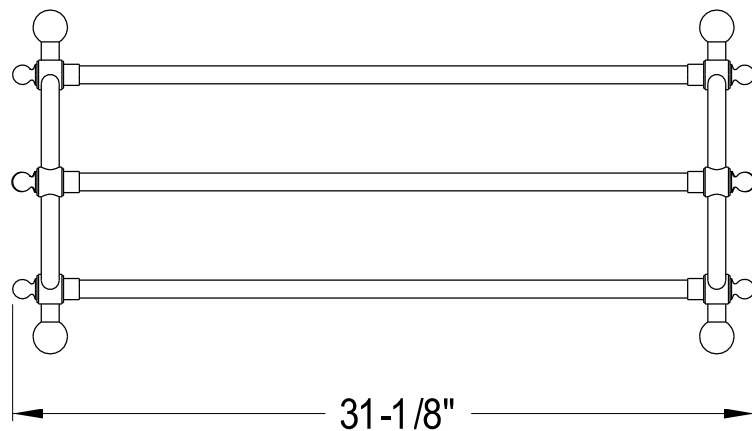
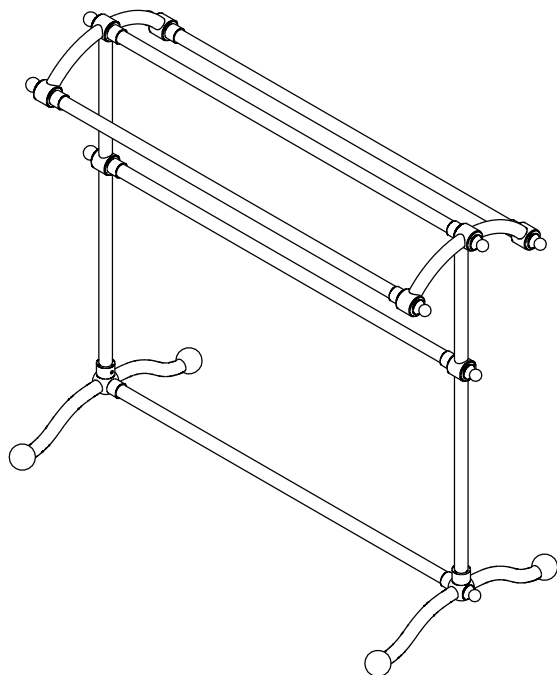

Parts:

Bolt			Set Screw	Sift Head
1	2	3	4	5
8 Pcs	2 Pcs	4 Pcs	2 Pcs	10 Pcs

TOOLS REQUIRED

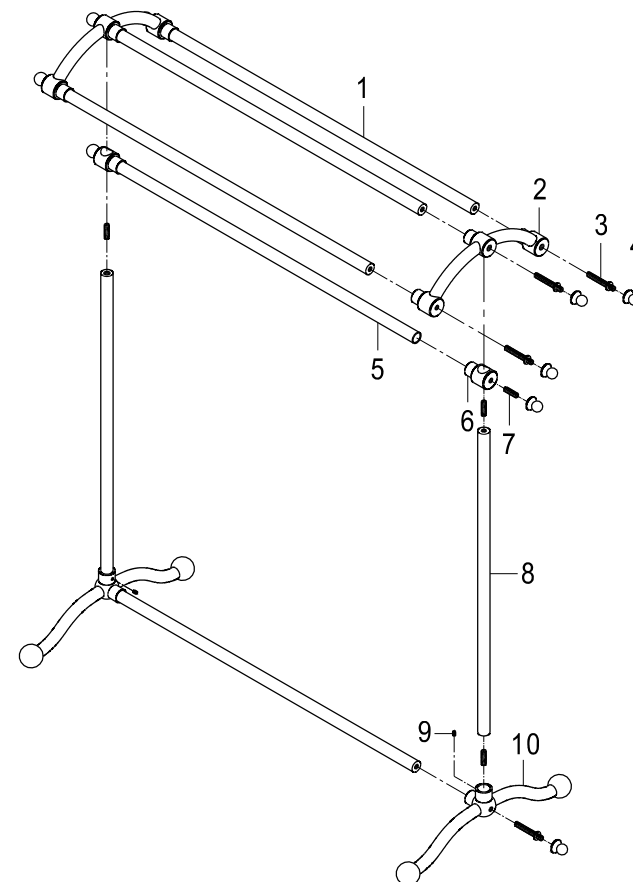

Installation Steps:

- Step 1. Set up one end of the base by locating the base (10) and attaching to the long pole (8) using the mounting hardware provided.
- Step 2. Complete the top portion by attaching curved rack holder (2) to the connector (6) using the mounting hardware. Repeat for other side.
- Step 3. Complete the installation by connecting the two sides using the towel rods and securing with screws and end caps.

Cleaning

Clean with a damp cloth only.
Avoid using metal or abrasive polishes.