



# Wooden Table & Chairs Set

## INSTRUCTION MANUAL

No.: 9001  
Ages:  
3-8 years

**⚠ WARNING:**  
Contains small parts and sharp points - ASSEMBLY MUST BE CONDUCTED BY AN ADULT ONLY.  
Prior to and during assembly of this product, keep unassembled screws, small parts and plastic bags out of children's reach. Small parts pose a choke hazard to children under 3 years.

- Phillips/cross-head screwdriver required (not included) for installation.
- Adult supervision advised when item is in use.
- Maximum weight limit on each chair: 23 kg (50 lbs). Limit one (1) child per chair.
- DO NOT use the table and chairs in any manner other than intended. Sitting and/or climbing on the table, and/or standing on the chair may cause a potential fall or tip in result of serious or fatal injury.

### ASSEMBLY INSTRUCTION

**FITTING PACK (not in scale)**

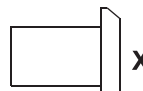
**X8**  
**N1** Nut

**X8**  
**N2** M6 Nut

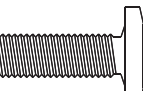
**X8**  
**S1** Bolt

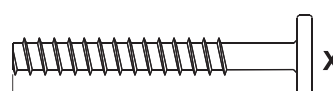
**X16**  
**S2** Truss-head screw

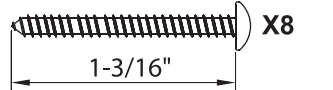
**X8**  
**S3** Round-head screw

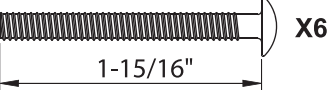
**X6**  
**S4** Round-head screw

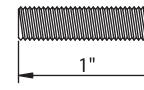
**X8**  
**S5** Bolt

PARTS LIST		
#	Description	QTY
A	Table Top	1
B	Table Leg	4
C	Crossbeam	2
D	Shelf	2
E	Drawing Board	1
F	Chair Back	2
G	Chair Front	2
H	Chair Seat	2
I	Chair Support - L	2
J	Chair Support - R	2
K	Chair Foot	4
L	Fabric Pocket	4
M	Fabric Storage	2

### TO ASSEMBLE CHAIR

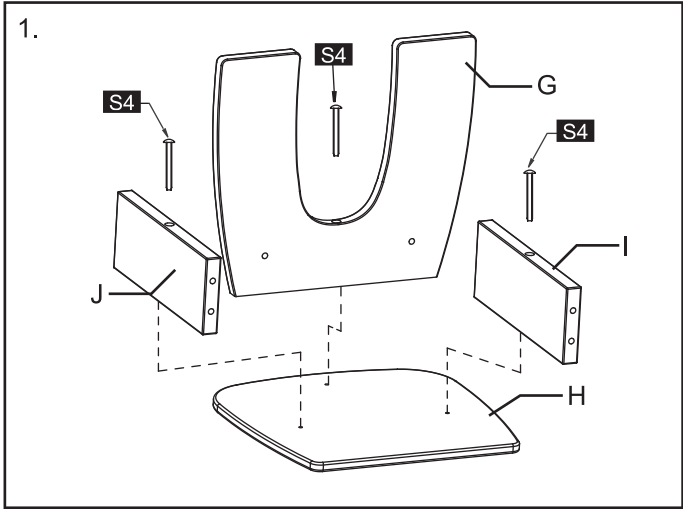

Place the chair seat (H) on a flat ground surface with the bottom facing **UP**. Align the chair supports (I & J), and the chair front (G) to the respective holes. Make sure the chair support end with 1 hole is matching the hole at the chair front. Join the panels by fasten (x3) 1-15/16" round-head screws (S4) and tighten with a Phillips / cross-head screwdriver.

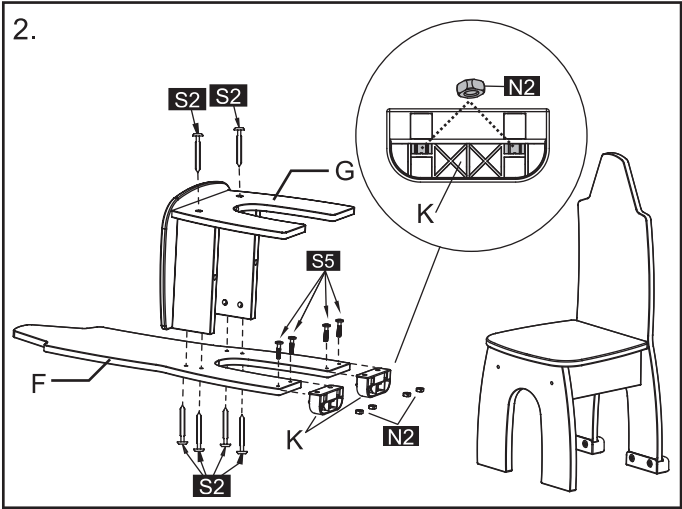

Attach the chair assemblies from step 1 to the chair back (F). Match the holes on the chair front and the chair back, then fasten (x2) 1-1/2" Truss-head screws (S2) through holes at the chair front; and (x4) same screws from the chair back. Fully tighten to secure. Now, insert (x2) M6 nuts to the slot of each chair foot (K) as shown in the inset. Tighten the chair foot with (x2) 1" bolts (S5) to lock the M6 nuts through holes to the chair back. Repeat this for the other chair.

### TO ASSEMBLE TABLE

#### Assembly Tips for Step 3 - 5

Make sure the Phillips screw head ("crosshead") of the plastic screw nut at the table leg is facing **OUT**, and the **LONGEST** side of the "cross" is pointing to the open end and through hole. It helps much easier to complete Step 7 to lock the S2 screws.

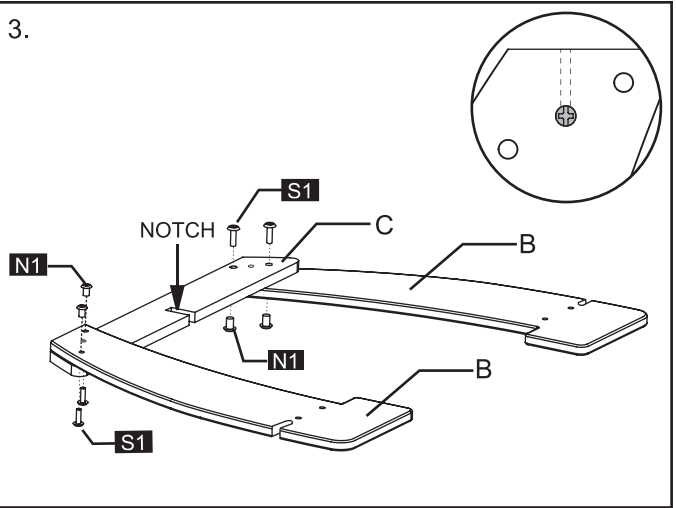
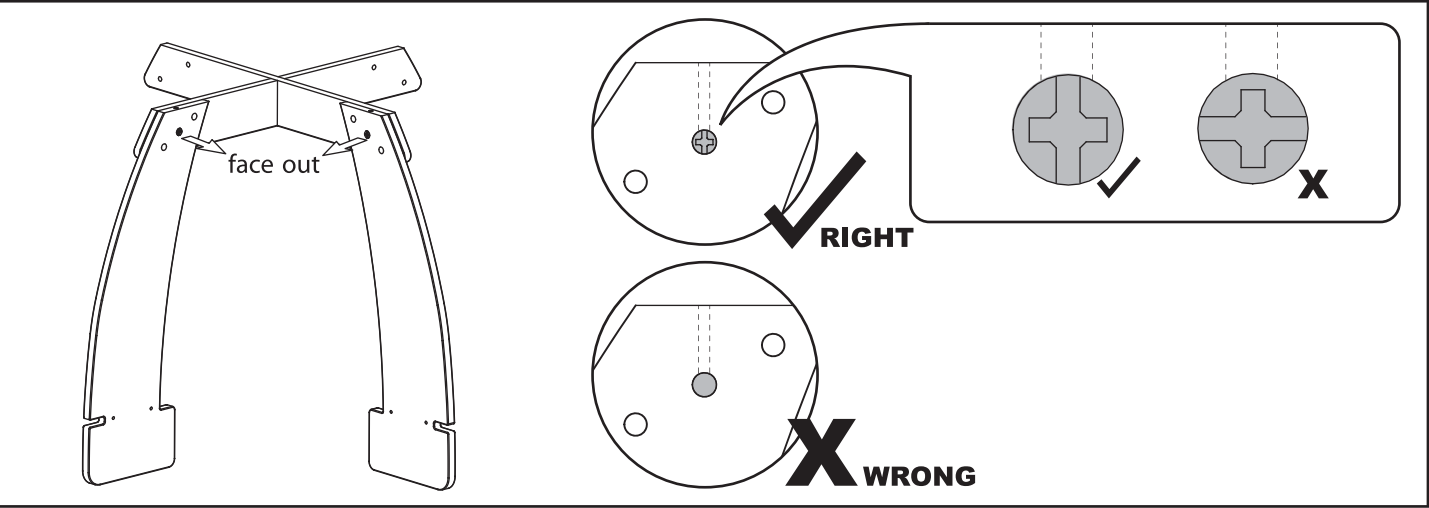

Align the table legs (B) and crossbeam (C) on the floor as shown. Ensure the notch is facing **DOWN**, and one leg on the top and one underneath as shown in diagram. Affix (x4) 11/16" bolts (S1) and (x4) 15/32" nuts (N1) to secure both legs with a cross-head screwdriver (do not over tighten).

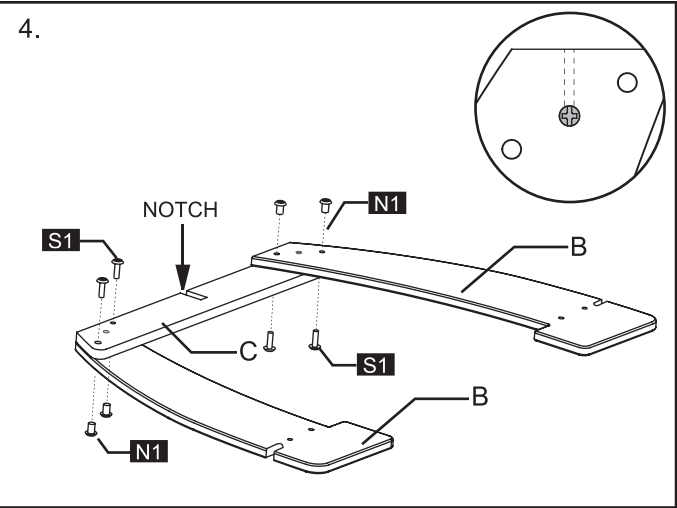

Do the same for the other table legs. Note: The notch for this leg assembly should be facing **UP**, and the leg position is opposite to Step 3 (do not over tighten).

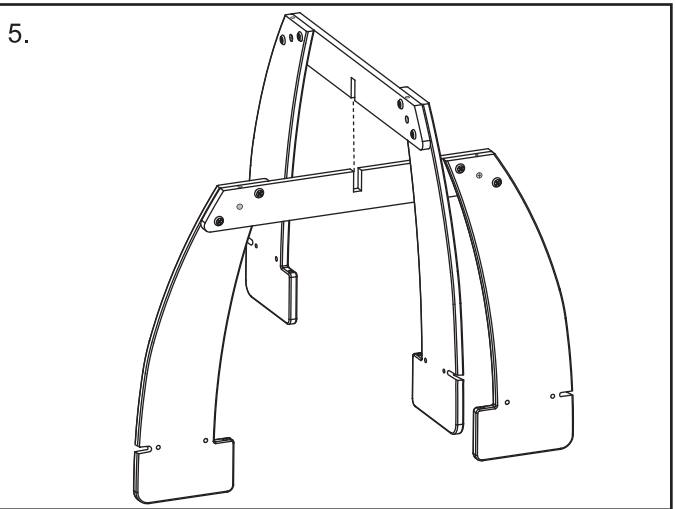

Lock the notches on the table legs together and make sure edges are flushed.

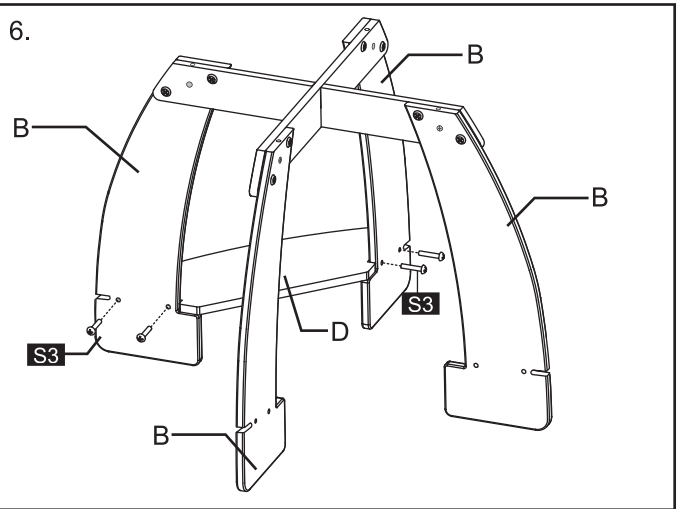

Attach the shelf (D) to the leg assembly as shown. Some adjustments to the table legs (B) may be necessary to fit the shelf correctly. Insert (x2) 1-3/16" round-head screws (S3) through each side of the table legs (B). Tighten screws. Repeat the same for the other shelf.

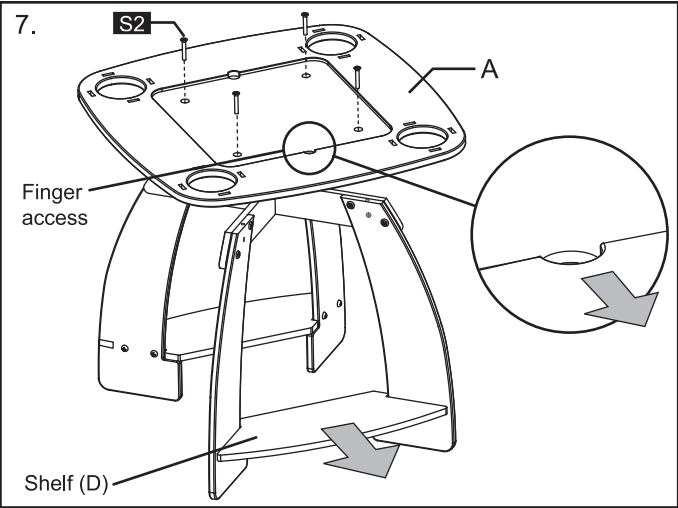

Align the holes of the table top (A) to the corresponding holes of the table legs (B). Make sure the finger access on the table top and the shelf (D) are facing to the same direction. Fasten with (x4) 1-1/2" Truss-head screws (S2) to secure the table top in its position.

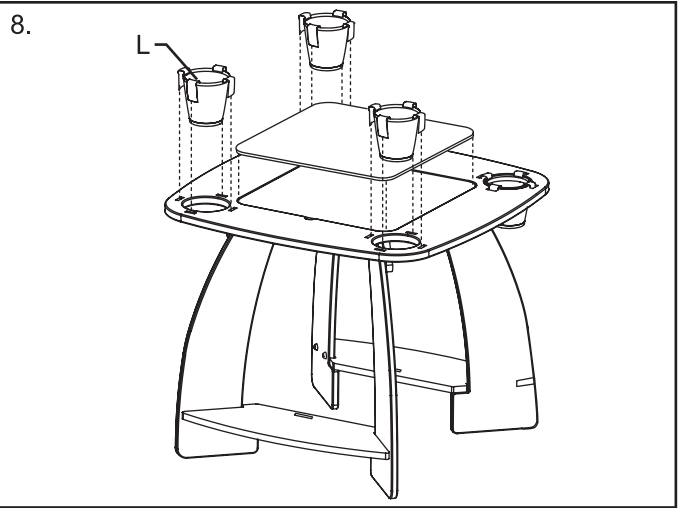

Place (x4) fabric pockets (L) and the reversible drawing board (E) on the table top.

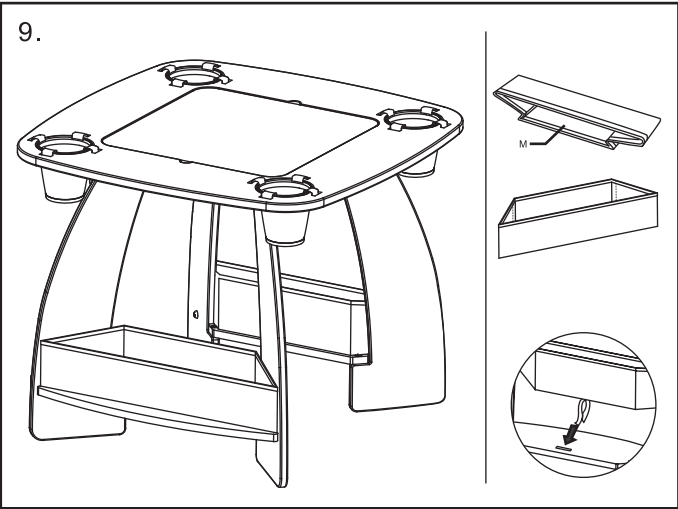

Unfold and place the fabric storages (M) on the shelves and tie securely in place.

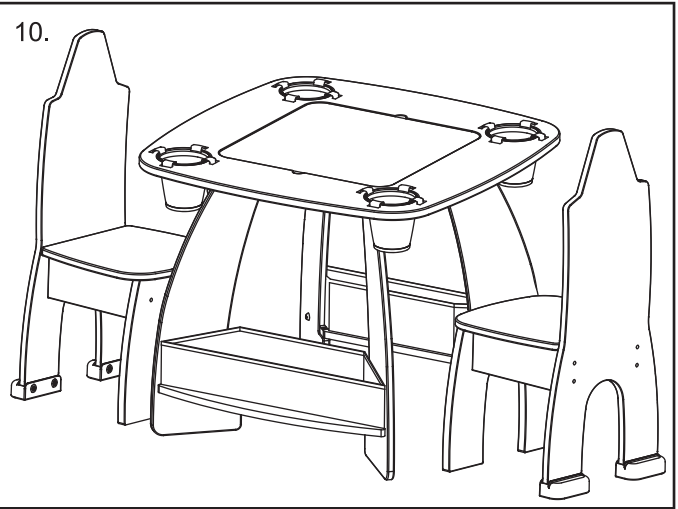

Picture shows the final assembled product.

### CARE INSTRUCTIONS

- Before use, please check that all parts are assembled securely. Failure to do so could result in serious or fatal injury.
- This table was made for INDOOR use. DO NOT attempt to use or expose the unit outdoors. The chalkboard surface is weather sensitive, any wetness or excessive dampness will ruin the board.
- Treat the boards' surfaces with care. DO NOT use sharp pointed objects on the writing surface. Scratching the surface will cause permanent damage.
- Chalkboard must be treated prior to use. To season: hold Crayola® Anti-Dust® or school chalk on the flat side (not the point side) and using board flat strokes, coat the board both horizontally then vertically making sure to cover the entire board surface. Wipe off the chalk with a slightly damp sponge (or paper towel). Let it dry overnight.
- Crayola® Anti-Dust® or school chalk (Calcium Carbonate Based) is recommended for use on the chalkboard surface. DO NOT use Crayola Sidewalk Chalk or other "street chalk" as it contains abrasives that will damage the board.
- Washable markers are not compatible with the dry erase surface. For best results, use only Crayola® Low Odor, Non Toxic Dry-Erase Markers.
- If there is some hard-to-erase ink left on the boards surface, use a slightly damp sponge (or paper towel) and wipe the board clean. Any excessive water may damage the board.
- DO NOT locate this product in close proximity to an open fire, radiator or heater.

### LIMITED WARRANTY

Our products are covered under warranty for a period of 60 days from the date of purchase, under normal use and service, against defective workmanship and material. If you have recently purchased this product and find it to be defective in anyway, kindly return it to the "Source of Purchase" for a Full Refund or Exchange.

Should the product no longer be covered by your Purchase Receipt, or should you have any questions pertaining to our product, please call our Toll Free Customer Service for assistance.

Keep a copy of the UPC Code with proof of purchase receipt for any future Warranty Service.

Please retain packaging and assembly instructions for future reference.

### CUSTOMER SERVICE

USA and Canada: [service@grow-n-up.com](mailto:service@grow-n-up.com)  
Toll free hotline: 1-888-GNU-9898  
Other countries: [support@grow-n-up.com](mailto:support@grow-n-up.com)  
[www.grow-n-up.com](http://www.grow-n-up.com)

©2008 Crayola.  
Grow'n up Ltd. Tsim Sha Tsui East.  
Kowloon, Hong Kong.  
All Rights Reserved.  
MADE IN CHINA.