



Fort Whorth, Texas 76140

ASSEMBLY INSTRUCTIONS

760 LOW LOFT BED



OPTIONAL COMPONENTS

3 DRAWERS CHEST
DESK
BOOKCASE

Thank you for purchasing this quality product. Be sure to check all packing material carefully for small parts which may have come loose inside the carton during shipment. Separate, identify and count all parts and hardware.

Compare with the parts list to be sure all parts are present.

"DO NOT TIGHTEN SCREWS UNTIL COMPLETELY ASSEMBLED"

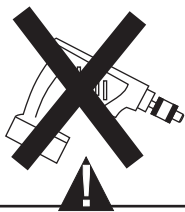

* Use of power tool to assemble this product will invalidate any claim and damage this product making unsafe !!!
* Please assemble on a clean soft surface to avoid damage.

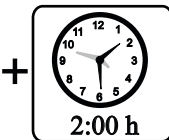

Tools Required

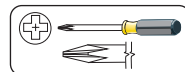

(Not includ)

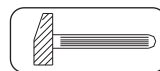

(Not includ)

IMPORTANT:

PLEASE READ INSTRUCTION BEFORE STARTING THE ASSEMBLY

Part List - 760 LOW LOFT BED

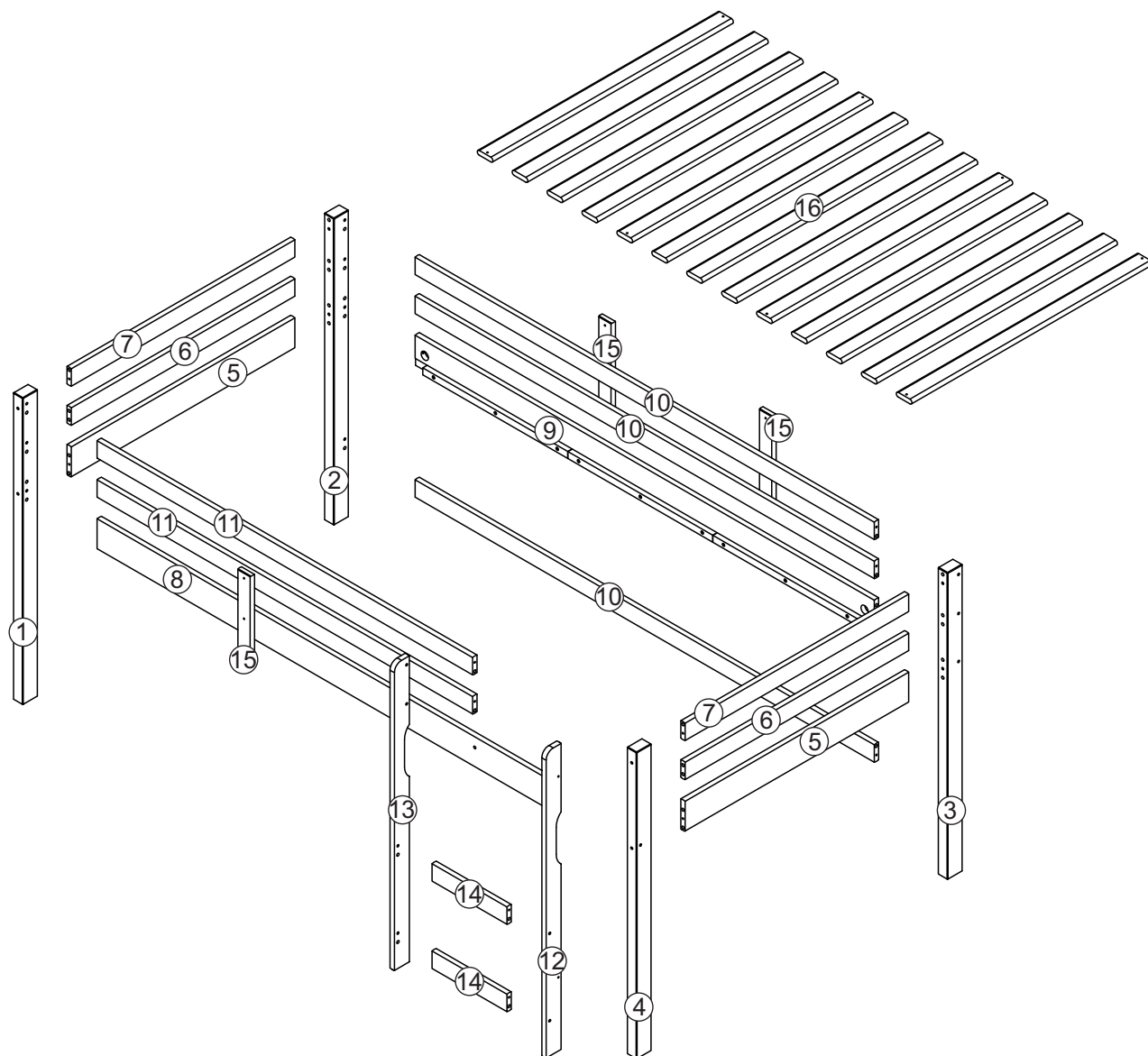

Identifying the Hardware-Identify the hardware using the illustrations below.

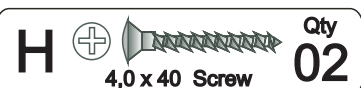
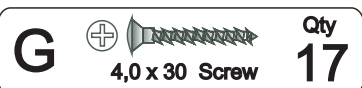
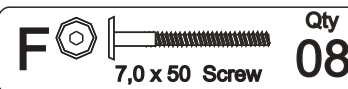
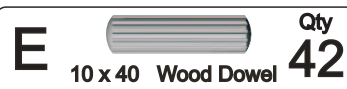
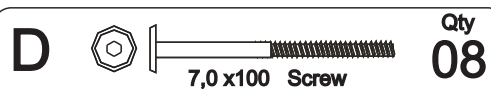
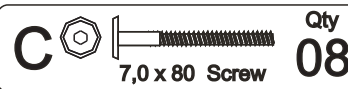
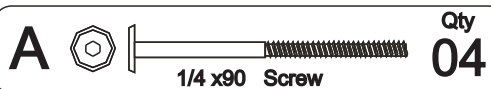

01

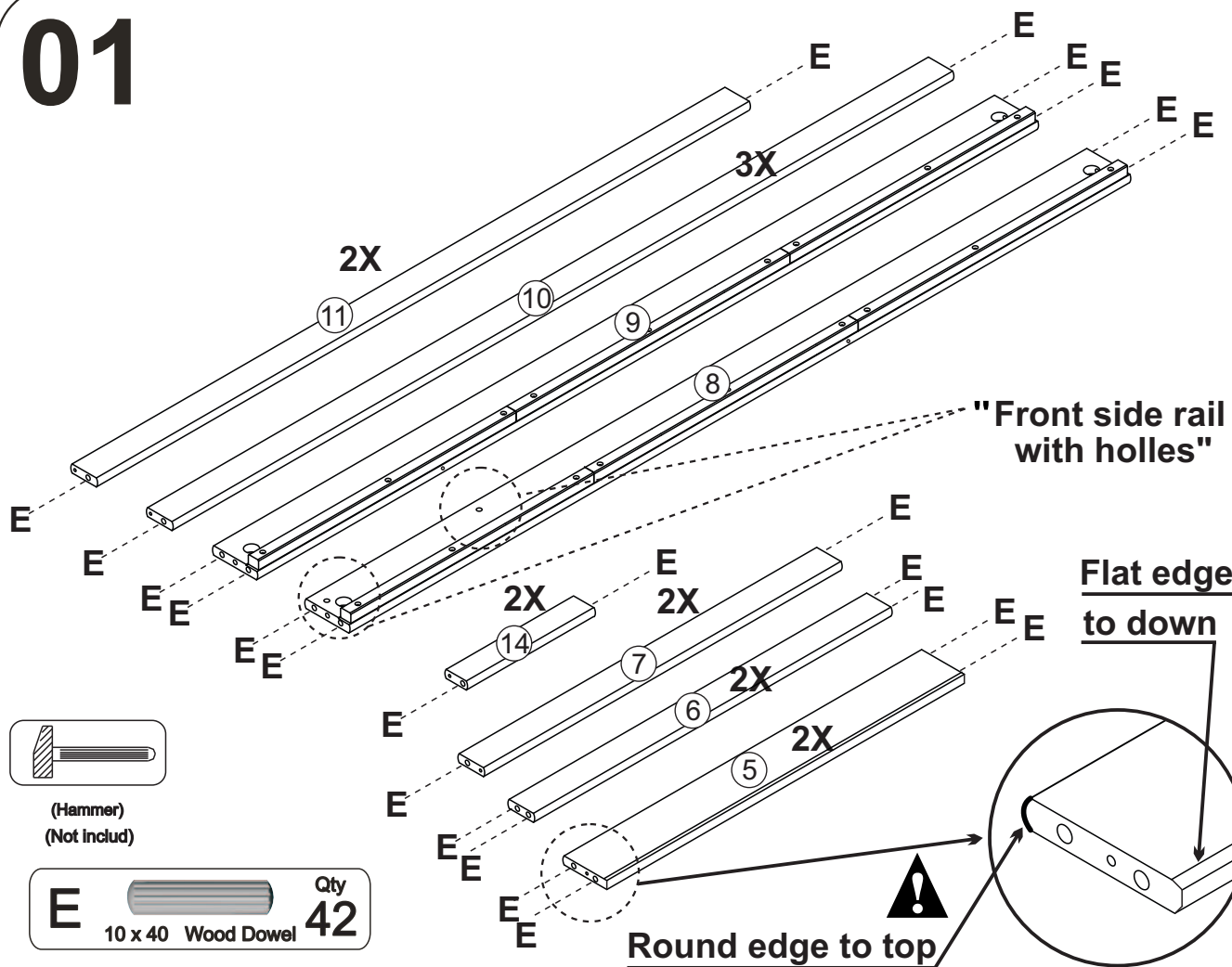

02

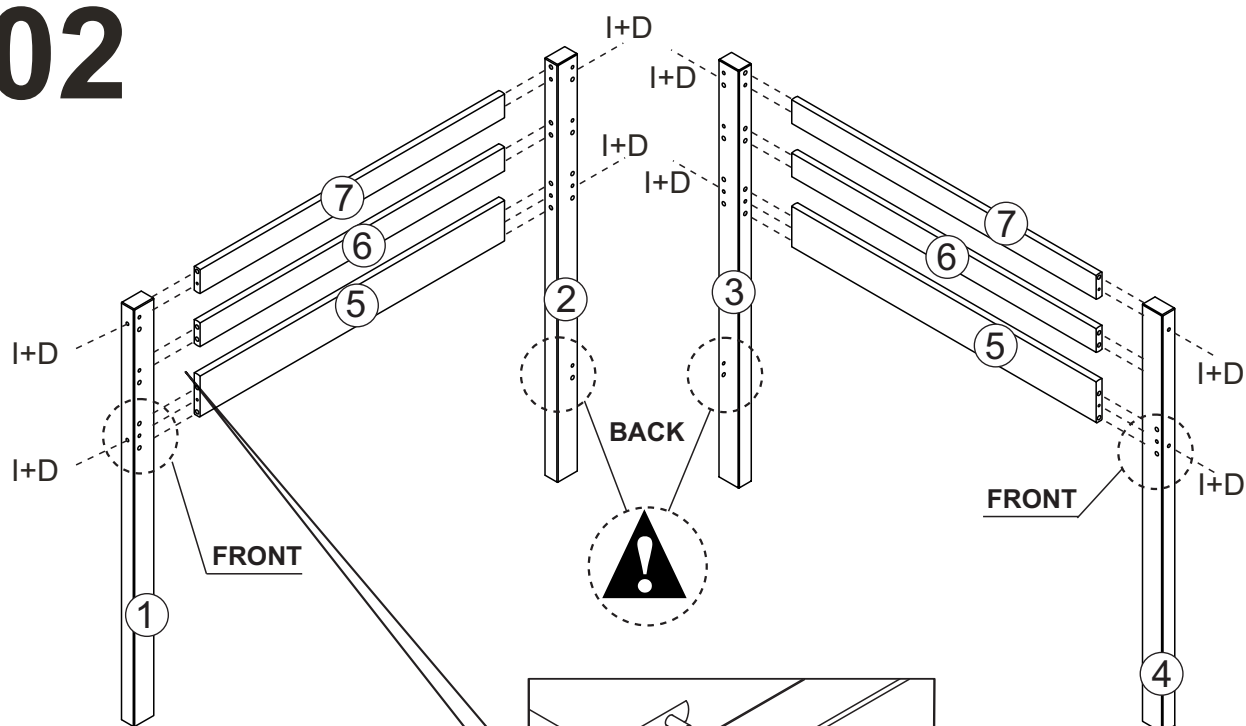

D



7,0 x 100 Screw

Qty
08

I



Hex Screwdriver

Qty
01

03



FRONT

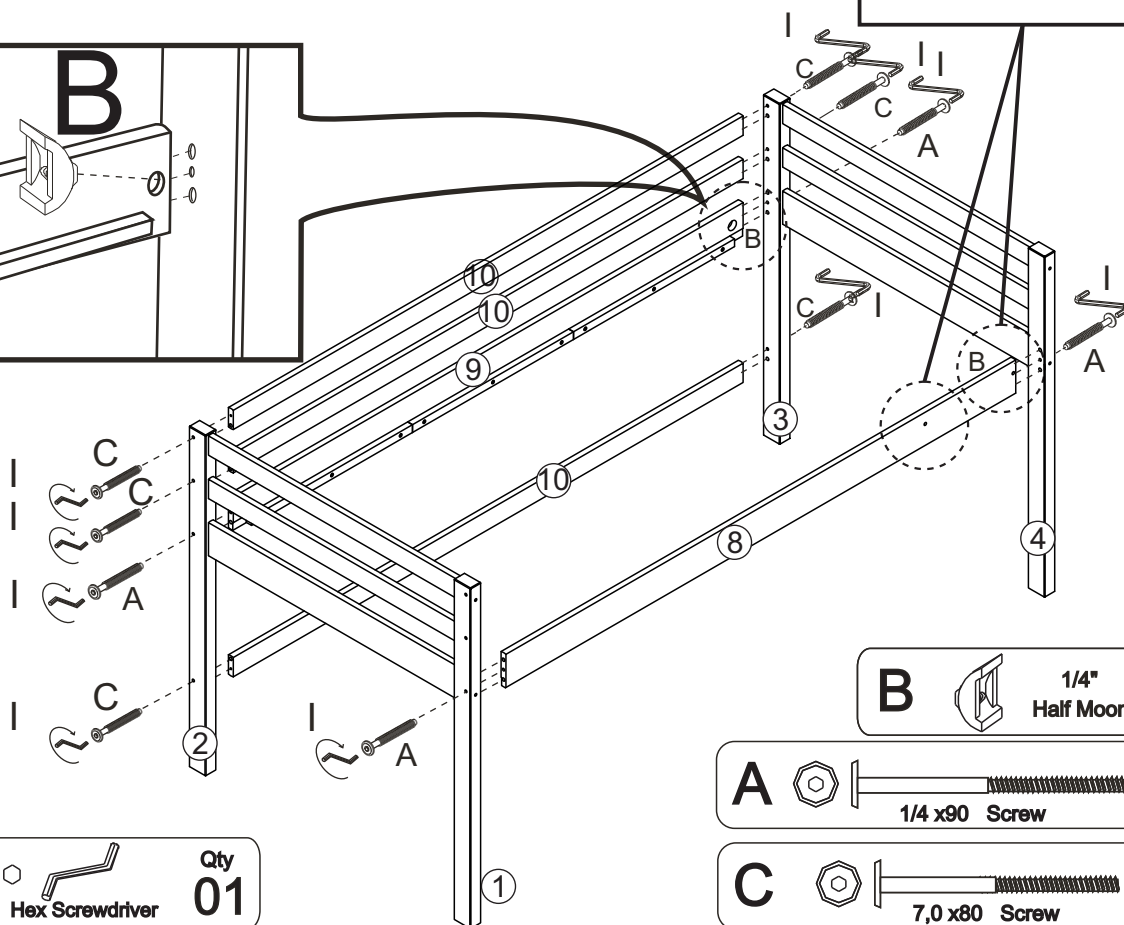
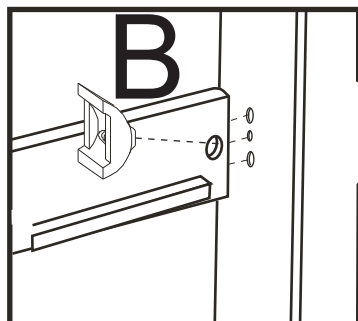

B



1/4"
Half Moon

Qty

04

A



1/4 x 90 Screw

Qty

04

C



7,0 x 80 Screw

Qty

06

I

Hex Screwdriver

Qty
01

04

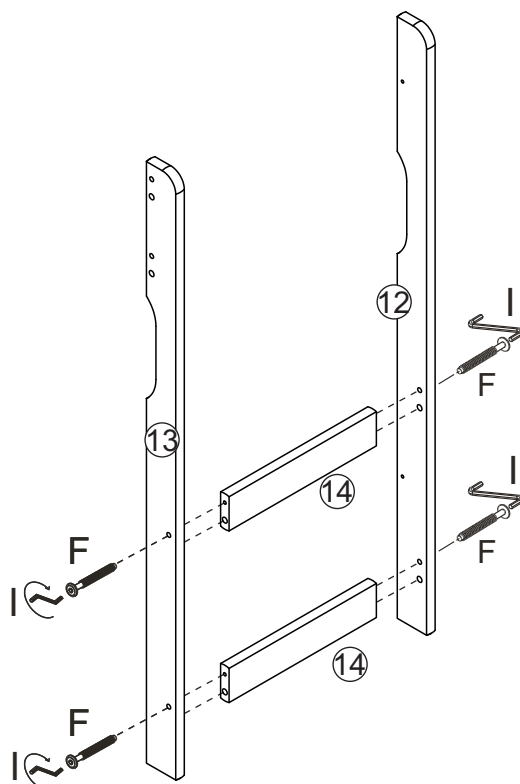

F



7,0 x 50 Screw

Qty

04

I





Hex Screwdriver

Qty

01

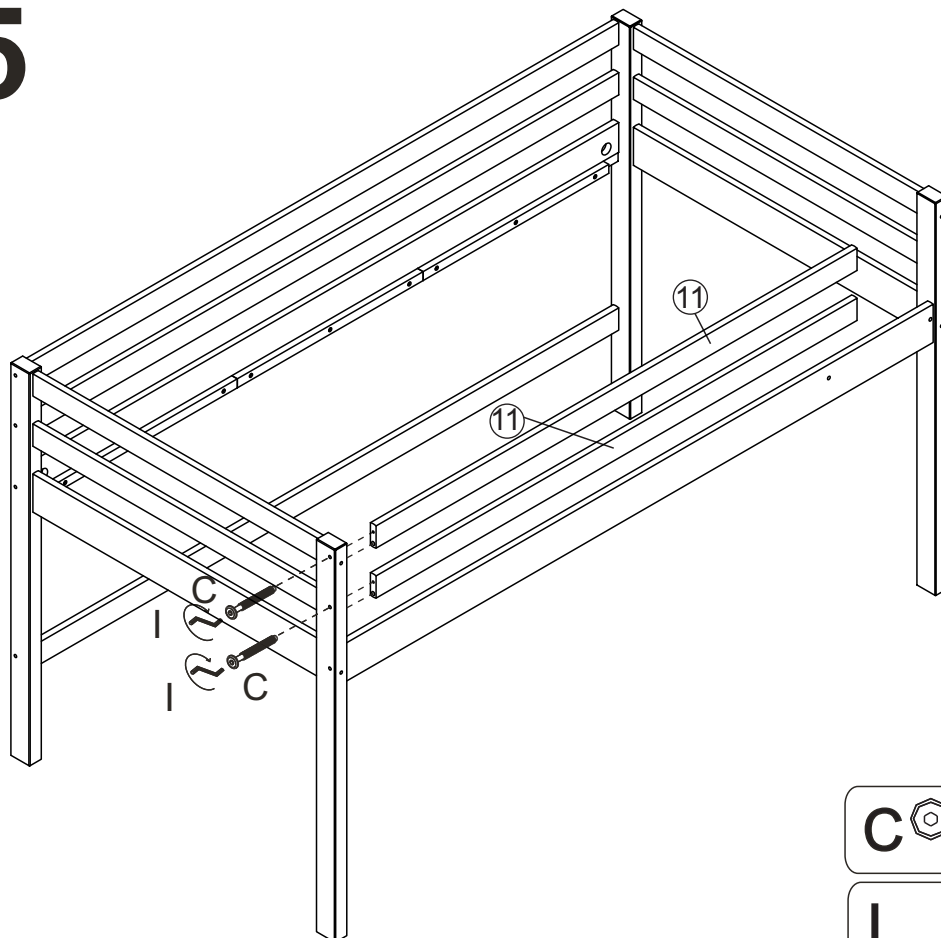
05



C  **7,0 x 80 Screw** Qty **02**

I  **Hex Screwdriver** Qty **01**

06

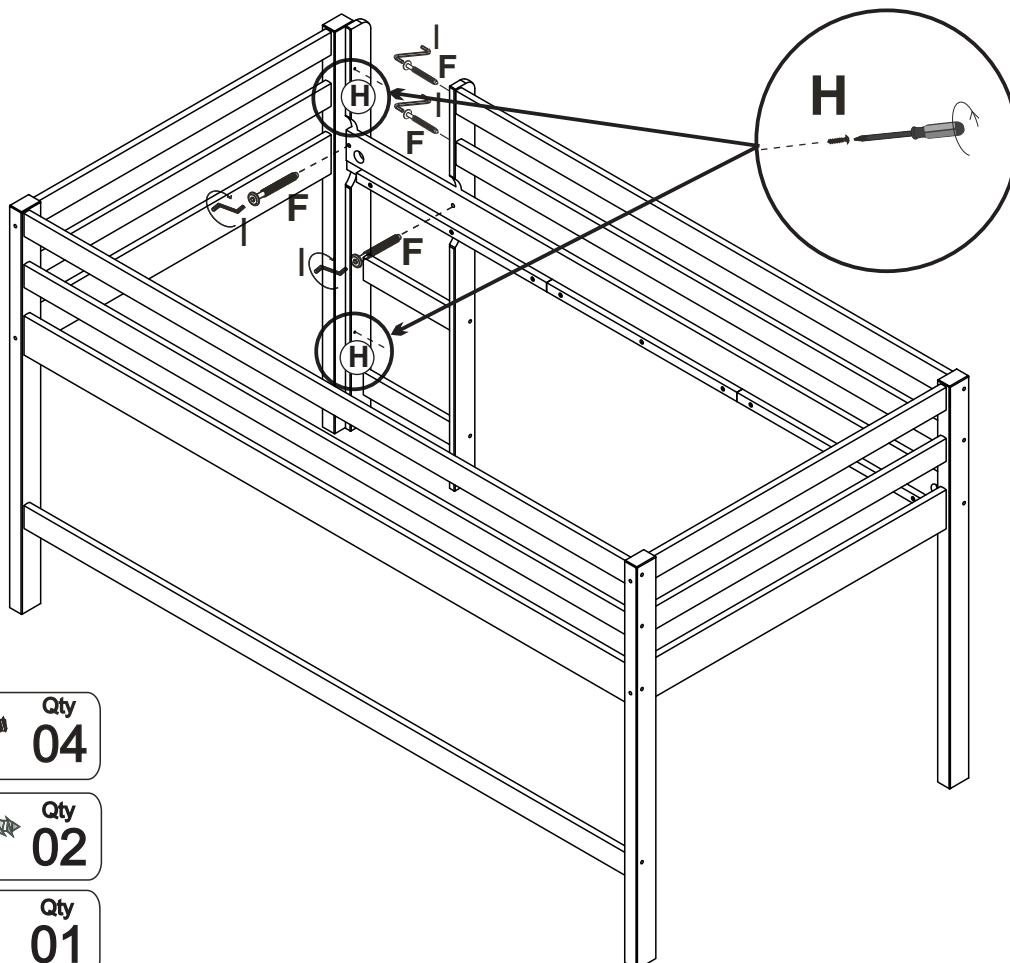

F  **7,0 x 50 Screw** Qty **04**

H  **4,0 x 40 Screw** Qty **02**

I  **Hex Screwdriver** Qty **01**

07

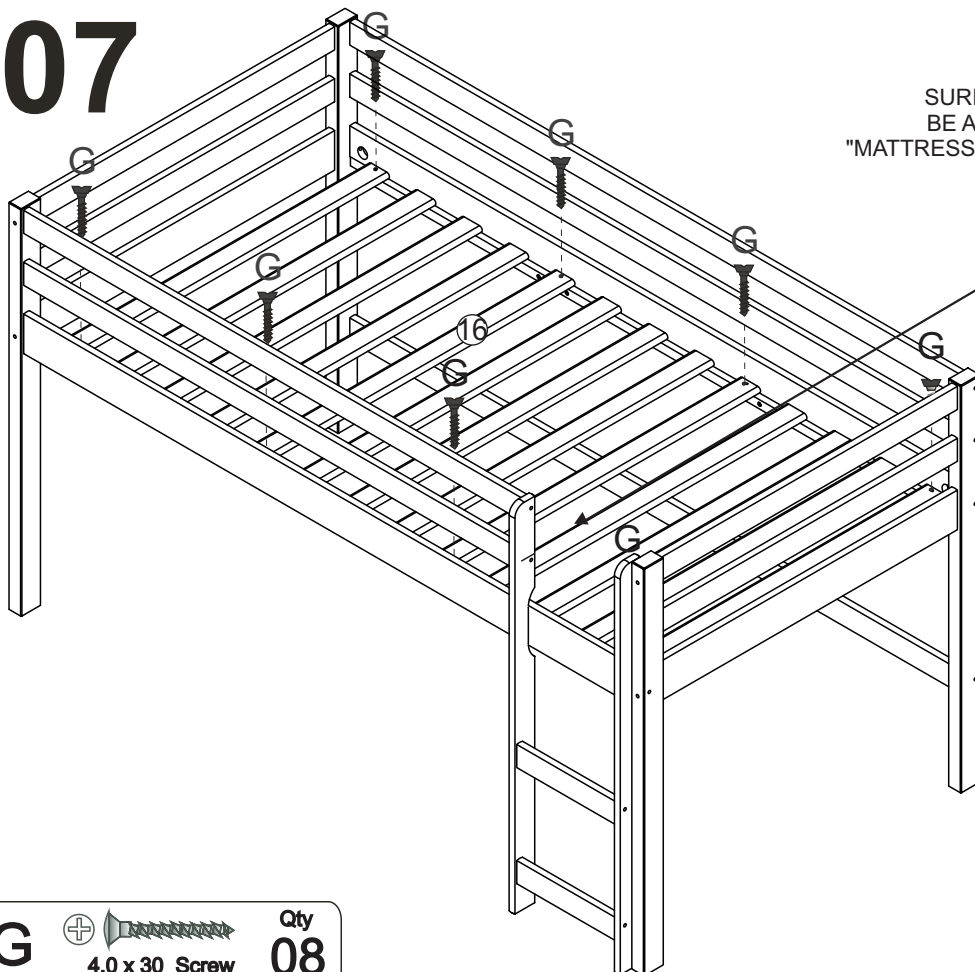

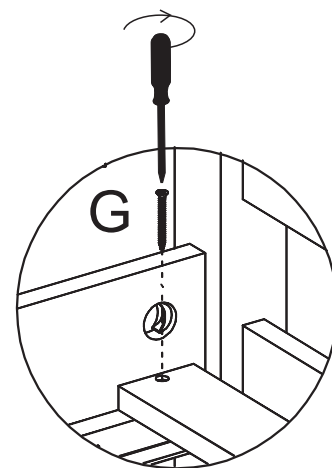

WARNING
THE MATTRESS
SURFACE MUST NOT
BE ABOVE THIS LINE
"MATTRESS 8" HIGH LIMITED"

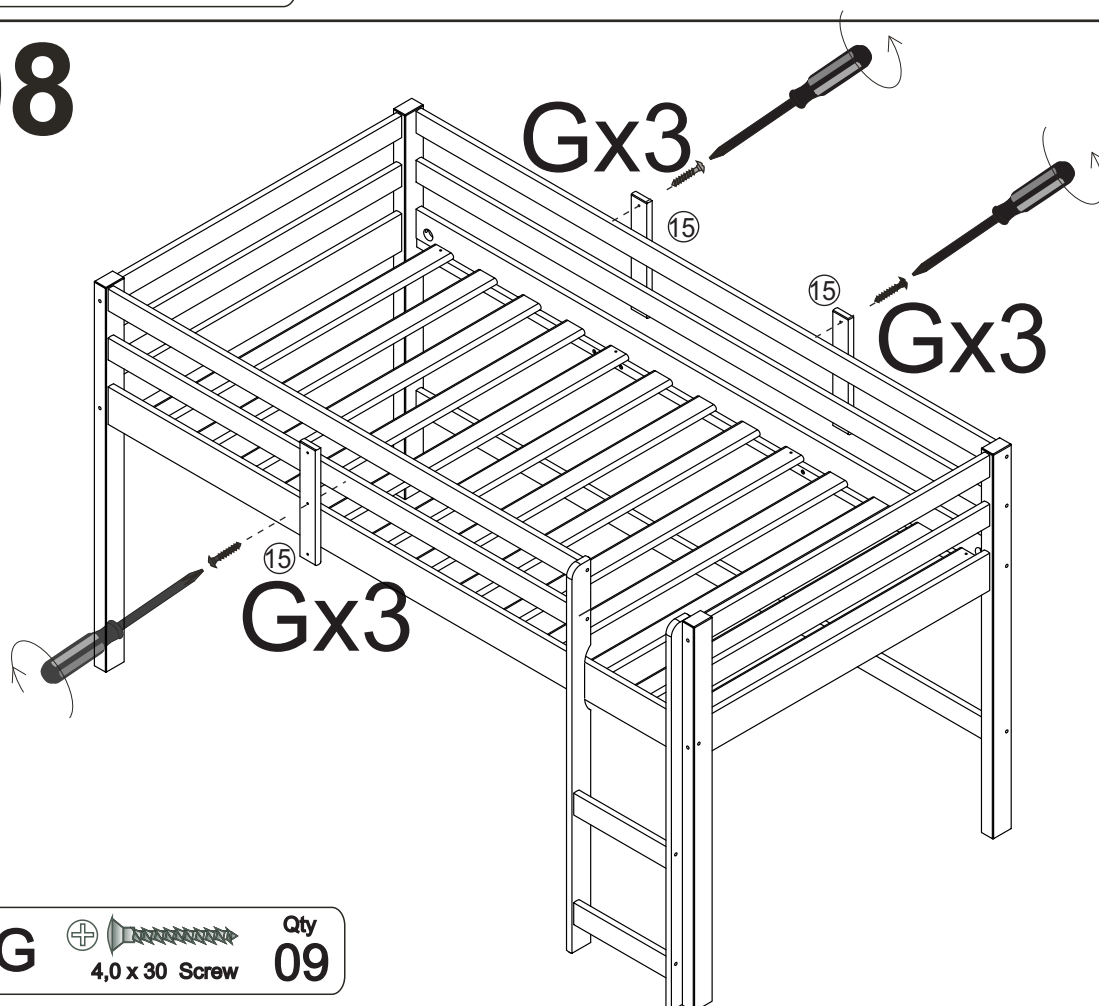

G  **4,0 x 30 Screw** Qty **08**

08



G  **4,0 x 30 Screw** Qty **09**

OPTION COMPONENTS

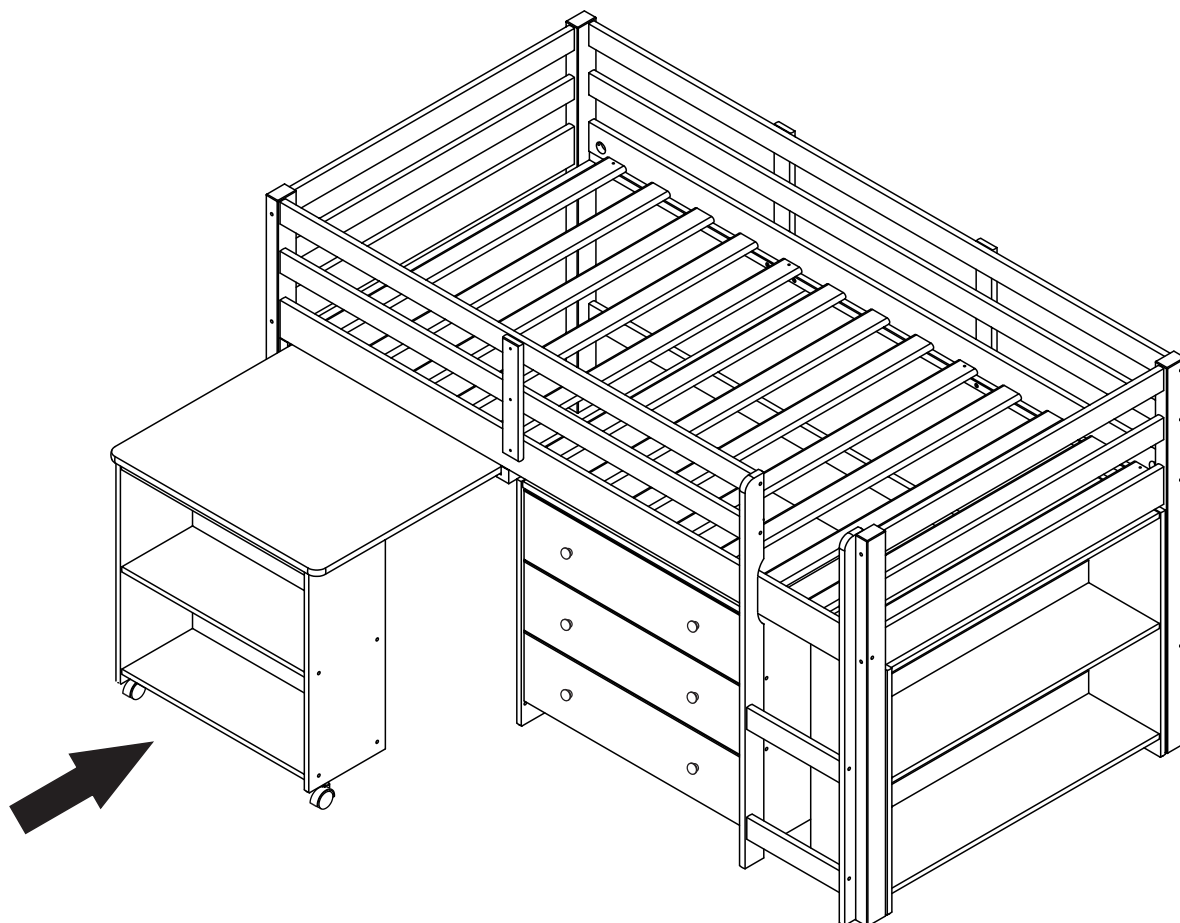
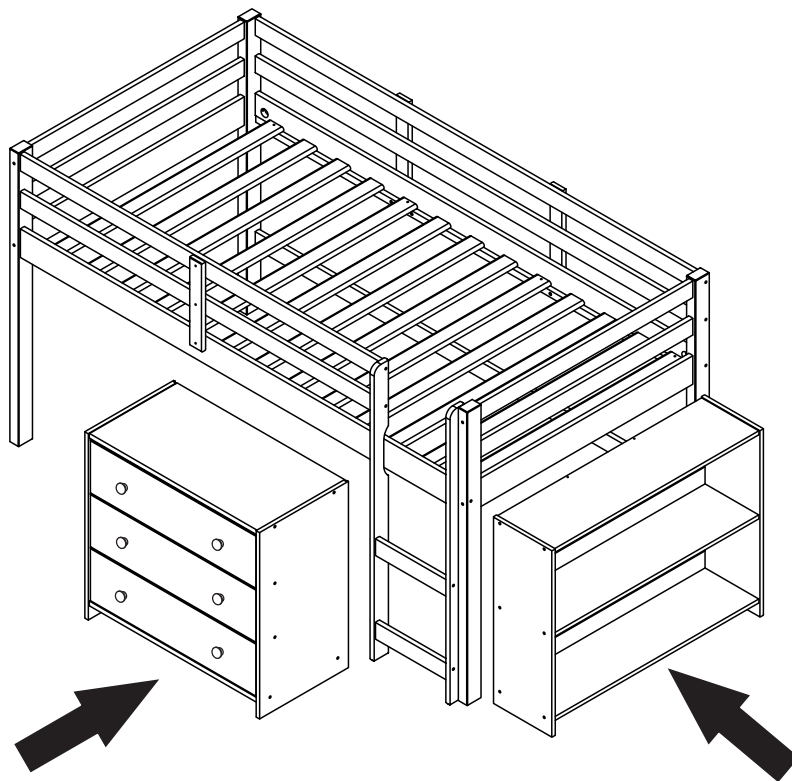

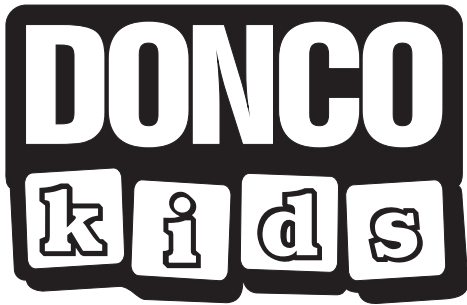

Fort Worth, Texas 76140

ASSEMBLY INSTRUCTIONS

760 BOOKCASE

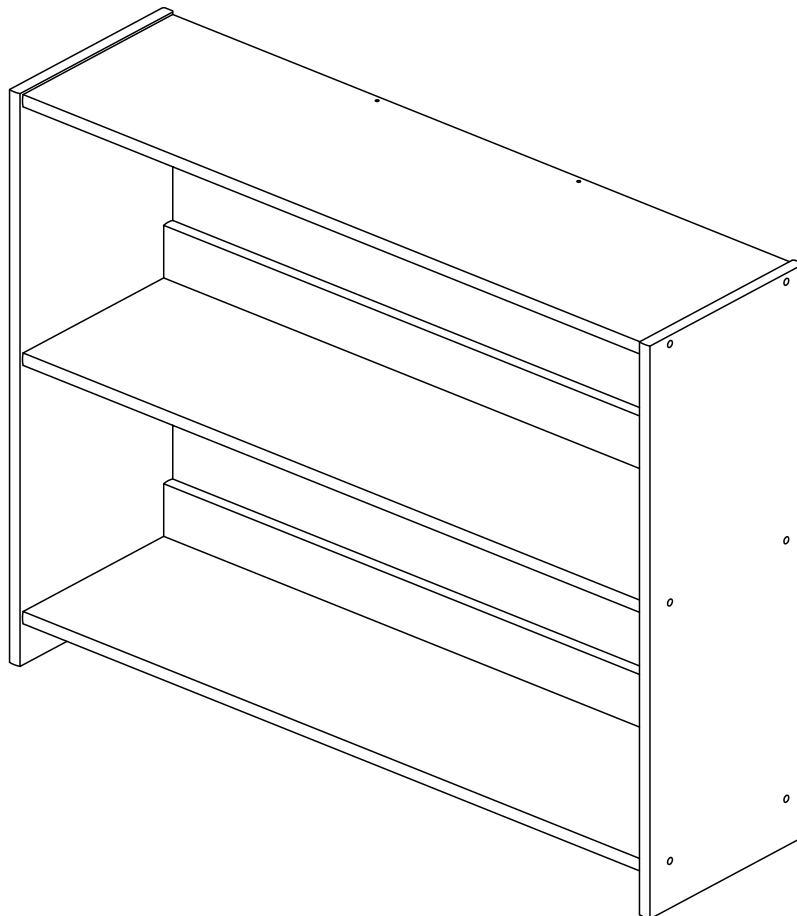

Thank you for purchasing this quality product. Be sure to check all packing material carefully for small parts which may have come loose inside the carton during shipment. Separate, identify and count all parts and hardware.

Compare with the parts list to be sure all parts are present.

"DO NOT TIGHTEN SCREWS UNTIL COMPLETELY ASSEMBLED"

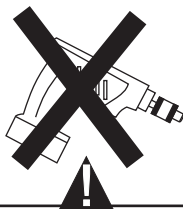

* Use of power tool to assemble this product will invalidate any claim and damage this product making unsafe !!!
* Please assemble on a clean soft surface to avoid damage.

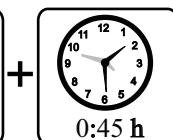
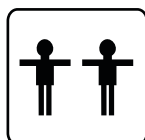

Tools Required

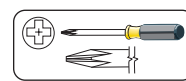

(Not include)

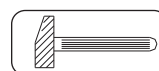

(Not include)

IMPORTANT:

PLEASE READ INSTRUCTION BEFORE STARTING THE ASSEMBLY

Part List - 760 Bookcase

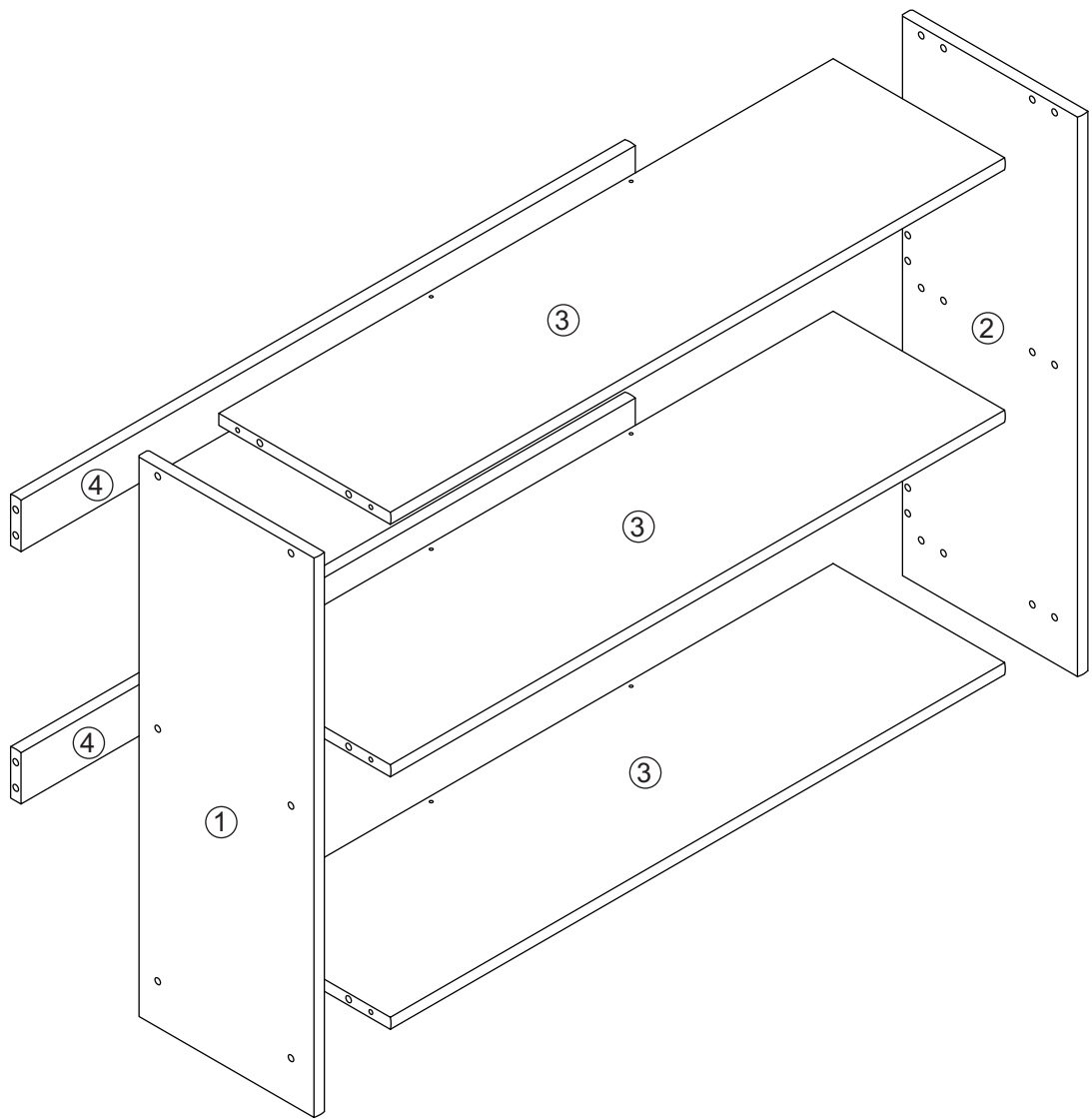

Identifying the Hardware-Identify the hardware using the illustrations below.

A



7,0 x 50 Screw

Qty
12

D



Hex Screwdriver

Qty
01

B



8 x 30 Wood Dowel

Qty
20

C



4,0 x 30 Screw

Qty
04

01

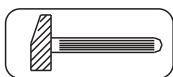
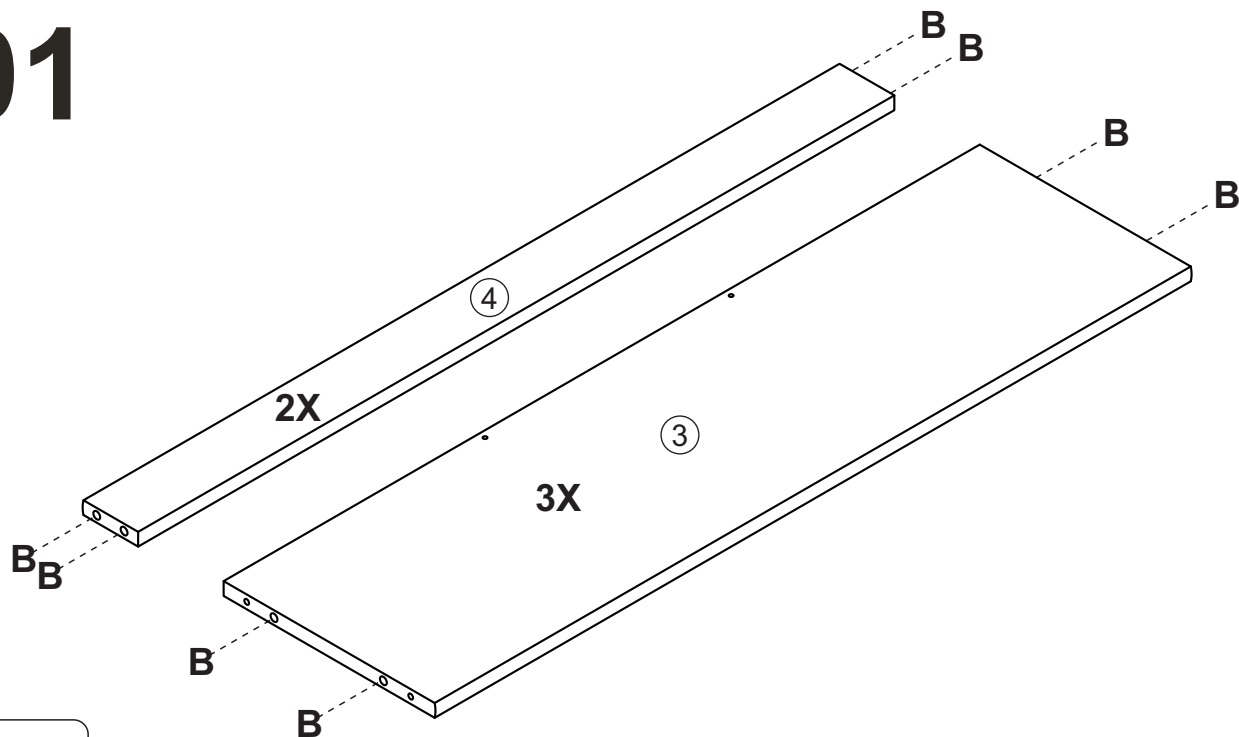

(Hammer)
(Not include)



02



space (-)

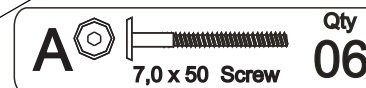
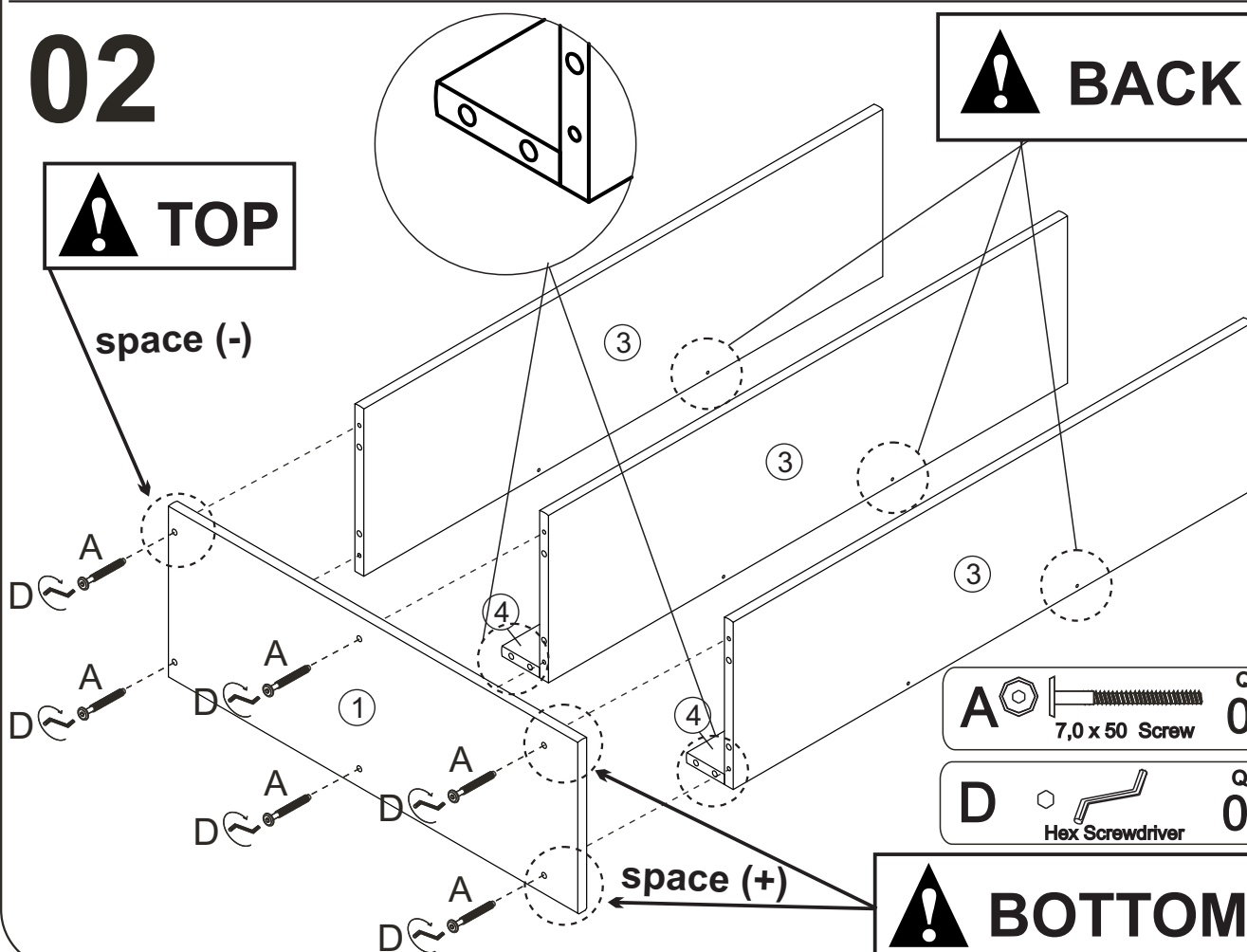

03

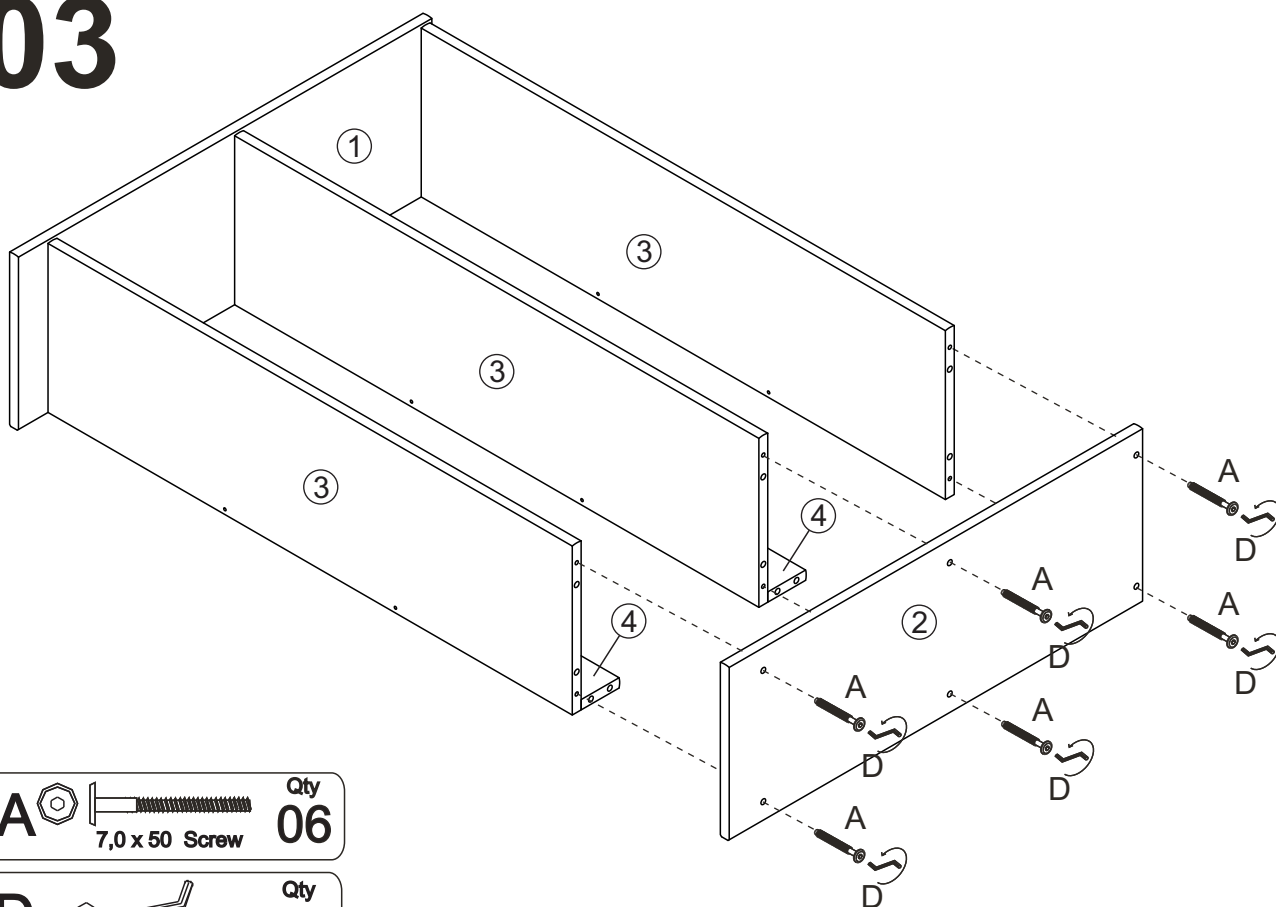

A  7,0 x 50 Screw Qty **06**

D  Hex Screwdriver Qty **01**

04

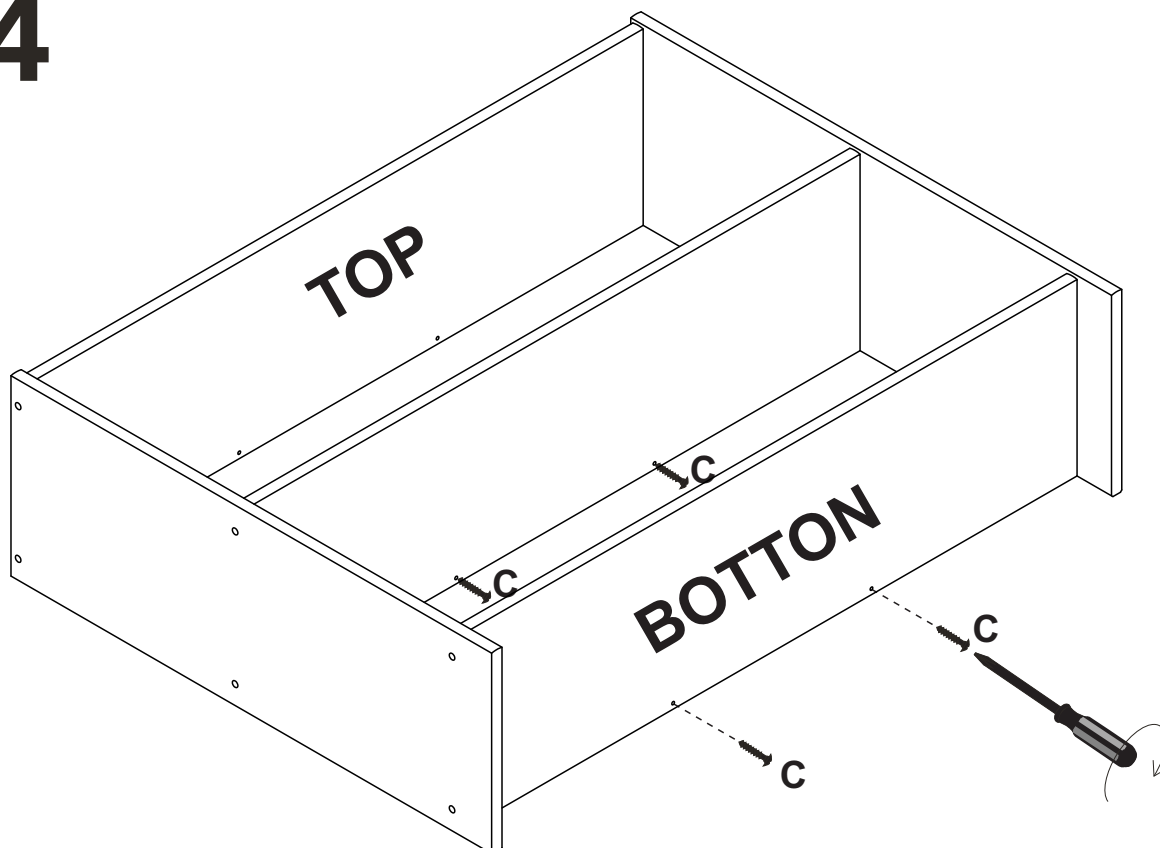

C  4,0 x 30 Screw Qty **04**



Fort Whorth, Texas 76140

ASSEMBLY INSTRUCTIONS

760 DESK

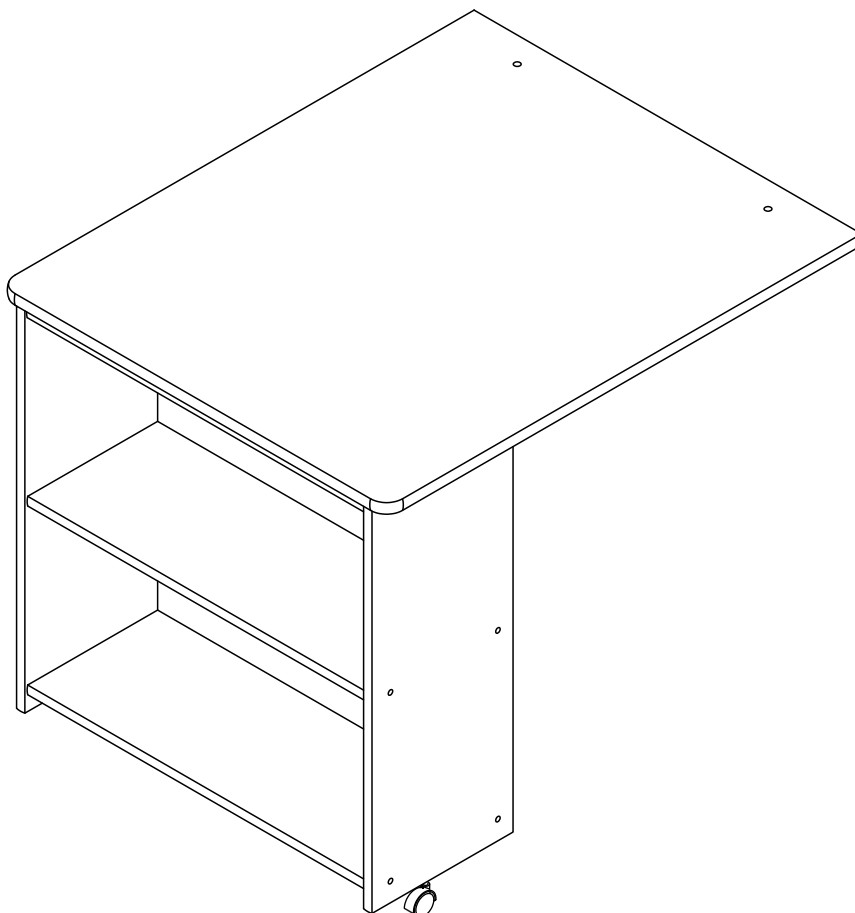

Thank you for purchasing this quality product. Be sure to check all packing material carefully for small parts which may have come loose inside the carton during shipment. Separate, identify and count all parts and hardware.

Compare with the parts list to be sure all parts are present.

"DO NOT TIGHTEN SCREWS UNTIL COMPLETELY ASSEMBLED"

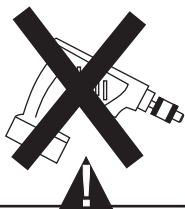

* Use of power tool to assemble this product will invalidate any claim and damage this product making unsafe !!!
* Please assemble on a clean soft surface to avoid damage.

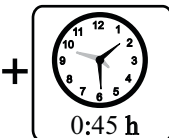
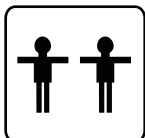

Tools Required

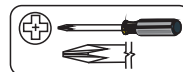

(Not Includ)

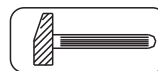

(Not Includ)

IMPORTANT:

PLEASE READ INSTRUCTION BEFORE STARTING THE ASSEMBLY

Part List - 760 DESK

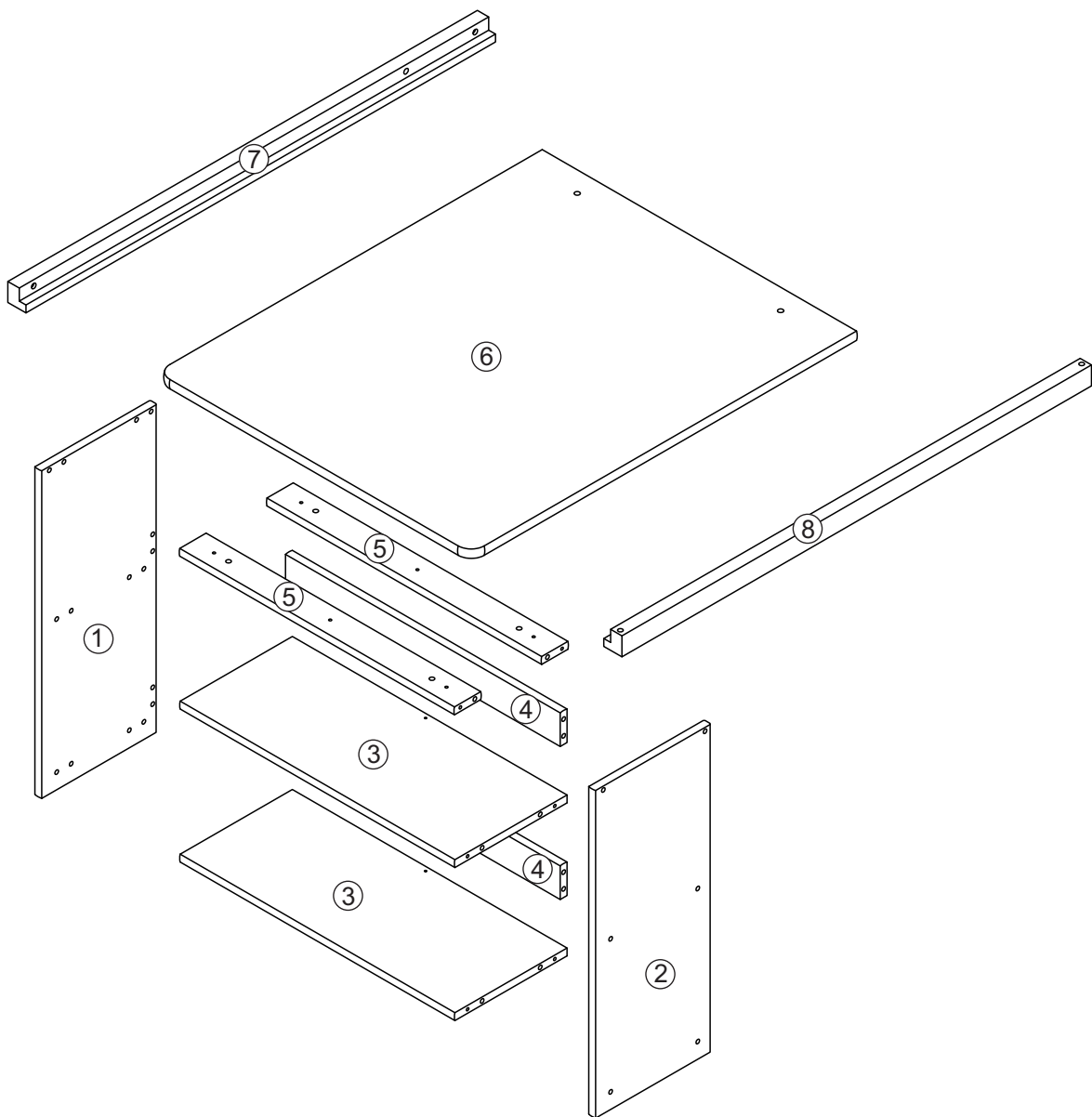

Identifying the Hardware-Identify the hardware using the illustrations below.

A  Qty **02**
7,0 x 80 Screw

B  Qty **12**
7,0 x 50 Screw

C  Qty **22**
8 x 30 Wood Dowel

D  Qty **02**
4,0 x 40 Screw

E  Qty **08**
4,0 x 30 Screw

F  Qty **06**
3,5 x 16 Screw

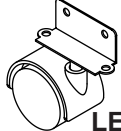
G  Qty **01**
LEFT

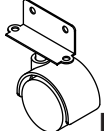
H  Qty **01**
RIGHT

I  Qty **01**
Hex Screwdriver

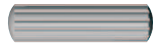
J  Qty **04**
10 x 40 Wood Dowel

01

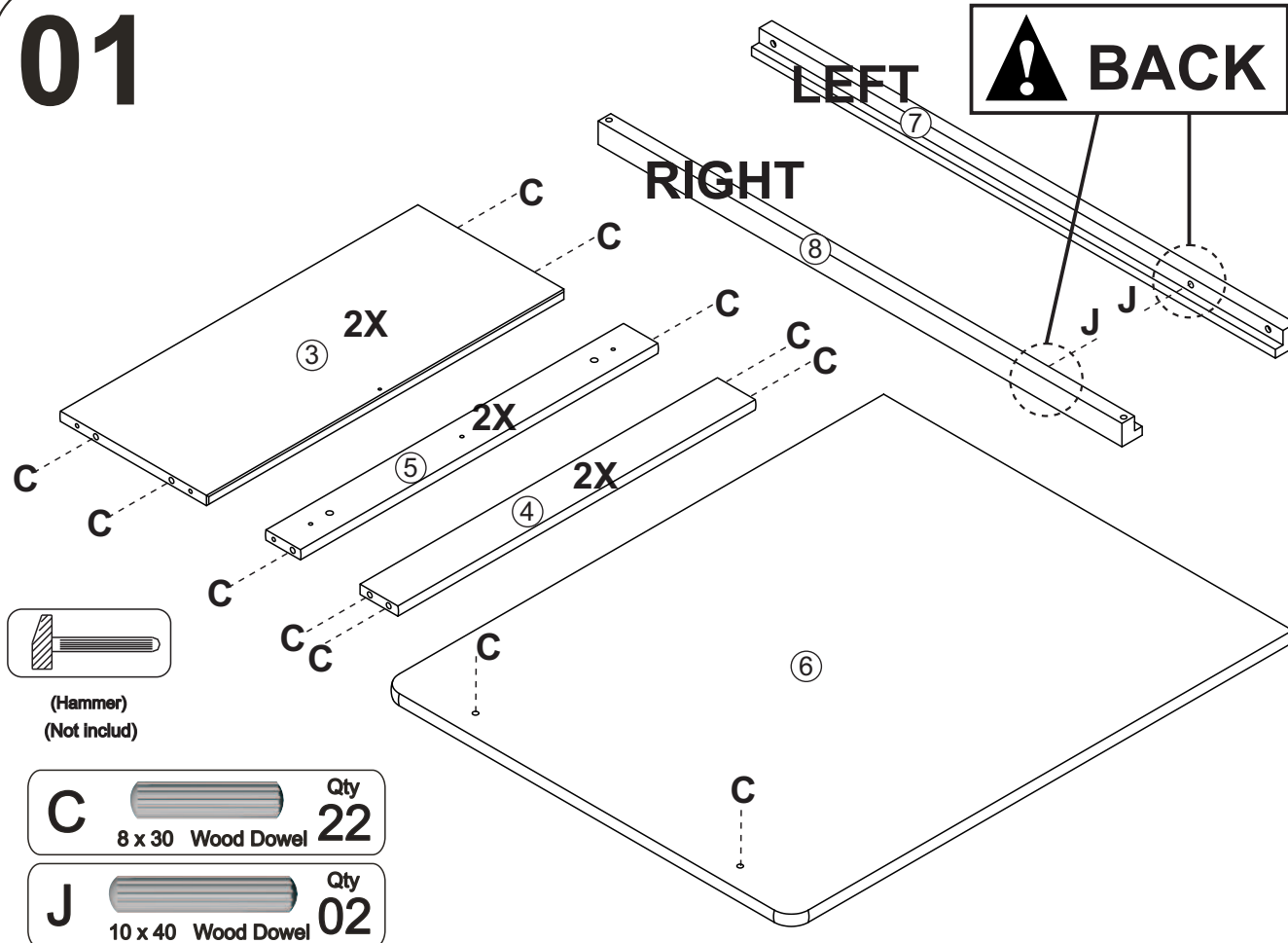

02

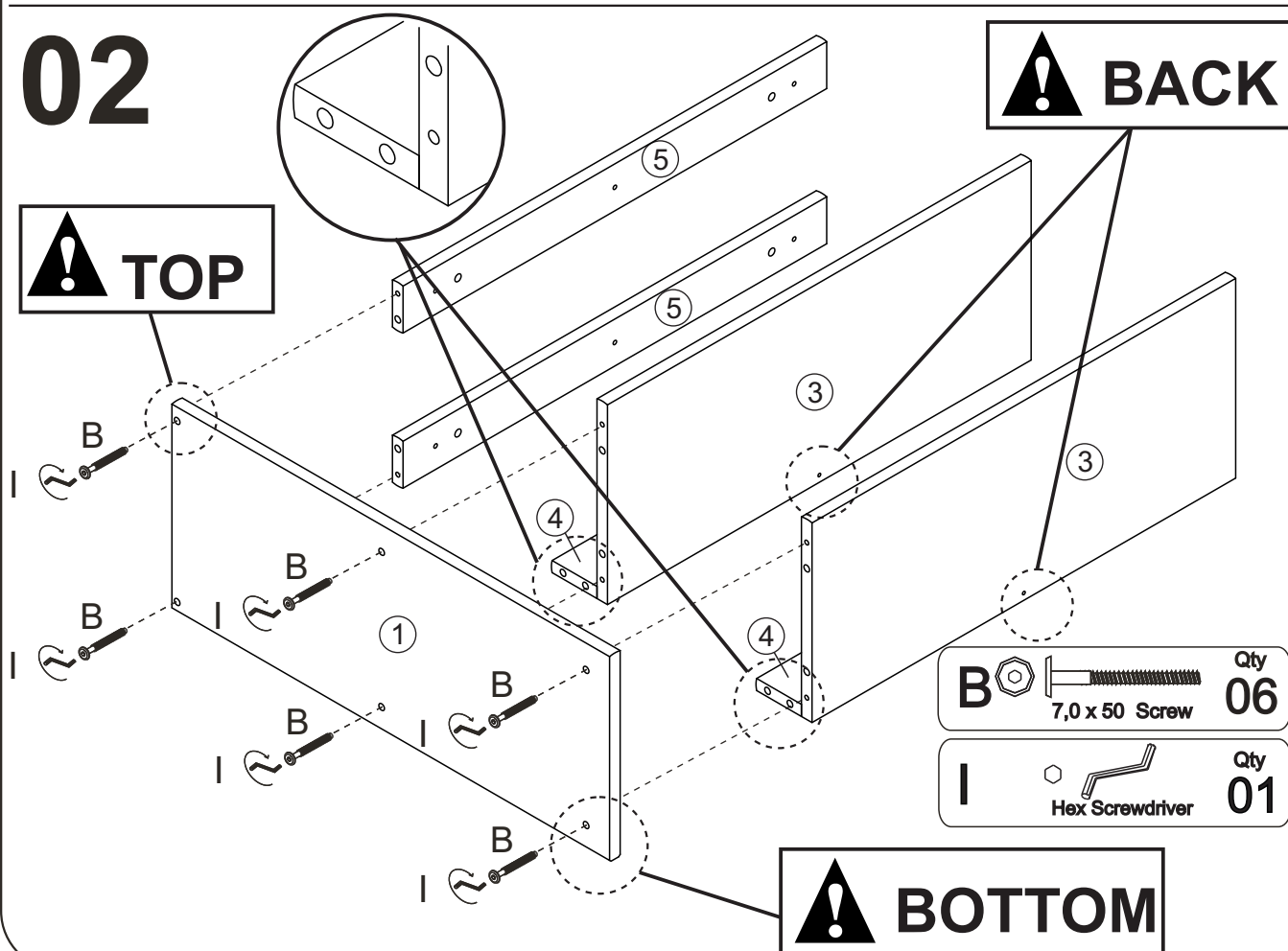

03

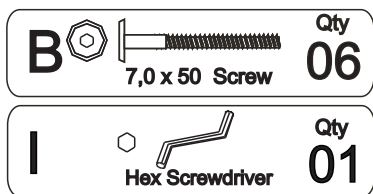
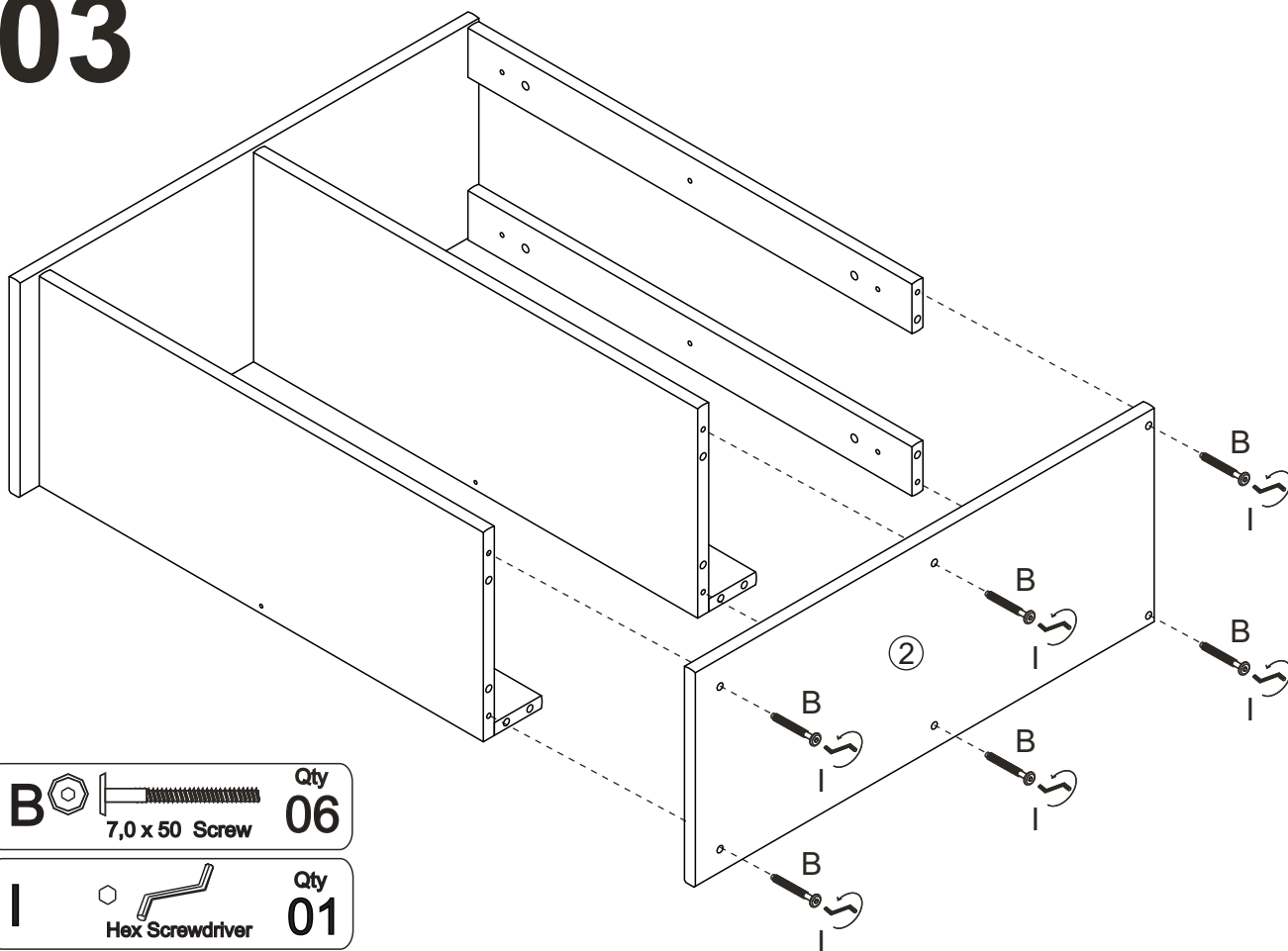

04

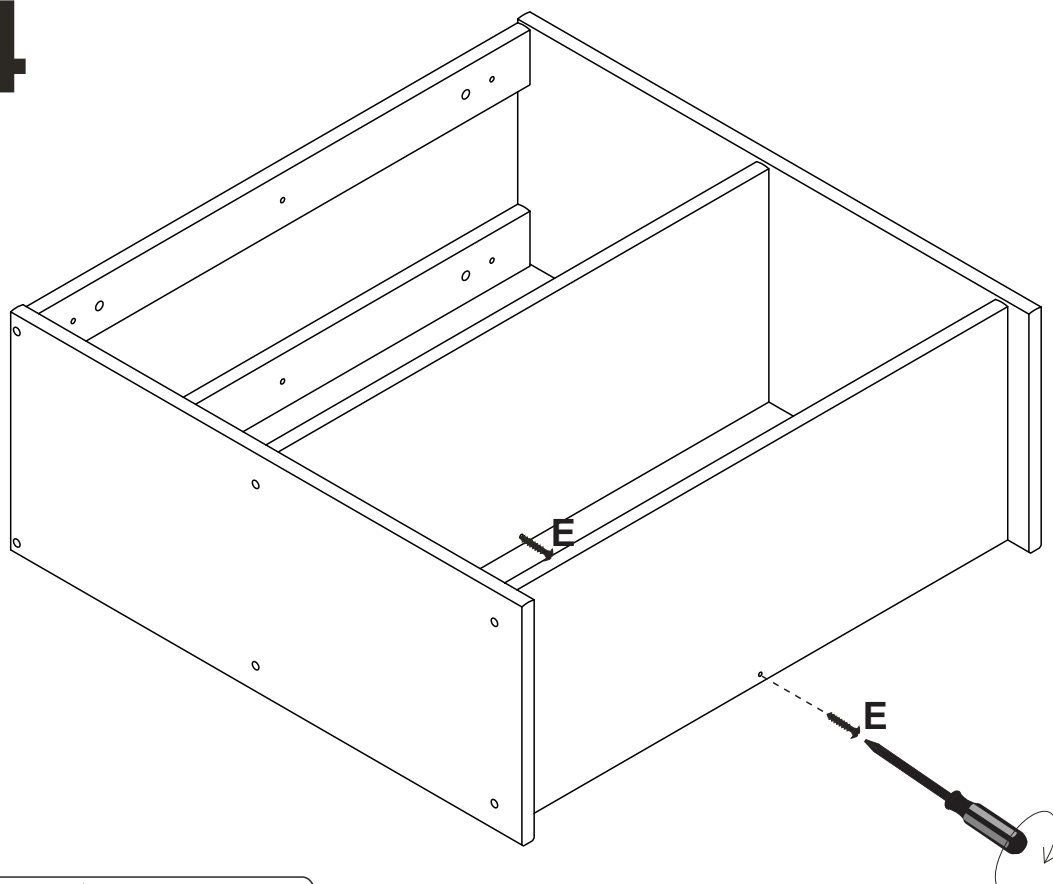

05

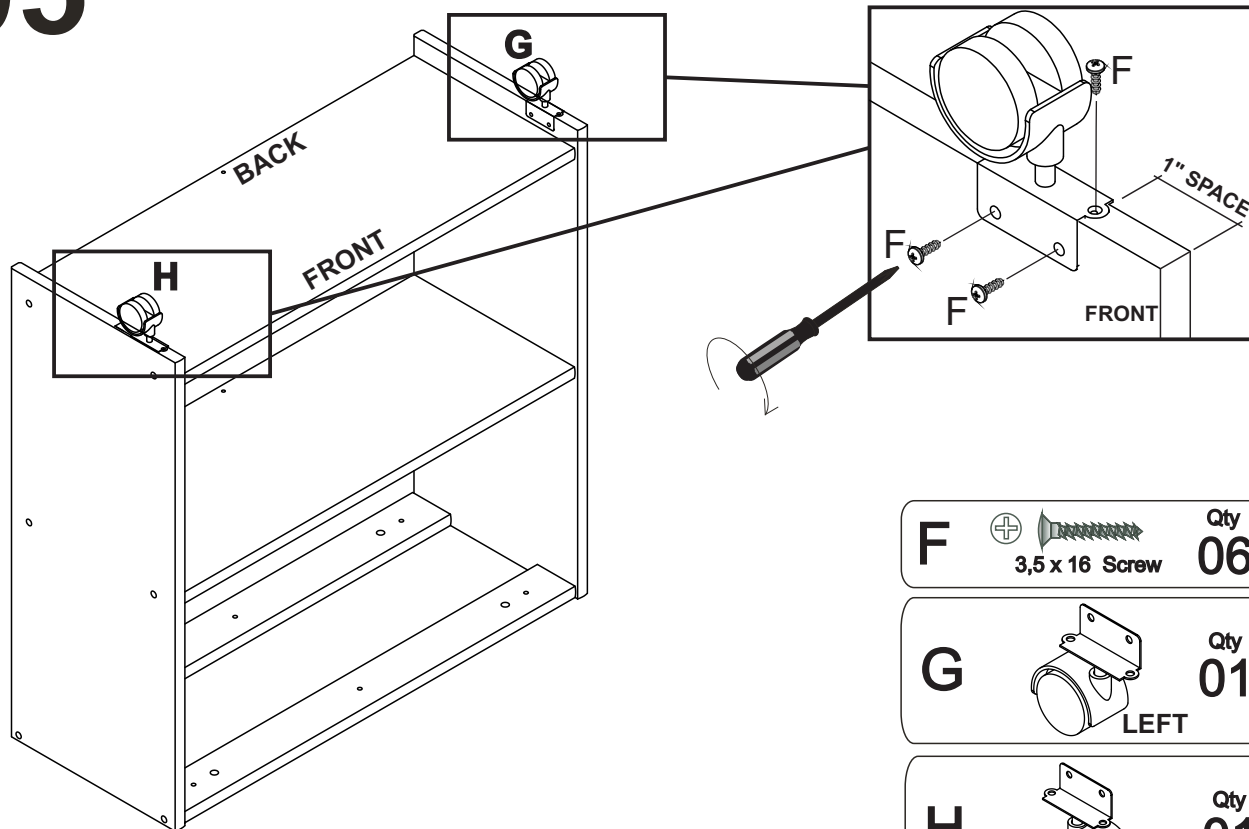

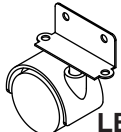

F  **3,5 x 16 Screw** Qty **06**

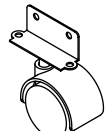
G  **LEFT** Qty **01**

H  **RIGHT** Qty **01**

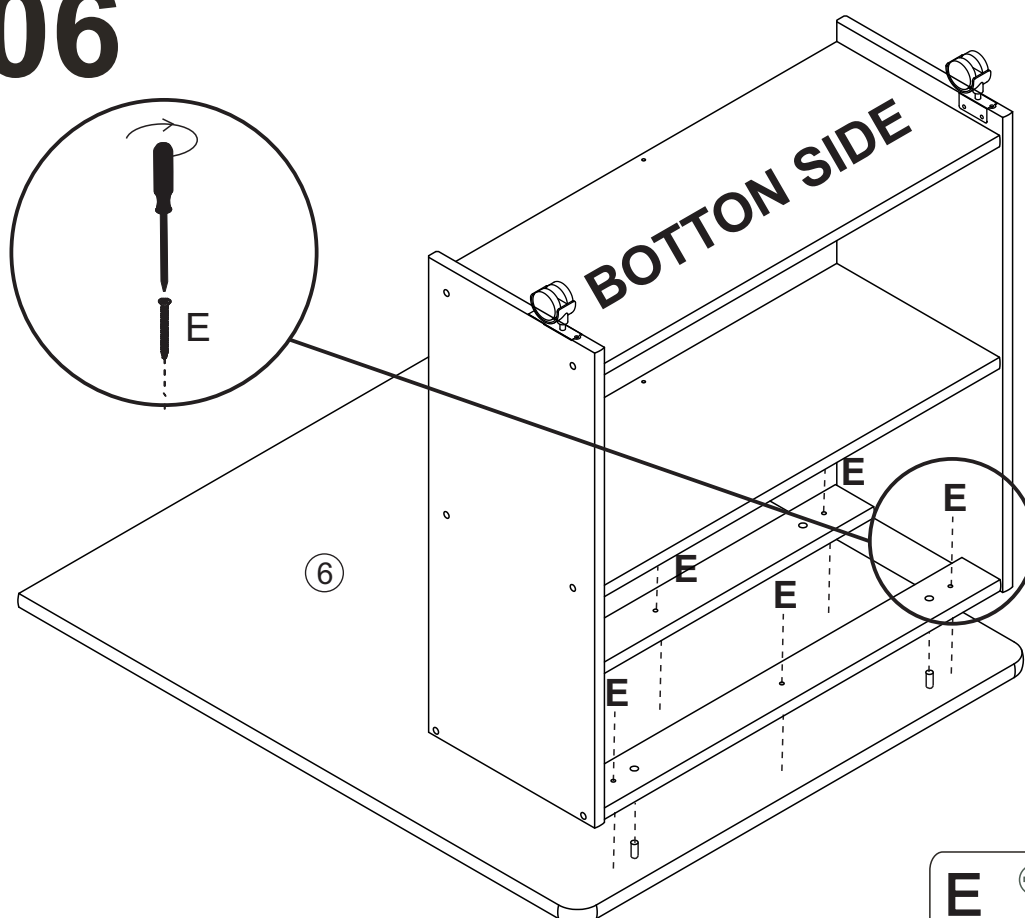
06



E  **4,0 x 30 Screw** Qty **06**

07

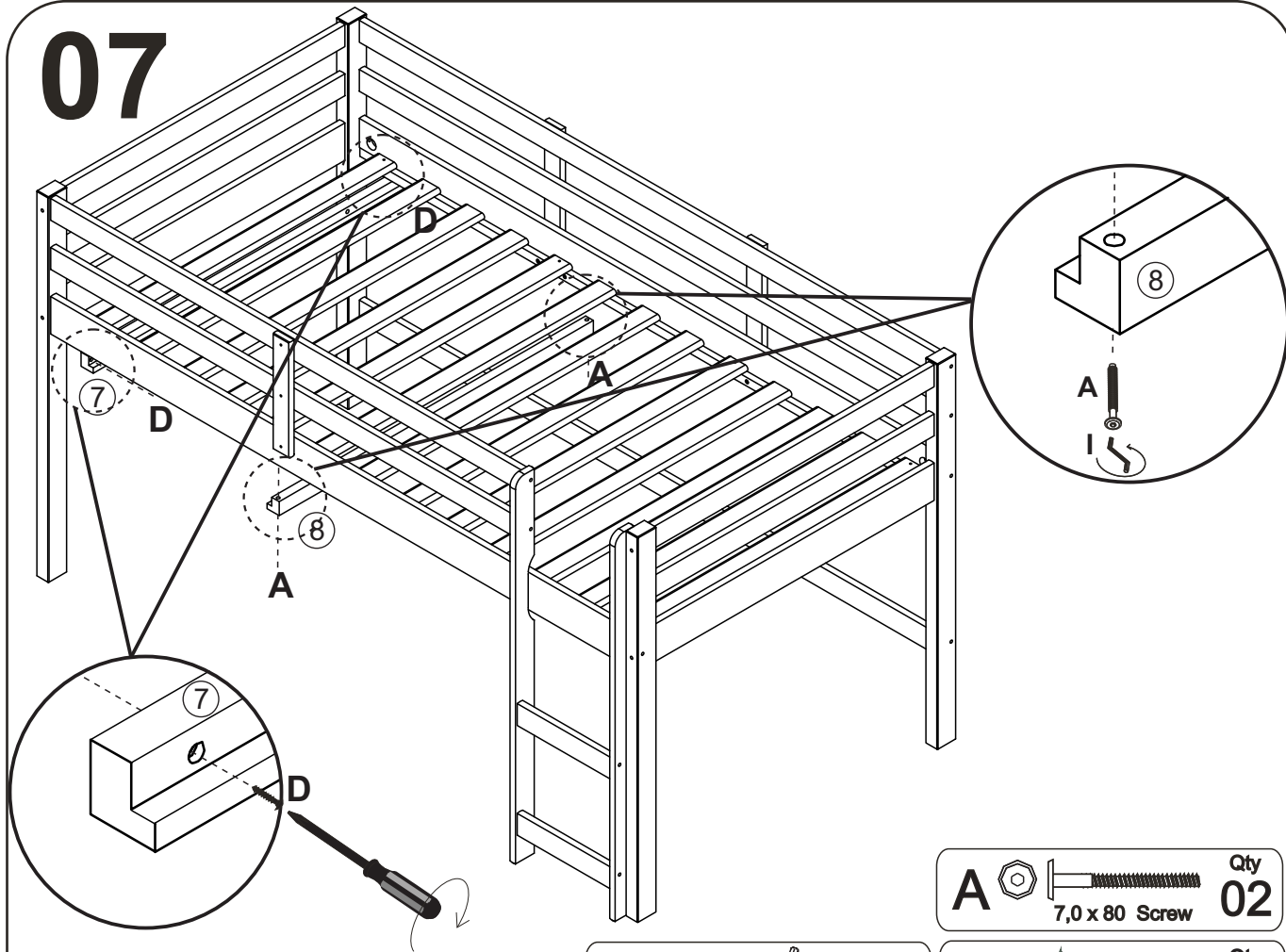

A  **7,0 x 80 Screw** Qty **02**

I  **Hex Screwdriver** Qty **01**

D  **4,0 x 40 Screw** Qty **02**

08

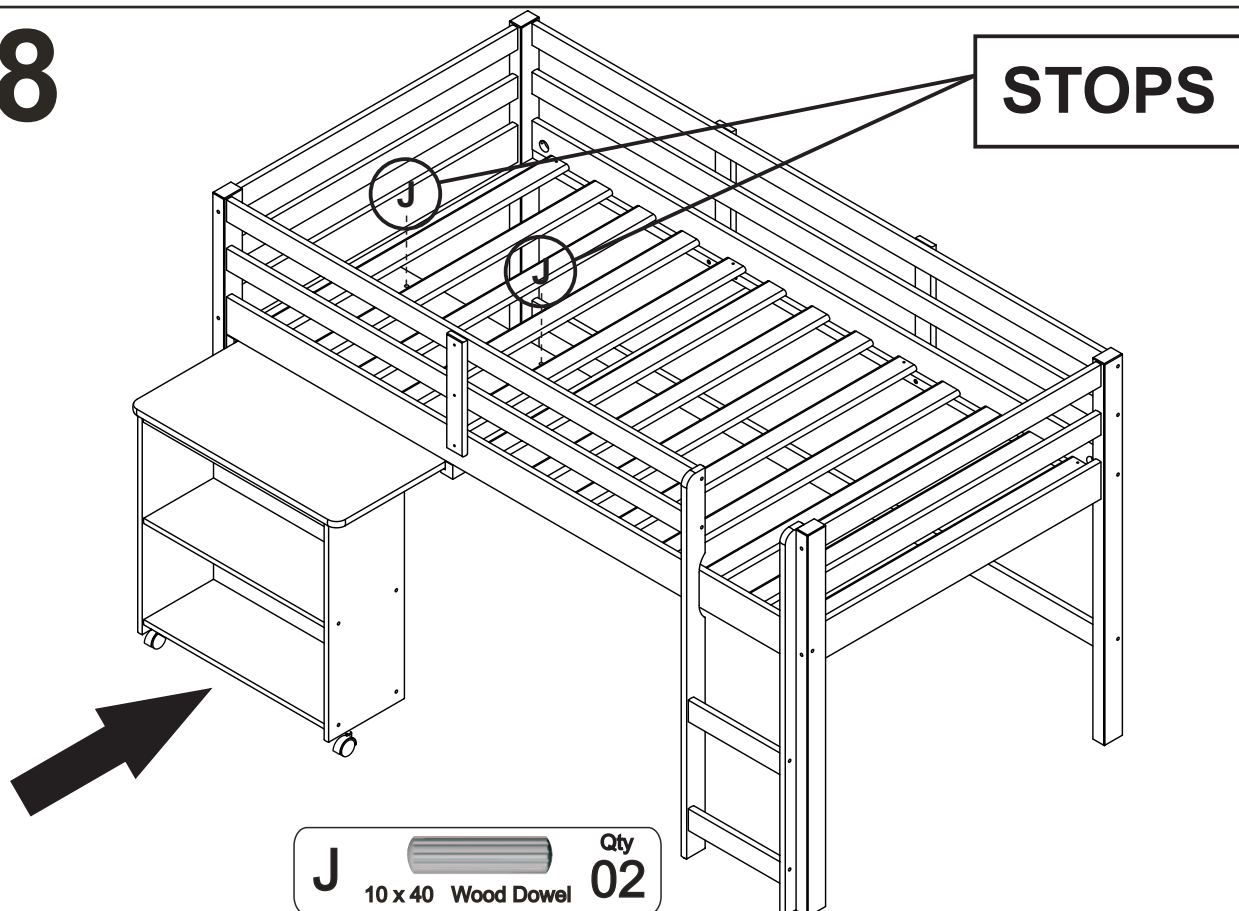

J  **10 x 40 Wood Dowel** Qty **02**

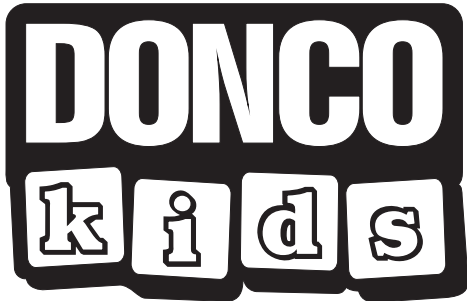

Fort Whorth, Texas 76140

ASSEMBLY INSTRUCTIONS

760 3 DRAWERS CHEST WOOD KNOB

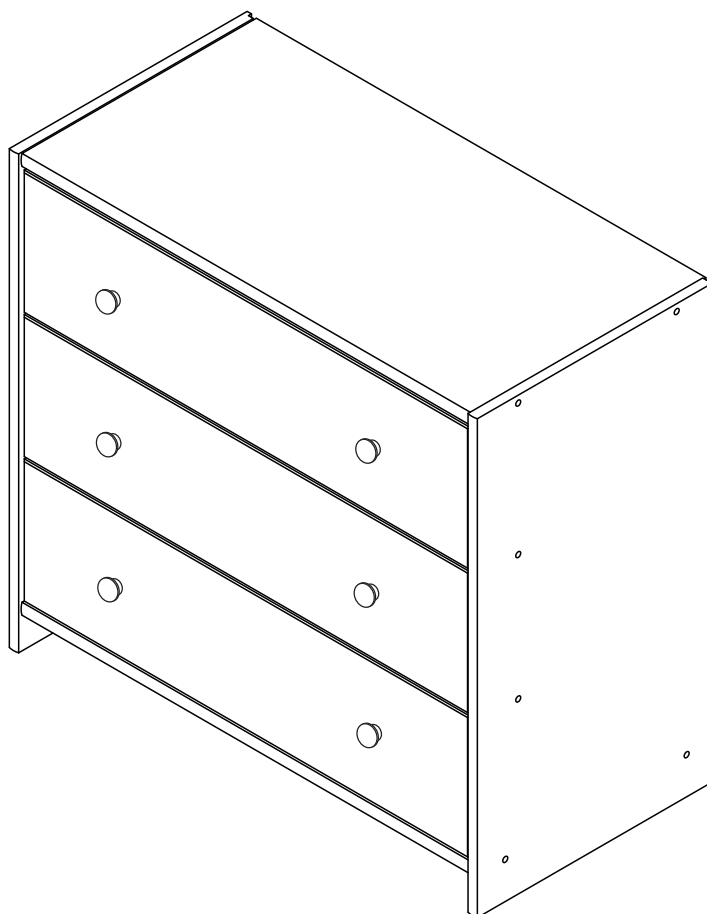

Thank you for purchasing this quality product. Be sure to check all packing material carefully for small parts which may have come loose inside the carton during shipment. Separate, identify and count all parts and hardware.

Compare with the parts list to be sure all parts are present.

"DO NOT TIGHTEN SCREWS UNTIL COMPLETELY ASSEMBLED"

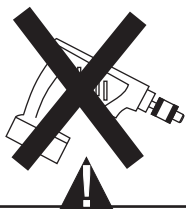

* Use of power tool to assemble this product will invalidate any claim and damage this product making unsafe !!!
* Please assemble on a clean soft surface to avoid damage.

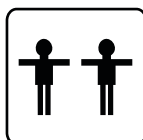

+

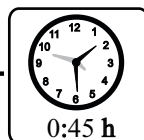

Tools Required

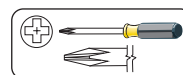

(Not includ)

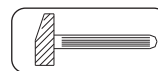

(Not includ)





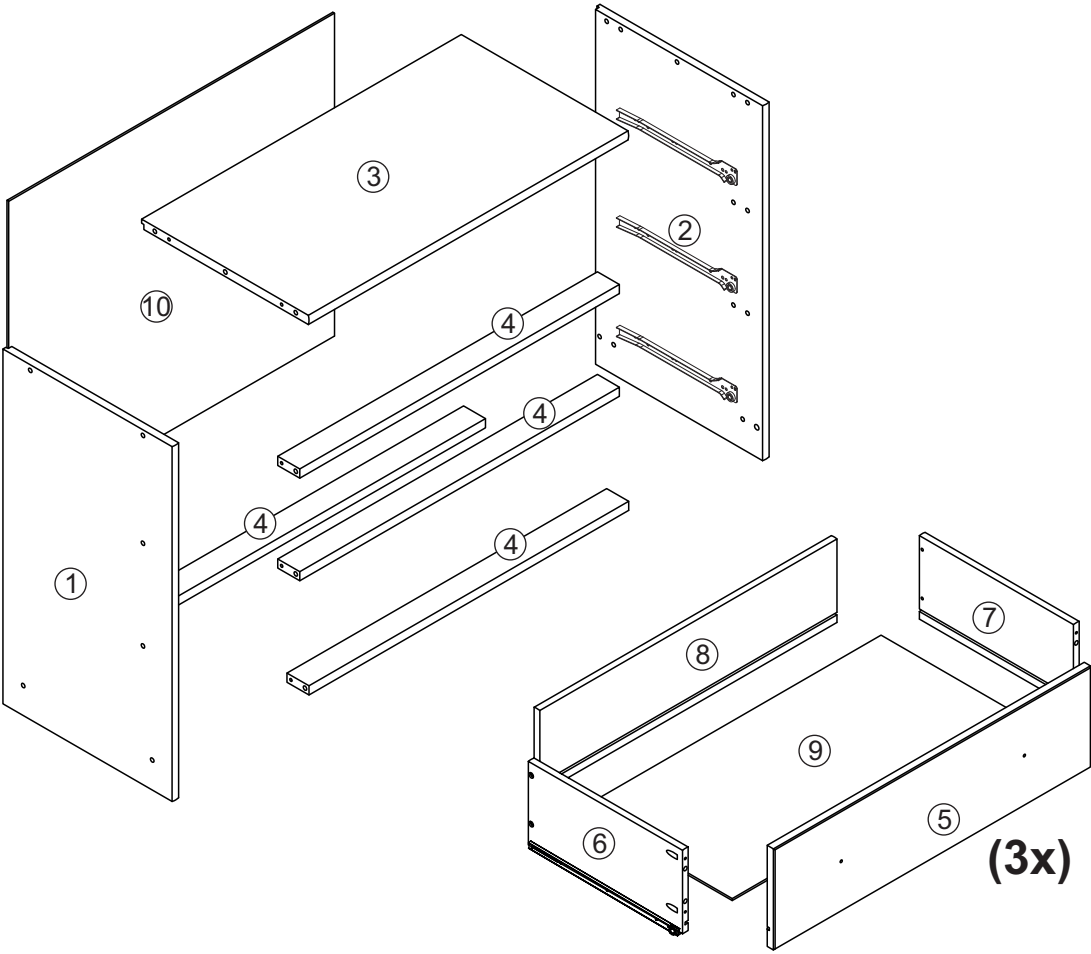

IMPORTANT:

PLEASE READ INSTRUCTION BEFORE STARTING THE ASSEMBLY

Part List - 760 3 DRAWERS CHEST

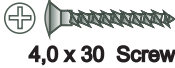

Identifying the Hardware-Identify the hardware using the illustrations below.

A  Qty 12	B  Qty 26	C  Qty 06
D  Qty 24	E  Qty 06	F  Qty 16
G  Qty 01		

01

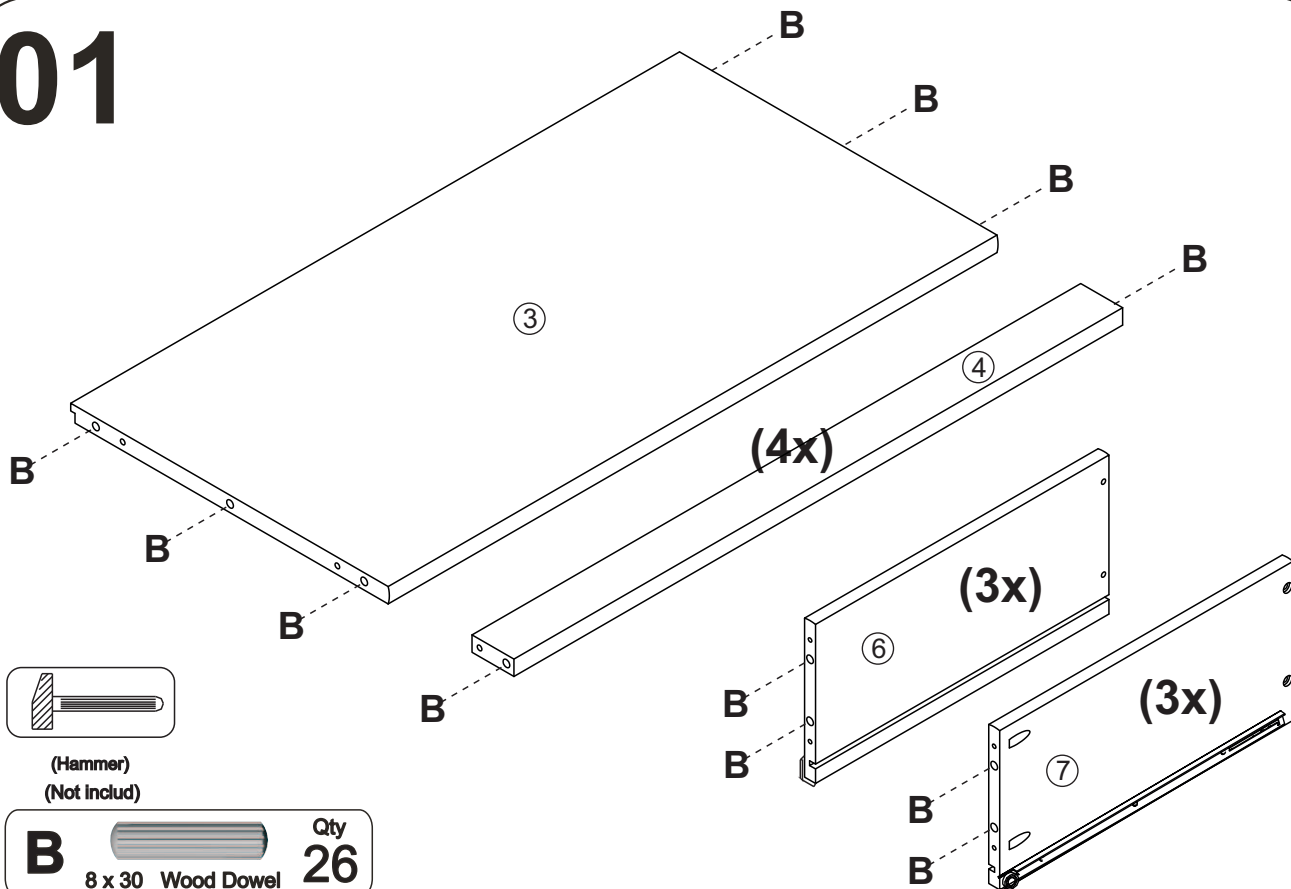

02



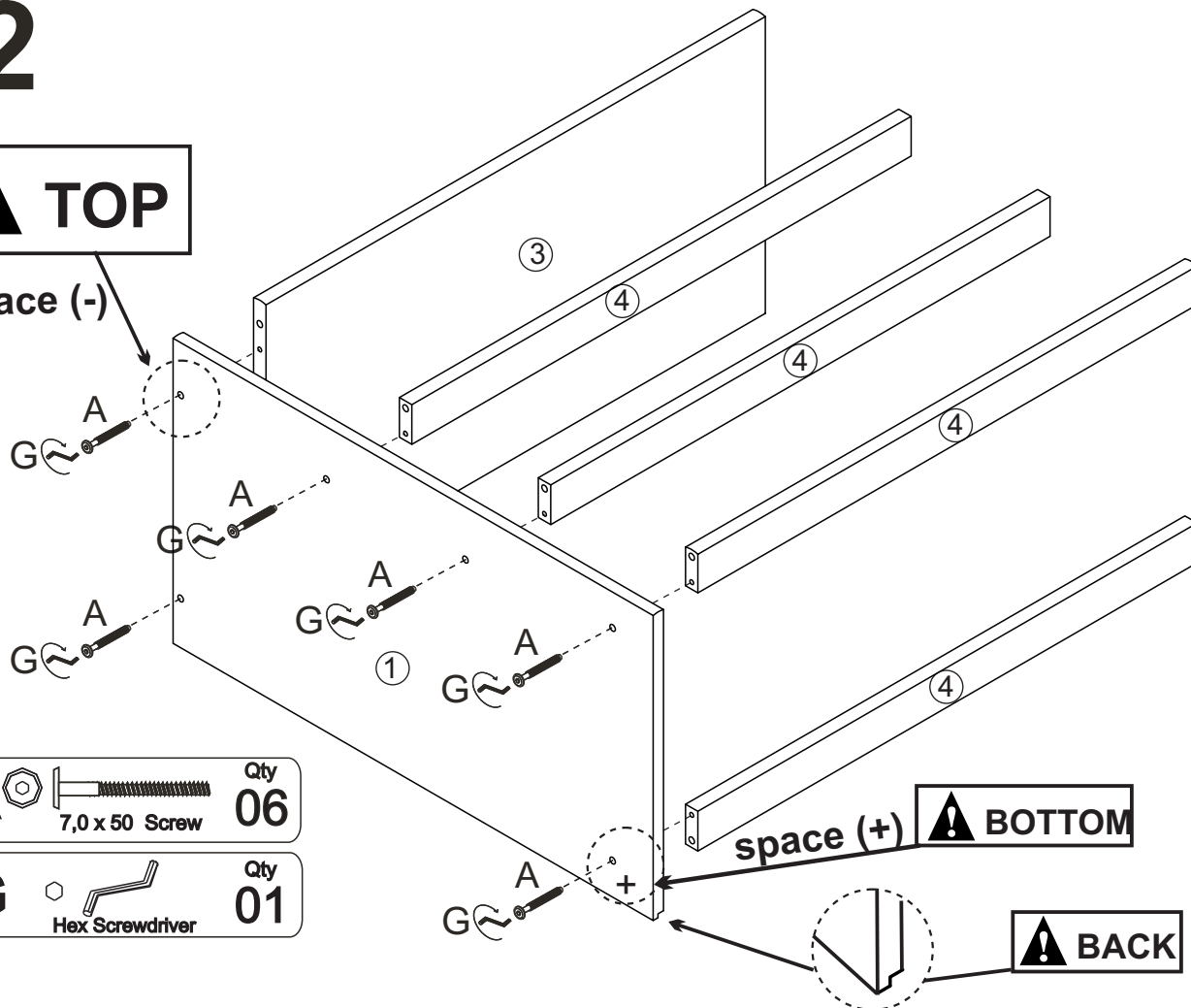

space (-)



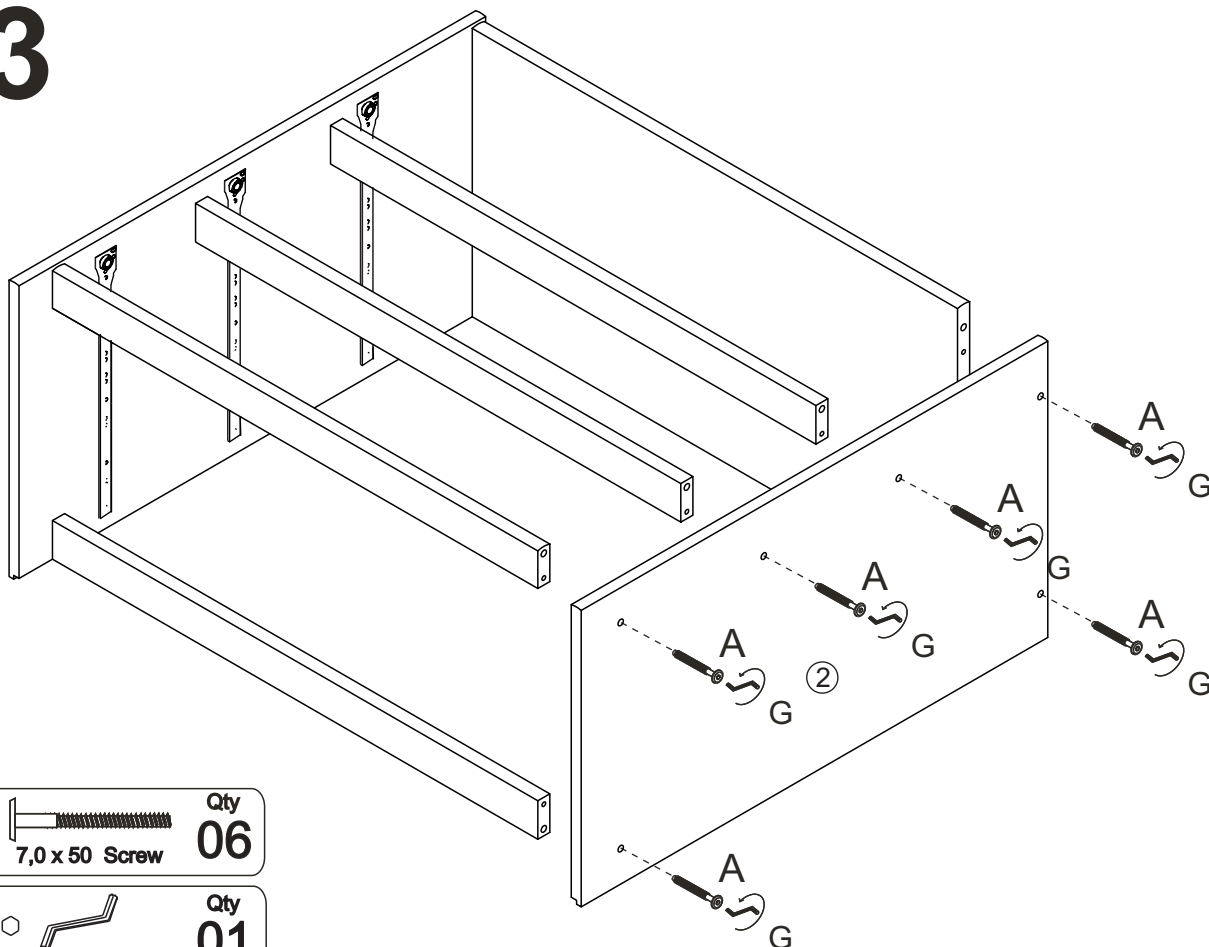

03



A		7,0 x 50 Screw	Qty 06
G		Hex Screwdriver	Qty 01

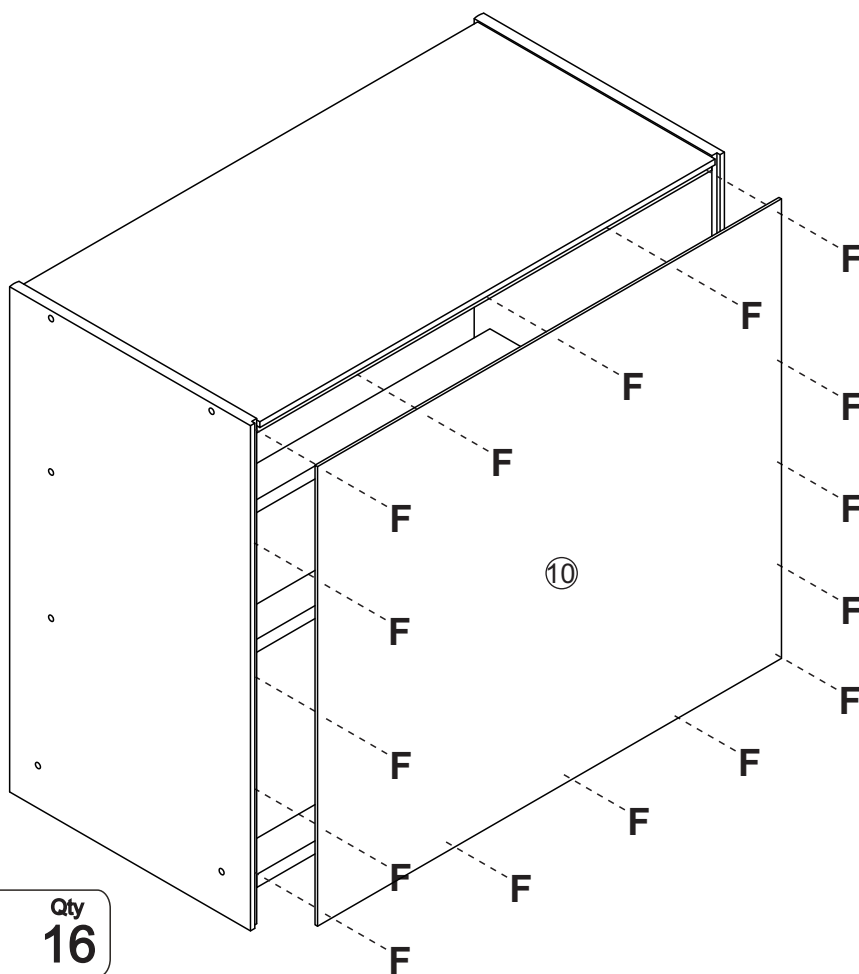

04

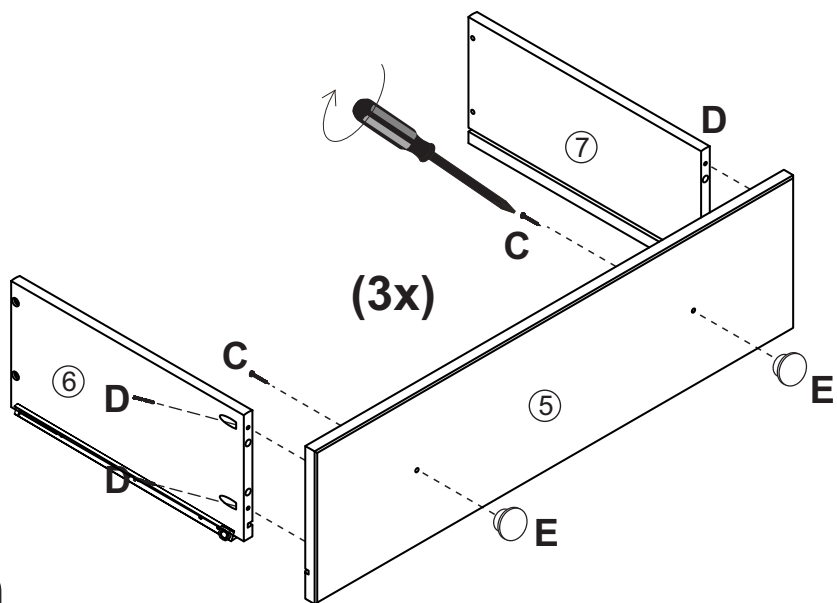

F		10 x 10	Qty 16
----------	---	---------	------------------

05



C		Qty 06
D		Qty 12
E		Qty 06

06

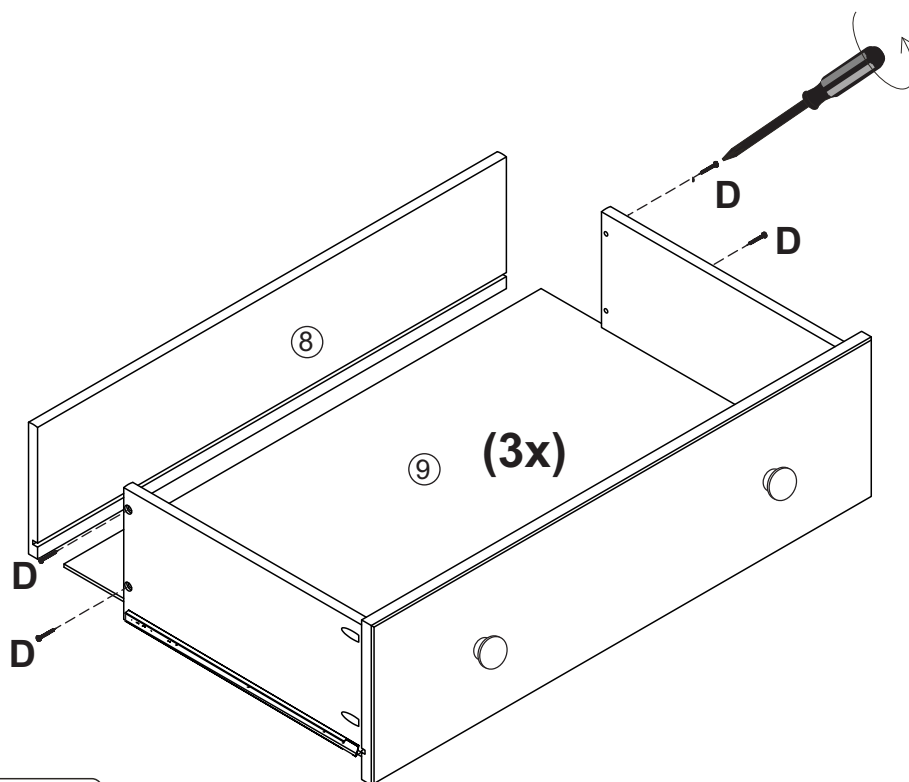

D		Qty 12
---	---	-----------

07

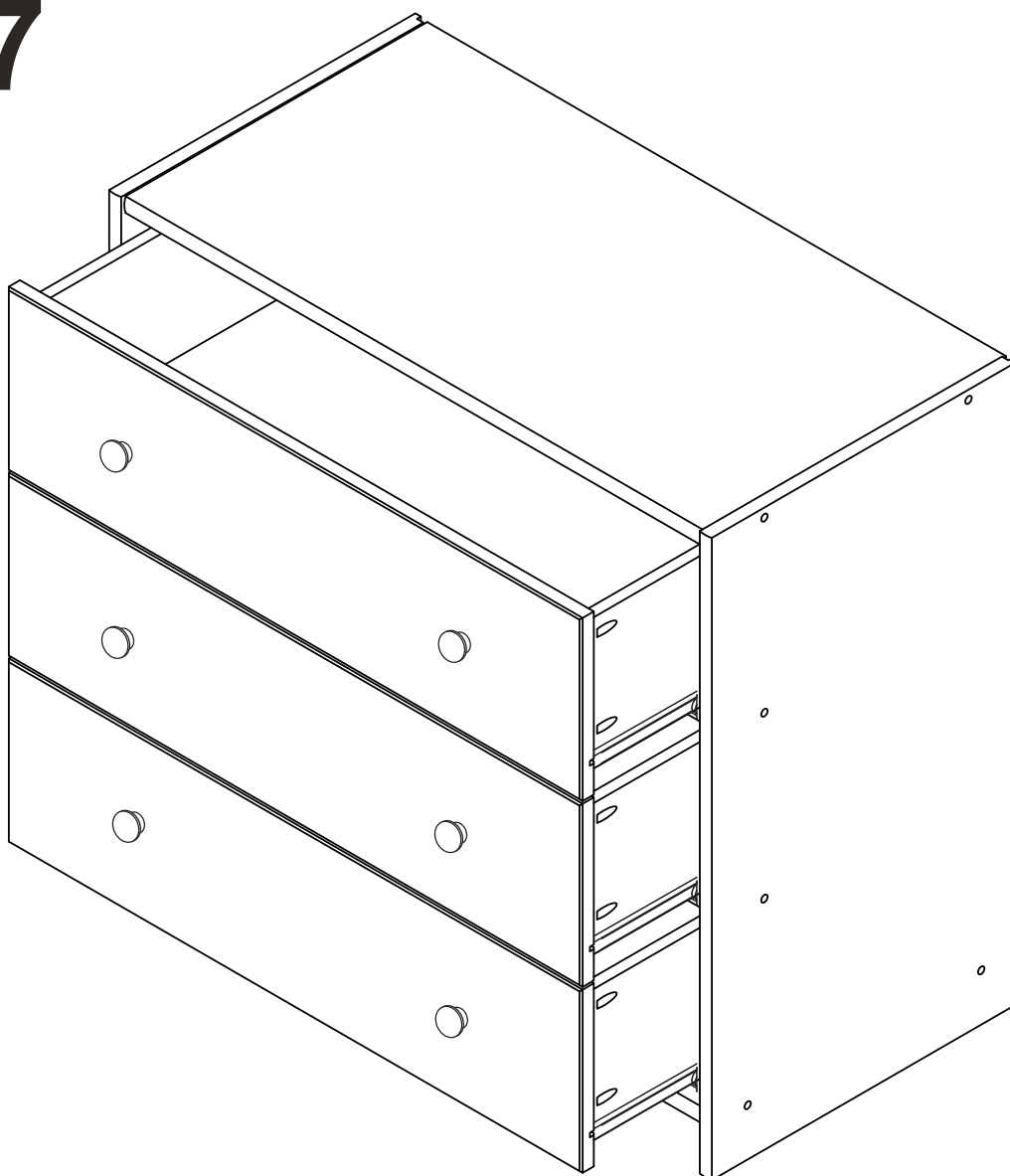

Please remove screw "A" and fix on "B" if necessary to adjust the slide, moving up or down.

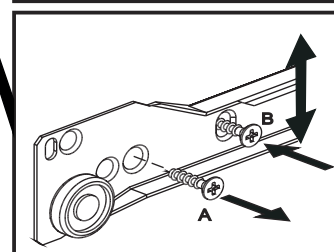
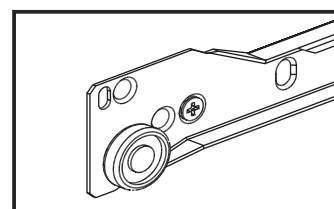



Fort Whorth, Texas 76140

ASSEMBLY INSTRUCTIONS

760 3 DRAWERS CHEST METAL KNOB

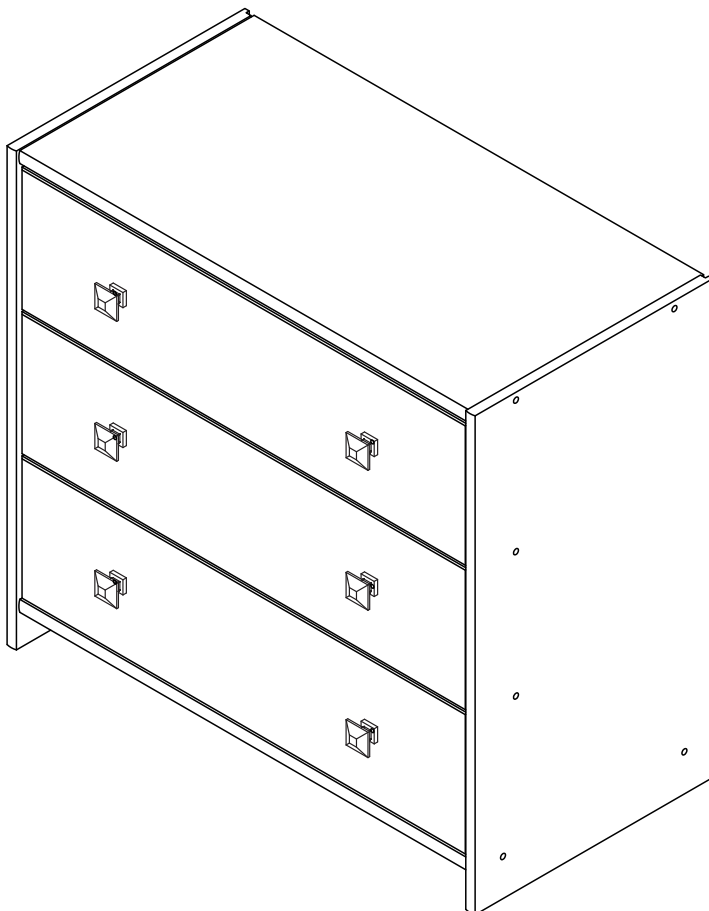

Thank you for purchasing this quality product. Be sure to check all packing material carefully for small parts which may have come loose inside the carton during shipment. Separate, identify and count all parts and hardware.

Compare with the parts list to be sure all parts are present.

"DO NOT TIGHTEN SCREWS UNTIL COMPLETELY ASSEMBLED"

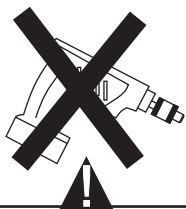

* Use of power tool to assemble this product will invalidate any claim and damage this product making unsafe !!!
* Please assemble on a clean soft surface to avoid damage.

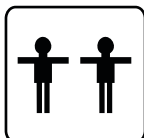

+

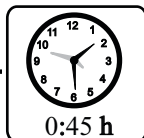

Tools Required

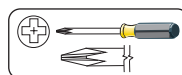

(Not includ)

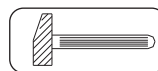

(Not includ)





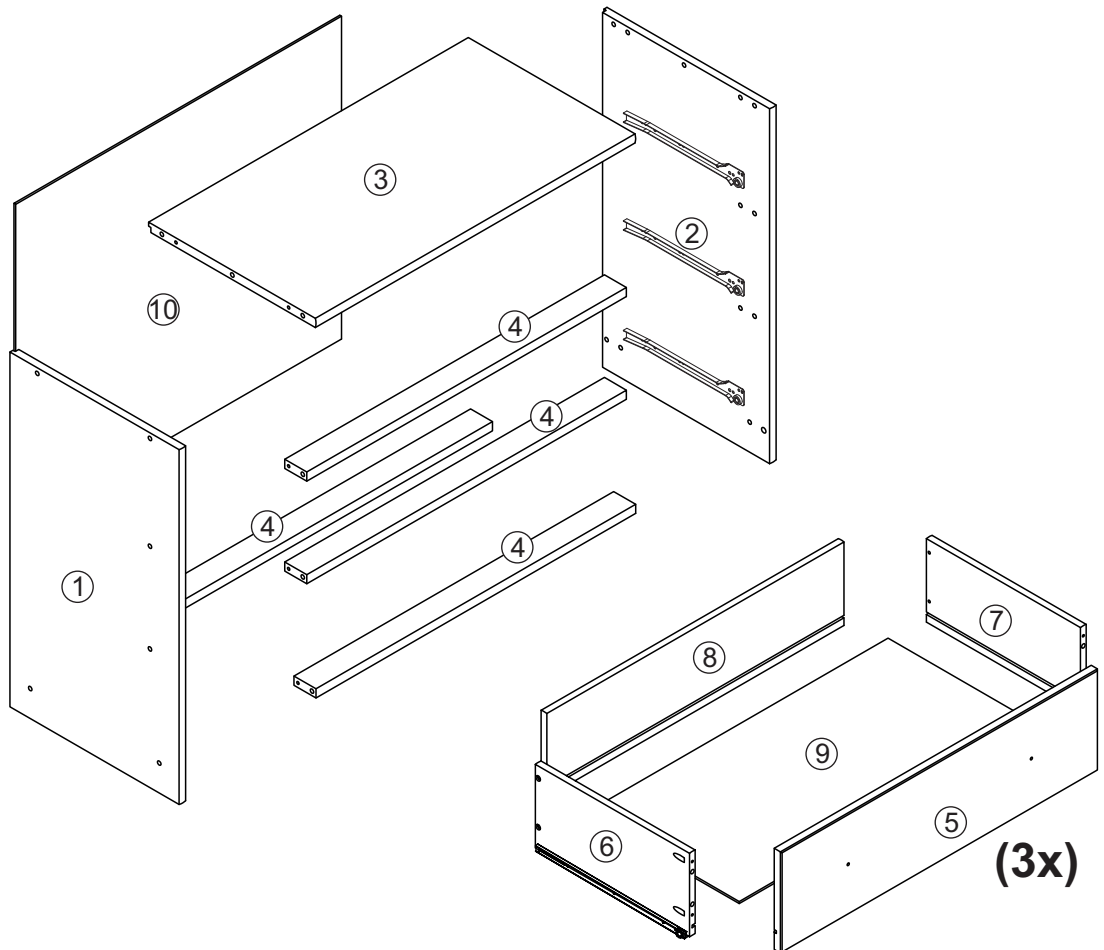

IMPORTANT:

PLEASE READ INSTRUCTION BEFORE STARTING THE ASSEMBLY

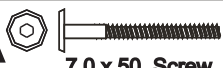
Part List - 760 3 DRAWERS CHEST

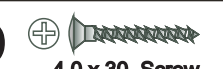

Identifying the Hardware-Identify the hardware using the illustrations below.

A  Qty 12	B  Qty 26	C  Qty 06
D  Qty 24	E  Qty 06	F  Qty 16
G  Qty 01		

01

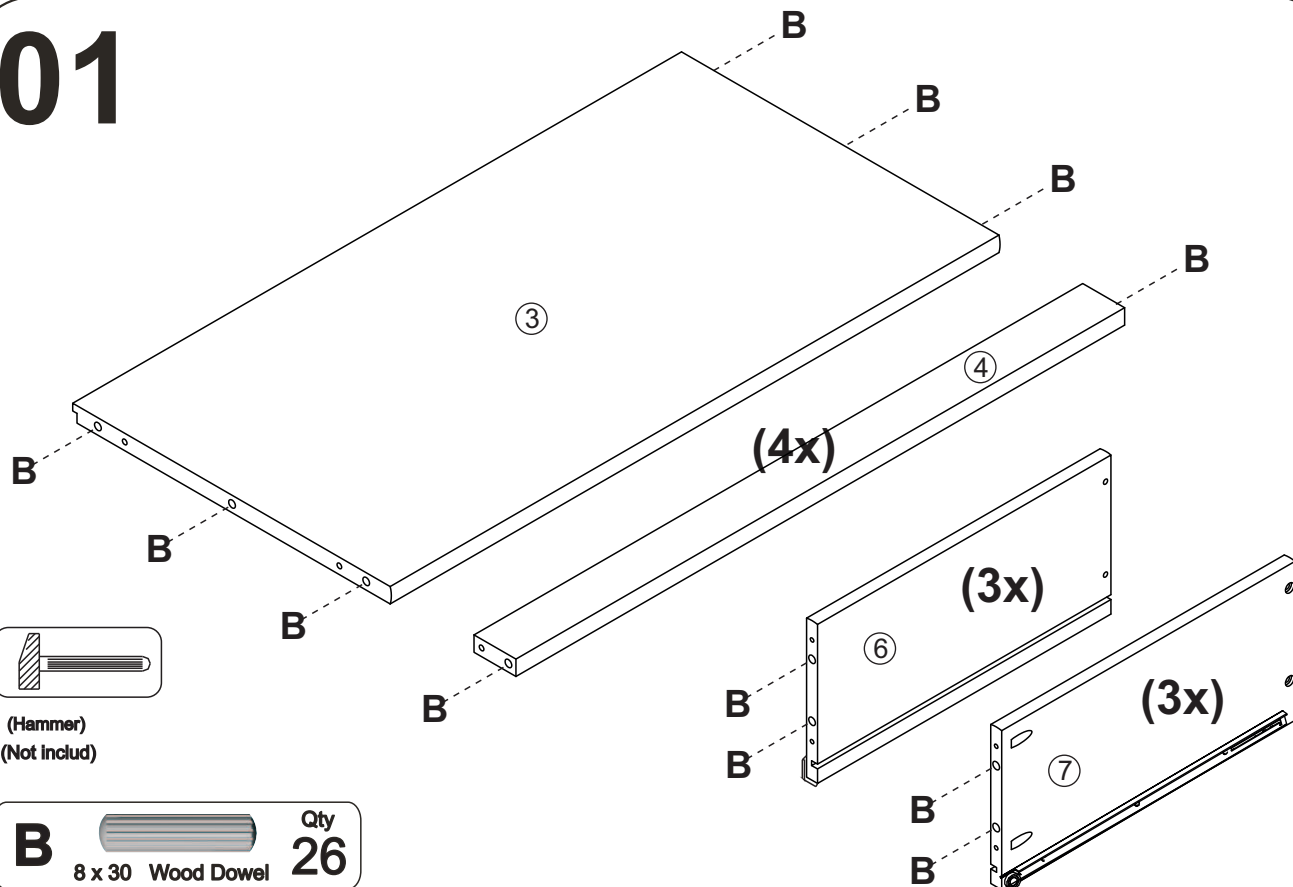

02



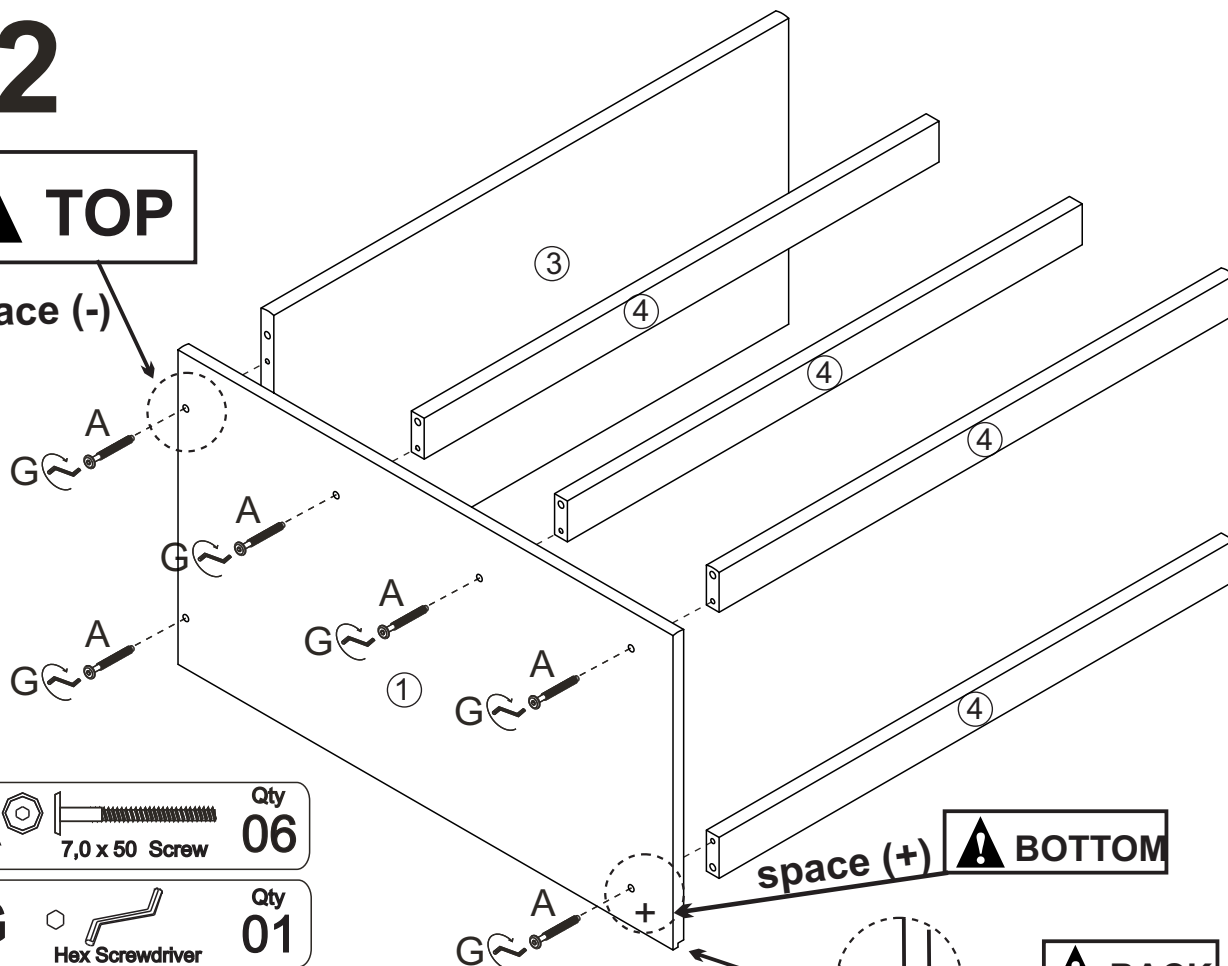

space (-)



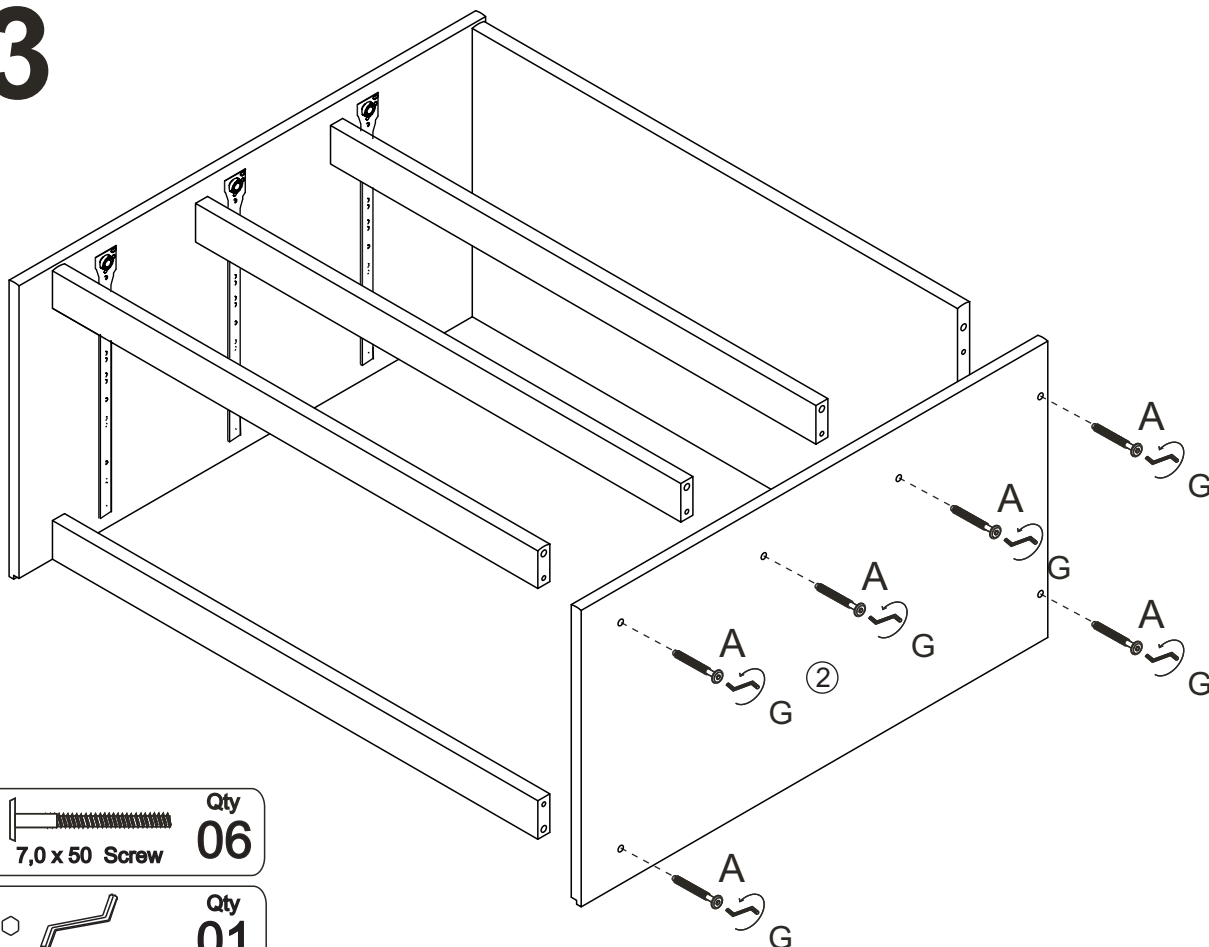

03



A		7,0 x 50 Screw	Qty 06
G		Hex Screwdriver	Qty 01

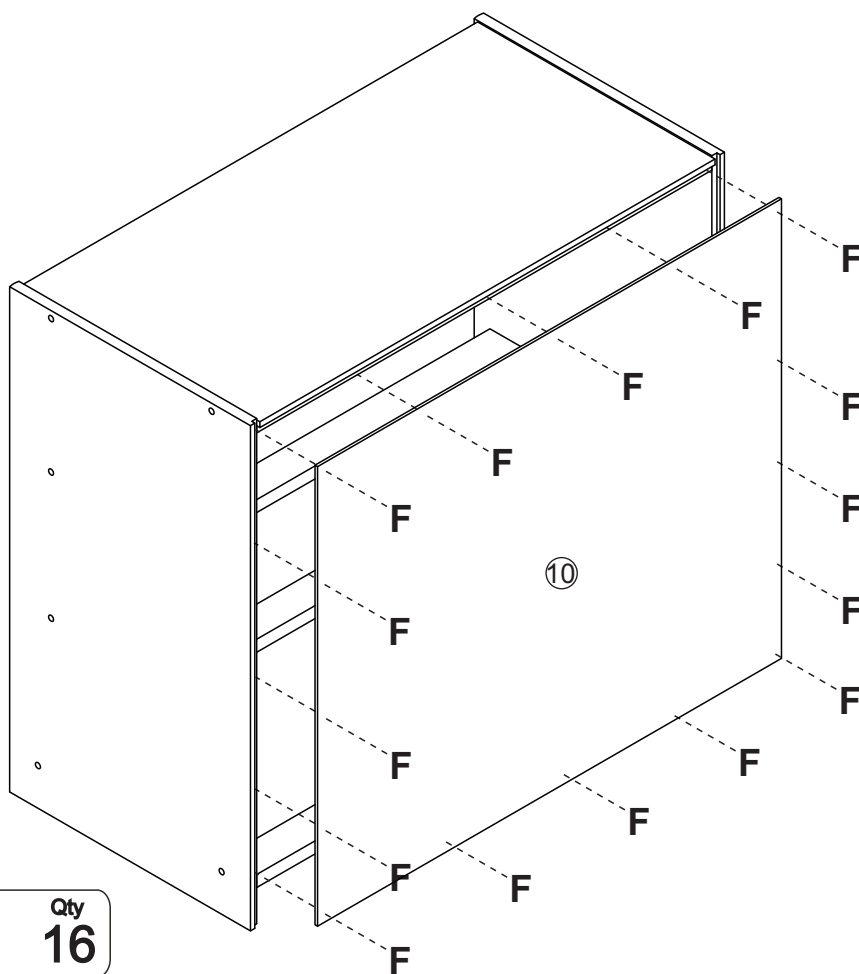

04

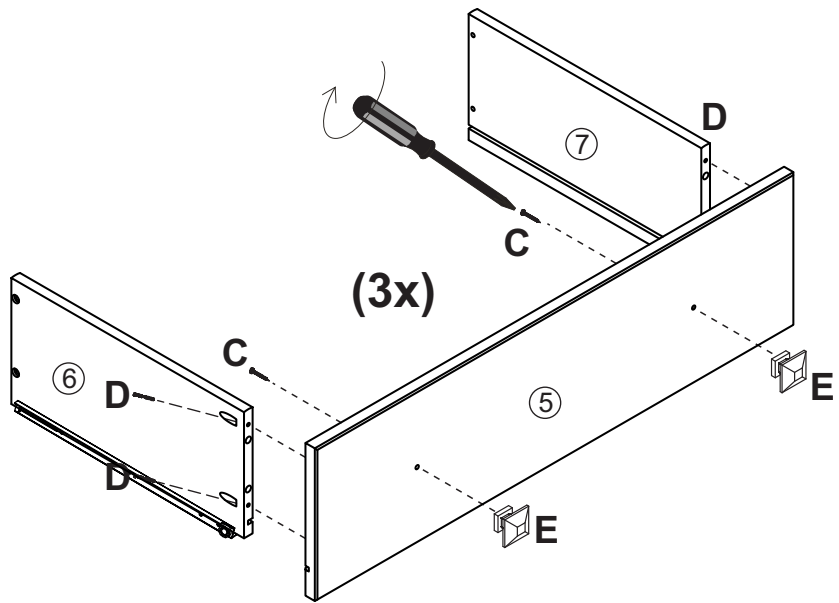

F		10 x 10	Qty 16
----------	---	---------	------------------

05



C		Qty 06
M4,0x30		
D		Qty 12
4,0 x 30 Screw		
E		Qty 06

06

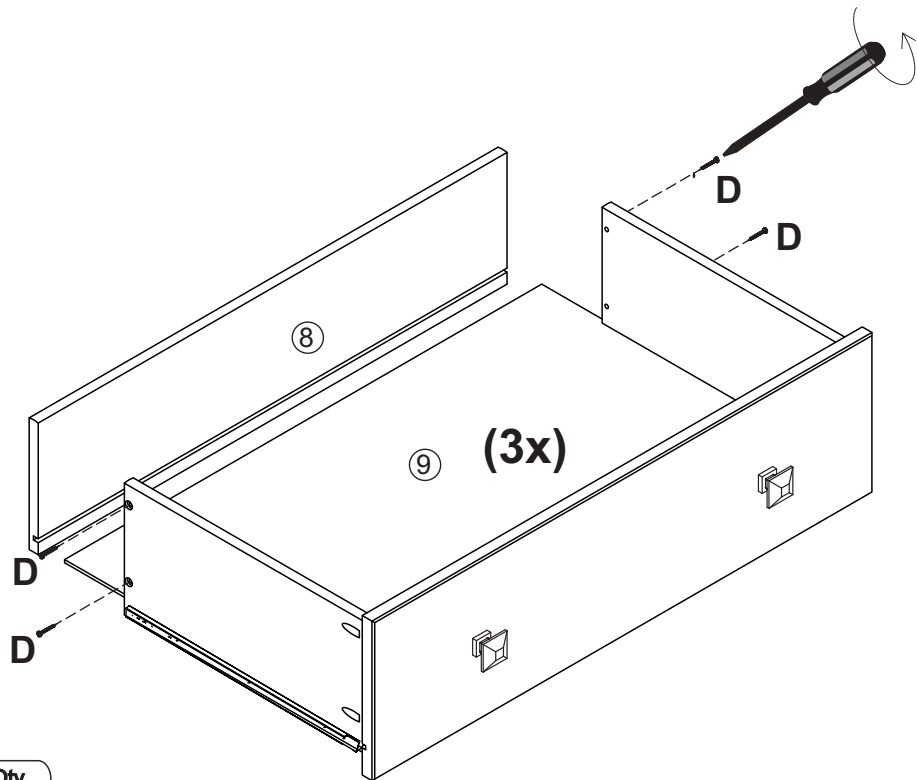

D		Qty 12
4,0 x 30 Screw		

07

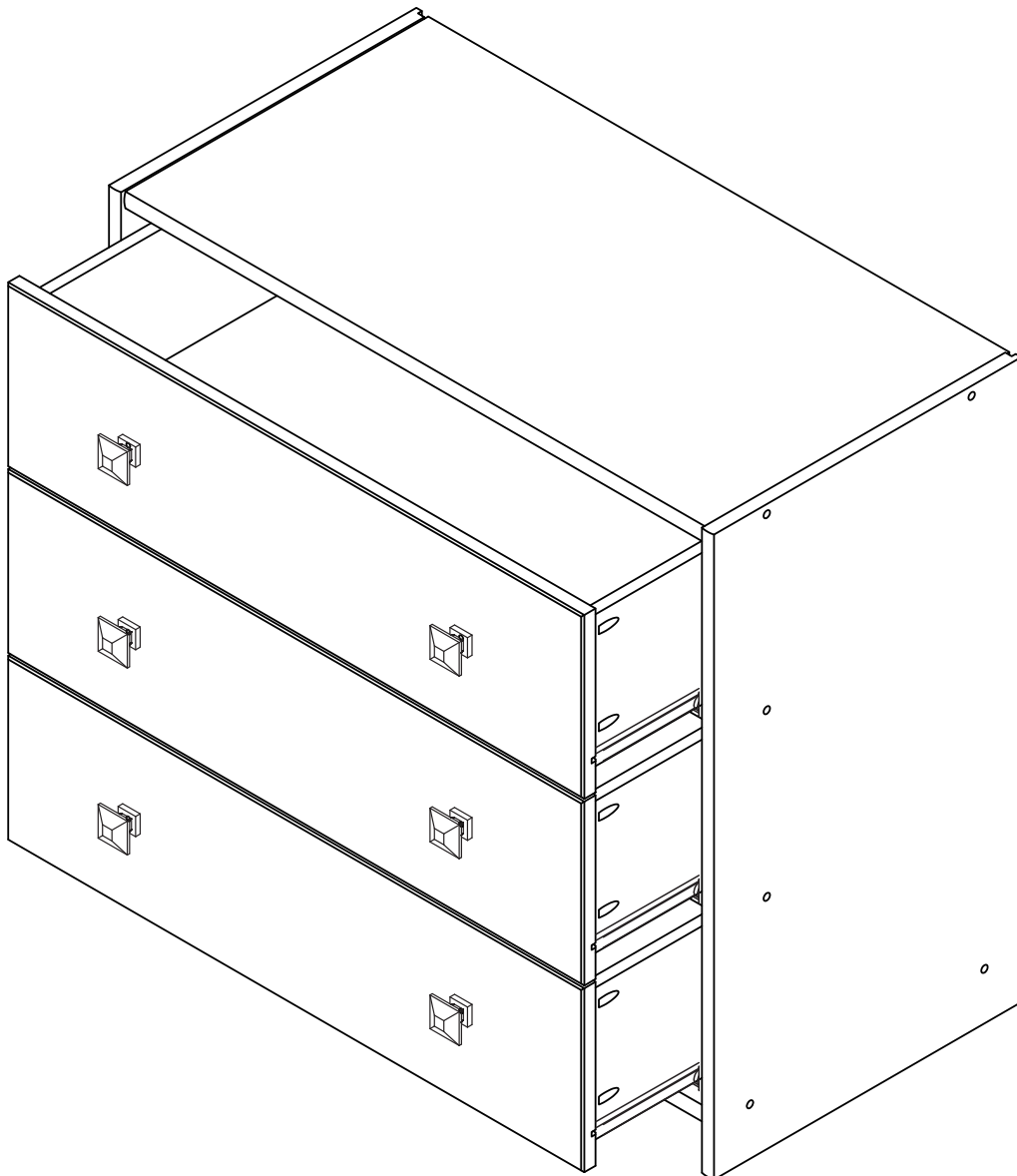

Please remove screw "A" and fix on "B" if necessary to adjust the slide, moving up or down.

