

Surface Mount Grid System

CeilingMAX®

ACP
Sound Ideas. Proven Products.

Installs Easily & Maximizes Your Headroom

4 easy steps

Easy-to-follow instructions on back

Works with 2' x 2' or 2' x 4' ceiling tiles

CAUTION: Although CeilingMAX is "Class A" fire rated, it can deform with exposure to excessive heat. Never allow direct exposure to heat exceeding 140°F.

Examples of where to use CeilingMAX

Attach
top hangers
after wall
brackets
are installed



Install
cross
tees



Tilt to insert
ceiling tiles
of choice



Snap
runners
into top
hangers



Covers old plaster
or drywall



Apply to joists



Use over 12" x 12" stapled
or glued tile ceilings

Compare CeilingMAX to any suspended metal grid system

	CeilingMAX	Suspended Metal Grid
Saves up to 6" of ceiling height	●	
No wires to hang or leveling	●	
Doesn't rust or show scratches	●	
Works with 2' x 2' or 2' x 4' ceiling tiles	●	●
Can be installed by one person	●	
Available in a wide range of colors and finishes	●	
8' sections are easy to get home	●	
Ceiling tiles are removable	●	●
Use any lighting that can be installed on a drywall ceiling	●	
Class A fire rating	●	●
Fastens directly to joists, plaster or drywall	●	
Easy to determine how many of each component to buy	●	
High-grade PVC plastic simple to cut and use	●	

Questions?

1.800.558.0615 www.acpideas.com

For successful results, read and follow the detailed instructions on back or view the installation video online at acpideas.com.

To calculate how much CeilingMAX you'll need, see the back of this sheet or ask a sales associate for assistance.

Surface Mount Grid System

For the amount of CeilingMAX needed, measure the room's perimeter and calculate square footage

of Pieces

Wall Bracket	Divide the perimeter of the room by 8 and round up to the nearest whole number.	
Top Hanger	Divide the square footage of the room by 16 and round up to the nearest whole number.	
Runner	Divide the square footage of the room by 16 and round up to the nearest whole number.	
Cross Tee & Ceiling Tiles	For 2'x4' ceiling tiles, divide the square footage of the room by 8 and round up to the nearest whole number. For 2'x2' ceiling tiles, divide the square footage of the room by 4 and round up to the nearest whole number.	

Easy-to-Follow Instructions

Tools you will need



String or Chalk Line



Drill with Phillips Tip



Tape Measure



Tin Snips



Quantity of 1" Drywall Screws

Room Planning ESTABLISHING ALIGNMENT

To ensure professional looking results, the room layout should be balanced with equal size border panels on opposite sides of the room, as shown below.

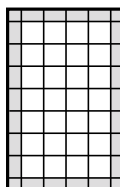

■ = Border Panels

Formula:

- Measure room in one direction
- Round down to closest even number of feet
- Subtract those numbers
- Add 24"
- Divide by 2 to get border tile size

(See Installation Tips 3 & 5)

Example
17' 6"
16'
1' 6" or 18"
42"
21"

Your Project

Establish your string (or dryline) at this measurement. Repeat these same steps for the other direction. **Note:** If your border tile size ends up being 0" or 24" and you will be using full-sized ceiling panels around the perimeter of the room, you will need to order 25" cross tees for your border (only). The 25" tees can be purchased directly from us. This is an extremely rare occurrence.

Step 1 ATTACHING THE WALL BRACKET

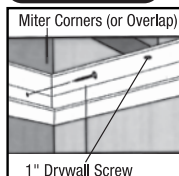

The Wall Bracket is 8' long and is installed around the perimeter of the room.

(Read Tip 3) Using screws, install the Wall Brackets around the perimeter of the room, directly beneath the joists or finished ceiling. Drywall screws can be installed into the ceiling, joists or wall, and should be spaced 16" to 24" apart.

Step 2 FASTENING TOP HANGERS



The Top Hanger is 8' long and is fastened to joists or existing ceiling.

Top Hangers will be installed either perpendicular to exposed joists or across the longest dimension. Using a string or chalk line, establish the drylines as determined above. The first row of Top Hangers & Cross Tees will be centered over these drylines.

NOTE: Be sure the intersection of drylines is square.

Measure and cut your first Top Hanger so the notch is aligned over the Cross Tee dryline, with the cut end resting in the Wall Bracket.

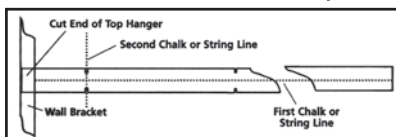

NOTE: If your measurement from the chalk line to wall is less than 12", use the first notch on the Top Hanger to measure from. If greater than 12", measure from the second notch to make your cut. Repeat this step for as many rows as needed and set aside for Step 4.

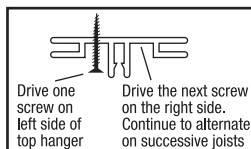

Drive one screw on left side of top hanger. Drive the next screw on the right side. Continue to alternate on successive joists.

Using a drill with Phillips tip, attach the first row of Top Hangers to the joist or current ceiling with screws, placing one screw in each joist, alternating sides as shown. If joists are not exposed, screws should be no more than 16" - 24" apart.

To install additional Top Hangers in line, cut a 6"

section of Runner and use it as a temporary splice to connect the installed Top Hanger to the one to be hung. When the first row is complete, cut the last Top Hanger in the row so it fits into the Wall Bracket.

Step 3 INSTALLING TOP HANGERS & CROSS TEES

The Cross Tee is 23" and is installed perpendicular to the Top Hanger to create grid support.

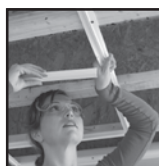
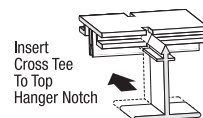

Using the pre-cut Top Hangers from Step 2, align the first notch with the Cross Tee dryline. Using an uncut Cross Tee as a spacer, place one end in the notch of the previously installed Top Hanger. Place the other end in the matching notch of the next Top Hanger. Make certain that both ends of the Cross Tee fit snugly into the notches, then attach Top Hanger using screws. Continue to install uncut

Cross Tees parallel to the previous row. Cut the last Top Hanger to fit into Wall Bracket. Continue installation of rows. When all the rows are installed, measure, cut and install the first and last row of Cross Tees, resting the cut ends in the wall bracket. Do not install the last Cross Tee in the border rows until Step 5.

Step 4 CUTTING & PLACING BORDER CEILING TILES

Beginning where the first Top Hanger was installed, cut ceiling tiles to fit each location and slide into the Wall Bracket. Rock the Cross Tee slightly as you insert the tile. When the end ceiling tile is correctly cut to size and in place, install the final Cross Tee.

Step 5 LOCKING IN THE RUNNER

The Runner is 8' long and snaps into the Top Hanger, locking the grid system and ceiling tiles.

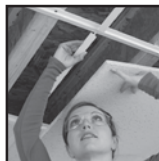

Install full ceiling tiles in the remaining rows by rocking the Cross Tee and placing each tile in the grid system. As each row of ceiling tiles is put into place, finish the installation by snapping the Runners into the Top Hangers as shown below. Cut the last row of Runners as required.

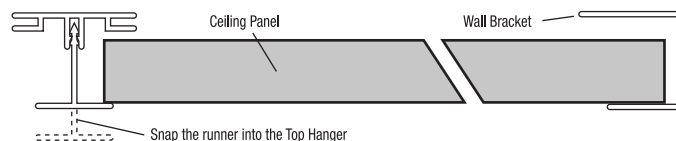

INSTALLATION TIPS

TIP 1: Before you begin, box in any ducts, piping or window openings as shown at right.

TIP 2: Light fixtures can be installed or adjusted to align with the CeilingMAX grid system. Make sure to provide adequate space (1/4" preferred) between the outer dimensions of the fixture and the ceiling tile. This is especially important when lighting is recessed incandescent. **NOTE:** If you plan to use lighting designed for use with suspended ceiling systems, be certain the fixture is supported by the joists, not the CeilingMAX grid system.

TIP 3: If starting a room with a full sized tile instead of border tile, order 25" cross tees from the manufacturer. The special order cross-tees would be for the border only. See the ROOM PLANNING section above to determine if you need border tiles or should start with full tiles.

TIP 4: To accommodate 1/2" conduit or pipes, notch the vertical portion of the Cross Tee or Runner.

TIP 5: If using 2' x 4' tile, round the 4' tile side of room measurement down to nearest number divisible by 4. Add 48" to remainder and divide by 2 to determine border tile size.

TIP 6: If your existing ceiling is not level you may need to furr the ceiling or place shims behind the Top Hangers to level. If the adjustment is minimal, you can back out the screws in the Top Hangers.

For Additional Tips and Information visit our FAQ page on acpideas.com

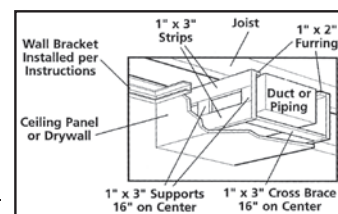

Tech Support
1-800-558-0615
acpideas.com

Surface Mount Grid System
CeilingMAX

ACP
Sound Ideas. Proven Products.

Patent # 5,611,185 (REV: 03.11) C13-99