

Assembly Instructions

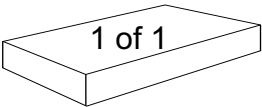



| | |
|------------|--|
| DATE STAMP | |
|------------|--|

Condo 6-Drawer Dresser
Model # DC-4829

This product is shipped in
1 carton

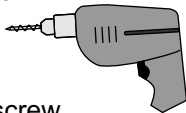
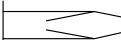

Depending on collection, the style of your product may vary from this picture.

| Required Tools | | Optional Tools |
|---|---|---|
|  |  Phillips Head |  Using a power screwdriver will speed up assembly. Caution Do not over tighten any screw. The last few turns of each screw should be done very slowly or by hand. |
| |  Flat Head | |
| |  Hammer | |

Hardware Identification

Cabinet Hardware

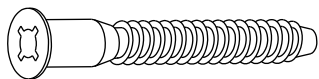

2" Confirmat Screws
(8)
RM-0001



Screw Cover Caps
(8)
RM-0226 black
RM-0523 maple
RM-0008 white
RM-0620 cherry

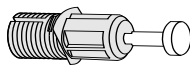

Blue Rapid Rod
(2)
RM-0583



15mm Zinc Cam
(8)
RM-0103



Green Twister Dowel
(6)
RM-0501

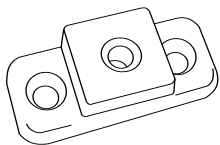

T Spacer
(24)
RM-0628



Drawer Slide Screw
(72)
RM-0074

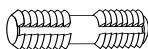

Plastic Dowels
(14)
RM-0072



3/4" Nail
(36)*
RM-0022

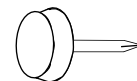

Levelling Feet
(6)
RM-0139

**More than required*

**More than required*

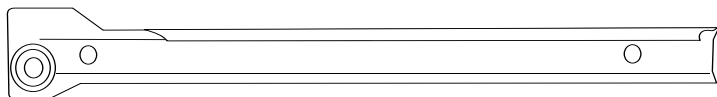

LEFT Cabinet Slide (6)

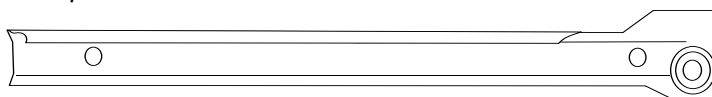

RIGHT Cabinet Slide (6)

Drawer Hardware

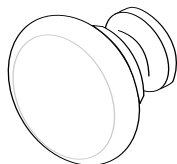

Knob
(6)
RM-0464 maple / black
RM-0625 white / cherry



#8 7/8" Machine Screw
(6)
RM-0465

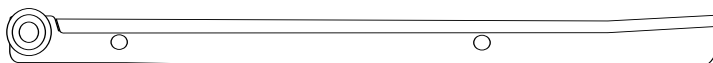

1 LEFT Drawer Slide per Drawer (Total = 6)

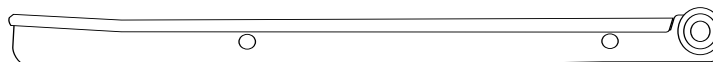

1 RIGHT Drawer Slide per Drawer (Total = 6)

4 per drawer



#8 - 1 1/2" Hi Lo Screws
(24)
RM-0504



12mm Zinc Cam
(24)
RM-0502



Green Twister Dowel
(24)
RM-0501

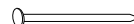

3/4" Nail
(24)
RM-0022



Drawer Slide Screw
(24)
RM-0074

Safety Strap Hardware Package

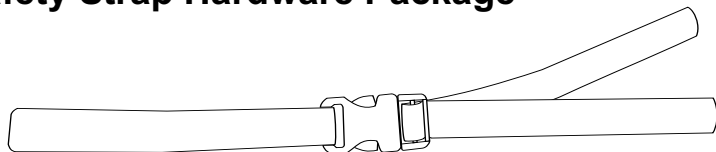

Safety Strap (1)



3/4" screw (1)

Cabinet Parts

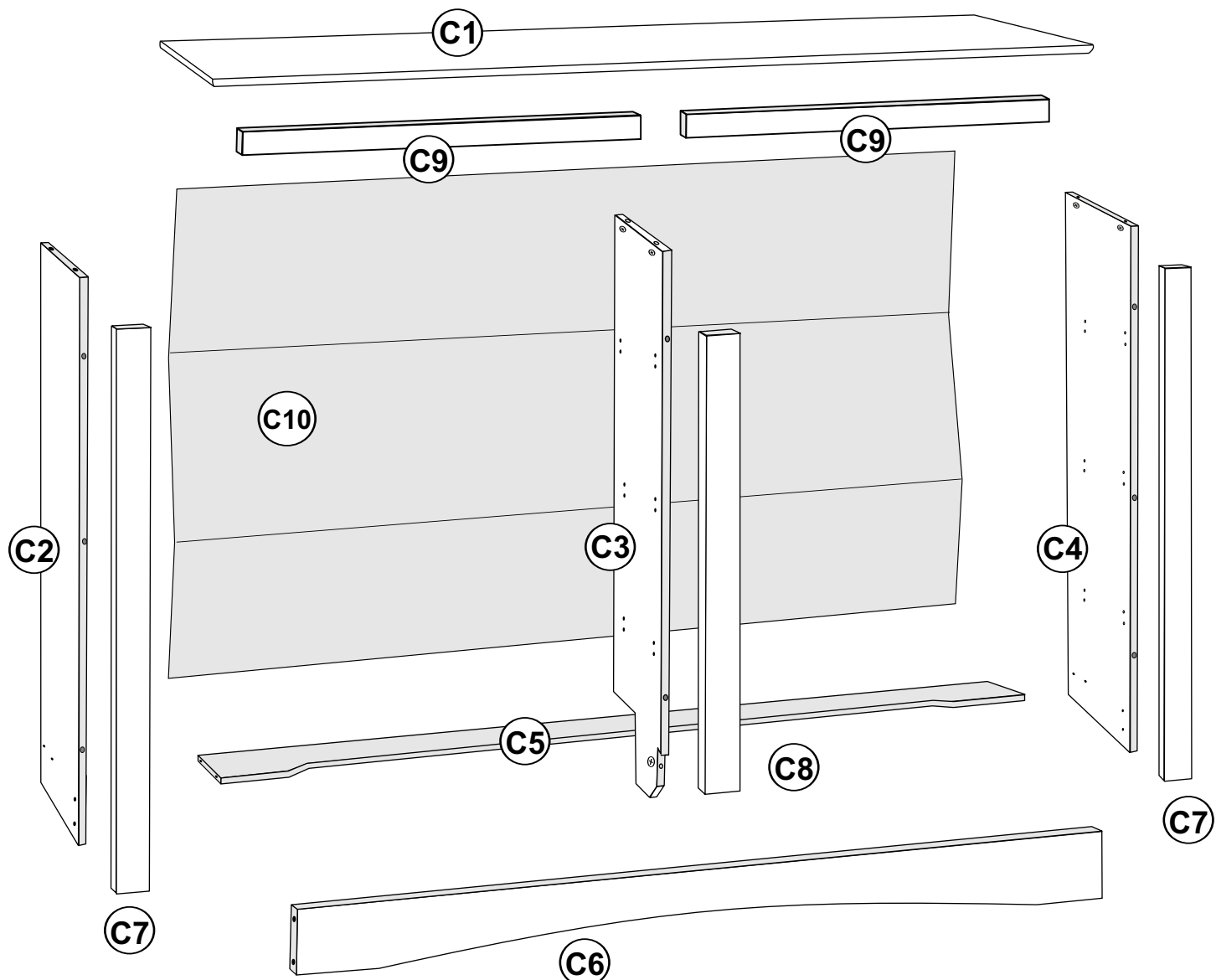

C1

Profiled Top (1)
TP-0476 maple
TP-0416 black
TP-0406 white
TP-0496 cherry

C2

Left Side (1)
SL-4710 maple
SL-4110 black
SL-4010 white
SL-4910 cherry

C3

Center Divider (1)
GA-4110 unfinished

C4

Right Side (1)
SR-4710 maple
SR-4110 black
SR-4010 white
SR-4910 cherry

C5

Decorative Stabilizer A (1)
ST-4719 maple
ST-4119 black
ST-4019 white
ST-4919 cherry

C6

Decorative Stabilizer B (1)
KR-0476 maple
KR-0416 black
KR-0406 white
KR-0496 cherry

C7

1 $\frac{3}{4}$ " Side Molding (2)
TR-4716 maple
TR-4116 black
TR-4016 white
TR-4916 cherry

C8

1 $\frac{3}{4}$ " Center Molding (1)
TR-0475 maple
TR-0415 black
TR-0405 white
TR-0495 cherry

C9

1 $\frac{3}{4}$ " Top Molding (2)
TR-0570 maple
TR-0510 black
TR-0500 white
TR-0590 cherry

C10

Folded Backer (1)
BB-0139

STEP 1 Estimated Time: 15 - 25 minutes

1a Attach T-spacers to left and right sides and to both sides of the center divider using drawer slide screws

1b Then, attach metal cabinet slides to T-spacers using drawer slide screws

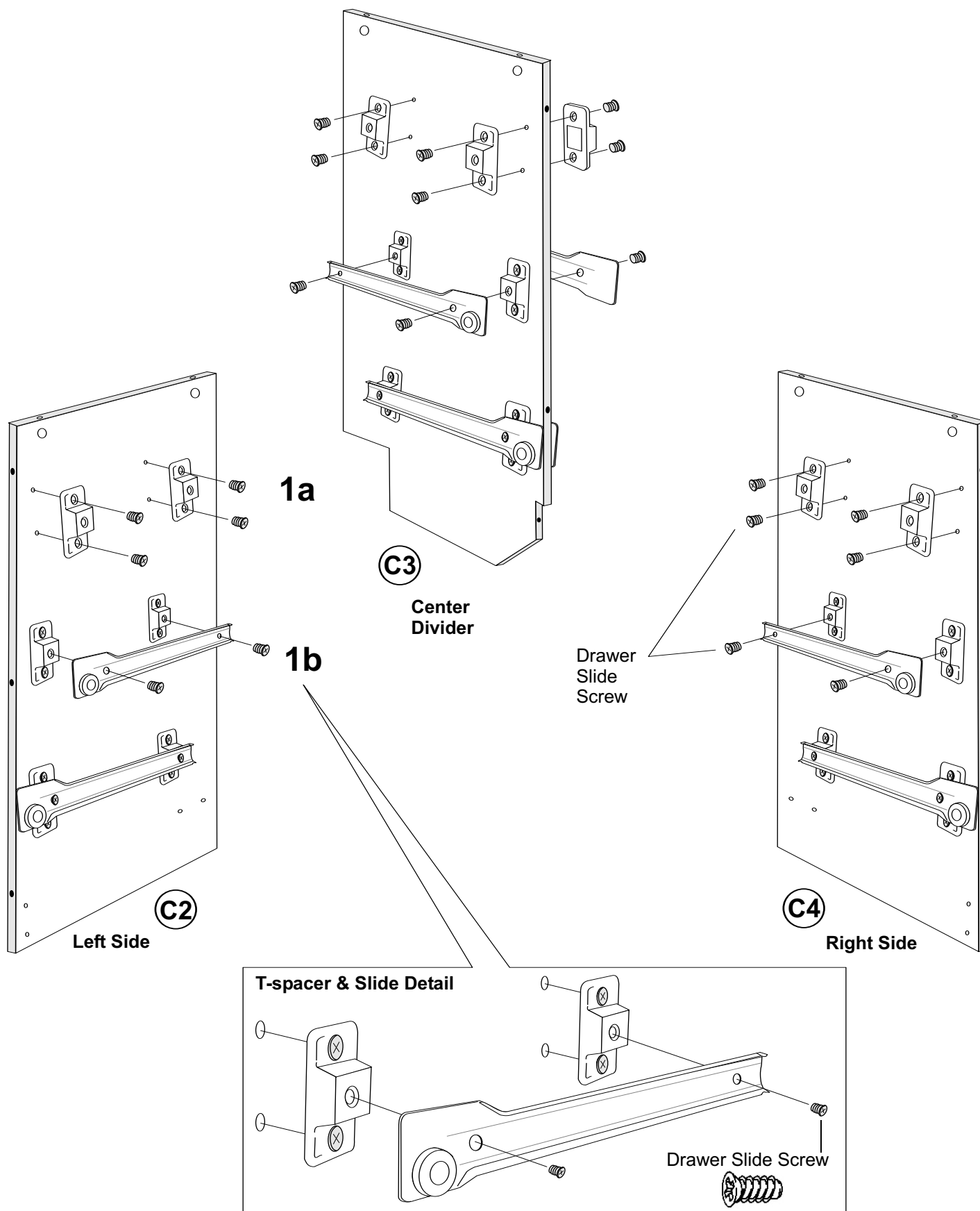

STEP 2 Estimated Time: 1 minute

Insert cams into holes on the top of each side

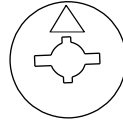
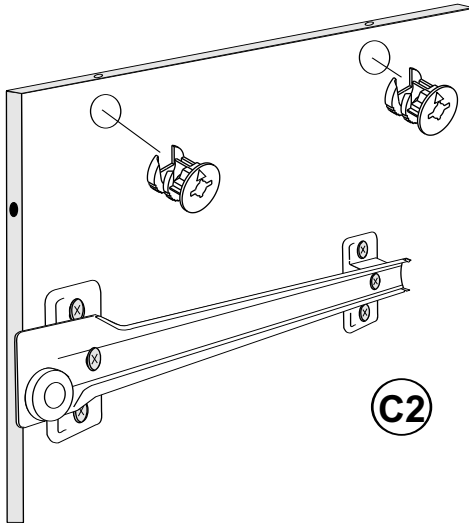

Make sure arrow
on cam faces top

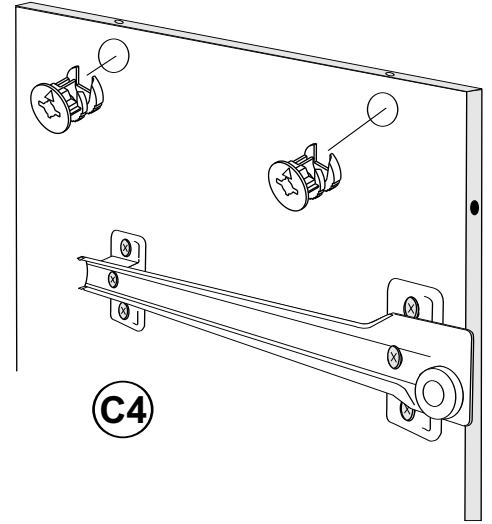

STEP 3 Estimated Time: 1 minute

On the center divider, insert cams where shown

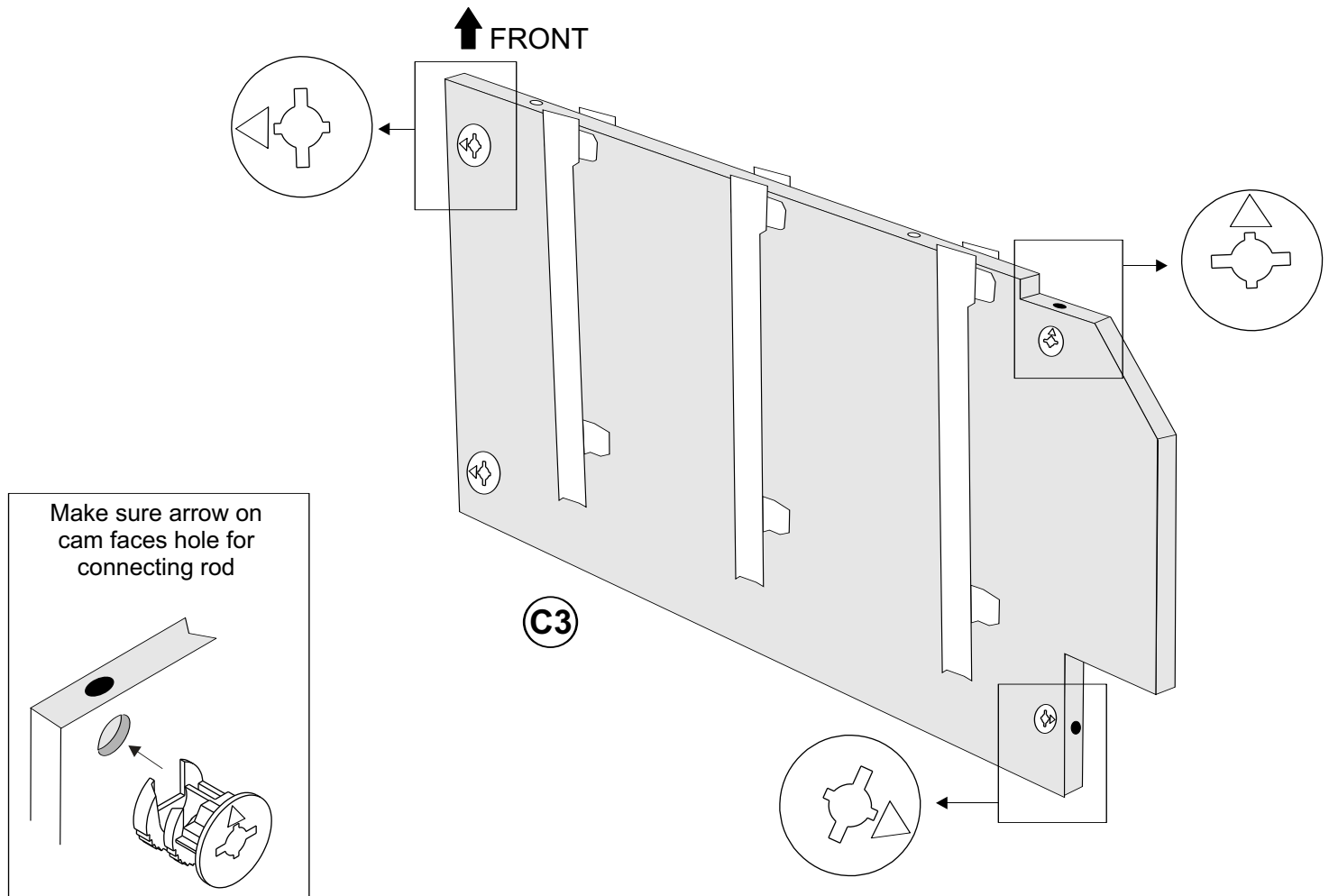

STEP 4 Estimated Time: 1 minute

Insert Blue Rapid Rod into the center hole on each decorative stabilizer

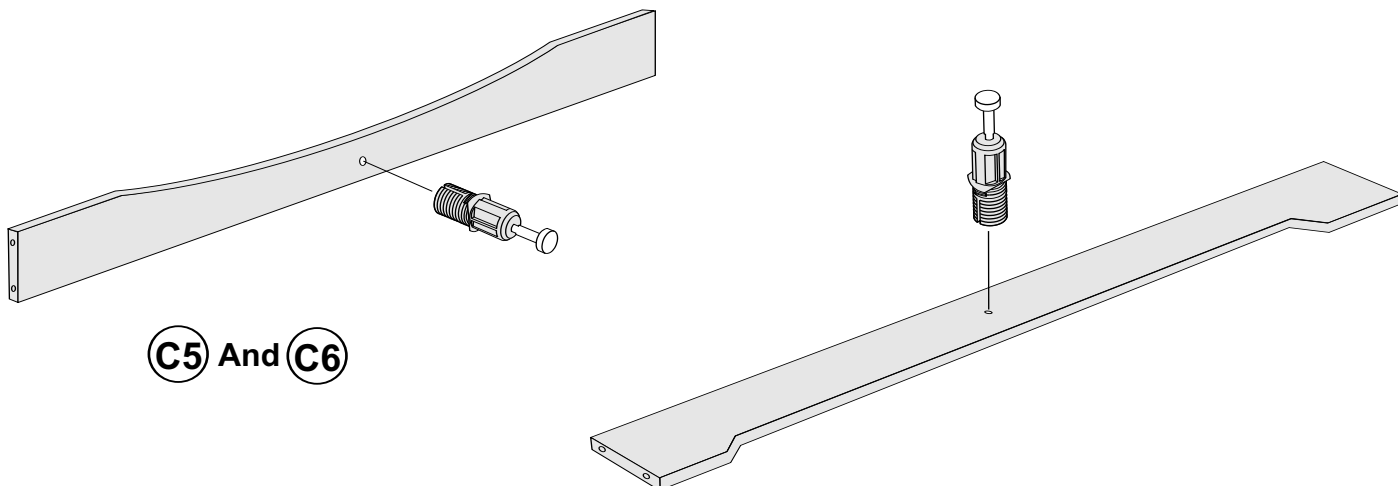

STEP 5 Estimated Time: 5 minutes

Decorative stabilizers **C5** & **C6** are interchangeable.

- 5a** Choose the style that you prefer, and attach it to the front of the center divider
- 5b** Attach the remaining stabilizer to the back of the center divider
- 5c** Lock both cams with a flat head screwdriver

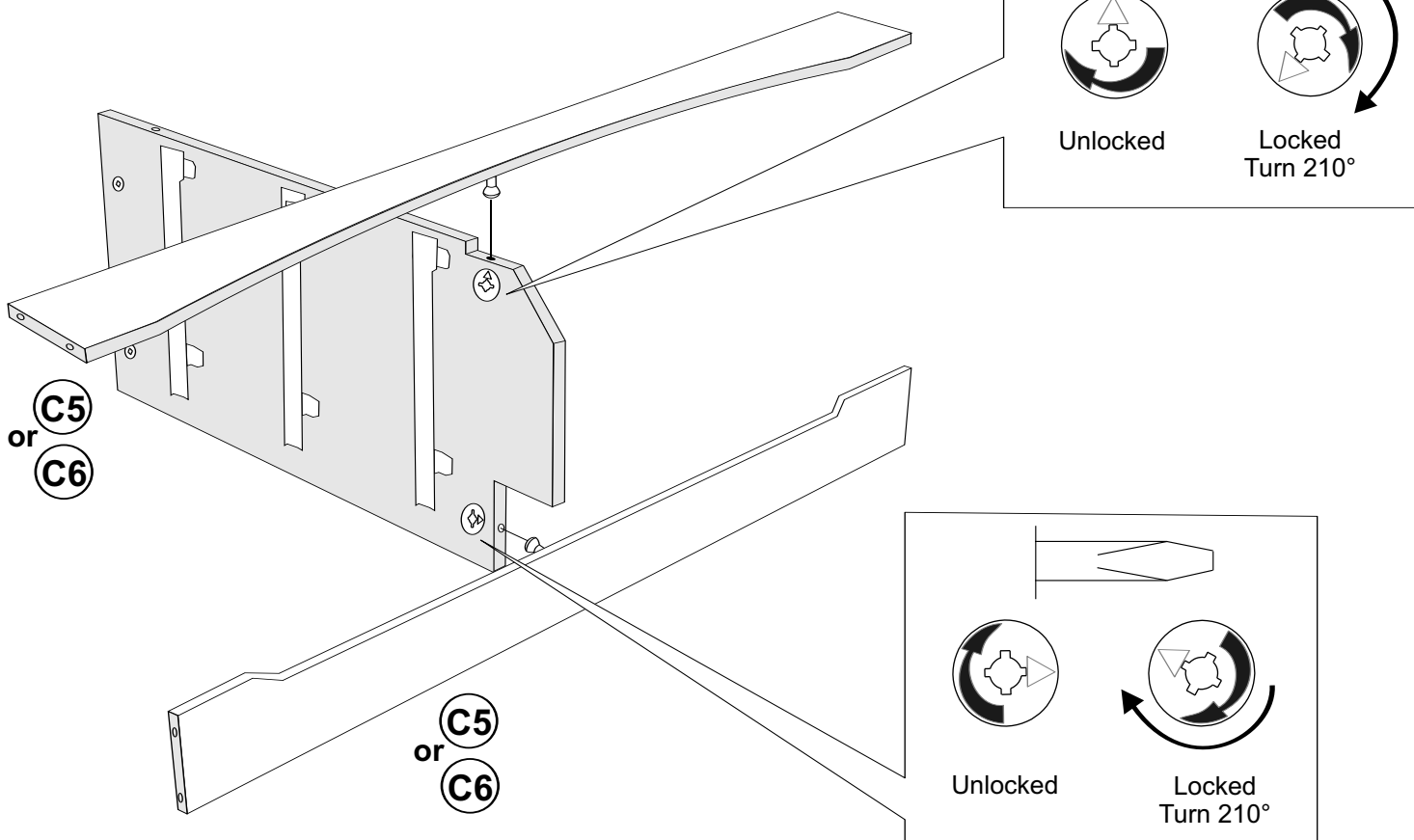

STEP 6 Estimated Time: 10 minutes

Attach both stabilizers to left and right sides using Confirmat screws. Insert screw cover caps to finish.

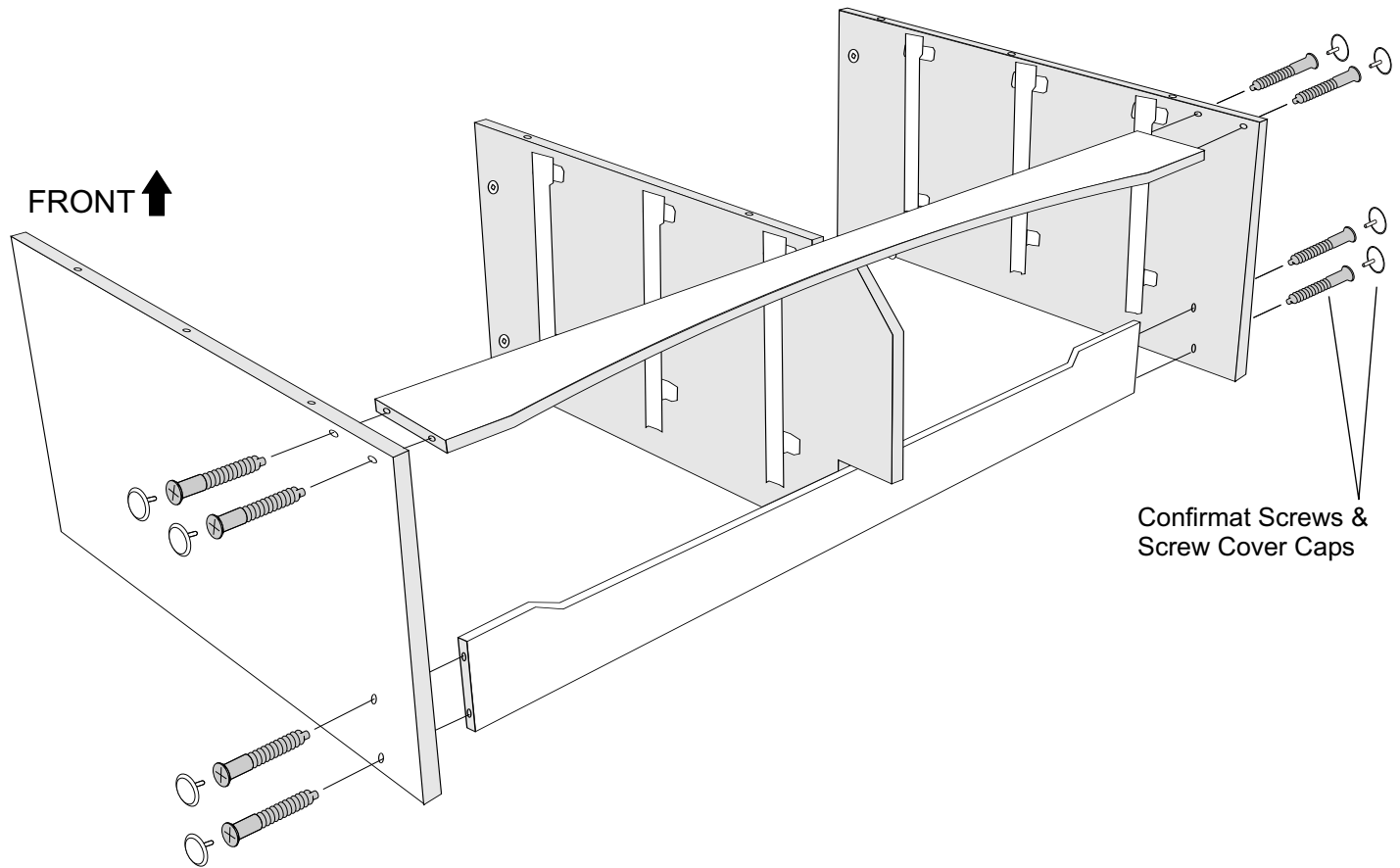

STEP 7 Estimated Time: 3 minutes

Hammer plastic dowels halfway into side, center and top moldings

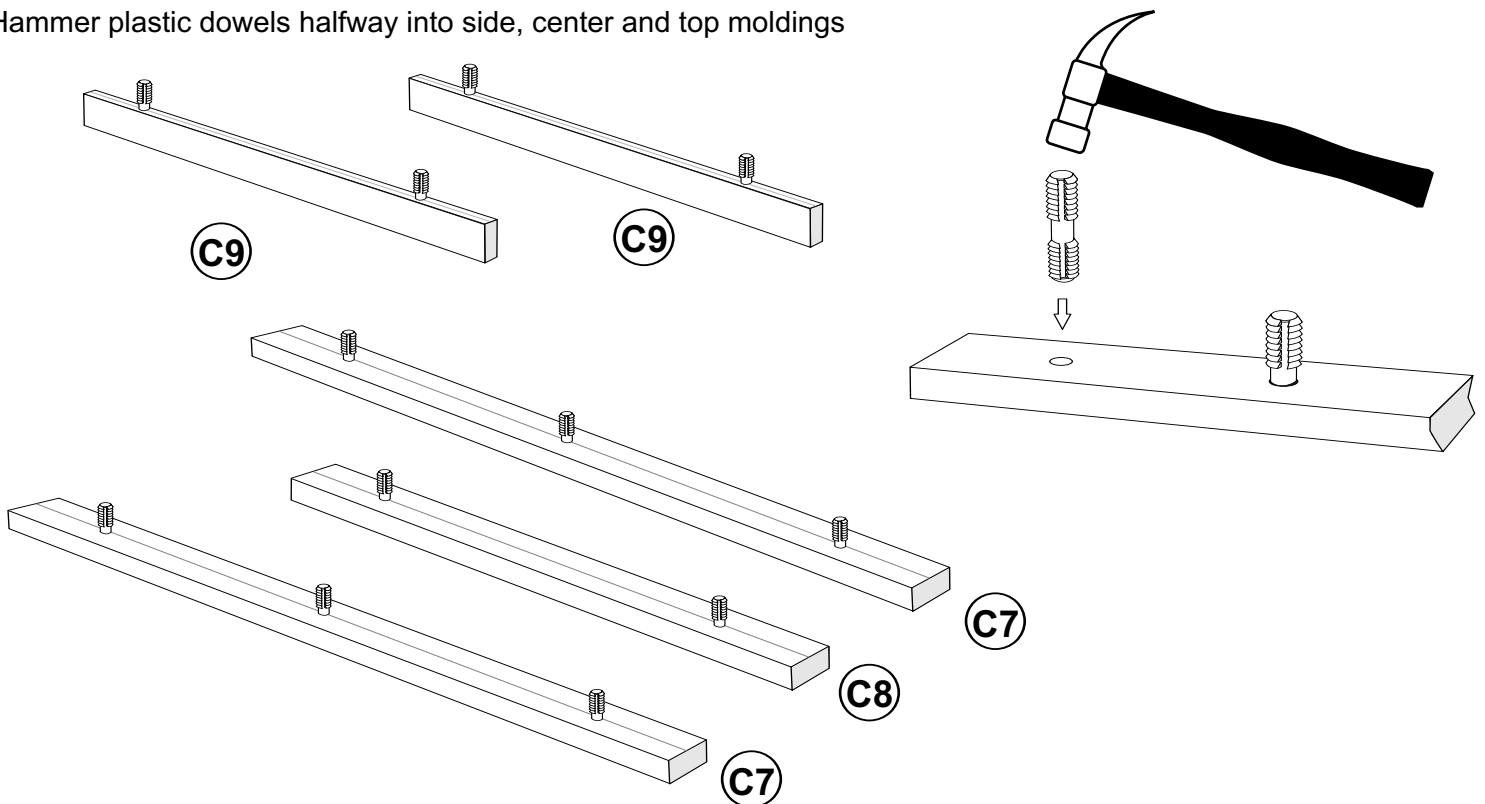

STEP 8 Estimated Time: 2 minutes

Screw green twister dowels into the underside of the top

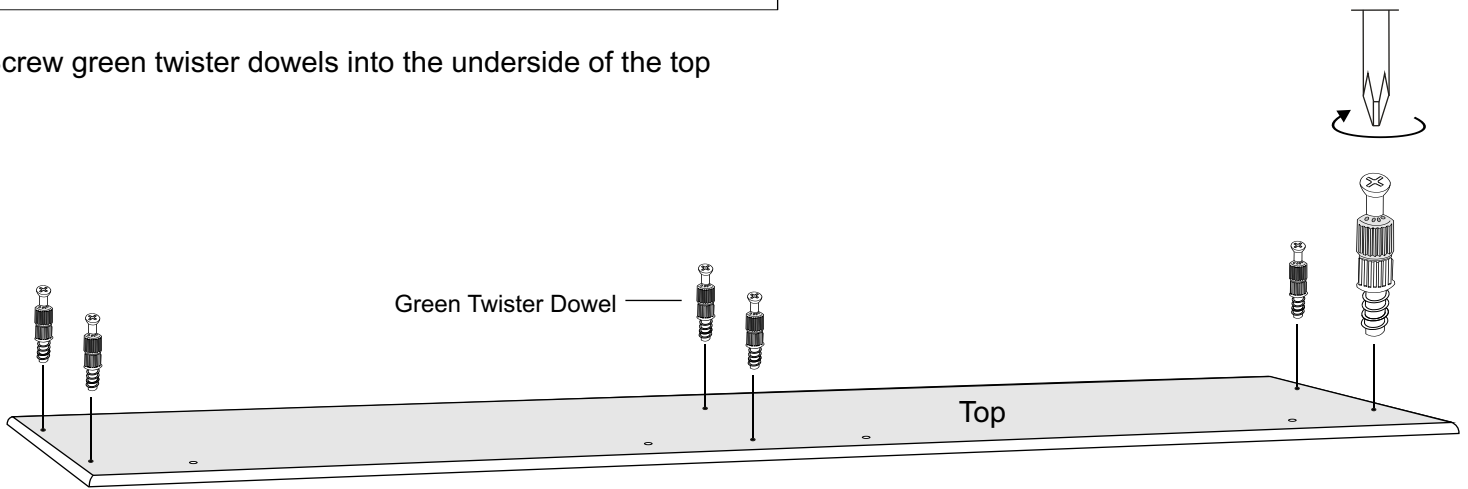

STEP 9 Estimated Time: 2 minutes

Attach top to sides and lock cams using a flat head screwdriver

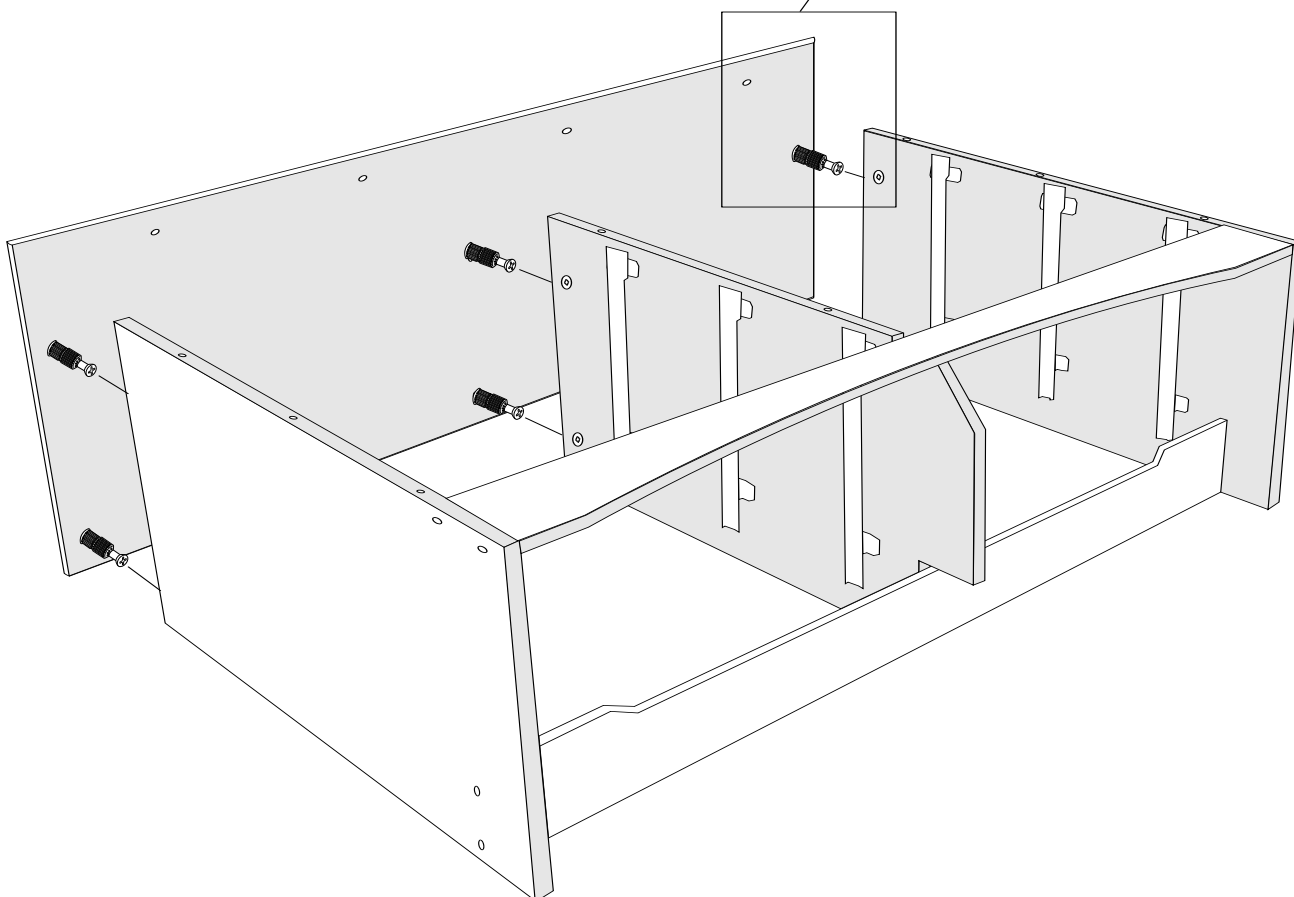
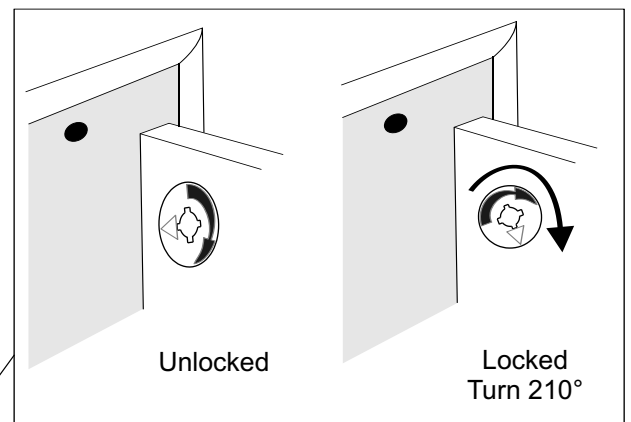
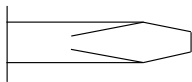

STEP 10 Estimated Time: 3 minutes

Attach top & side moldings.

Using your hands, apply even pressure to moldings and press firmly

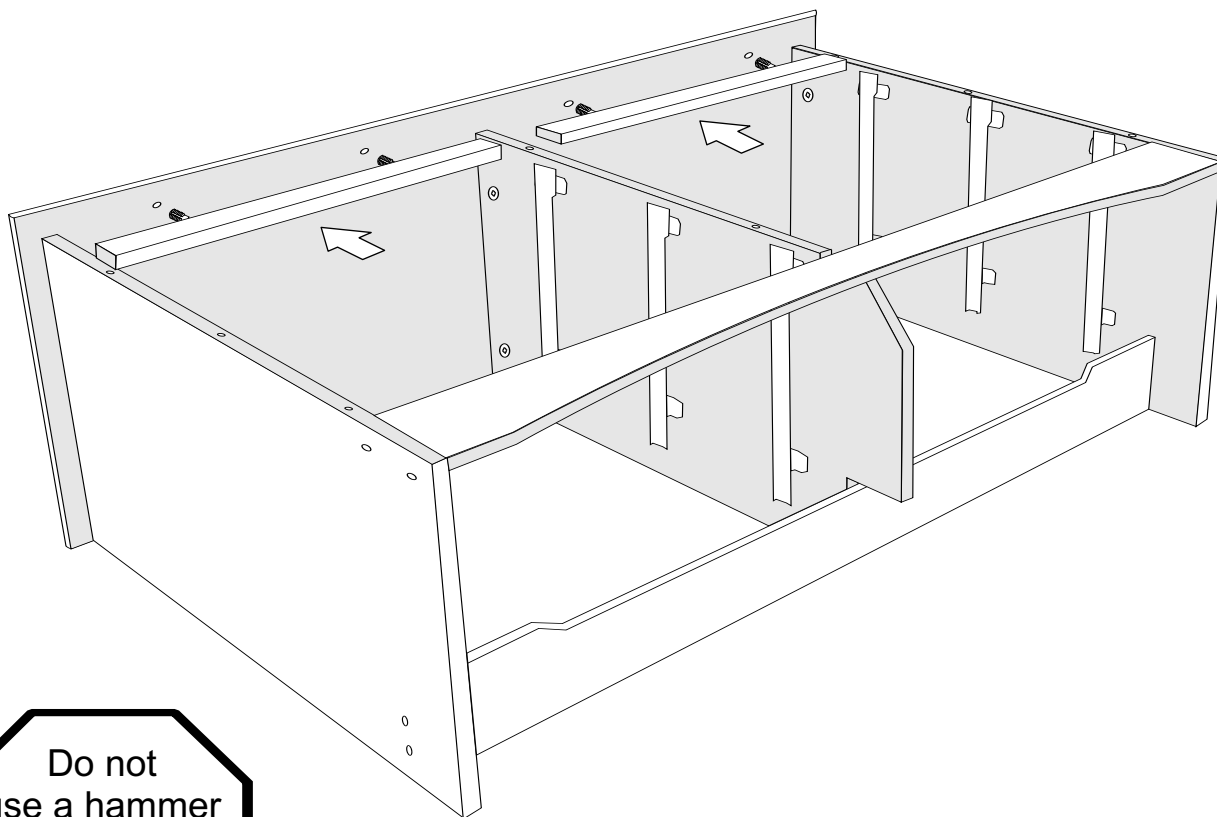

Do not
use a hammer

It may damage
the molding

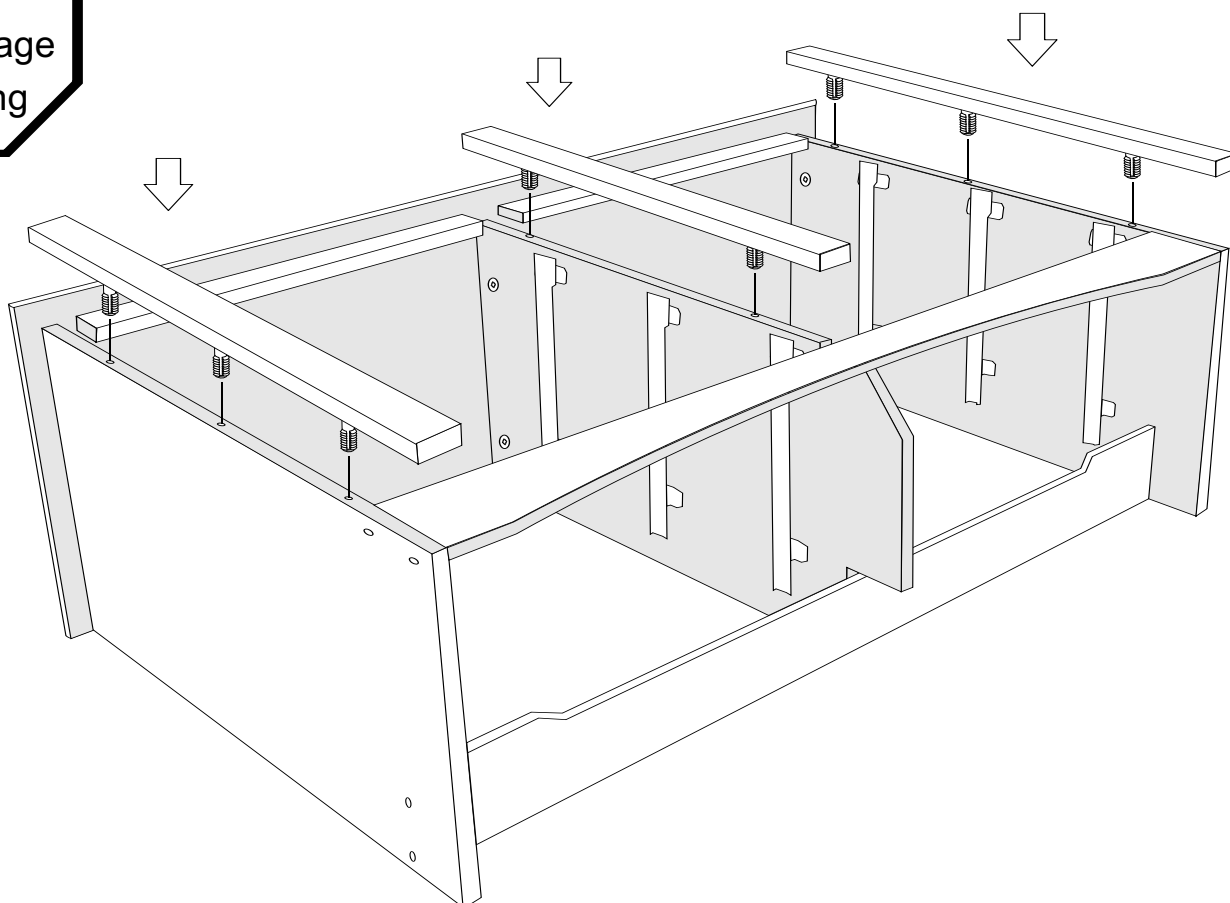

STEP 11 Estimated Time: 4 minutes

Carefully turn dresser over and attach backer and levelling feet

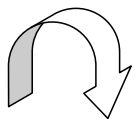

Nail backer as indicated. You may have more nails than are necessary

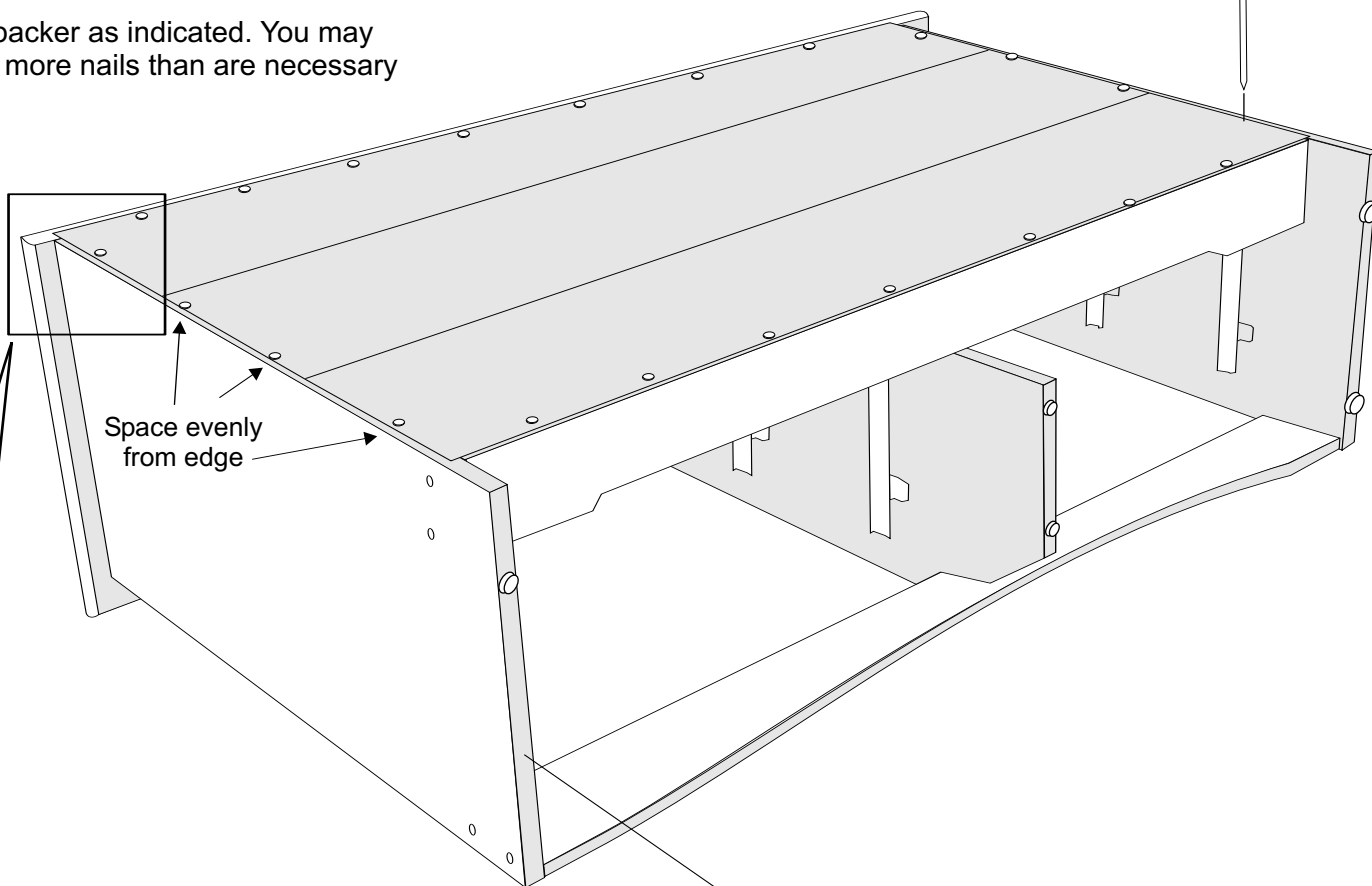

Space evenly from edge

Position nails in the center of the board

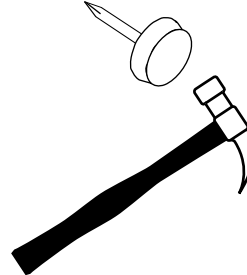
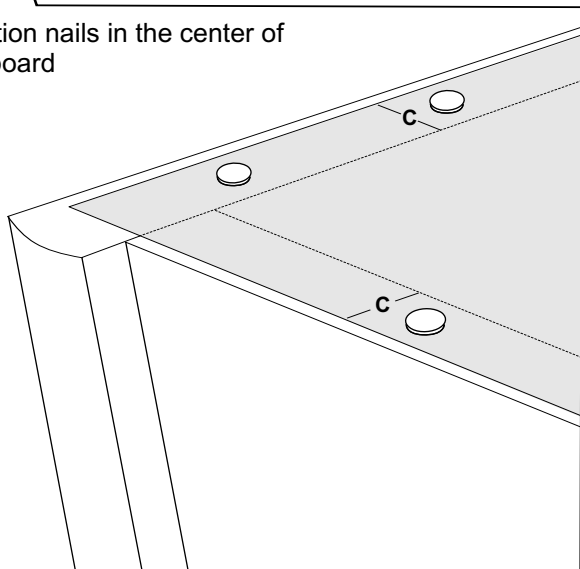

Hammer 2 levelling feet on the bottom edge of each side and the center divider

NOTE:

Do not stand unit up without the backer fastened

Drawer Parts Identification

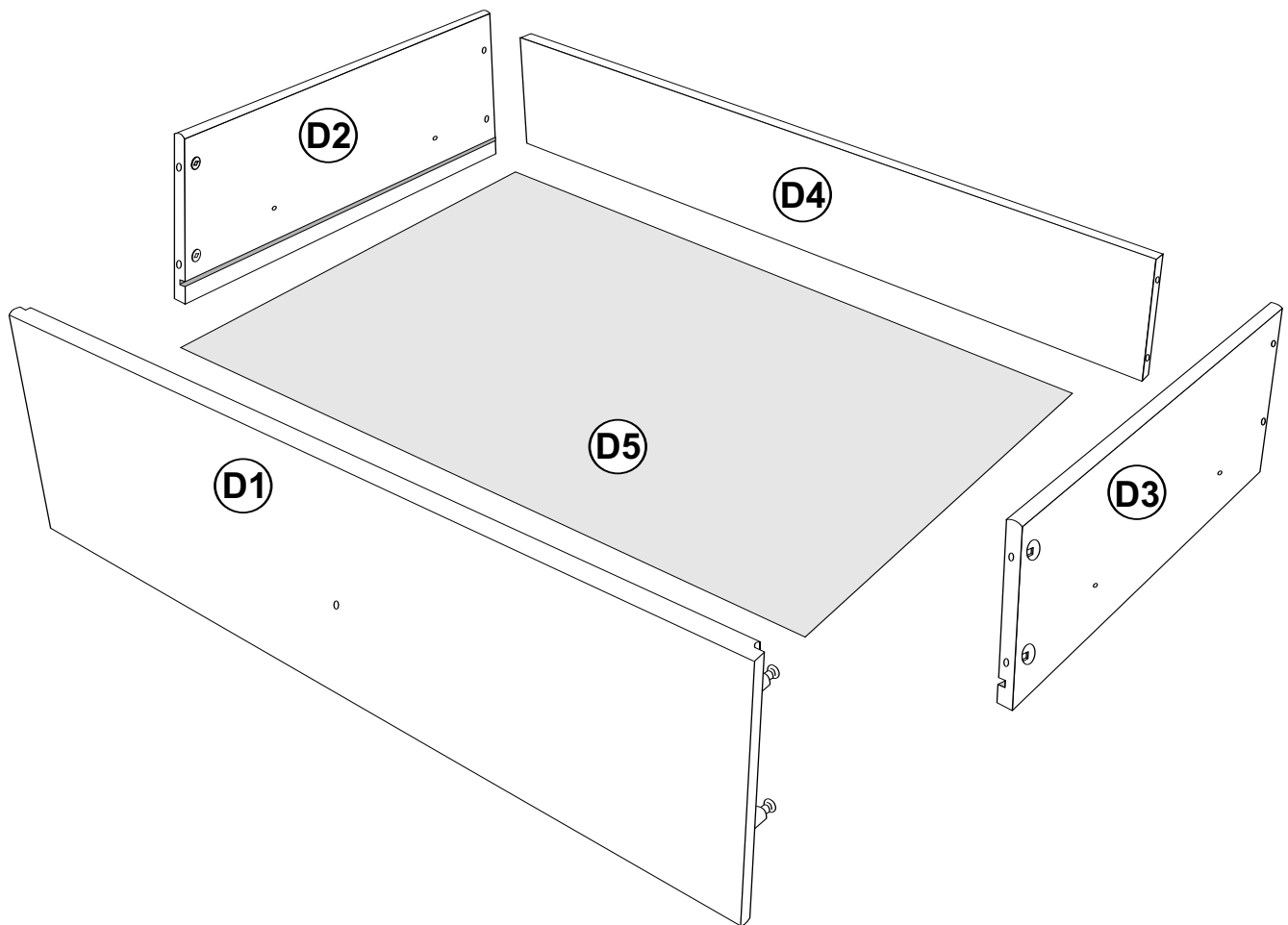

(D1)

Drawer Front (6)
DF-0477 maple
DF-0417 black
DF-0407 white
DF-0497 cherry

(D2)

Left Drawer Side (6)
DS-0412-L
 Unfinished

(D3)

Right Drawer Side (6)
DS-0412-R
 Unfinished

(D4)

Drawer Back (6)
DK-0416
 Unfinished

(D5)

Drawer Bottom (6)
DB-0416
 Unfinished

STEP 12 Estimated Time: 5 minutes PER DRAWER

12a Insert cams into drawer sides

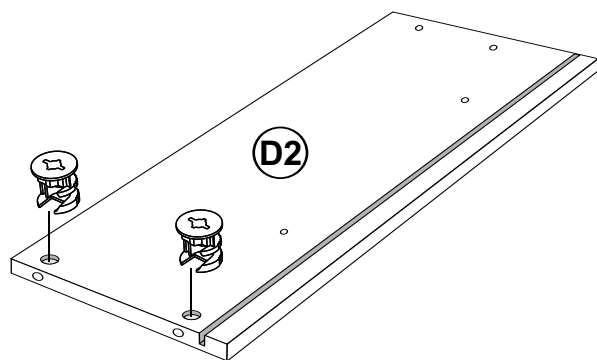

Left Drawer Side

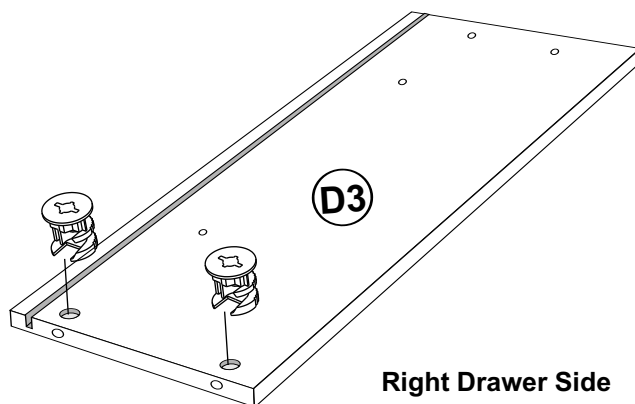

Right Drawer Side

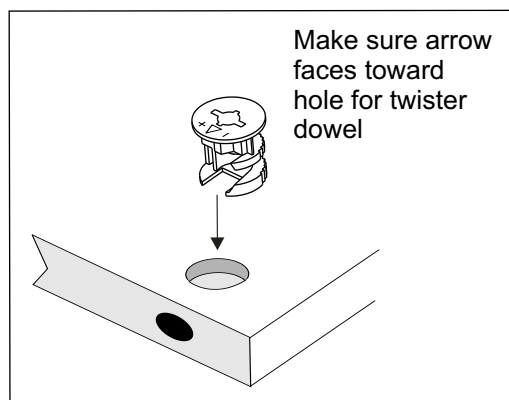

12b Screw green twister dowels into drawer fronts

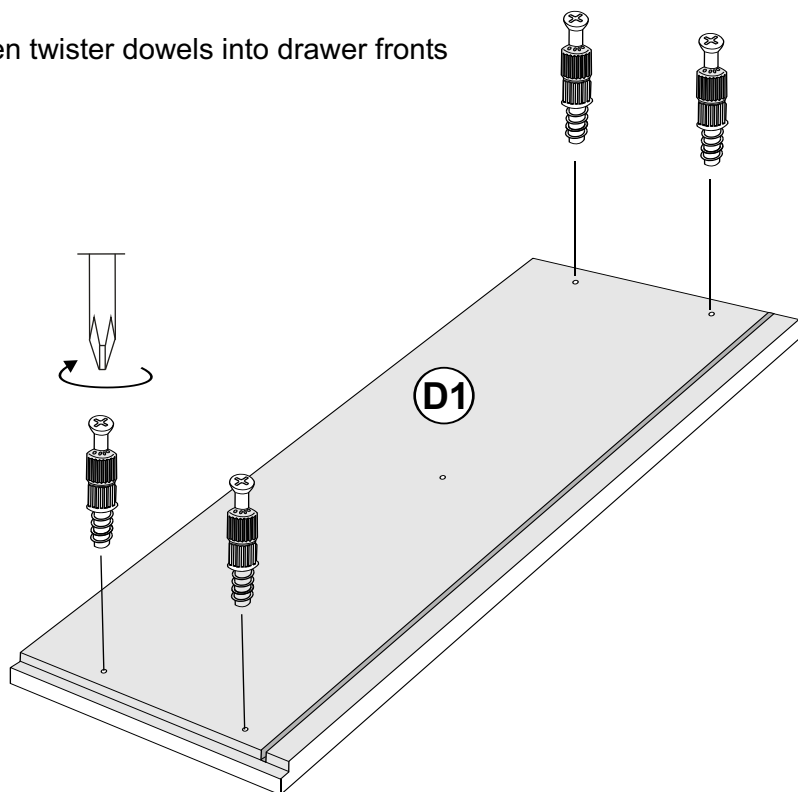

12c Attach drawer sides to drawer back with 1½" Hi Lo screws

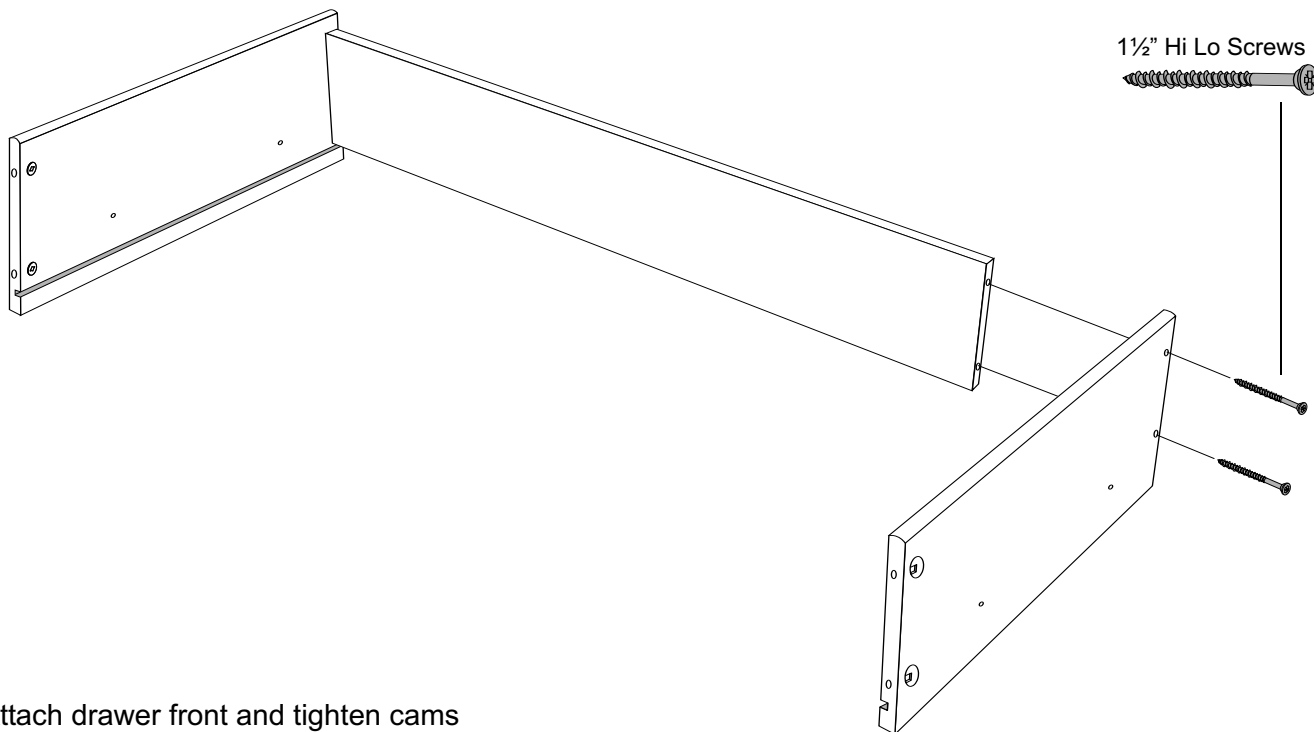

12d Attach drawer front and tighten cams using a flat head screwdriver

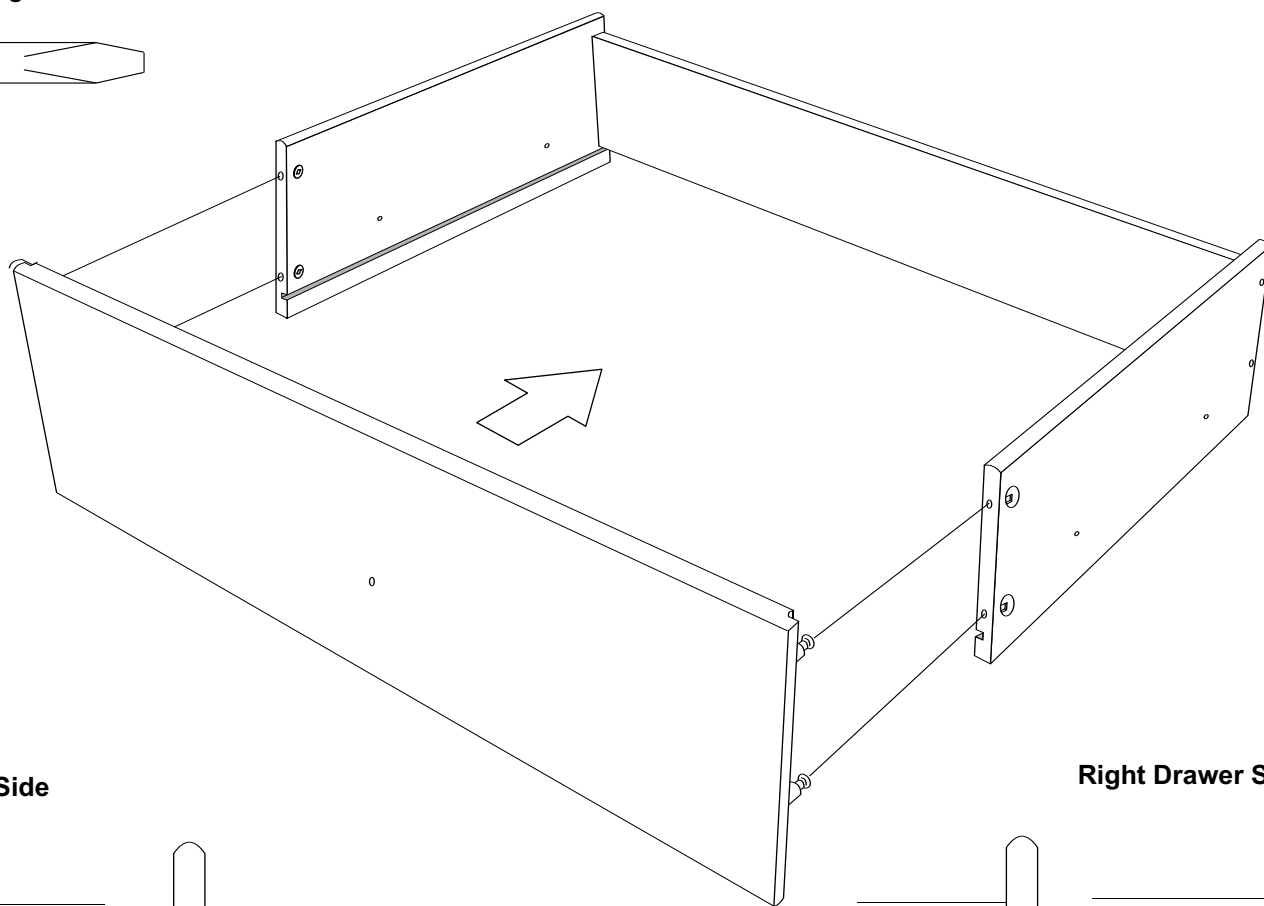
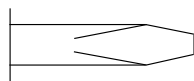

Left Drawer Side

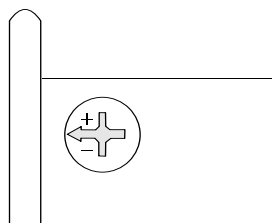

Unlocked

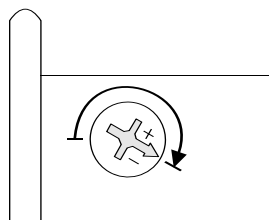

Locked
Turn 210°

Right Drawer Side

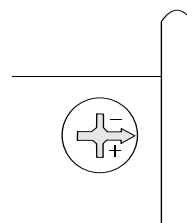

Unlocked

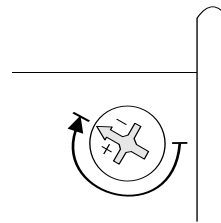

Locked
Turn 210°

12e Turn drawer upside down and slide drawer bottom into grooves

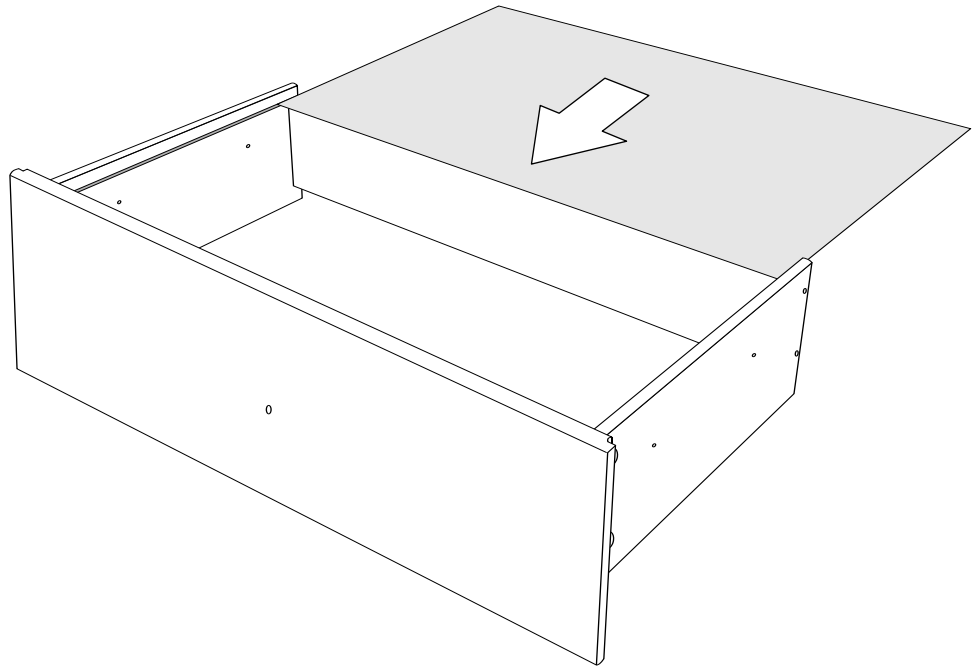
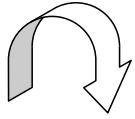

12f Secure the drawer bottom to the drawer back with nails

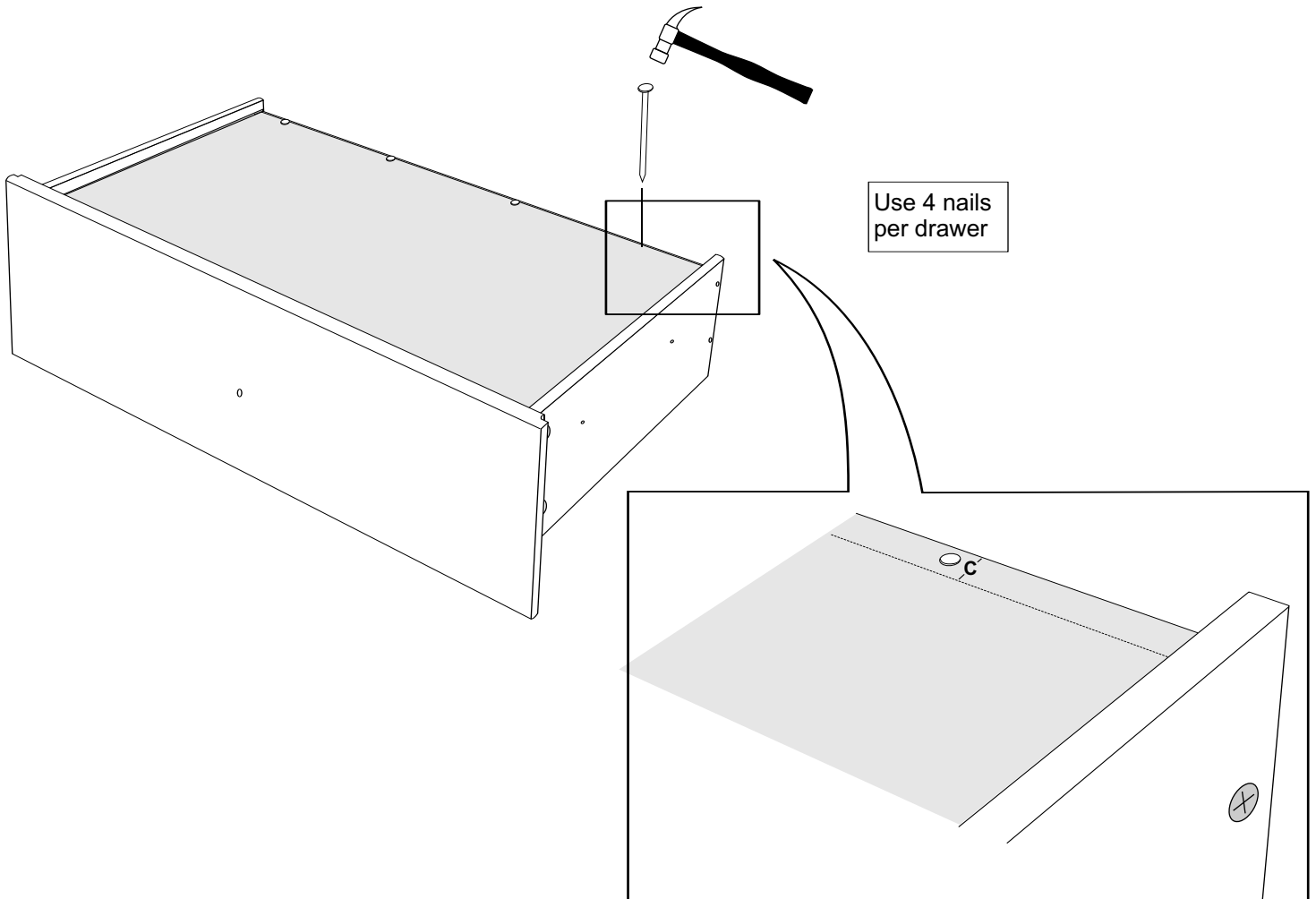

12g Attach drawer slides to left and right drawer sides using drawer slide screws

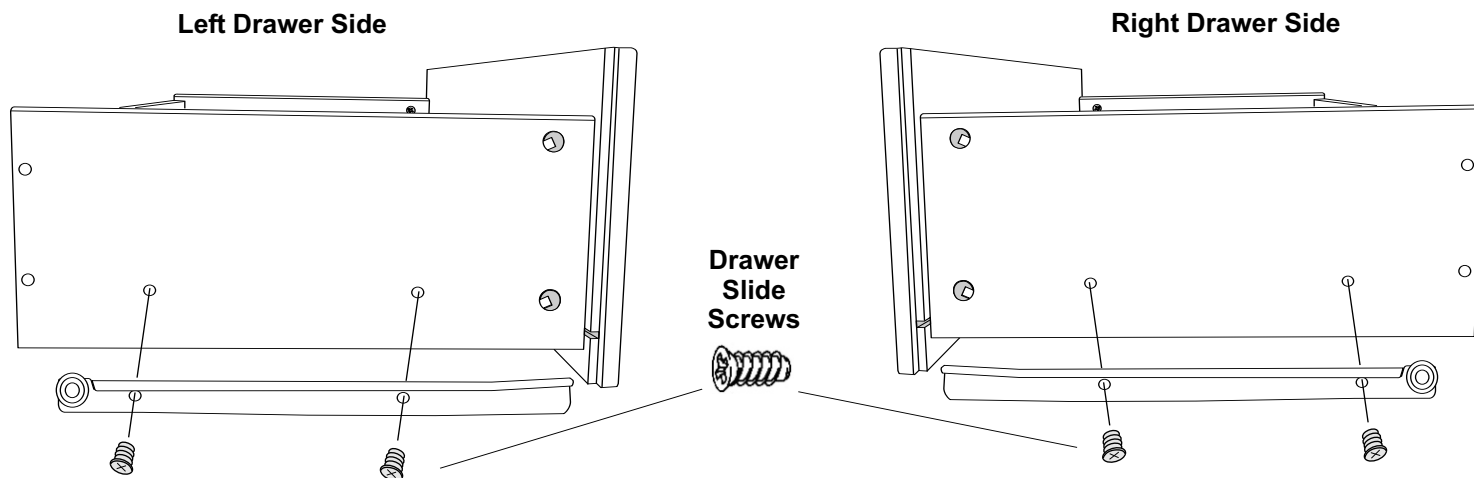

12h Attach knobs with machine screws

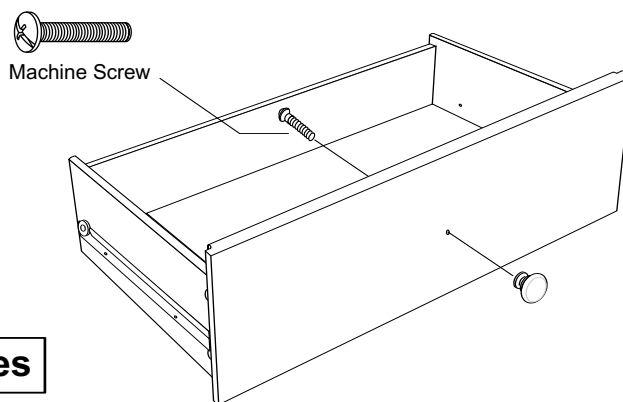

STEP 13 Estimated Time: 2 minutes

Insert drawers

A.

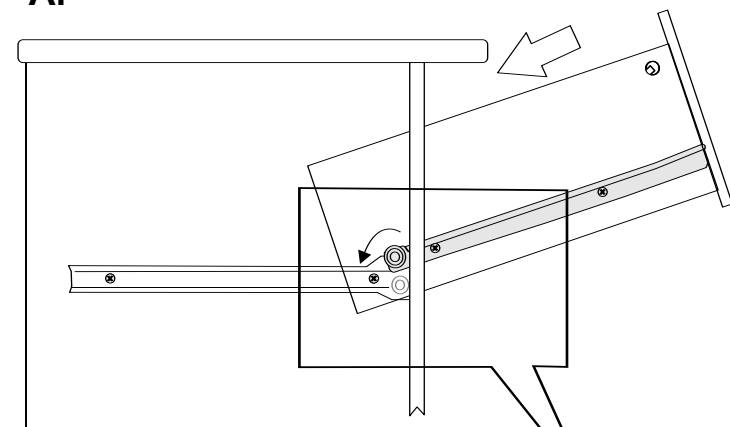

B.

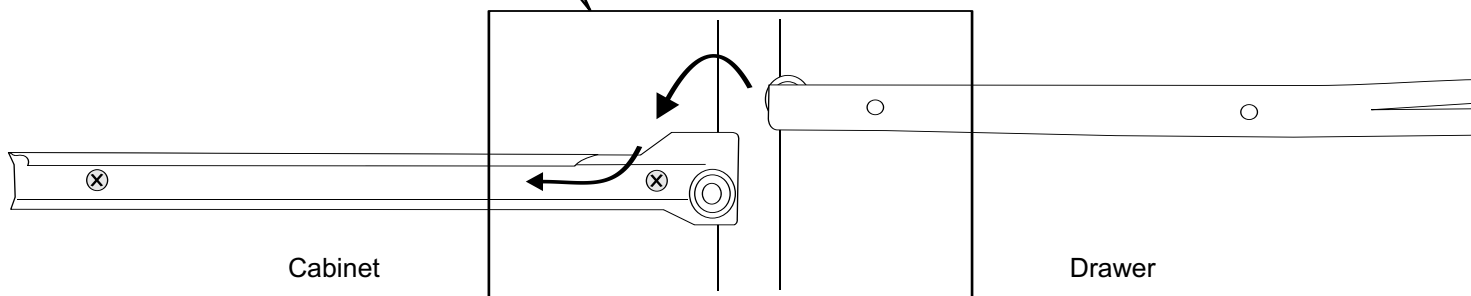
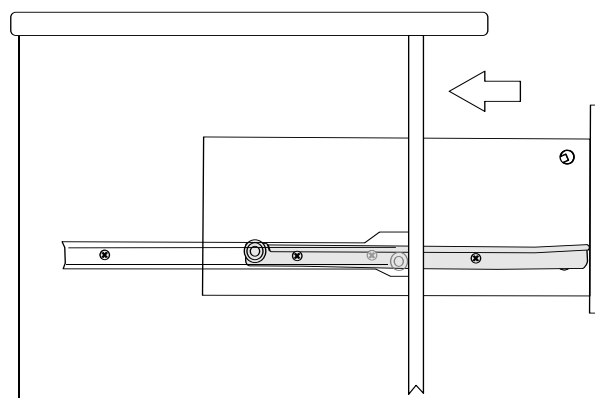

Note: When drawers are installed correctly, you will not be able to remove them without first lifting up the drawer front.

STEP 14 Attaching and Using the Safety Strap

We strongly recommend using a safety strap on all furniture, especially if small children have access

Secure product to wall using the Safety Strap and a screw suitable for your wall (**Not supplied**)*

We recommend you screw into a stud. If you cannot locate a stud use a wall anchor appropriate for your type of wall.

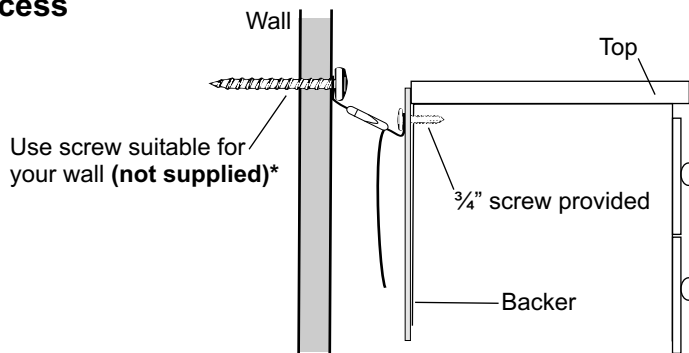

Attach one end of safety strap to one of the sides



Attach the other end to the wall

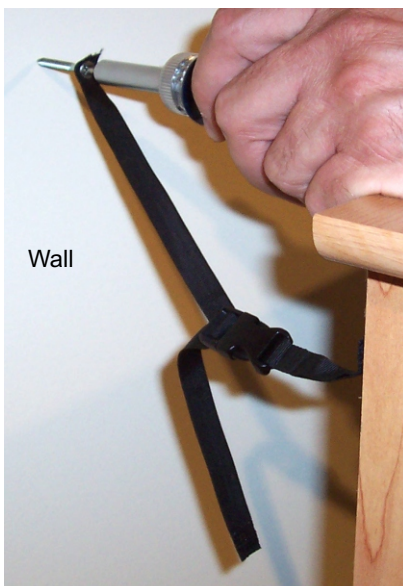

Pull remaining strap to tighten

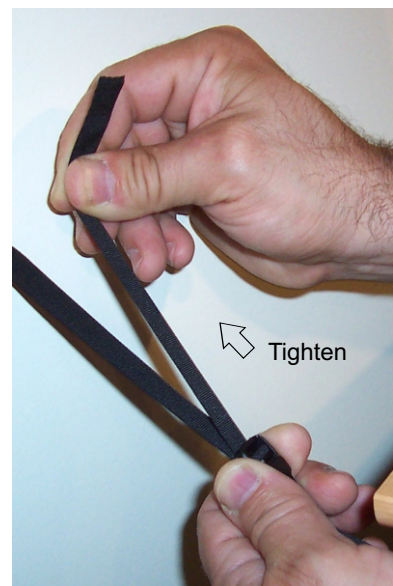

Furniture Care Q&A

Q. How do I clean your products?

A. We recommend that you simply wipe your products with a clean, damp cloth and then dry immediately with another clean cloth to maximize the life span and look of your unit

Q. Can I paint or varnish your products?

A. Our products are made from durable composite woods with a laminate finish and therefore should not be painted or varnished.

Q. Are they waterproof?

A. NO. If liquid is spilled and quickly wiped up, no damage will be done to your product. However, continuous exposure to liquids or high humidity may cause damage to the board.