



Liberty Furniture
INDUSTRIES, INC



ASSEMBLY INSTRUCTION

ITEM#: **244 - HB6642**

DESCRIPTION: **HALL BUFFET**

Thank you for purchasing this quality product. Be sure to check all packing material carefully for small parts which may have come loose inside the carton during shipment. Identify and count all parts and compare with the parts List Below:

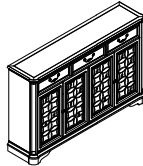
PART LIST:

①		②	
HALL BUFFET: 1PC		WOOD PANEL: 4PCS	

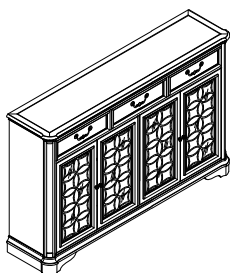

OPTIONAL ANTIQUE
MIRRORED GLASS

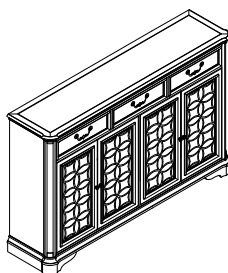

OPTIONAL
WOOD DOOR

HARDWARE LIST

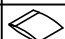
NO.	Drawing	Description	Q'ty
A		Furniture Tipping Restraint	1 Set

HOW TO REMOVE DRAWER

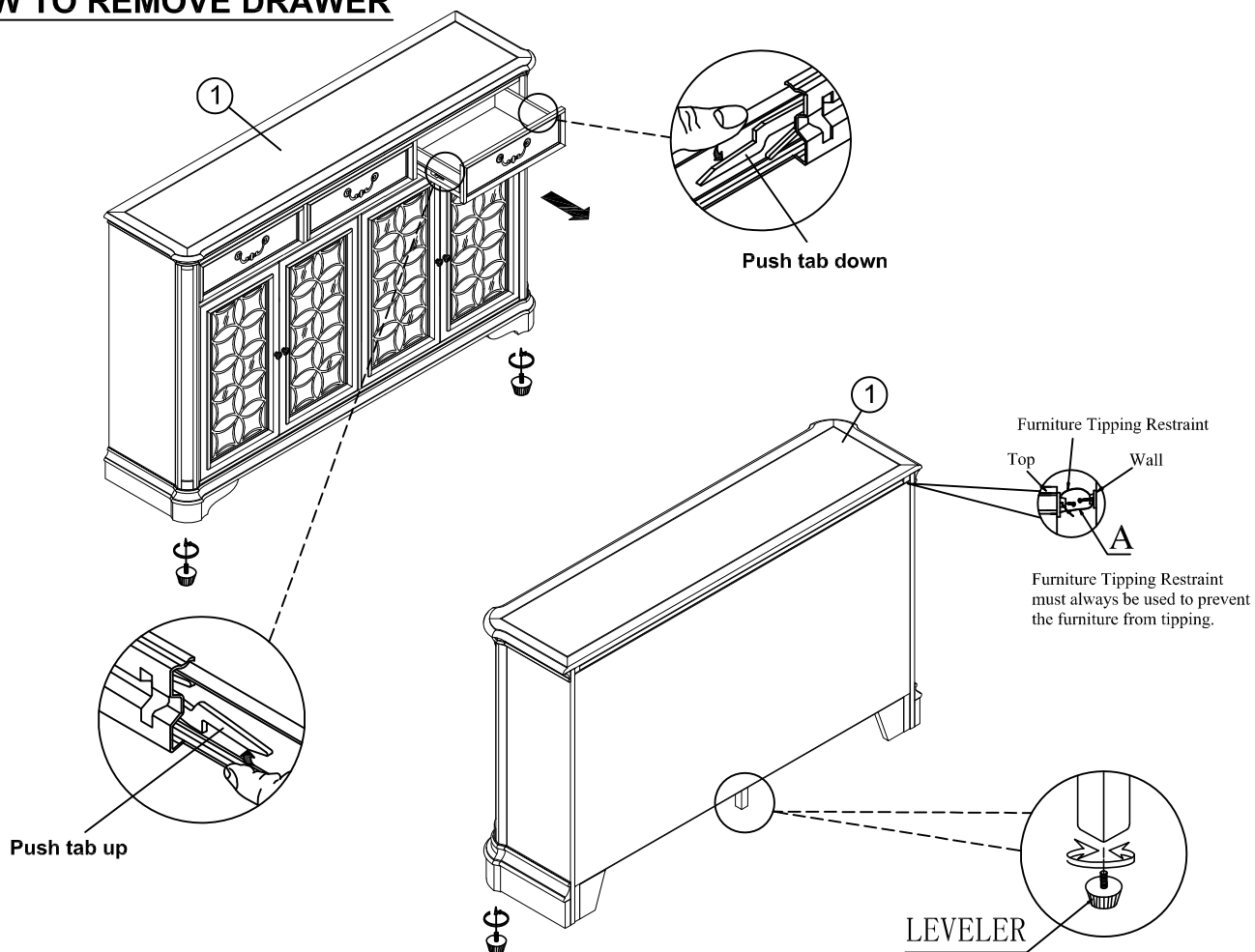

CLEANING INSTRUCTION

Clean the Hall Buffet surface with a furniture polish and a soft cloth.

Made in VietNam

ASSEMBLY INSTRUCTION

DESCRIPTION: HALL BUFFET

ITEM#: 244 - HB6642

OPTIONAL WOOD PANEL

NOTE:

- Optional wood door panel is located inside the door, behind the mirrored panel. To install, unscrew the back panel and switch out the mirrored panel and place the wood panel in front. Attach the back panel with screws and tighten.

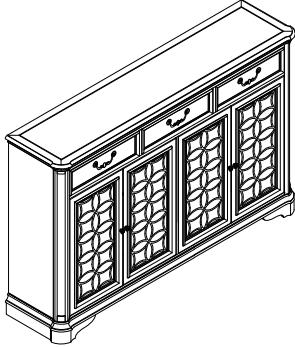

STEP 1: Open the door back panel

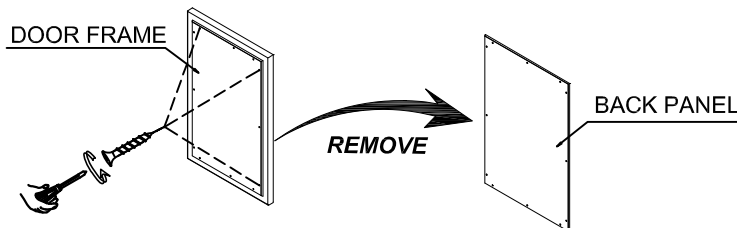

STEP 2: Remove antique mirrored glass

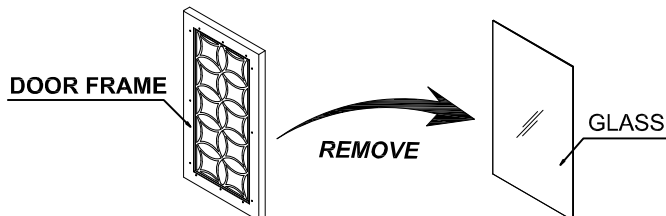

STEP 3: Insert wood panel

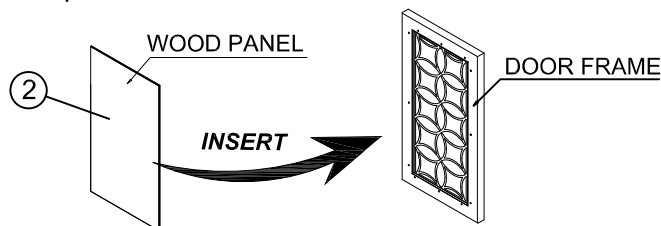

STEP 4: Attach the door back panel with decorative screw

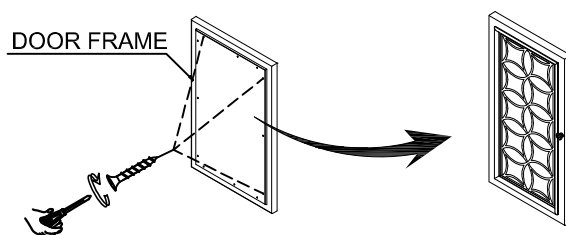

CLEANING INSTRUCTION

Clean the Hall Buffet surface with a furniture polish and a soft cloth.