

ST181

VISTA TASK CHAIR

OPERATING INSTRUCTIONS

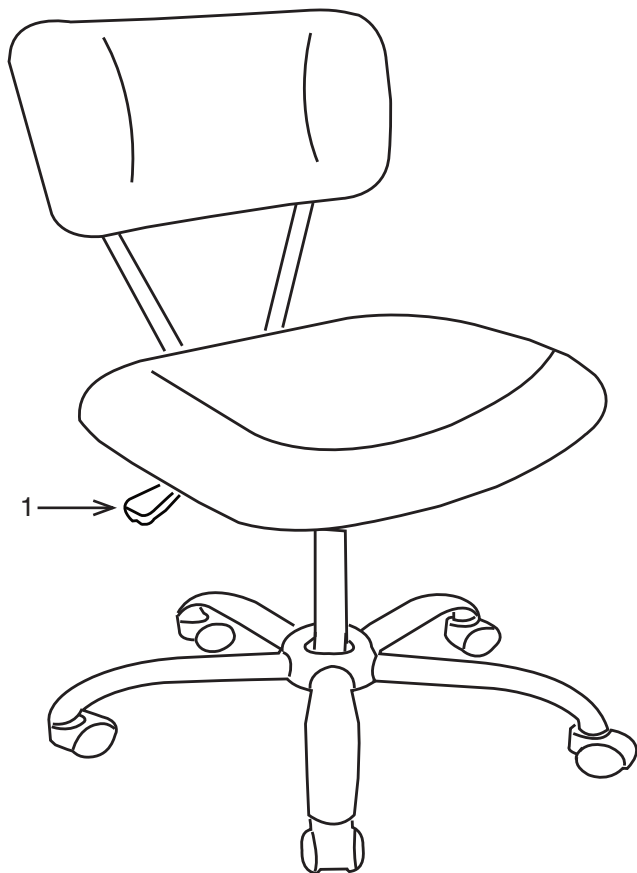

FEATURE

- **SEAT HEIGHT ADJUSTMENT**

To raise seat height, remove pressure from seat and lift lever (1) up. To lower seat height, sit on chair and lift lever (1) up.

NOTE: It is normal for chair to slightly lower under body weight.

WARNING

1. Do not use this product unless all screws are securely tightened.
2. Check that all screws are tight every three months or as needed.
3. Dispose of packing material properly. Do not use plastic cover as head covering. It may cause suffocation.
4. Do not use this product as a stepladder.
5. Use this product for its intended purpose only.
6. **Intended for residential use only.**

LIMITED WARRANTY

Office Star Products warrants to the original purchaser that this product will be free from defects in material and workmanship as described below. Office Star Products will repair or replace, at its option, without charge to the original purchaser only, defective products or parts for one (1) year from the date of purchase. Replacement parts can only be supplied if parts are available. Items out of production may be unavailable. This warranty shall be effective for the applicable time period beginning from the date of purchase as shown on your original sales receipt. This warranty is your sole remedy for product defects and excludes defects due to or arising in connection with product abuse or misuse, use modification of, or attachments to the product, and products or parts not used, maintained, or installed in accordance with the company's installation, maintenance and/or applicable guidelines. There are no other warranties, express or implied, other than those specifically described, including without limitation any implied warranty of merchantability or of fitness for a particular purpose. Office Star Products will not be responsible for incidental or consequential damages. Some states do not allow the exclusion or limitation of incidental or consequential damages, so the above limitations or exclusions may not apply to you. This warranty gives you specific legal rights and you may also have other rights which may vary from state to state. Our quality standards are among the highest in the industry. Sometimes, no matter how hard we try, there are times when parts are damaged or missing. Our Parts Department will do everything possible to promptly remedy the problem. Contact us via e-mail parts@officestar.net, by Fax 1-909-930-5629, or toll free parts number 1-800-950-7262, Monday through Friday 8:00 a.m. - 5:00 p.m. Pacific Time.

ST181

VISTA TASK CHAIR

ASSEMBLY INSTRUCTIONS

STEP 1

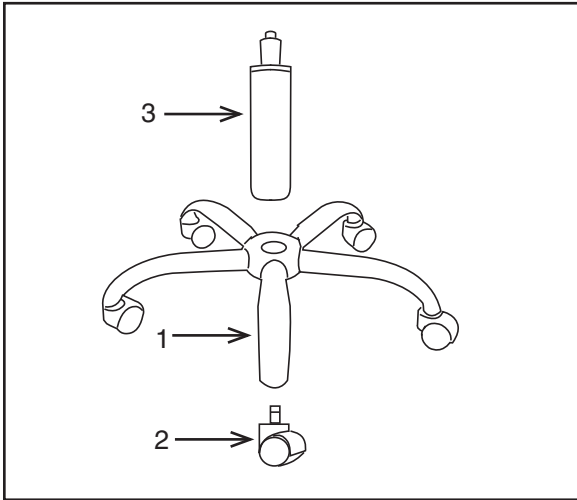

STEP 2

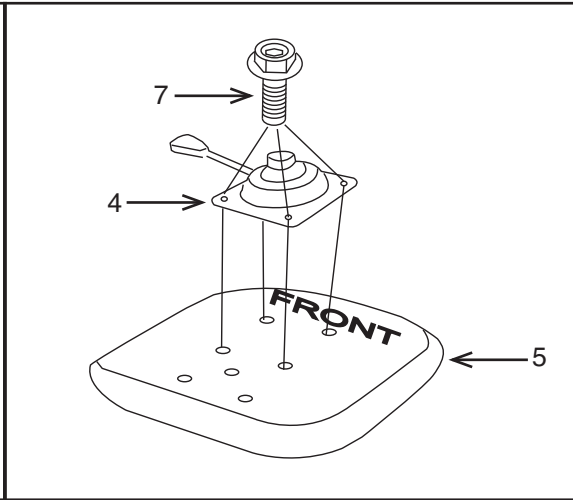

STEP 3

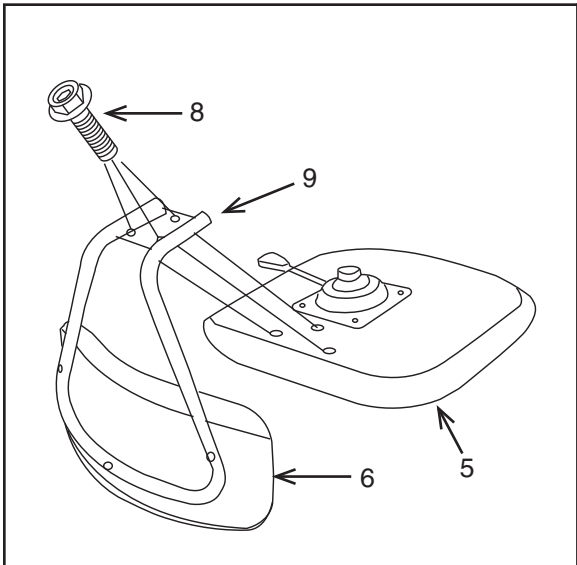

STEP 4

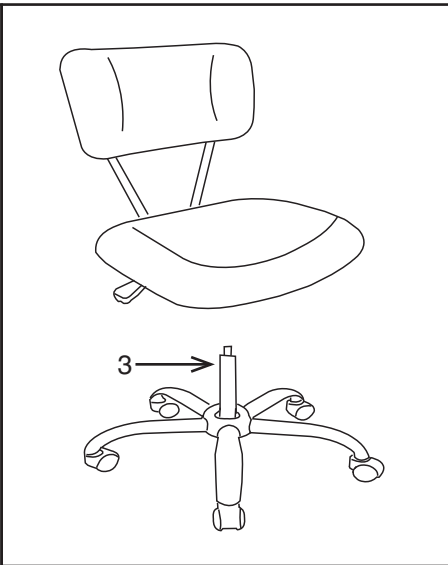

PART	QTY
1. Base	1
2. Casters	5
3. Pneumatic Cylinder	1
4. Seat Plate	1
5. Seat Cushion	1
6. Back Assembly	1
7. Seat Plate Screws	4
8. Back Support Screws	3
9. Back Support (pre-installed)	1
10 Allen Wrench (not shown)	1

Remove all the parts from carton, separate them into part numbers indicated on the list and make sure part quantities are correct.

STEP 1 Insert five Casters (2) into Base (1) be sure all casters are inserted and locked into place, insert Pneumatic Cylinder (3) into Base (1).

STEP 2 Attach Seat Plate (4) to Seat Cushion (5), with arrow towards the front, secure using four Seat Plate Screws (7). **FULLY TIGHTEN ALL SCREWS USING ALLEN WRENCH (10).**

STEP 3 Secure Back Support (9) to rear of Seat Cushion (5) using three Back Support (8). **FULLY TIGHTEN ALL SCREWS USING ALLEN WRENCH (10).**

STEP 4 Place assembled seat on Pneumatic Cylinder (3) and apply downward pressure.

ATTENTION: MAKE SURE ALL SCREWS ARE FULLY TIGHTENED BEFORE USING CHAIR.