

# ASSEMBLY INSTRUCTION OF CORNER DESK

ITEM NO. : 23610

## Wooden dowel installation

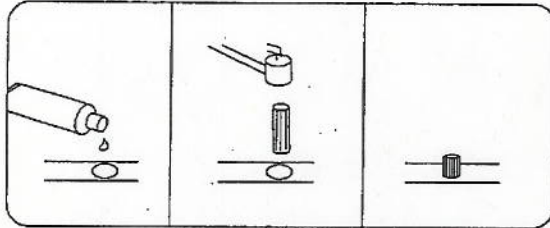

APPLY GLUE INTO PRE-DRILLED HOLE.  
AND GENTLY TAP WOOD DOWEL INTO  
THE HOLE WITH RUBBER Mallet.

\*GLUE-DO NOT PUT IN MOUTH

\*Before discarding packing materials, please check all parts and hardware are presented

\*Please follow the instruction closely, don't tighten screws or bolts unless instructed

\*After few days of initial assembly, the product may has acclimated to new environment, please tighten all hardware again

\*Do not use power tool to assemble this desk.

### TWO PERSONS REQUIRED

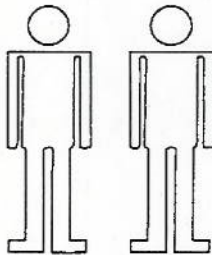

### WHEN FITTING CAMLOCKS

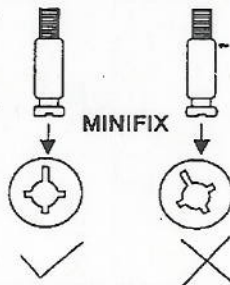

### TOOLS REQUIRED BUT NOT INCLUDED

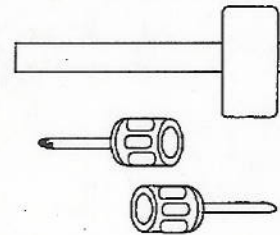

MADE IN CHINA

# ASSEMBLY INSTRUCTION OF CORNER DESK

ITEM NO. : 23610

## STEP 1

STEP 1.1: Turn the Camlock D at panel#7 clockwise 45 degree to hoop onto E (Do NOT fully Tighten the Camlock until Step 1.3)

STEP 1.2: Turn the Camlock D at panel#8 clockwise 45 degree to hoop onto E (Do NOT fully Tighten the Camlock until Step 1.4)

STEP 1.3: Turn the Camlock D another clockwise 45 degree at panel#7

STEP 1.4: Turn the Camlock D another clockwise 45 degree at panel#8

STEP 1.5: Firmly locked both Camlock D at panel#7&8. Warning-Do not over tighten the camlock. It will cause the cam lock to break

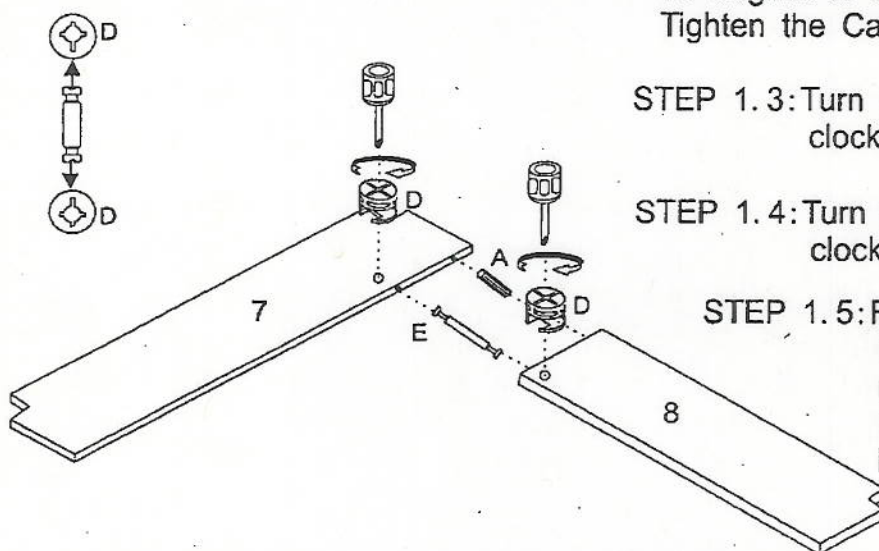

## STEP 2

Important: when Installing the plastic glide (I), make sure it's aligned to the top side of the drawer back (13)

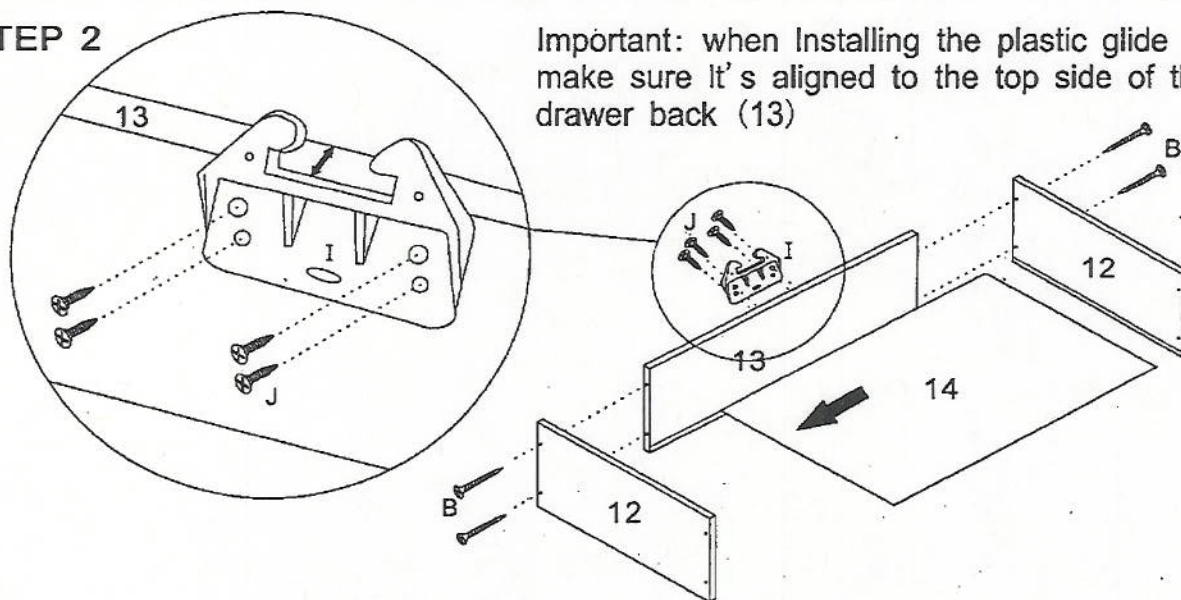

Assemble drawer plastic glide (I) to drawer backpanel (13) by using screw (J); Important: Please assemble screws on the TOP two holes then follow by the BOTTOM two holes.

Assemble drawer side walls (12), drawer backpanel (13) and drawer bottom panel (14) together by using screw (B). Tighten all screws

MADE IN CHINA



# ASSEMBLY INSTRUCTION OF CORNER DESK

ITEM NO. : 23610

## STEP 3

Assemble drawer front panel (11) to drawer by using screw (B)  
Assemble handle (G) to the drawer front panel (11) by using bolt (H). Tighten all bolts or screws

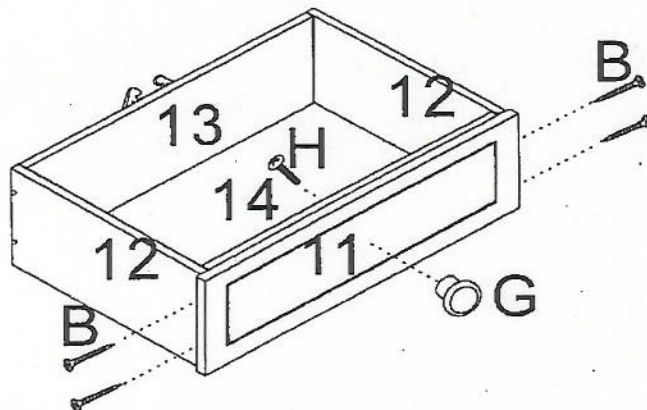

## STEP 4 DO NOT TIGHTEN SCREWS/BOLTS STEP11

Connect the leg (3) and the left side frame (2) by left apron (15), using bolt (F) and washer (C)

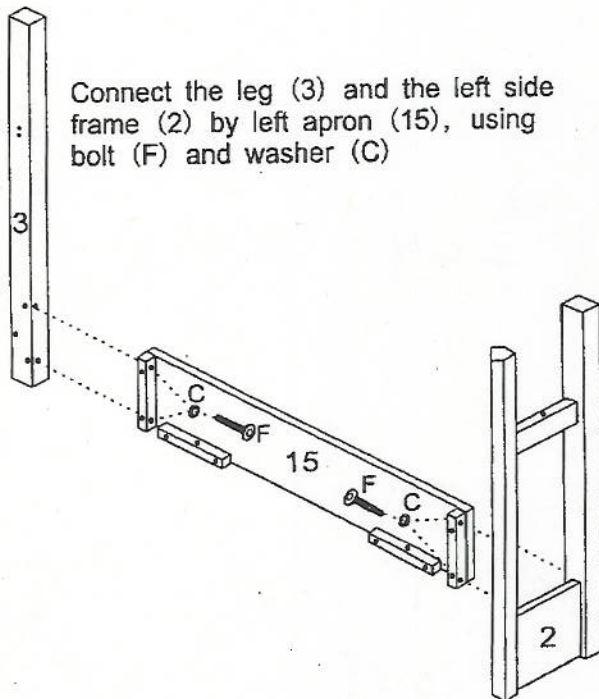

## STEP 5 DO NOT TIGHTEN SCREWS/BOLTS UNTIL STEP11

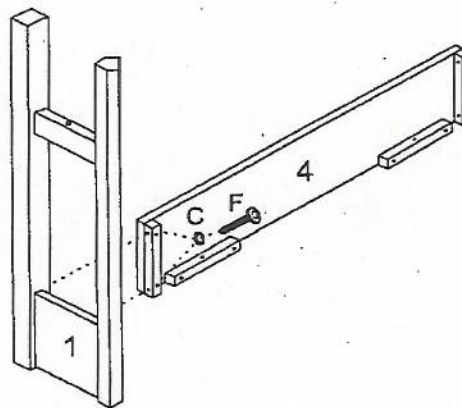

Joint the right side frame (1) and right apron (4) with bolt (F) and washer (C)

MADE IN CHINA

# ASSEMBLY INSTRUCTION OF CORNER DESK

ITEM NO. : 23610

## STEP 6 DO NOT TIGHTEN SCREWS/BOLTS UNTIL STEP11

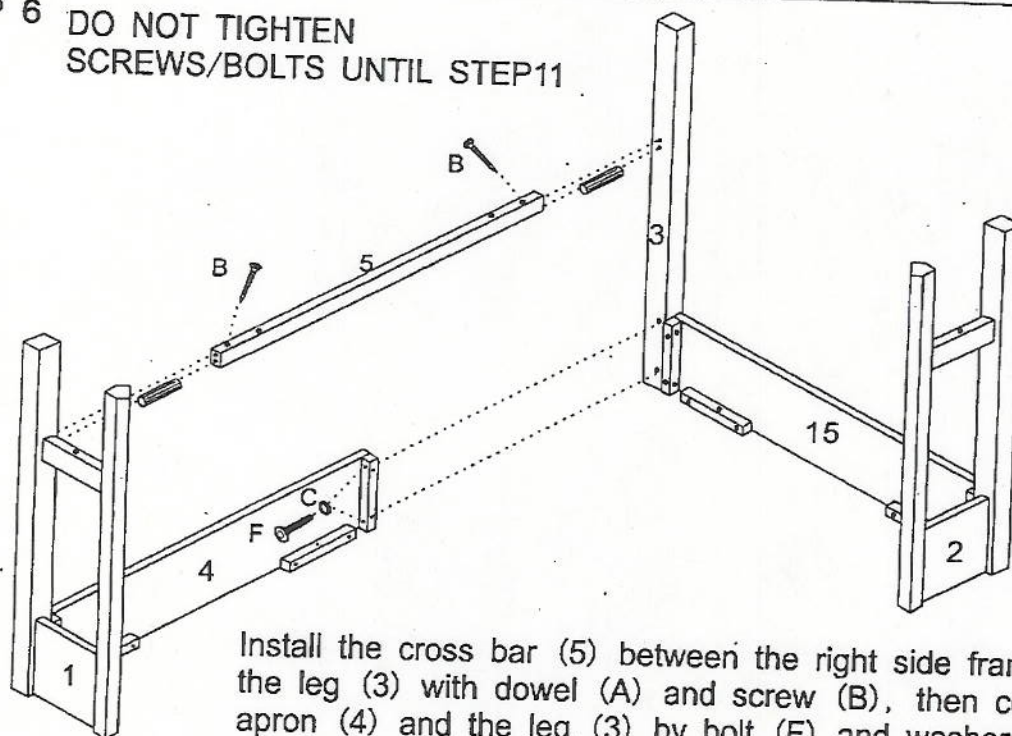

Install the cross bar (5) between the right side frame (1) and the leg (3) with dowel (A) and screw (B), then connect the apron (4) and the leg (3) by bolt (F) and washer (C)

## STEP 7 DO NOT TIGHTEN SCREWS/BOLTS UNTIL STEP11

Connect the right side frame (1) and left side frame (2) by the front frame (6), with screw (M)

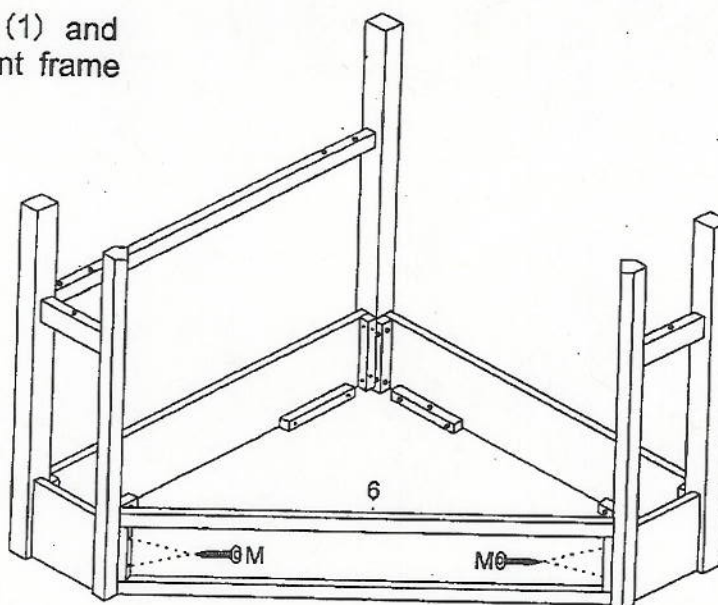

MADE IN CHINA

# ASSEMBLY INSTRUCTION OF CORNER DESK

ITEM NO. : 23610

## STEP 8

DO NOT TIGHTEN  
SCREWS/BOLTS UNTIL STEP11

On a soft, clean surface, turn the top panel (10) upside down, then install the unit from step 7 to the top, bolt (F) and washer (C)

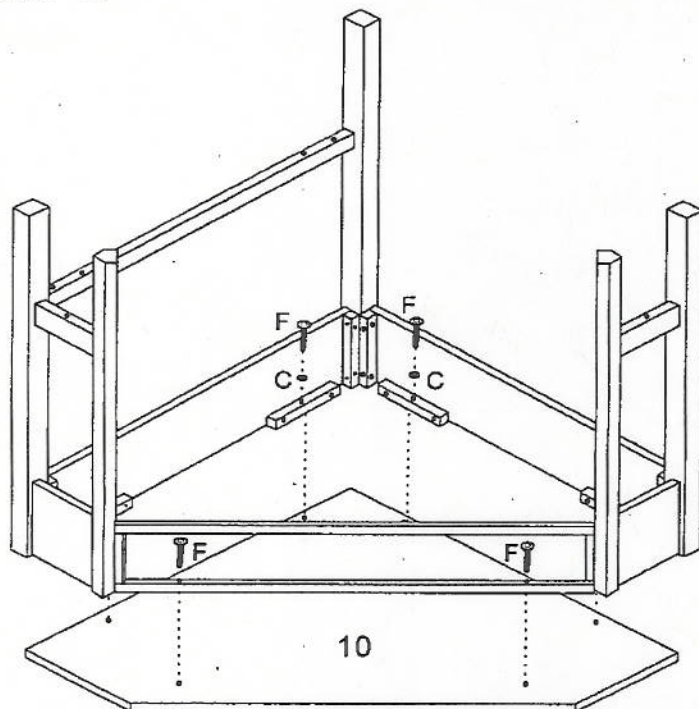

## STEP 9

DO NOT TIGHTEN  
SCREWS/BOLTS UNTIL STEP11

Attach the wooden drawer glide (9) to the back side of the top (10), with dowel (A) and screw (B)

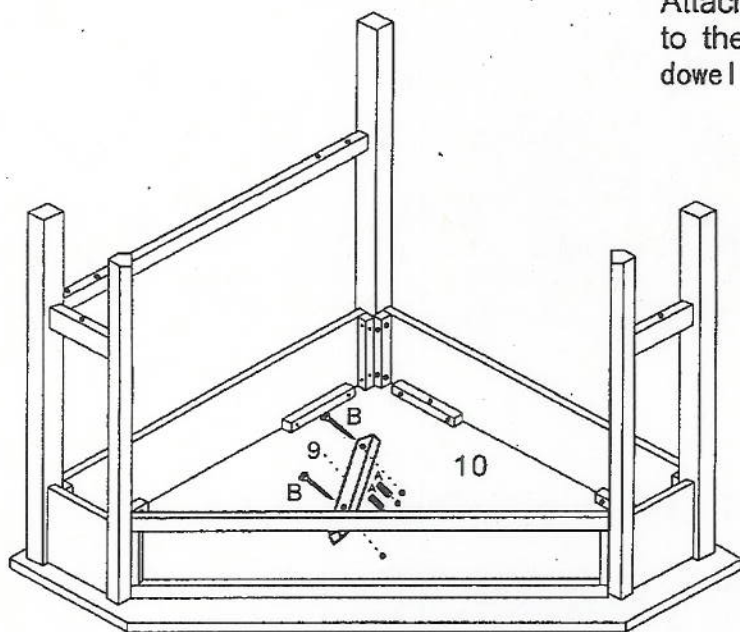

MADE IN CHINA



# ASSEMBLY INSTRUCTION OF CORNER DESK

ITEM NO. : 23610

## STEP 10

DO NOT TIGHTEN  
SCREWS/BOLTS UNTIL STEP11

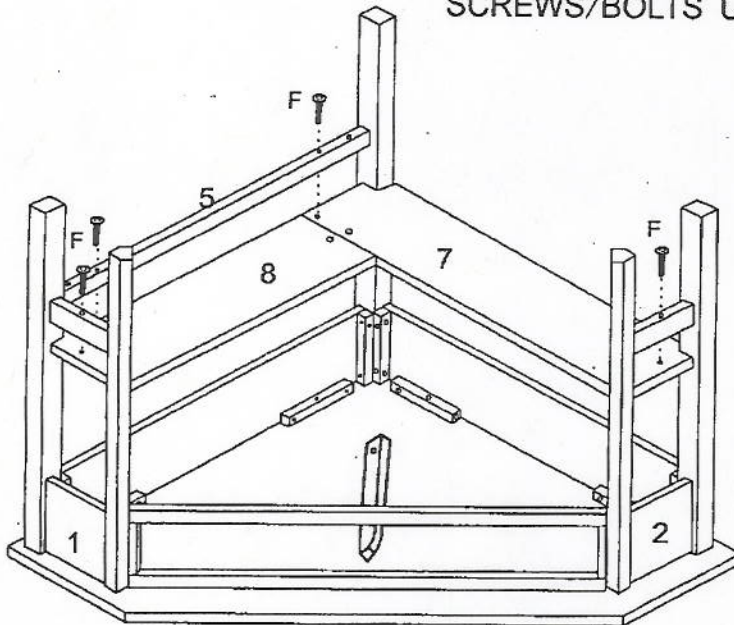

Install the shelves (7 & 8) to the  
cross bar (5), left side frame (1) and  
right side frame (2) by bolt (F)

## STEP 11

Adjust alignment & tighten all  
screws and bolts.

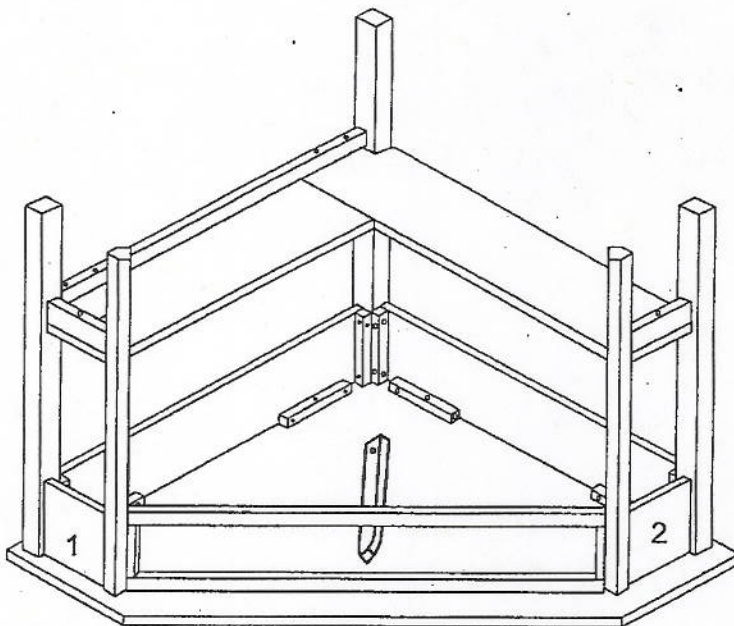

MADE IN CHINA

# ASSEMBLY INSTRUCTION OF CORNER DESK

ITEM NO. : 23610

## STEP 12

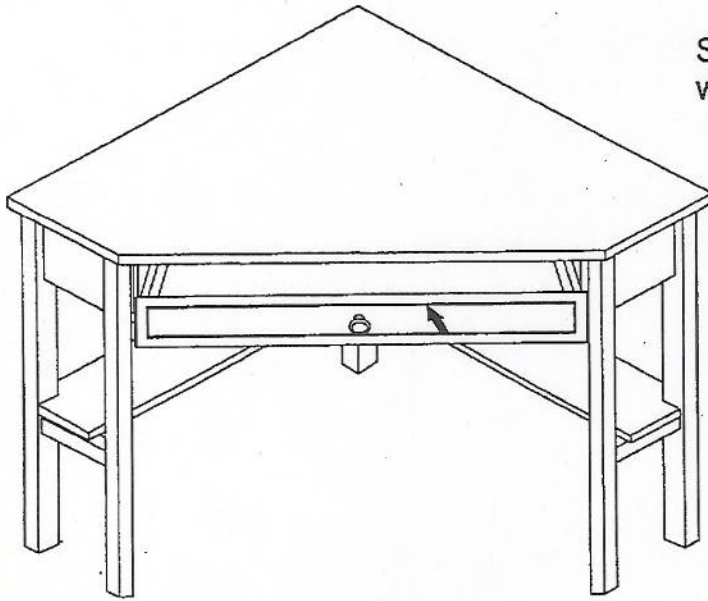

Slide the drawer at an angle to fix to wooden drawer glide (9).

## STEP 13

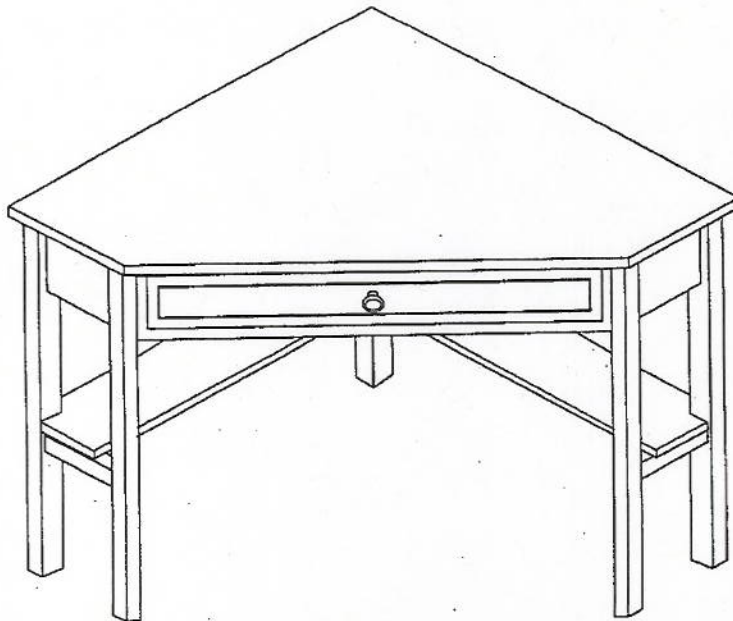

MADE IN CHINA



## ASSEMBLY INSTRUCTION OF CORNER DESK

ITEM NO. :23610

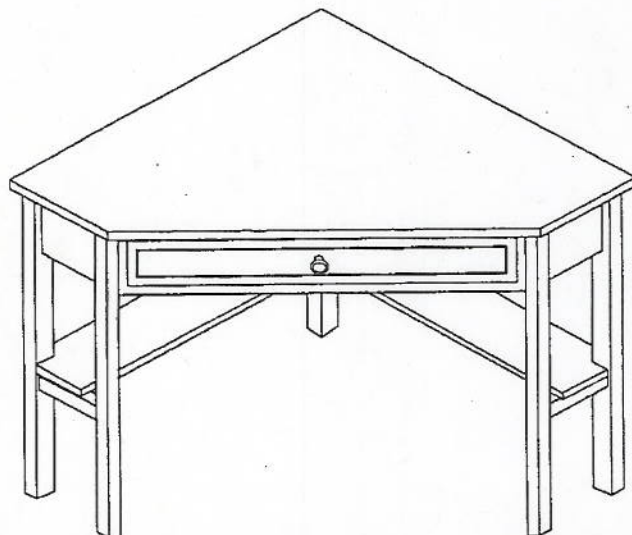

ITEM	DESCRIPTION	PART	QTY
A	Wooden Dowel ( $\Phi 8 \times 30\text{mm}$ )		5PC
B	Screw ( $\Phi 4 \times 25\text{mm}$ )		12PC
C	Flat washer ( $\Phi 12 \times 1\text{mm}$ )		18PC
D	Cam lock ( $\Phi 15 \times 12\text{mm}$ )		2PC
E	Camlock Bolt ( $\Phi 6 \times 65\text{mm}$ )		1PC
F	Bolt ( $\Phi 1/4 \times 30\text{mm}$ )		18PC
G	Handle ( $\Phi 25 \times 20\text{mm}$ )		1PC
H	Handle bolt ( $\Phi 4 \times 22\text{mm}$ )		1PC
I	Plastic drawer glide		1PC
J	Screw ( $\Phi 3 \times 12\text{mm}$ )		4PC
K	Allen Key 115*30mm		1PC
L	Glue		1PC
M	Screw ( $\Phi 5 \times 40\text{mm}$ )		4PC

ITEM	DESCRIPTION	PART	QTY
1	Right side frame (747*260*49mm)		1PC
2	Left side frame (747*260*49mm)		1PC
3	Leg (747*40*40mm)		1PC
4	Right Apron (656*149*33mm)		1PC
5	Cross bar (656*30*20mm)		1PC
6	Front frame (642*149*28mm)		1PC
7	Long shelf (732*160*15mm)		1PC
8	Long shelf (572*160*15mm)		1PC
9	Wooden drawer glide (300*30*27mm)		1PC
10	Top panel (754*754*15mm)		1PC
11	Drawer front panel (612*119*24mm)		1PC
12	Drawer side wall (310*95*12mm)		2PCS
13	Drawer back panel (574*95*12mm)		1PC
14	Drawer bottom panel (297*585*3mm)		1PC
15	Left Apron (656*149*33mm)		1PC

MADE IN CHINA