



TOUCHLESS TRASH CAN[®]

NEW DZT13 PLUS-USER MANUAL

This is an all new DZT13 PLUS with the following free improvements:

- Extra-wide lid opening, accommodate larger debris
- Includes Deodorizer Compartment with one (1) Carbon Filter pre-installed (last up to 3 months)
- Advanced Seal Technology: Sealed away lid hinges for longer lasting and easier cleaning
- Air escape holes at the base to ensure effortless bag removal
- Added AC Adaptor Jack (For use with optional AC Adaptor. Purchase separately.)

Any Problem or Package Is Damaged? DO NOT RETURN TO STORE
Email us at service@itouchless.net or call toll free:

1-800-660-7978

TOUCHLESS TRASH CAN[®] Any Problem or Package Damage When Receive? DO NOT RETURN TO STORE
Email us at service@itouchless.net first or call toll free 1-800-660-7978

BRIEF INTRODUCTION:

The Touchless Trashcan uses patented invisible, harmless, infrared technology. As your hand or debris approaches the can (about 6 inches/10 cm away), the infrared sensor on the lid (Sensor Zone as shown on **Picture 1**), it will automatically opens the lid. After your hand is withdrawn the lid will close automatically (4-second delay). Lid will remain open if debris or hand is within 6 inches of the infrared sensor zone. There are 2 buttons on the front to open and close the lid manually, as well as an on/off switch on the back of the trash can. The Touchless Trashcan creates a germ free, odor free, automated environment. It is convenient to use and it is very hygienic. Touchless Trashcan is available in various sizes online at iTouchless.com

Indicator Light (LED Light)

- (1) The indicator light in the normal waiting mode flashes red once every 3 seconds.
- (2) While the lid is opened by the manual button, it flashes green once every three seconds.
- (3) When the batteries are nearly used up, the indicator light flashes yellow/amber once every 3 seconds

ATTENTION:

1. Do not immerse the Lid Cover in water because it is equipped with many electronic parts. You can clean it with a uneck space damp cloth.
2. Do not press or force the trashcan lid to close. Lid will close automatically after your hand or debris is removed from sensor zone.
3. To prevent damage to the electronic components from chemicals leaked from old batteries, replace a new set of batteries immediately when the indication light turns to yellow/amber.
4. Avoid direct sunlight on the infrared sensor, and ensure there is enough room to operate the trash can without blocking the opening and closing of the lid.
5. Do not use a power adaptor that is not authorized by iTouchless, it may result in fire, electric shock or injury.
6. Do not use power adaptor and battery (together) to operate the trash can at the same time. It can only be powered by one way or the other.
7. Do not overstuff the trash bag causing it hard to be removed or torned.
8. Since this product opens automatically, it may not be suitable for small children or pets.

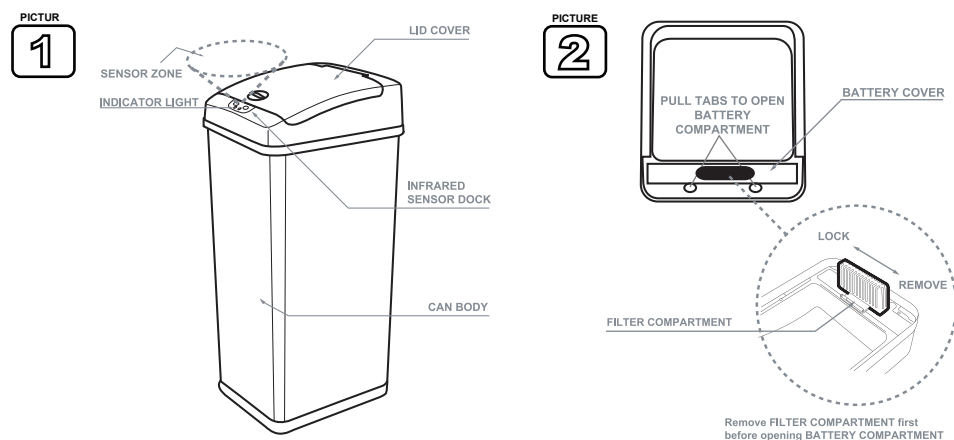

OPERATING INSTRUCTIONS:

- a. Remove the Lid Unit from the trash can. Remove the Filter Compartment located on the underside **picture 2** (see **Instruction for using the Active Carbron Filter** on the back side of this user manual) Then open the battery compartment cover to insert four "D"size batteries according to the marks of "positive and negative pole". Close the battery compartment cover and attach the Filter Compartment
- b. Insert the garbage bag (13 gallon to 18 gallon) through the Smart Retainer Ring and wrap the top part of the garbage bag over the Ring (**STEP 1**). Put the Ring onto the top edge of the can body (**STEP 2**). Video instruction www.touchlesstrashcan.com/ring.html
- c. Place the Lid Unit onto the can body and make sure it is securely attached.
- d. Turn on the power switch on the back of the Lid Unit(**Picture 4**). A red Indicator Light will turn on for 3 seconds. Then it flashes once every three seconds, which shows that the system is on and ready.
- e. To open the lid, just place your hand or any object 6 inches above the Infrared Sensor on the front of the Lid Unit. The Lid will remain open if it detects objects within the Sensor Zone. It will close in 4 seconds after your hand or object moves away.
- f. If you press the open button(manual operation), the lid will open and remain open until you press the close button. Then the trash can returns back to automatic mode.

HOW DOES SMART RETAINER RING WORK?



NEW DZT13 PLUS-USER MANUAL

INSTRUCTION FOR USING THE ACTIVE CARBON FILTER

This new Odorless Touchless Trash Can is equipped with the 3D Filter Compartment that can be used with the powerful Active Carbon Filter to eliminate odors up to 90% in the trash can. One (1) replaceable Active Carbon Filter is pre-installed inside the 3D Filter Compartment. Please follow the instruction below to maximize the filter power.



Fig. 1



Fig. 2



Fig. 3

1. Remove and turn the Lid Cover upside down with power switch turned off
2. Slide the 3D Filter Compartment (Fig.1) to the right as (Fig.2) to remove the filter compartment
3. Take out the bag of the Active Carbon Filter from the filter compartment
4. Tear open and throw away the clear plastic bag that is protecting the Active Carbon Filter pouch
5. Insert the pouch of the Active Carbon Filter (Fig.3) back to the filter Compartment
6. Put the 3D Filter Compartment back to the Lid Cover (Fig.1) and slide to the left as (Fig.2) to lock the filter compartment
7. Change the Active Carbon Filter every 3 months or change it when you smell the odor is too strong.
8. Order the most updated version of Active Carbon Filter online at www.trashcanparts.com

Cleaning Tip:

- 3D filter Compartment can be washed if it gets dirty
- Used Active Carbon Filter pouch should be disposed in a trash can

iTouchless® © 2011 iTouchless Housewares & Products, Inc. All Rights Reserved.



WARNING:

Since this product opens automatically, it may not be suitable for small children or pets.

MADE IN CHINA

TOUCHLESS TRASH CAN®

Any Problem or Package Damage When Receive? DO NOT RETURN TO STORE
Email us at service@itouchless.net first or call toll free 1-800-660-7978

TROUBLESHOOTING Q & A

General Troubleshooting Steps:

- (1) Turn off power switch, remove battery or AC power adaptor. Then rub and wipe clean the sensor area with a soft damp cloth and dry it immediately with a soft dry cloth. Re-insert batteries or plug in the AC adaptor (DO NOT USE battery and AC adaptor at the same time). They will not work together.
- (2) Move the trashcan to an open area and make sure nothing is blocking or within 10 inches from the sensor eye, and no sunlight or spotlight shines on the sensor. Turn on the power and try it agim.
- (3) If the trash can is still not working correctly, remove the batteries and AC adaptor. Let the trash can sit for at least 2 hours to reset. Try it again after reset.

After these troubleshooting steps, if your trash can is still not working, please contact us through TouchlessTrashcan.com for warranty service.

1. Just receive the trash can, but it only works sometimes	Peel off the thin, transparent protector/sticker on top of the sensor eye. The protector is not very visible. Try a new set of batteries. Then follow the General Troubleshooting Steps above
2. The lid stays open or lid opens and closes continuously	The sensor eye may be affected by dirt, stain, dust,moisture or reflection.Move the trash can to a different location or turn the trash can slightly so that the sensor faces another direction, and follow the General Troubleshooting Steps above
3. Grinding noise when the lid opens/closes	This can be can be caused by broken gears, lid hinge <ul style="list-style-type: none">• Follow the General Troubleshooting Steps• Check the hinges that connect the lid if it is broken• Visit Trashcanparts.com to order a new lid unit• Contact us through TouchlessTrashcan.com for warranty service
4. If the lid does not open/close Important: Do not use batteries and the AC power adaptor at the same time. It can only be powered one way or the other.	If you are using Batteries: <ul style="list-style-type: none">• Make sure they are inserted in correct directions and close the battery cover firmly• Turn the power switch to “ON” position to see if there’s any indication light If you are using AC Power Adaptor: <ul style="list-style-type: none">• Unplug the adaptor and insert new alkaline batteries to see if the lid works on battery• If the trashcan works with batteries, the AC adaptor may be broken
5. I wave my hand over the sensor eye, but the lid does not open	It is not a motion sensor,you should hold your hand or object steadily (not waving) within 4-6 inches on top of the sensor eye for it to detect and open
6. why is the indicator light flashes in yellow/amber color	The battery power is low, replace all batteries with a new set of alkaline batteries. Do not use rechargeable battery or mix old batteries

ORDER ACCESSORIES AND PARTS:

To order accessories and parts, please visit website www.trashcanparts.com

- Official AC Power Adaptor
- Trash Bag Retainer Ring
- Battery Compartment Cover
- Stainless Steel Cleaner
- Premium Trash Bags
- Carbon Filter Refills and more...

For other iTouchless innovative sensor products, please visit us at www.iTouchless.com

ONE (1) YEAR LIMITED WARRANTY

Touchless Trashcan is distributed by iTouchless Housewares & Products, Inc. (iTouchless) with the highest quality components and most advanced technology available. The trash can’s Lid Cover is warranted to be free from defects in material and workmanship, given normal use and care, for 365 days from the date of the original purchase with proof of purchase within the United States and Canada. iTouchless will only honor warranty request from purchases made from our websites and authorized dealers. Trashcan sold as used, floor sample, closeout or refurbished are sold solely under the terms and conditions of the selling party. iTouchless will not warrant such purchase. We will repair or replace the Lid Cover thereof which fails as the result of such a defect during the warranty period.

This warranty is the customers’ exclusive remedy for product defect and does not apply to:

- User modification
- Attachments to product by user that causes damage
- Any product, on which the seals and/or serial numbers have been broken, removed, tampered with, defaced or altered in any manner
- Damage caused by abuse, misuse, accident, water or theft

Except as stated above, iTouchless makes no express or implied warranties as to any product, in particular, makes no warranty of merchantability or of fitness for any particular purpose. iTouchless shall not be liable for consequential or incidental damages arising from any product defect. Our Liability is limited to the replacement of any defective product. iTouchless expressly disclaims all warranties not satisfied in this limited warranty. Any implied warranties that may be imposed by law are limited to the terms of this limited warranty. Retainer Ring, Battery Cover and Filter Compartment are not covered by this warranty.

If Trash Can should fail during the warranty period, contact us through www.TouchlessTrashcan.com to request a Repair# before returning to us. We WLL NOT ACCEPT package without the Repair#. Remember to return package FREIGHT PREPAID by an insured carrier such as UPS and include a check of US\$9.95 for return postage. Extra US\$10.00 should be added to return postage when requesting repaired item to be shipped to Canada (Total US\$19.95). We will not pay for any return postage fee.

Return Address:
iTouchless Housewares & Products Inc.
23497 Eichler Street, Unit A, Hayward, CA 94545 USA
Attn: Product Return Repair# _____

Subject to the above conditions, we will repair or ship you a working Lid Cover within 30 working days after receipt. This warranty gives you specific legal rights, and you may also have other rights that vary from state to state and province to province. For more information, please visit our website at www.TouchlessTrashcan.com

Thank you for purchasing the Touchless Trashcan®!