

## CARE INSTRUCTIONS

Thank you for choosing northbeam<sup>tm</sup> WINDSOR SHOE BENCH.

With a little care and maintenance, the northbeam<sup>tm</sup> WINDSOR SHOE BENCH will provide you with comfort and enjoyment for many years to come!

- To clean panels, use clean water on a damp cloth.
- When assembling northbeam<sup>tm</sup> WINDSOR SHOE BENCH, please handle all the panels and/or hardware with care to avoid any possibilities of damages and/or injuries.

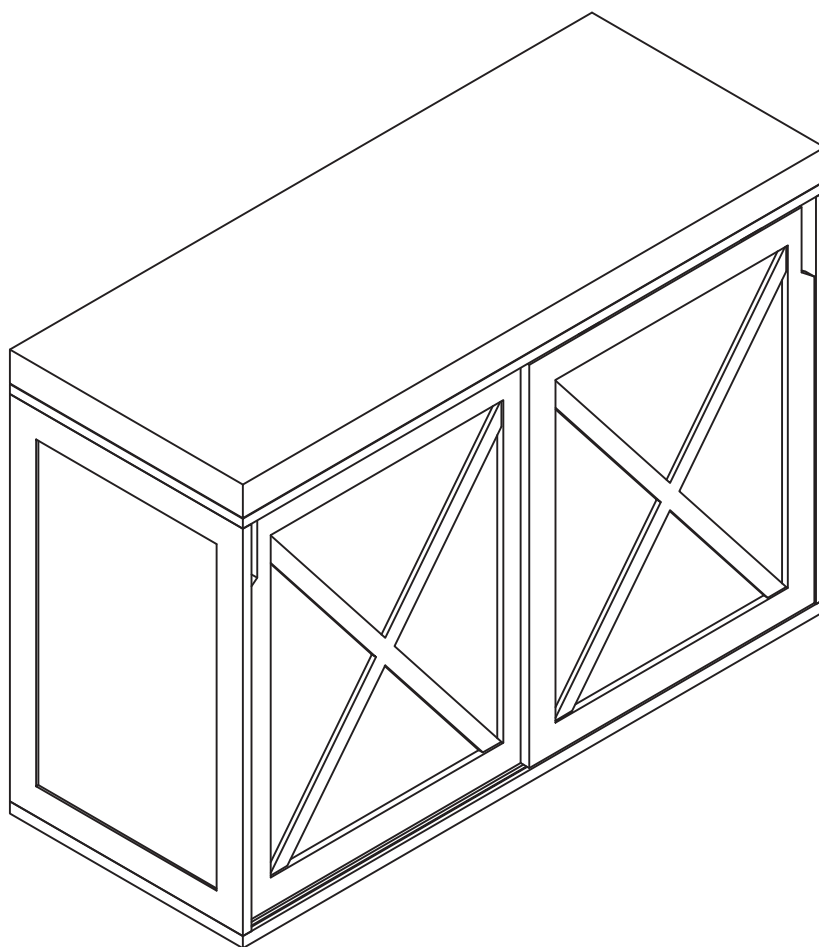

NOTE: Please read all instructions carefully before starting assembly. Also, we recommend that the unit is fully assembled on a level surface. Two people are recommended to assemble this product. DO NOT over torque screws and bolts.

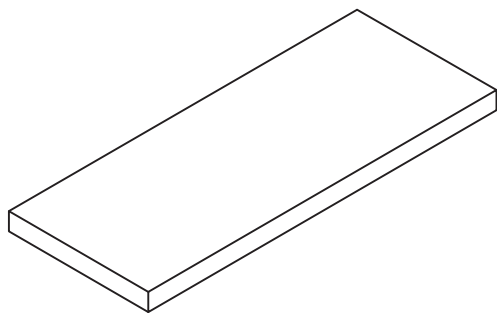

**A** CUSHION X 1PC

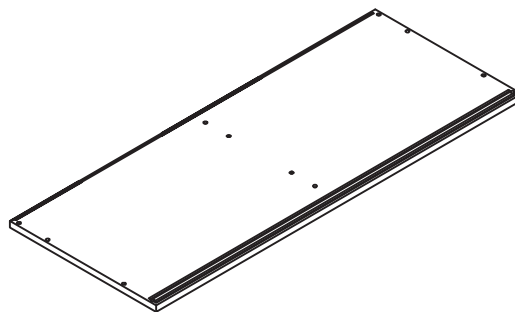

**B** INTERIOR TOP PANEL X 1PC

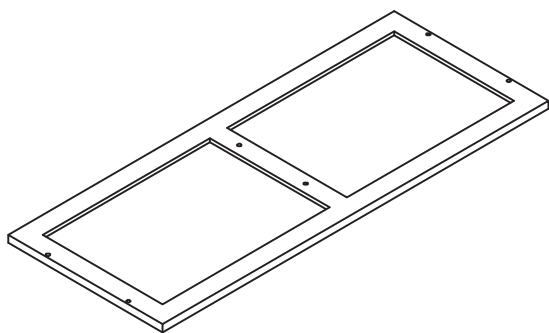

**C** BOTTOM PANEL X 1PC

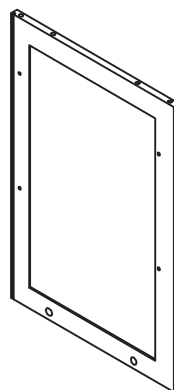

**D** LEFT SIDE PANEL X 1PC

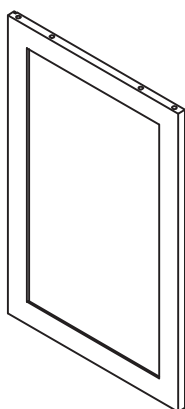

**E** RIGHT SIDE PANEL X 1PC



**F** MIDDLE INTERIOR PANEL X 1PC

NOTE: Please read all instructions carefully before starting assembly.  
Also, we recommend that the unit is fully assembled on a level surface.  
Two people are recommended to assemble this product.  
DO NOT over torque screws and bolts.

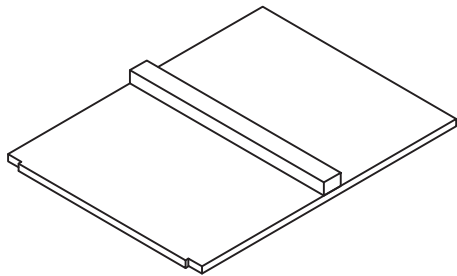

**G**

SHELF X **4PCS**

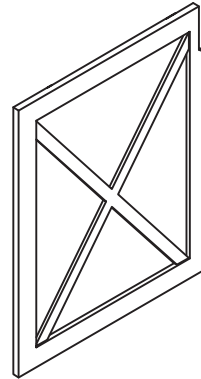

**H**

RIGHT DOOR X **1PC**

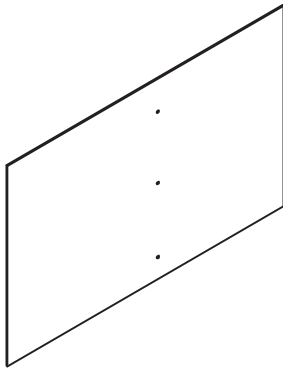

**I**

BACK PANEL X **1PC**

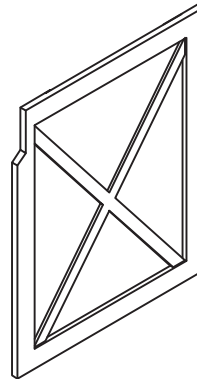

**J**

LEFT DOOR X **1PC**

NOTE: Please read all instructions carefully before starting assembly.  
Also, we recommend that the unit is fully assembled on a level surface.  
Two people are recommended to assemble this product.  
DO NOT over torque screws and bolts.



1 \_\_\_\_\_ DOWEL \_\_\_\_\_ **12+1PCS**

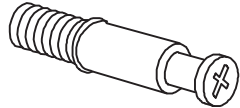

2 \_\_\_\_\_ LOCKING BOLT \_\_\_\_\_ **6+1PCS**



3 \_\_\_\_\_ SMALL CAM \_\_\_\_\_ **2+1PCS**



4 \_\_\_\_\_ HOLE CAP \_\_\_\_\_ **6+1PCS**

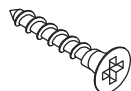

5 \_\_\_\_\_ SCREW \_\_\_\_\_ **6+1PCS**

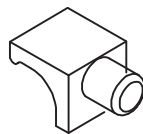

6 \_\_\_\_\_ SHELF BRACKET \_\_\_\_\_ **16+2PCS**



7 \_\_\_\_\_ PAN HEAD SCREW \_\_\_\_\_ **3+1PCS**

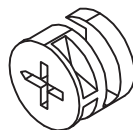

8 \_\_\_\_\_ LARGE SCREW \_\_\_\_\_ **4+1PCS**

NOTE: Please read all instructions carefully before starting assembly.  
Also, we recommend that the unit is fully assembled on a level surface.  
Two people are recommended to assemble this product.  
DO NOT over torque screws and bolts.

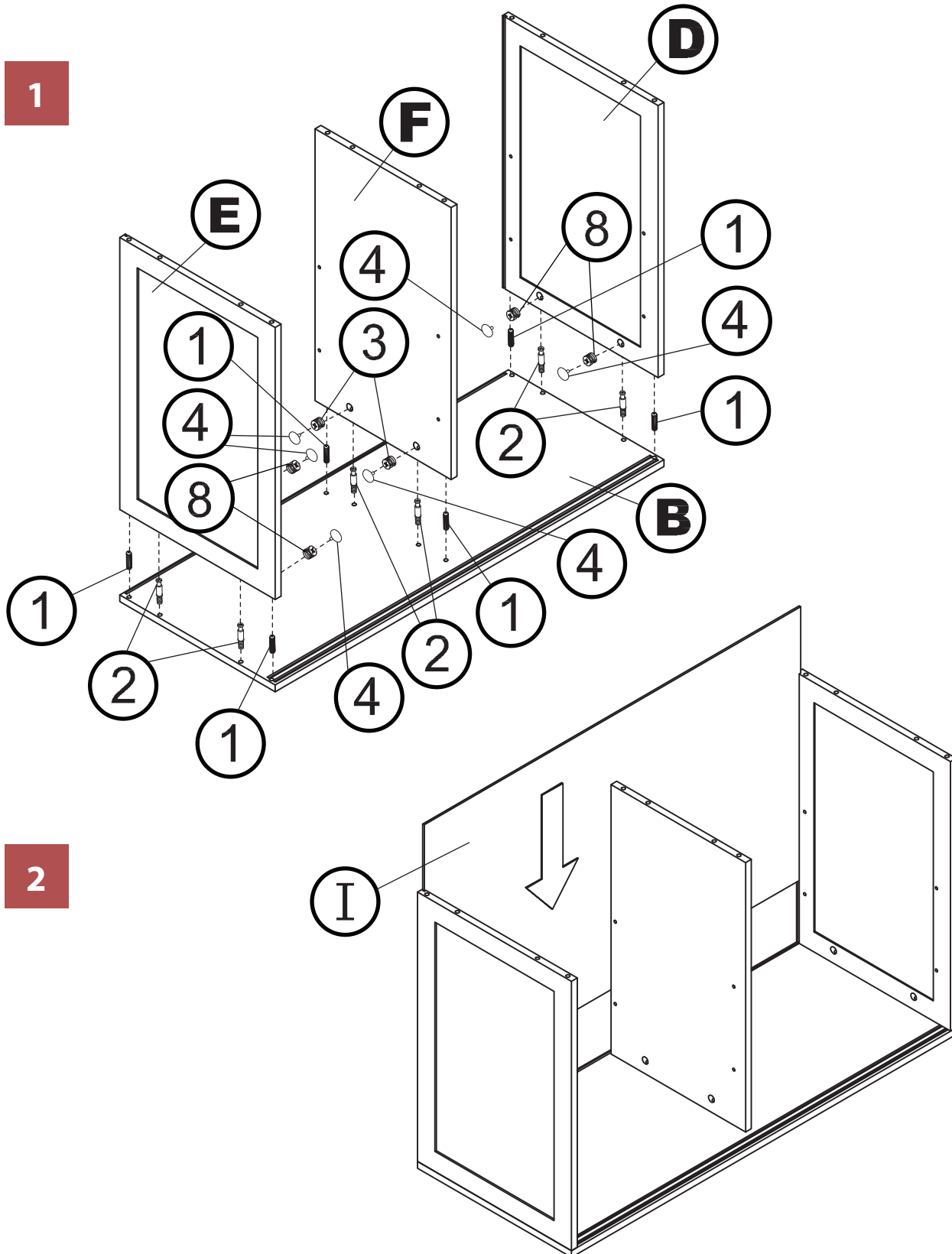

NOTE: Please read all instructions carefully before starting assembly.  
 Also, we recommend that the unit is fully assembled on a level surface.  
 Two people are recommended to assemble this product.  
 DO NOT over torque screws and bolts.

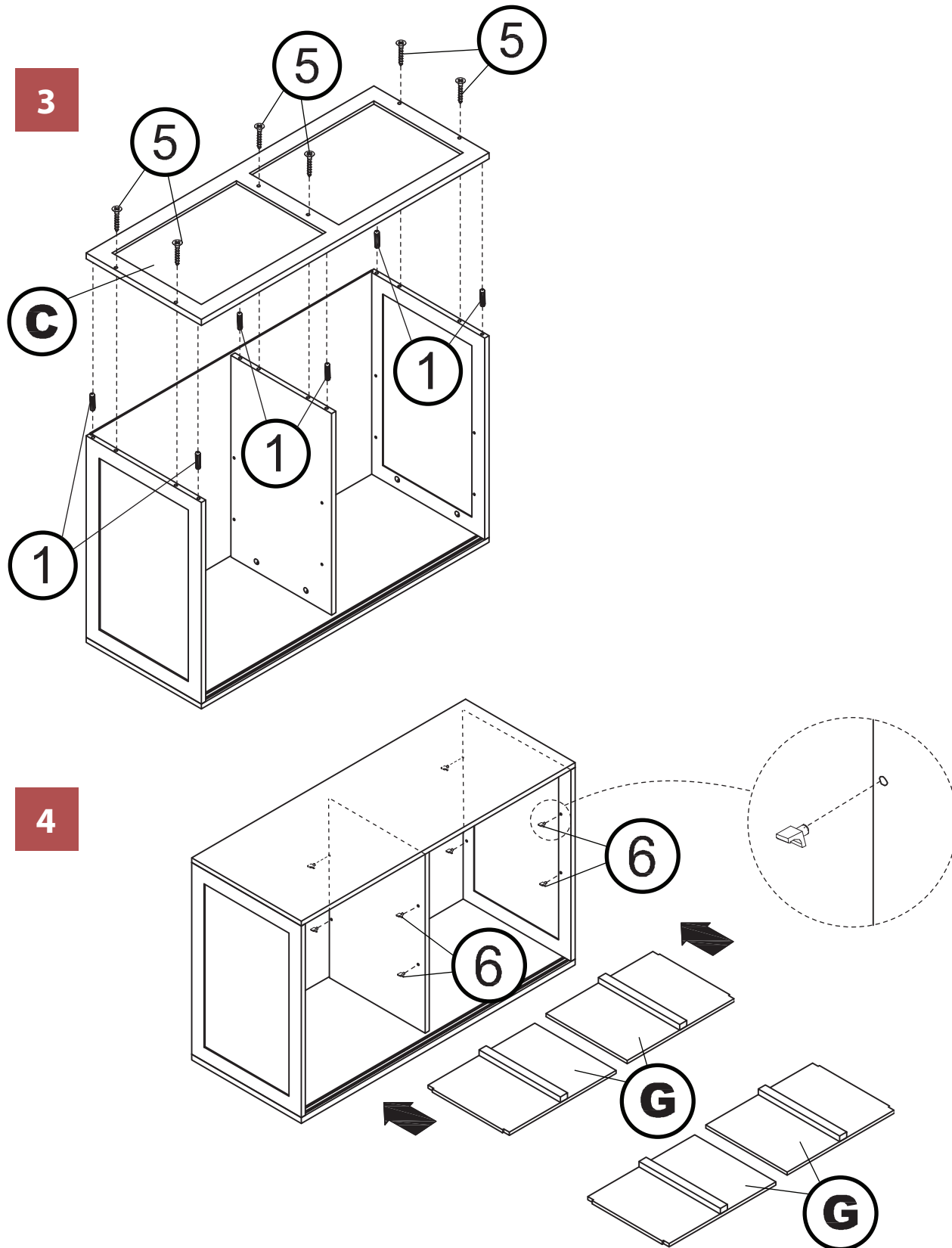

NOTE: Please read all instructions carefully before starting assembly.  
Also, we recommend that the unit is fully assembled on a level surface.  
Two people are recommended to assemble this product.  
DO NOT over torque screws and bolts.

5

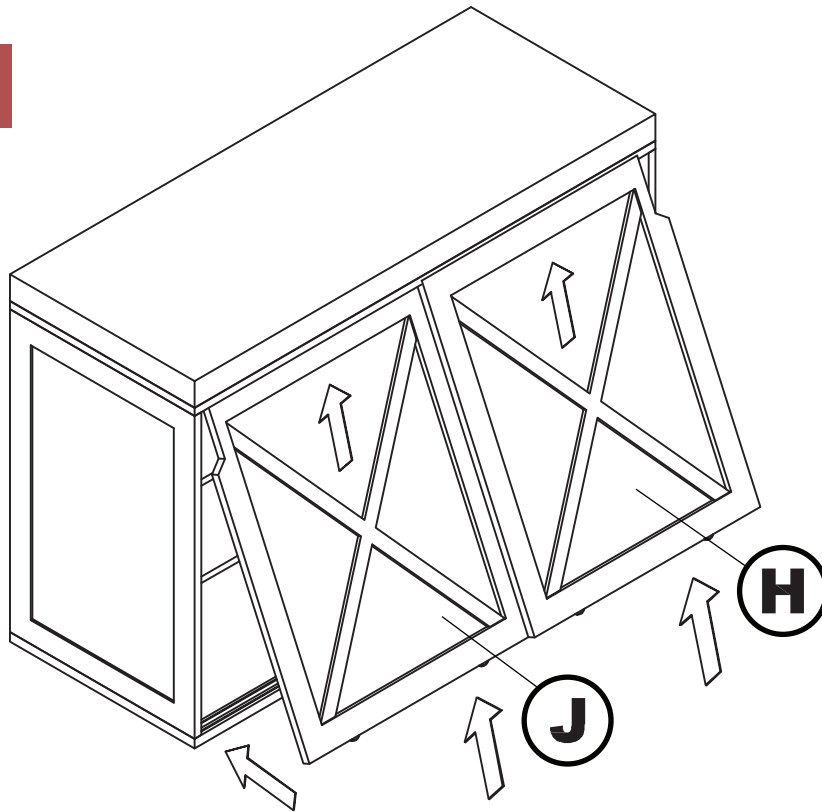

6

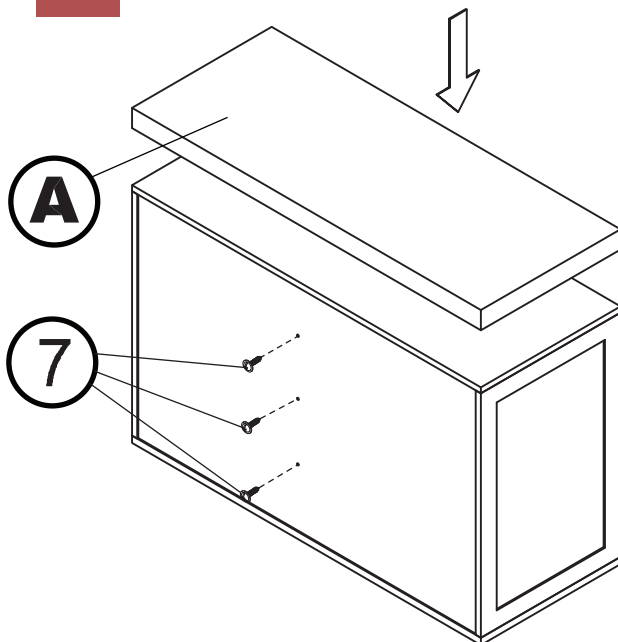

OK!

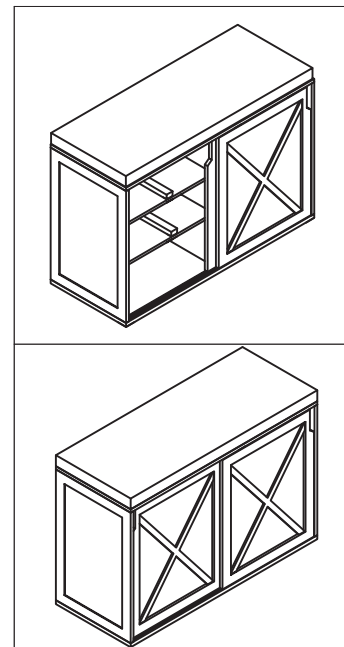

NOTE: Please read all instructions carefully before starting assembly.  
Also, we recommend that the unit is fully assembled on a level surface.  
Two people are recommended to assemble this product.  
DO NOT over torque screws and bolts.

Please check contents before assembly. If any items are missing or damaged, do not take the unit back to the store. Call (775) 629-5029 or email: [service@merryproducts.com](mailto:service@merryproducts.com) for customer service and we will save you time by correcting any problems directly for you.

NOTE: Please read all instructions carefully before starting assembly. Also, we recommend that the unit is fully assembled on a level surface. Two people are recommended to assemble this product. DO NOT over torque screws and bolts.