

Assembly Instructions

4808863 37" Bathroom Vanity - Cinnamon

Product Issues? Please Call Us Before Contacting Your Retailer At 1-800-549-3300
Email customerservice@mshome.co, or visit www.mshome.co
We can help with Assembly Issues, Part Requests, Damages, & All Other Product
Related Questions

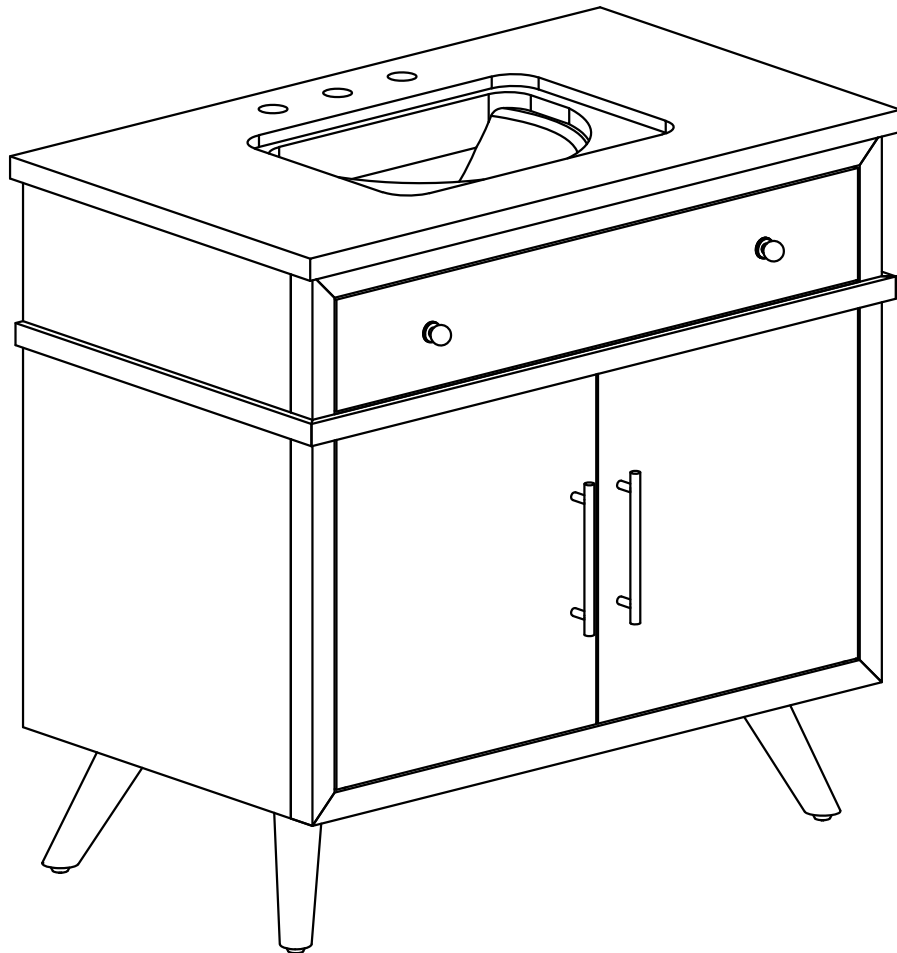

MSH-USA

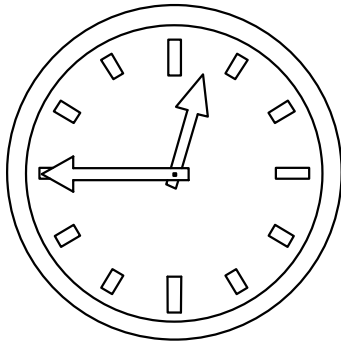

20 min

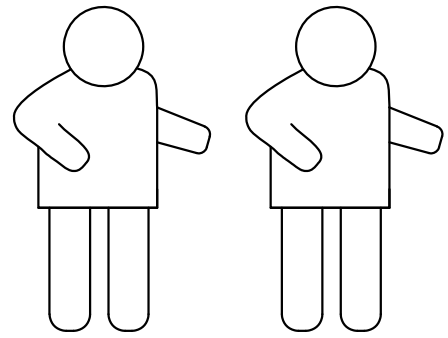

Two People Required

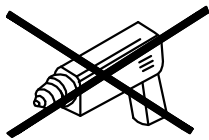
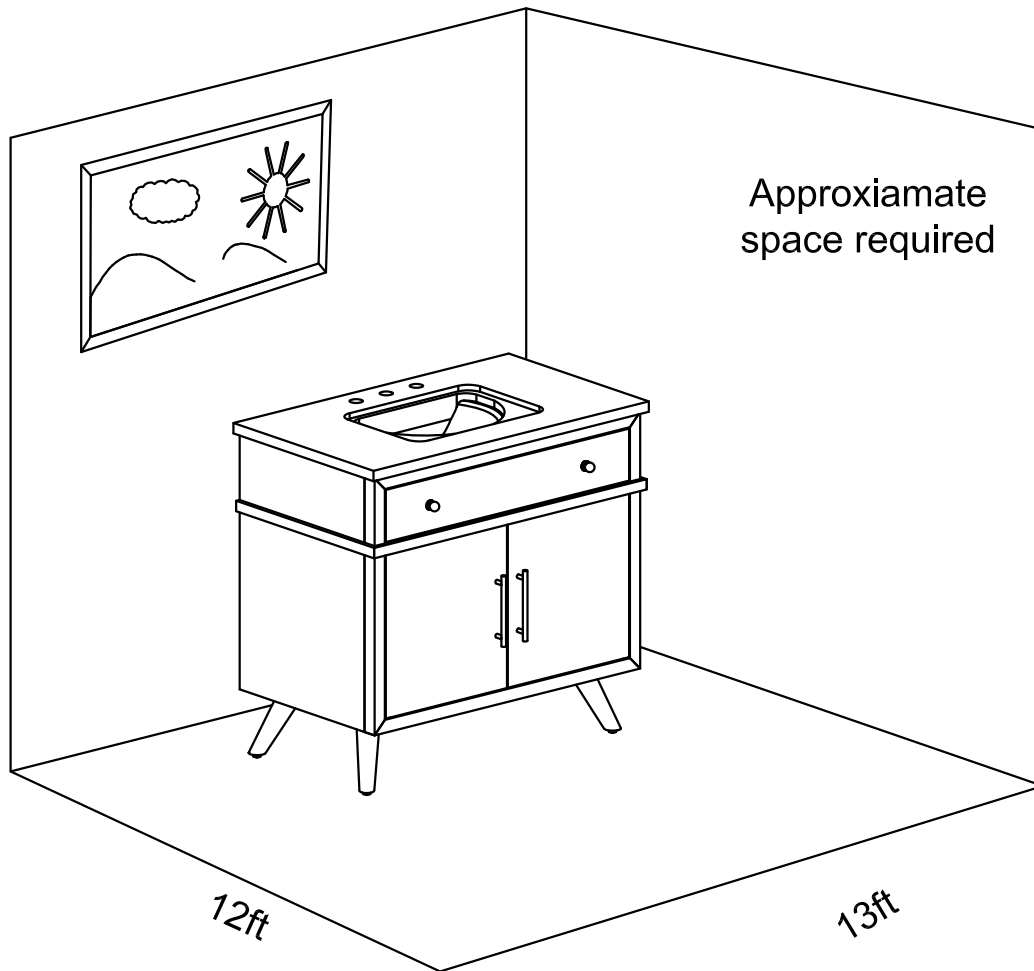

Do not use power tools

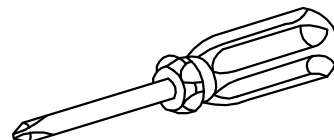

Phillips Head (Not provided)



- Carefully read all of the instructions before starting the assembly and installation process. Failure to do so may lead to injury, damage to the product, or other property damage.
- This vanity should be installed by an experienced plumber
- **Two people** are required to assemble this vanity
- Drain pipe and drain trap are not supplied. Connect to an existing drain pipe.
- Assemble in or near final installation position
- Do not drag the vanity as it may damage the product.
- Warning the top is VERY HEAVY and FRAGILE, use extreme caution while handling and moving.

Technical drawing of the 3000 Series vanity, showing three views: isometric, front elevation, and top view. Dimensions are provided in inches and millimeters.

Isometric View Dimensions:

- Countertop Width: 37" [938]
- Countertop Depth: 22" [555]
- Overall Height: 35-1/4" [897]
- Drawer Height: 9-3/8" [238]
- Cabinet Height: 19" [484]
- Leg Height: 6-3/4" [172]
- Base Width: 17-1/2" [445]

Front Elevation View Dimensions:

- Countertop Width: 37" [938]
- Countertop Thickness: 1" [28]
- Drawer Height: 8-1/4" [210]
- Cabinet Height: 19" [484]
- Leg Height: 6-3/4" [172]
- Base Width: 12" [303]
- Base Depth: 11-3/4" [300]
- Sink Depth: 15-3/4" [400]
- Drawer Depth: 10" [254]

Top View Dimensions:

- Countertop Width: 37" [938]
- Countertop Depth: 22" [555]
- Sink Width: 15-3/4" [400]
- Sink Depth: 11-3/4" [300]
- Drawer Width: 4" [102]
- Drawer Depth: 4" [102]
- Leg Width: 9" [220]
- Leg Depth: 9" [220]
- Sink Mounting Holes: 3-Ø1-3/8" [3-Ø35]
- Sink Mounting Hole Diameter: Ø1-3/4" [Ø44]

PARTS INCLUDED: 4808836

- 1 Top x 1
- 2 Left Side Panel x 1
- 3 Right Side Panel x 1
- 4 Front Frame x 1
- 5 Back Frame x 1
- 6 Bottom Panel x 1
- 7 Shelf Panel x 1
- 8 Leg Frame x 2
- 9 Door Panel x 2

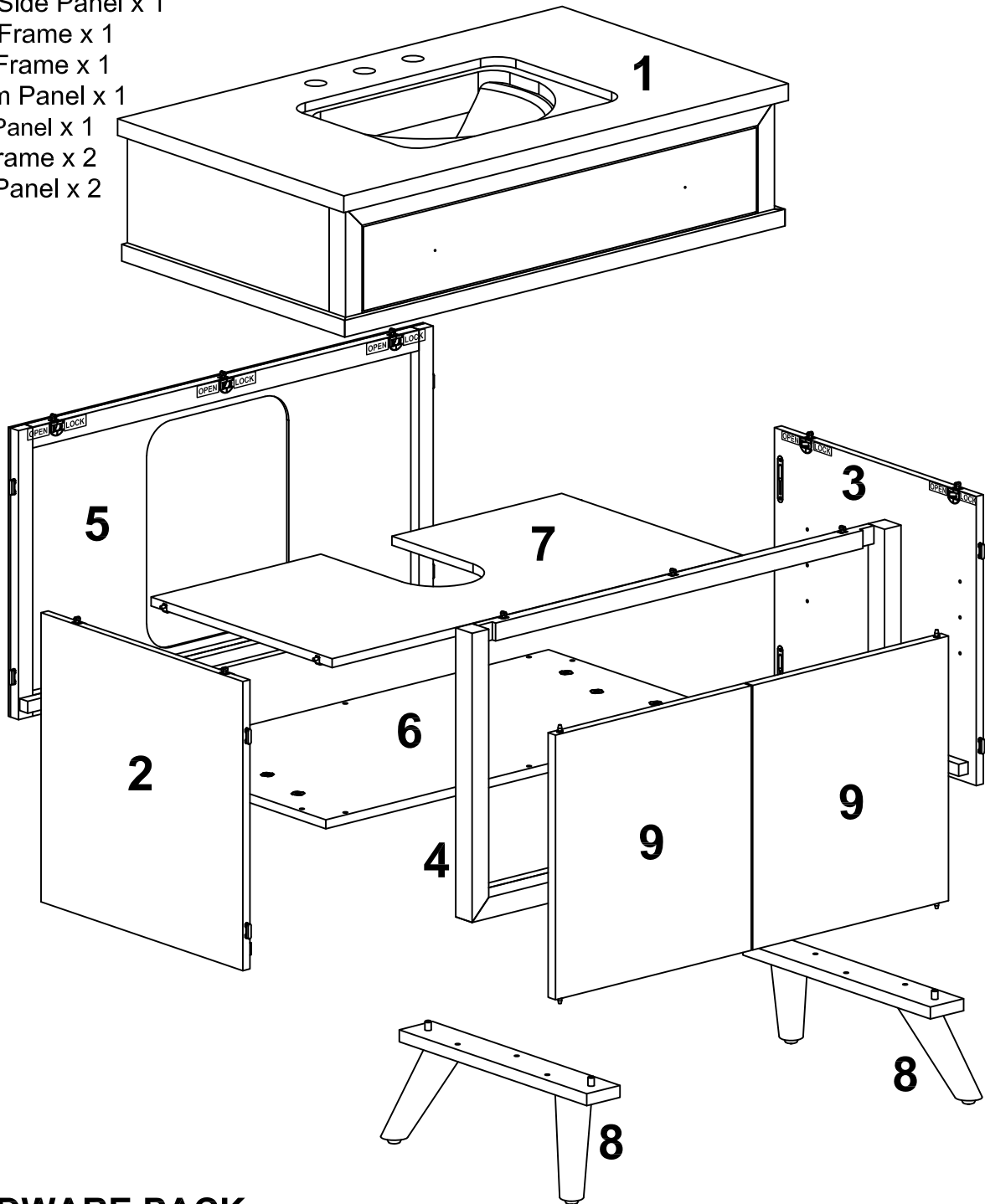

HARDWARE PACK

A x 16	B x 01	C x 04	D x 04	E x 02	F x 02	G x 06
Ø6.3x25(mm)			Ø3.5x15 (mm)			Ø4x25 (mm)

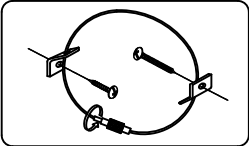

ANTI-TIP x 1 SET

1

1. Please ensure the box is turned at upside down position
2. Carefully open the box by unfolding all 4 sides panel by scissor (or knife)
3. Slightly remove all the internal packaging materials inside the box side to open the whole box
4. Install the part per illustration

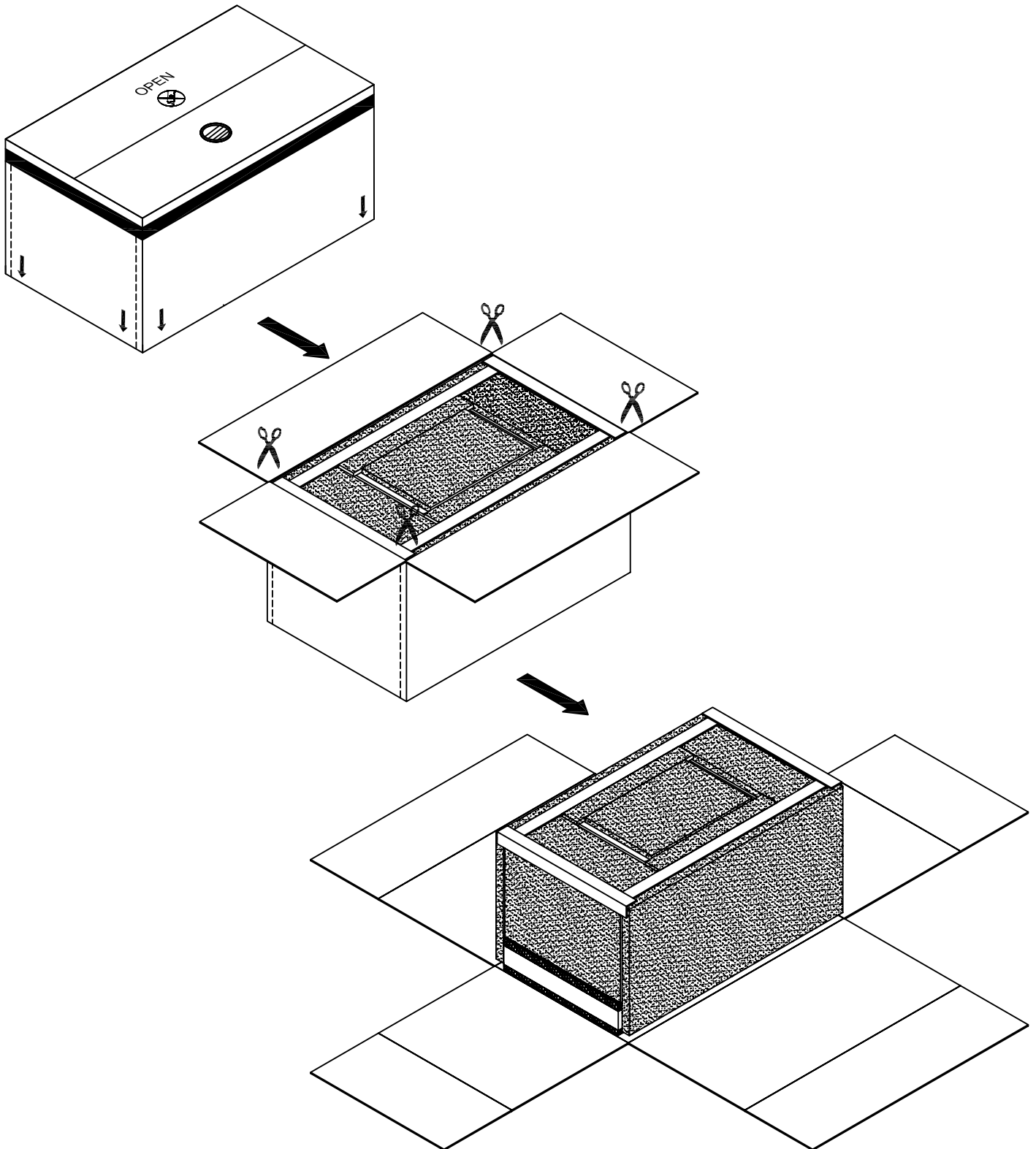

Please keep all part in the flat surface to prevent scratch

2

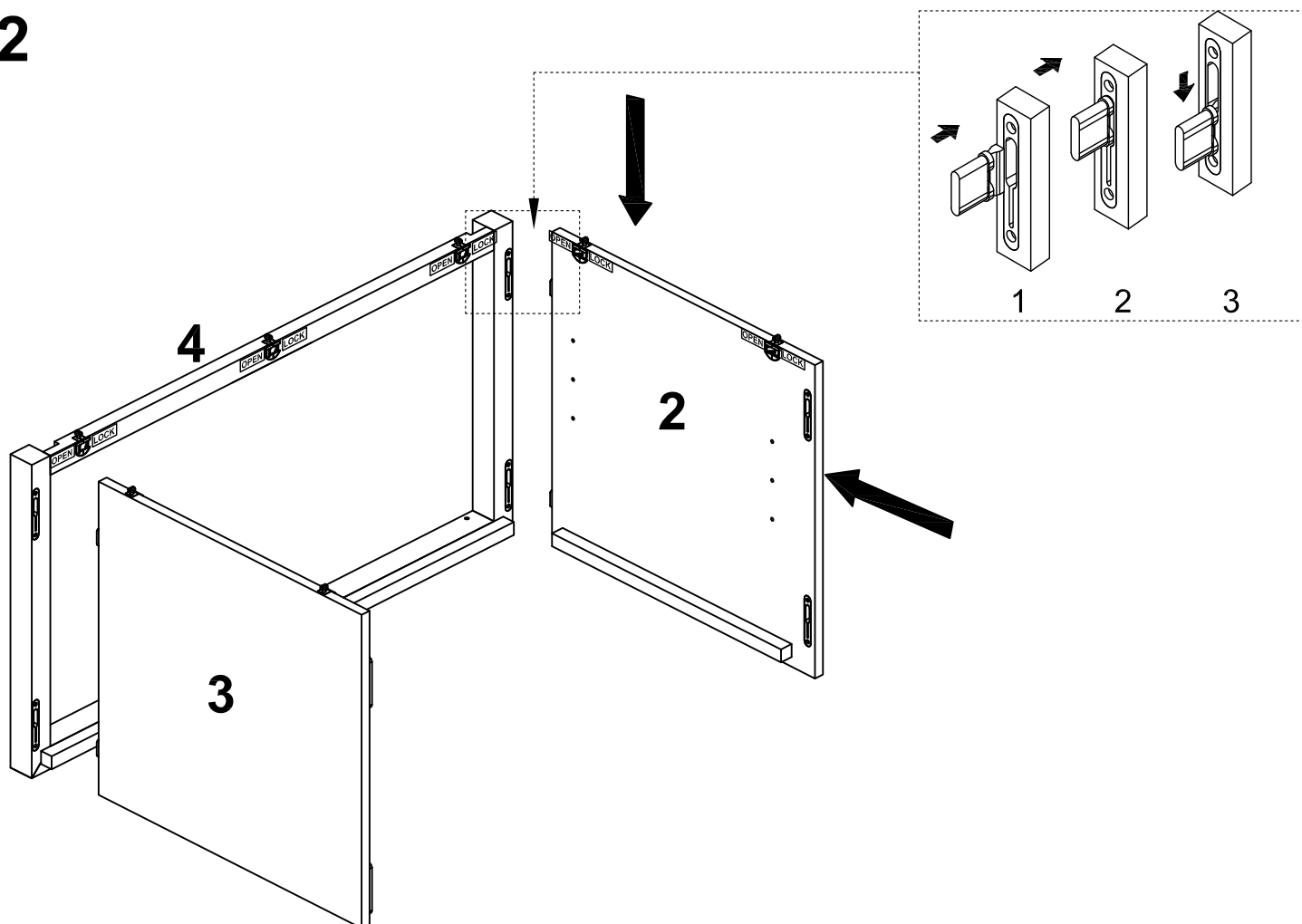

3

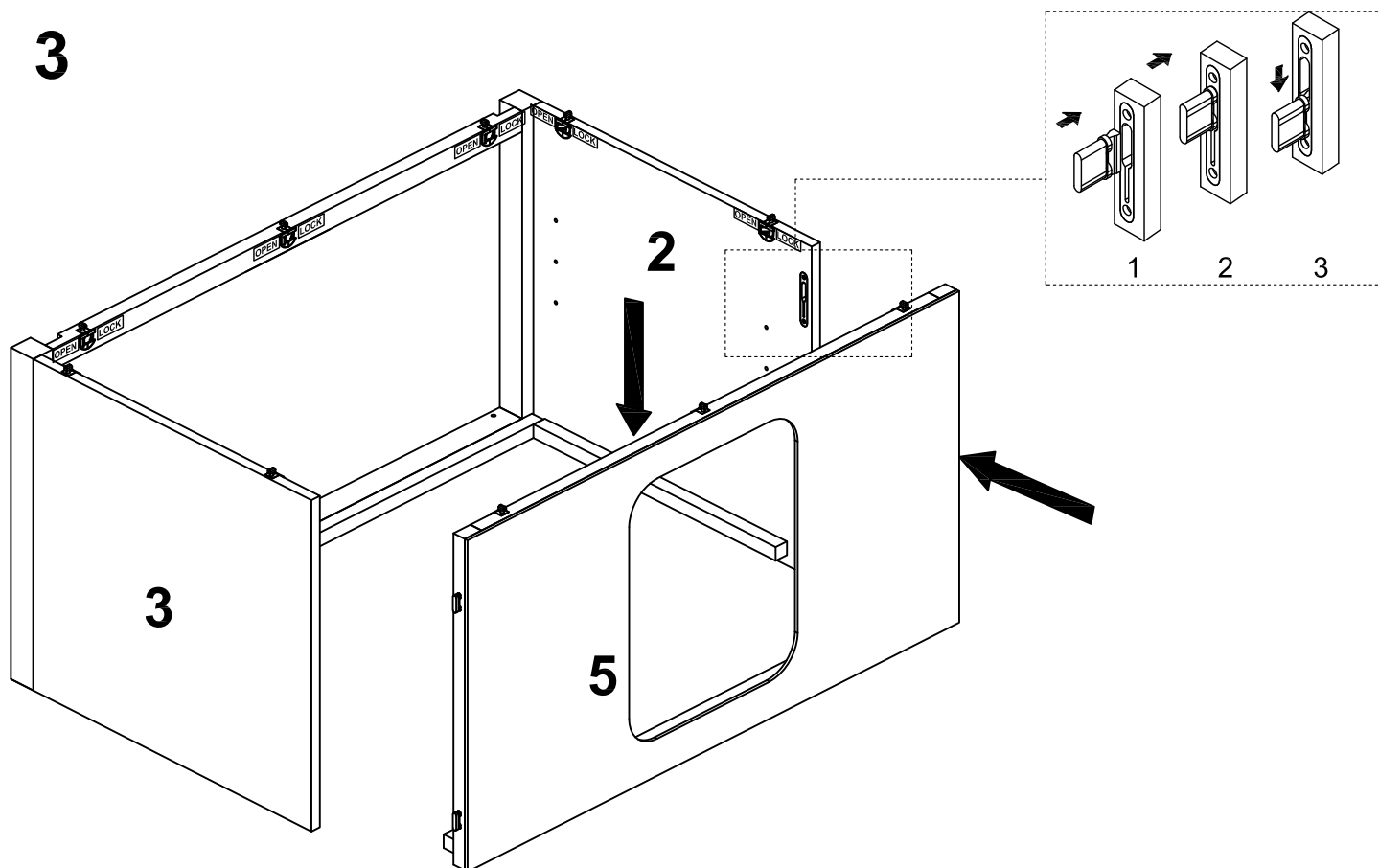

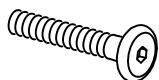
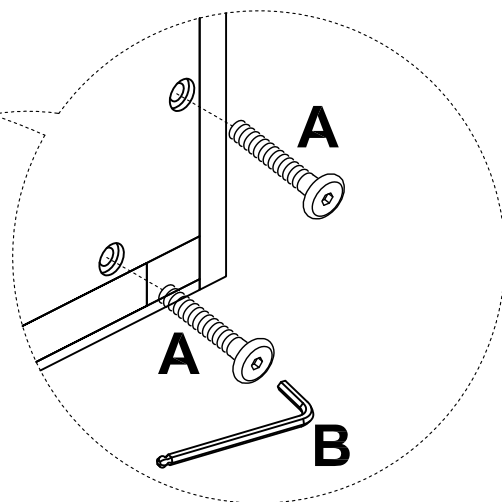
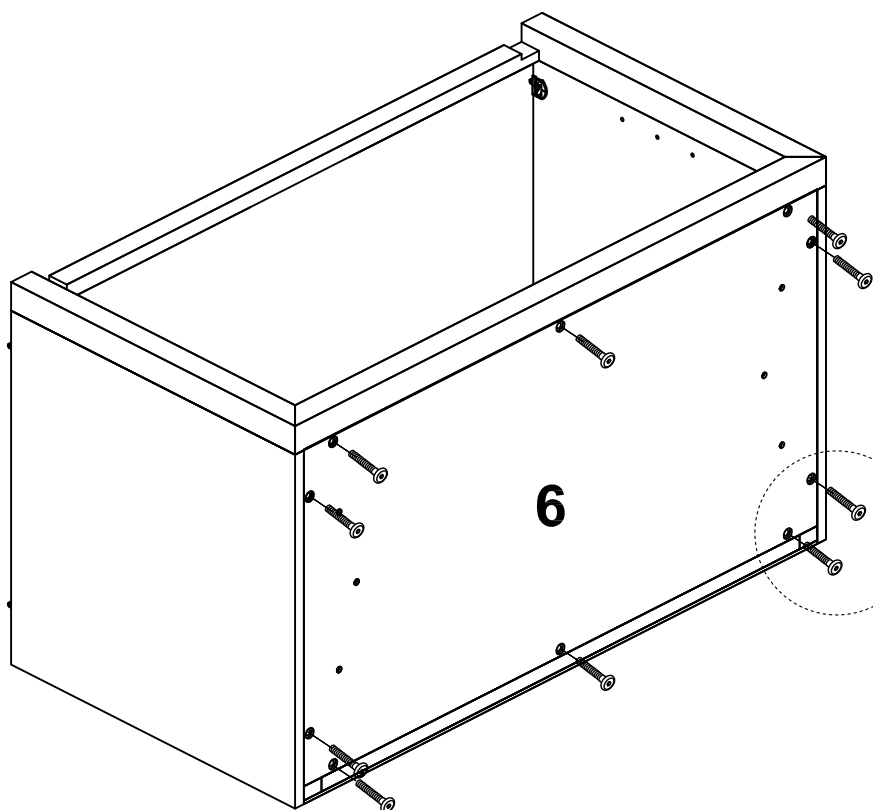
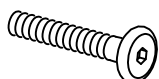
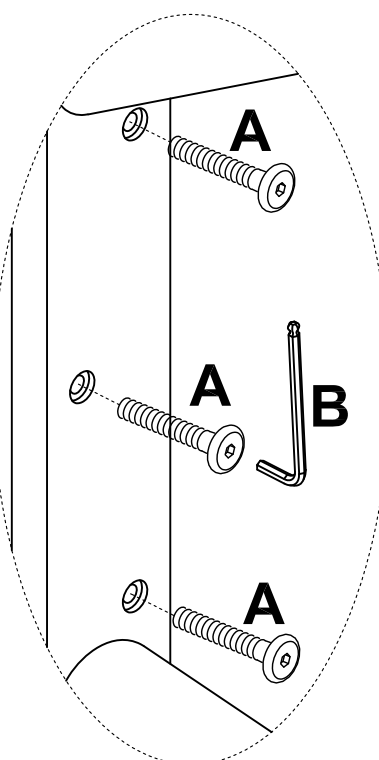
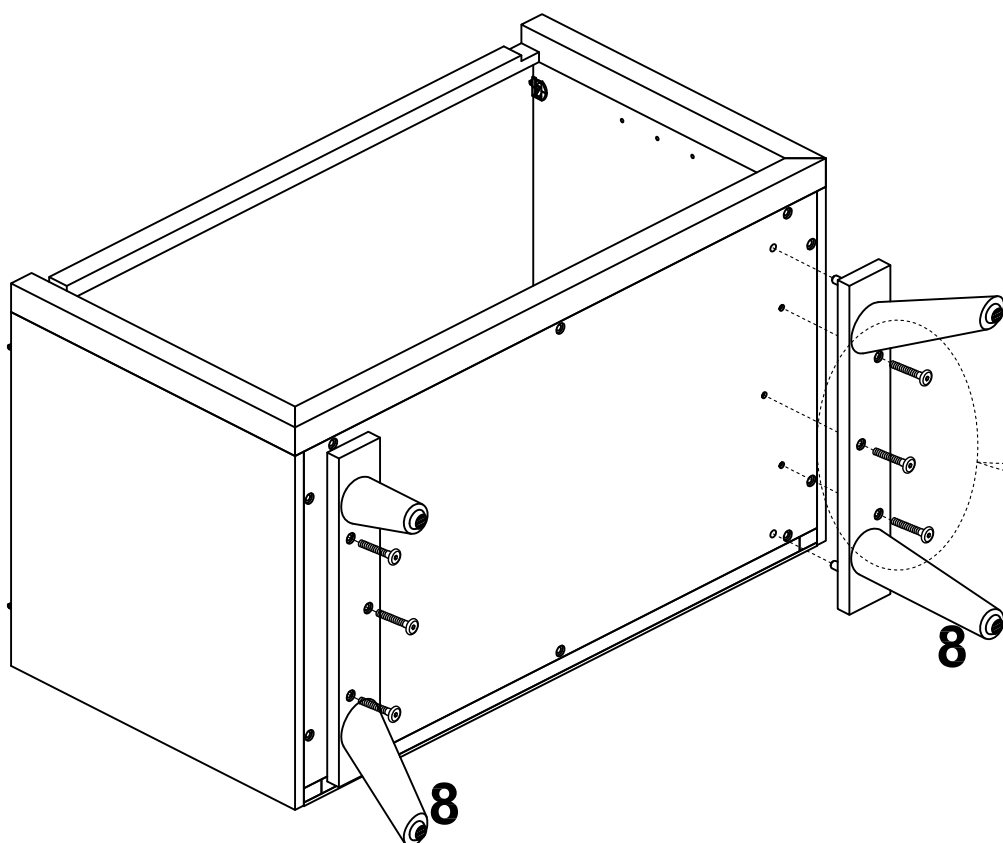
4**A x 10****B x 1****5****A x 6****B x 1**

7-12

6

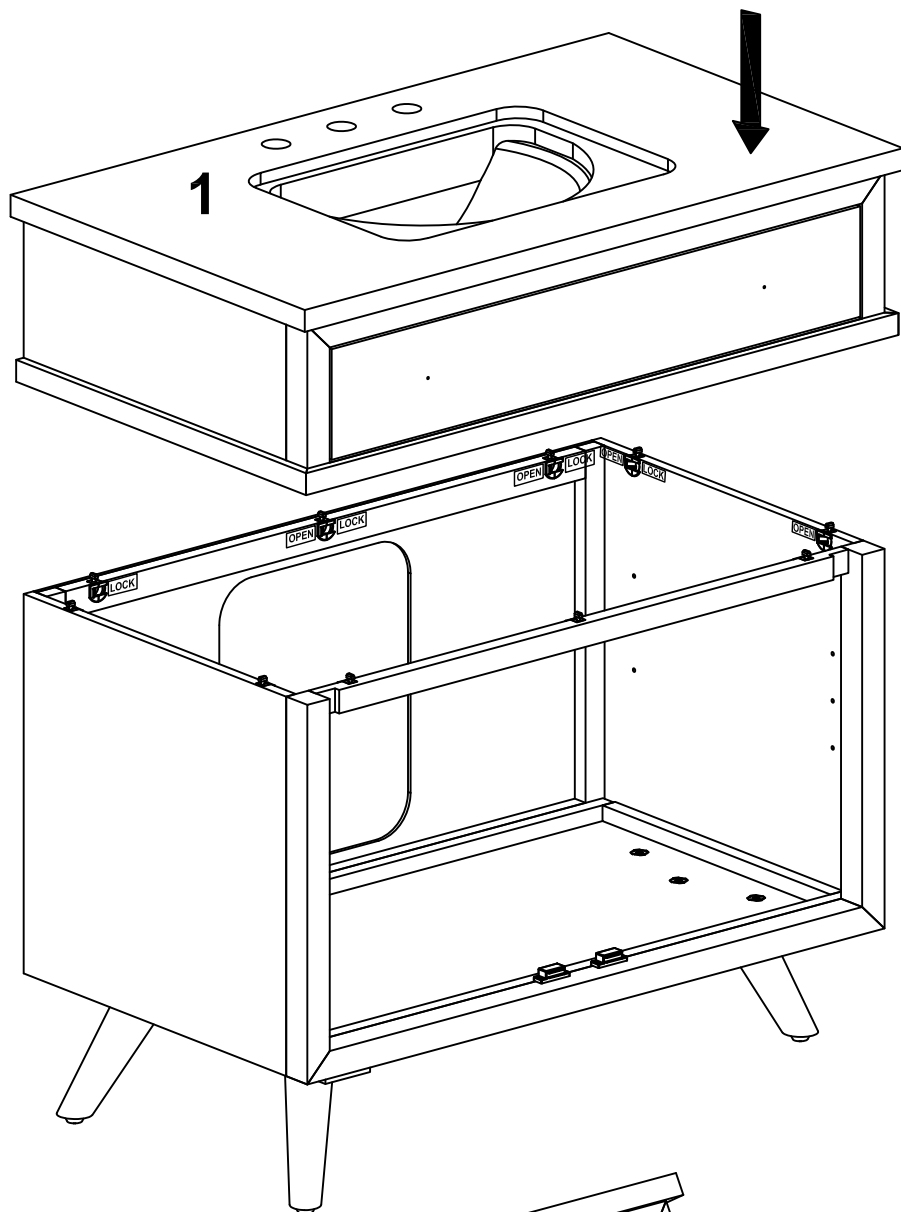

7

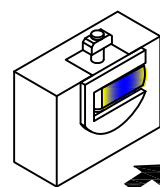
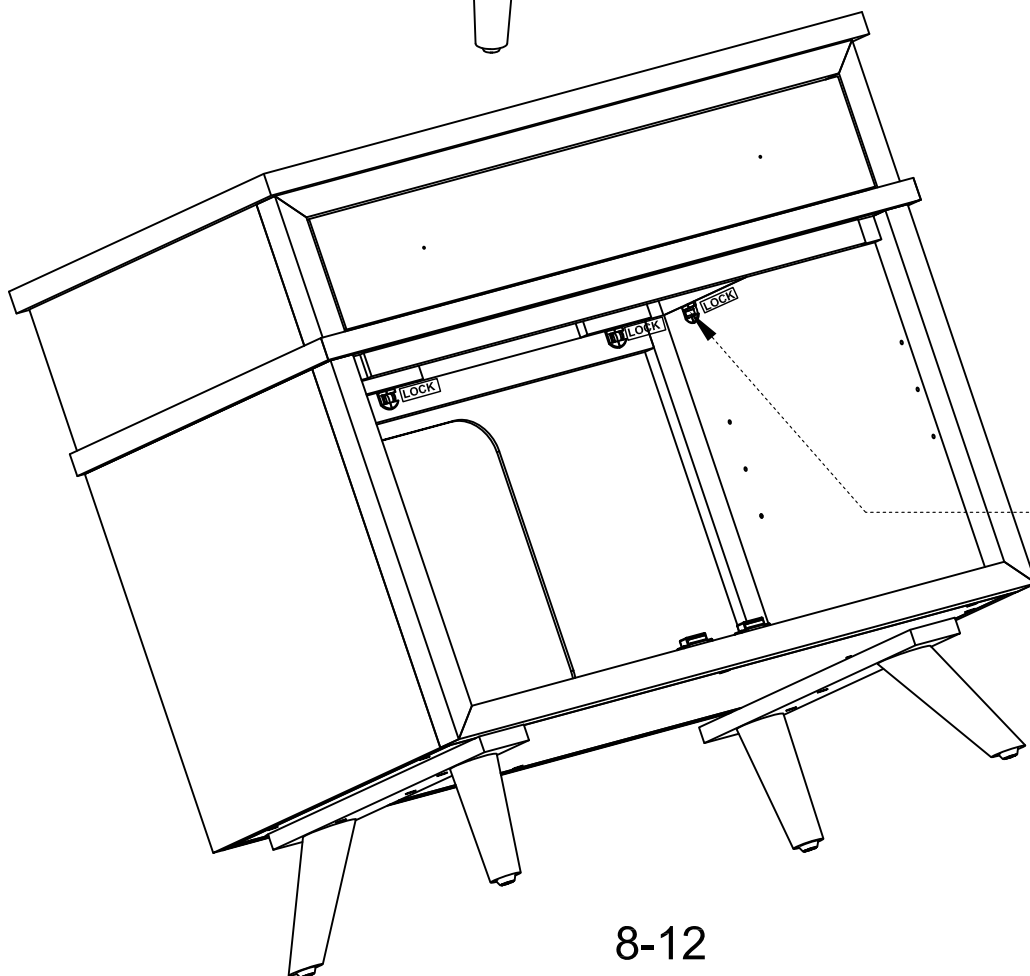

Lock

Make sure all latches are in the locked position

8-12

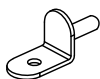
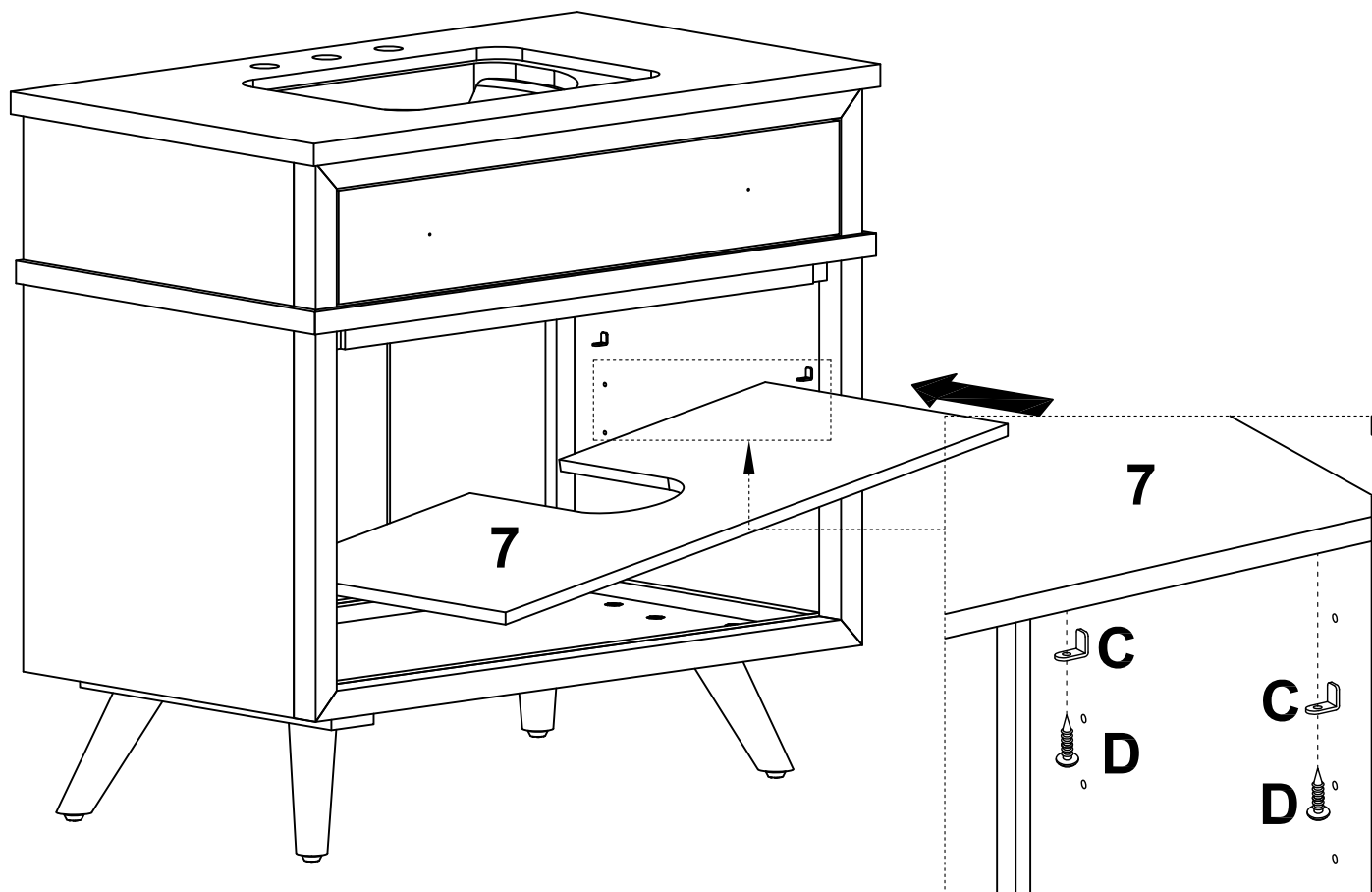
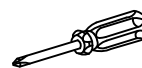
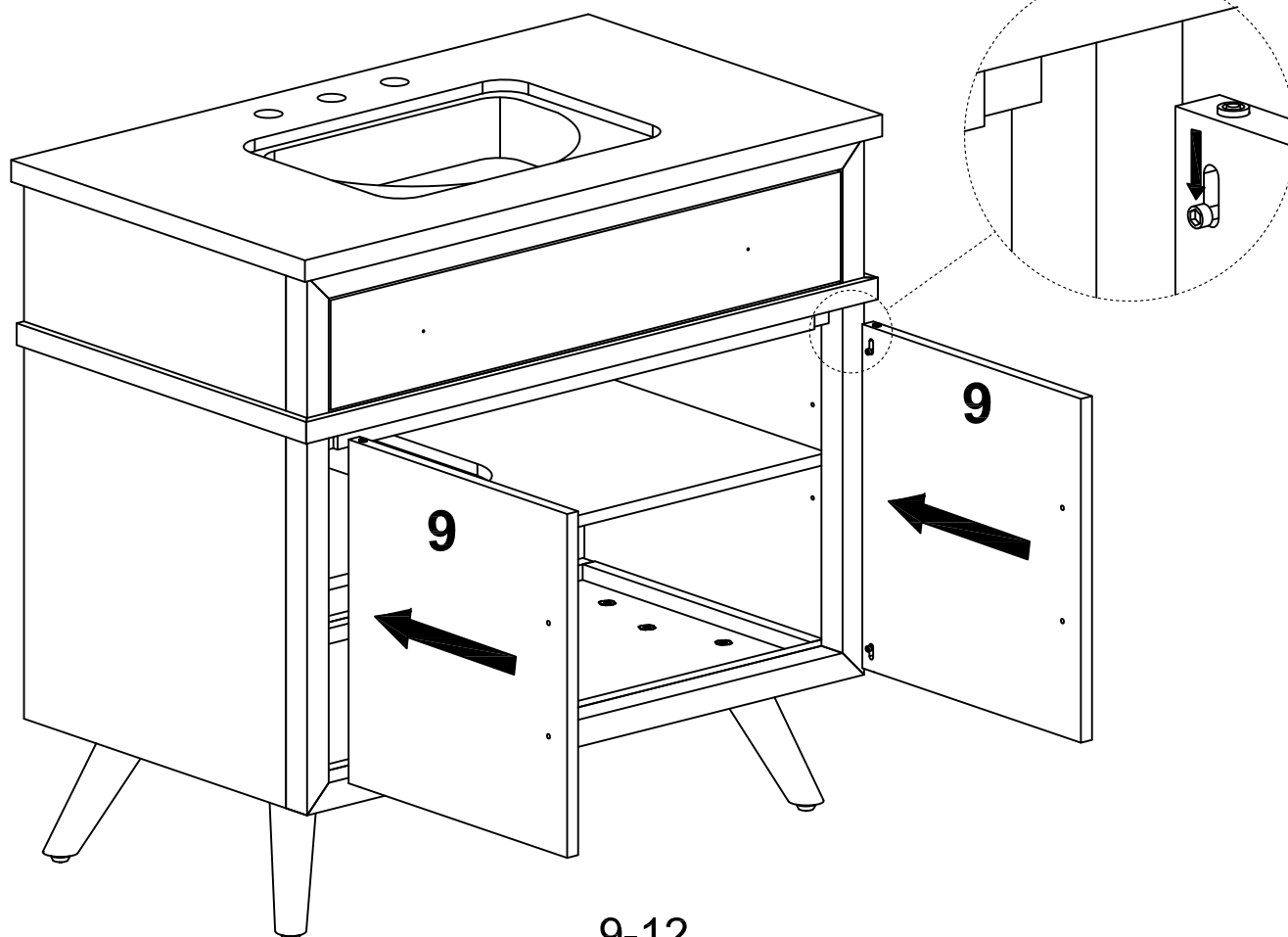
8**C x 4****D x 4****9**

9-12

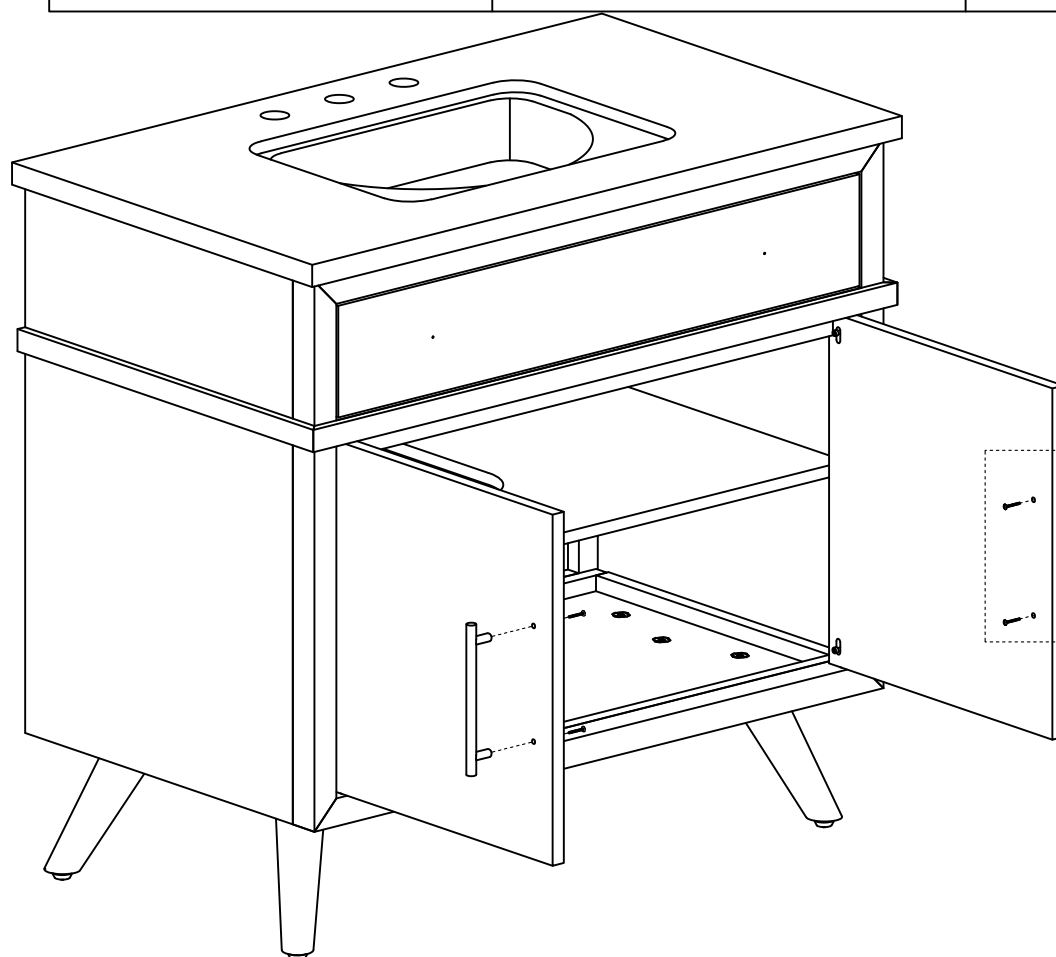
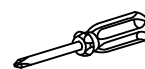
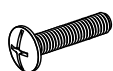
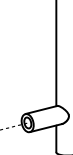
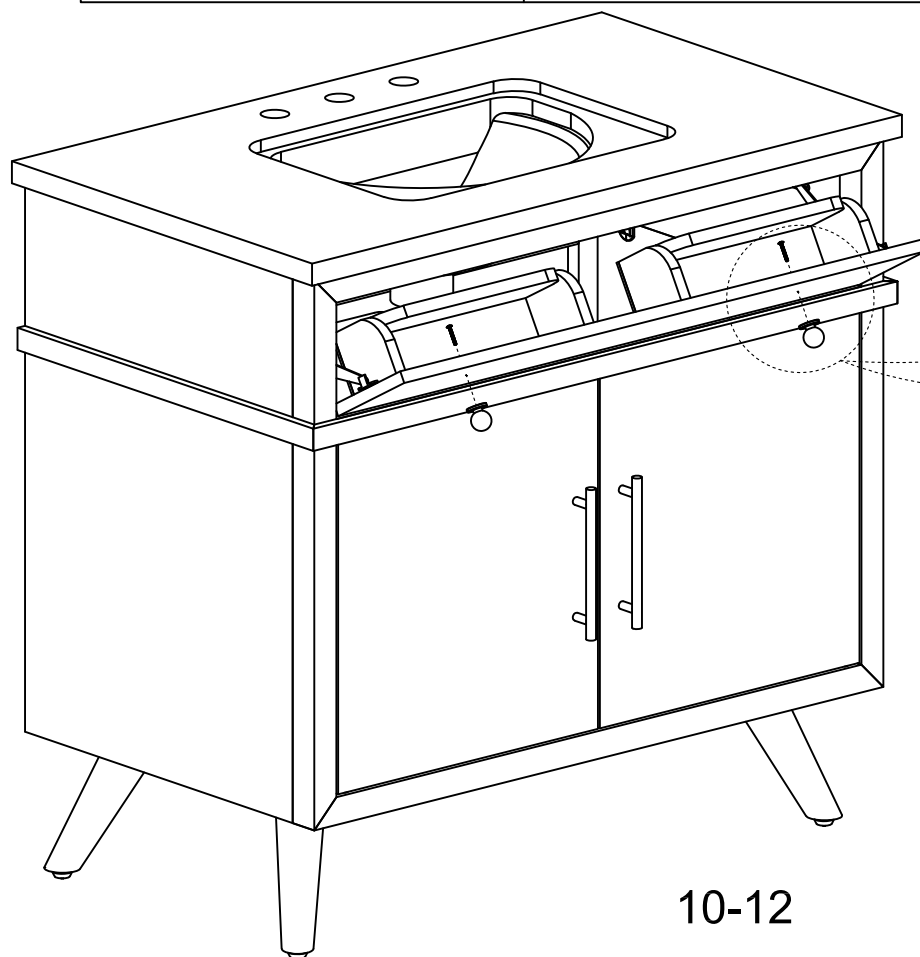
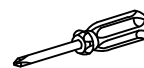
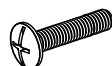
10**E x 2****G x 4****G****E****G****11****E x 2****G x 2****G****F**

10-12

12

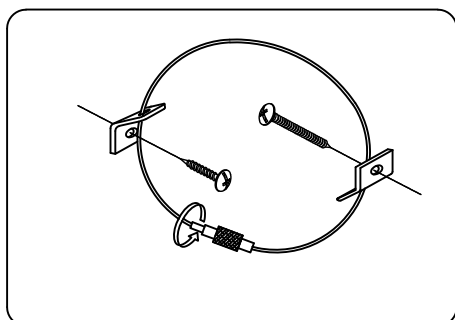
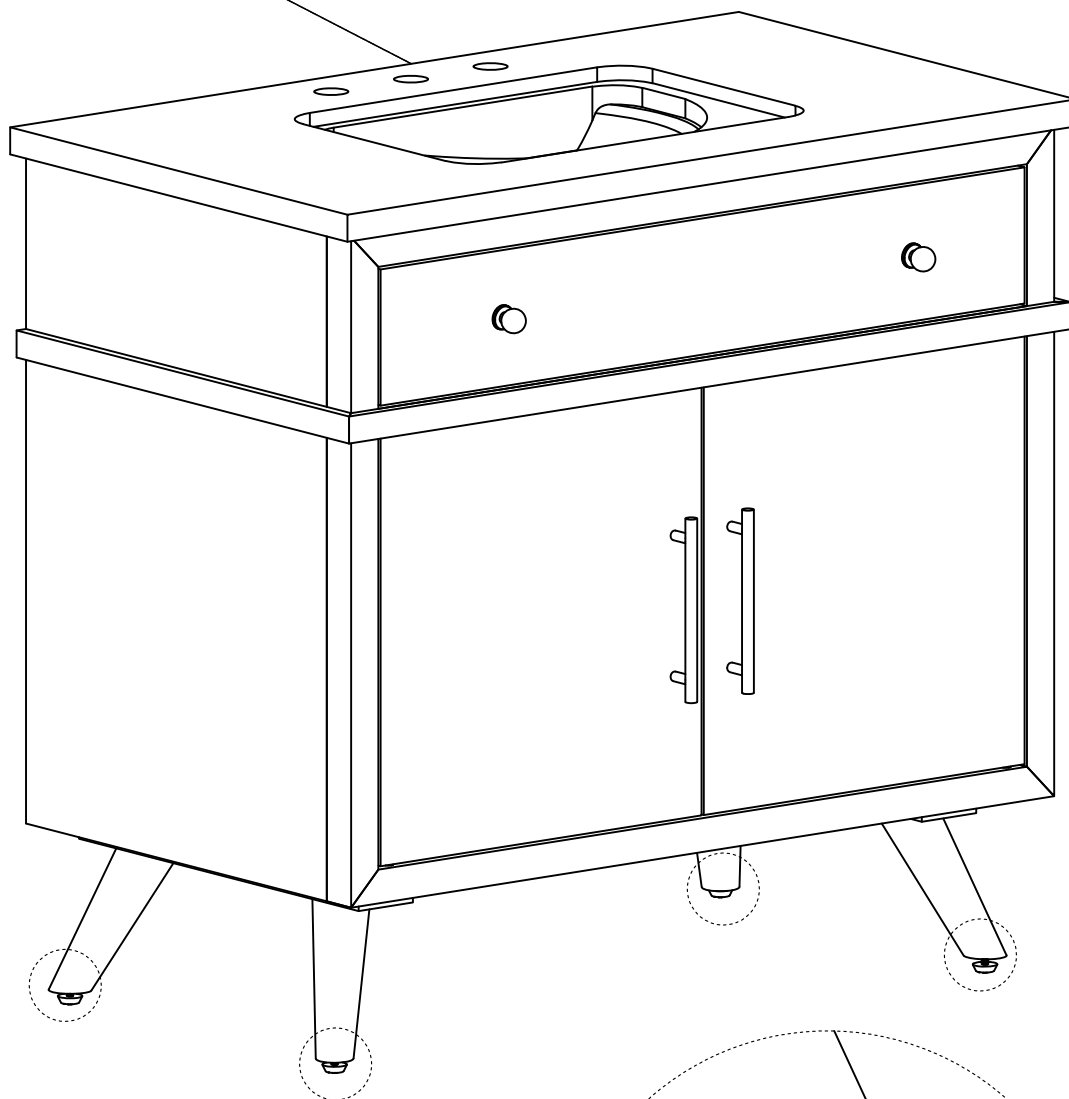
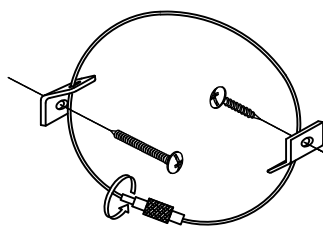
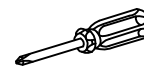

ANTI-TIP x 1 SET

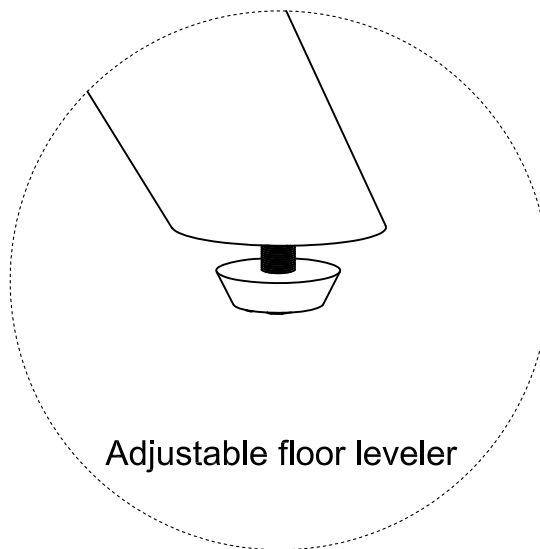

Adjustable floor leveler

MARTIN SVENSSON HOME LIMITED WARRANTY

EXCEPT AS EXPRESSLY STATED BELOW, OUR PRODUCTS ARE "AS IS" WITHOUT WARRANTY OF ANY KIND, EITHER EXPRESS OR IMPLIED, INCLUDING, WITHOUT LIMITATION, ANY WARRANTIES OF MERCHANTABILITY OR FITNESS FOR A PARTICULAR PURPOSE. BECAUSE SOME JURISDICTIONS DO NOT PERMIT THE EXCLUSION OF IMPLIED WARRANTIES, THIS DISCLAIMER MAY NOT APPLY.

We strive to produce defect-free furniture. Our products are warrantied for one (1) year from date of purchase against defects. **"Manufacturing Defects"** are described as:

- Missing drawer pulls or missing hardware required for assembly
- Drawers that are inoperable or that fail to open and close easily
- Screws or staples penetrating outer faces of product

Martin Svensson does not provide warranty protection against "damages resulting from inappropriate handling of the product by the customer, in-store, in-warehouse, or during transportation. **"Damages Resulting from Inappropriate Handling"** are described as:

- Crushed corners of top
- Separation of tops from their cases due to lifting the item by their tops
- Damage caused by failure to follow assembly instructions
- Blown out or punctured case-backs
- Rub marks on the wood surfaces, usually caused by improper handling

Most damages are caused by mishandling of furniture while it is still in the box. Care should be taken that products be stored with "arrows up" and not be "dragged across the floor" once they are assembled and are out-of-their cartons in the warehouse, in the store, or in the homes of consumers.

There are some "naturally occurring imperfections" associated with our type of product and manufacturing process that cannot be avoided, and therefore, must be accepted by our customers. **"Naturally Occurring Imperfections"** are described as:

- Limited number of small nail holes in decorative moldings
- Small spaces not fully covered at the edges and corners of the item and/or its tops



Replacement Part Form

Have an issue? Need a replacement part?

Please E-mail us before contacting your retailer, we will be happy to fix your issue.

This process will be hassle free! We will replace your part for free!

Please follow these easy steps below.

You will need to E-mail *Martin Svensson Home* Customer Service: Customerservice@mshome.co
(Please note it is .CO not .com)

Please scan or take a picture of this form filled out.

1. **Customer Name:** _____

2. **SKU# with issue:** _____

3. **Replacement Part # needed** _____

*Please reference the Assembly Instructions to identify needed part #'s

4. **Photos of the Damaged Part** (please include in the e-mail)

5. **Brief description of the part issue:** _____

6. **Proof of Purchase** (please provide a copy of your purchase receipt)

7. **Ship to Address:** _____

8. **Other contact information:**

Email Address _____

Phone # _____

*If possible, could you please provide the UPS or FedEx tracking from original shipment _____

*If possible, could you please provide the P.O. # - information found on back/underneath product _____

*If you have any other question, we are happy to assist with assembly questions or all other parts related questions. Thank you for your purchase!