

# Assembly Instructions

Caution: You must read this before you proceed

## Care & Maintenance



- Not for commercial use. For residential use only.



- Do not put hot items directly on furniture surface.



- Do not clean furniture with harsh cleansers or polish.



- Do not place furniture under direct sunlight.



- Do not place furniture near heating or cooling vents.



- Do not write on furniture without a padded barrier to protect the surface.



- Do not place furniture outside . For indoor use only.



- Stains may be removed with mild soap solution and damp cloth.



- Children should not climb or jump on the furniture.



- Dust and pick-up spills using a clean, non-colored, lint-free cloth.

Please look in Corners of carton for hardware packs and Legs.

# Assembly Instructions

Please look in the Table for Hardware packs and Legs

## Round Coffee Table

Item No: N735P369879

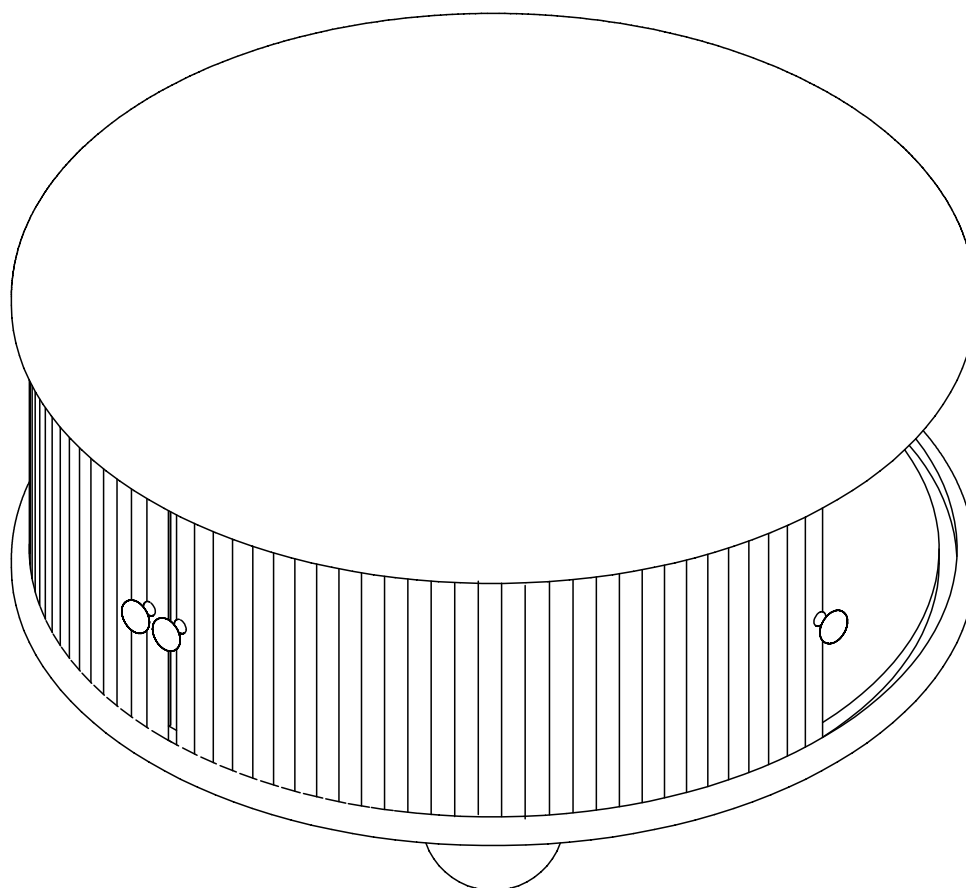

**Caution:** This Round Coffee Table is NOT a TOY. Keep your child / children at bay during the assembly process. Whenever lifting or moving the Loveseat and to prevent damage to the Table, two adults may be needed to execute these actions.

# ASSEMBLY INSTRUCTION

## ITEM NO. N735P369879

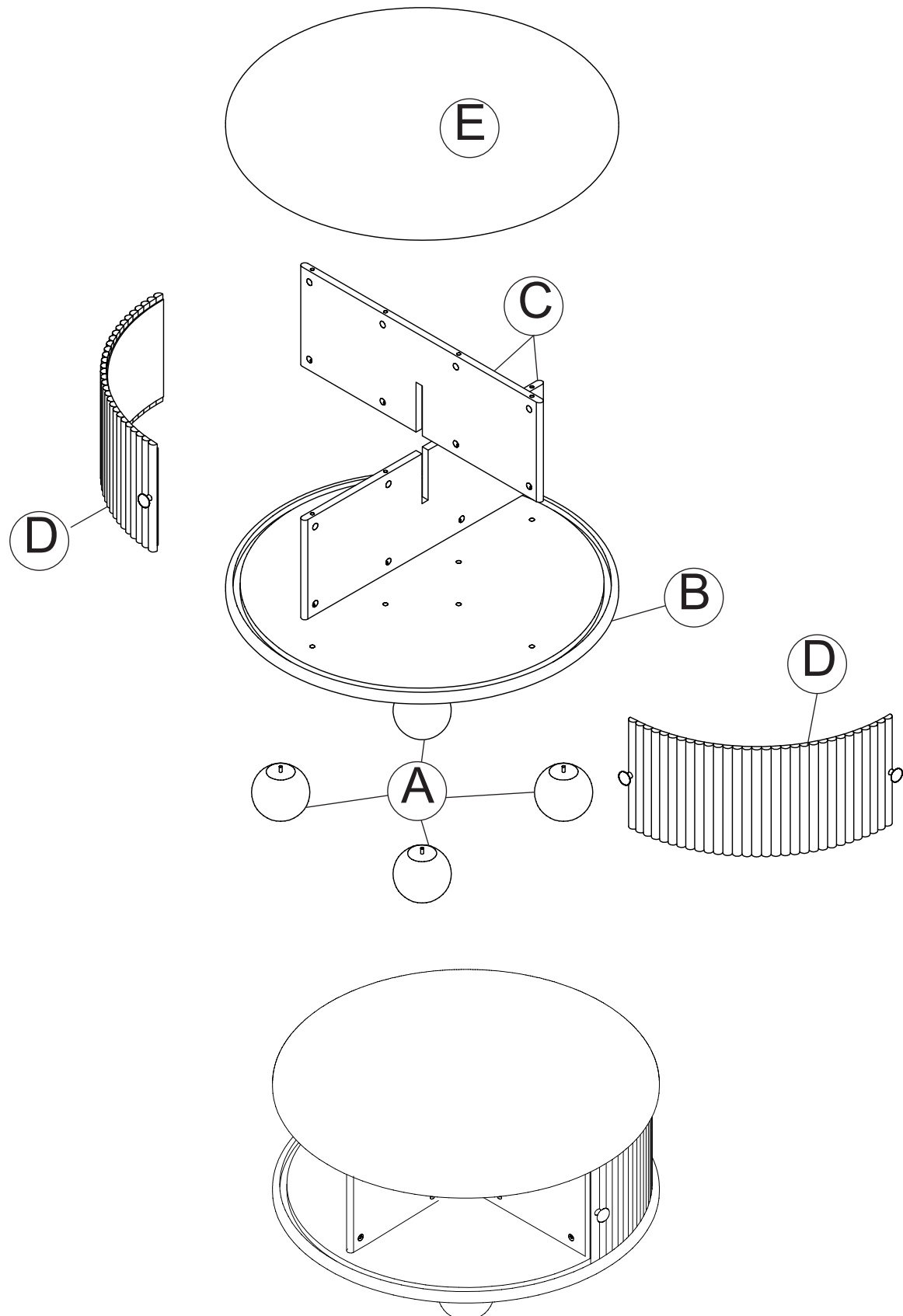

# ASSEMBLY INSTRUCTION

## ITEM NO. N735P369879

### Part List

A

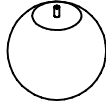

Legs = 4pcs

B

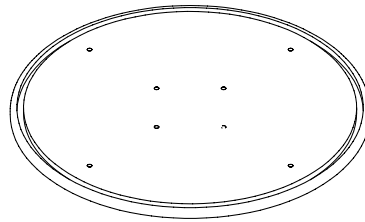

Bottom = 1pc

C

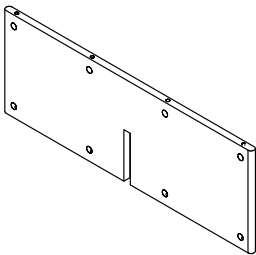

Midle Panel = 2pcs

D

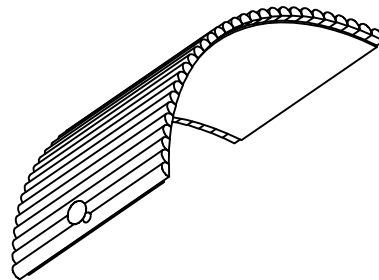

Door = 2pcs

E

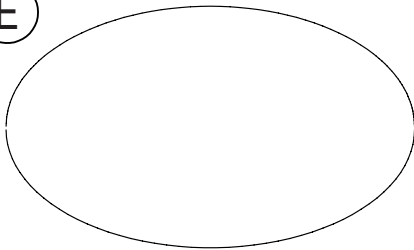
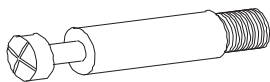

Table Top = 1pc

### Hardware List

1



Cam Bolt =16 pcs

2



Cam Lock = 16pcs

3



Handle = 4pcs

4



Bolt of Handle=4pcs

5



Allen Key=1 pc



Screwdriver (Not included)

# Assembly Preparation

## Before Beginning Assembly:

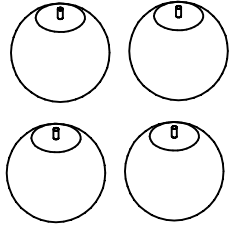

Ⓐ Legs = 4pcs

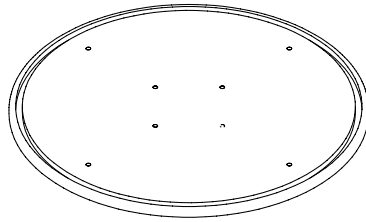

Ⓑ Bottom = 1pc

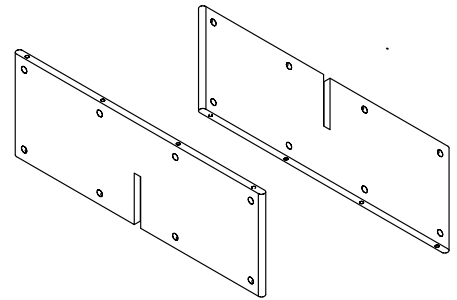

Ⓒ Midle Panel = 2pcs

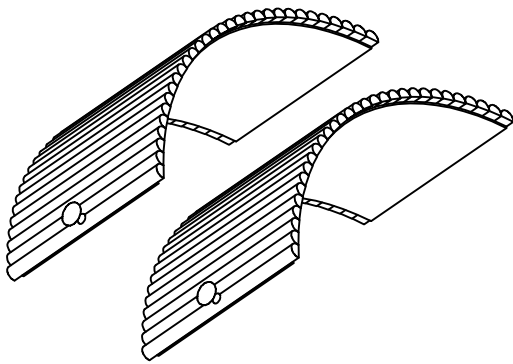

Ⓓ Door = 2pcs

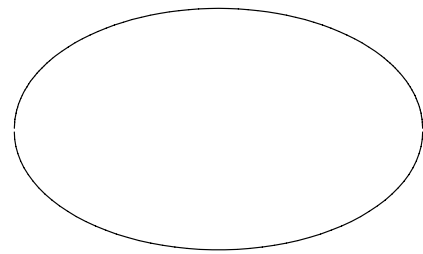

Ⓔ Top table = 1pc

① X 16



④ X 4



② X 16



⑤ X 1



③ X 4



Screwdriver (Not included)

## Assembly Preparation Before Beginning Assembly:



- Read instructions, cover to cover-



- Have 2 adults on hand for assembly-



- Do not assemble on flooring or carpet-



- Assemble on a clean non-marring surface (packing foam)-



- Save all packaging until finished-

## Assembly Steps

### Overview

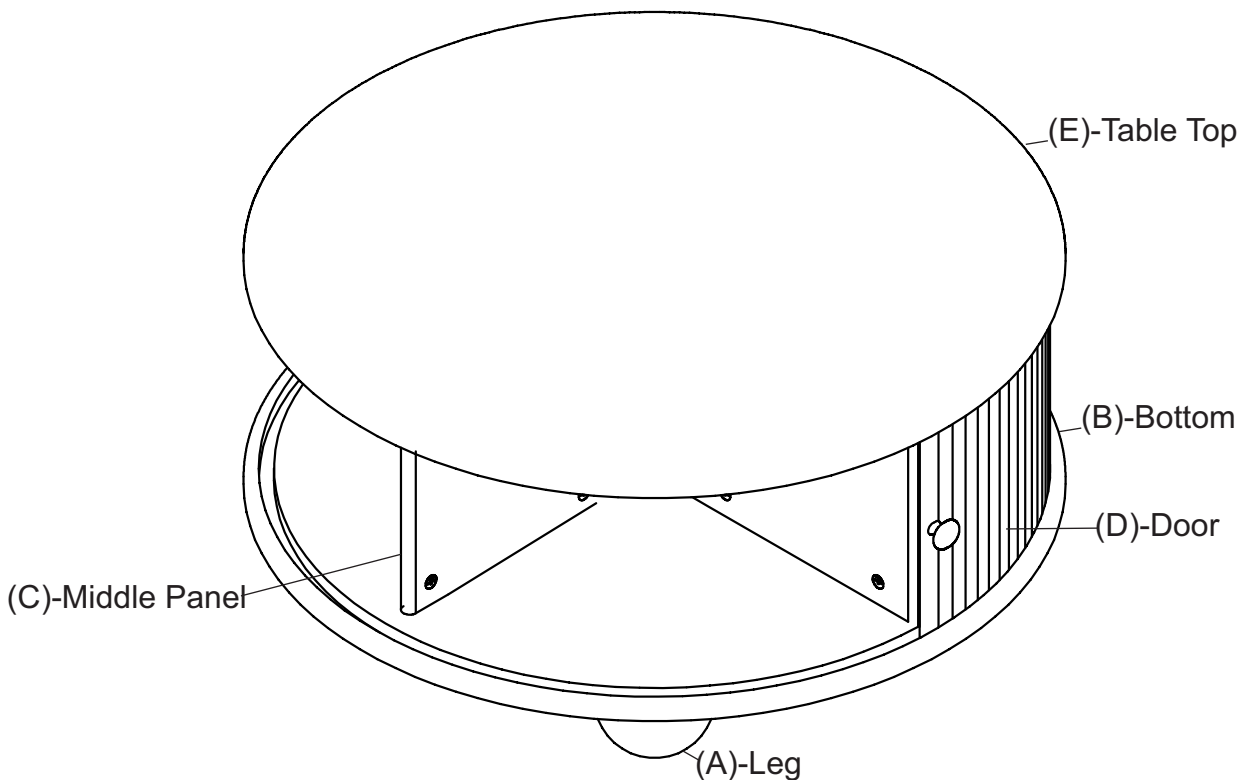

FRONT FACING

This Coffee Table has multiple parts and may require up to 30 minutes to assemble. To give you an overview of the Table parts, the above picture is to help you put the various parts into perspective. Please read through the instructions below to familiarise yourself with the parts and steps before assembly.

# ASSEMBLY INSTRUCTION

## ITEM NO. N735P369879

**Step 1** Install the four table legs onto the underside of the bottom panel using a simple fastening procedure. Once all four legs are securely attached, turn the panel over to its upright position.

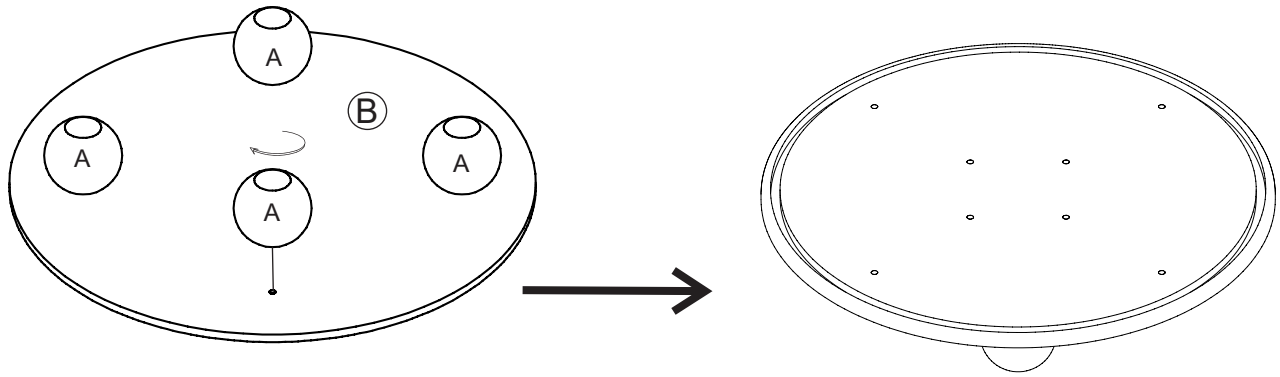

**Step 2** . Screw the Cam Bolts (1) into the Bottom panel (B) and Table Top (E)

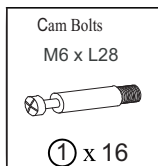
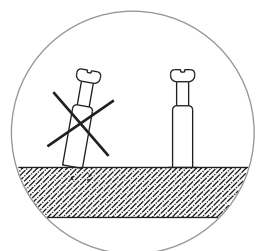
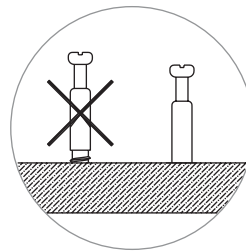
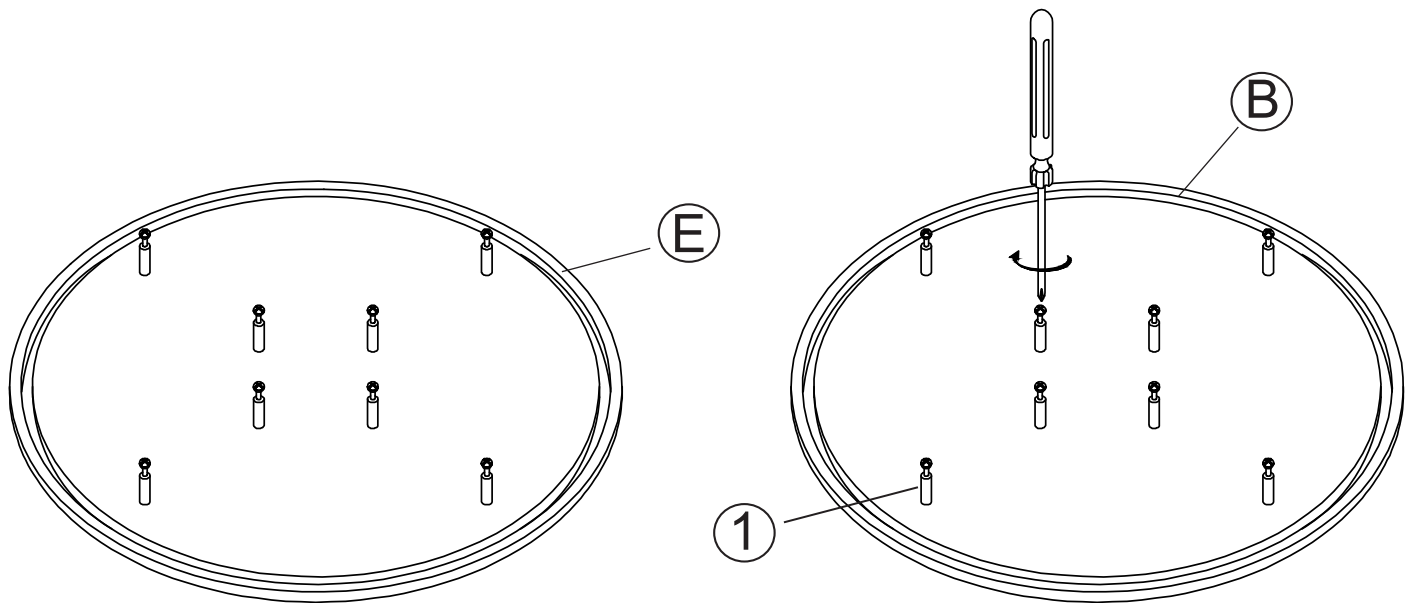

# ASSEMBLY INSTRUCTION

## ITEM NO. N735P369879

**Step 3** Next, install the Middle Panels (C) onto the Bottom panel (B) .Align the holes with the Cam Bolts (1) you inserted in Step2, then secure with the Cam Locks (2)

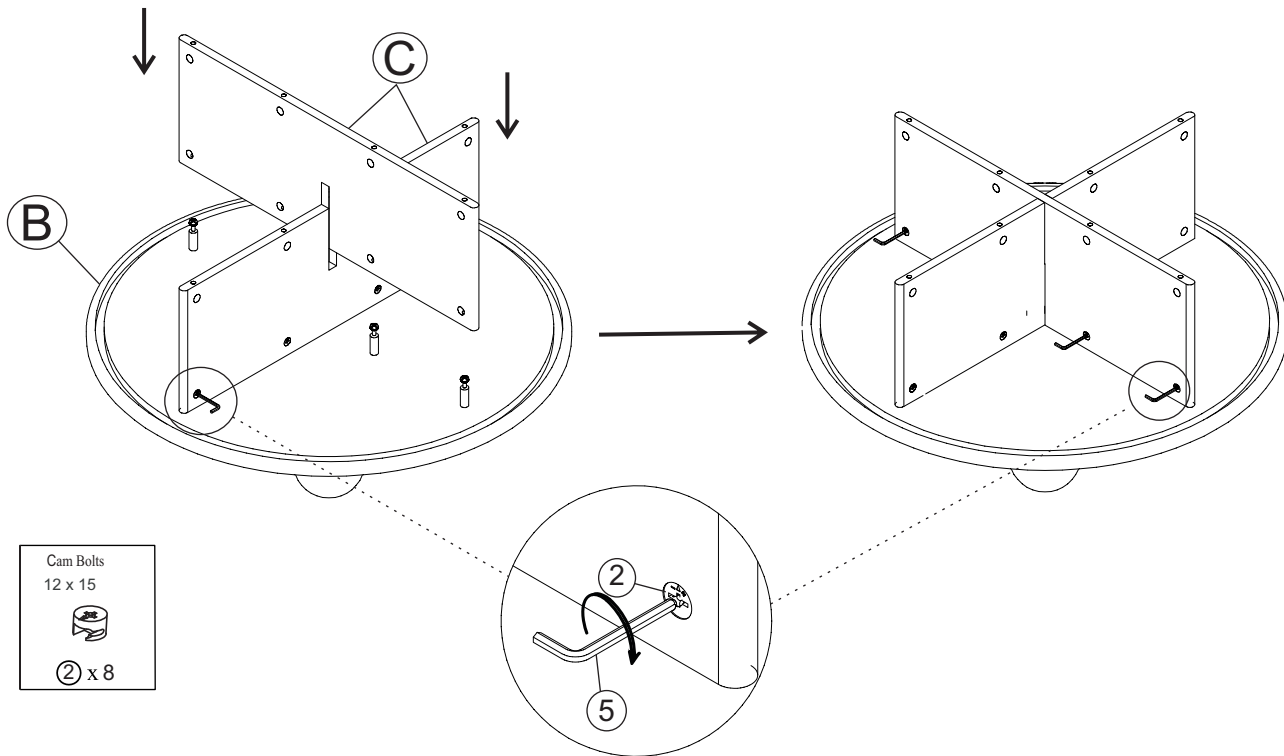

**Step 4** . Next, install the handles (3) onto the doors and secure them using Bolts (4). Then, insert the two doors into the sliding door grooves on the Bottom panel (B).

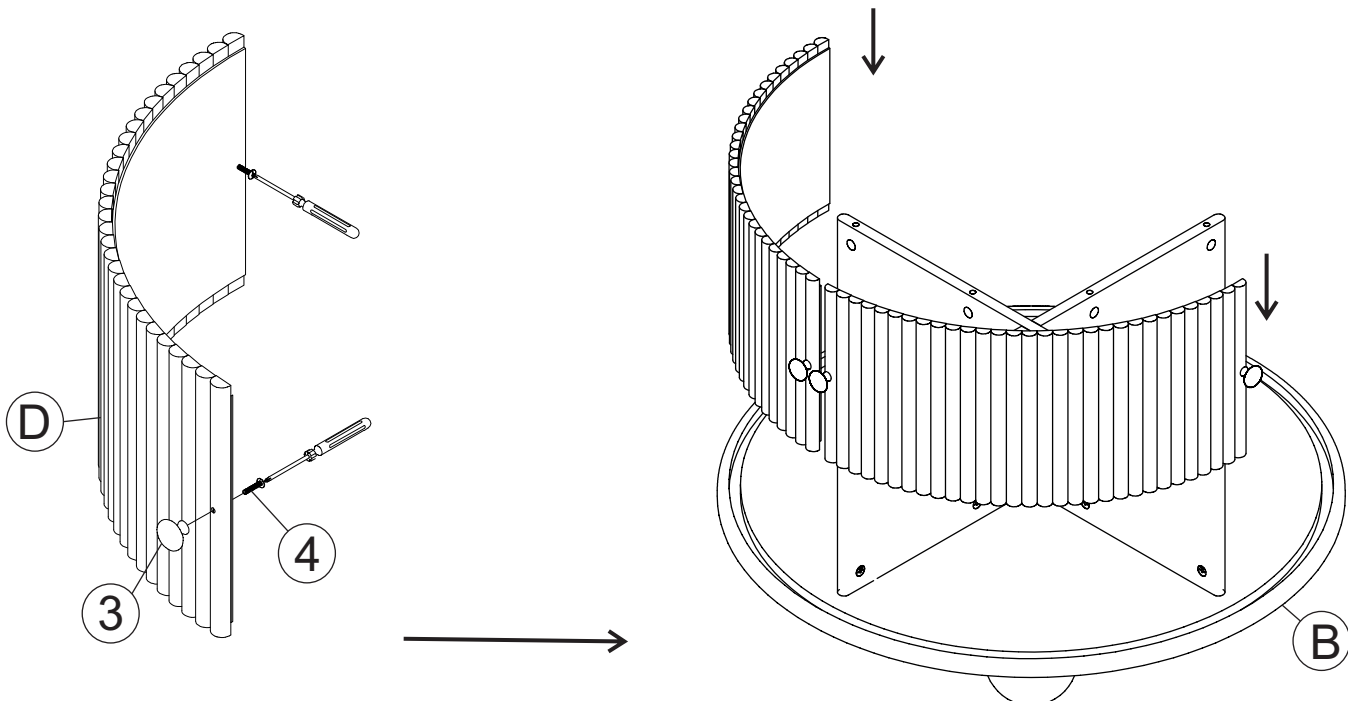

# ASSEMBLY INSTRUCTION

## ITEM NO. N735P369879

**Step 5** Next, install the Table Top (E) onto the Middle panel © .Align the holes with the Cam Bolts (1) you inserted in Step2, then secure with the Cam Locks (2)

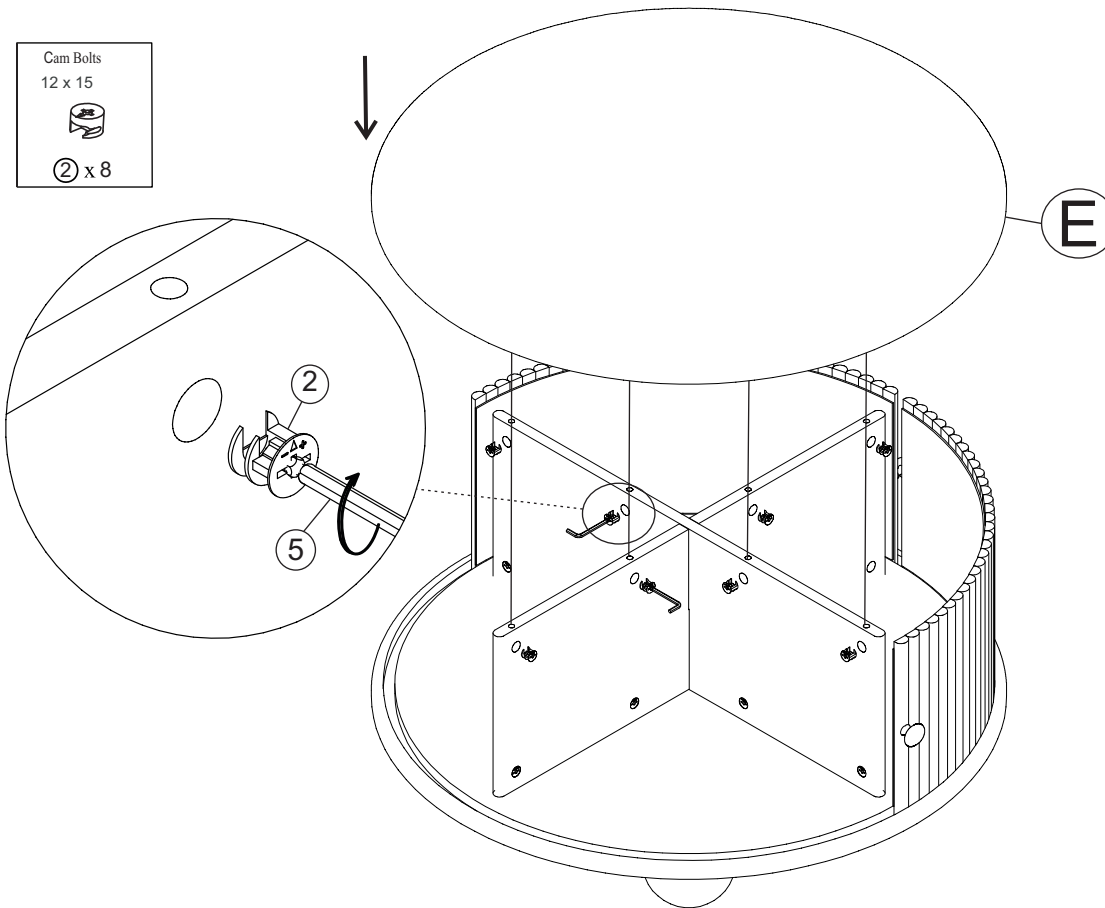

**Step 6** . Finally, you may slide the doors to different positions to easily inspect all connection points, ensuring that the product has been fully and properly assembled before use.

