

DREAMS

IDEA

Instruction Manual



DREAMS/IDEA

NO.OD0003(D)-LOVESEAT

ABOUT US

*D*REAMSIDEA IS A ONE-STOP HOME

FURNISHING AND SERVICE COMPANY BASED IN USA.

WE ARE DEDICATED TO BRINGING YOUR DREAM HOME TO LIFE.

OUR SERVICES COVER FROM DESIGN, PRODUCTION,

DIRECT SELL, STORAGE, AND TRANSPORTATION.

IF REALITY IS THE NEAR SHORE

AND IDEALISM THE FAR SHORE,

*D*REAMSIDEA

AS THE FERRY BETWEEN THEM,

EAGER TO ACCOMPANY YOU ON A JOURNEY

TO YOUR IDEAL HOME.

ITEM NO.OD0003(D)-LOVESEAT

WARRANTY

We strive to offer high quality product and we also try our best to satisfy each customer that order from us, no matter on products or services as needed. Each customer receives a record of their order, such as the order number or item receipt. For any items that are out of warranty period, you may still be able to purchase the replacement parts from our company if they are available.

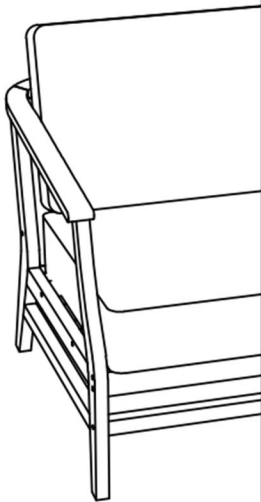

Are you having difficulty
with assembly? Missing parts?

Please contact us : info@firstopintl.com

Tel:(562)-781-3327

send an email with your order No. to us

For return, please check the return policy with
the retailer or platforms you bought from.

Appreciate your purchasing from us.

Pop up your life by our furniture !

MAINTENANCE AND WARNING

Please read the manual thoroughly
before you start installing.

Please keep the product away from
sharp object.

Packaging and small parts may have
chocking hazard, please keep them away
from children and pets.

Please clean the product according to each
clean code, check the product description
for more information.

Please keep the product away from
fire.

If you have any other questions, please
contact us, we will be glad to help you out.

If the product is placed under direct
sunlight, the pattern or color might fade
away overtime.

Check the product periodically to make
sure everything is secured and tightened.

Always use proper tools for installation.

Do not jump on the product.



Two people

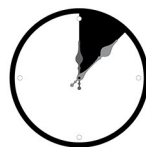

Around 35 min

PRODUCT DESCRIPTION

Crafted from durable solid teak wood for excellent weather resistance and long-lasting strength.

Waterproof cotton-blend fabric upholstery resists rain, UV rays, and stains, making it ideal for outdoor spaces.

Spacious seating area with a gracefully curved backrest ensures superior ergonomic comfort.

Thick cushions filled with plush foam and soft synthetic fibers offer outstanding relaxation and support.

Sculptural openwork armrests with rich wood grain provide a modern, refined look that complements outdoor décor.

Dream



House

EXPLODED VIEW

Jx2



Ix2

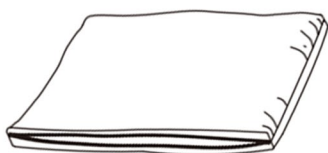

The product's left and right are determined by sitting posture

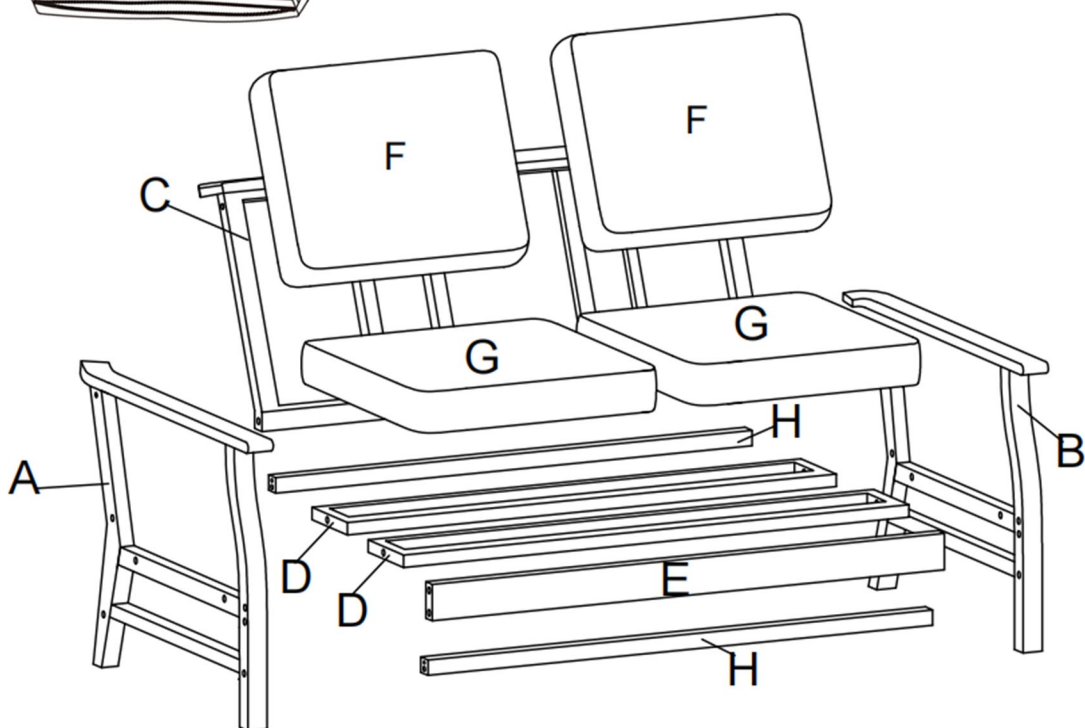

PARTS

Ax1

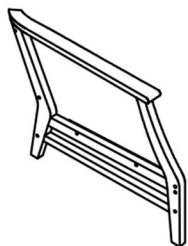

Right arm

Bx1

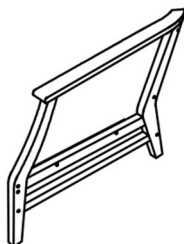

Left arm

Cx1

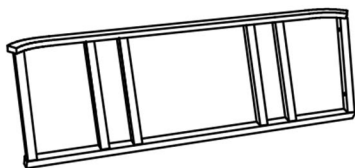

Backrest

Dx2



Seat frame

Ex1



Seat rail

Fx2



Back cushion

Gx2

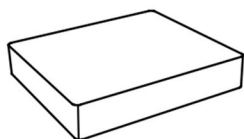

Seat cushion

Hx2



Rail bar

Ix2



Seat cushion cover

Jx2



Back cushion cover

HARDWARE

TOOL LIST

NOTE: Designated with (★) We provide additional spare parts in the hardware package

①*4



M6*40mm
Bolts

②*12



★ M6*50mm
Bolts

③*1

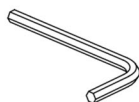

Allen key

④*8



★ Vertical nut

⑤*16



★ Black hole
cover

⑥*16



★ Ø6*14mm
Flat washer

⑦*4



Wooden dowel

Please make sure all hardware&packing material fitting the list.
Especially some small accessories may be missing during transportation. Please contact us if you have any question.

step 1 ---Cut the air compression bags

After taking out the cushions (F&G) from the air compression bags, please allow them to recover for a period of time. It may take up to **48** hours to fully recover. You can gently slap them to speed up the process.

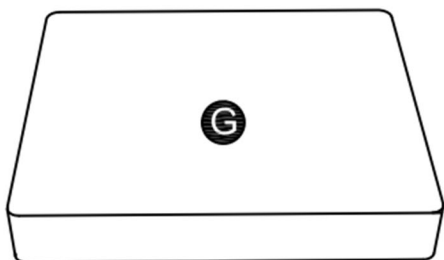
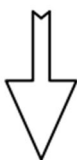
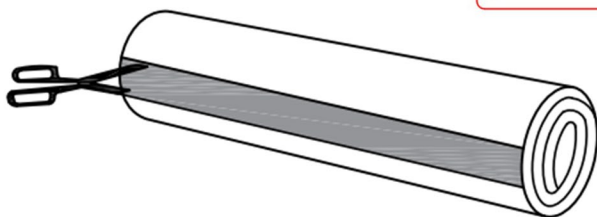
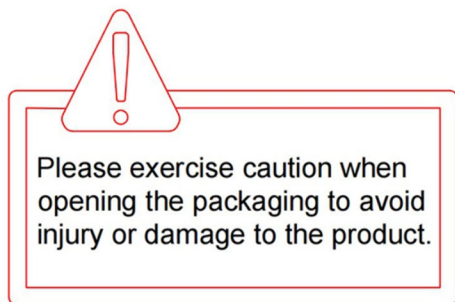

X2

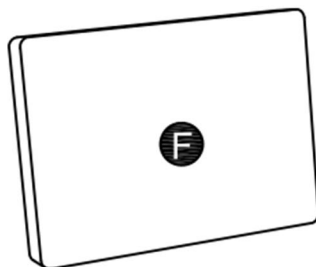

X2

step 2 ---Put on the cushion cover

How to Put on the Cushion Cover

1

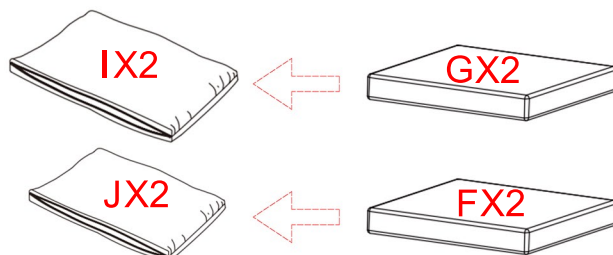

1.Take the cushion covers and inner inserts out of the carton.

2

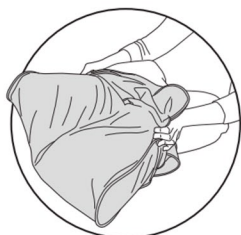

2.Fold the inner in half, pushing the sides together, then begin to slide the cover onto it.

3

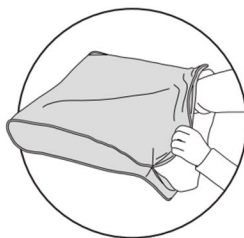

3.Align both far corners, then gently compress insert while fitting cover around it.

4



4.To avoid a stuck zipper, please pull the fabric away from the zipper before moving forward.

5

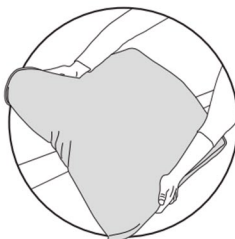

5.When all done, please pat the cushion or give it a little shake to make it more flat.

step 3 ---Install the Rail bar (H)

Insert the wooden dowels (7) into each end of the rail bar (H) as shown, then align with the pre-drilled holes on the armrest. Place the nuts (4) into the designated holes on the rail bar (H) as shown, make sure the holes on the nuts (4) are aligned with the holes on both sides of the rail bar (H). Use the allen wrench (3) provided to tighten the bolts (2) and washers (6) from the other side of the armrest.

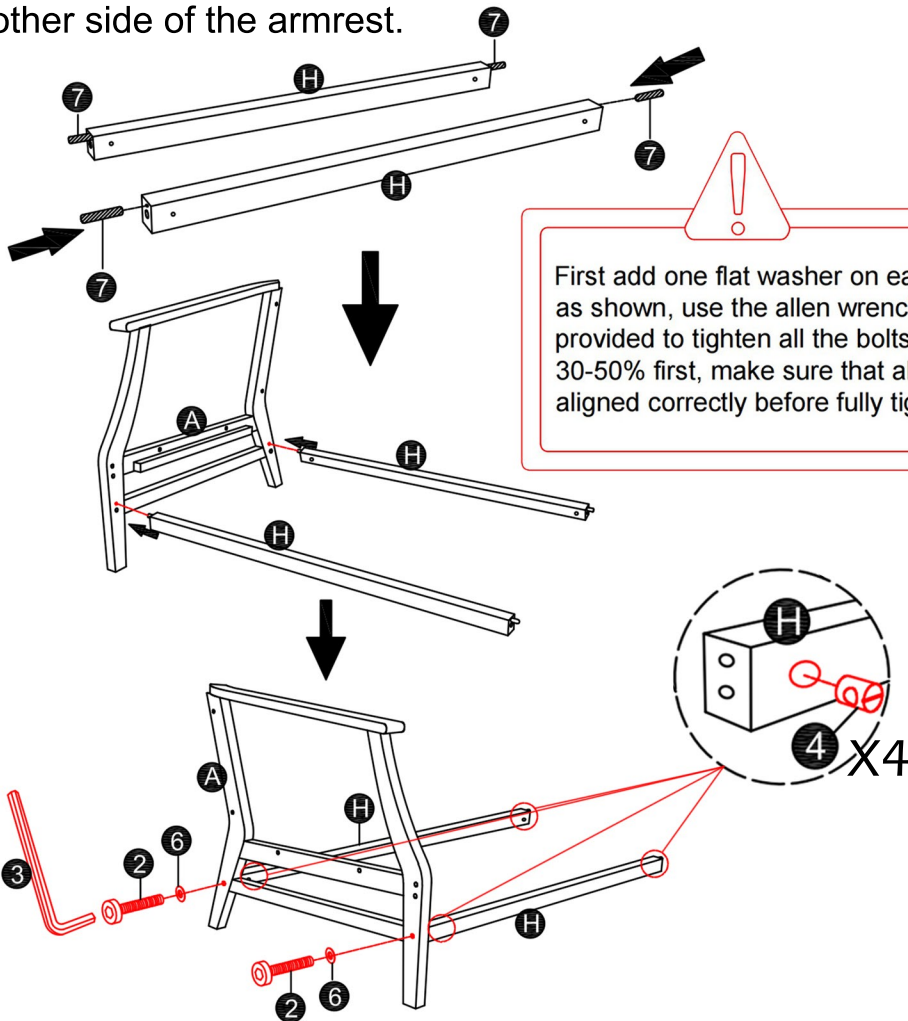

step 4 ---Install the Seat Rail (E)

Place the nuts (4) into the designated holes on the Seat Rail (E) as shown, make sure the holes on the nuts (4) are aligned with the holes on both sides of the Seat Rail.

Attach the Seat Rail (E) to the Right Armrest (A), use the allen wrench (3) provided to tighten the bolts (2) and washers (6) .

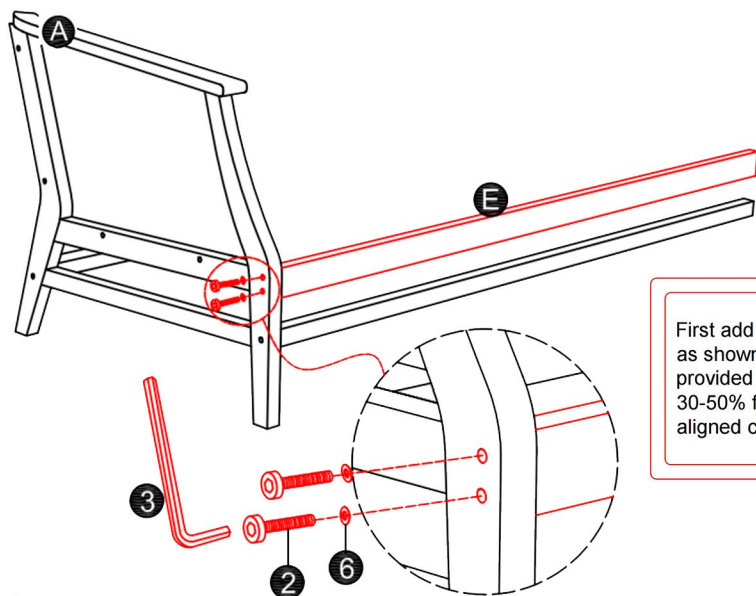
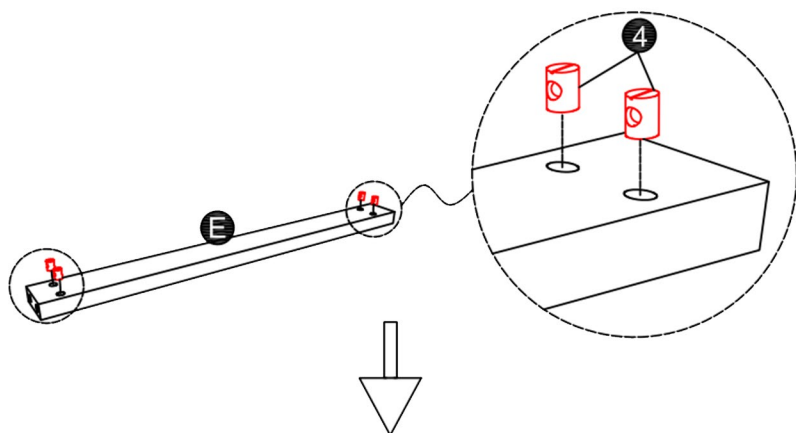

First add one flat washer on each bolt as shown, use the allen wrench provided to tighten all the bolts by 30-50% first, make sure that all bolts are aligned correctly before fully tightening.

step 5 ---Install the Seat frame (D)

Attach the Seat frame (D) to the Right Armrest (A), use the allen wrench (3) provided to tighten the bolts(1) and washers(6).

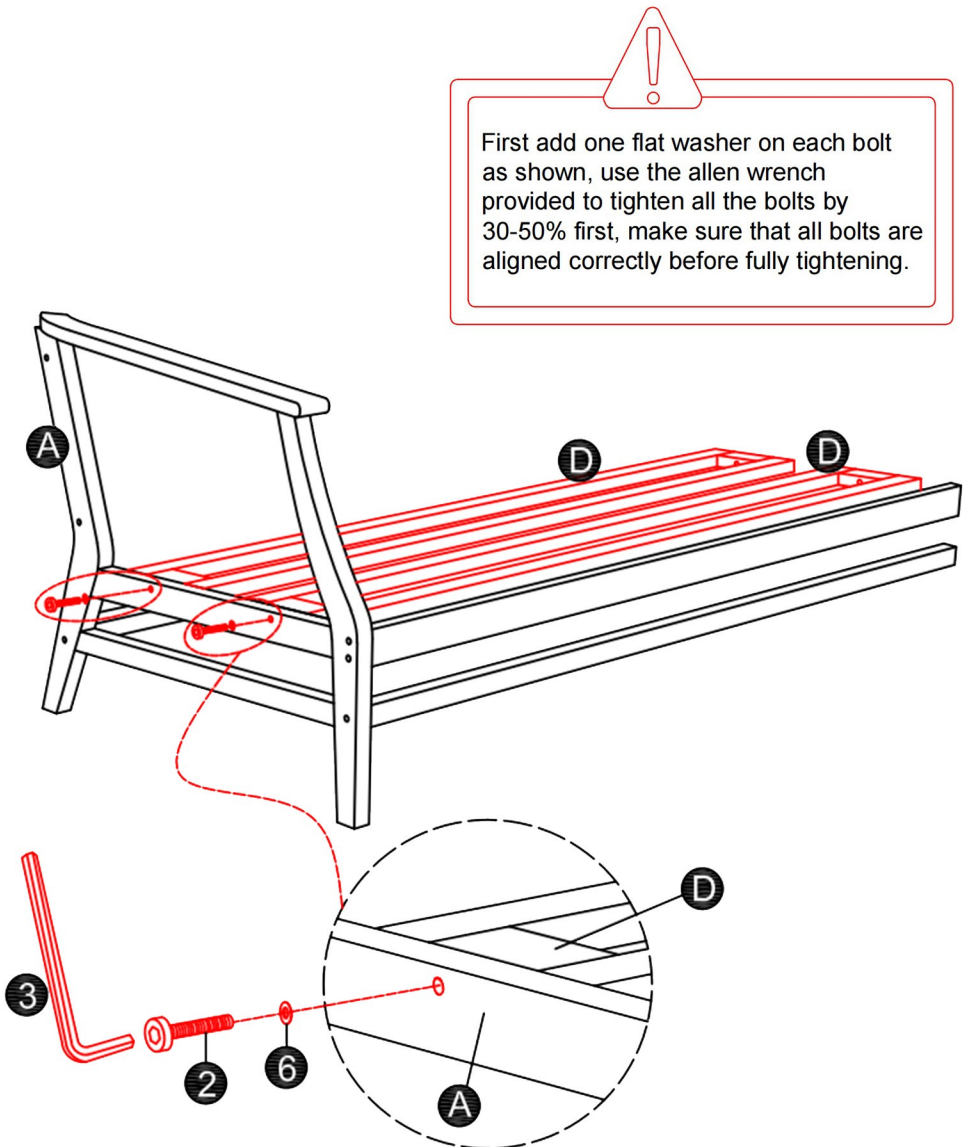

step 6 ---Install the Backrest (C)

Connect the Backrest (C) to the Right Armrest (A) as shown, then use the allen wrench provided (3) to tighten the bolts (1) and washer (6) .

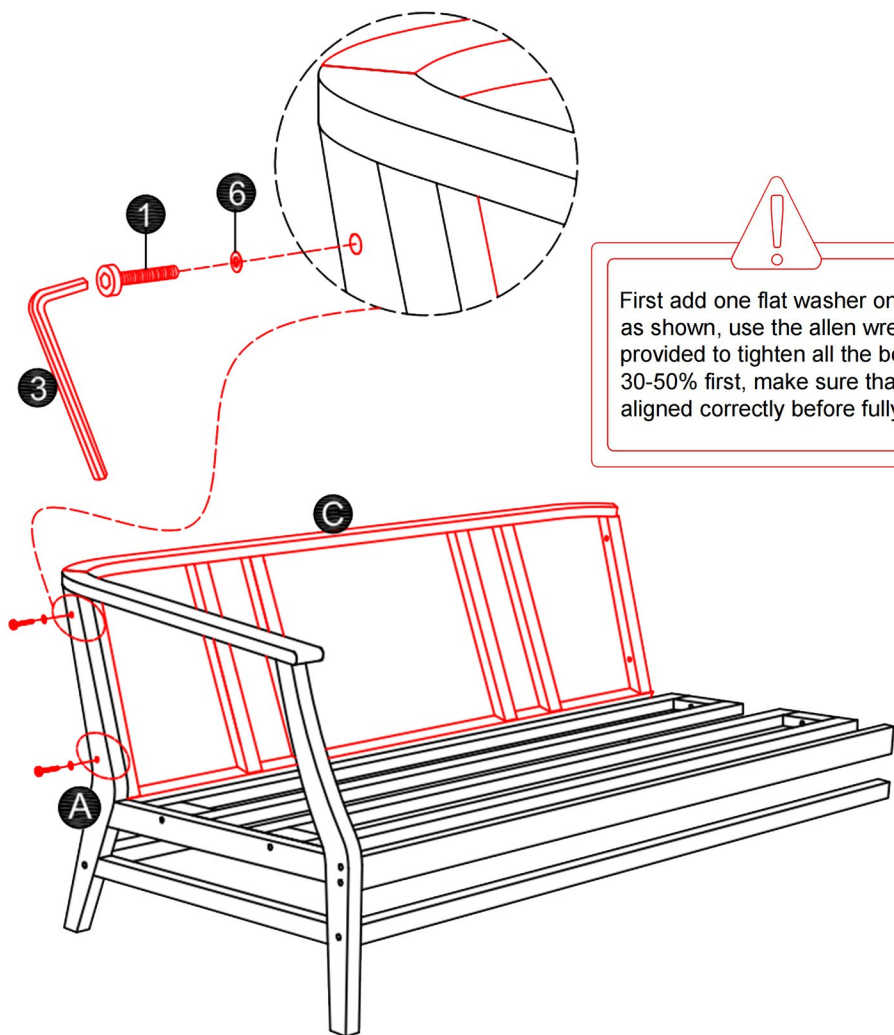

step 7 ---Install the Left Armrest (B)

Install the Left Armrest (B) using the same method from previous step.



First add one flat washer on each bolt as shown, use the allen wrench provided to tighten all the bolts by 30-50% first, make sure that all bolts are aligned correctly before fully tightening.

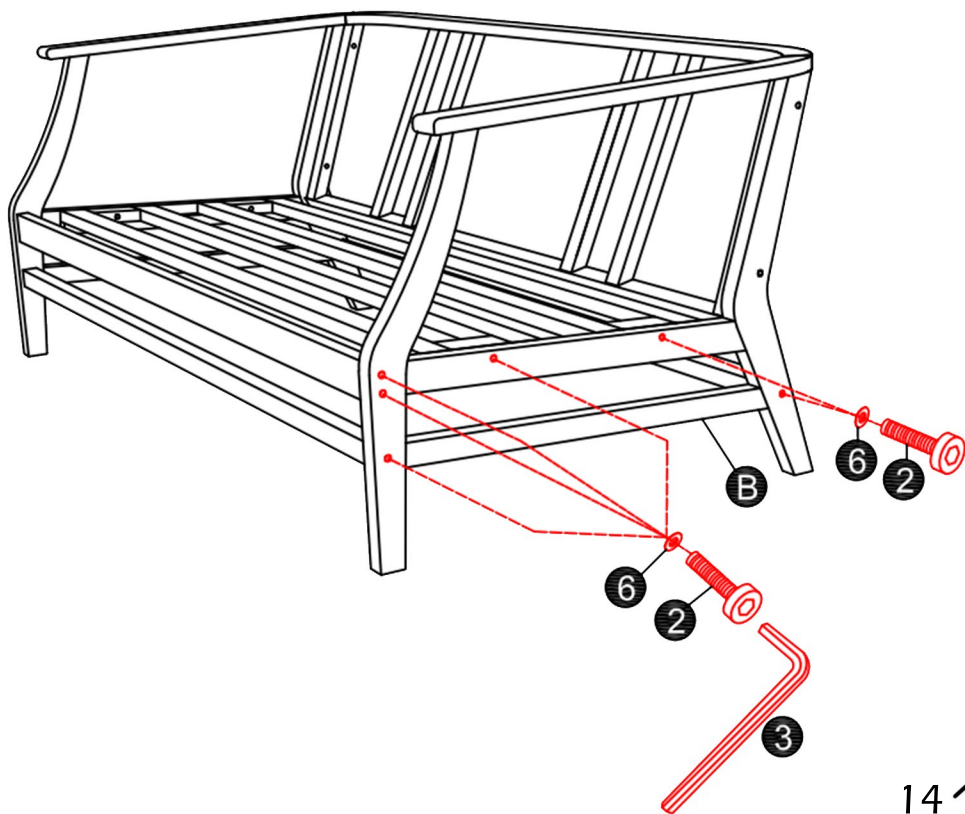

step 8 ---Install the Left Armrest (B)

Connect the Left Armrest (B) to Backrest (C) as shown, then use the allen wrench provided (3) to tighten the bolts (1) and washer (6) .



First add one flat washer on each bolt as shown, use the allen wrench provided to tighten all the bolts by 30-50% first, make sure that all bolts are aligned correctly before fully tightening.

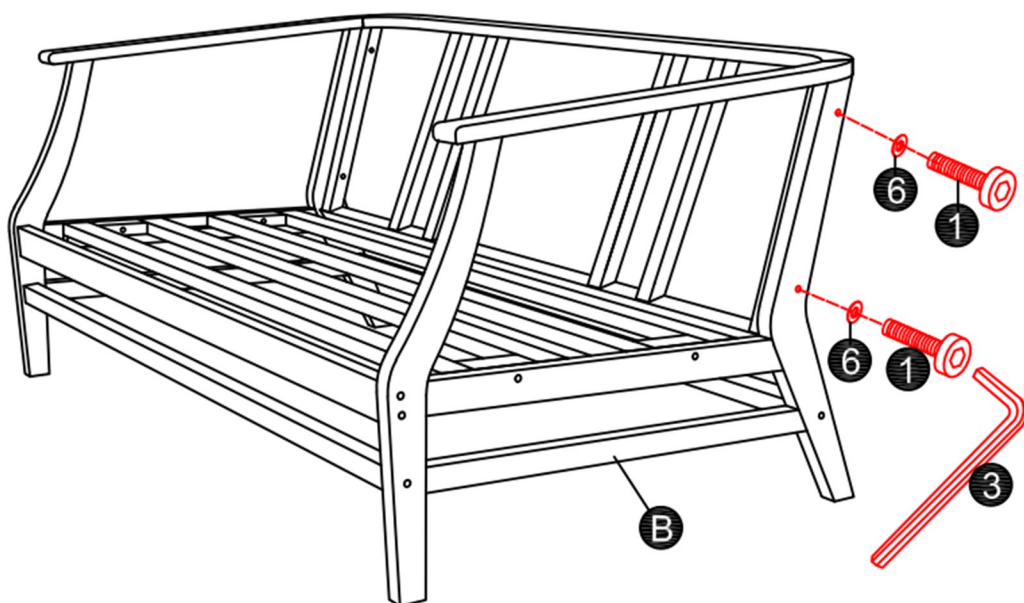

step 9 ---Install the Plastic Caps (5)

Cover all the bolt holes on both legs with the Plastic Caps (5) as shown.

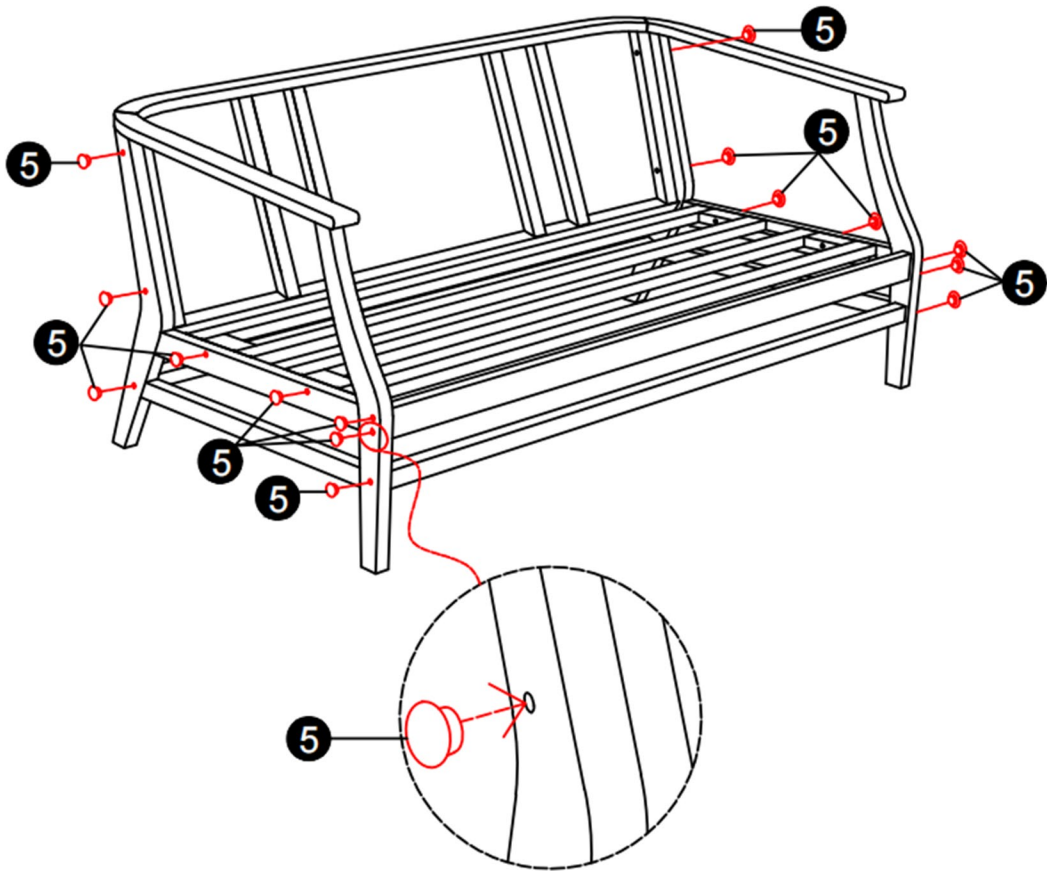

step 10 ---Place the Back Cushion (M) and Seat Cushion (L)

Place the Back Cushion (M) and Seat Cushion (L) on the chair.
Turn the Back cushion & Seat cushion with the labeled side
facing up.

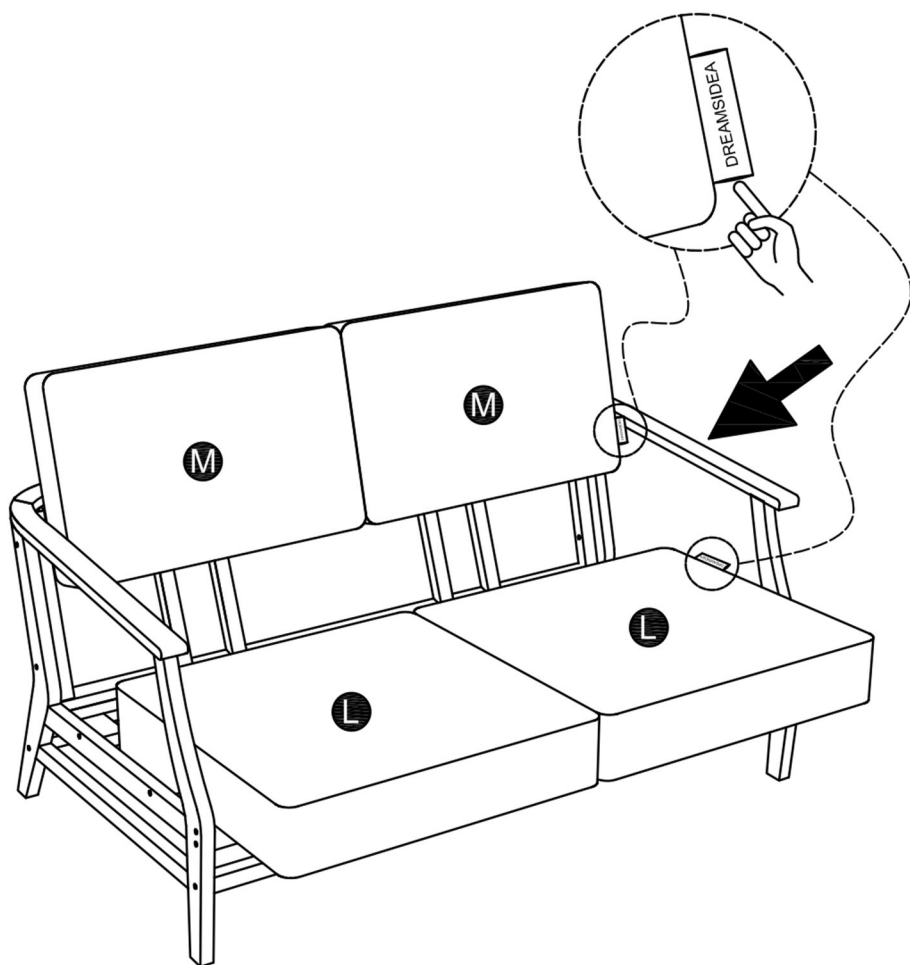

step 1 1

Congratulations! You have finished the assembly, thank you again for choosing our product! Please enjoy!

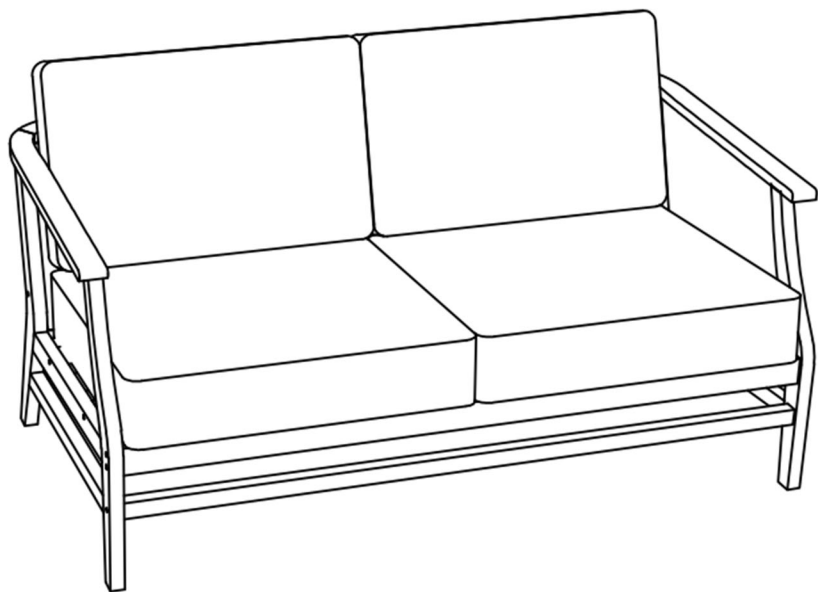



ASSEMBLY INSTRUCTIONS

Tel.(562)-781-3327

Please contact us:info@firstopintl.com

<https://www.dreamsidea.com>