

# **INSTRUCTION MANUAL**

## **MODEL:B1230-2GSM-X**

Edition:20250613489Z

Congratulations, you now have a new function sofa with massage.

Before enjoy the comfort chair,you have to put it together.This Assembly Guide will take you through the basic assembly process.To make sure your assembly goes smoothly,please follow the assembly instructions, and especially the important safety information.

Also, while it is possible to assemble the chair on your own, having a second person to help you makes it even easier.

Before you begin, please check if there are any missing parts from the package.

# PACKAGE LIST

02

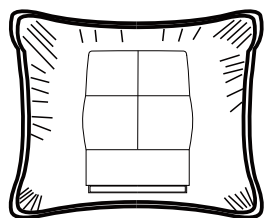

Seat cushion (A) \* 1

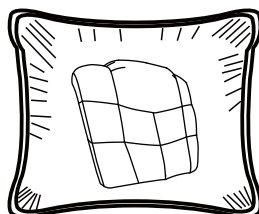

Back (B) \* 1

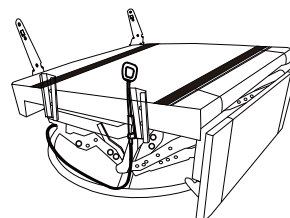

Seat frame (C) \* 1

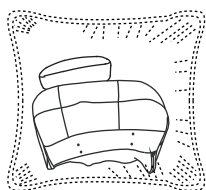

F(R)  
Armrest cover (F) \* 1

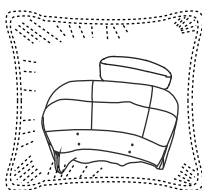

F(L)  
Armrest cover (F) \* 1

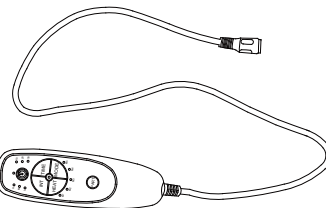

Massager remote control board (G) \* 1



Massager power supply (H) \* 1

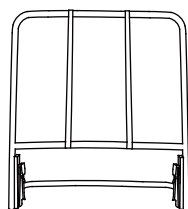

Back frame (T) \* 1

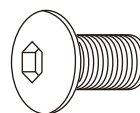

Bolts  
M6\*16mm (N) \* 8+1(extra)

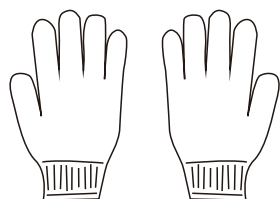

Glove (Q) \* 1



Spanner (O) \* 1

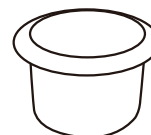

Cup holder (P) \* 2



Connector (U) \* 4

**STEP 1:** Flip the seat frame over with the footrest facing upwards, Pull the footrest with your hand, Then remove the seat cushion and the accessory box from the frame.

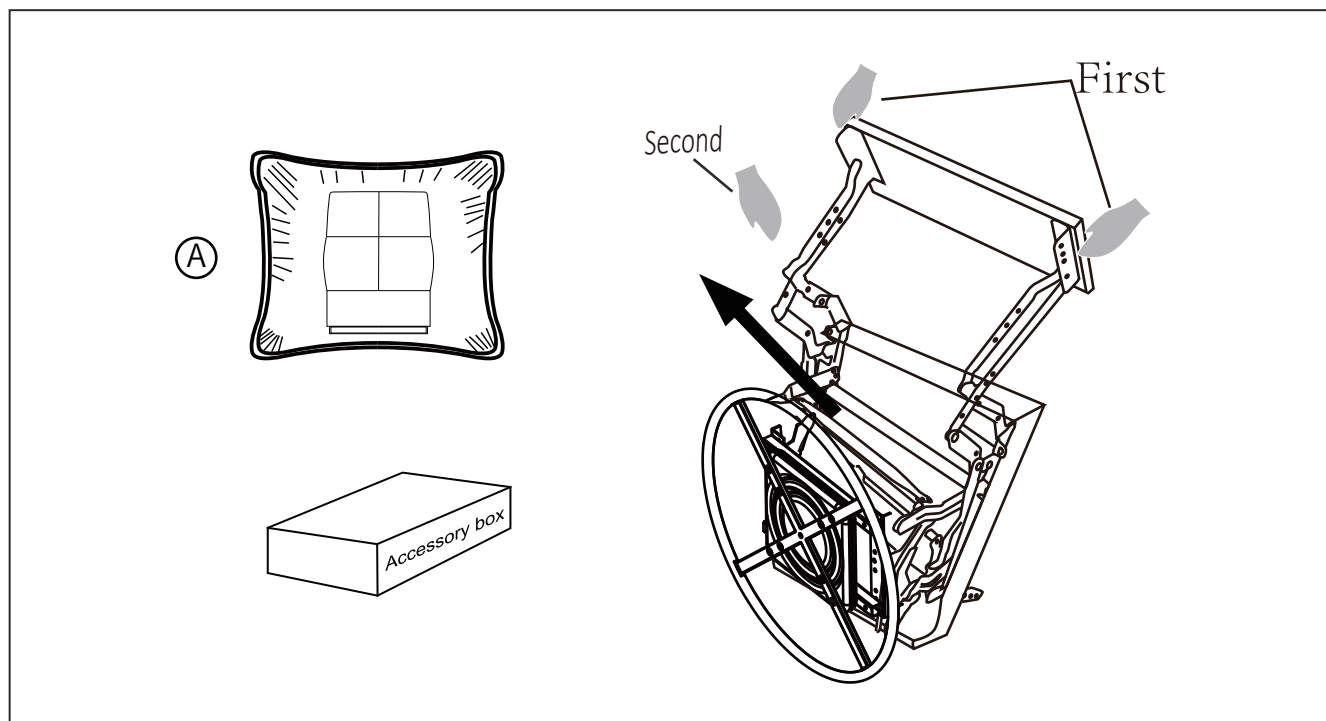

**STEP 2:** Open the compression bag and remove the back and Gently pat the back package with your hand.

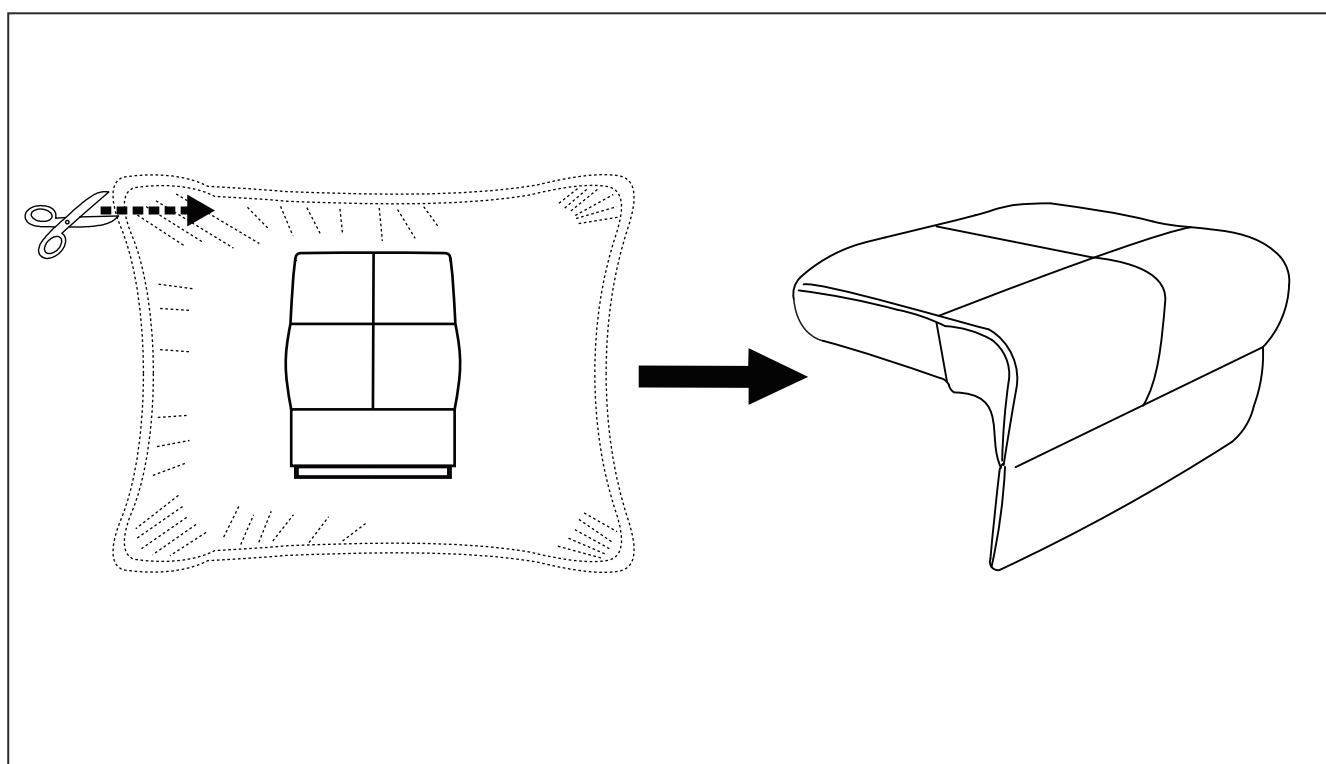

STEP 3: Open the compression bag and remove the armrest cover.

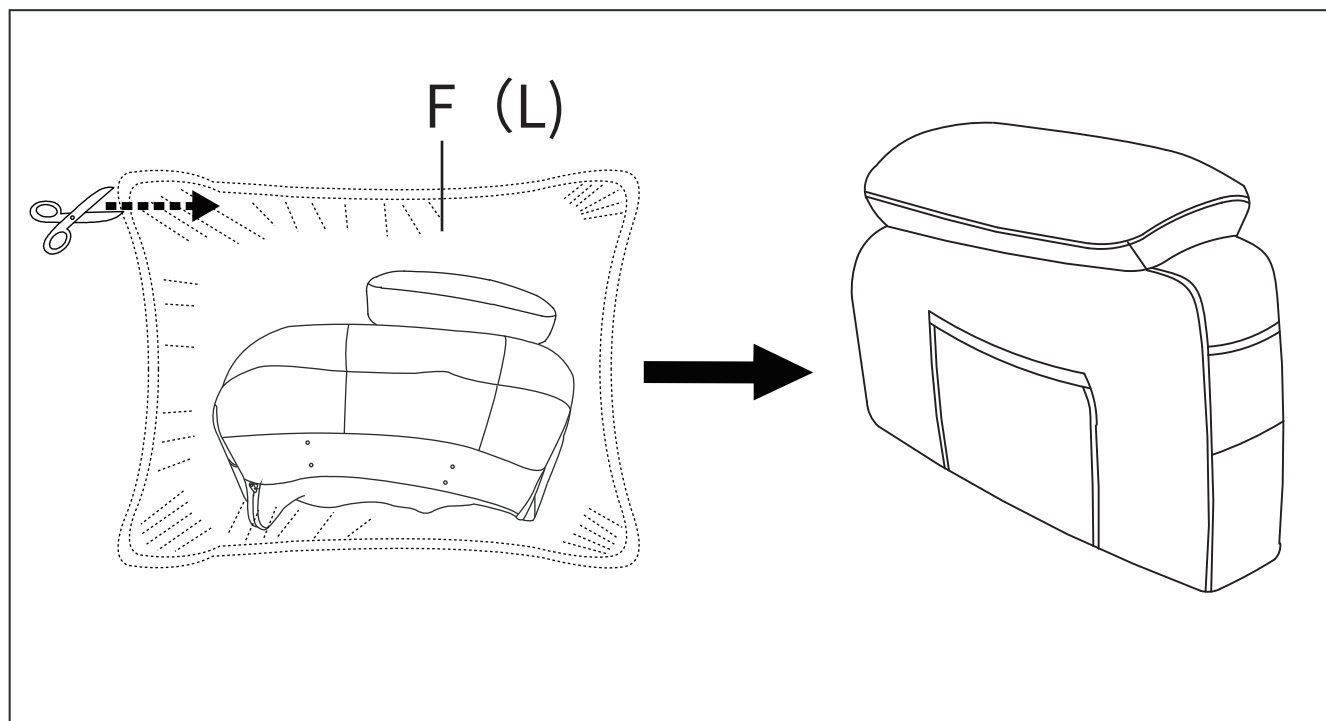

STEP 4: Open the compression bag and remove the armrest cover.

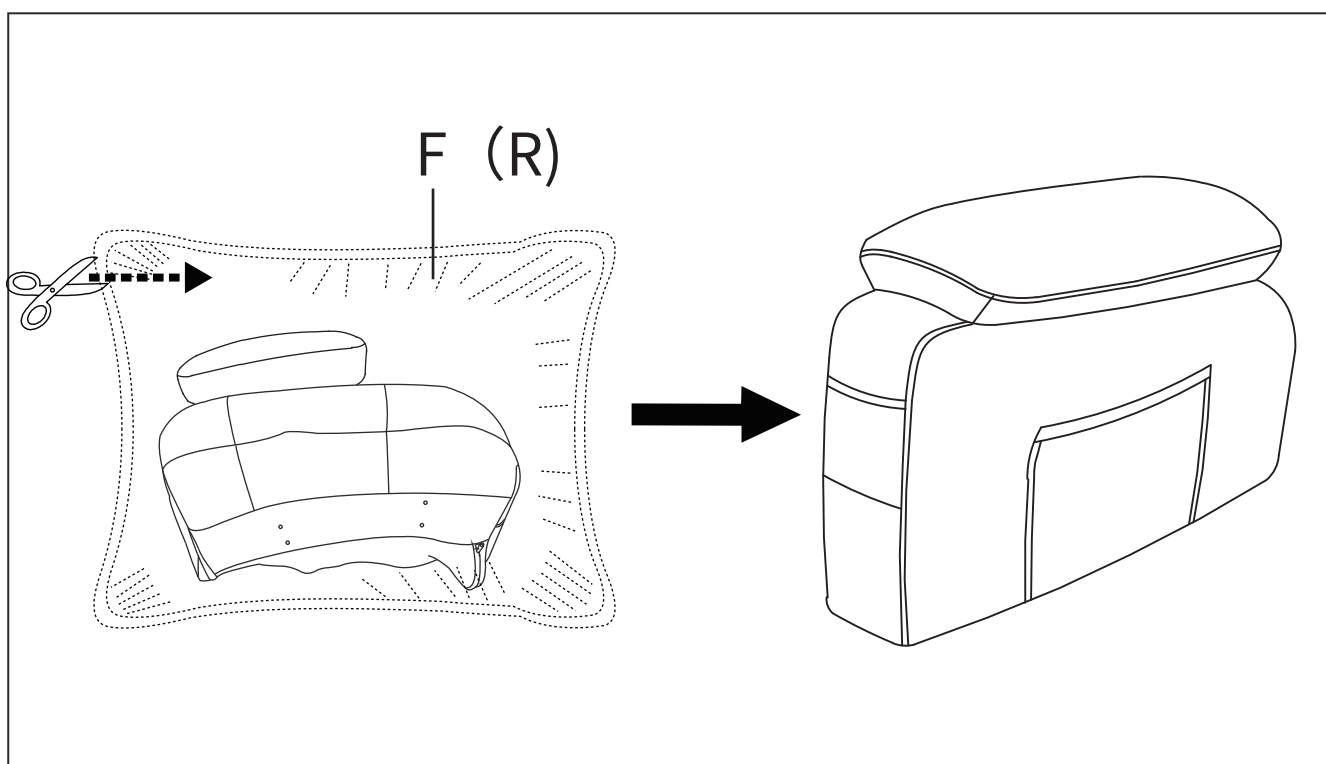

**STEP 5:** Fix the connector to the inside of the armrest with M6x16mm bolts, paying attention to the direction of fixing the connector.

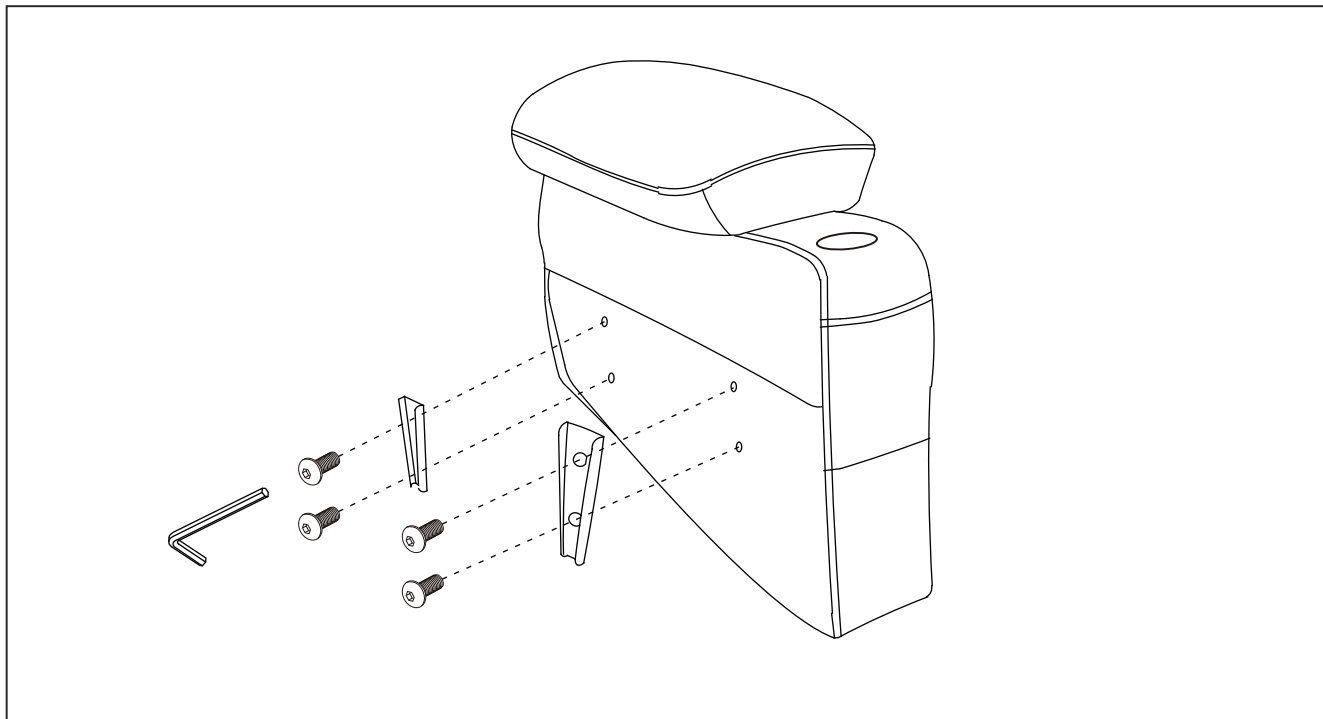

**STEP 6:** Fix the connector to the inside of the armrest with M6x16mm bolts, paying attention to the direction of fixing the connector.

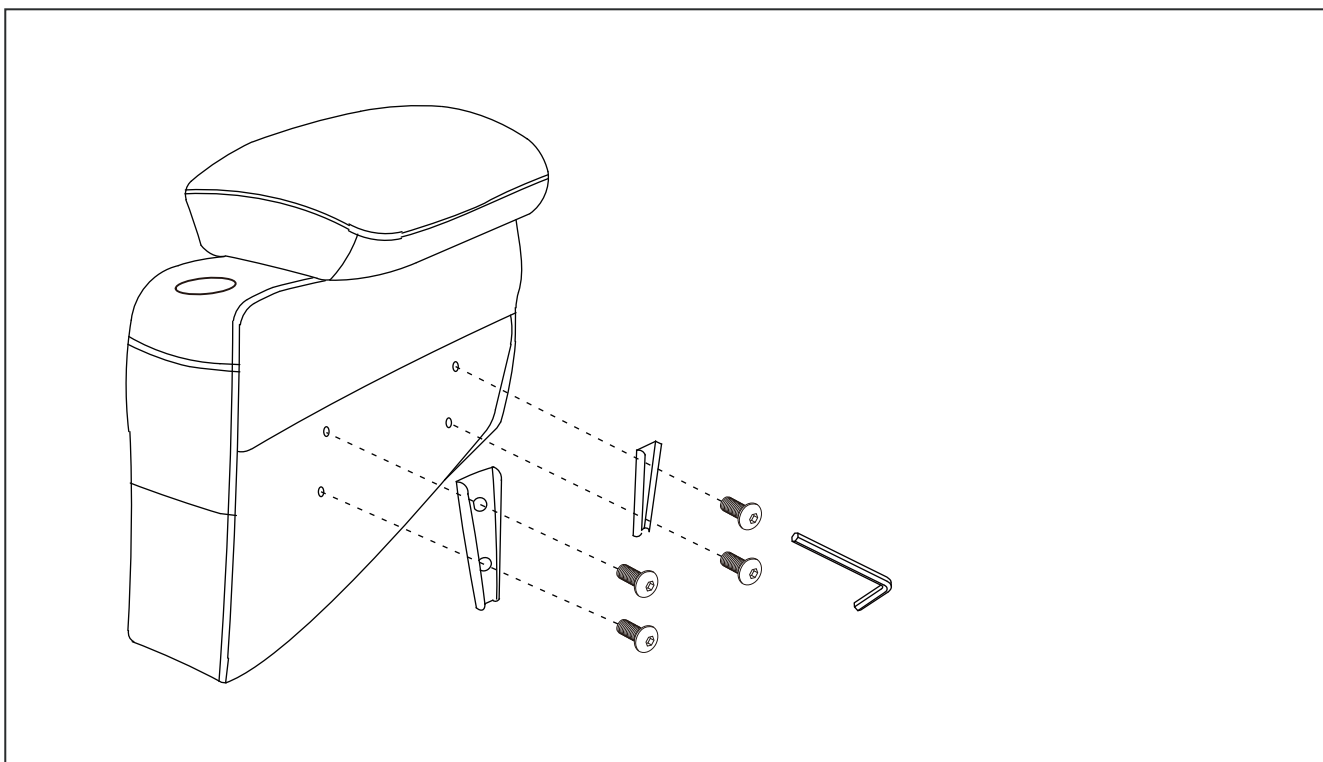

# ASSEMBLY INSTRUCTION

06

**STEP 7:**Place the cup holder into the groove.

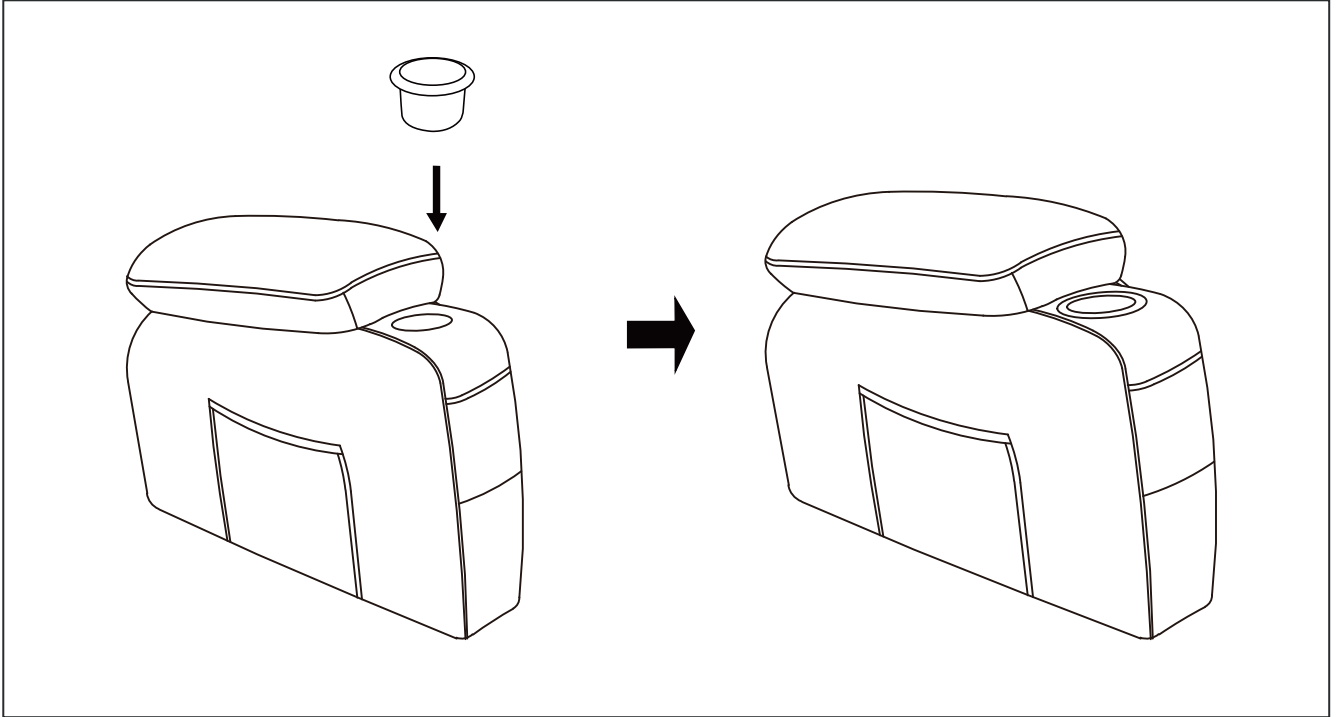

**STEP 8:**Insert arms so that they can fit into the seat, you will hear a “click” when they are engaged.

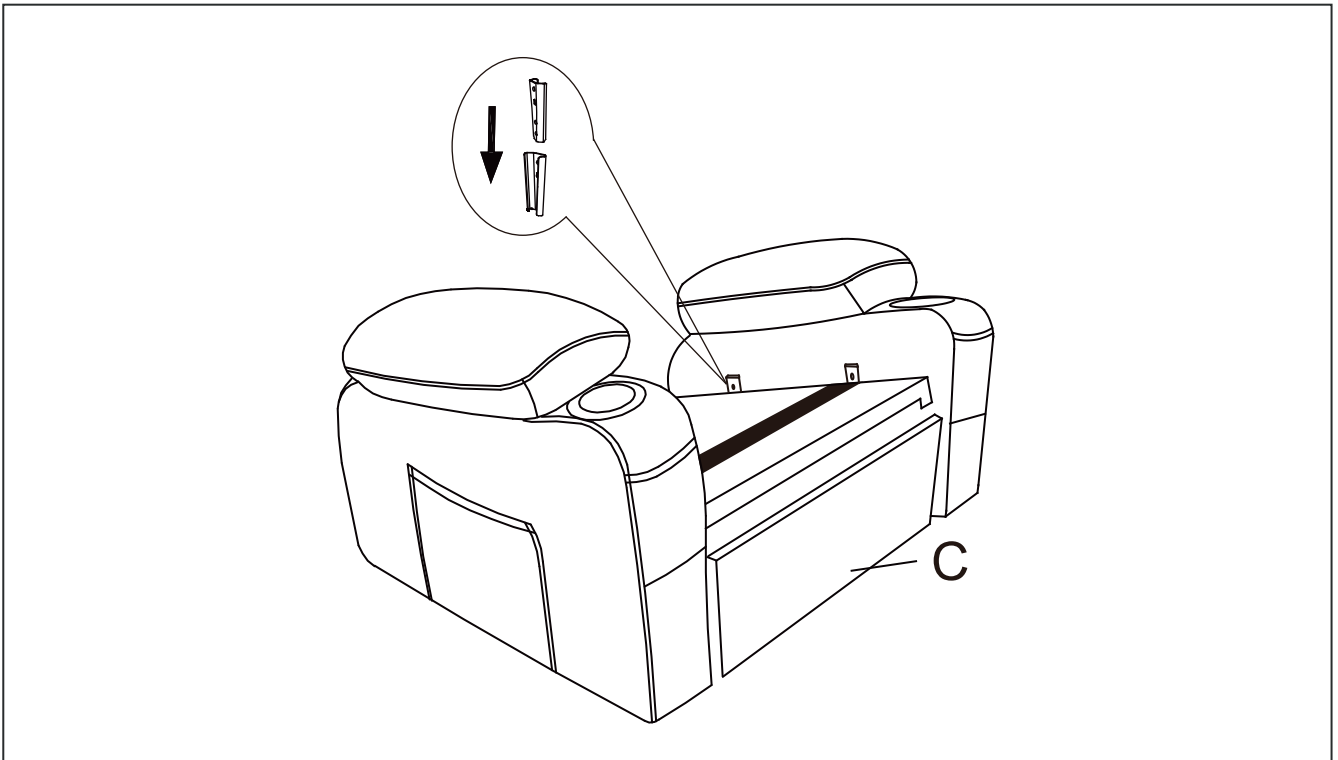

**STEP 9:** Pull the pull ring on the side of the seat and turn on the rack. Put the seat cushion to the corresponding position and stick the magic sticker to fixed seat cushion.

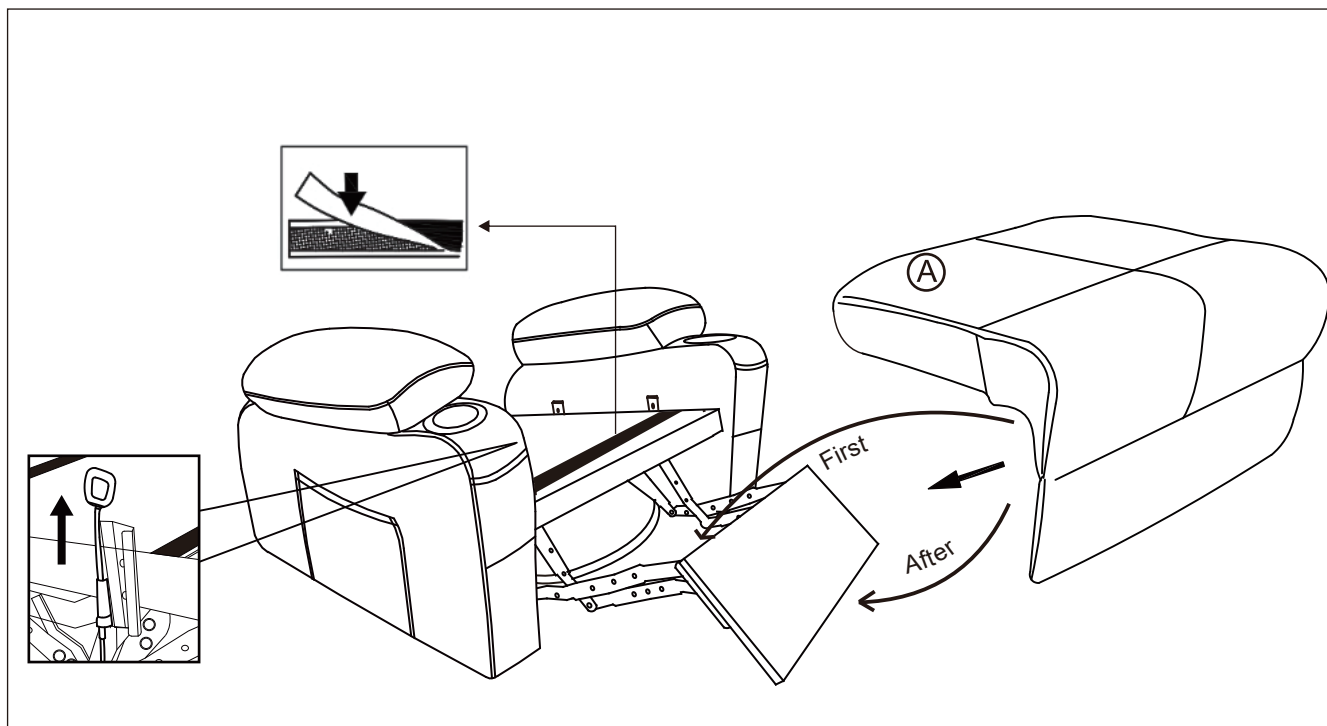

**STEP 10:** Open the compression bag and remove the soft bag and Gently pat the soft package with your hand.

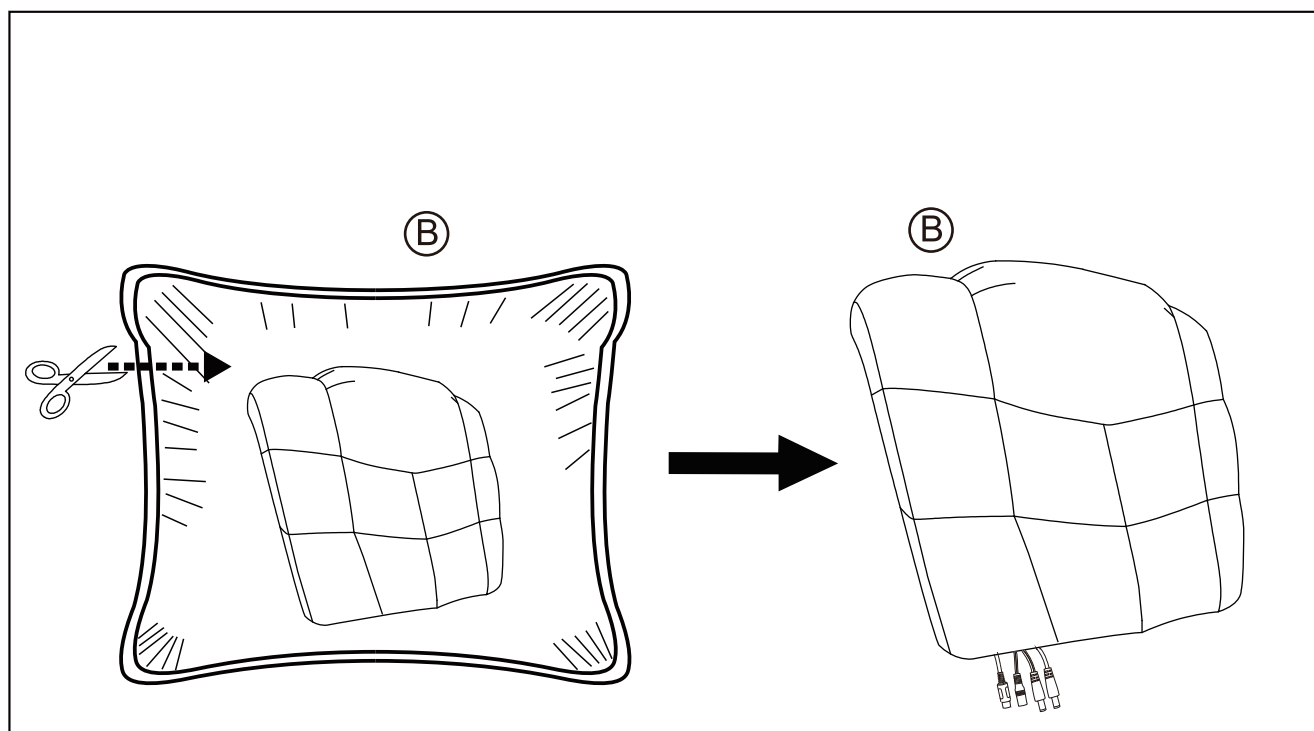



**STEP 11:** Zip the backpack and back frame, and then connect the backpack and back frame with velcro. gently pat them.

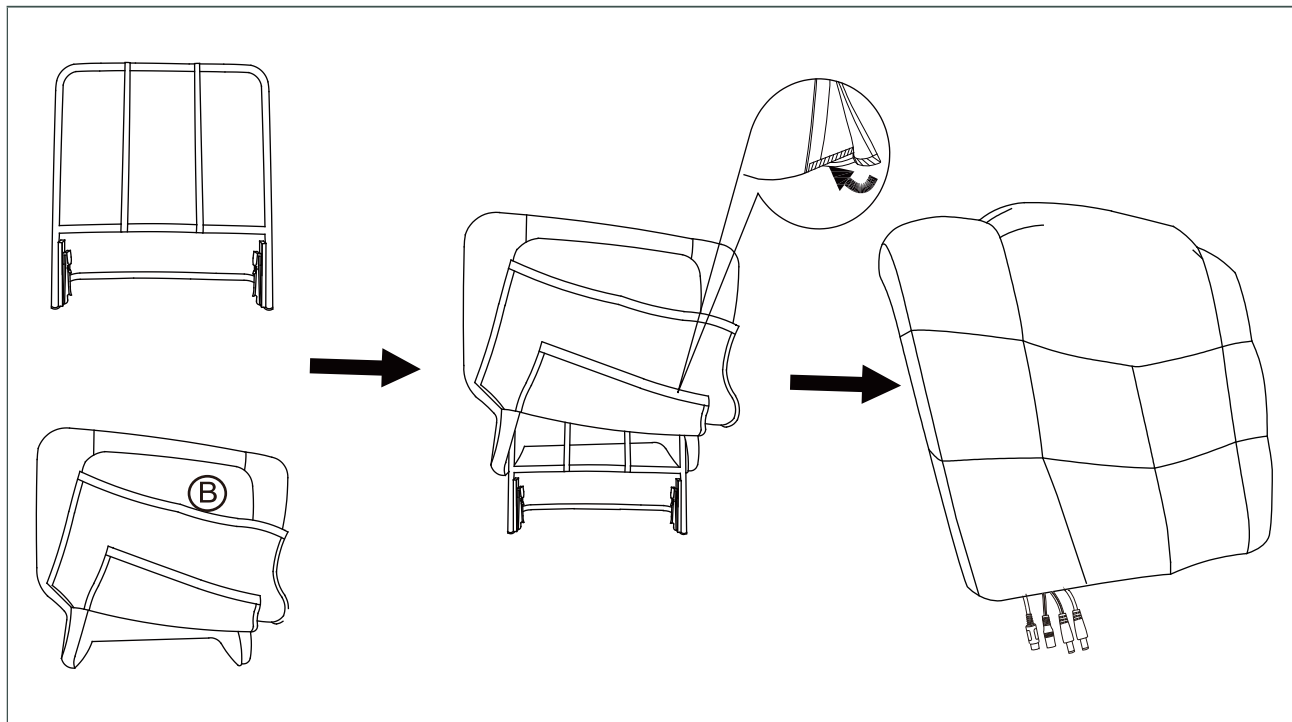

**STEP 12:** Plug the back pad into the seat frame, and then connect the massager line white and white, red and red, black and power lines, and the massage line with the hand controller.

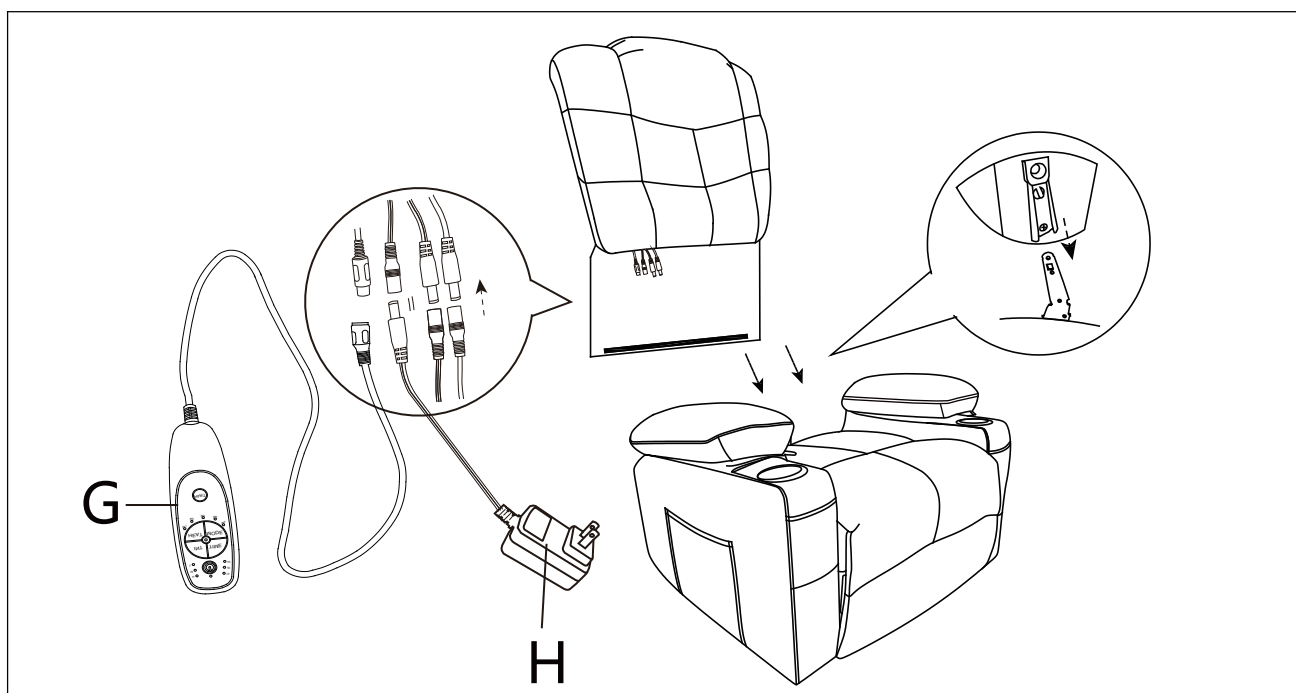

**STEP 13:** Stick the velcro from the back frame to the seat frame.

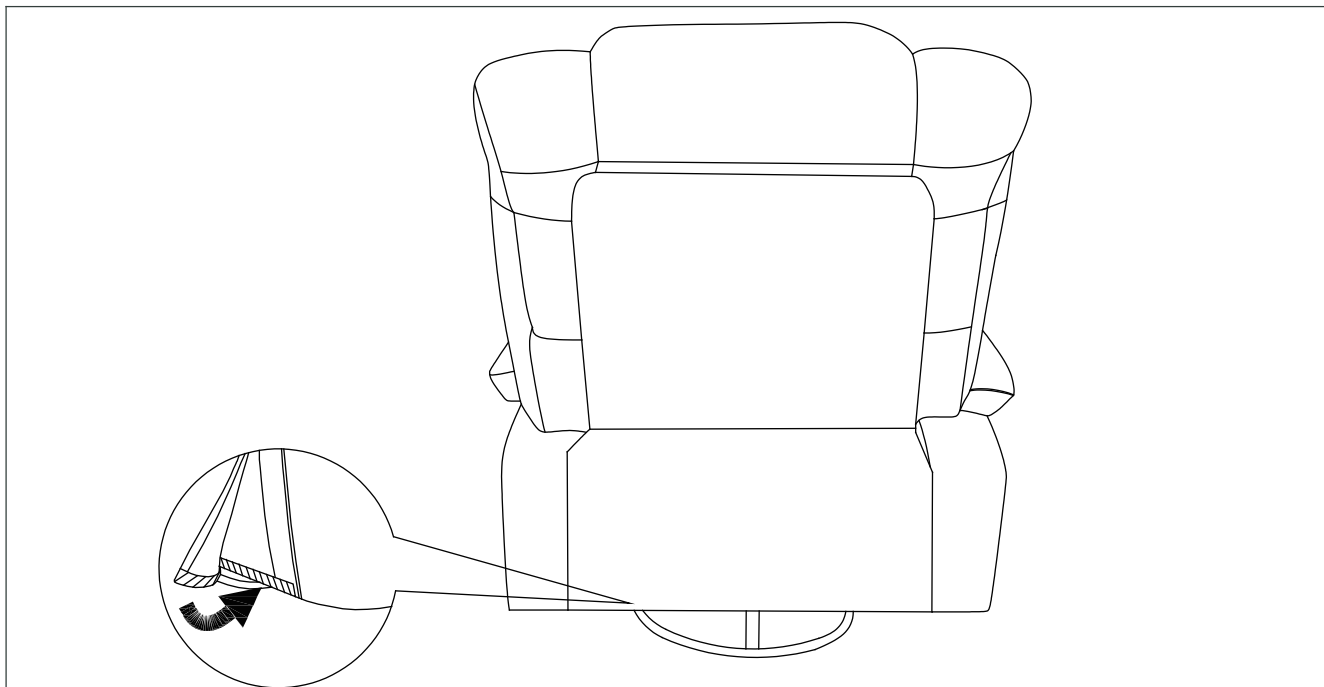

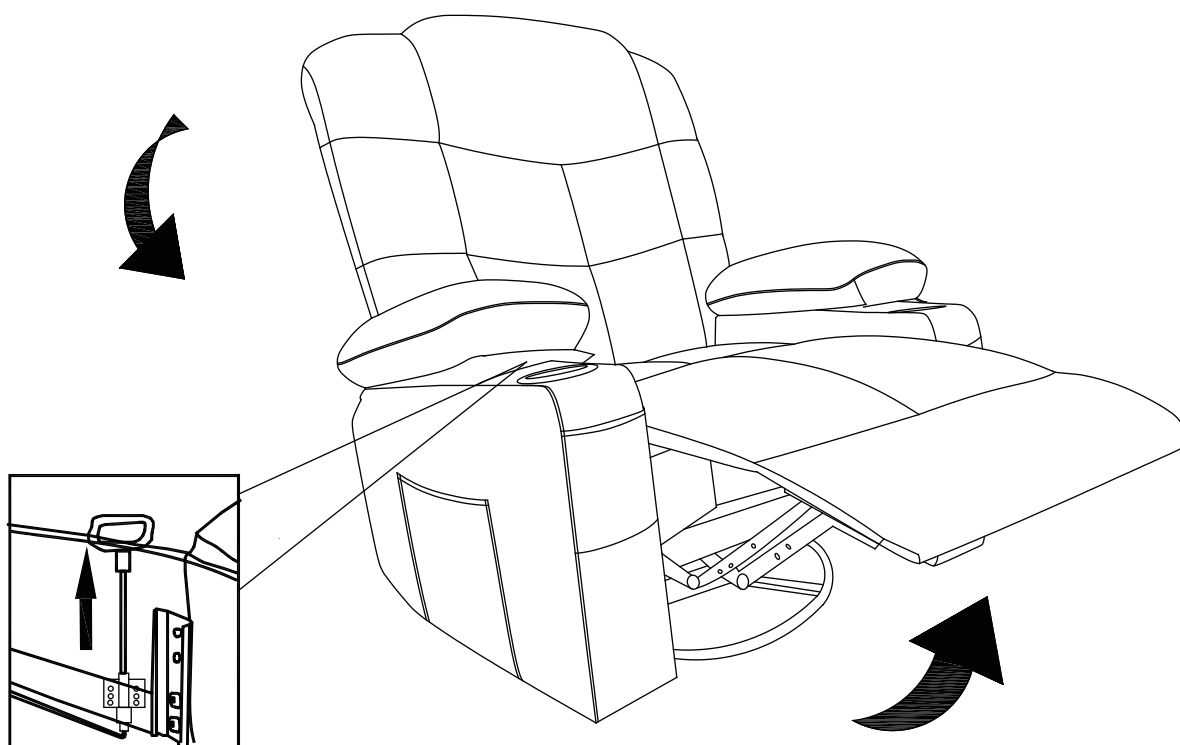

Pull the handle to spread out the SOFA

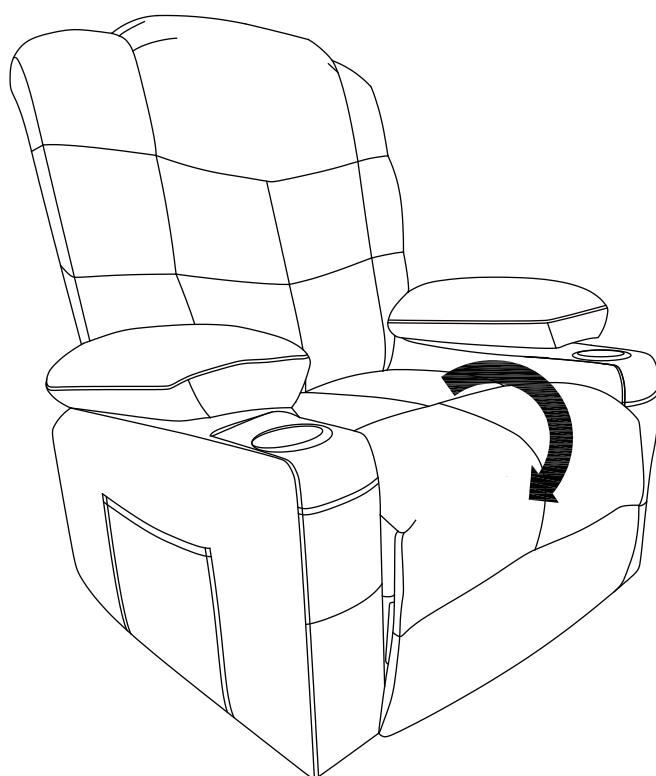

Pull back the SOFA with your legs

# *Congratulations! You've assembled* **Your Sofa!**

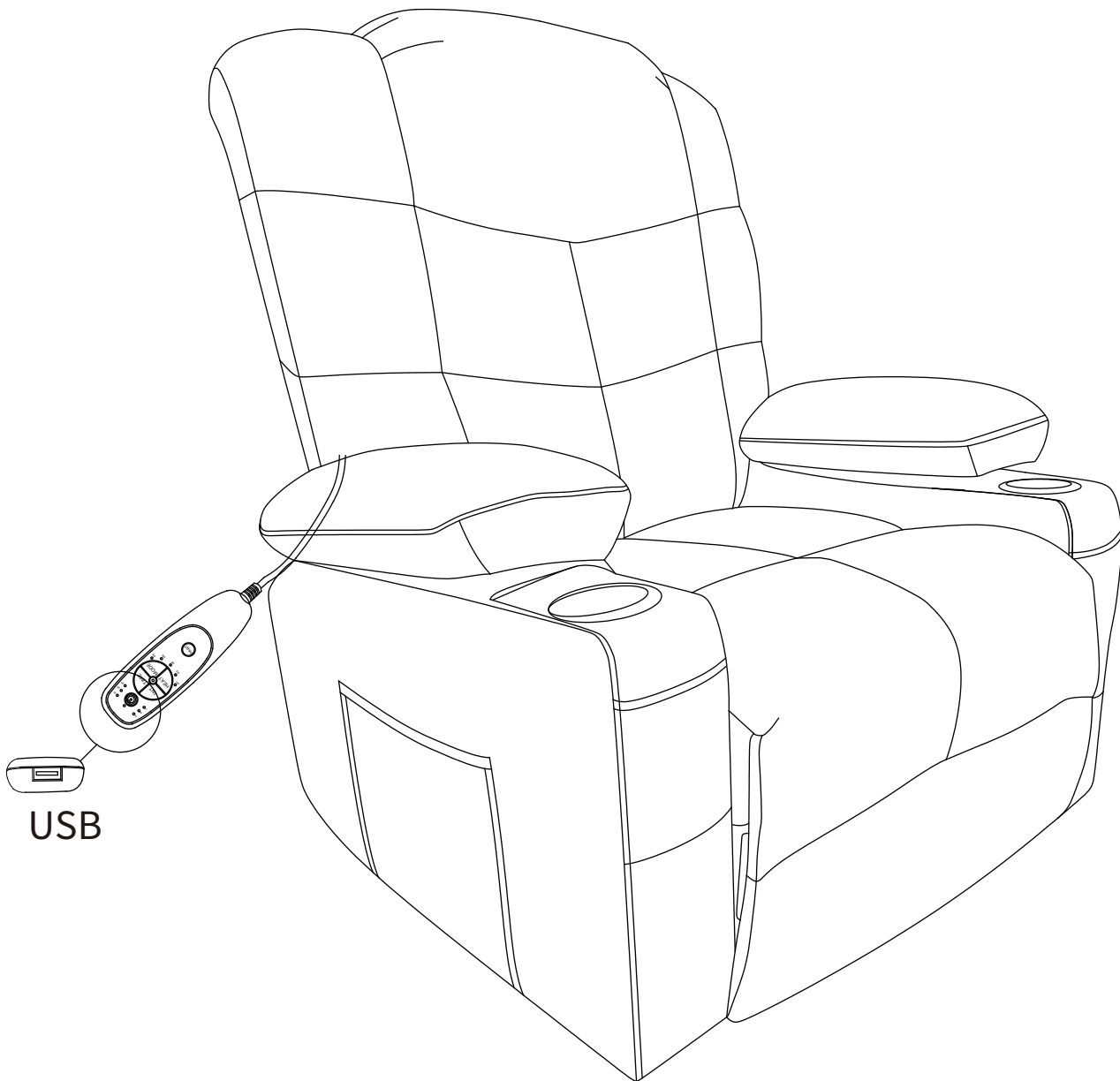

Note: Since the cushion is packed in compression, after the product is installed, you need to tap and adjust the cushion which can help restore fullness. After two days, you will get an Overstuffed Recliner as picture shows.

# MASSAGE CHAIR

READ ALL INSTRUCTIONS  
BEFORE USING THE ITEM

## REMOTE CONTROL

Function of remote

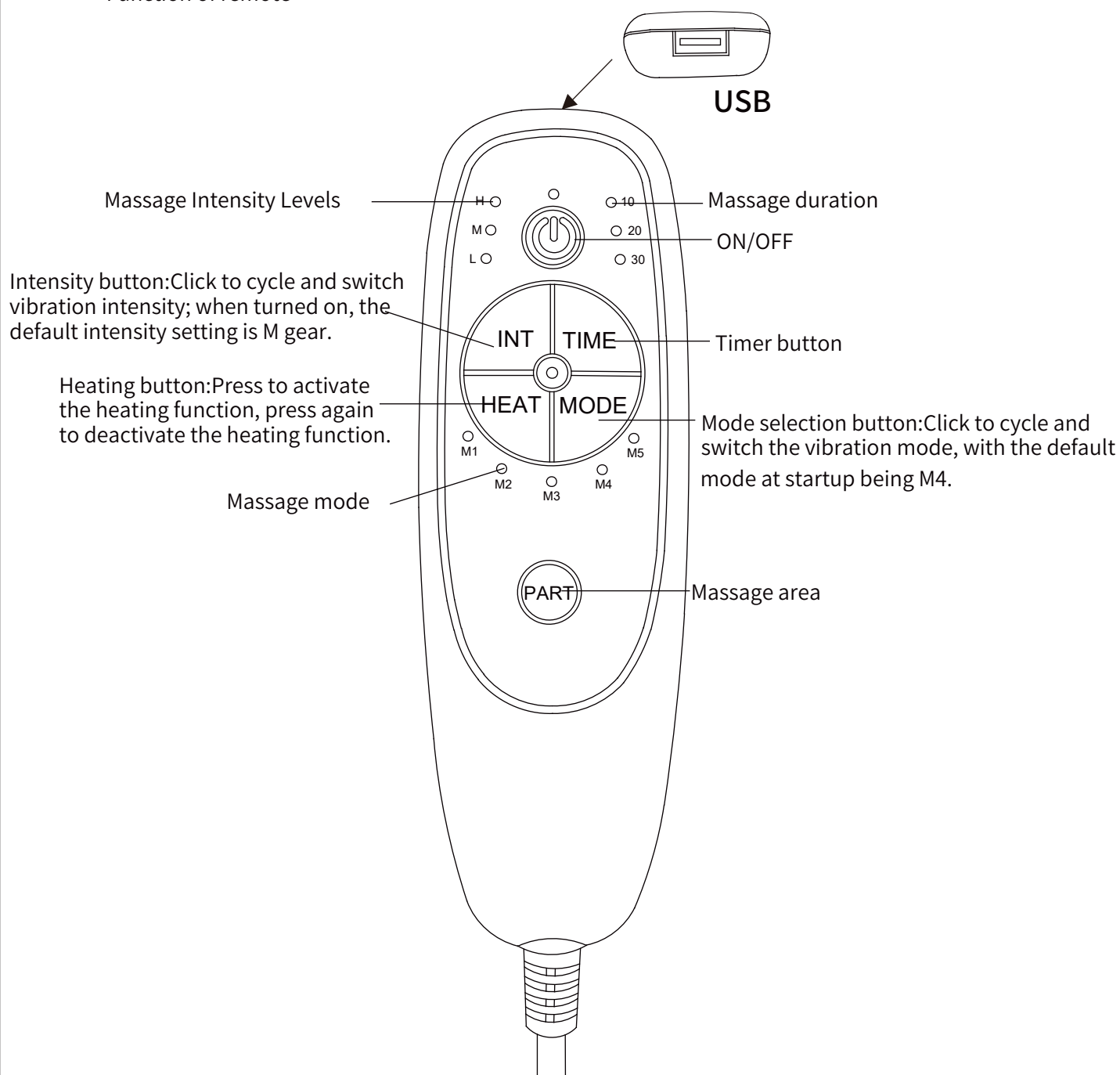

## I 、 Specifications of power adapter

The power is on in the standby state. The user can activate the function via the hand controller.

Input:AC100-240V,50Hz/60HZ;Output:DC12V1A.

## II 、 Product features

- 1、8 points massage
- 2、One-way switch for independent heating plate operation
- 3、Three-segment timing, with a default shutdown time of 10 minutes.
- 4、Three levels of vibration intensity
- 5、5 vibration modes

## III、 Function details

- 1、Switch on and off
- 2、TIME: Cycling through massage durations (10/20/30min). Default startup is 10 minutes.
- 3、MODE: Tap the five vibration modes to switch (M1/M2/M3/M4/M5).The default startup mode is M4
- 4、INT: Switch intensity by vibration strength(H/M/L). Default startup is M(medium)
- 5、HEAT: Click to toggle heating.
- 6、PART: Vibration positioning key.Default startup is full vibration; tap to switch to single-part vibration.
- 7、Massage Intensity Levels
- 8、Massage duration
- 9、Massage mode

## Warnings

1. Sit down in the chair gently. To avoid tipping over, do not throw yourself into the chair. Move the chair into the reclining position slowly, making sure that no children or pets are in close proximity. Do not allow children to play on or around the chair, particularly when it is in an open position.
2. Close the recliner completely before getting out of it.
3. Never sit on the footrest when it is open, even if it is a child.
4. To eliminate the risk of tipping over, do not sit on the arms or footrest of the chair.
5. This chair is designed to be used by 1 adult at a time.
6. Please forbid people with the following ailments from using this sofa: Those people with severe symptoms of heart disease, high blood pressure, cerebral thrombosis and others who are sensitive to heat or completely insensitive to heat, those with brittle bones or have issues with waist support pregnant women, children and others where it has been determined they are not suitable to use this product under the guidance of doctors.
7. To fully recline the sofa, ensure the sofa well, you need to put the sofa at least 19 inches away from the wall or any other obstacle.
8. Product cannot touch water, fire, etc. Product can also not come in contact with sharp objects (knives, nails, etc.)

## Maintenance Manual Instructions

1. To avoid dropping, you should carry the sofa carefully.
2. If you find dirt and or stains on the chair, spray the sofa with a sofa specific cleaner then use a sponge or cloth to wipe the dirt away. Do not use water, soapy water or cleaner with waxed wooden areas. Take care to wipe the sofa carefully and gently.
3. Do not put the sofa in an area with direct sunlight and do not put the sofa directly in front of an air conditioner, this will fade the upholstery and make it brittle.

## How to Disassemble

Please find a strong tool to prod the small piece of metal grooves, then the backrest will be pulled out. The tool is not included.

