

## ASSEMBLY INSTRUCTIONS



### CAUTION

- ◆ Inspect the wire insulation for any cuts, abrasions, or exposed copper that may have resulted during shipping. If there is a defect in the wire, do not attempt installation.
- ◆ Before starting installation of this fixture or removal of a previous fixture, disconnect the power by turning off the circuit breaker or by removing the fuse at the fuse box.

## TOOLS REQUIRED



Ladder



Safety  
glasses



Phillips  
screwdriver

PARTS SHOWN MAY DIFFER SLIGHTLY PER LIGHT FIXTURE

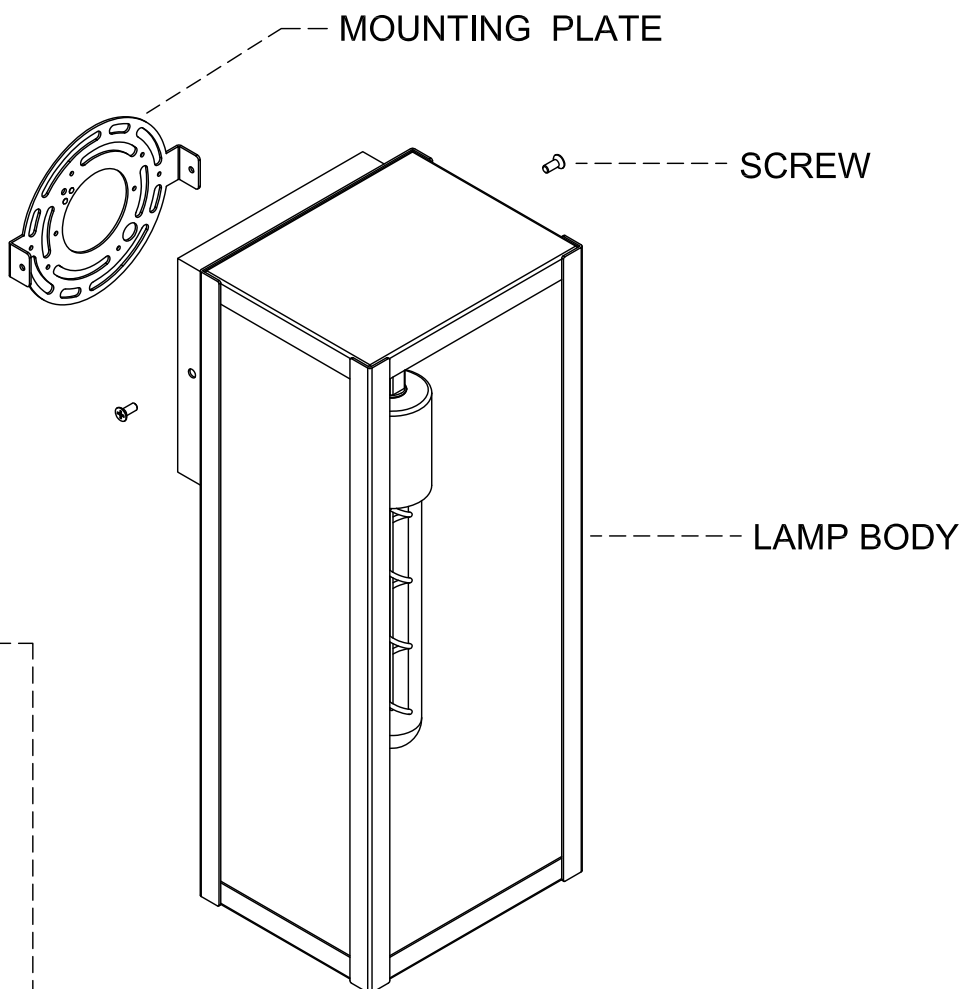

### PART BAG

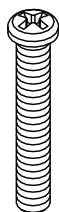

X2



X3