

INSTALLATION INSTRUCTIONS

- Prior to installation please check received items against the Packing List .If any part is missing or damaged, please do not return the product to the store and contact us;
Call: (302)336-8180
Email: vanityinservice@gmail.com
- Protect all surfaces from sharp objects , high heat sources,direct prolonged sunlight and chemical hazards .
- Professional installation is recommended !

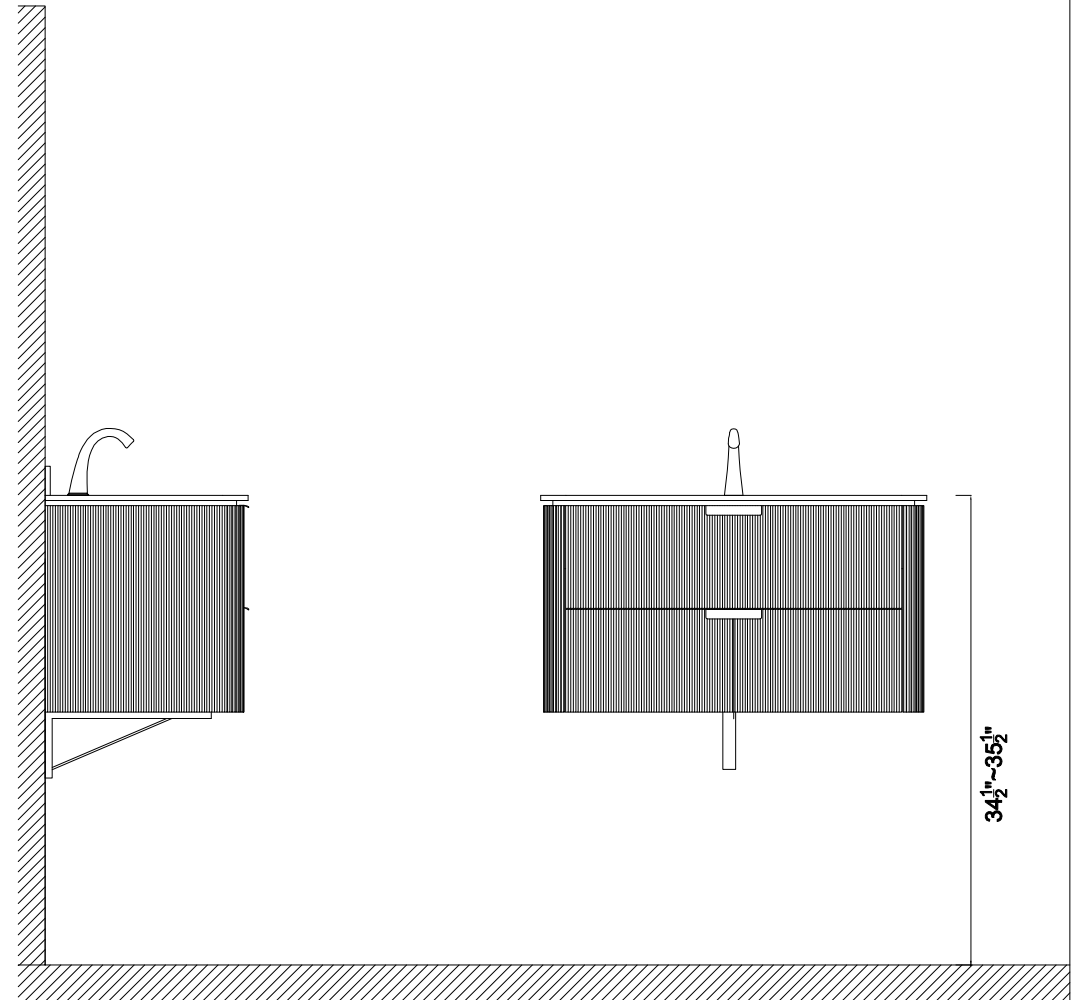

INSTALLATION INSTRUCTIONS

PACKING LIST

A Main Vanity
1 PC

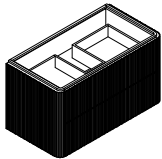

B Top
1 PC

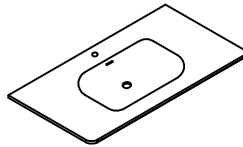

C Wood Cleat
1 PC

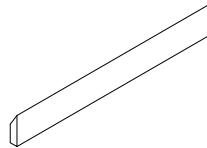

D Metal Bracket

24": 1pcs
30": 1pcs
36": 1pcs
48": 2pcs
60": 2pcs

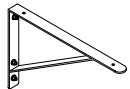

E Wood Screw

24": 5pcs
30": 5pcs
36": 5pcs
48": 8pcs
60": 8pcs

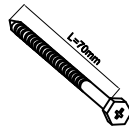

M5 x 70

F Screw

24": 3pcs
30": 3pcs
36": 3pcs
48": 6pcs
60": 6pcs

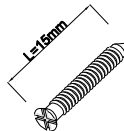

M4 x 15

G Wall Anchor

24": 5pcs
30": 5pcs
36": 5pcs
48": 8pcs
60": 8pcs



H Metal Washers

24": 5pcs
30": 5pcs
36": 5pcs
48": 8pcs
60": 8pcs



I Handle

24": 2pcs
30": 2pcs
36": 2pcs
48": 4pcs
60": 4pcs

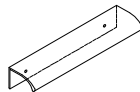

TOOLS REQUIRED

Drill Bits

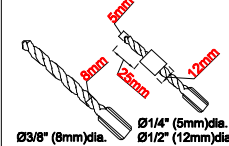

HSS

Screw Driver

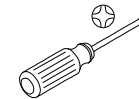

Drill

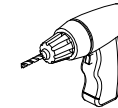

Level

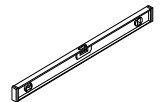

Knife

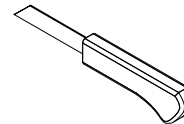

Glove



MASONRY DRILL BIT FOR TILE Ø3/8" (8mm)



Safety Glasses



Silicone

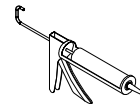

Measuring Tape



Soft Head Hammer

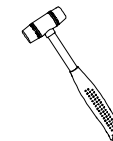

Pencil

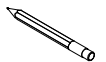

INSTALLATION INSTRUCTIONS

- STEP 1:**
- Use a wood stud finder to locate the wood studs behind the walls , and then mark by pencil.
 - Use a pencil to mark the installation location on the **Wood Cleat (B)** , according to the Wood stud's location.
 - Use a level to ensure the **Wood Cleat (B)** will be level before installing to the wall.

NOTE

Make sure the screw holes must be on the wood studs otherwise the vanity will fall out because the dry wall cannot hold the cabinet.

vanity	hole	a	b	c
24"	3	8"	8"	-
30"	3	12"	12"	-
36"	3	12"	12"	-
48"	4	12"	12"	12"
60"	4	12"	24"	12"

NOTE: The a/b/c value is for reference only , please according to the Wood stud's location.

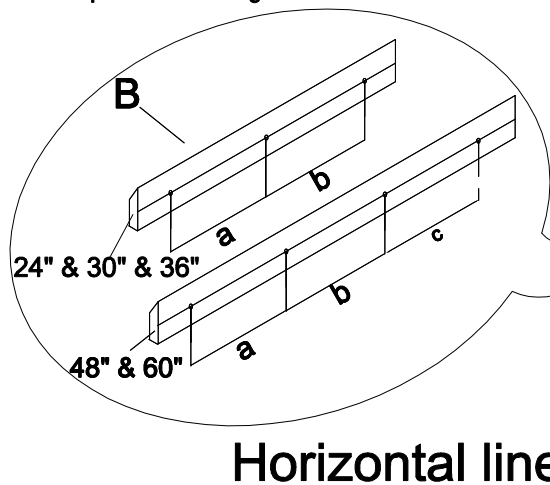

Wood stud

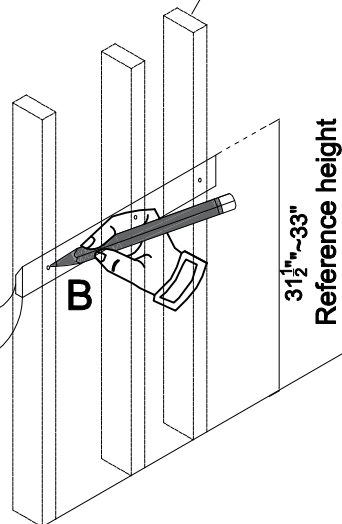

- STEP 2:** Drill the holes according to the marks using a drill.

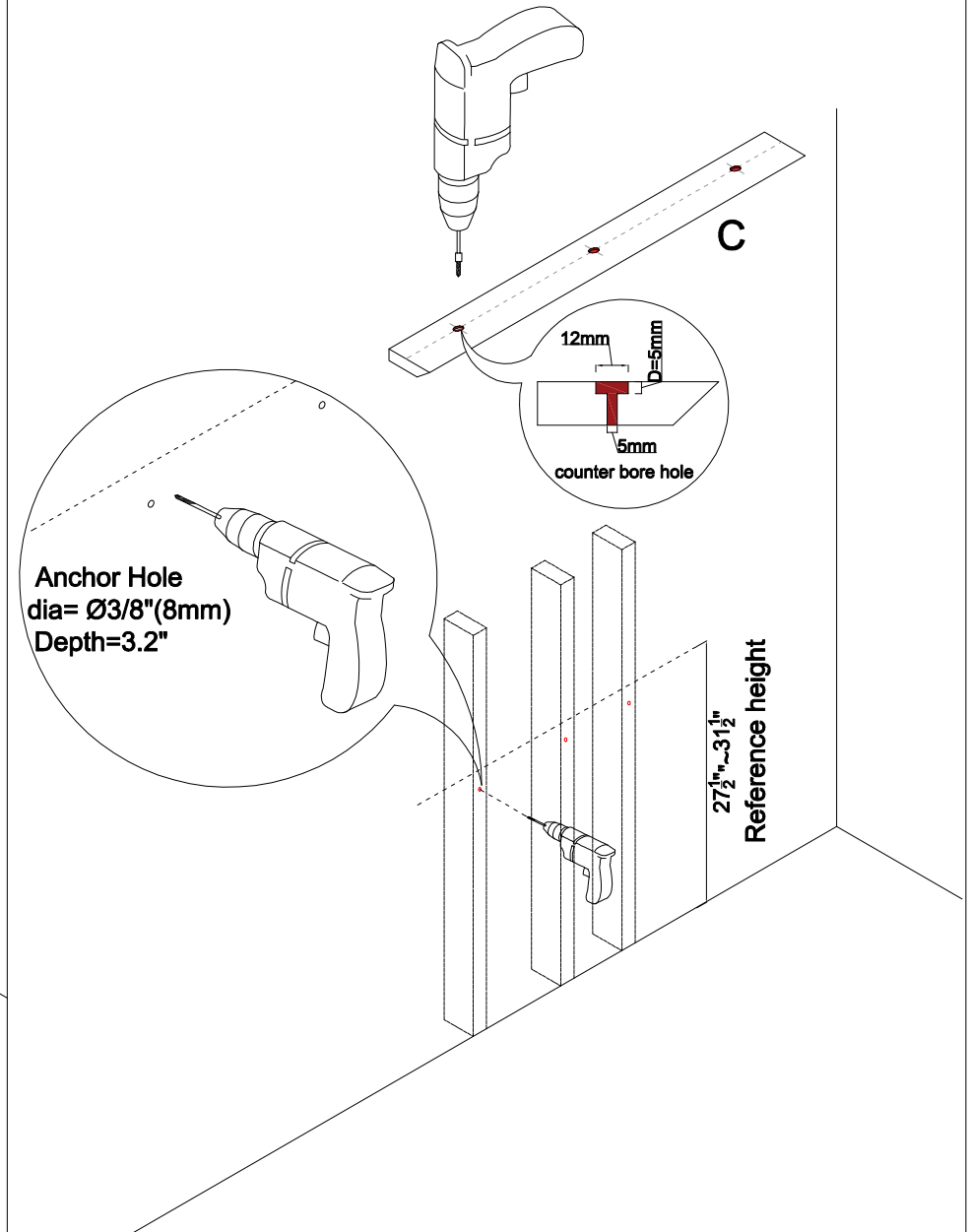

INSTALLATION INSTRUCTIONS

STEP 3: Install the **Wall Anchors (E)** provided into the wall with hammer.

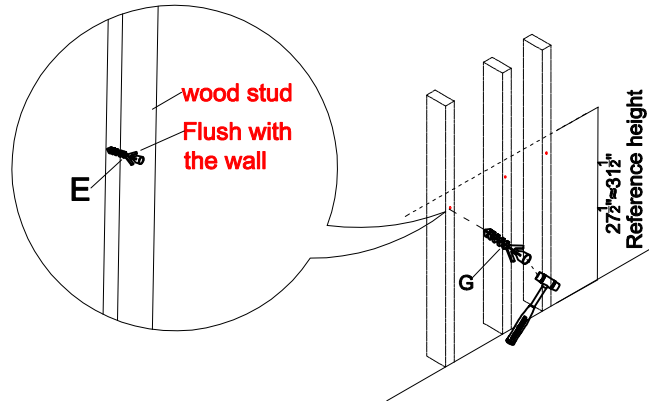

STEP 4: Install the **Wood cleat (B)** to the wood studs by screw driver.

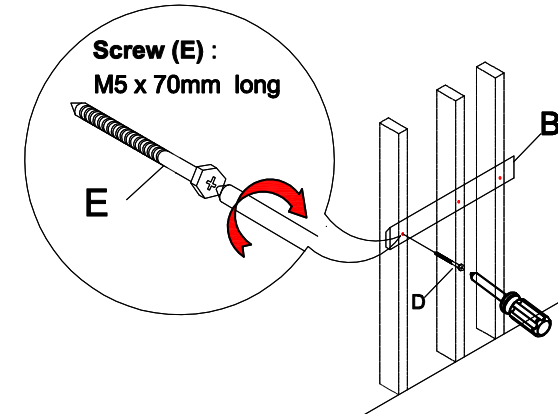

STEP 5: With help from another person, carefully hang the **Vanity (A)** onto the **Wood Cleat (C)**.

NOTE When installing the **Wood Cleat (B)** make sure the angle cut is facing the wall.

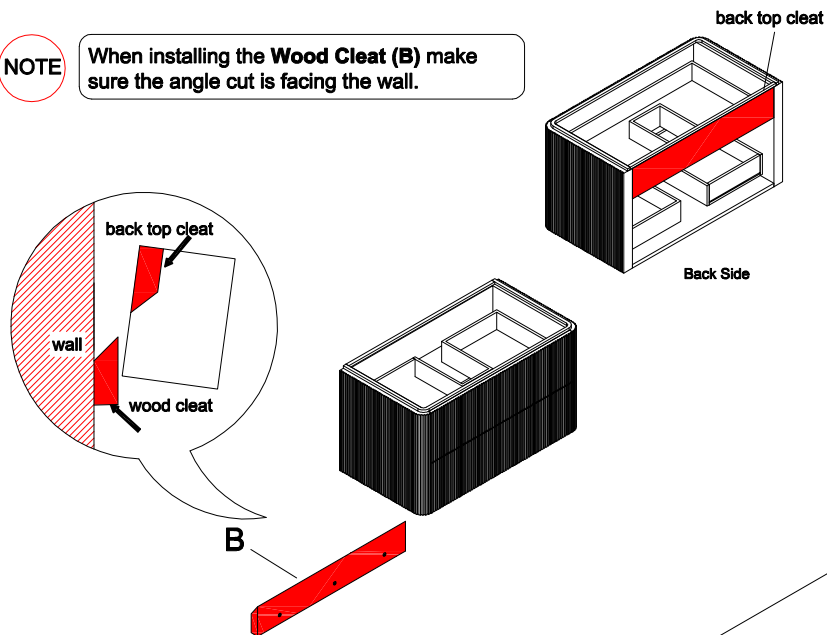

STEP 6: Using a pencil to mark the installation location for the **Metal Brackets (D)**.

NOTE Make sure the **Metal Brackets (D)** are installed on the wood studs.

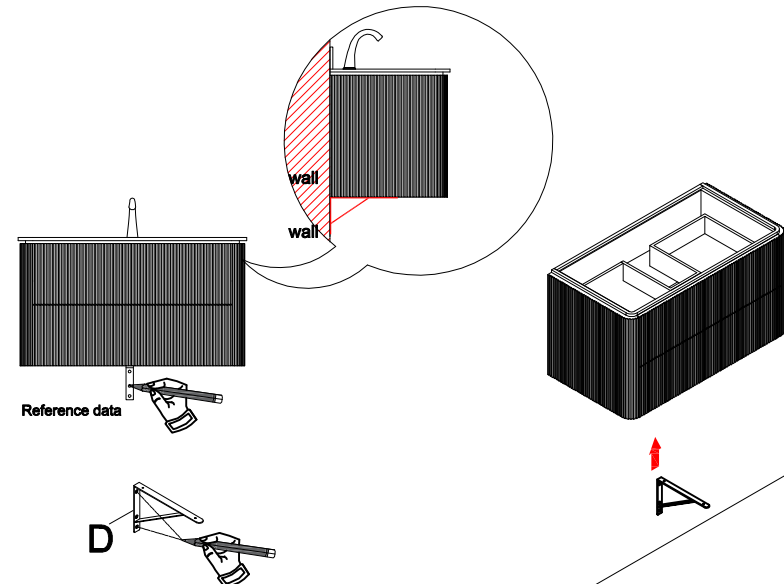

INSTALLATION INSTRUCTIONS

STEP 7: Carefully remove the **Vanity (A)** with the help from another person, and then drill the anchor holes according to the marks using a drill.

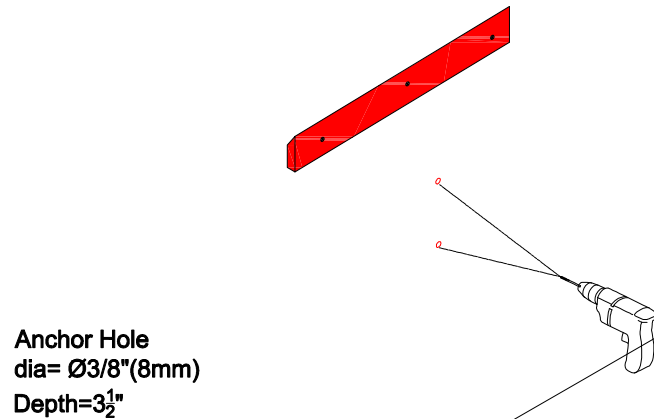

STEP 8: Install the **Wall Anchors (G)** provided into the wall with hammer.

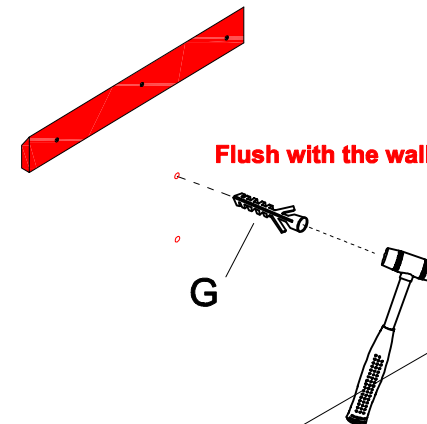

STEP 9: Install the **Metal Bracket (C)** to the wood studs by screw driver.

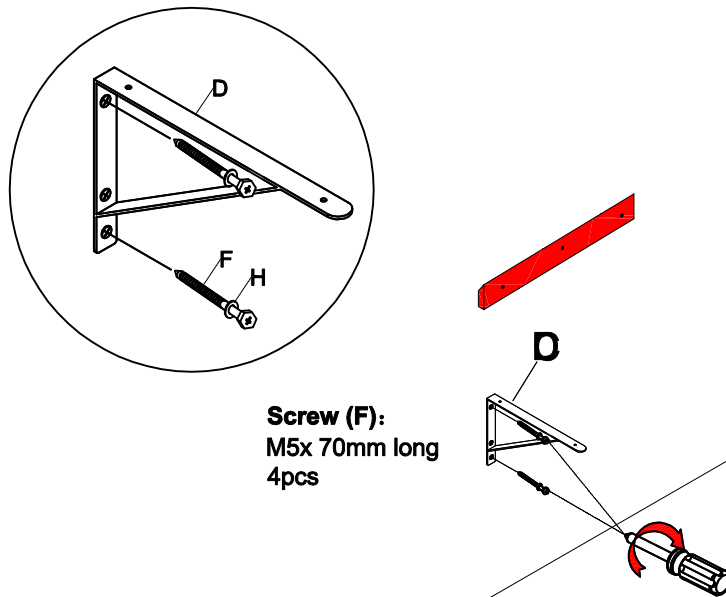

STEP 10: Hang the **Vanity (A)** to the wall and then connect the **Vanity (A)** to the **Wood Cleat (C)**.

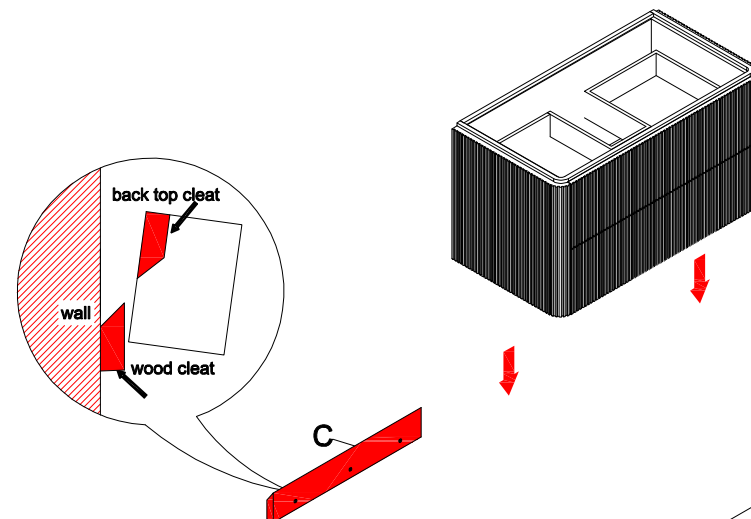

INSTALLATION INSTRUCTIONS

STEP 11: Connect the **Metal Bracket (C)** to the **Vanity (A)** with **Screws (E)**.

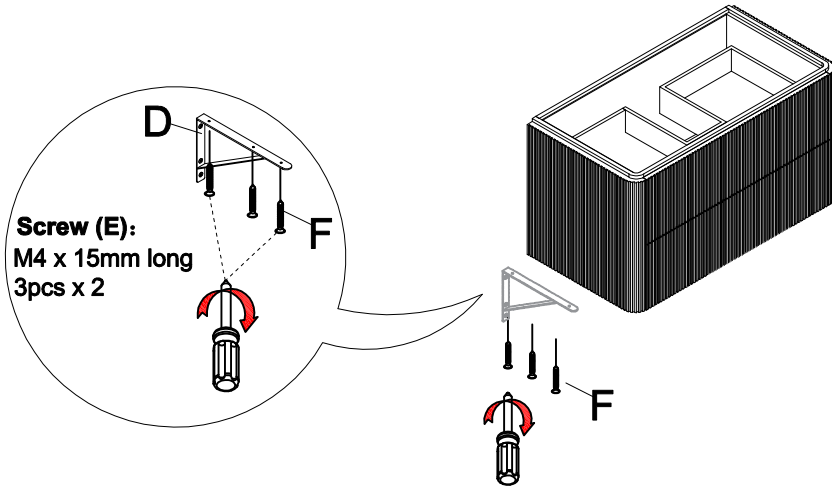

STEP 12: Using a Screw(F) to mark the installation location for the **Handle (I)** in the middle .

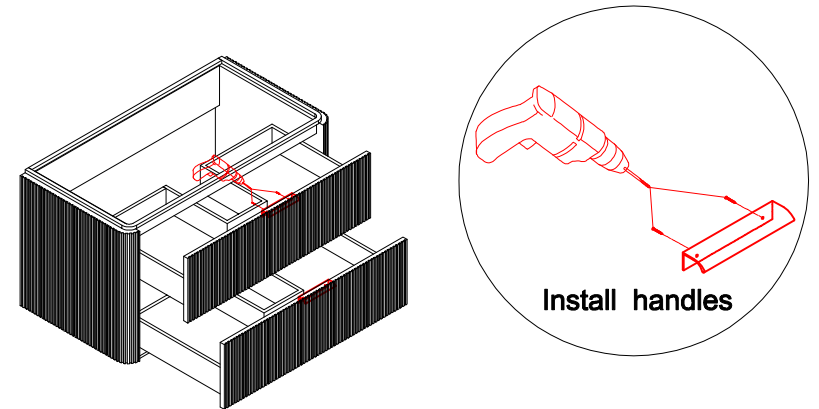

STEP 13:

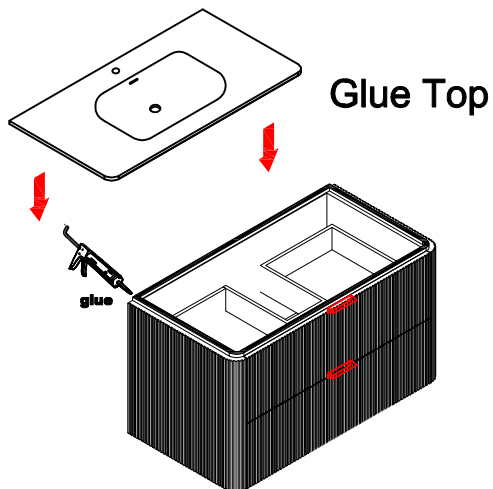

STEP 14:

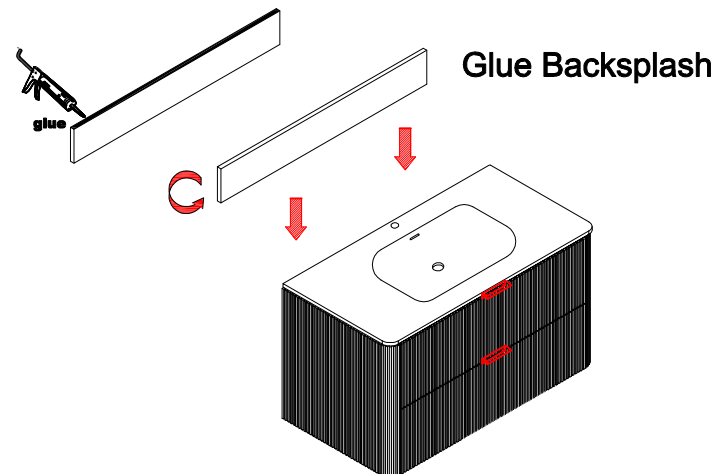

STEP 15:

