

## Two-Piece Toilet

### **INSTALLATION INSTRUCTIONS**



**PRIOR TO INSTALLATION:**

- Inspect toilet to ensure no damages have occurred while in shipping.
- Observe all plumbing and building codes in accordance with your state and local requirements.
- All dimensions are nominal! Be sure to measure your toilet prior to installation.
- The step-by-step guidelines in the installation instructions are a general reference. Should there be any discrepancies, Carlton cannot be held liable. It is recommended to install all Carlton products by hiring a licensed professional.
- Read installation and maintenance instructions thoroughly before installing. Be sure to use proper tools and always wear proper personal safety accessories for your protection.
- Two people are recommended to handle and install this product as it is fragile.

If you have any questions or concerns please contact us:  
[info@carltonplumbing.com](mailto:info@carltonplumbing.com)

**SUGGESTED TOOLS & MATERIALS:**

Marker

Flexible  
Supply Tube

Wrench

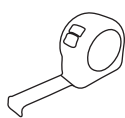
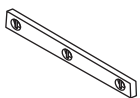
Tape  
Measure

Level

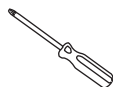

Drill

Outlet  
Gasket Seal

Screwdriver

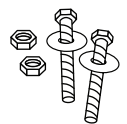
No-Hub  
Waste System**INCLUDED PARTS:**Two-Piece  
ToiletToilet  
SeatMounting  
Bolts

Cover Caps

## Recommended Fitting Type for Back-to-Back Installation

Depending on your plumbing and venting conditions, the flow from the toilet in a back-to-back installation may create a vacuum on the system and draw water from the opposing installation. The National Standards Plumbing Code prohibits the use of a cross fitting for drainage as throw over from one side to the other is possible. The Code does approve a directional "Y" style fitting with the proper venting to direct the water downward and away from the other installation.

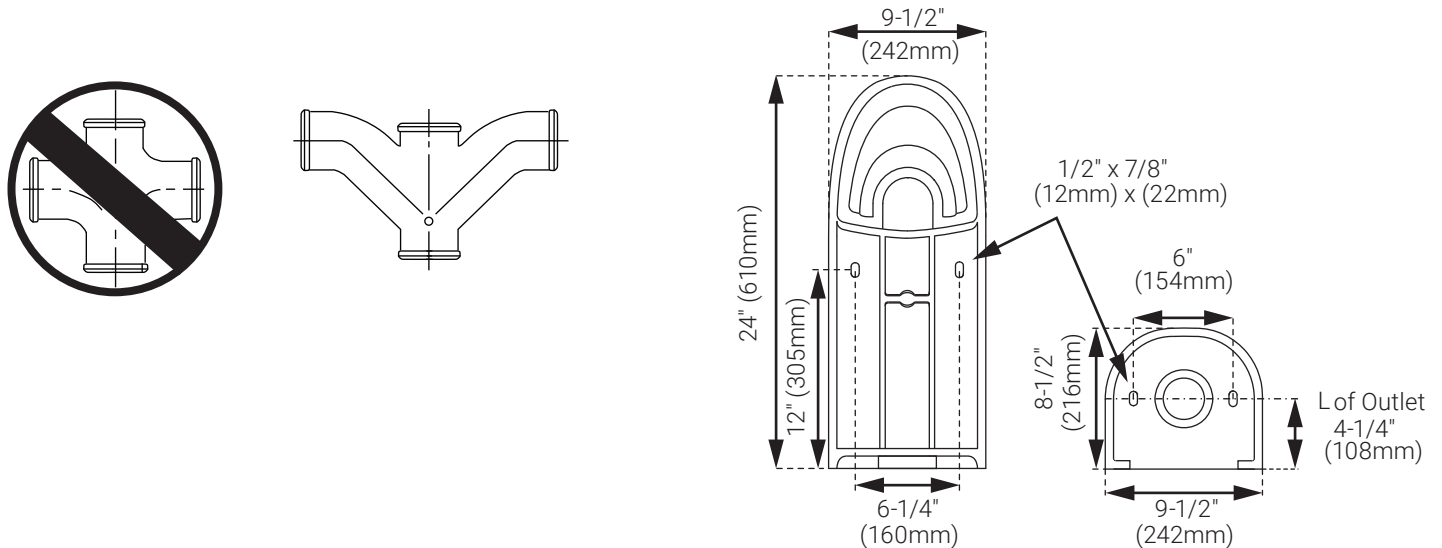

### Dimensions (Nominal)

The distance from the floor to the centerline of the bowl flange rough-in must be set at 4-1/4" (108 mm)

## INSTALLATION

### 1. INSTALLING THE FLANGE

#### Flange System Installation

- Install the closet bolts into the flange channel and turn 90 degrees, then slide into place in the flange locations to align with the centerline of the flange.
- Disconnect and remove supply line, if you are replacing the valve shut main water supply first.
- Remove closet bolts from flange and clean wax and putty from base area.

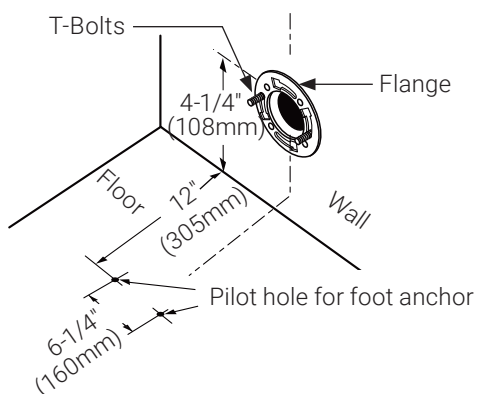

#### Installing the Outlet Gasket Seal

- Fit the outlet gasket seal to the back of the bowl and around the horn of the outlet.
- locations to align with the centerline of the flange.
- Apply a bead of caulk sealant around the fit area of the back of the bowl.

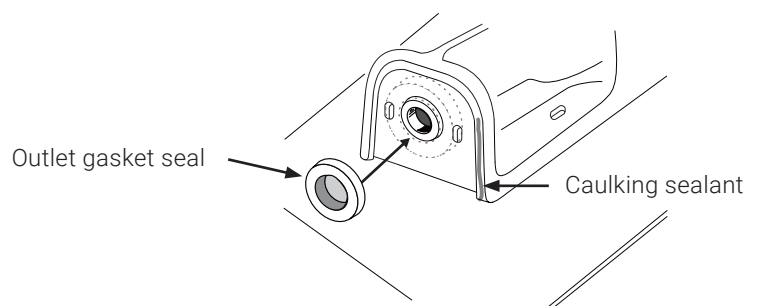

**NOTE:** Wax seal is not recommended for this installation.

## 2. INSTALLING THE BOWL

### Attaching the Toilet Bowl

- Place the bolt cap snap washers (side "UP") to the T-bolt or waste system attachment bolts, then loosely attach the nuts on both sides of the outlet on the back of the bowl.
- Place the bolt cap snap washers (side "UP") on the two floor anchor bolts, align the bolts to the floor anchors and loosely tighten.

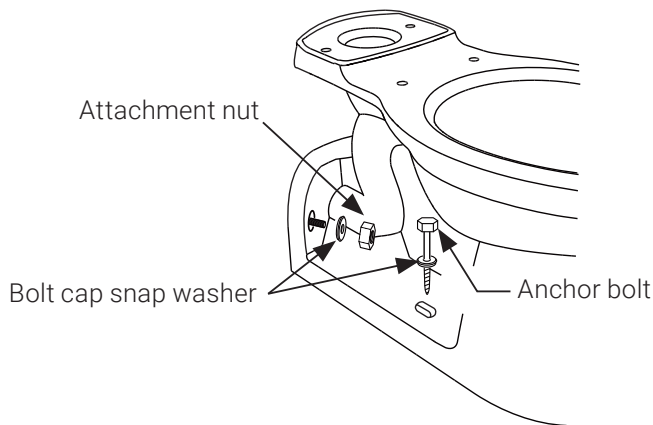

### Setting the Toilet and Final Attachment

- Position the toilet squarely to the wall and with a rocking motion, set (push) the bowl against the wall snug.
- Alternately turn the nuts and anchor bolts until the toilet is firmly anchored to the wall and floor.

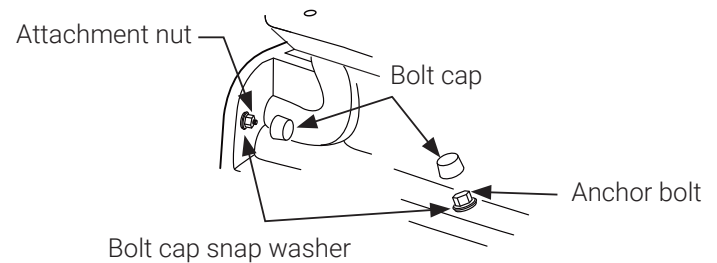

## 3. INSTALLING THE TANK

### Install the Tank

- Install the large rubber gasket over the threaded outlet on the bottom of the tank.
- Lower the tank onto the bowl, aligning the two tank bolts with the two mounting holes on the bowl. Secure the tank with the two brass washers and two brass bolts that are supplied with tank.
- With the tank back parallel to the wall, alternately tighten the nuts under the bowl rim until the tank is snugged down evenly against the tank bar surface.
- Do not spin head of screw. Tighten with wrench.

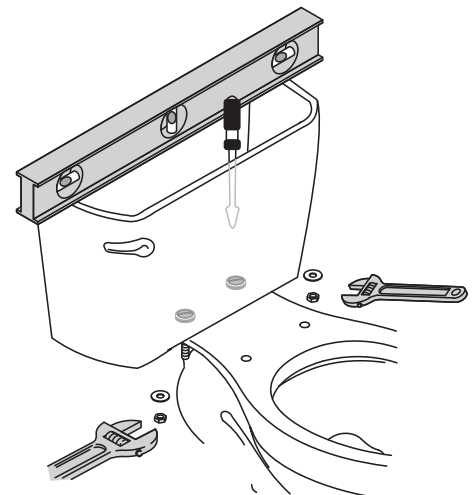
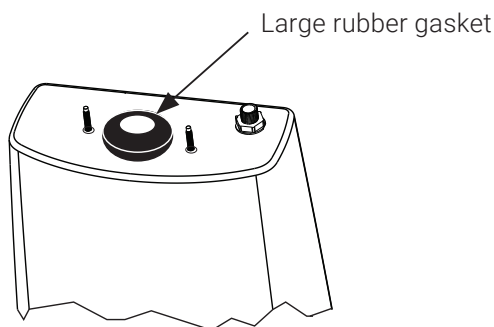

## 4. CONNECT WATER SUPPLY

### Connecting the Water Supply

- Flush the water supply line thoroughly before attaching the supply to the tank.

### Turn on Water Supply

- After all connections are made, turn on the water and check closely for leaks.

### Install the Toilet Seat

- Install the toilet seat (not included) in accordance with the toilet seat manufacturer's directions..

### Troubleshooting and Adjustments

- Water level adjustment: Rotating adjustable rod will adjust the height of the float cup and change the water level.

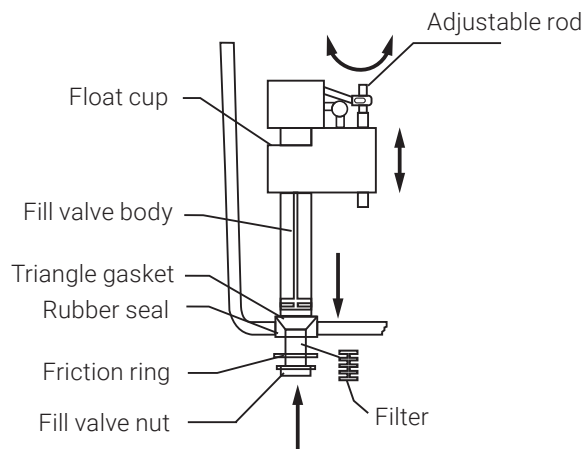

Before continuing determine the type of water supply connections you have from the chart below and use the appropriate assembly parts required to properly reconnect the water supply. **DO NOT** use plumber's putty to seal these fittings.

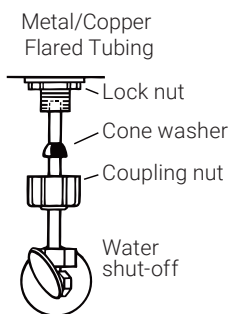

These parts must be used as illustrated to ensure water-tight connection. Use of existing coupling nut may result in water leakage. Water supply tube or pipe must extend at least 1/2" inside threaded shank of valve (does not apply to flanged tubing).

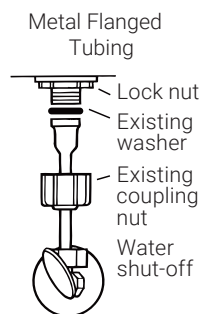

Use existing coupling nut and washer.

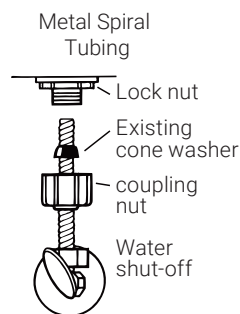

Use existing spiral cone washer. Fluid master cone washer may not seal completely on spiral type supply line.

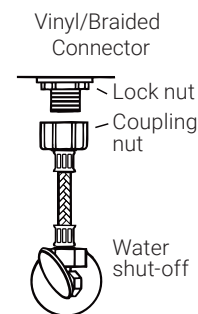

Captive cone washers already included. No additional washers needed.

**CAUTION:**  
DO NOT USE  
CONE WASHER  
WITH PLASTIC  
SUPPLY LINE.

**CAUTION:**  
Overtightening  
of LOCK NUT or  
COUPLING NUT  
could result in  
breakage and  
potential flooding.

5. TROUBLESHOOTING & MAINTENANCE

Difficulties	Reason	Solution
Water level is too high or too low	Fill valve adjusted incorrectly	Adjust water level
Fill valve can't fill	Shut-off valve not fully open	Open shut-off valve
	Filter clogged	Remove and clean filter
	Float cup is stuck by tank wall	Rotate valve away from tank wall
Leaking	Fill valve nut is loose	Tighten fill valve nut

Care and Maintenance

- Do not use abrasive-powered or liquid cleaners which can damage the product surface.
- Only use mild soap, and rinse thoroughly and use a soft cloth to dry.
- Avoid detergents, disinfectants or cleaning products in an aerosol can.
- Overtightening of the lock nut or coupling nut could result in breakage and flooding.
- DO NOT USE a cone washer with a plastic supply line.
- DO NOT USE pipe dope or other silicon-based materials to seal the supply coupling nut.



## ONE YEAR LIMITED WARRANTY

Carlton products are made with quality materials and excellent craftsmanship to provide our customers with beautiful, durable, long-lasting products. Should there be any defects in materials or craftsmanship under regular use that are discovered within the first year of installation, Carlton will provide replacement parts at no charge, or at its discretion, replace any product or part of the product that is deemed defective, under normal installation, use, service or maintenance. This warranty applies only to the original purchaser. Proof of purchase will be required in the instance of a claim.

Carlton recommends all installations of Carlton products to be conducted by a licensed, professional plumber or contractor. Carlton will not be held responsible for any damage or product failure due to improper installation, misuse, or failure to utilize a licensed professional for installation. Carlton is not responsible for any installation or removal costs.

### **This One Year Limited Warranty Will Be Voided If:**

- The installation recommendations were not followed by the installer
- The product has been moved from its initial place of installation
- The product has in any way been modified from its packaged state
- The product has been subjected to improper maintenance, abuse, misuse, excessive use of chemicals, accidents, or other damages, etc.

Carlton makes no implication that its products comply with any local building or plumbing codes. It is the consumer's responsibility and obligation to determine local code compliance prior to and during installation. This warranty extends only to the original purchaser and first consumer.

Carlton is not responsible for any special, incidental or consequential damages associated with the installation, replacement, return or use of the original purchaser's product. This includes, but is not limited to: freight costs, labor, travel time, lost profit, home damages and other contingent liabilities and costs (including, without limitation, costs associated with 'professionals' or 'experts', investigations, audits, analyses, attorneys and any other professional/hired services).

The Carlton warranty is a comprehensive and explicit limit of liability. All items not disclosed within the warranty are not addressable within the responsibility of Carlton. Certain states have variances regarding implied warranties; in those situations, we remain fully compliant.

**If you have any questions or concerns, please contact us at  
[info@carltonplumbing.com](mailto:info@carltonplumbing.com)**

 **WARNING:** Contents of your order may contain sharp and possibly other harmful pieces and may cause hazard to children and adults. Carlton is not responsible in any way for personal damages.