

# DJYC2519

ASSEMBLY INTRODUCTION

## Needed for Assembly:

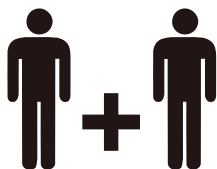

2 People

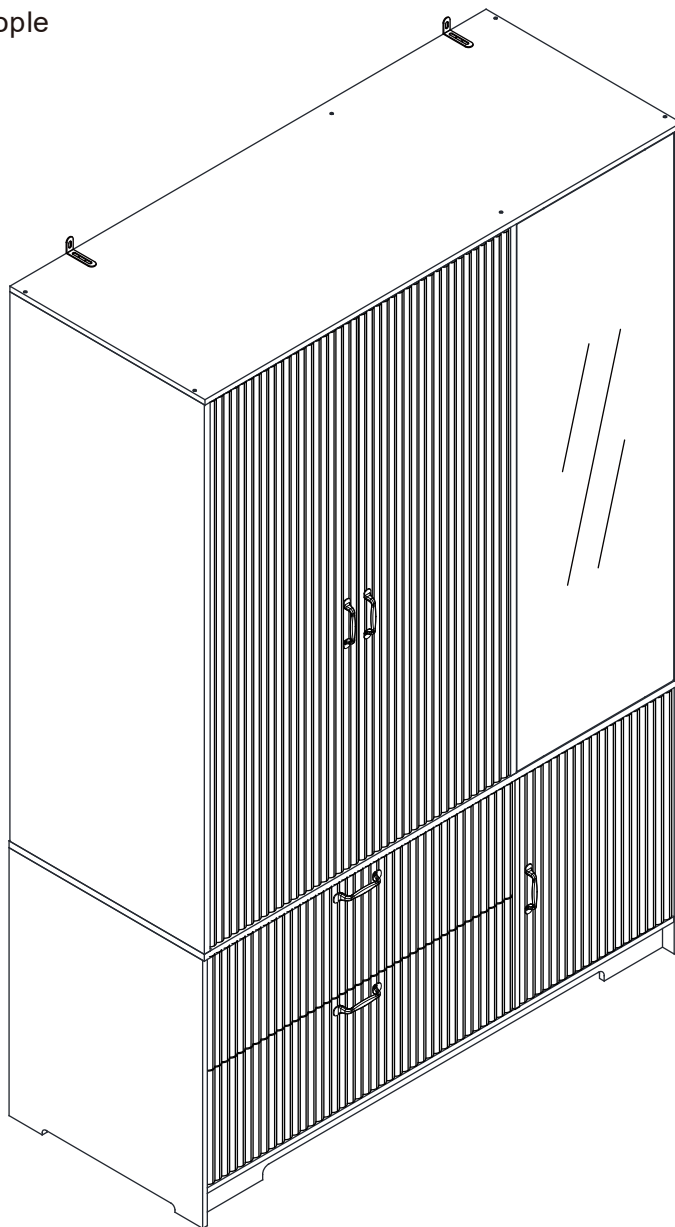

Exploded View

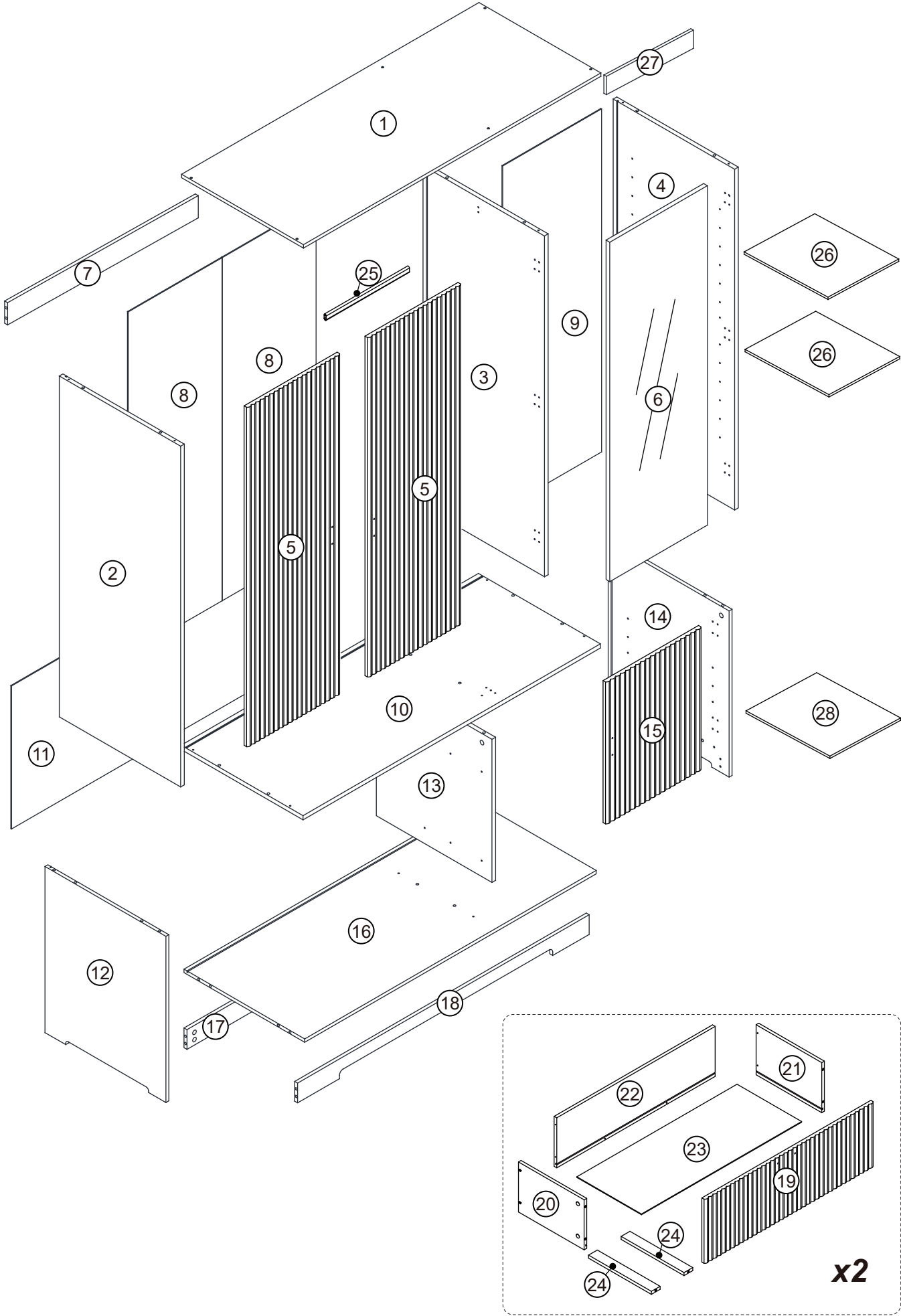

## Fittings

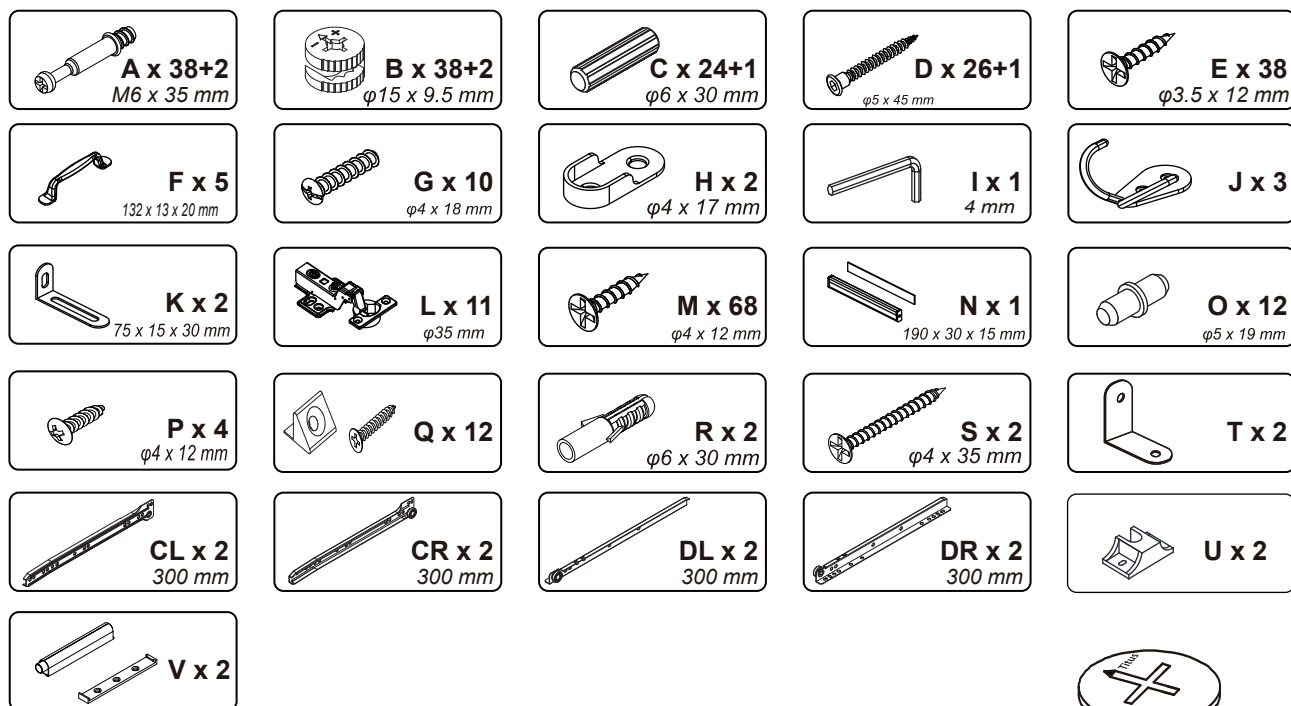

## CAM-LOCK



**WHEN FITTING CAMLOCK  
ENSURE STARTING POSITION IS CORRECT  
BEFORE YOU INSERT CONNECTING QUICKFIT  
TURN CLOCKWISE UNTIL SECURE**

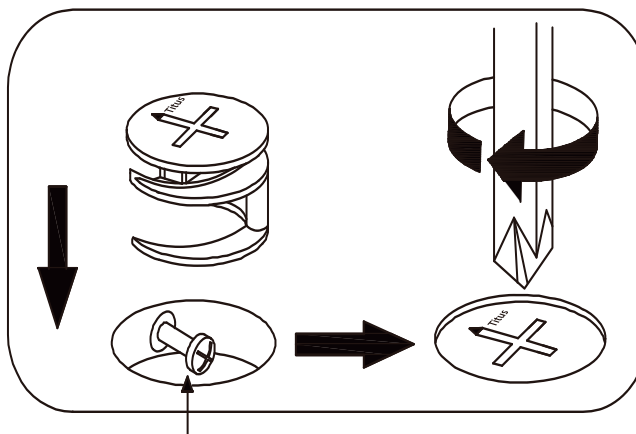
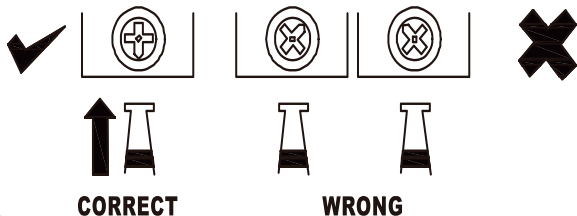

**Quickfit head needs to be in centre**

## QUICKFIT

**Tighten until shoulder is flush  
with panel. DO not overtighten  
or undertighten (see example  
below)**

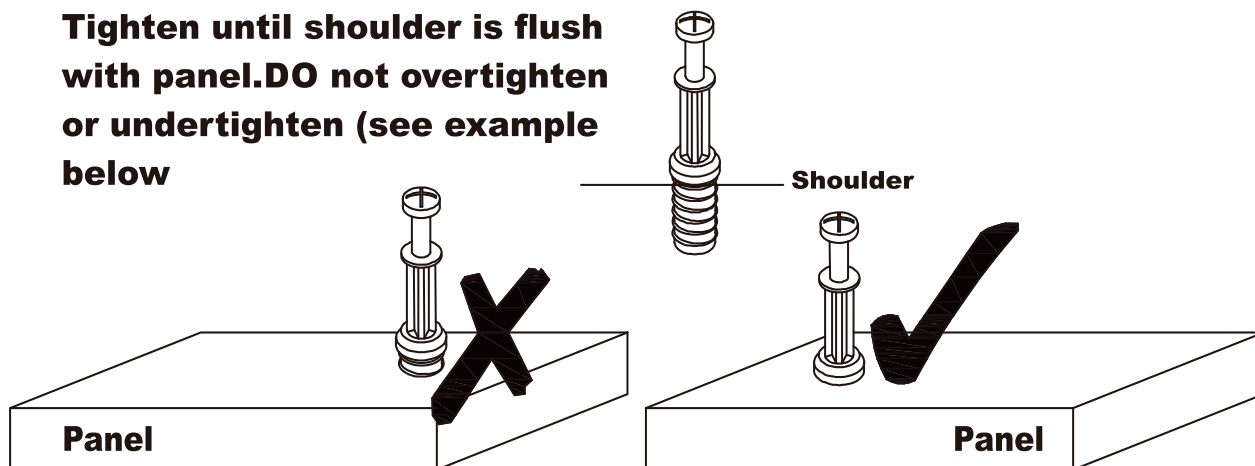

# Step 1

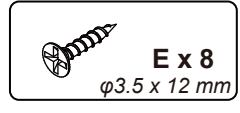
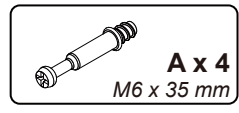
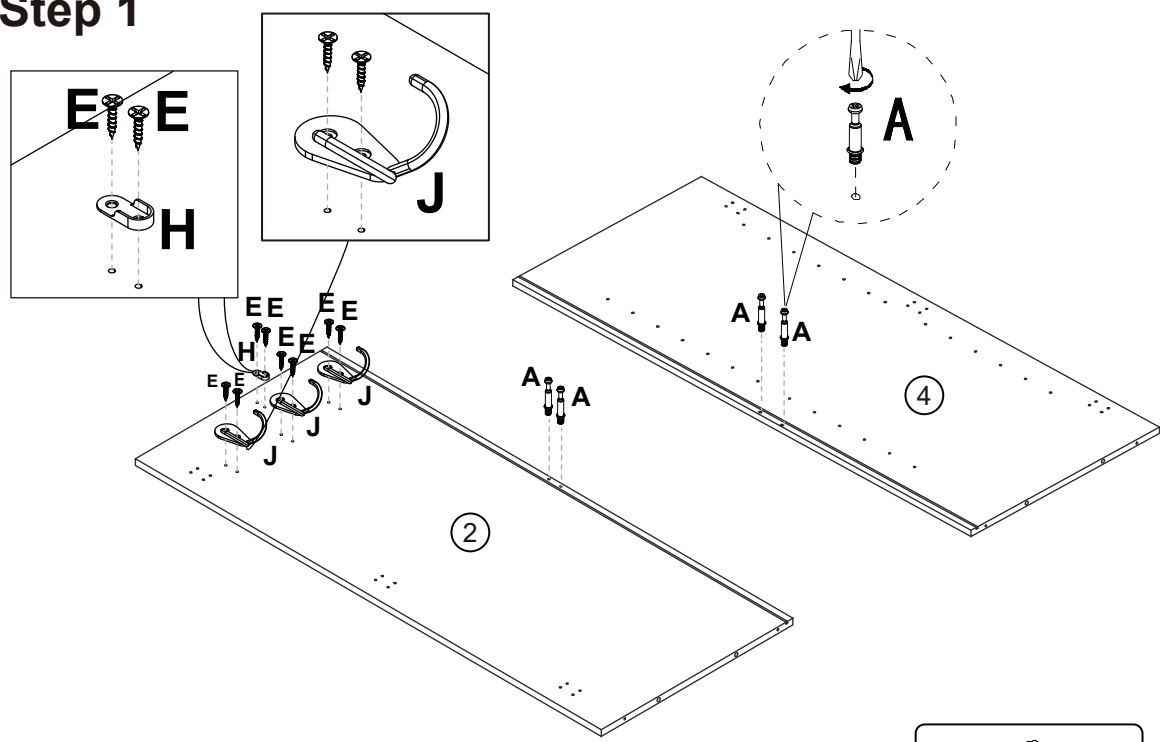

# Step 2

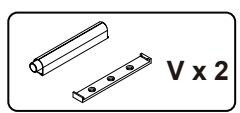
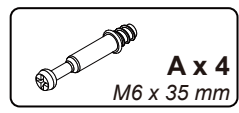
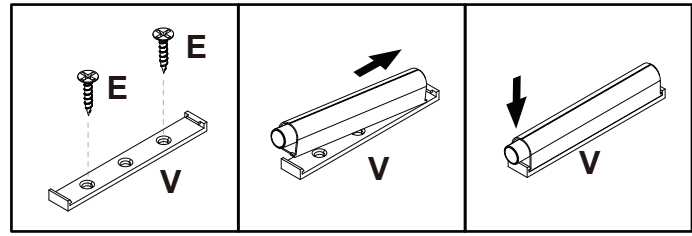
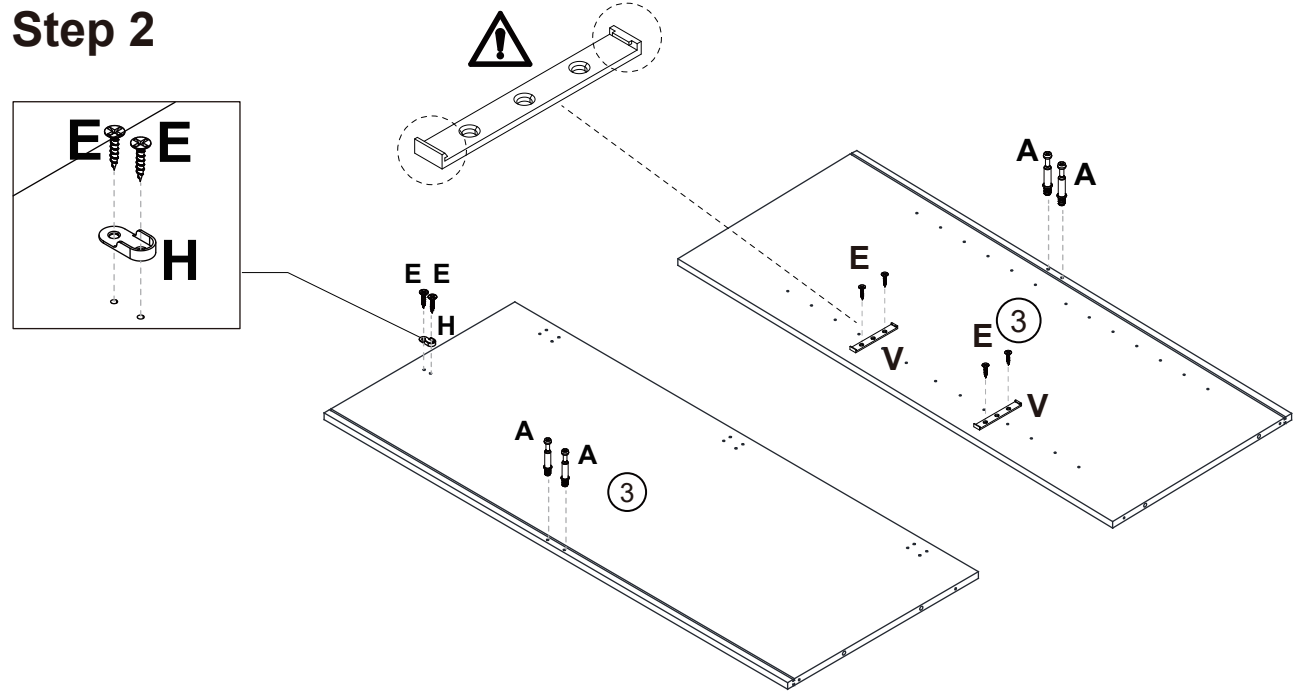



## Step 3

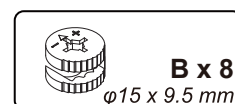
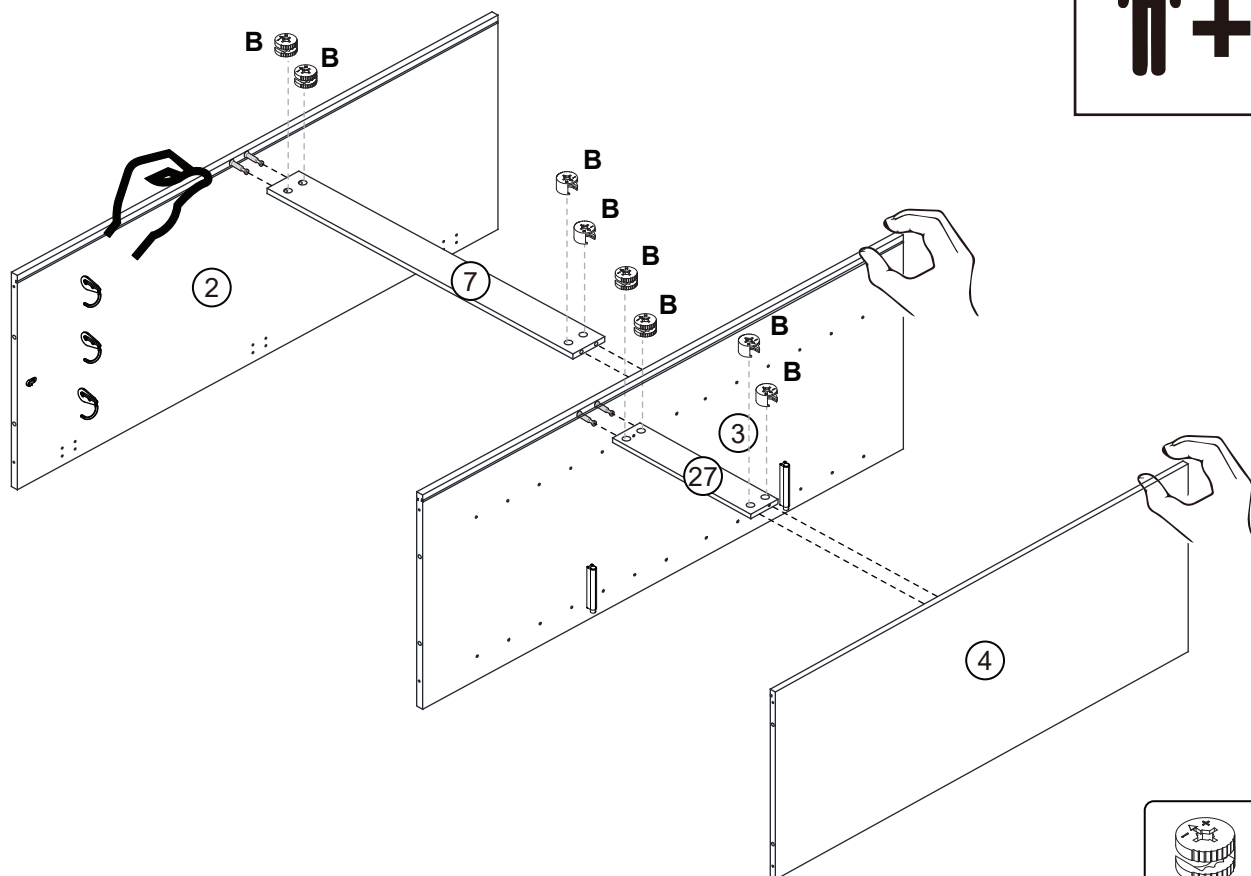
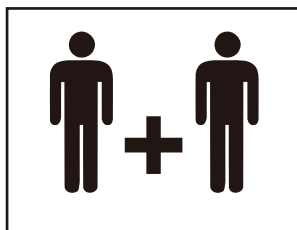

## Step 4

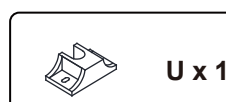
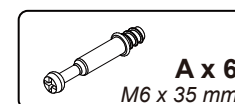
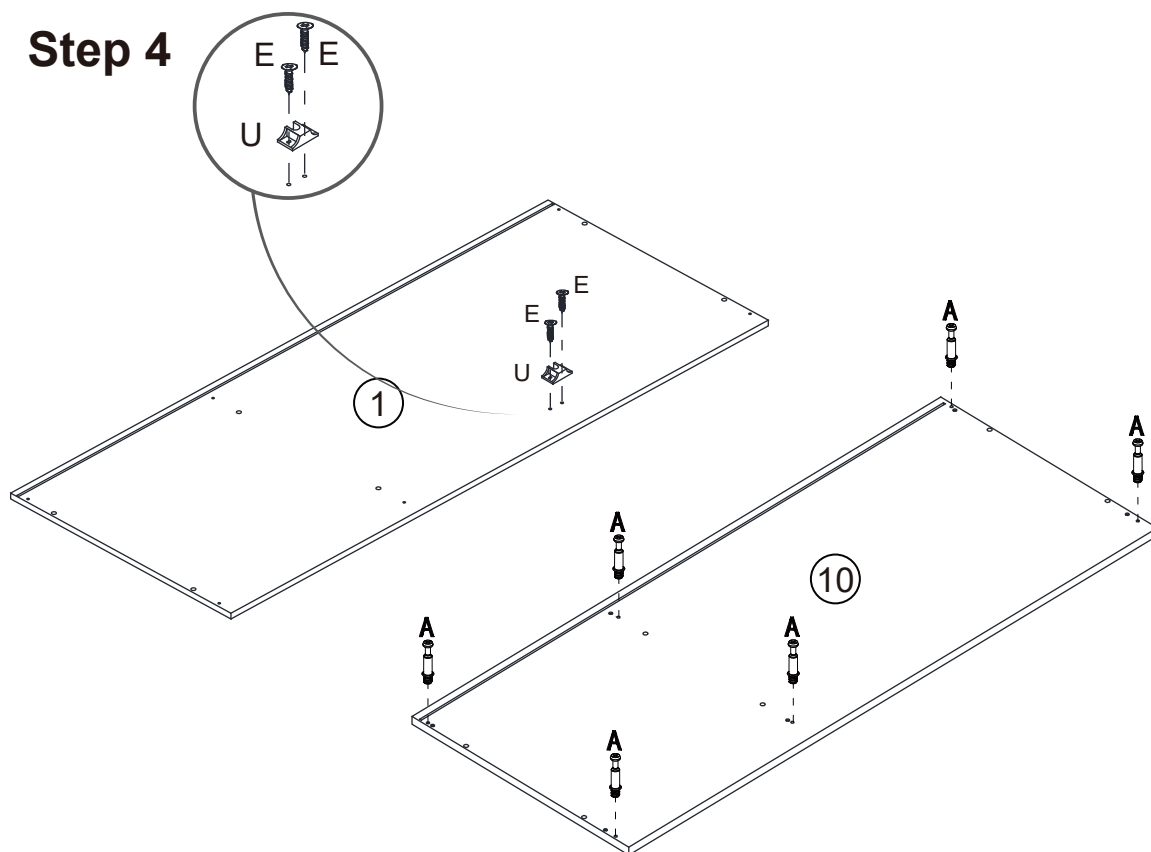

## Step 5

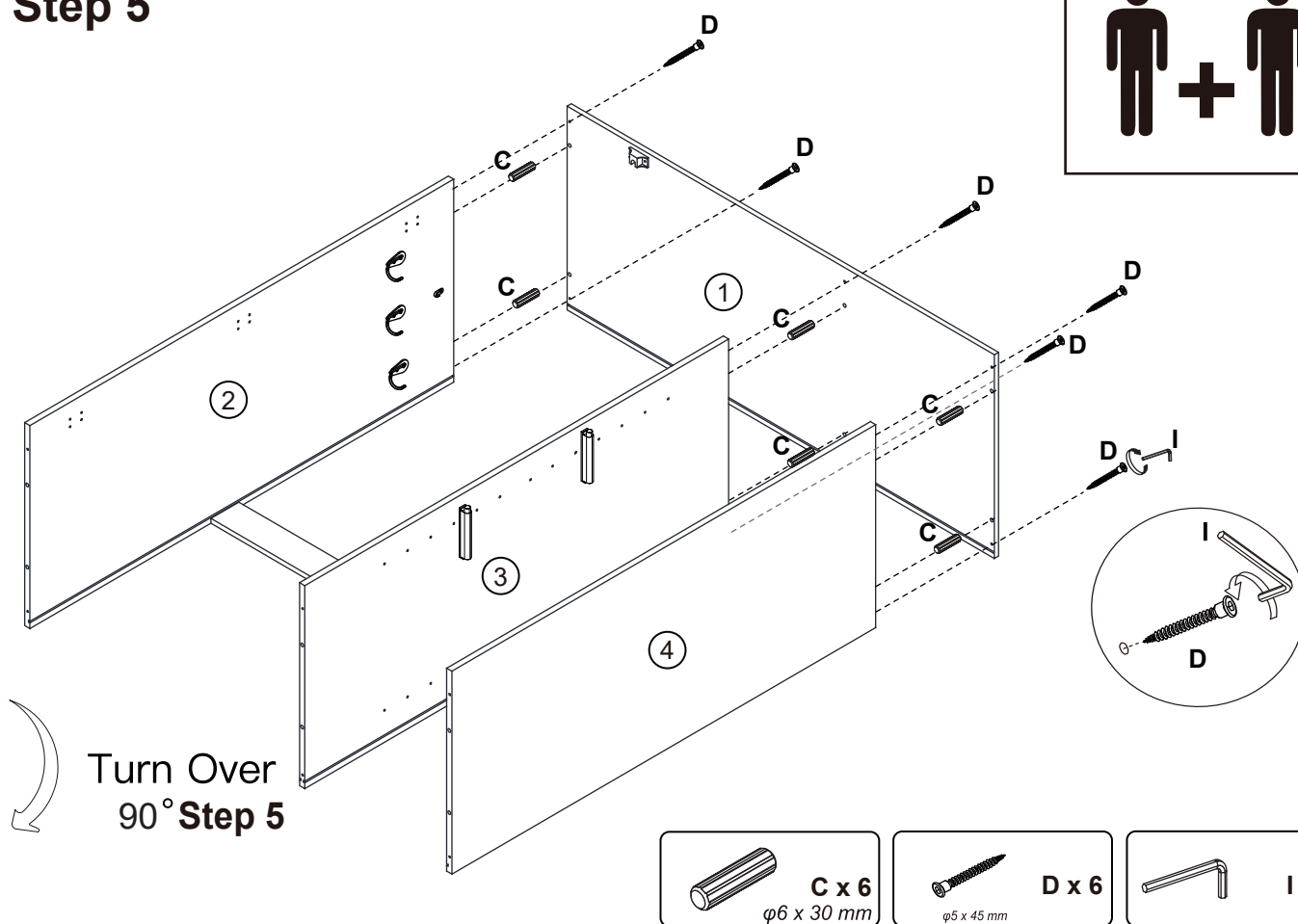
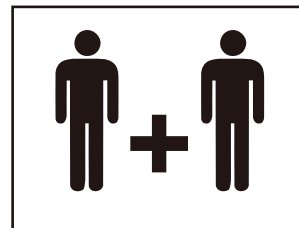

## Step 6

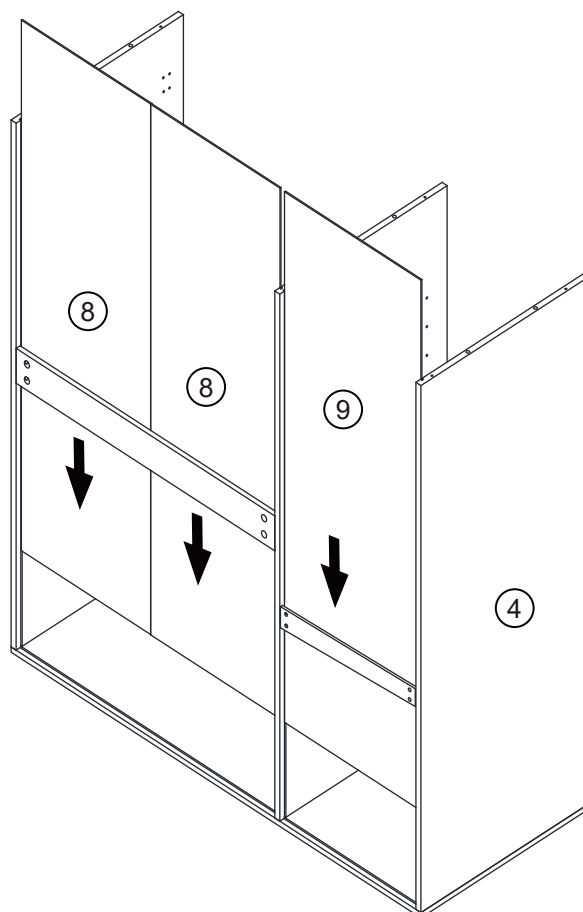

## Step 7

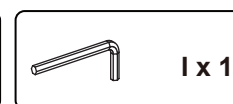
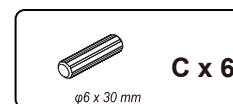
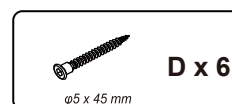
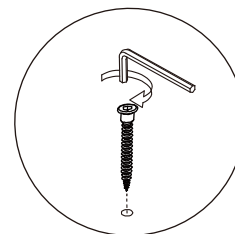
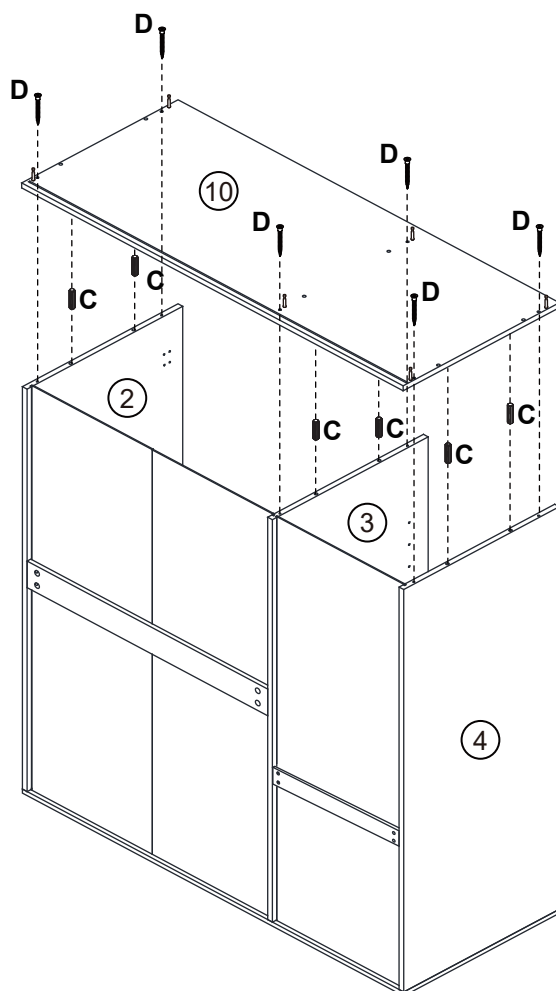

## Step 8

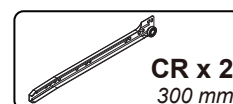
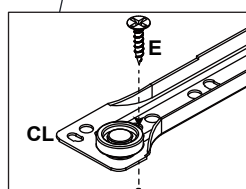
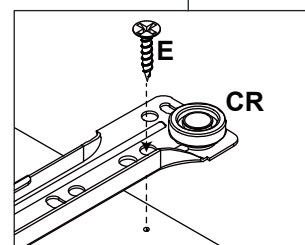
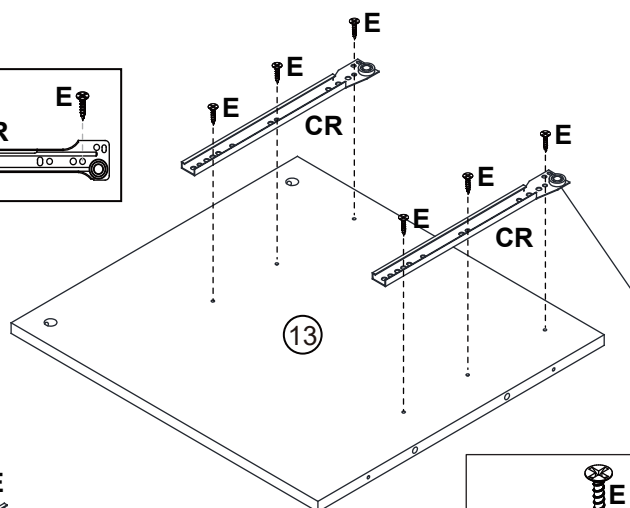
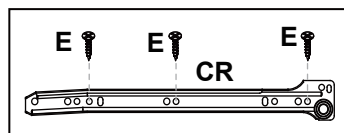
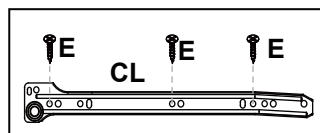

Step 9

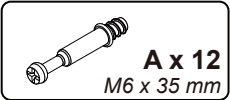
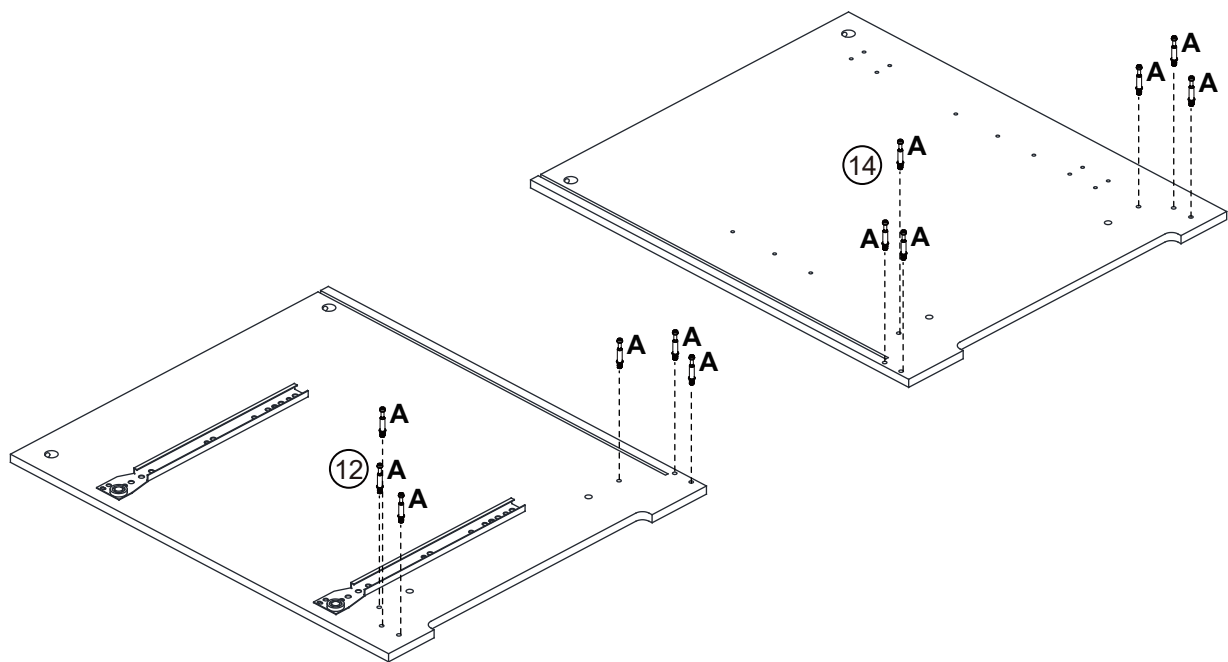

Step 10

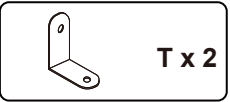
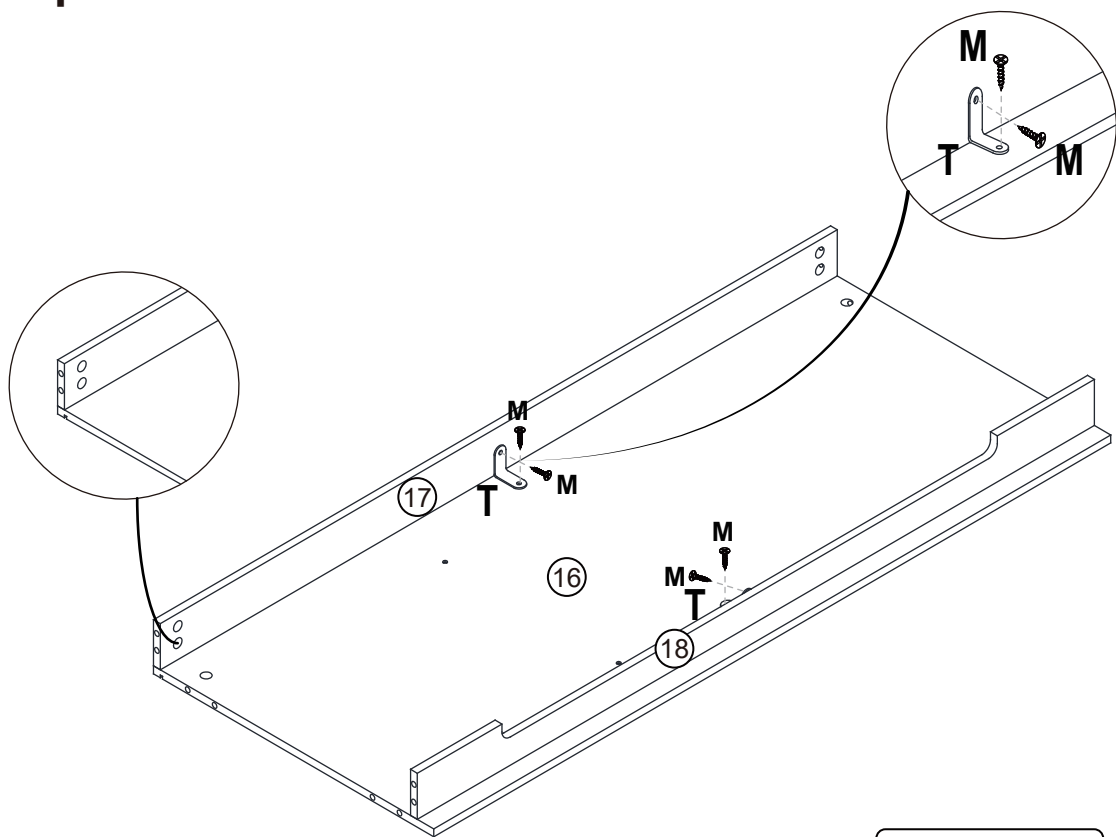

## Step 11

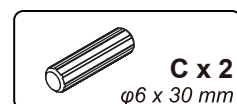
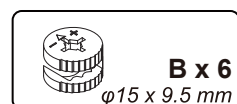
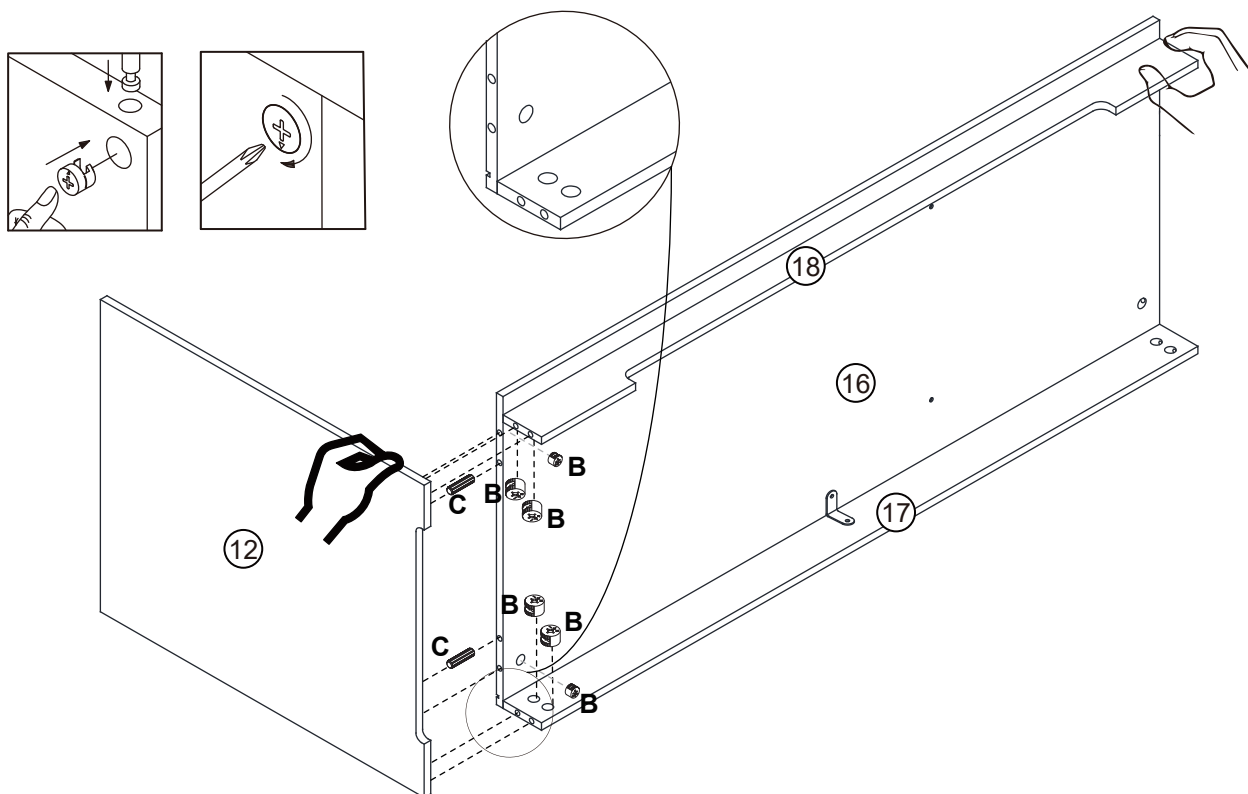

## Step 12

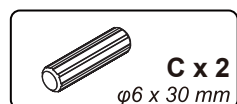
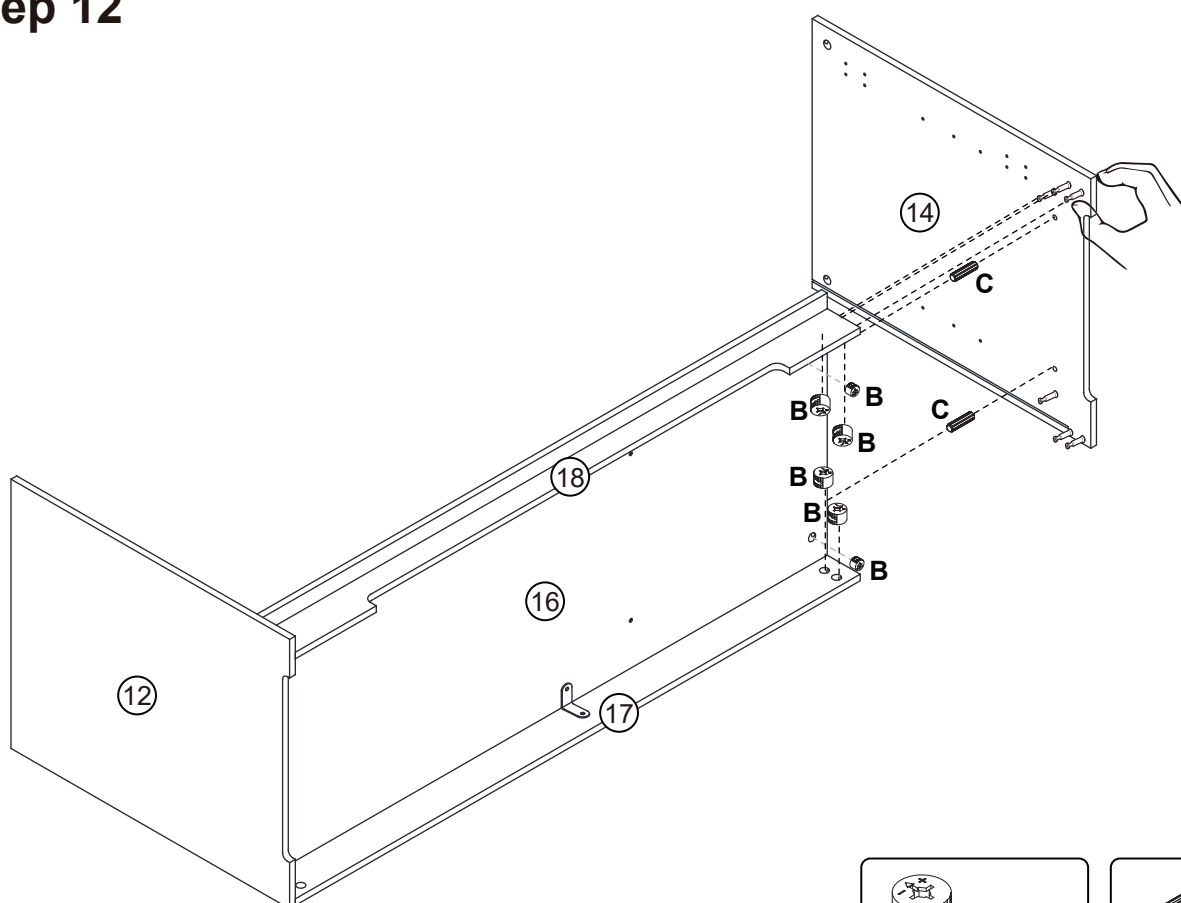

## Step 13

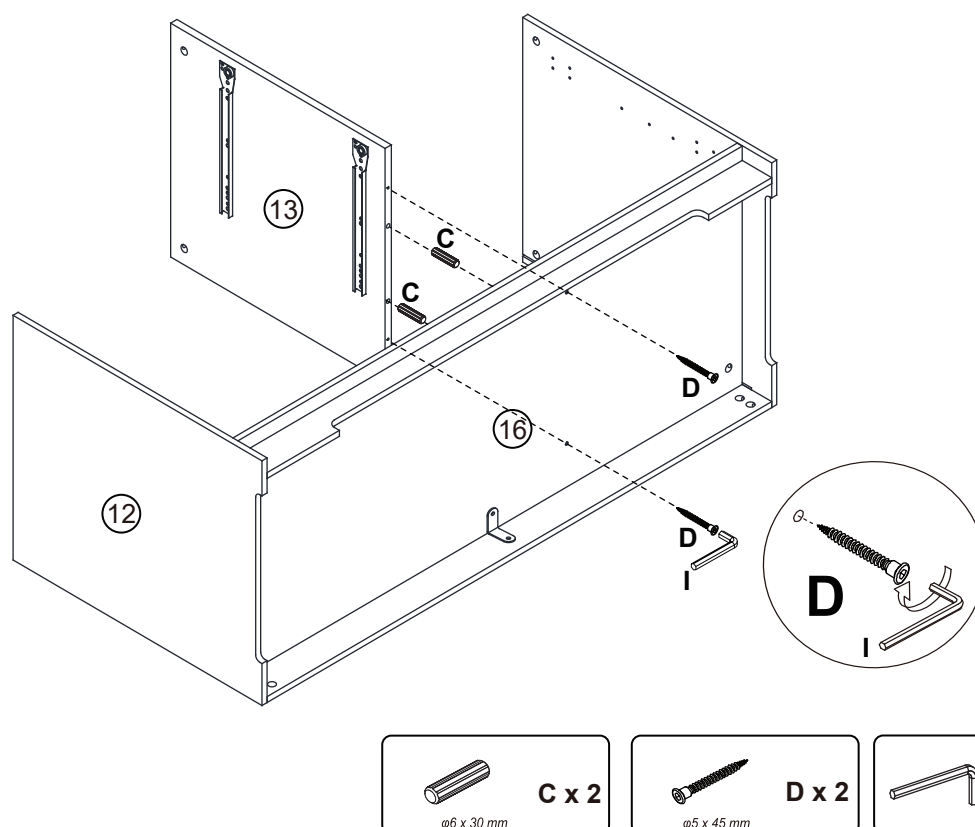

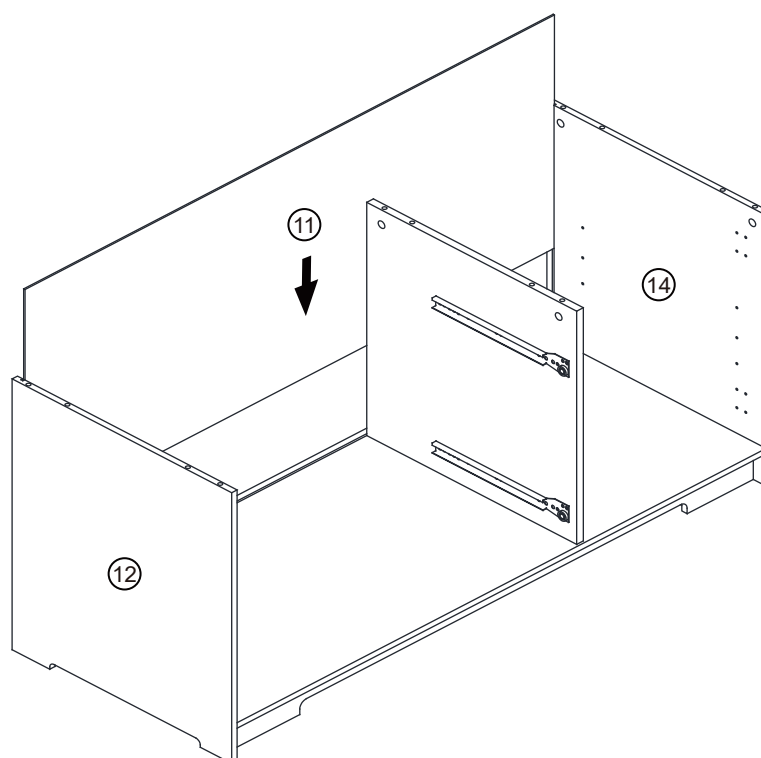

## Step 14

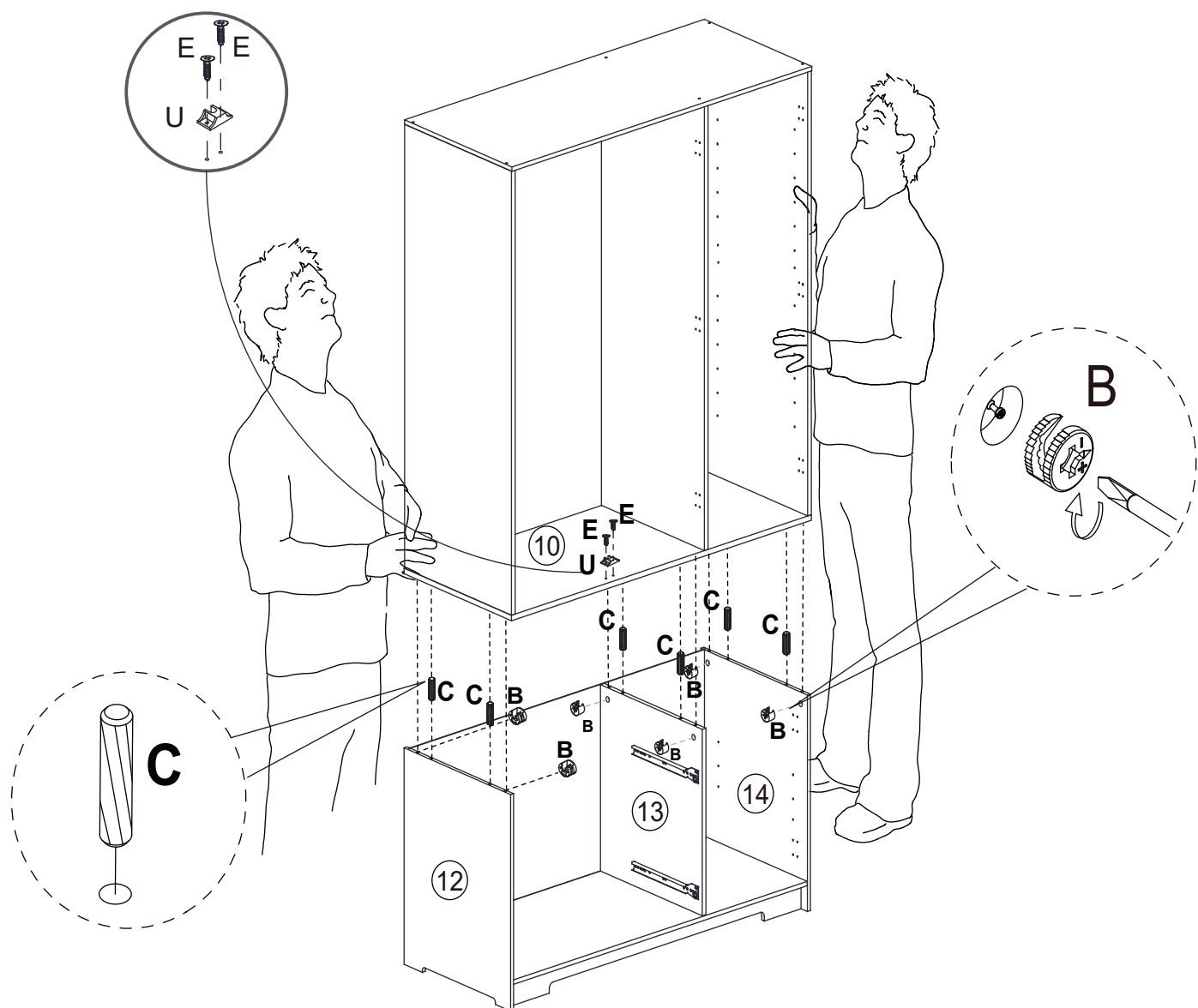
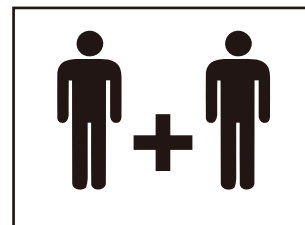

# Step 15

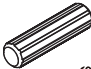

	<b>U x 1</b>		<b>E x 2</b> φ3.5 x 12 mm
	<b>B x 6</b> φ15 x 9.5 mm		<b>C x 6</b> φ6 x 30 mm

## Step 16

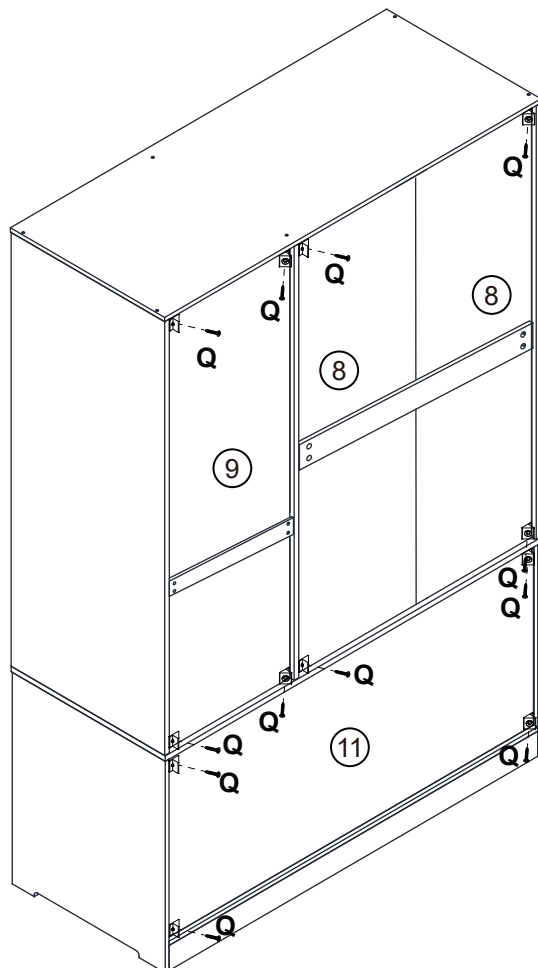

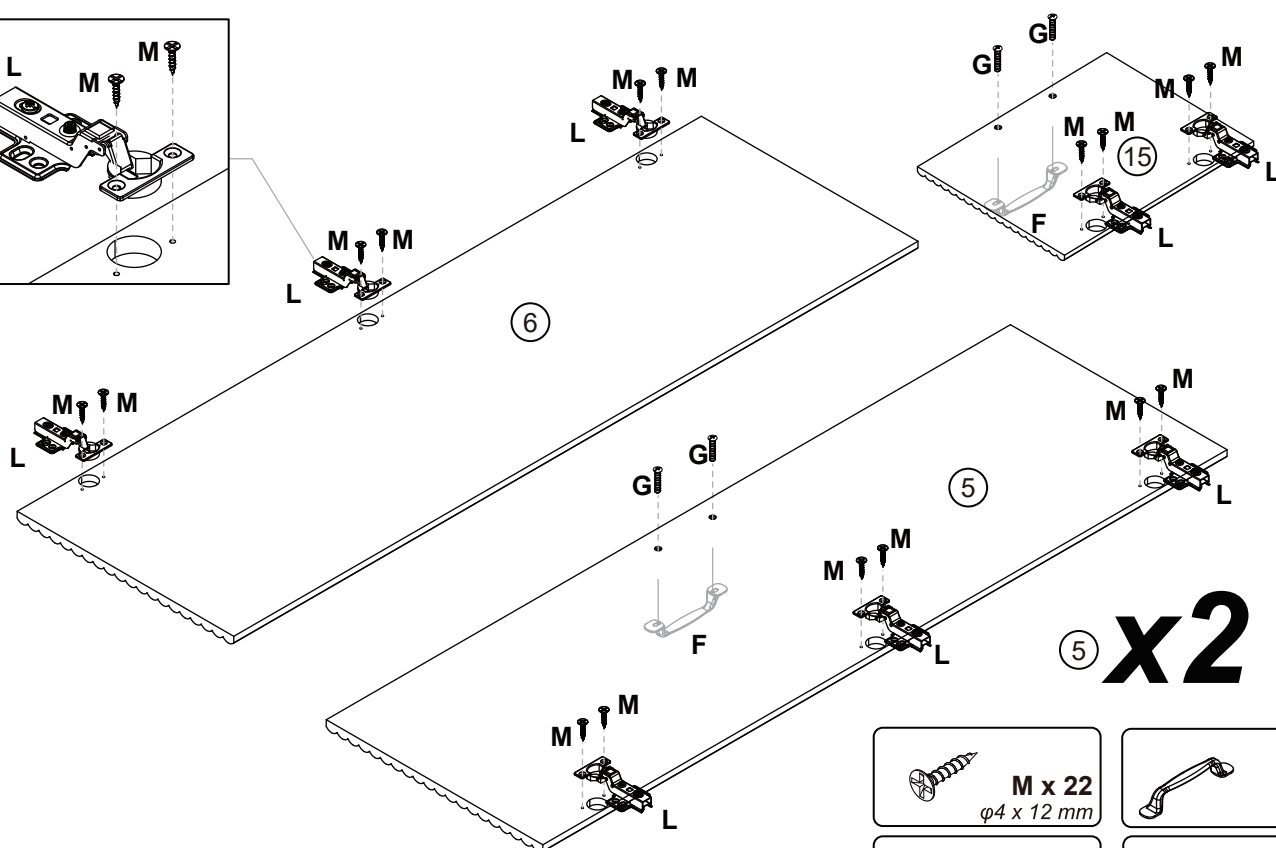
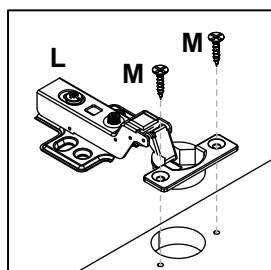

 **Q x 12**

## Step 17



 **M x 22**  
 $\phi 4 \times 12 \text{ mm}$

 **F x 3**

 **G x 6**

 **L x 11**



## Step 18

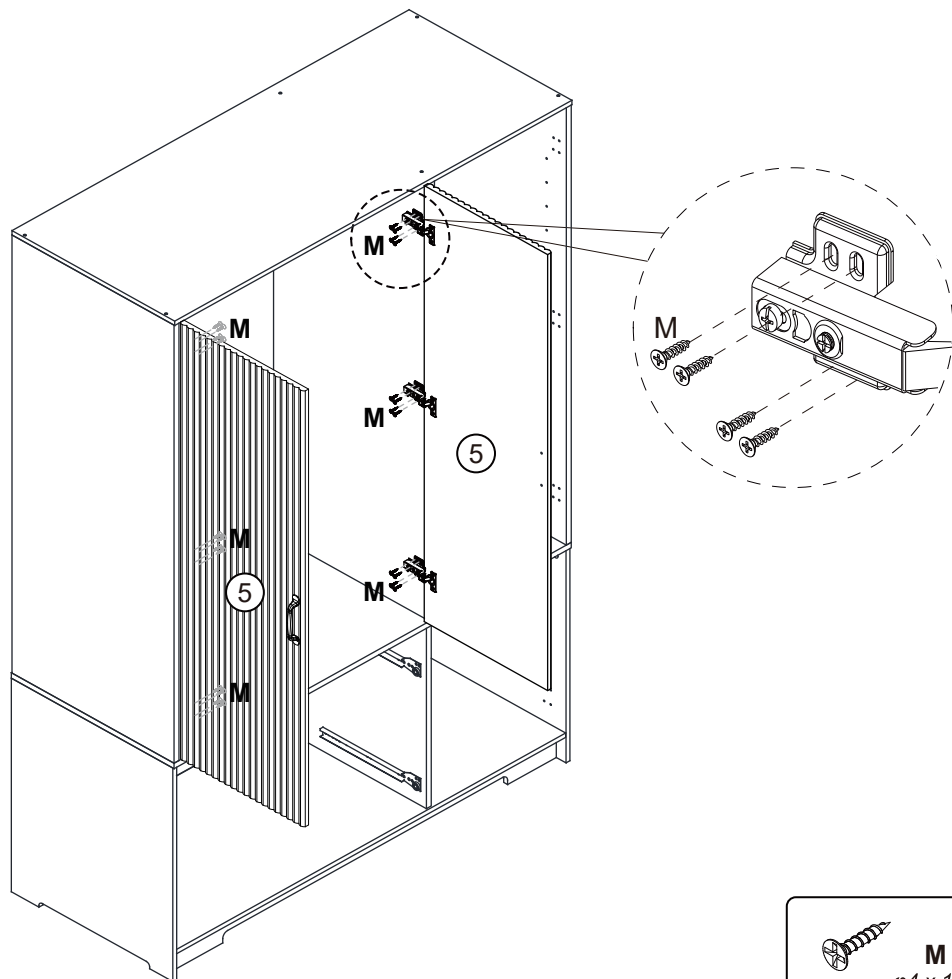

## Step 19

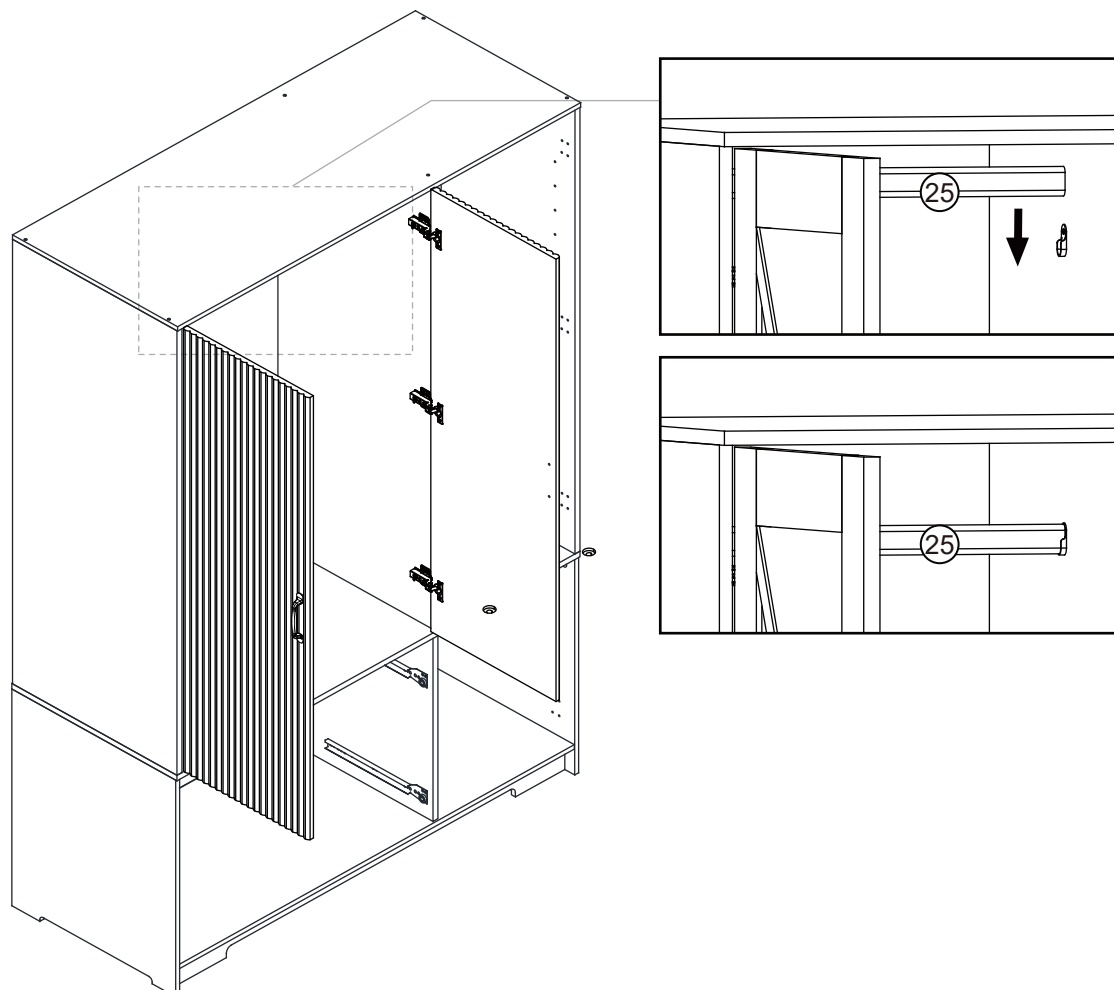

## Step 20

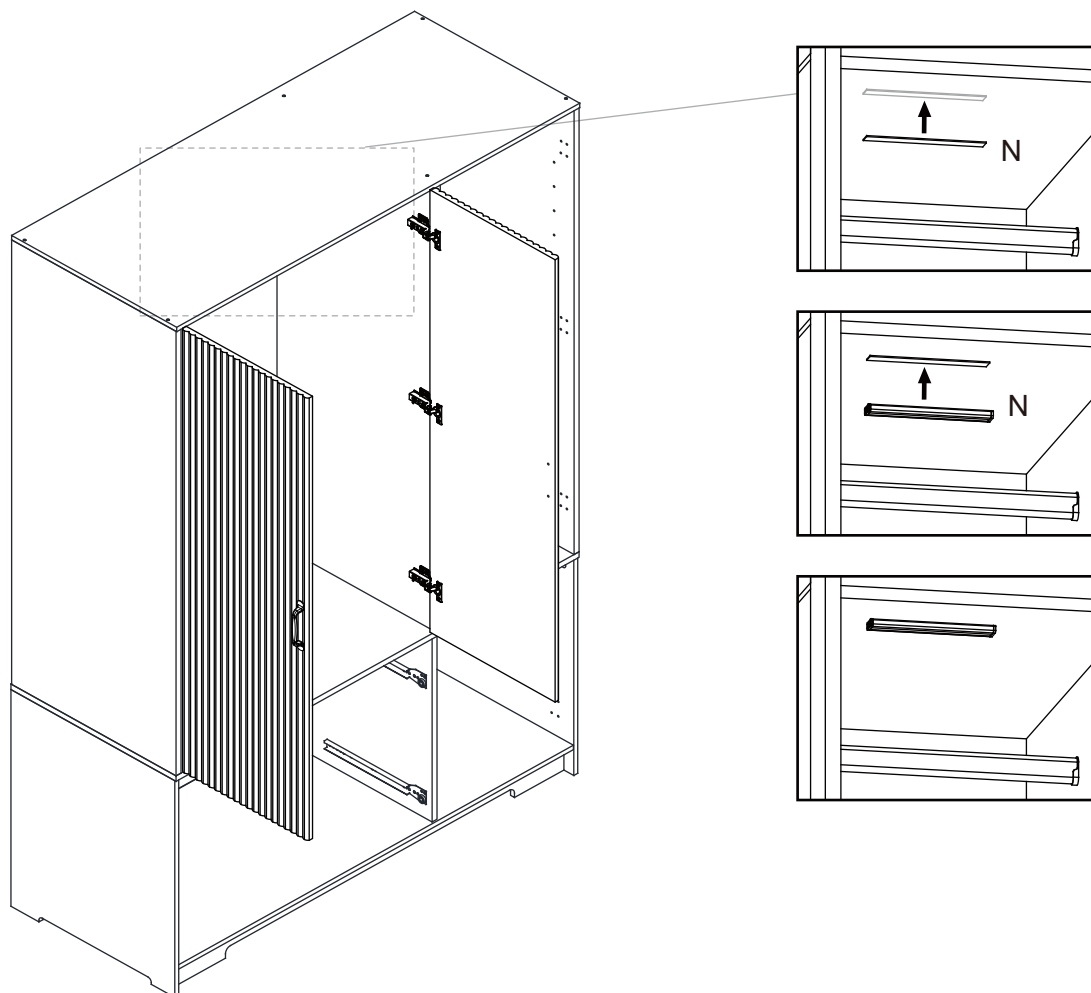

## Step 21

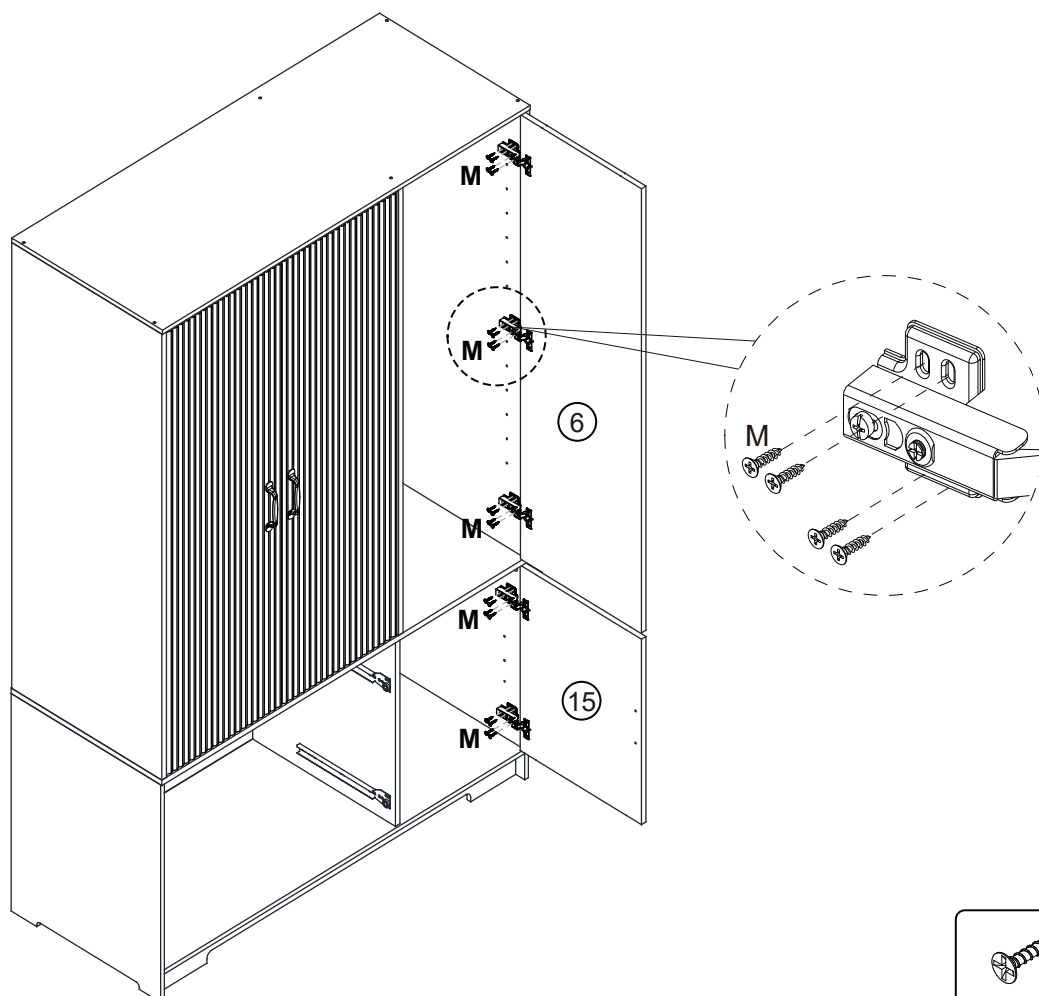

**M x 20**  
φ4 x 12 mm

## Step 22

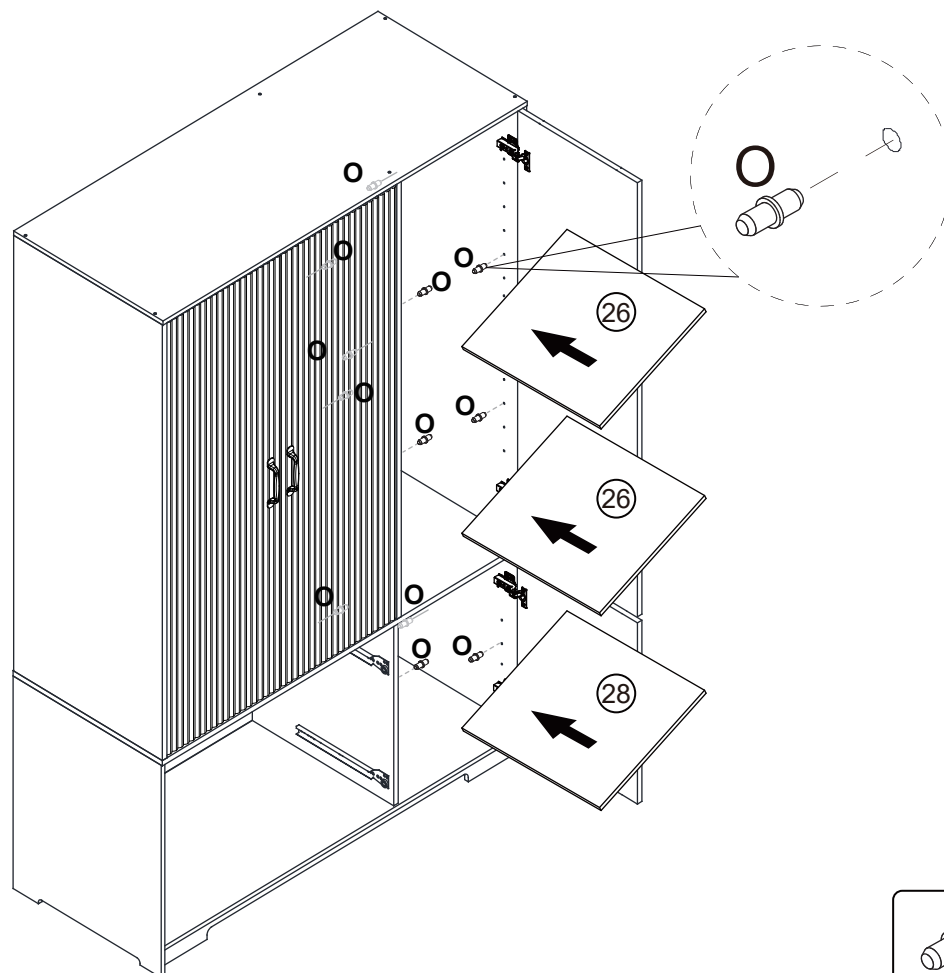

O x 12

## Step 23

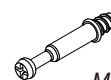
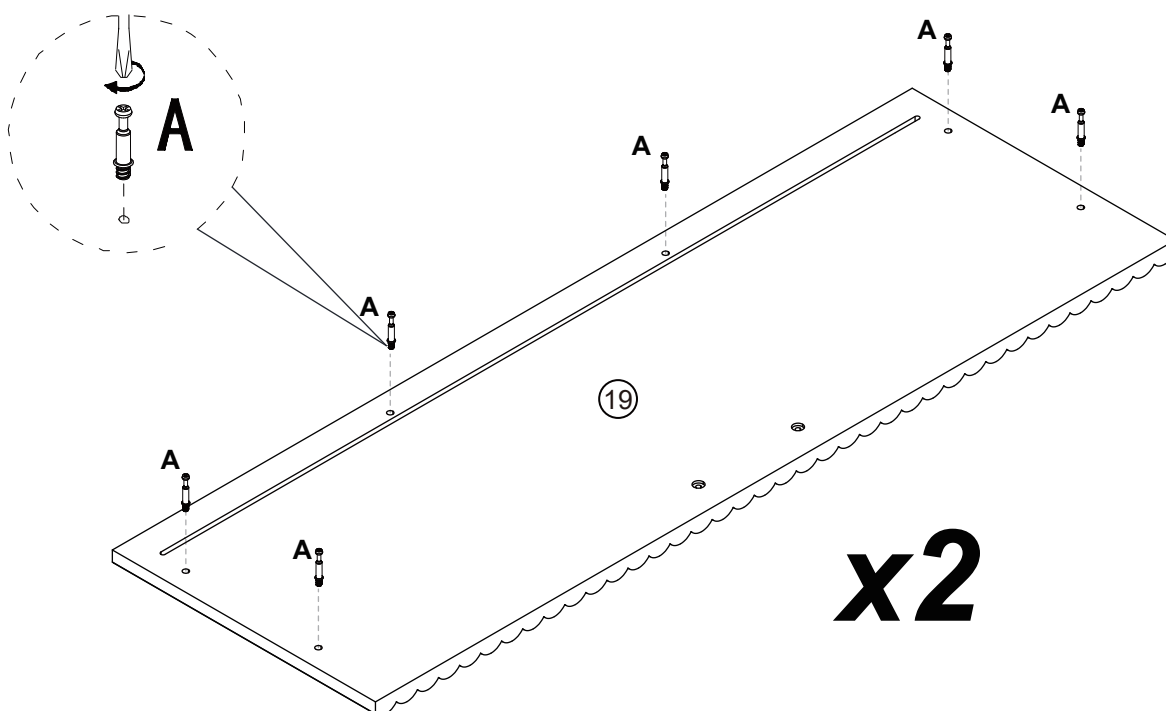

A x 12  
M6 x 35 mm

## Step 24

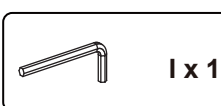
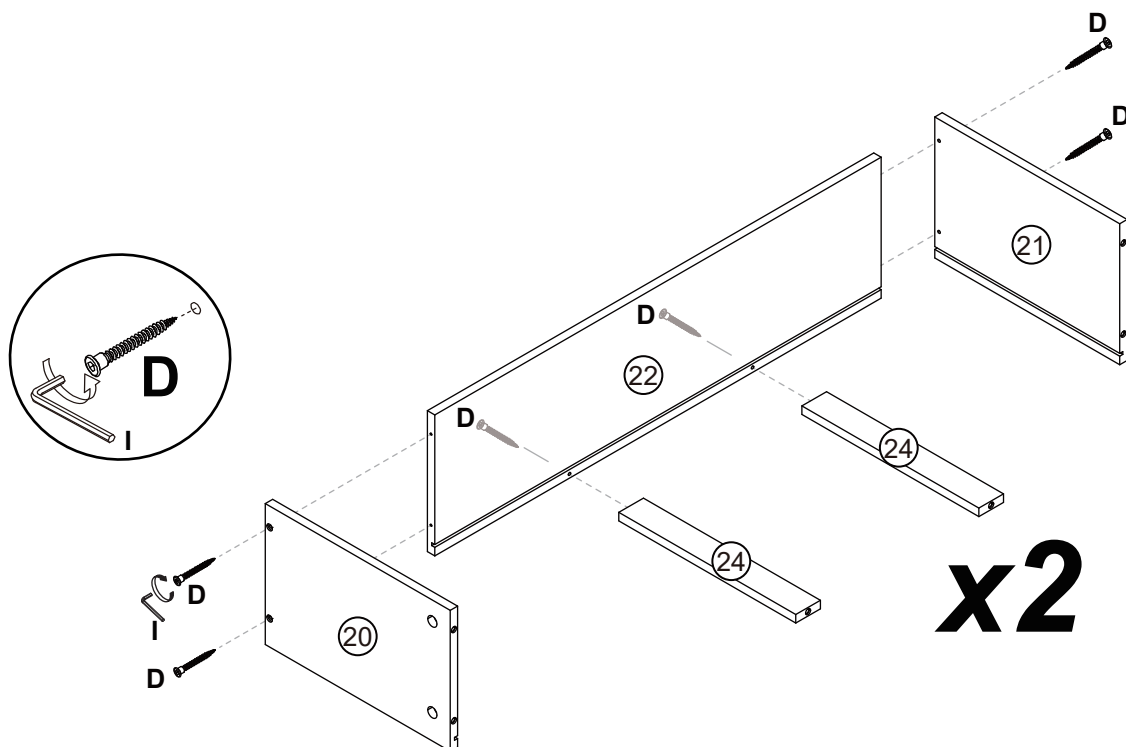

## Step 25

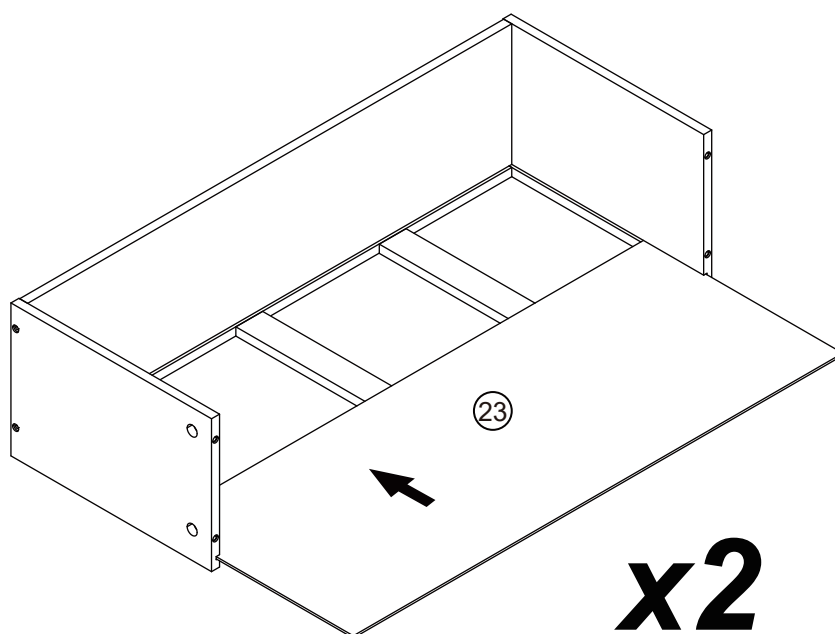

Step 26

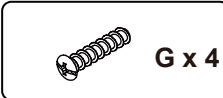
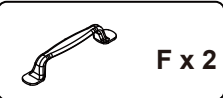
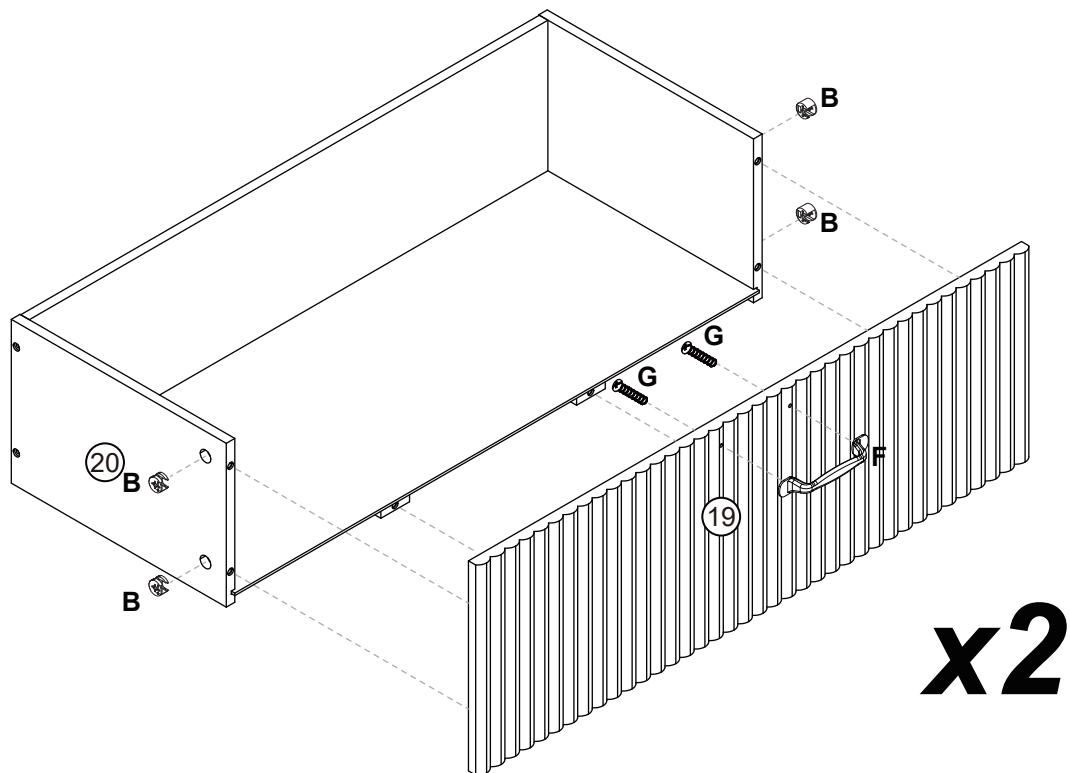

Step 27

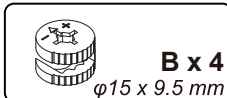
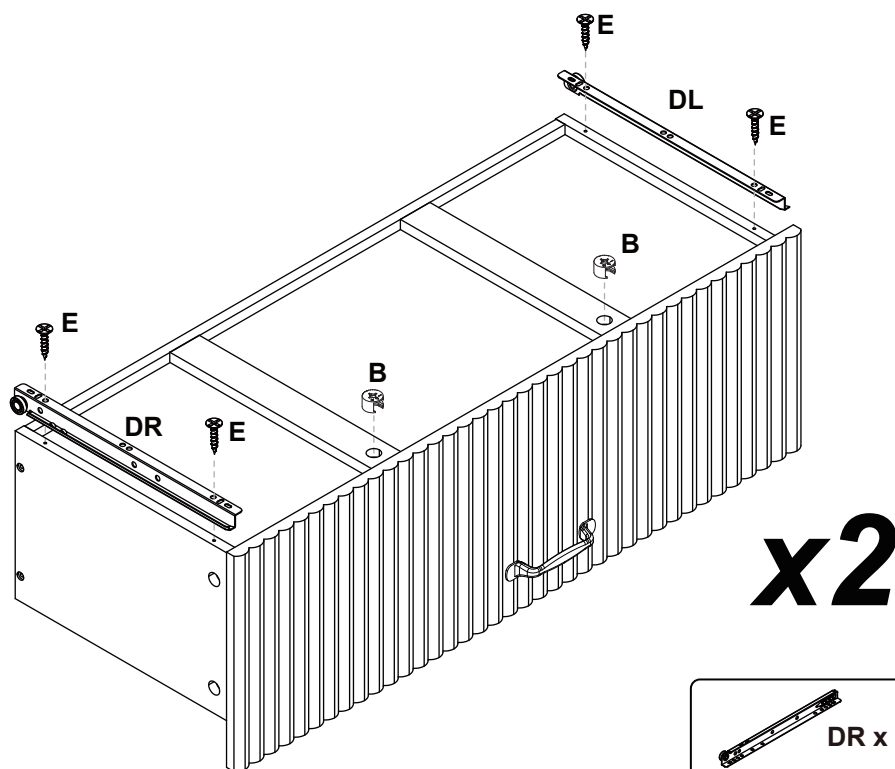

## Step 28

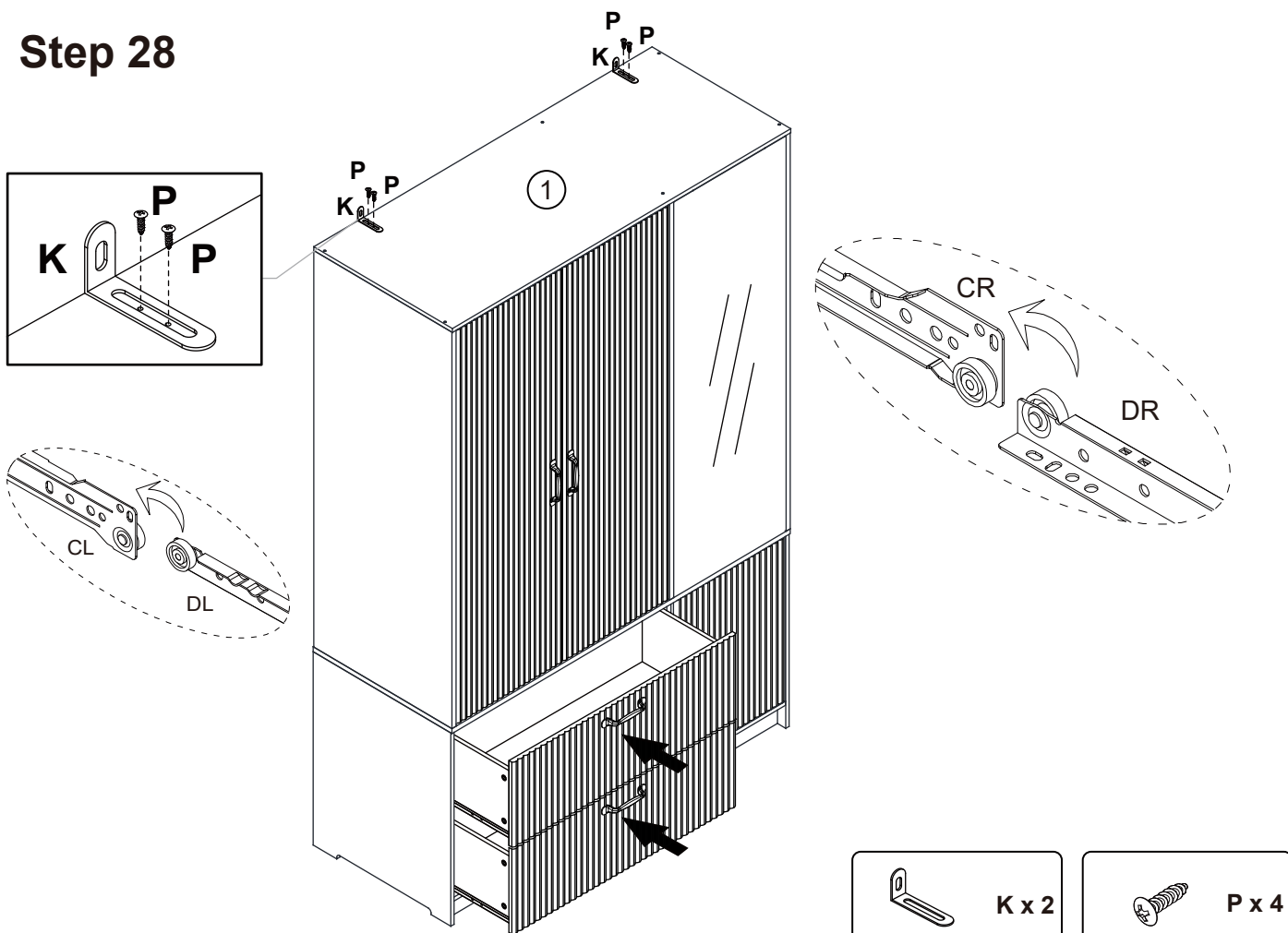

## Step 29

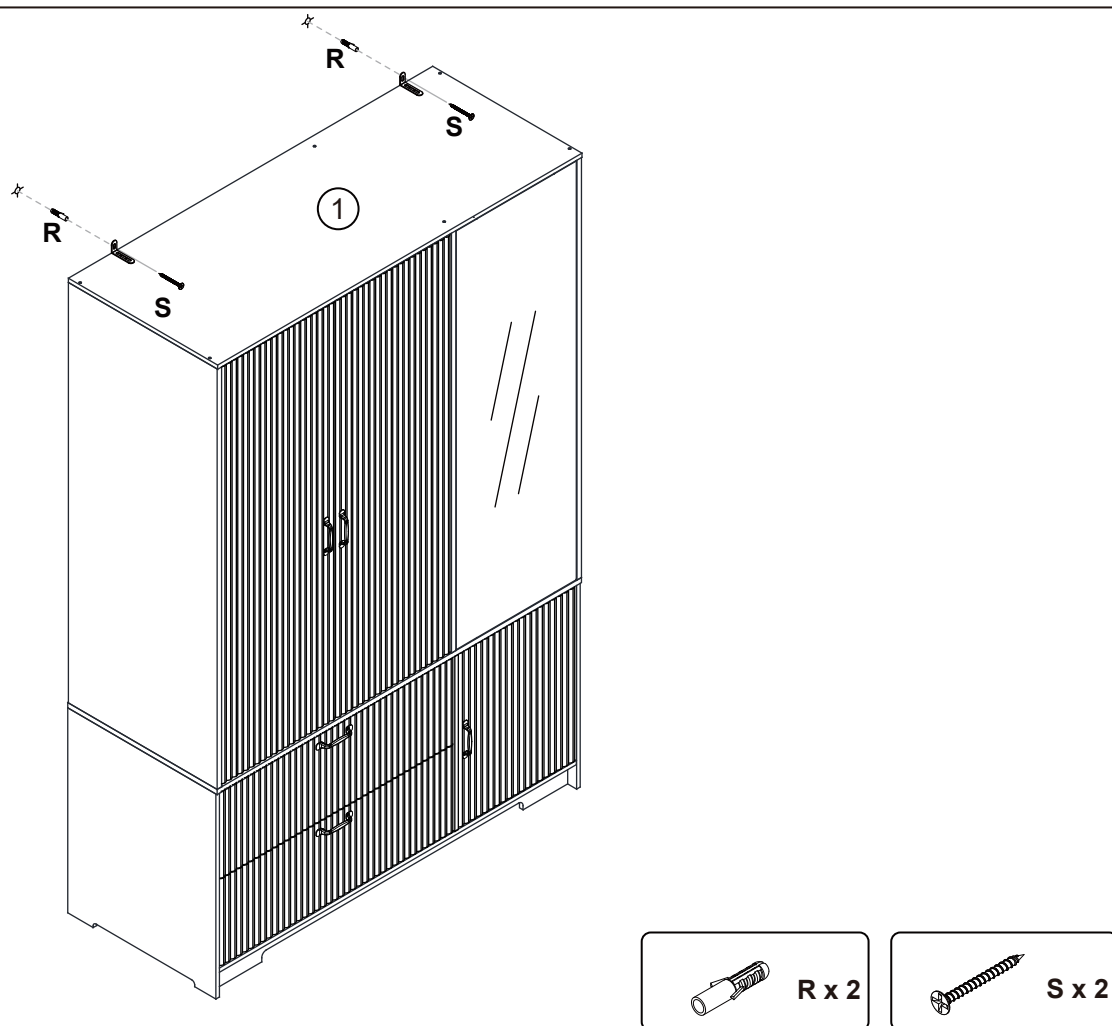

## Step 30



### Customer Attention:

To align doors and control gap in between doors. Product doors may need adjusting during and after assembly. This can be done by adjusting appropriate screws. See below illustration.

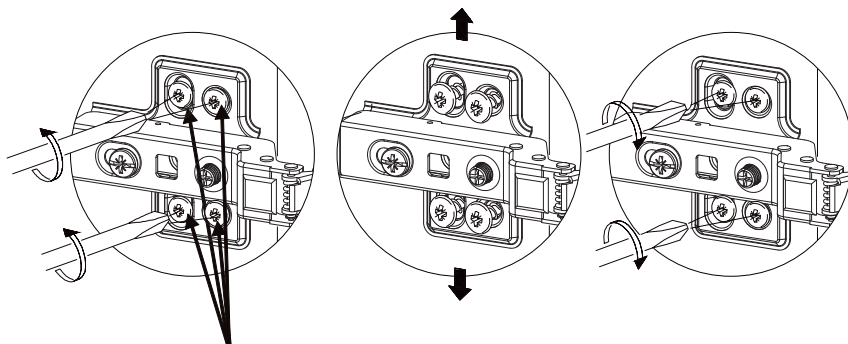
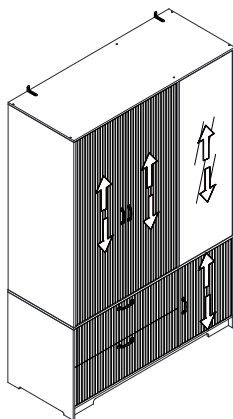

### Vertical Door Adjustment:

Loosen both screws on all hinges and lift the door to the desired height. This allows an even space at the top and bottom between the door and frame.

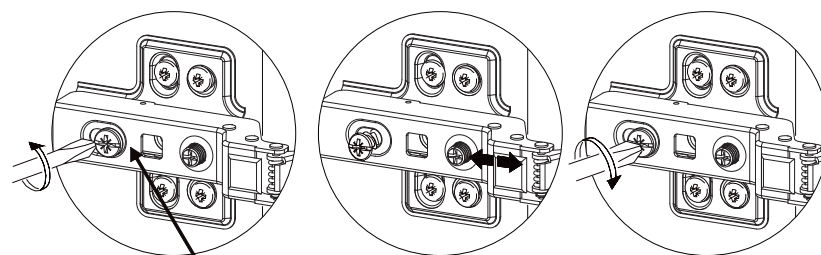
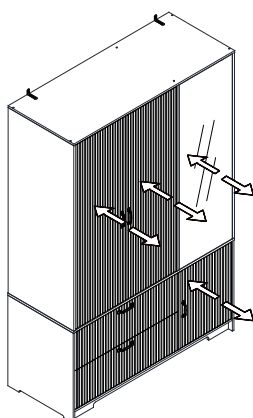

### Lateral Door Adjustment:

If door is hinge bound, (rubbing on frame as you close or open door) loosening screw shown and move the door in appropriate direction. (In or out)

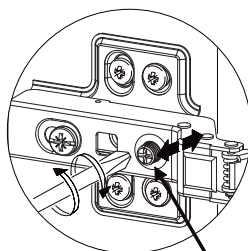
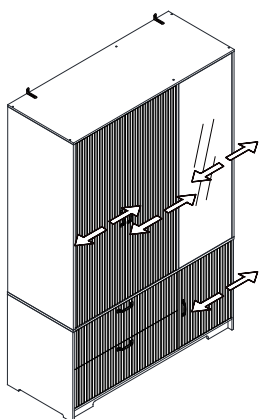

### Horizontal Door Adjustment:

Rotate Screw clockwise or anticlockwise. This will produce an even gap between doors and frame.