

ASSEMBLY INSTRUCTIONS

ITEM NO: 194S1007BEG/BUE/DGY-1

Accent Chair



Legs and hardware are stored in the bottom of the seat, please take them out for assembly.

Note: Do not use power tools for assembly. Power tools increase the risk of over tightening which lead to splitting or cracking the wood.

PART	DRAWING	DESCRIPTION	QTY
A		Seat	1 PC
B		Front Wooden Leg 12"x2"x2"	2 PCS
C		Rear Wooden Leg 11"x2"x1-1/4"	2 PCS

PART	DRAWING	DESCRIPTION	QTY
1		Bolt Ø5/16"x2-3/16"	8 PCS
2		Spring Washer Ø5/16"	8 PCS
3		Flat Washer Ø5/16"x3/4"	8 PCS
4		Allen Key M4	1 PC

STEP 1:

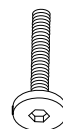
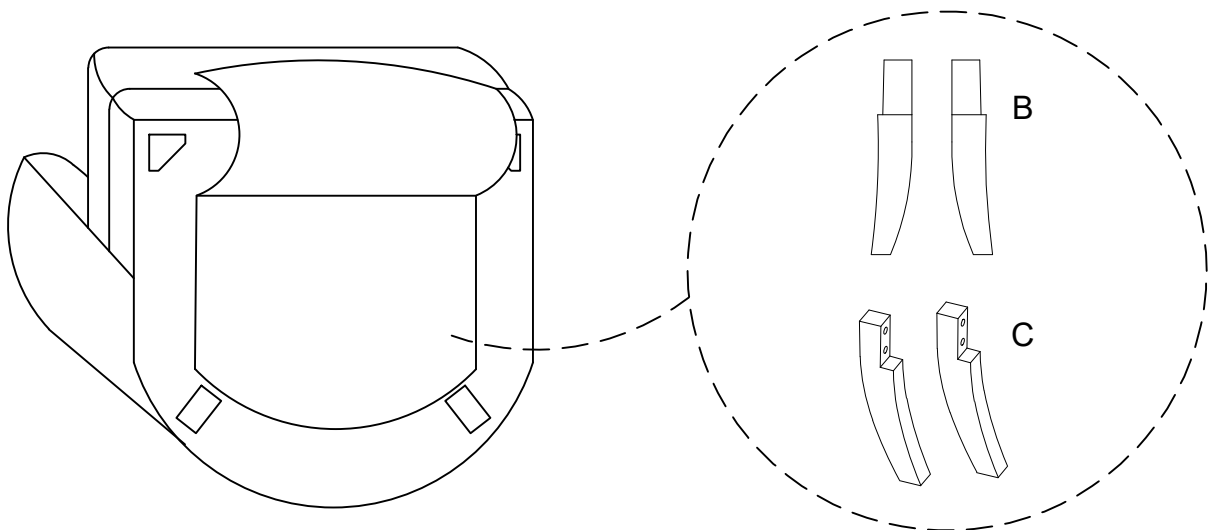

x8



x8



x8

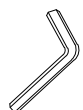

x1

ASSEMBLY INSTRUCTIONS

ITEM NO: 194S1007BEG/BUE/DGY-1

Accent Chair

STEP 2:

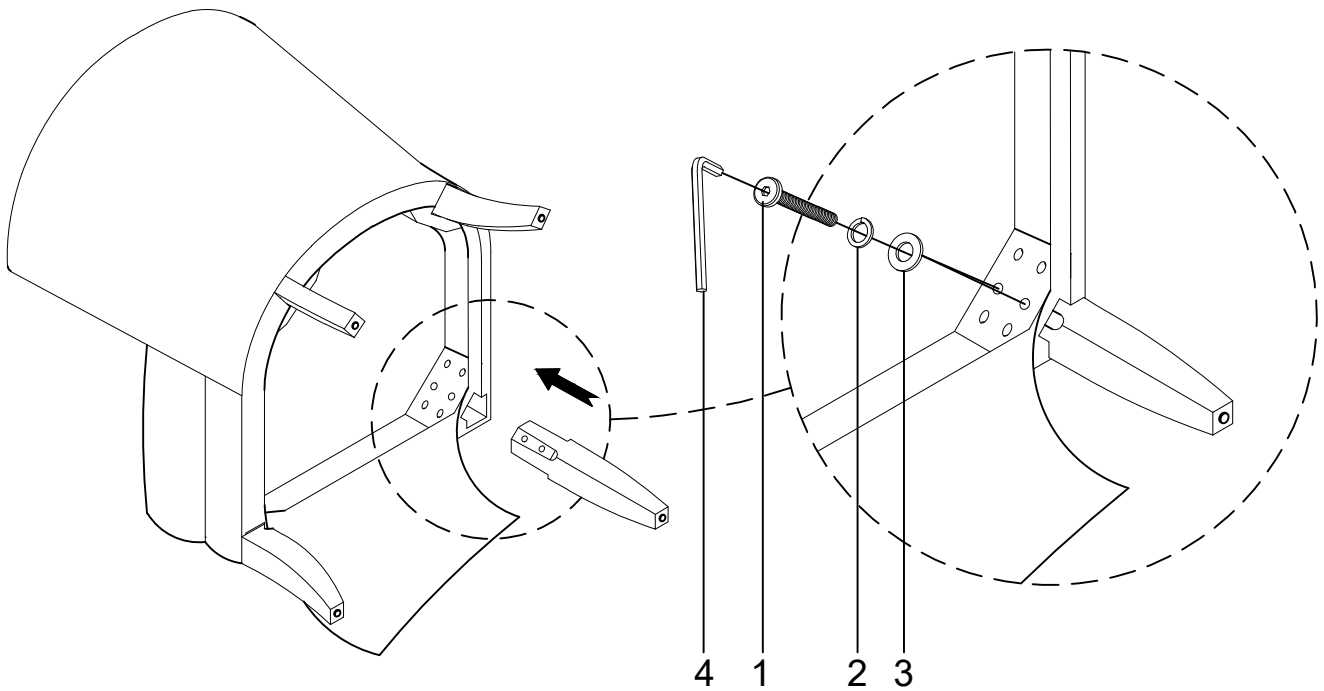
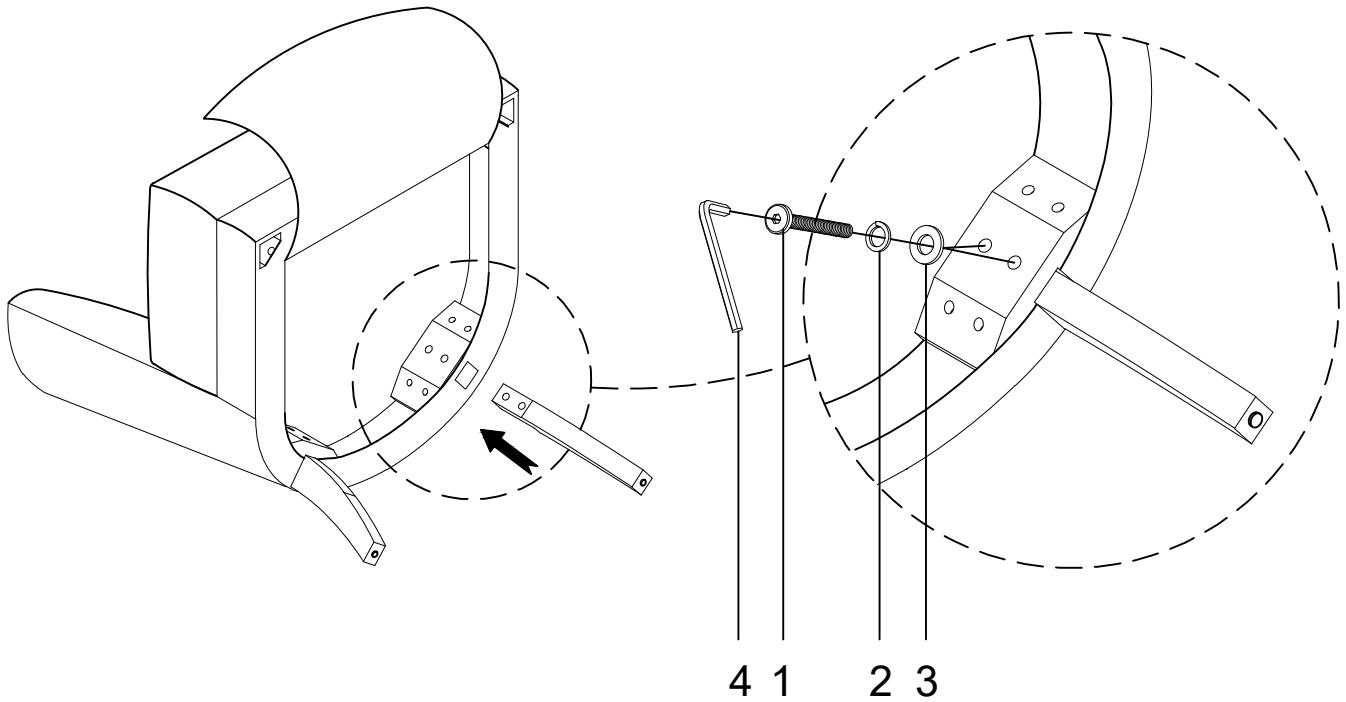

ASSEMBLY INSTRUCTIONS

ITEM NO: 194S1007BEG/BUE/DGY-1

Accent Chair

COMPLETE

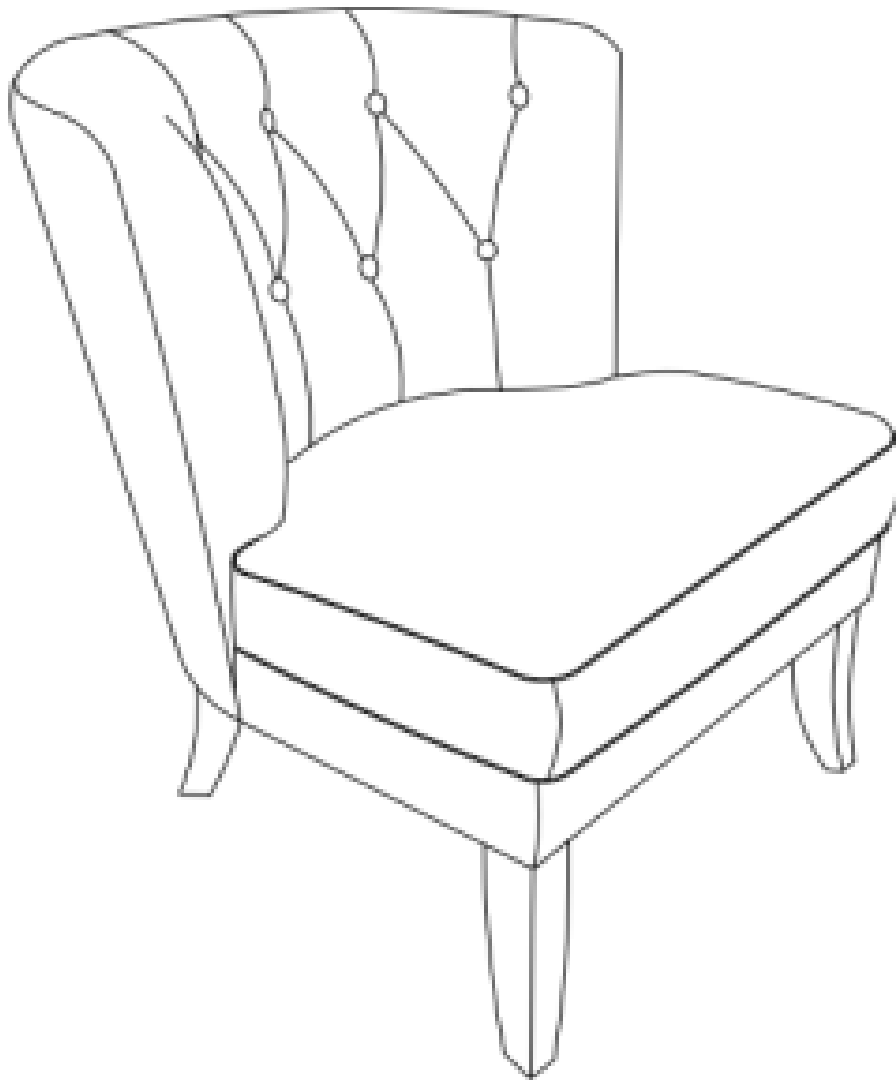

Care Instruction for Textured Furniture:

In order to maintain the original appearance of your textured furniture, please follow below simple care procedures:

- Avoid exposing furniture directly to sunlight or heating and air conditioning outlets.
Sunlight and/or exposure to heating and air conditioning outlets will fade/damage textured furniture.
 - Vacuum or wipe with a soft cloth to remove dust.
 - Hardware may loosen over time. Periodically check to make sure all connections are tight, Re-tighten if necessary
- ⚠ For item use on wooden floor, hard surfaces or carpets, it is recommended to install protective pads under all legs and supports to avoid/prevent from damages/scratches and discoloration.