

# WARNING!!

Children have died from furniture tipover. Tip restraints have been included with this product; you must install the tip restraints according to these instructions in order to minimize the risk of furniture tipping.

**NEVER** allow children to climb or hang on furniture, including drawers or cabinet doors.

In addition to installing the restrains, to help prevent tip-over

1. **NEVER** put a TV or other heavy objects on top of this product".
2. Do not stand on the product

 <b>WARNING</b>	
	<p><b>Children have died from furniture tipover. To reduce the risk of furniture tipover:</b></p> <ul style="list-style-type: none"><li>-ALWAYS install anti-tip device provided.</li><li>-NEVER put a TV on this product.</li><li>-NEVER allow children to stand, climb, or hang on any drawers, doors, or shelves.</li><li>-NEVER open more than one drawer at a time.</li><li>-Place heaviest items in the lowest drawers.</li></ul> <p><i>This is a permanent label. Do not remove!</i></p>
	

# Assembly Instructions

**Caution: You must read these Assembly Instructions before you proceed**

## Care & Maintenance



- Do not put hot items directly on furniture surface.



- Do not clean furniture with harsh cleansers or polish.



- To obtain the longest lifespan of your outdoor product minimizing exposure to direct sunlight is recommended.



- Children should not climb or jump on the furniture.



- Do not write on furniture without a padded barrier to protect the surface.



- To obtain the longest lifespan of your outdoor products, avoid extended and lengthy exposure to rain, snow, and direct sunshine. Whenever possible cover the product and /or place under patio or awnings.



- Not for commercial use. For residential use only.



- Stains may be removed with mild soap solution and damp cloth.



- Dust and pick-up spills using a clean, non-colored, lint-free cloth.

# ASSEMBLY INSTRUCTIONS

Please look in the Table Top for hardware packs.

## CONSOLE TABLE

Item No: N780P347333D / N780P34733N

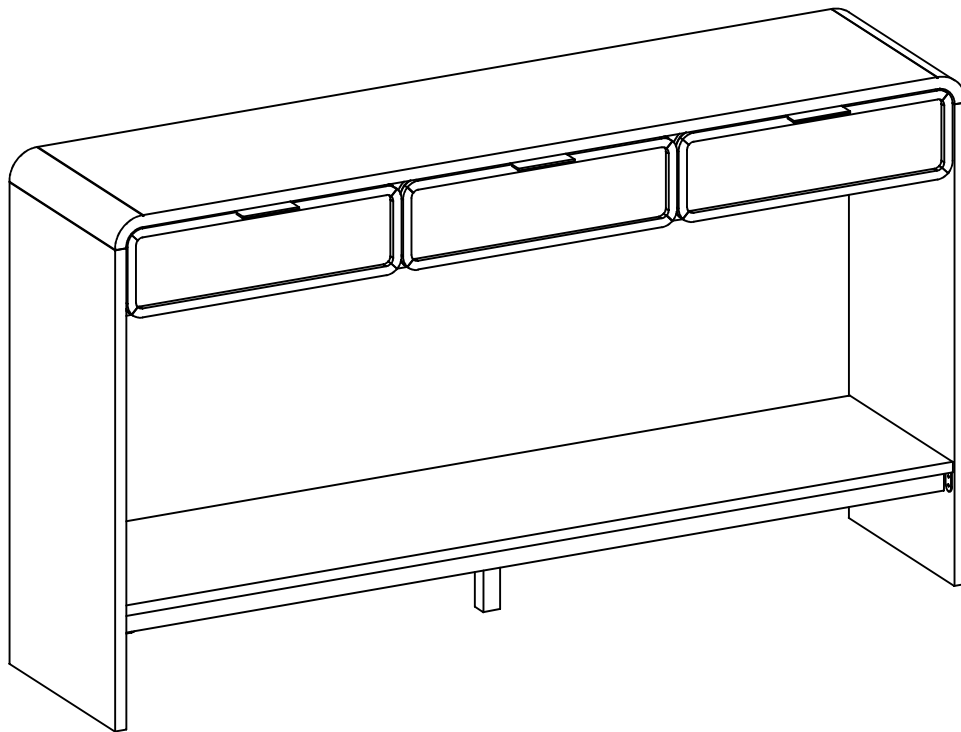

**Caution: This Console Table is NOT a TOY**  
**Keep your child/children at bay during the assembly process.**  
**Whenever lifting or moving the Console Table and to prevent damage to the ConsoleTable, two adults may be needed to execute these action.**

# ASSEMBLY INSTRUCTIONS

## Console Table

Item No: N780P347333D / N780P34733N

### Part List

**A**

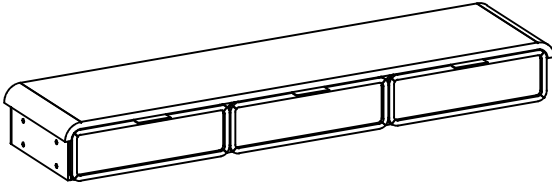
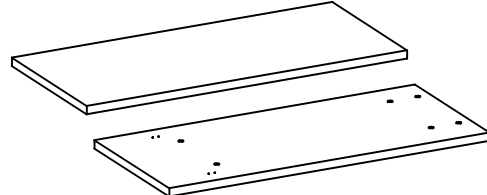

Table Top = 1pc

**B**



Side Panel = 2pcs

**C**

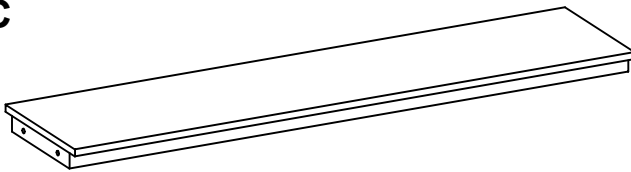

Shelf Frame = 1pc

**D**

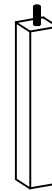

Support Leg = 1pc

### Hardware List

**1**

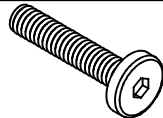

Bolt 6.3 x 35mm = 4pcs + Extra 1 pc

**2**

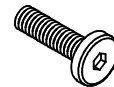

Bolt 6.3 x 20mm = 8pcs + Extra 1 pc

**3**



Lock Washer  
Ø7.8 x 13mm = 12pcs + Extra 1 pc

**4**



Flat Washer  
Ø7.8 x 16 x 2mm = 12pcs + Extra 1 pc

**5**



Allen Wrench = 1pc

**6**

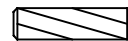

Wooden Dowel  
Ø8 x 25mm = 8pcs + Extra 1 pc

**7**

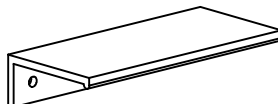

Handle = 3pcs

**8**



Short Screw  
Ø3.5 x 15mm = 14pcs + Extra 1 pc

**9**



Metal Strap = 2pcs

**9.1**



Short Screw = 2pcs

**9.2**



Long Screw = 2pcs

**9.3**



Patch L = 4pcs

**9.4**



Anchor = 2pcs

⑩ Metal Strap  
Qty 1pc

# Assembly Preparation Before Beginning Assembly:

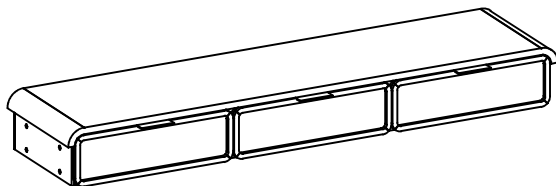
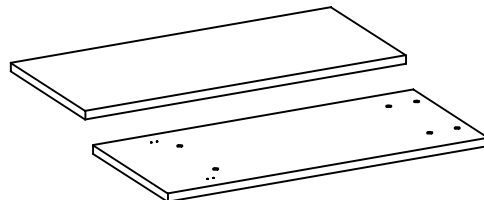
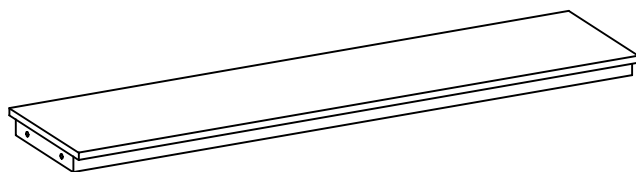

Table Top = 1pc



Side Panel = 2pcs



Shelf Frame = 1pc

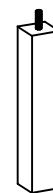

Support Leg = 1pc

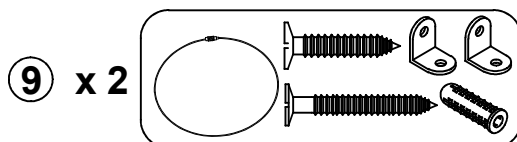
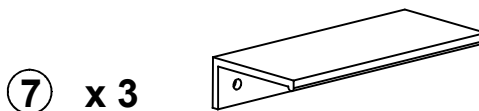
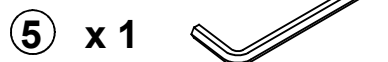



- Read instructions, cover to cover-



- Have 2 adults on hand for assembly-



- Do not assemble on flooring or carpet-



- Assemble on a clean non-marring surface (packing foam)-



- Save all packaging until finished-

## Assembly Steps

### Overview

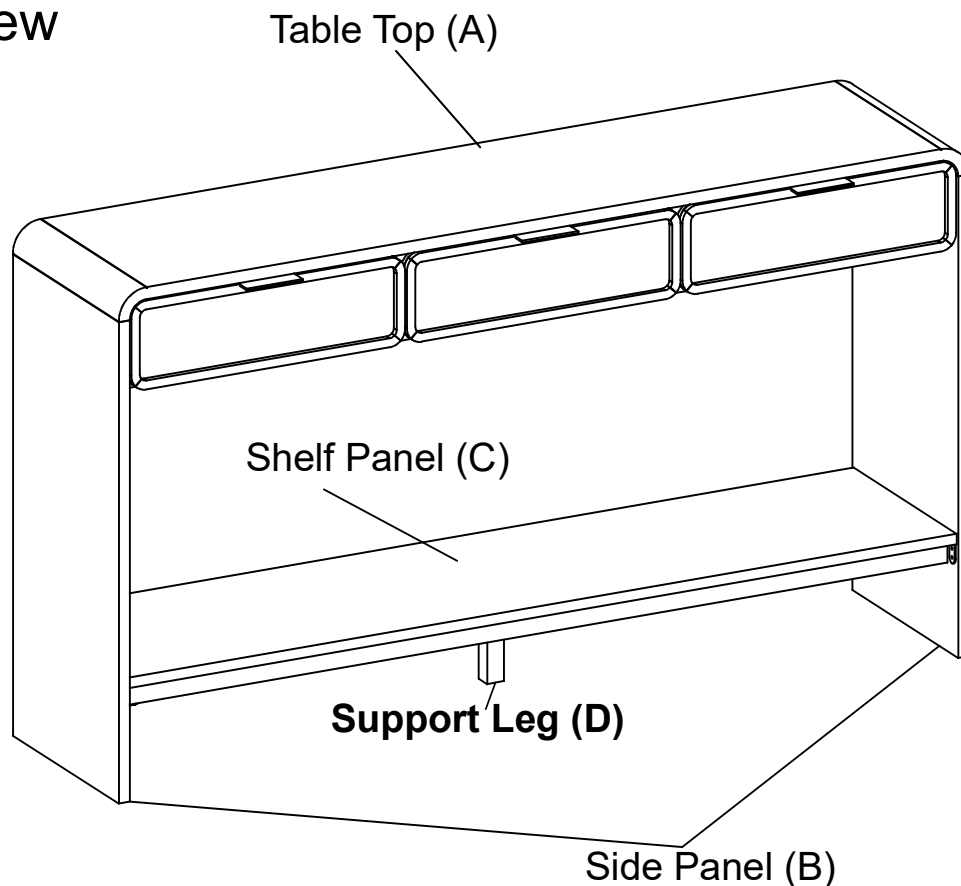

This Console Table has multiple parts and may require up to some 30 minutes to assemble. To give you an overview of the Console Table parts, the above picture is to help you put the various part into perspective. Please read through the instruction below to familiarise yourself the part and steps before assembly.

# ASSEMBLY INSTRUCTIONS

## Console Table

Item No: N780P347333D / N780P34733N

### Step 1

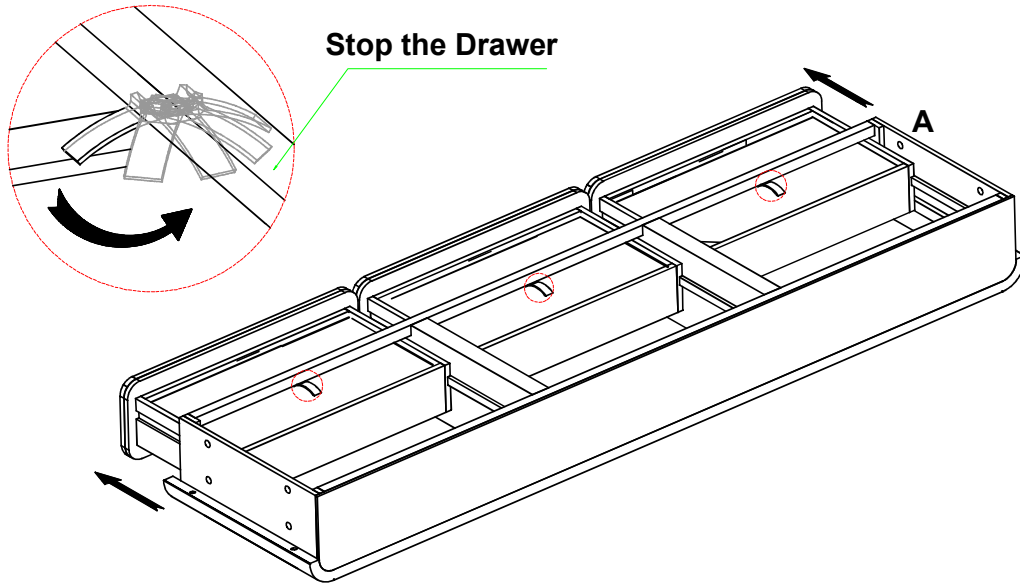

Place the table top (A) on a carpeted surface and take out the drawer as shown in the picture

### Step 2

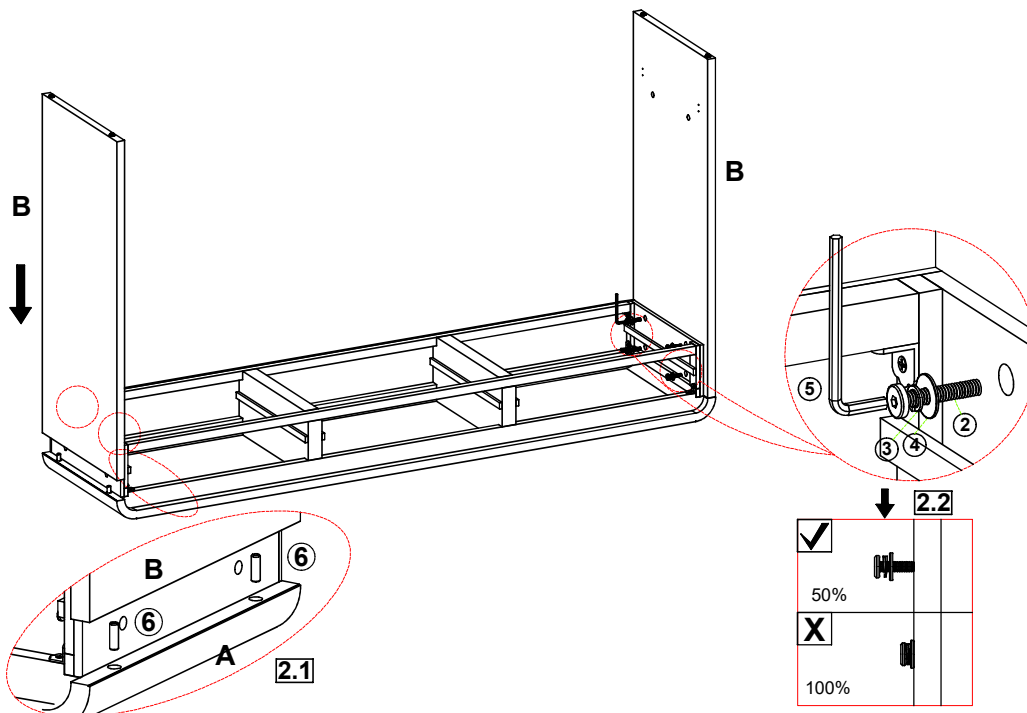

Place the Table top on a carpeted surface.

Attach Side Panel (B) to the Table top (A) using Wooden Dowel (6) Bolt (2) and Lock Washer (3) and Flat Washer (4) with Allen Wrench (5) as shown in the picture.

**Do not fully tighten the Bolts**

# ASSEMBLY INSTRUCTIONS

## Console Table

Item No: N780P347333D / N780P34733N

### Step 3

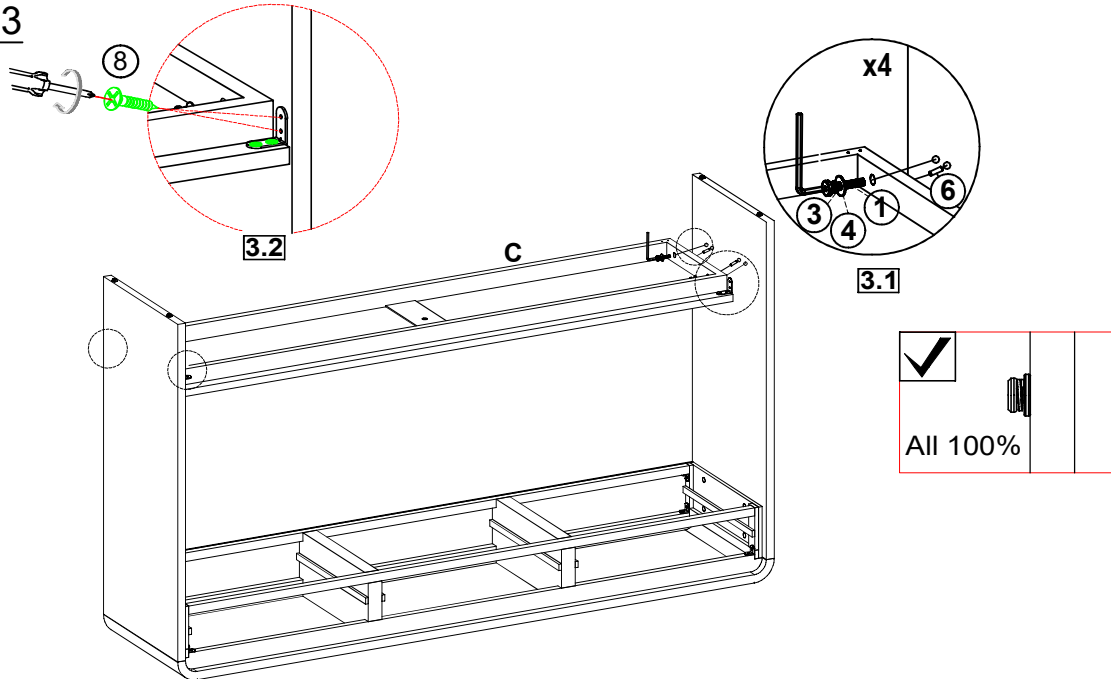

Place the Table top and side panle on a carpeted surface.

Attach the Shelf Frame (C) to the Table top (A) and Side panel (B) using Short Screw (8) Botl (1) and Lock Washer (3) and Flat Washer (4) with Allen Wrench (5) , Wooden Dowel (6) as shown in the picture.

**FULLY TIGHTEN ALL THE BOLTS**

### Step 4

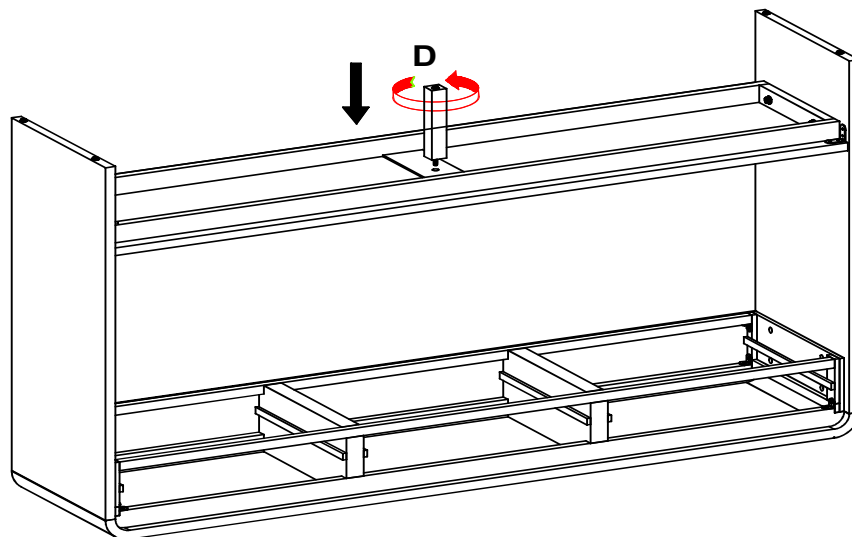

Place the Table on a carpeted surface.

Attach the Support Leg (D) to the shelf Frame (C) as shown in the picture.

**FULLY TIGHTEN ALL THE BOLTS**



# ASSEMBLY INSTRUCTIONS

## Console Table

Item No: N780P347333D / N780P34733N

### Step 5 x 3

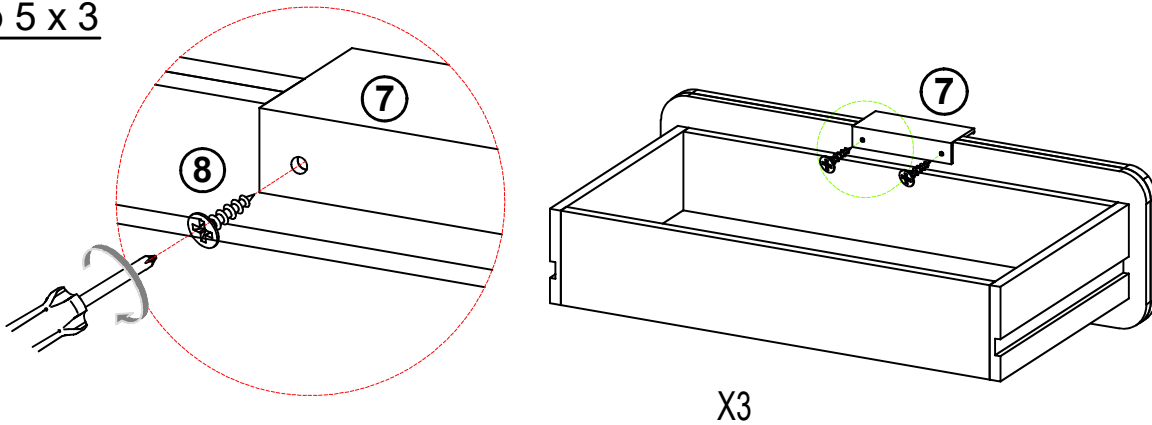

Place the Drawers on a carpeted surface.  
Attach the Handle (7) to the Drawers using Short Screw (8)  
as shown in the picture.

### Step 6

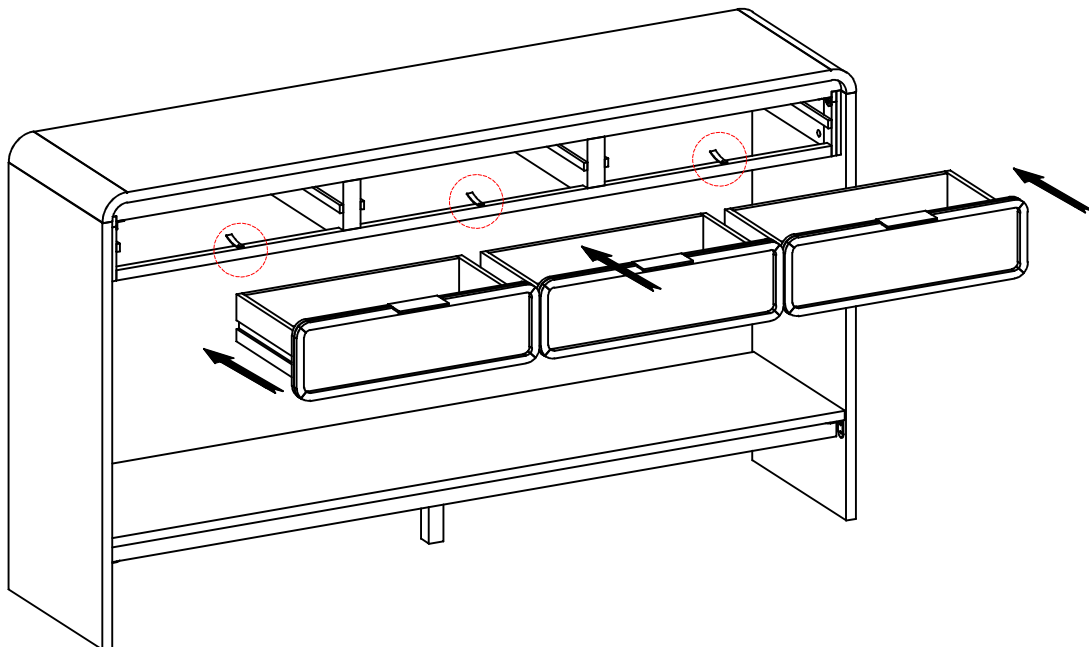

Put the drawer back in the drawer  
as shown in the picture.

# ASSEMBLY INSTRUCTIONS

## Console Table

Item No: N780P347333D / N780P34733N

### Step 7

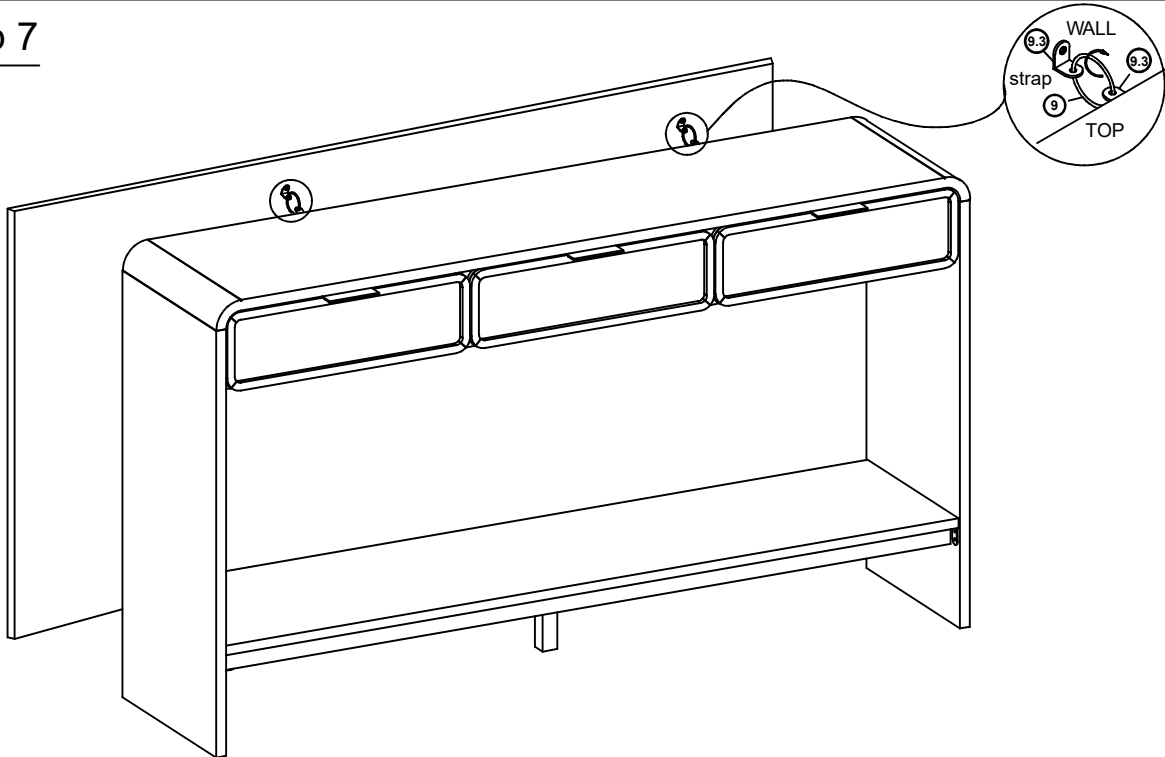

Part Enclosed/Material Fourni/Partes incluidas Installation Instructions  
The tip restraint must be attached to a wall stud using the 2" screw enclosed

### Step 8

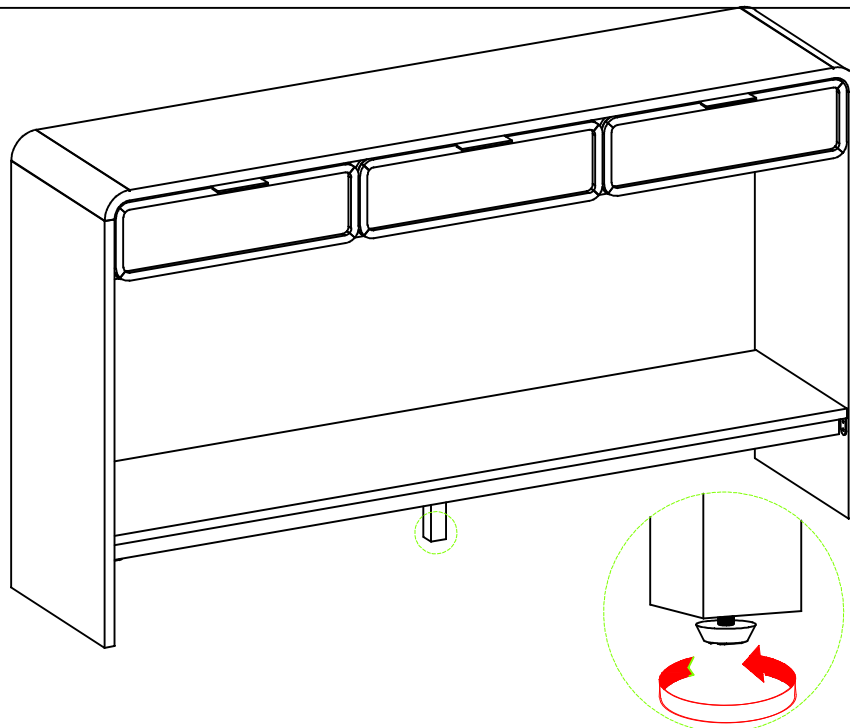

Adjustable floor leveler

## ”Questions & Answers about Proposition 65

- What is Proposition 65?

Proposition 65 requires businesses to provide warnings to Californians about significant exposures to chemicals that cause cancer, birth defects or other reproductive harm. These chemicals can be in the products that Californians purchase, in their homes or workplaces, or that are released into the environment. By requiring that this information be provided, Proposition 65 enables Californians to make informed decisions about their exposures to these chemicals.

Proposition 65 also prohibits California businesses from knowingly discharging significant amounts of listed chemicals into sources of drinking water.

Proposition 65 requires California to publish a list of chemicals known to cause cancer, birth defects or other reproductive harm. This list, which must be updated at least once a year, has grown to include approximately 900 chemicals since it was first published in 1987.

- What types of chemicals are on the Proposition 65 list?

The list contains a wide range of naturally occurring and synthetic chemicals that include additives or ingredients in pesticides, common household products, food, drugs, dyes, or solvents. Listed chemicals may also be used in manufacturing and construction, or they may be byproducts of chemical processes, such as motor vehicle exhaust. ”