



ASSEMBLY INSTRUCTIONS

COASTER FINE FURNITURE



Fine Furniture for every stage of life

115391
Dining Table

ITEM: **115391**



ASSEMBLY INSTRUCTIONS

ASSEMBLY TIPS:

1. Remove hardware from box and sort by size.
2. Please check to see that all hardware and parts are present prior to start of assembly.
3. Please follow attached instructions in the same sequence as numbered to assure fast & easy assembly.



WARNING!

1. Don't attempt to repair or modify parts that are broken or defective. Please contact the store immediately.
2. This product is for home use only and not intended for commercial establishments.



ASSEMBLY TIME

10 MINUTES

PARTS IDENTIFICATION

A TOP

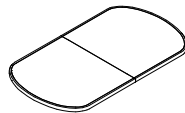

1PC

B LEAF



1PC

C LEG



2PCS

D BASE

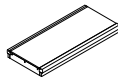

1PC

E UPPER MOUNTING PLATE

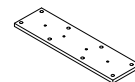

2PCS

F LOWER MOUNTING PLATE

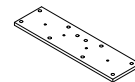

2PCS

G CROSSBAR

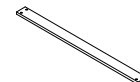

1PC

HARDWARE IDENTIFICATION

1 SHORT BOLT
(1/4" x 32mm - BLK)



12PCS

2 MEDIUM BOLT
(5/16" x 40mm - BLK)



22PCS

3 LONG BOLT
(5/16" x 50mm - BLK)

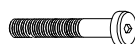

8PCS

4 BIG LOCK WASHER
(5/16" - BLK)



30PCS

5 BIG FLAT WASHER
(5/16" x 19 x 1.5mm - BLK)



30PCS

6 ALLEN WRENCH
(74 x 30 x 4mm - BLK)



1PC

7 SMALL LOCK WASHER
(1/4" - BLK)



12PCS

8 SMALL FLAT WASHER
(1/4" x 19 x 1.5mm - BLK)



12PCS

ITEM: **115391**
ASSEMBLY INSTRUCTIONS

STEP 1

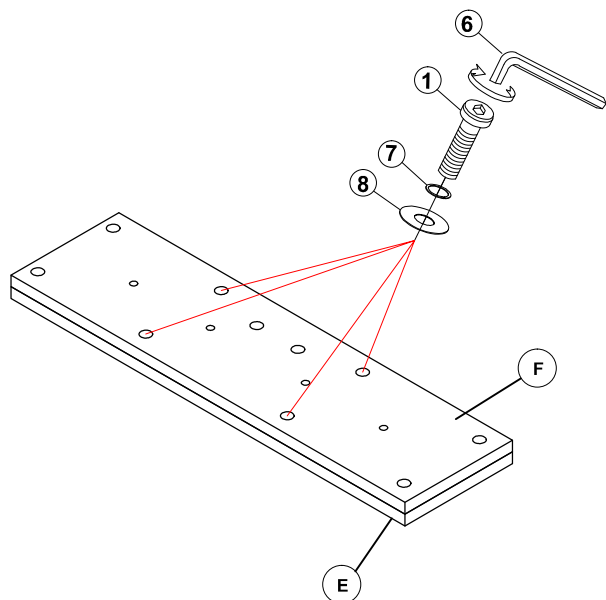

STEP 2

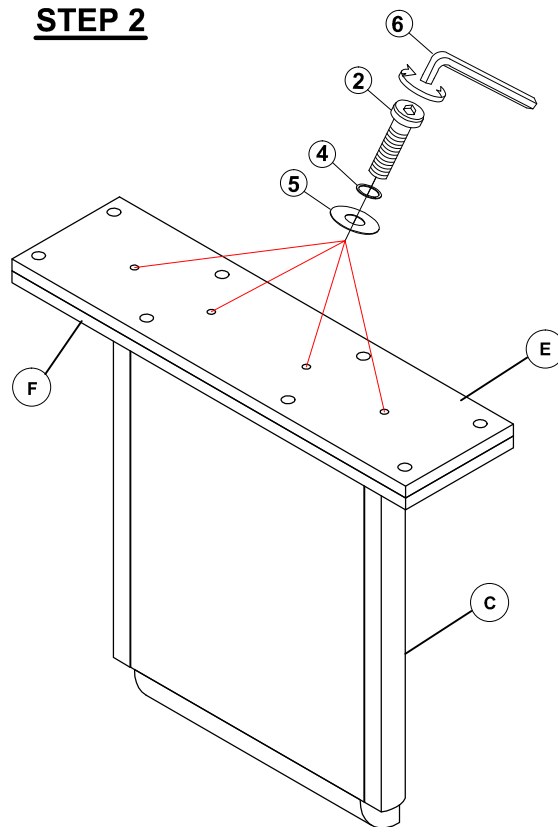

STEP 3

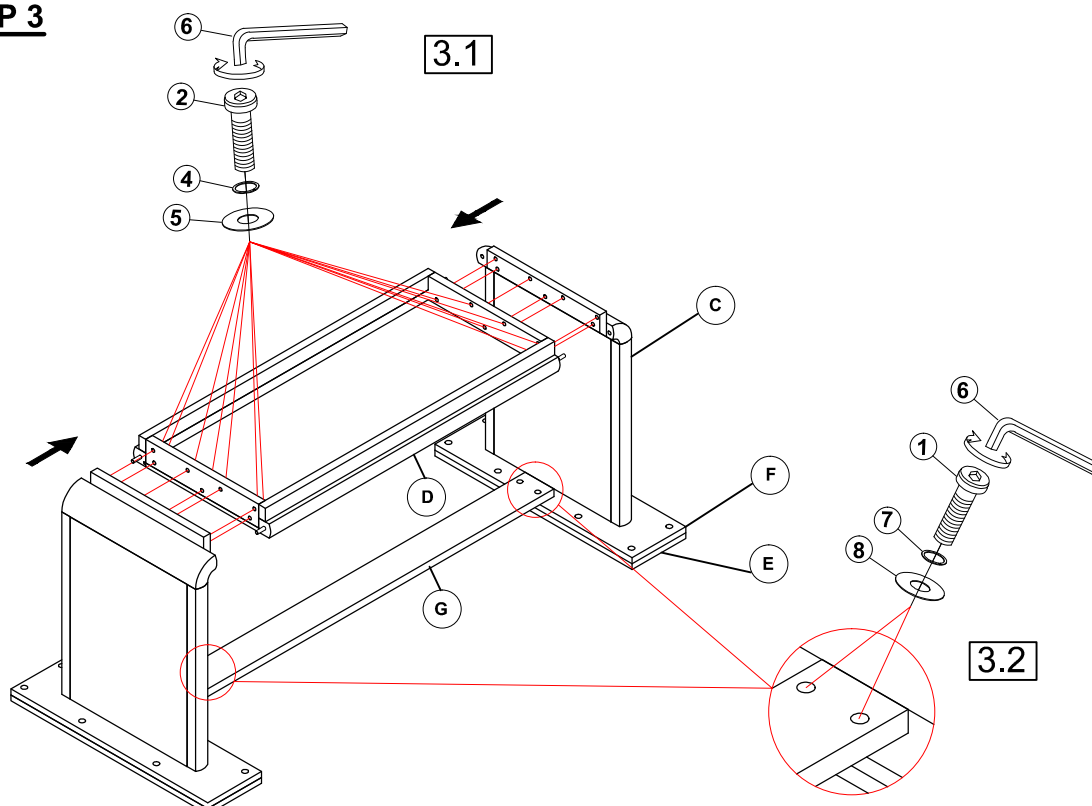

ITEM: **115391**
ASSEMBLY INSTRUCTIONS



STEP 4

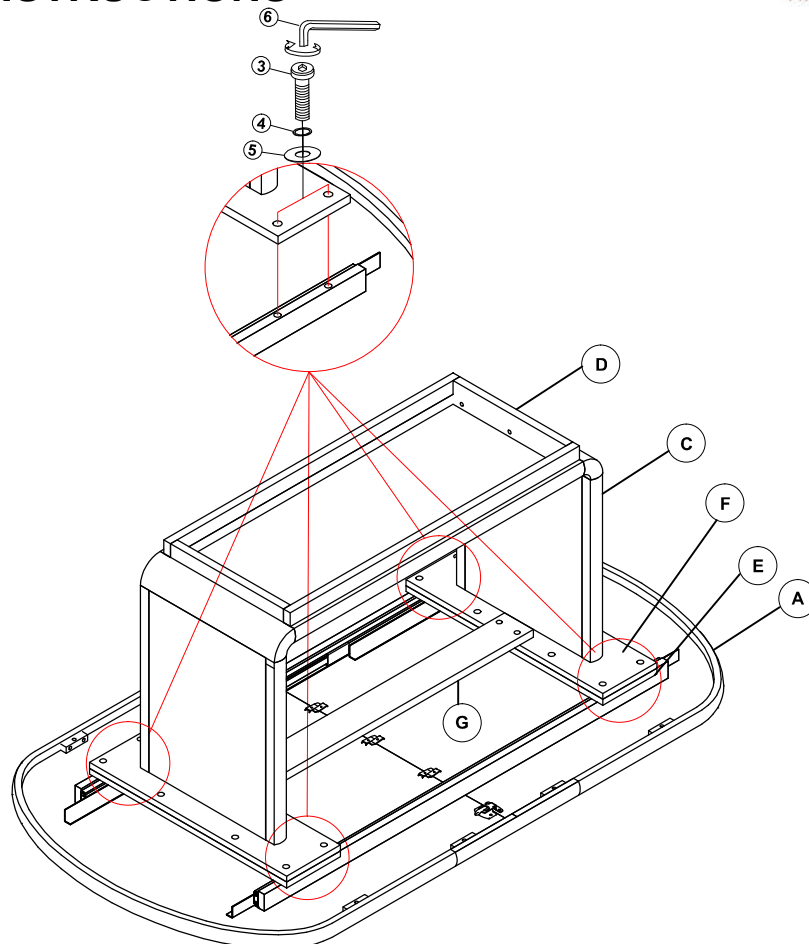

STEP 5
COMPLETE

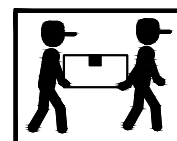
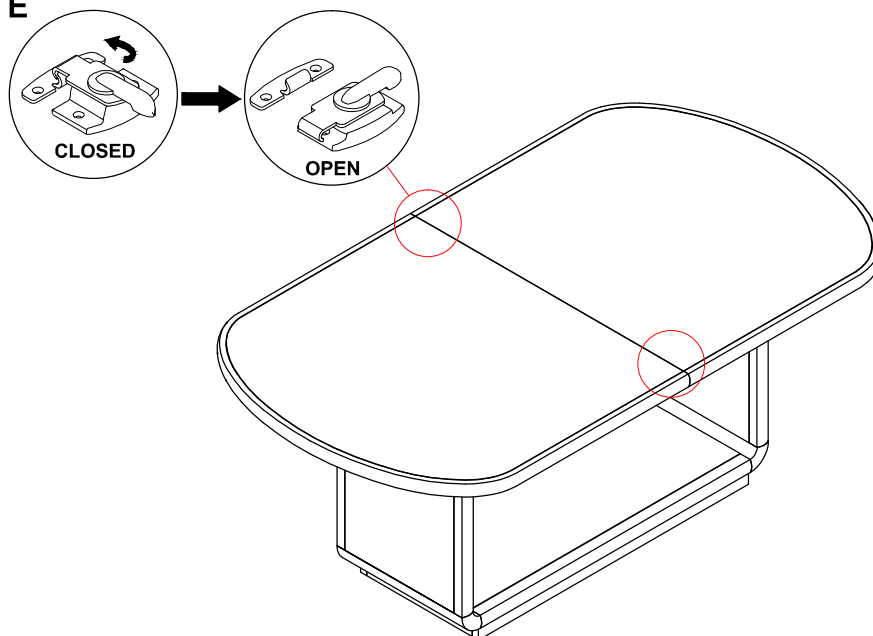

ITEM: **115391**
ASSEMBLY INSTRUCTIONS



STEP 6

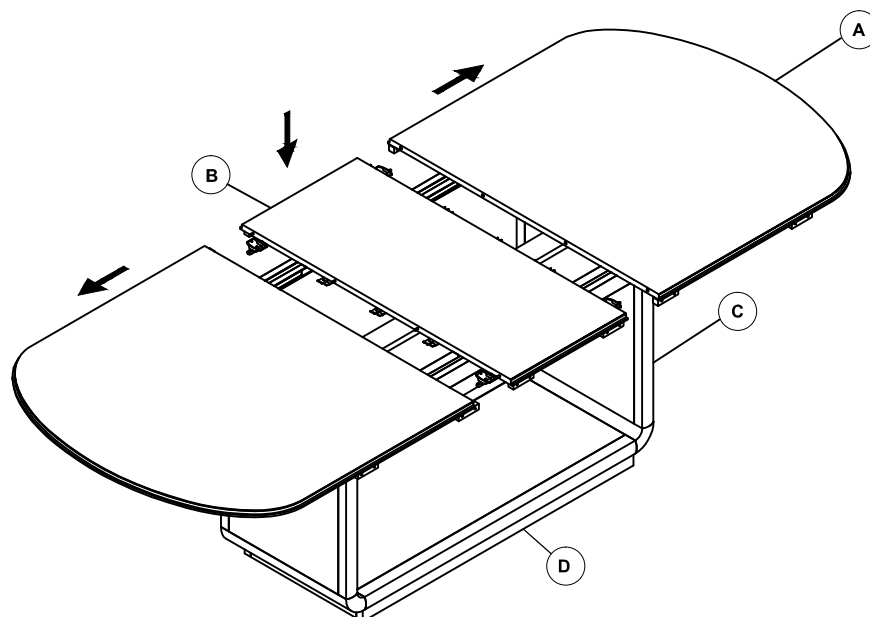

STEP 7

COMPLETE

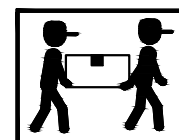
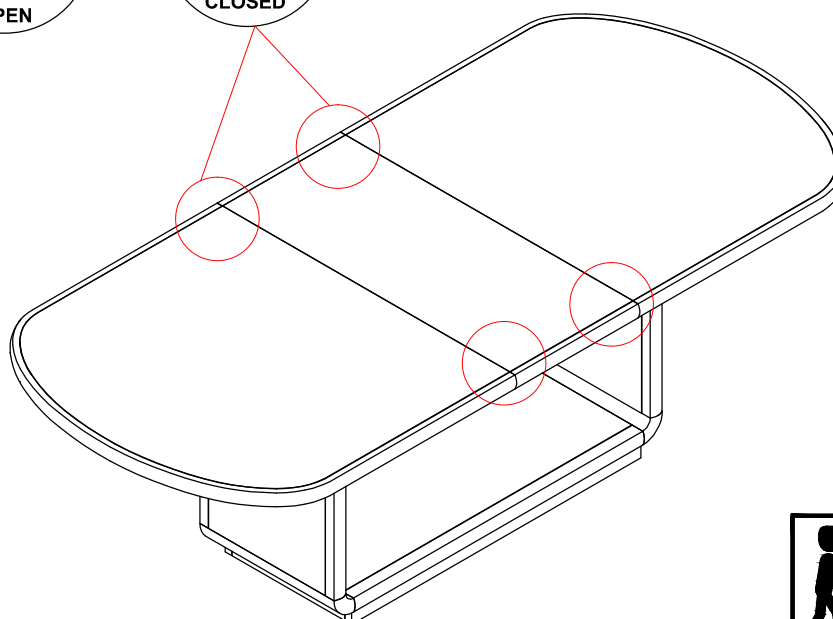
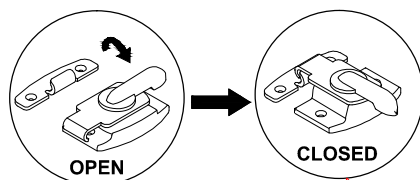

ITEM: **115391**

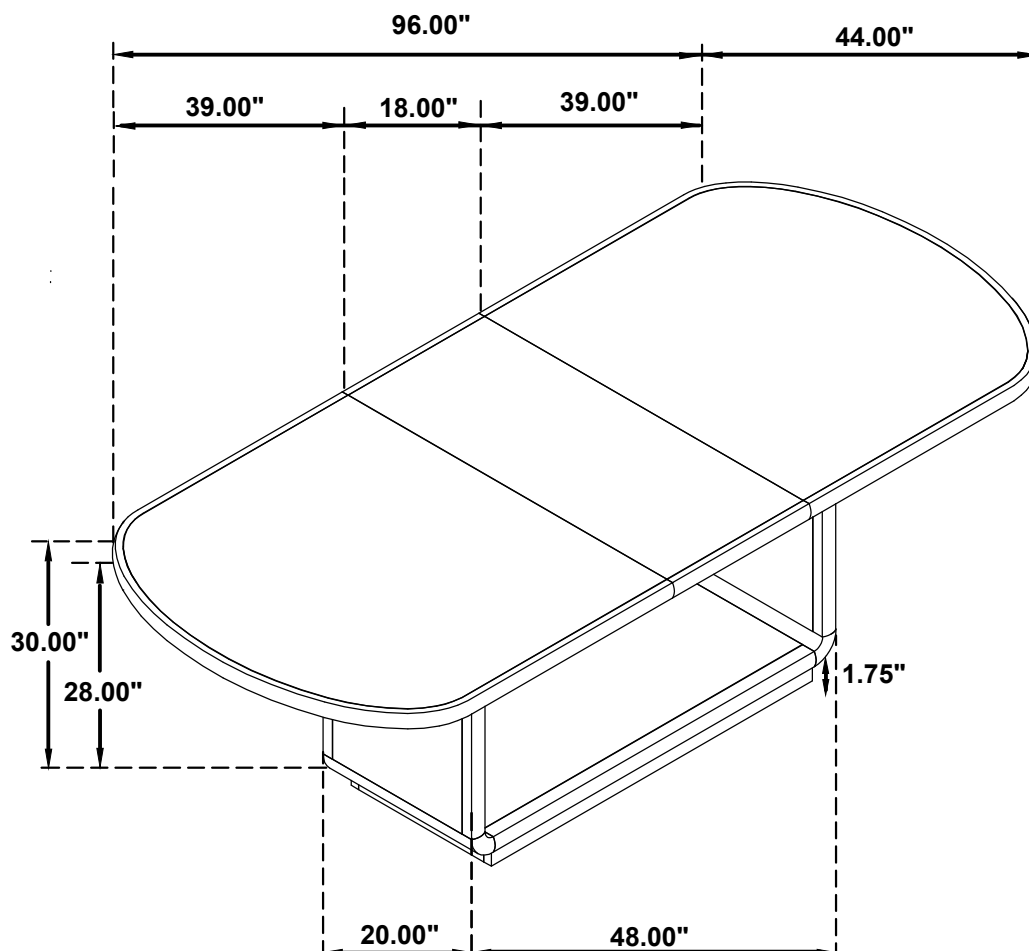

Note: Dimension tolerance $\pm 5\%$