



ASSEMBLY INSTRUCTIONS

COASTER FINE FURNITURE



Fine Furniture for every stage of life

115390
Dining Table

ITEM: **115390**



ASSEMBLY INSTRUCTIONS

ASSEMBLY TIPS:

1. Remove hardware from box and sort by size.
2. Please check to see that all hardware and parts are present prior to start of assembly.
3. Please follow attached instructions in the same sequence as numbered to assure fast & easy assembly.



WARNING!

1. Don't attempt to repair or modify parts that are broken or defective. Please contact the store immediately.
2. This product is for home use only and not intended for commercial establishments.



ASSEMBLY TIME

10 MINUTES

PARTS IDENTIFICATION

A TOP



1PC

B BASE

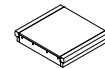

1PC

B LEG FRAME



2PCS

D MOUNTING PLATE

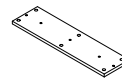

2PCS

HARDWARE IDENTIFICATION

1 BOLT

(5/16" x 35mm - BLK)



30PCS

3

FLAT WASHER

(5/16" x 19 x 1.5mm - BLK)



30PCS

2 LOCK WASHER

(5/16" - BLK)



30PCS

4

ALLEN WRENCH

(74 x 30 x 4mm - BLK)



1PC

ITEM: **115390**
ASSEMBLY INSTRUCTIONS



STEP 1

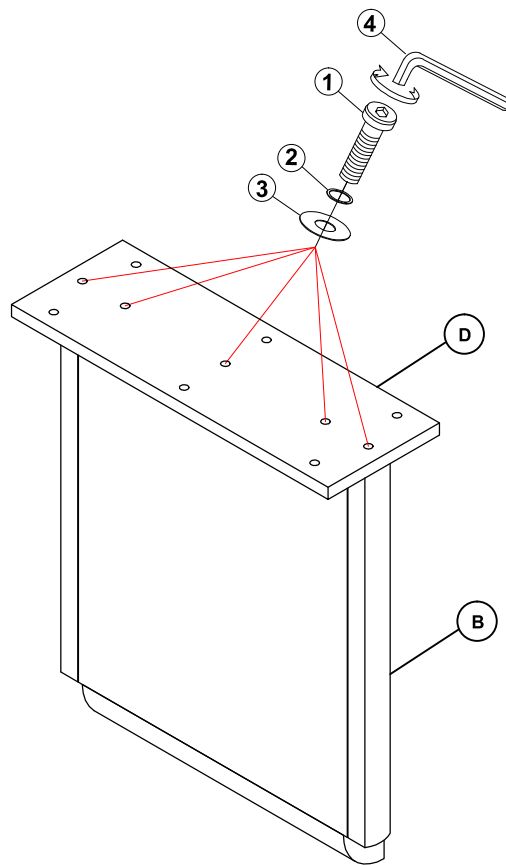

STEP 2

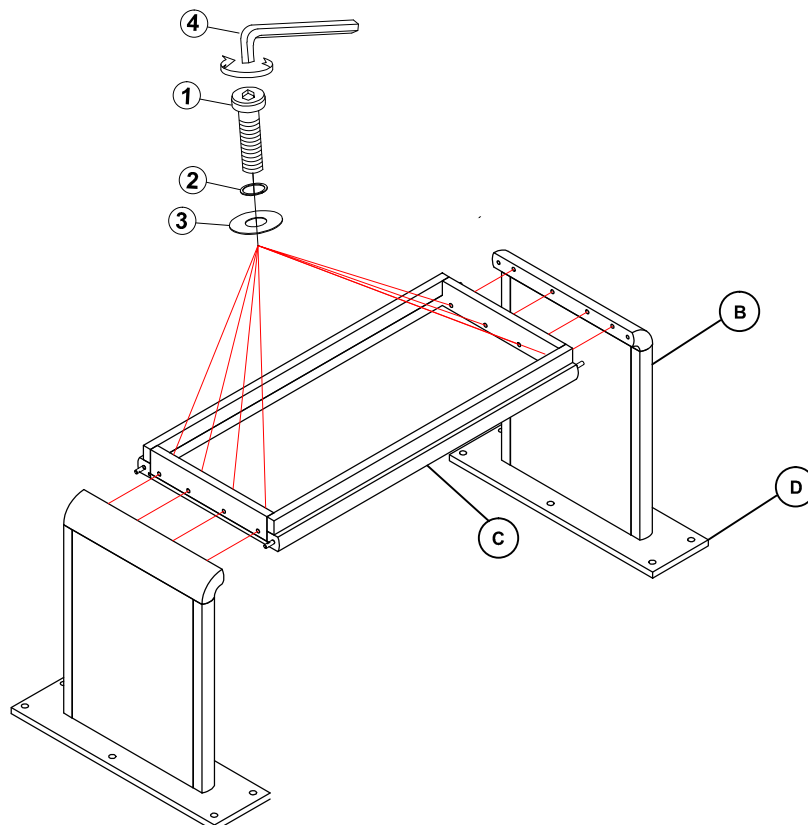

ITEM: **115390**
ASSEMBLY INSTRUCTIONS



STEP 3

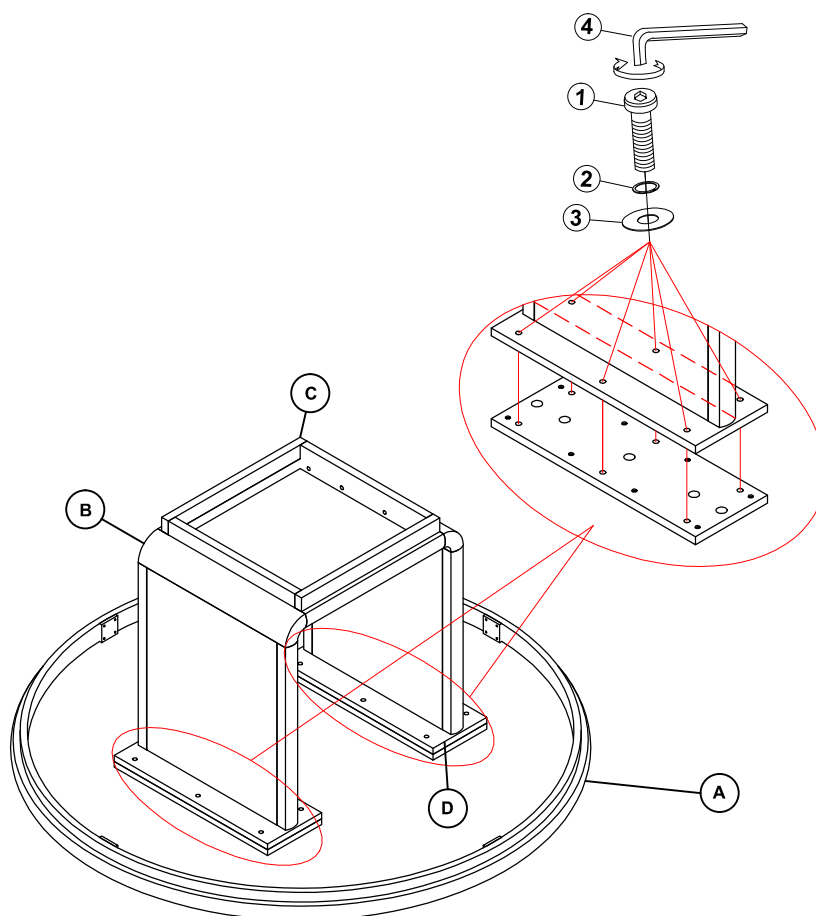

STEP 4
COMPLETE

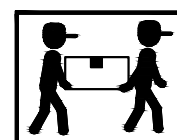
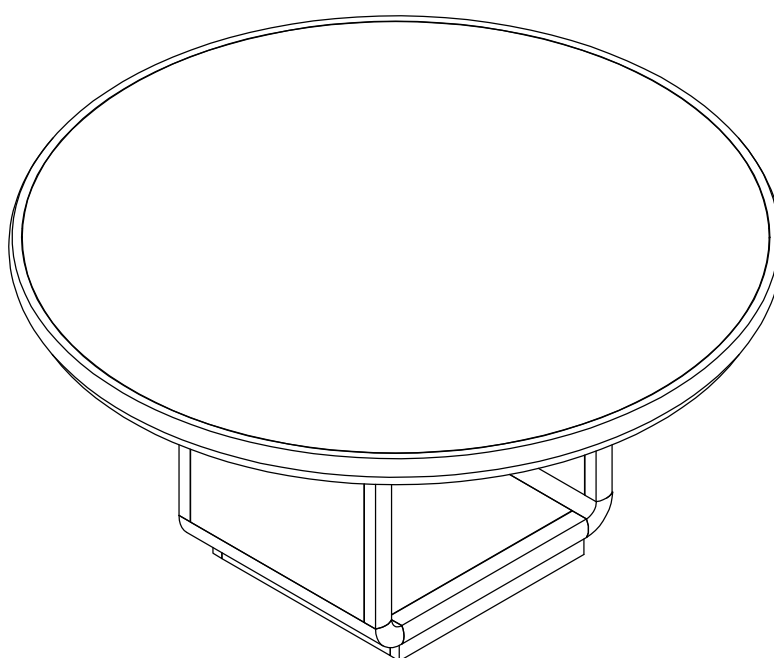

ITEM: **115390**

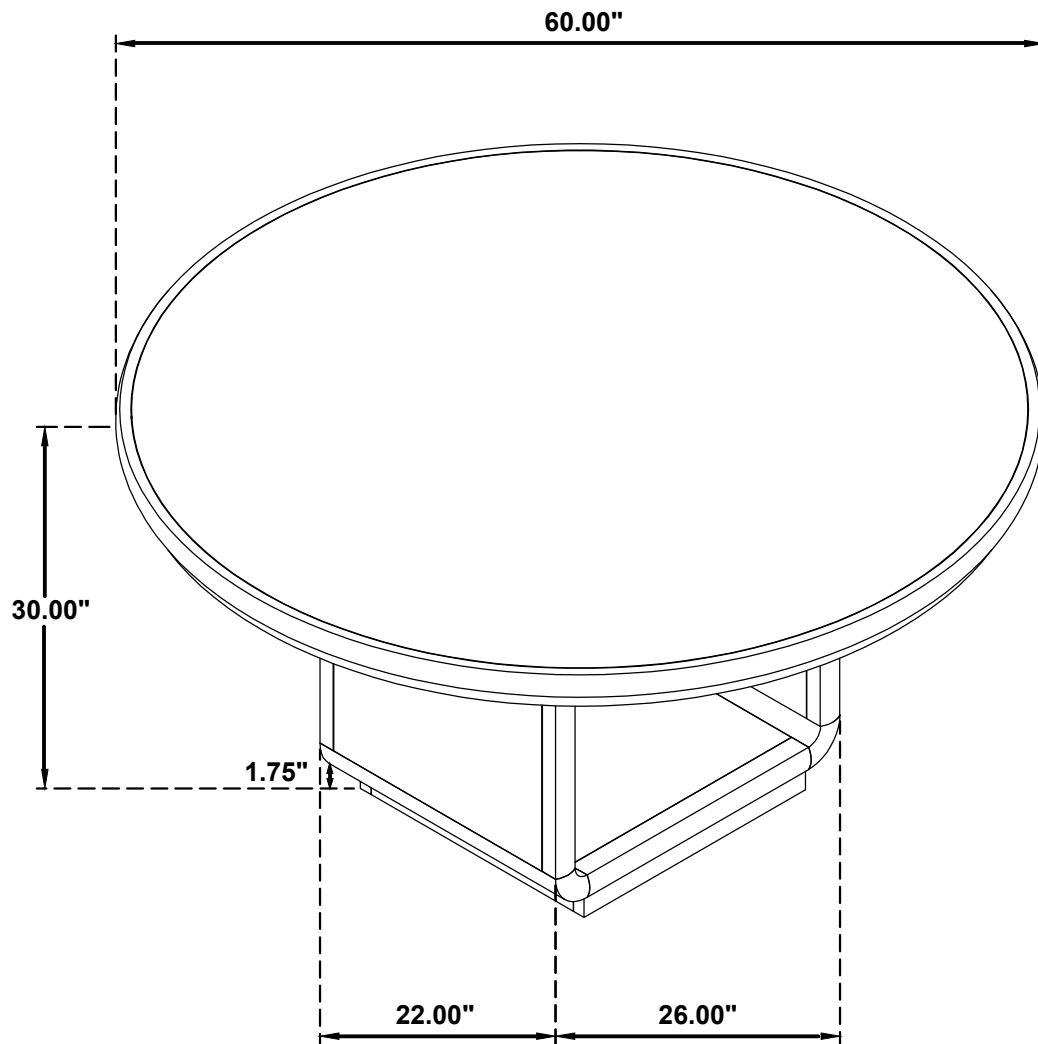

Note: Dimension tolerance $\pm 5\%$