

## Ceramic Bedside Lamps Set of 2

### User Manual

#### Introduction

Thank you for choosing our 3-color-temperature bedside lamps. Please read this user manual carefully before using and keep it for future reference.

If you need any assistance, please feel free to contact us via Email: [amazon\\_vip\\_service@163.com](mailto:amazon_vip_service@163.com)

#### Package Contents

1\*User Manual    2\* Led Bulbs  
2\*Table Lamps    2\*top finials  
2\* harps

#### Specifications

Material	Fabric Shade + Ceramic Base
Number of Lamps	2
Switch Style	Rotary Switch
Voltage	110-120V
Features	3-color Temperature
Bulb Base Type	E26 Base (Max. 100W)
Included Components	2 Led Bulbs Included
Color Temperature	2700K-4000K-5000K

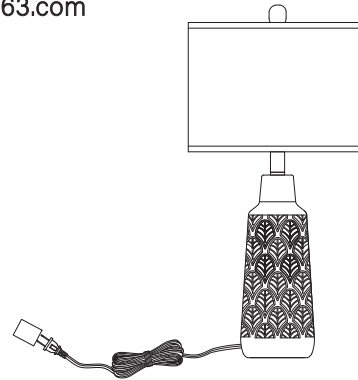

#### Easy Installation

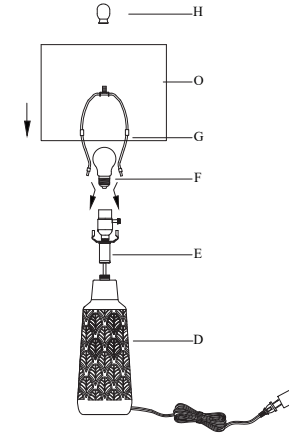
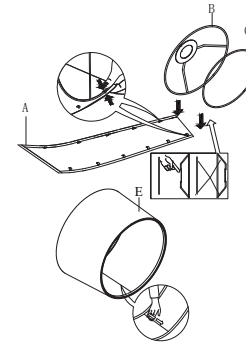

1. Put the bulb on the E26 socket and screw it.
2. Insert the harp on both sides of the socket.
3. Put the lampshade on the lamp holder. (PS: as shown in the right corner, the whole lampshade needs to be assembled with iron fixing ring first.)
4. Screw the top finial on the harp top. Next you can connect the power supply and turn on your beautiful lamp.

#### Warranty

This 3-color Temperature Table Lamp is warranted to be free from defects in material and operation for one year.

In the unlikely event that it is found to be defective within this period time, please contact us for a solution. Note that accidental or intentional damage is not included in the warranty coverage.

For questions:

Please contact us on [amazon\\_vip\\_service@163.com](mailto:amazon_vip_service@163.com)  
Or Facebook <https://www.facebook.com/hilary.cox.98>