

Antler Table Lamp

User Manual

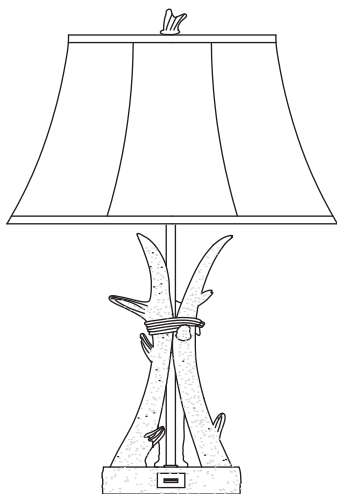
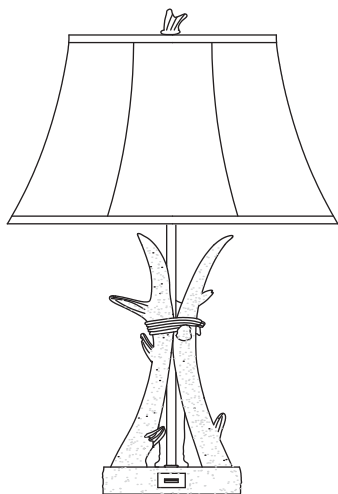

Antler Table Lamp

Introduction

THANK YOU for purchasing our table lamp. For a better using experience, please install and use the lamp according to following instructions.

Package Contents

2 x Table Lamp	2 x Lamp Shade
2 x A19 Blubs	1 x User Manual

Specification

Material	Resin+Fabric
Voltage	110V-120V
Base Type	E26
Switch Type	Touch control Manual
USB Charging Ports	Two
Style	Western/Country Cottage
Dimmable	3 Way Dimmable

Antler Table Lamp

Easy Installation

1. Unpack all parts from cartons carefully.
2. Install the KD shade with bracket.
3. Squeeze harp together and insert into saddle.
4. Install bulb onto the lampholder.
5. Place the shade onto harp and tighten finial.

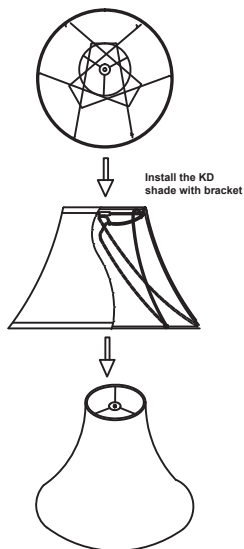
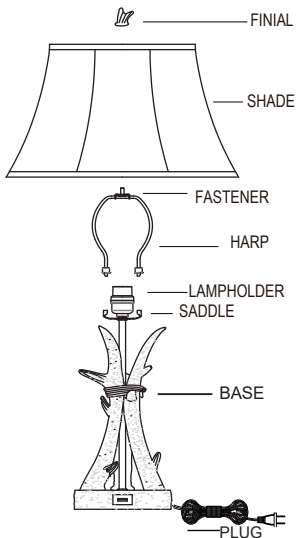

Antler Table Lamp

Note:

- You can grasp the finial and fastener together to adjust the shade to correct position if it is skew. Fastener is slightly rotatable by external force.
- Refer to the wattage caution label located.
- Do not attempt to replace the bulb while the lamp is plugged into a wall receptacle.