

INSTRUCTION MANUAL

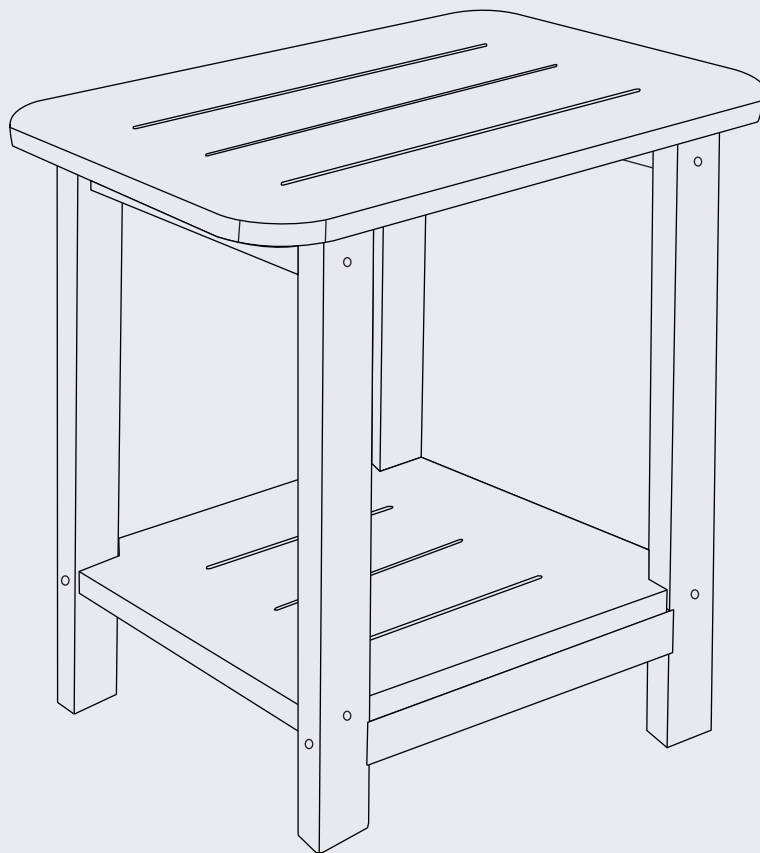

Outdoor Poly Two Shelf Side Table

V1.0

! CARE & MAINTENANCE

Please keep these instructions for your future reference.

- Be careful when assembling, avoid damaging the painted surface.
- Clean the table with lukewarm water, mild detergent & soft cloth.
- Firmly secure all bolts before use, do not use any part of this item as a step ladder.
- Reconfirm that all bolts, screws, and nuts are secure every 90 days.
- Do not use or store this item in the proximity of open flame or flammable/combustible chemicals.
- Be aware that some parts are heavy and have sharp edges.
- Do not overtighten screws. (Insert all screws before tightening screws.)
- Please do not exceed the weight limitations of this item.

TOOLS REQUIRED



**TABLE
300 LBS
CAPACITY**



**1 PERSON
ASSEMBLY**



**UP TO 20 MIN.
ASSEMBLY**

HARDWARE

1

SCREW
M6 x 70mm



4 PCS

2

SCREW
M6 x 50mm



8 PCS

PARTS

A

TABLE TOP

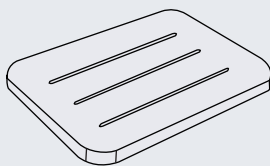

1 PC

B

**STORAGE
LAYER**

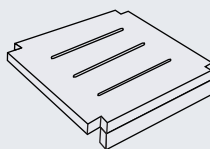

1 PC

C

LEG

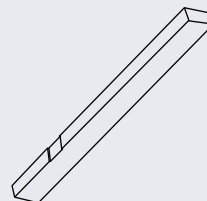

4 PCS

PRODUCT ASSEMBLY – OVERALL VIEW

Look at following overall view of this table and learn the exact position of each part to be assembled.

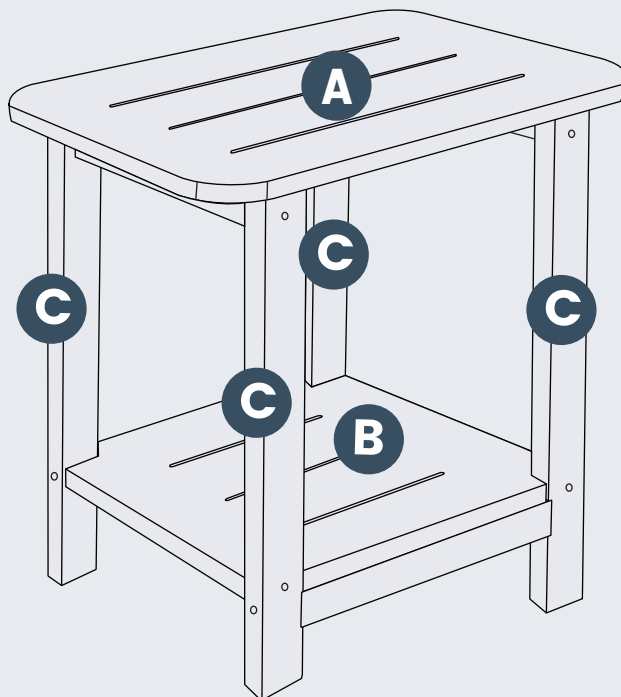

PRODUCT ASSEMBLY

1

Pick out **Part B Storage Layer** and **Part C Leg** from the package.

Attach 4 pcs of **Part C Leg** to **Part B Storage Layer** with 4 pcs of **Hardware #1 Screw** and 4 pcs of **Hardware #2 Screw** as below.

Pay attention not to tighten the screws too much, by about 70% of the tightness.

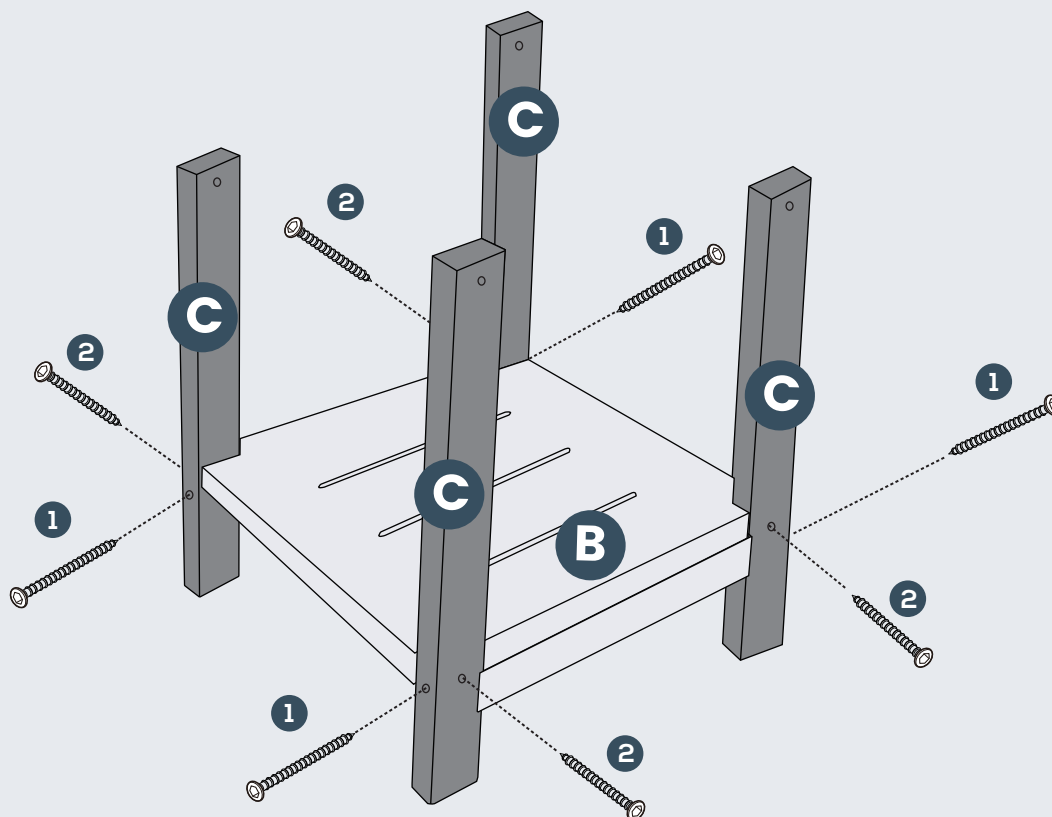

PRODUCT ASSEMBLY

2

Place **Part A Table Top** onto the top of **Part C Leg**, make sure to align the holes in the legs with the holes in the rails of **Part A Table Top**.

Attach **Part A Table Top** to the legs with 4 pcs of **Hardware #2 Screw**.

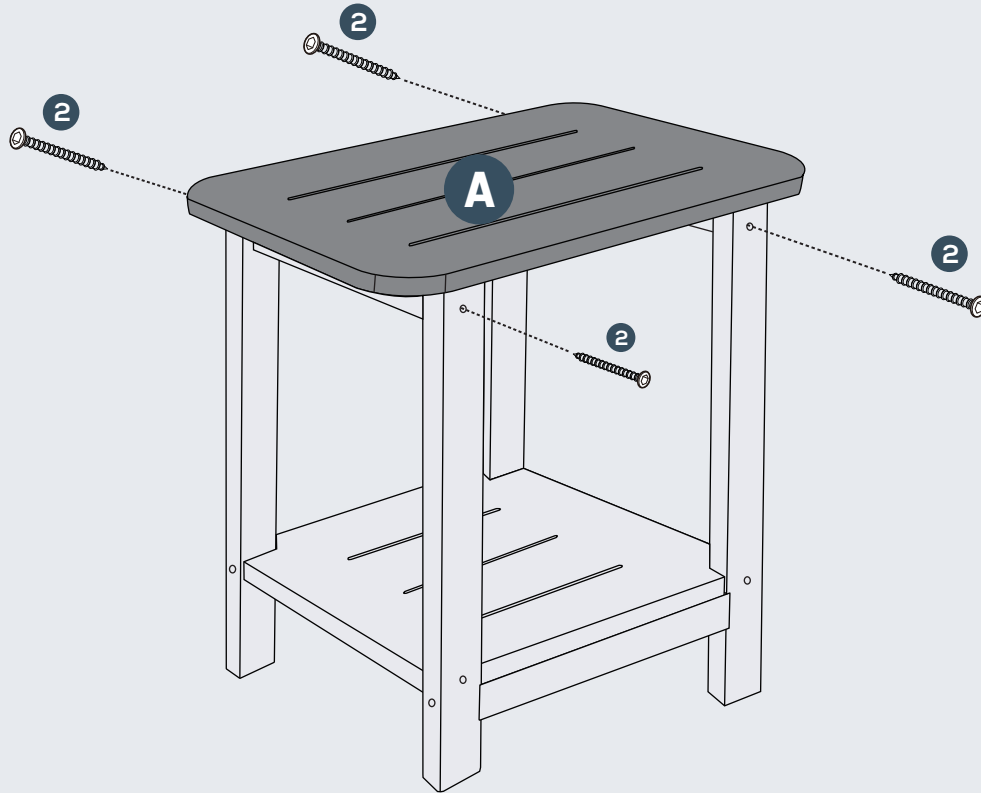

3

Check and tighten all the screws again to ensure the table is steady enough.

Enjoy the table now.

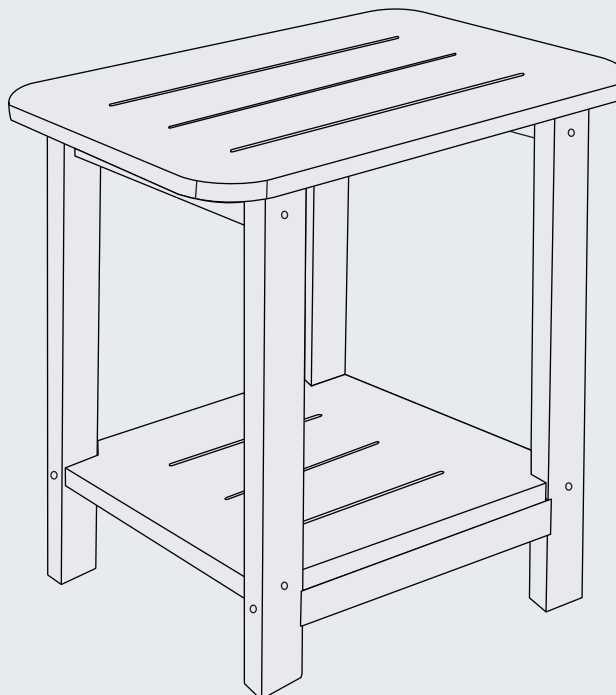

CLEANING TIPS

REGULAR CLEAN: Use a mixture of warm water and mild soap. Gently scrub the surface with a soft bristle brush to remove any dirt or stains.

QUICK CLEAN: You can simply wipe down the furniture with a damp cloth.

Regular cleaning not only preserves the aesthetic appeal of your furniture, but also helps extend its lifespan.