

Assembly Instruction

Item: GMK03

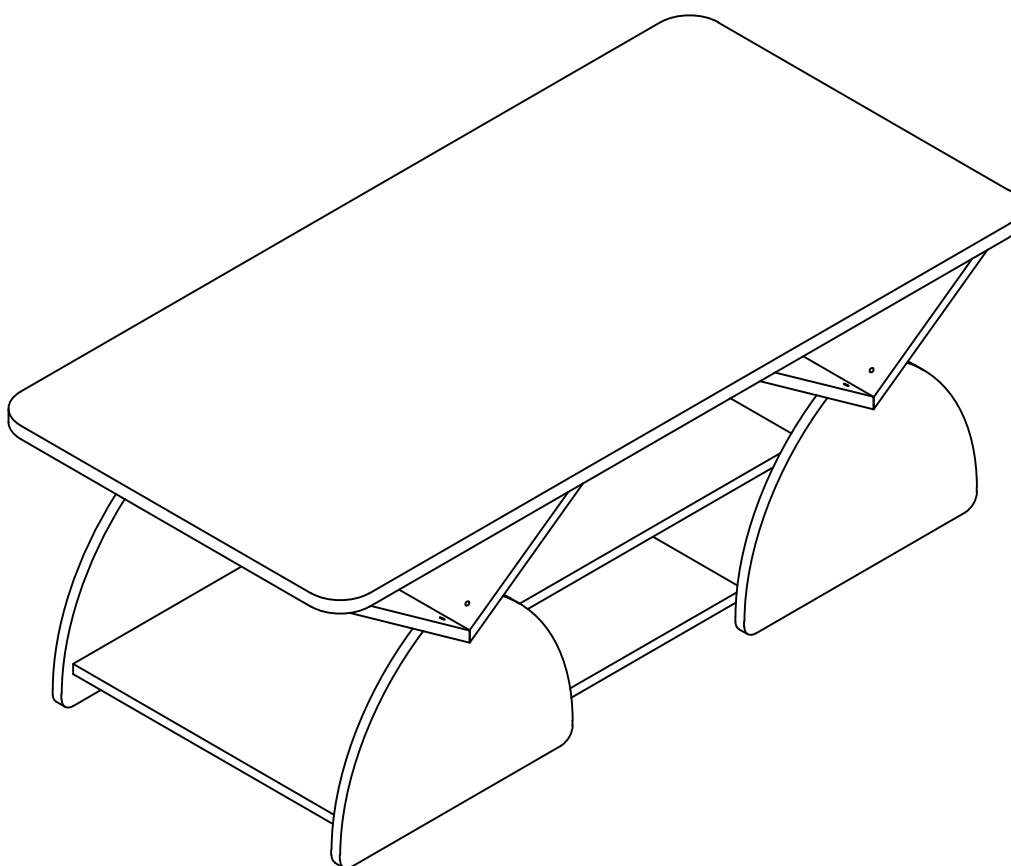

ASSEMBLY INSTRUCTION

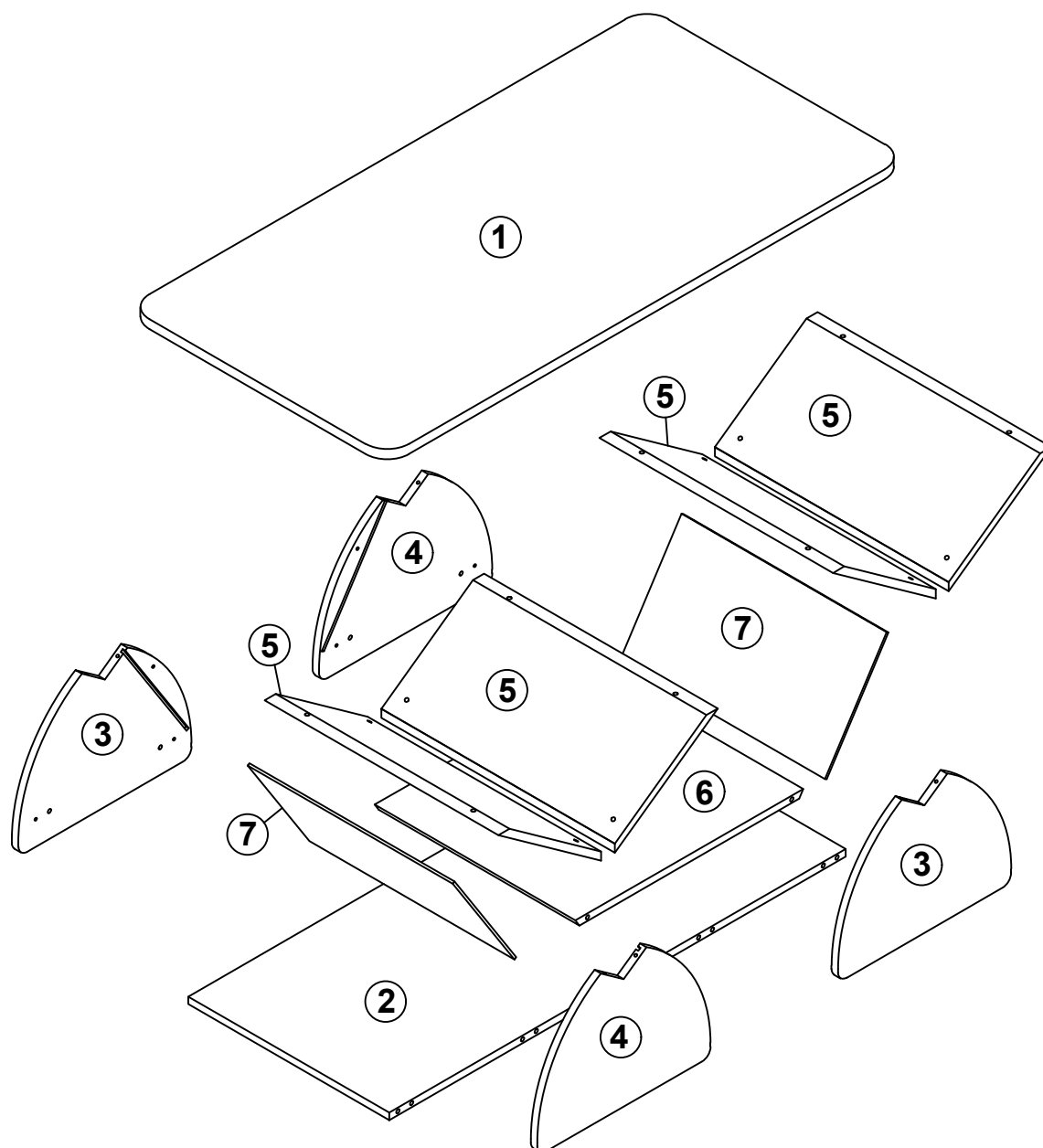

HARDWARE

A x 12+2spare

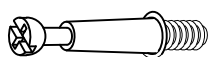

Ø6 x 32mm

B x 12+2spare

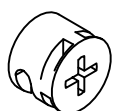

Ø15 x 10mm

C x 8+1spare

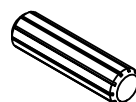

Ø8*30mm

D x 8+1spare



M6 *50mm

E x 8+1spare

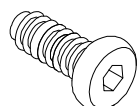

M6 *20mm

F x 1

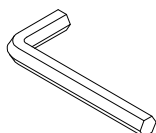

G x 23



Ø20mm

H x 1



I x 1

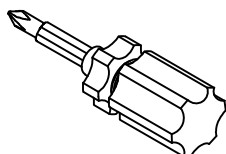

Installation of Cams and Pins

Screw the pin into the hole. To set the cams correctly, ensure that the arrow on the cam is opening to the hole of the pin it is locking. Lock the cam by turning the cam head with a screwdriver until it is tightened. Please do not use an electric screwdriver to assemble the unit.

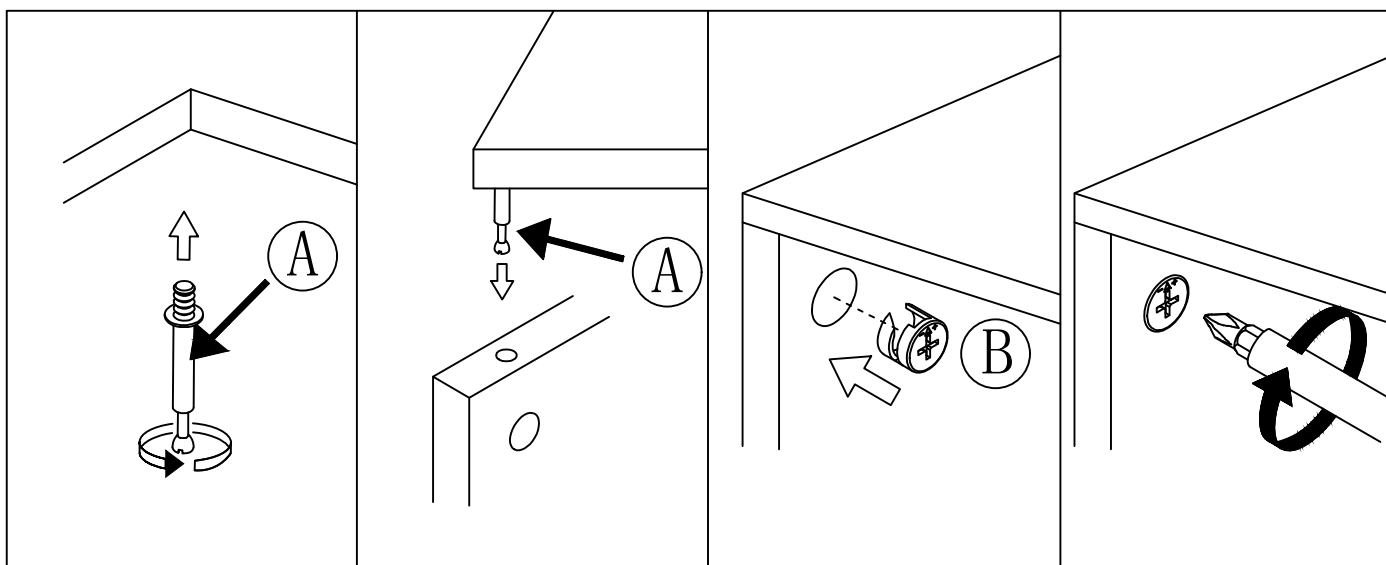

Read each step carefully before starting. It is very important that each step of instruction is performed in the correct order. If these steps are not followed in sequence, assembly difficulties will occur.

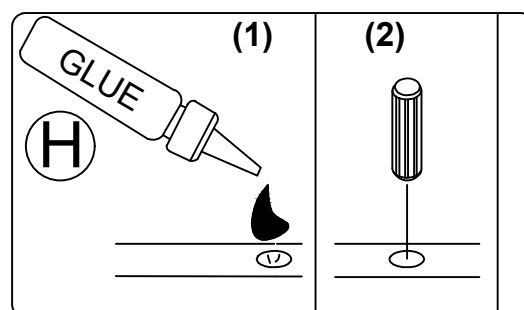
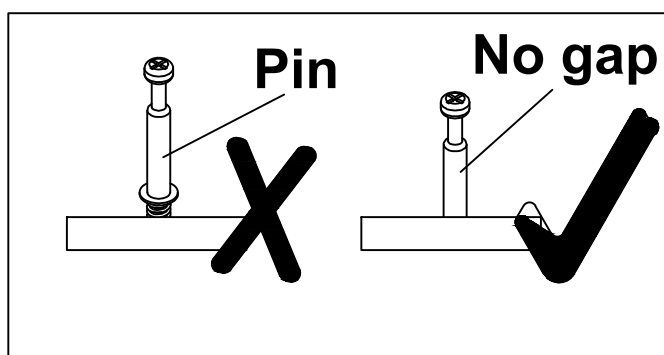

ASSEMBLY INSTRUCTION

STEP 1

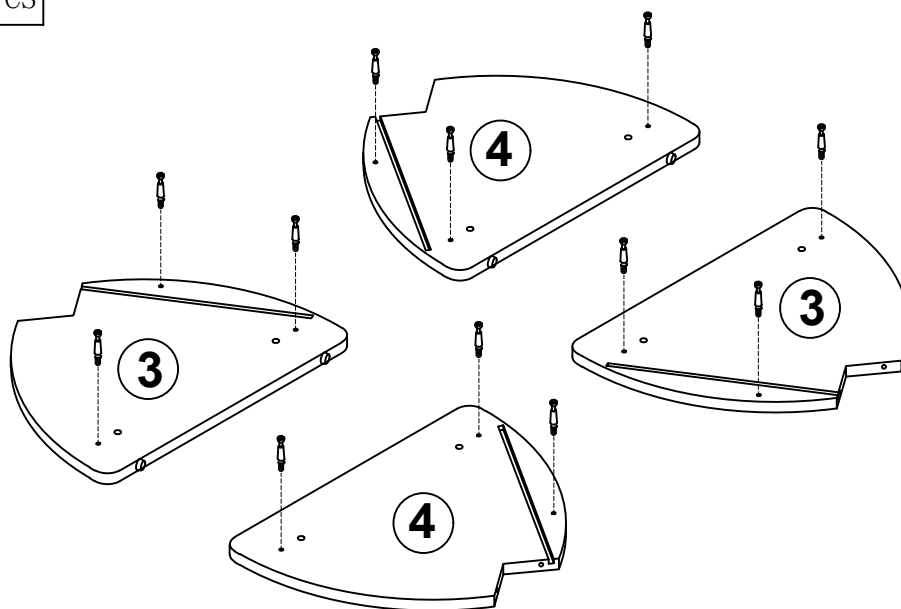
A:  12PCS

STEP 2

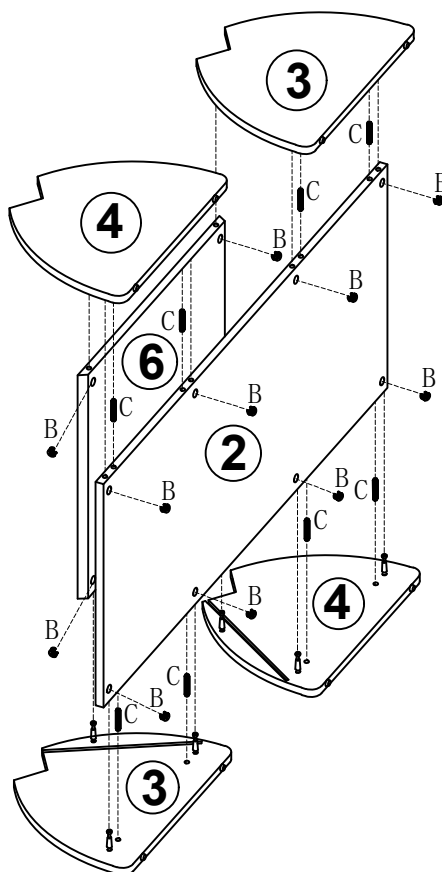
B:  12PCSC:  8PCSI:  1PC

ASSEMBLY INSTRUCTION

STEP 3

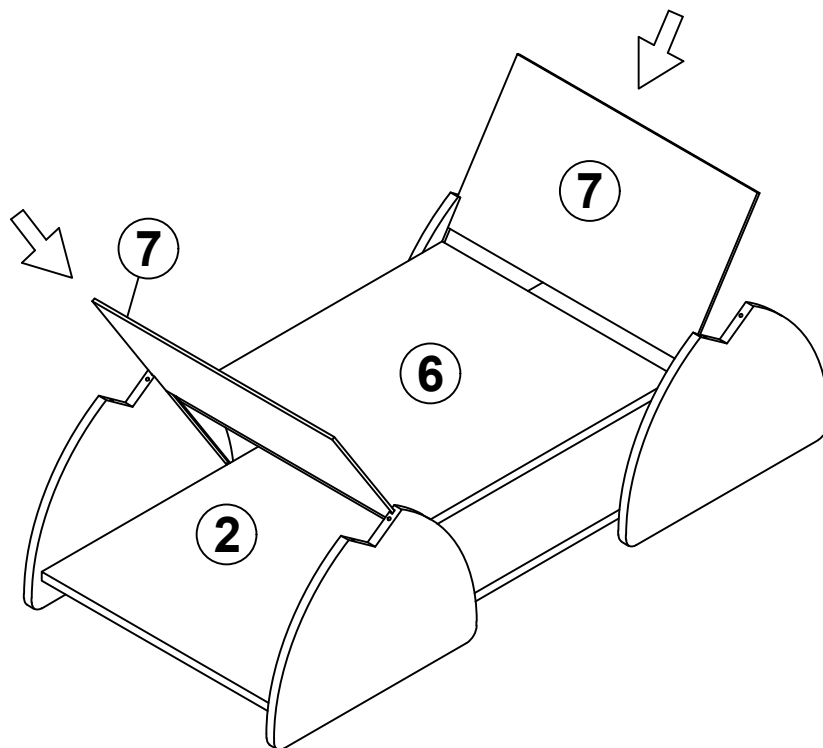

STEP 4

D:  8PCS

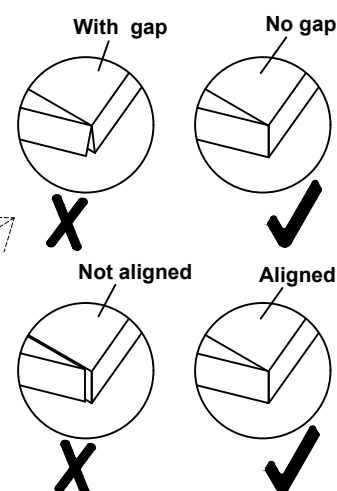
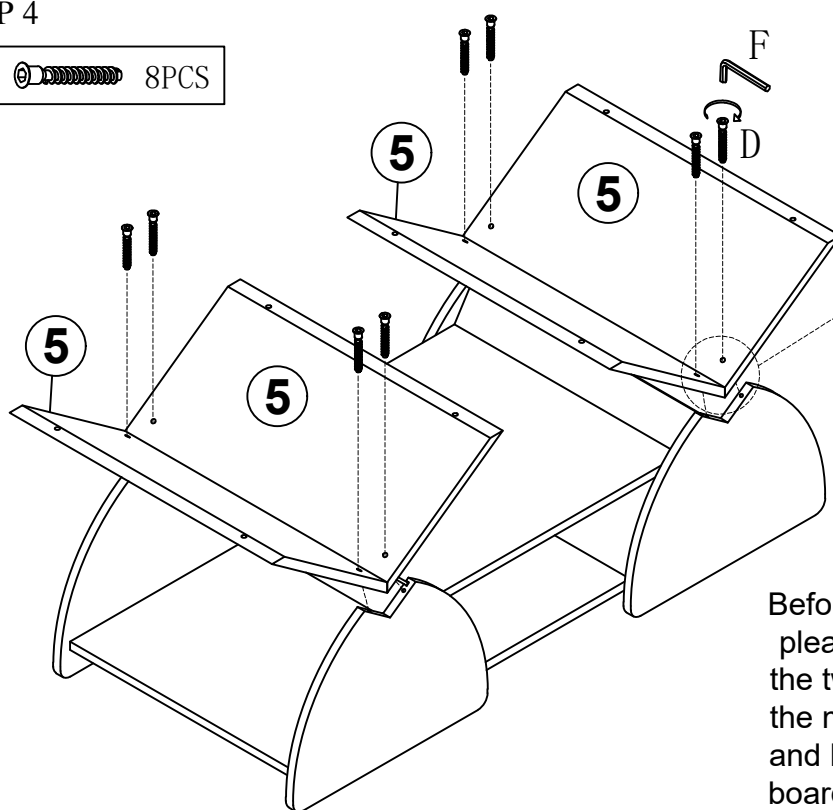

Before tightening the screws, please adjust the gap between the two No.⑤ wooden boards to the minimum and align the front and back ends of each two No.⑤ boards. After confirmation, tighten the screws.

ASSEMBLY INSTRUCTION

STEP 5

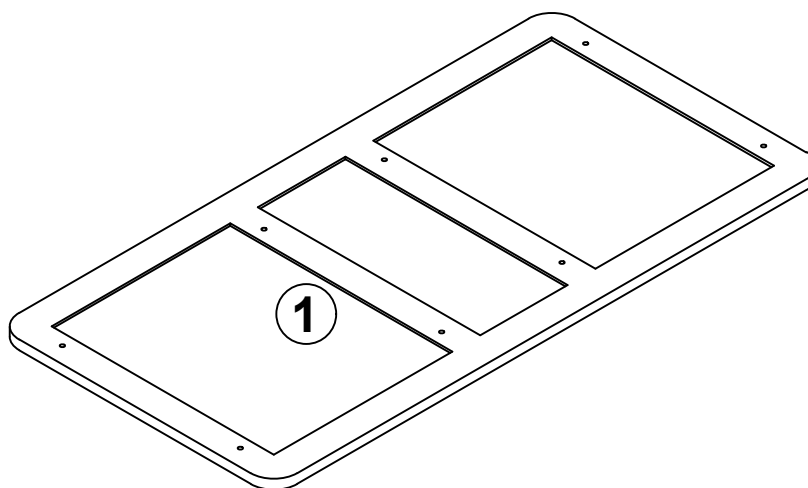

STEP 6

E:  8PCS

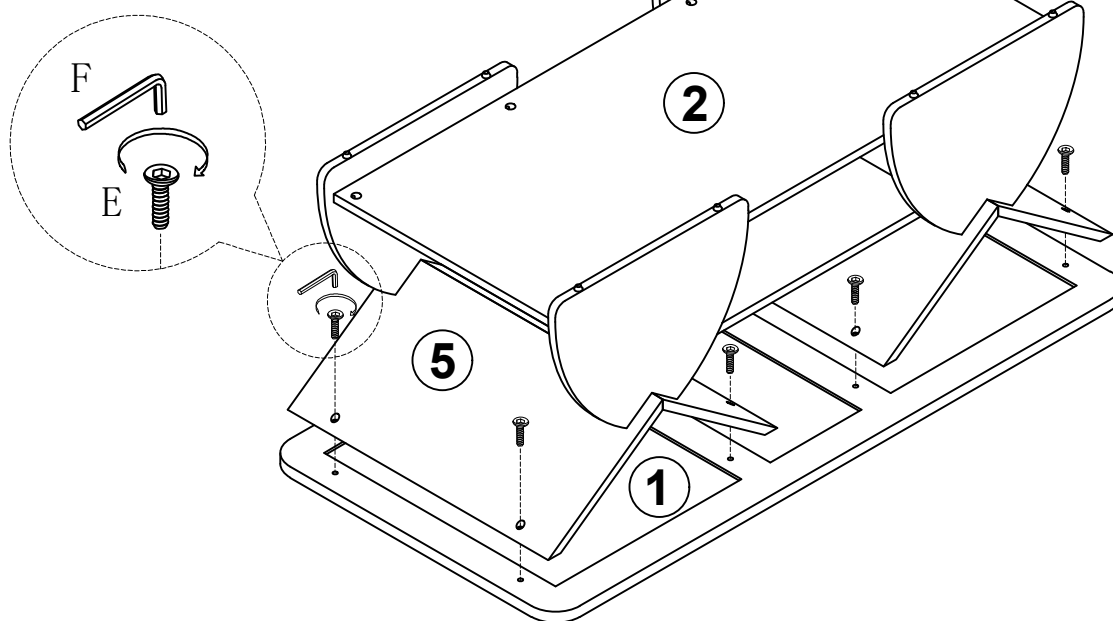

ASSEMBLY INSTRUCTION

STEP 7

G: ○ 23PCS

