

# TV 1831

## ASSEMBLY INSTRUCTIONS

Important note : -  
-Place all wooden part on a clean and smooth surface to avoid the part from being scratch.  
-Keep all hardware part out reach of children.

No	Hardware List	Qty
1	15mm Titus Mini fix 	20
2	Wood dowel 6 x 30mm 	20
3	Hingges 	4
4	M4 x 16mm Screw 	20
5	M4 x 20mm Screw 	16
6	Leg 	4
7	Center leg 	1
8	Power Nail 	24
9	Handle 	2
10	Handle Screw 	2

No	Part	Quantity
a	top plank	1
b	bottom plank	1
c	side plank	1L, 1R
d	center plank	2
e	shelf	1
f	door	2
g	back	2

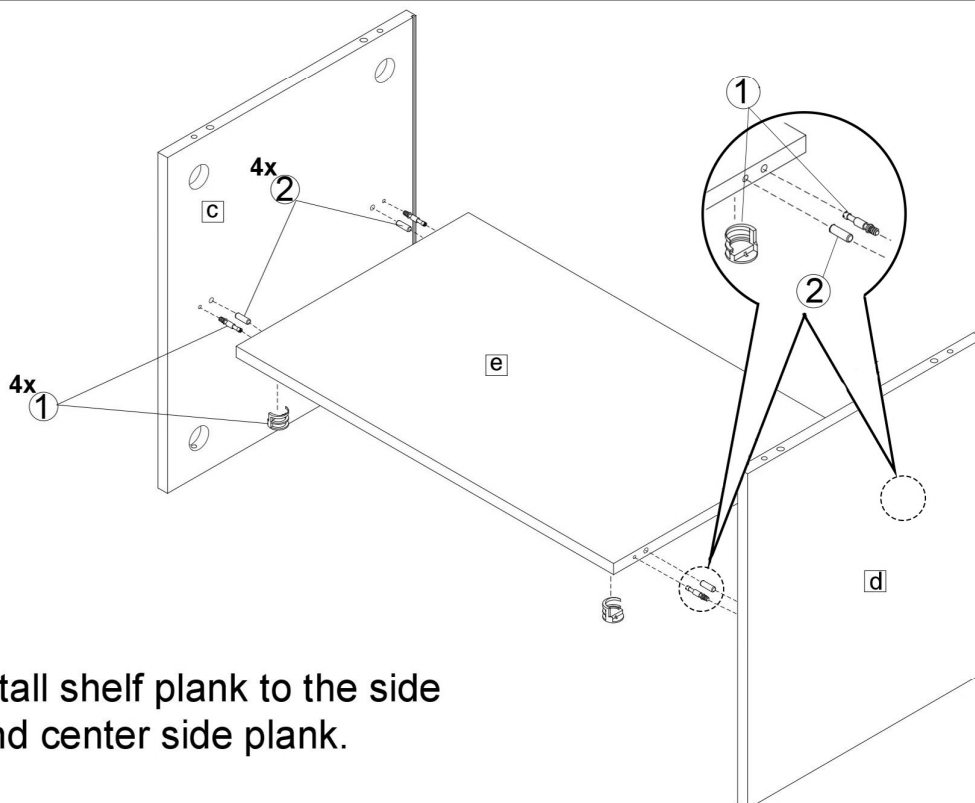
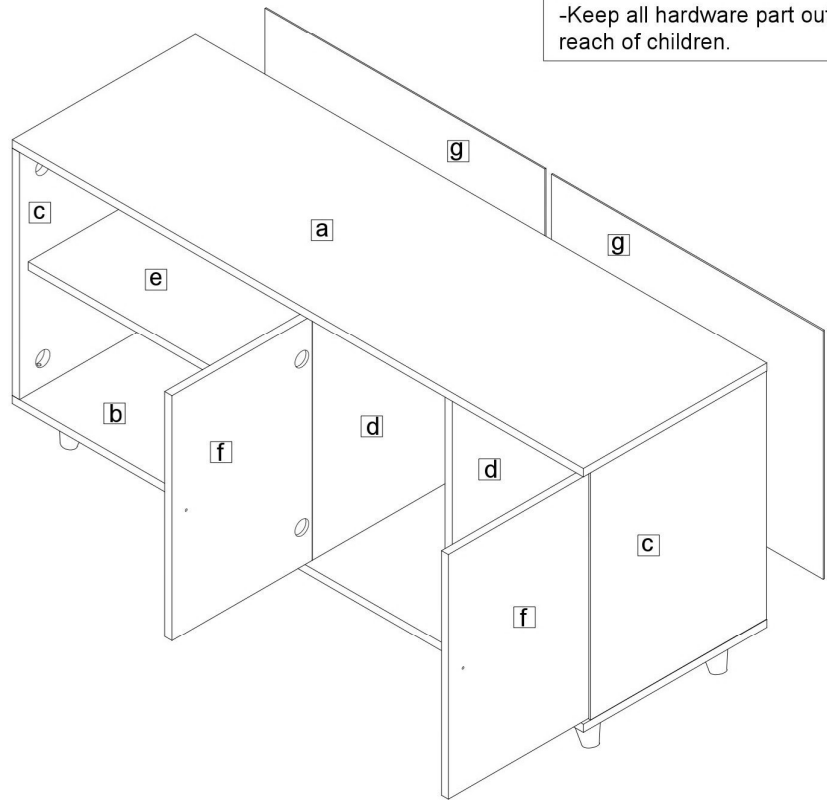

# 1 . install shelf plank to the side plank and center side plank.

# 2 . install s/p and center side plank to the bottom.

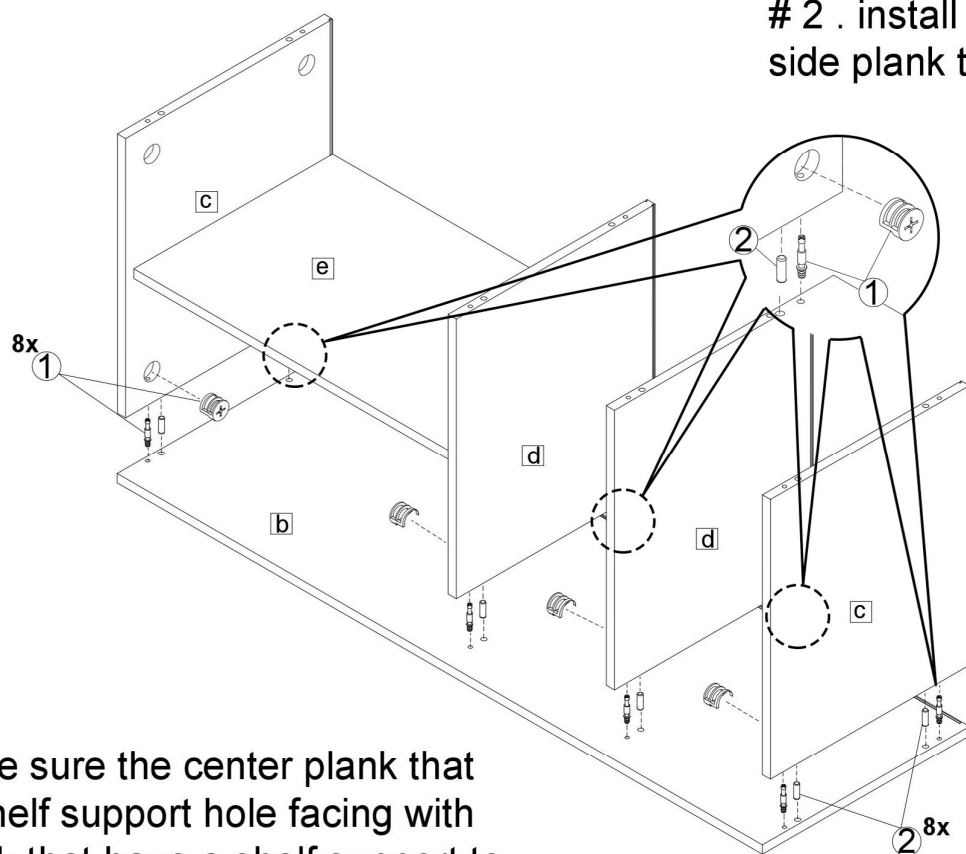

p/s : make sure the center plank that have a shelf support hole facing with side plank that have a shelf support to.

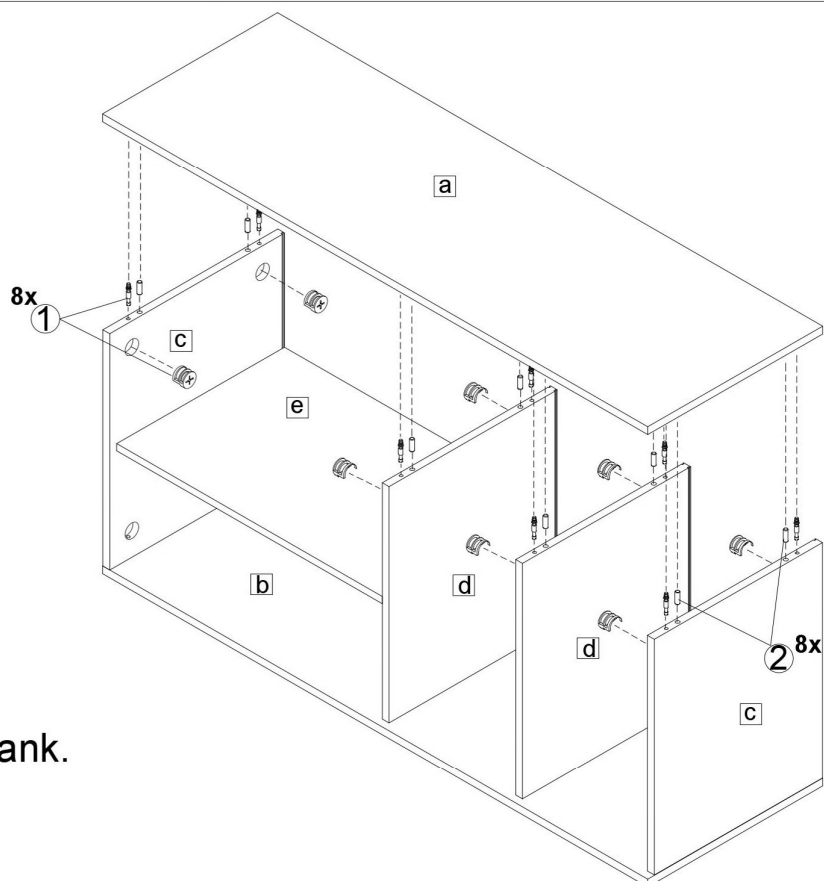

# 3 . install top plank.

# 4 . install door plank by using hinges.

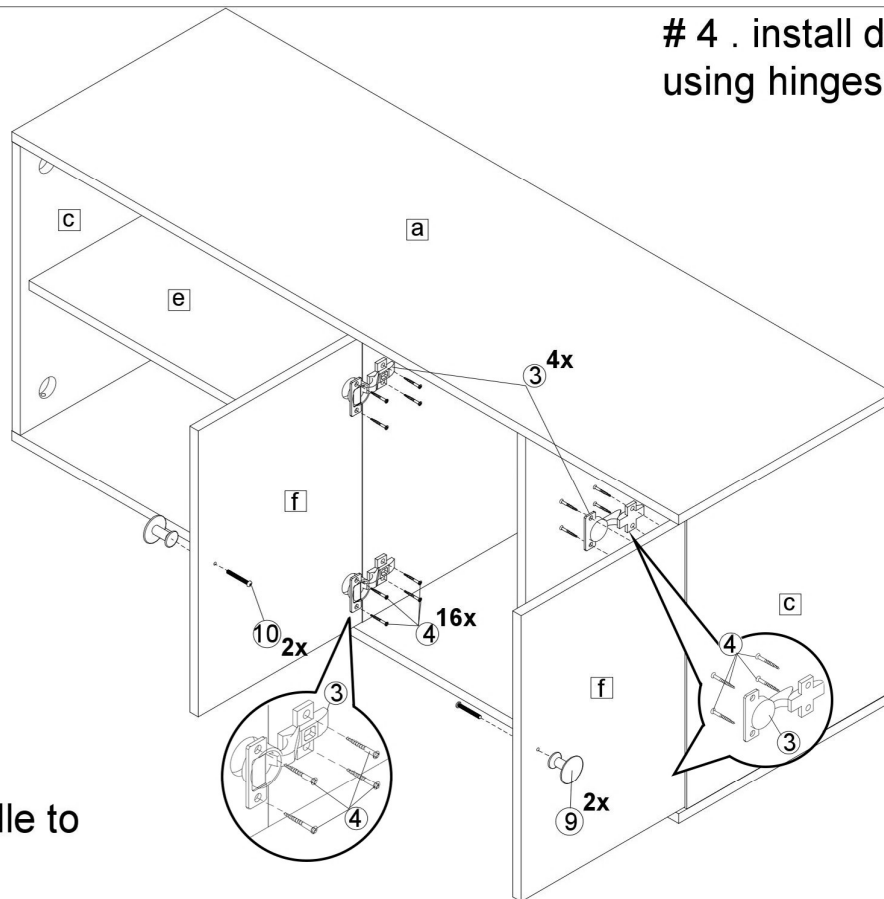

# 5 . apply handle to the door plank.

# 6 . install back cover by using the nail. make sure knock slowly until the nail completely inside.

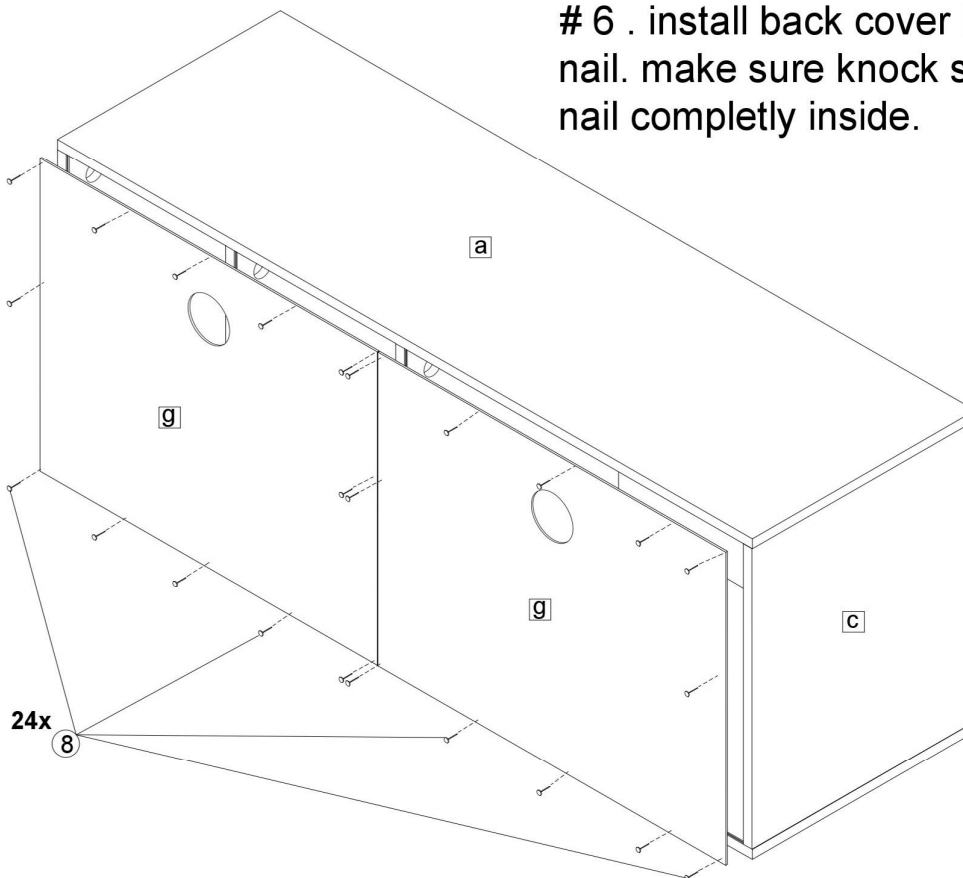

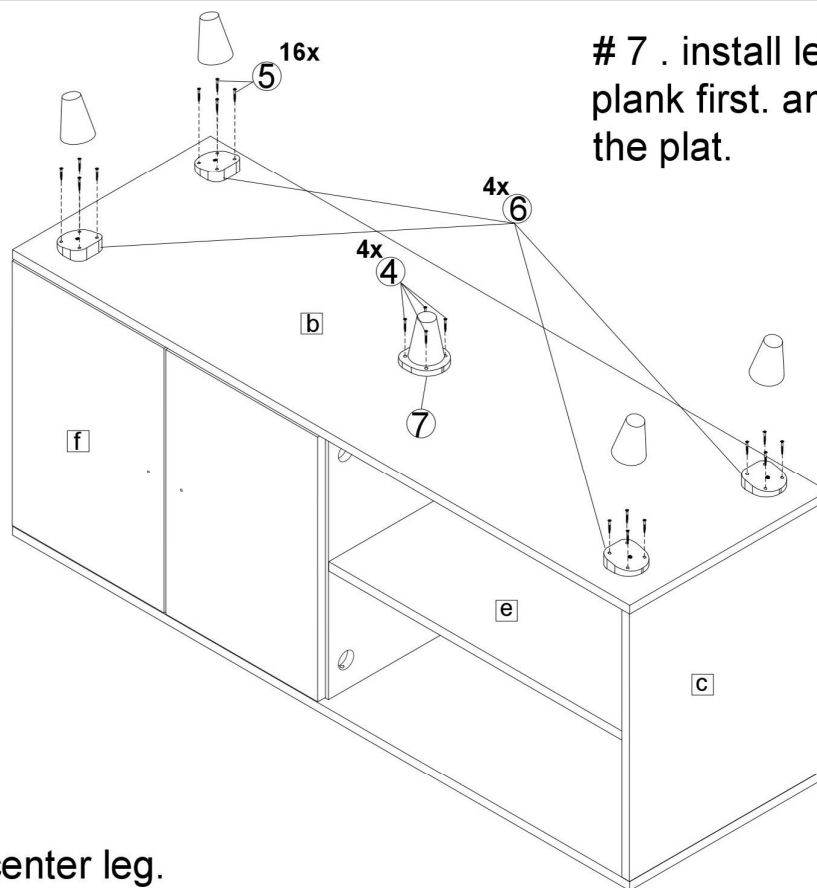

# 7 . install leg plat to the bottom plank first. and then install leg to the plat.

# 8 . install center leg.

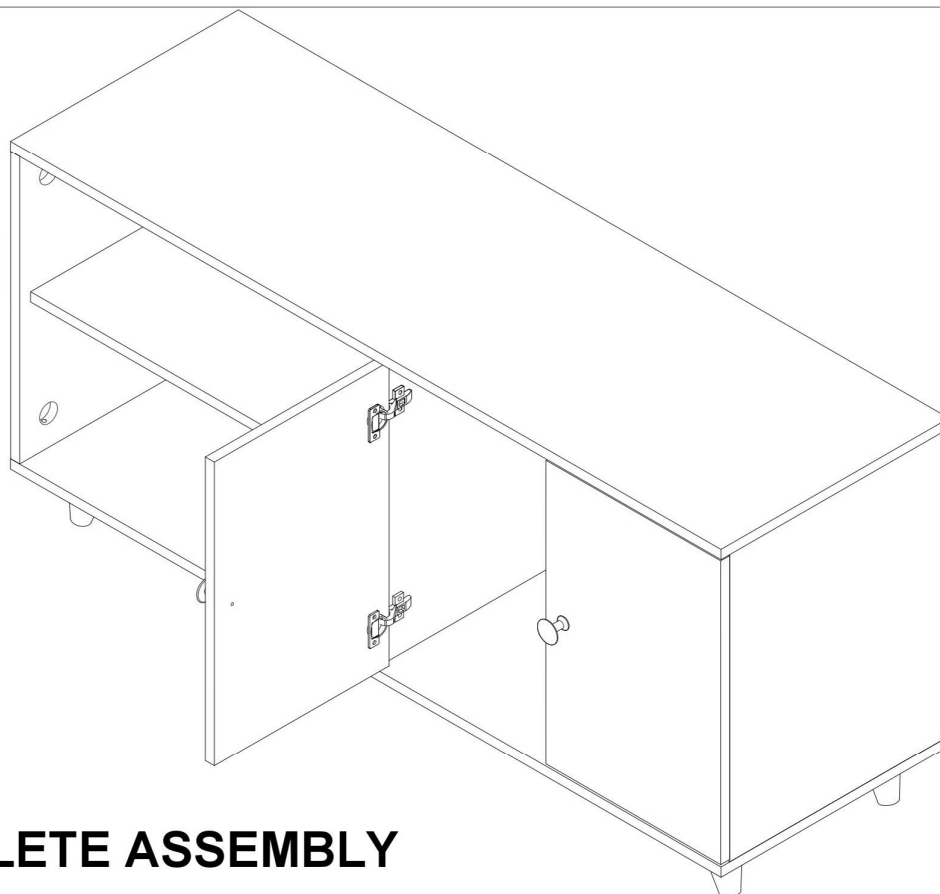

**COMPLETE ASSEMBLY**