

# DREAMS

IDEA

Instruction Manual



DREAMS/IDEA

NO.CH0067

# ABOUT US

*D*REAMSIDEA IS A ONE-STOP HOME

FURNISHING AND SERVICE COMPANY BASED IN USA.

WE ARE DEDICATED TO BRINGING YOUR DREAM HOME TO LIFE.

OUR SERVICES COVER FROM DESIGN, PRODUCTION,

DIRECT SELL, STORAGE, AND TRANSPORTATION.

IF REALITY IS THE NEAR SHORE

AND IDEALISM THE FAR SHORE,

*D*REAMSIDEA

AS THE FERRY BETWEEN THEM,

EAGER TO ACCOMPANY YOU ON A JOURNEY

TO YOUR IDEAL HOME.

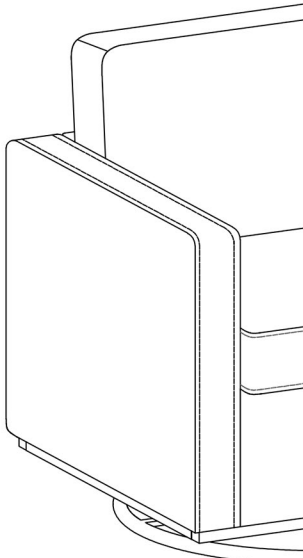

ITEM NO.CH0067

# WARRANTY

We strive to offer high quality product and we also try our best to satisfy each customer that order from us, no matter on products or services as needed. Each customer receives a record of their order, such as the order number or item receipt. For any items that are out of warranty period, you may still be able to purchase the replacement parts from our company if they are available.

Are you having difficulty  
with assembly? Missing parts?

Please contact us : [info@firstopintl.com](mailto:info@firstopintl.com)

Tel:(562)-781-3327

send an email with your order No. to us

For return, please check the return policy with  
the retailer or platforms you bought from.

Appreciate your purchasing from us.

Pop up your life by our furniture !

# MAINTENANCE AND WARNING

Please read the manual thoroughly  
before you start installing.

Please keep the product away from  
sharp object.

Packaging and small parts may have  
chocking hazard, please keep them away  
from children and pets.

Please clean the product according to each  
clean code, check the product description  
for more information.

Please keep the product away from  
fire.

If you have any other questions, please  
contact us, we will be glad to help you out.

If the product is placed under direct  
sunlight, the pattern or color might fade  
away overtime.

Check the product periodically to make  
sure everything is secured and tightened.

Always use proper tools for installation.

Do not jump on the product.



Around 45 min



# PRDOUCT DESCRIPTION

Upholstered in premium chenille fabric, this armchair combines a silky touch with a warm, inviting look while being easy to clean and maintain.

A wide ergonomic backrest paired with a plush cushion ensures superior spinal support, making it ideal for extended seating sessions.

The armrests are set at an optimal height, designed to provide natural comfort for the arms without straining shoulders.

The seat features a layered build of foam sponge, resilient synthetic fibers, and an integrated spring package, offering balanced softness and bounce.

A sturdy metal swivel base delivers effortless 360-degree rotation, while the streamlined assembly process and minimalist silhouette allow seamless integration into modern or traditional interiors.

Dream



House

# EXPLODED VIEW



The product's left and right are determined by sitting posture

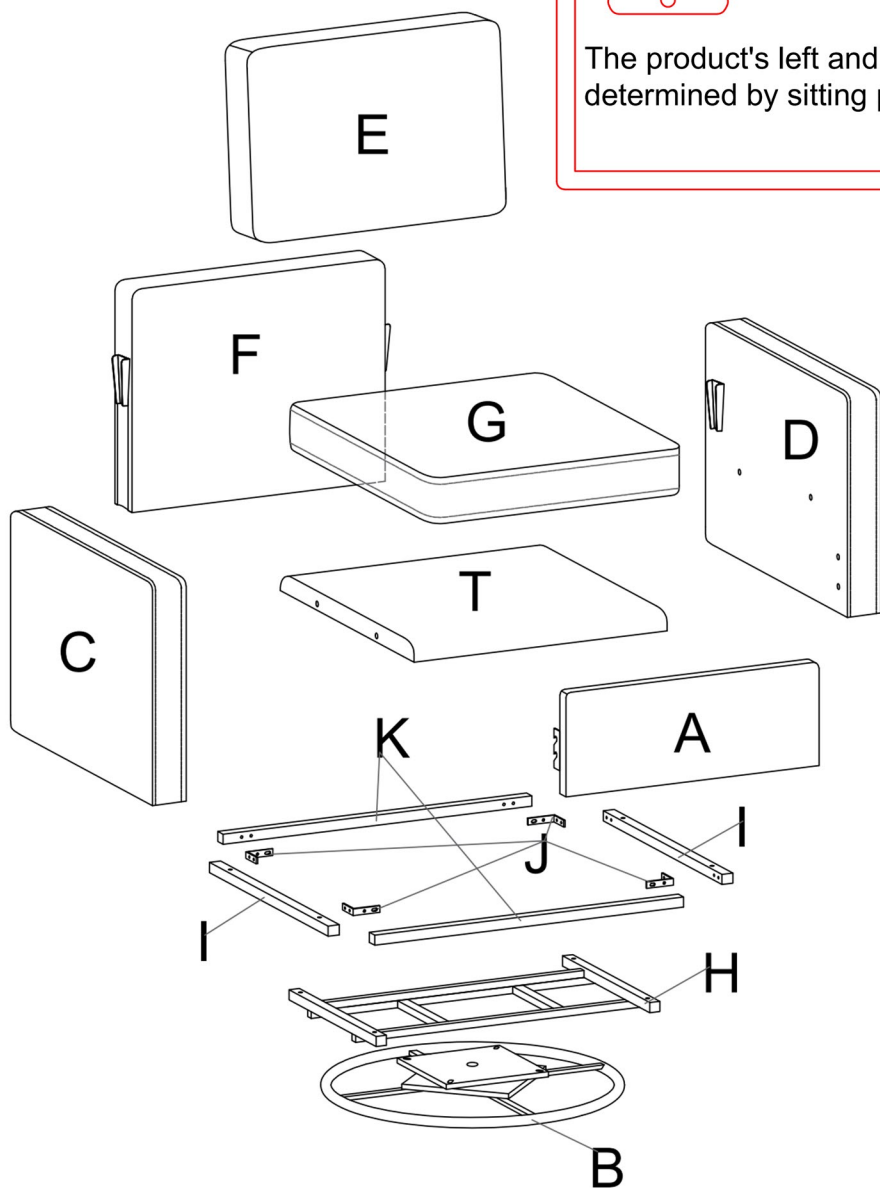

# PARTS

A\*1



Front panel

B\*1



Swive base

C\*1

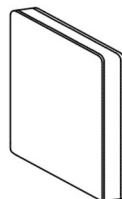

Right arm

D\*1

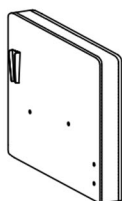

Left arm

E\*1

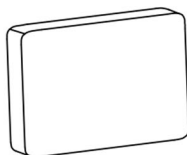

Back cushion

F\*1

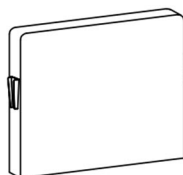

Backrest

G\*1



Seat cushion

H\*1

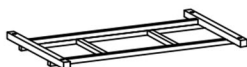

Connecting frame

K\*2



Long bar

I\*2



Short bar

J\*4



L-shaped connectors

T\*1

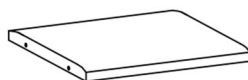

Seat frame

# HARDWARE

## TOOL LIST

NOTE: Designated with (★) We provide additional spare parts in the hardware package

①\*20



②\*4



③\*12

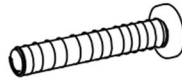

★ M6\*16mm Bolt    ★ M6\*30mm Bolt    ★ M6\*60mm Bolt

④\*1

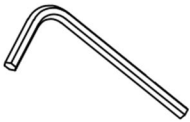

Allen key

Please make sure all hardware&packing material fitting the list.  
Especially some small accessories may be missing during transportation. Please contact us if you have any question.

# step 1

Cut the plastic air compression bags, and take out cushions (G) and (E). Place them on the side for recover to their original shape, the whole process might take up to 48 hours, you may gently slap on them to speed up the process.

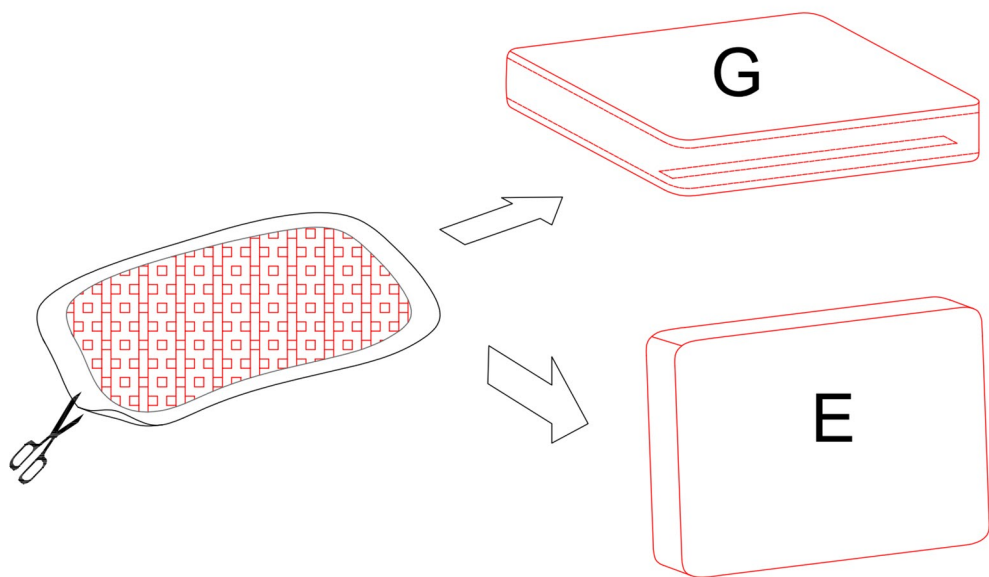

# step 2

Twist two bolts (2) to the designated holes on each armrest as shown, use the allen wrench (4) provided to tighten both bolts for about 2/3 of their length, do not tighten them completely.

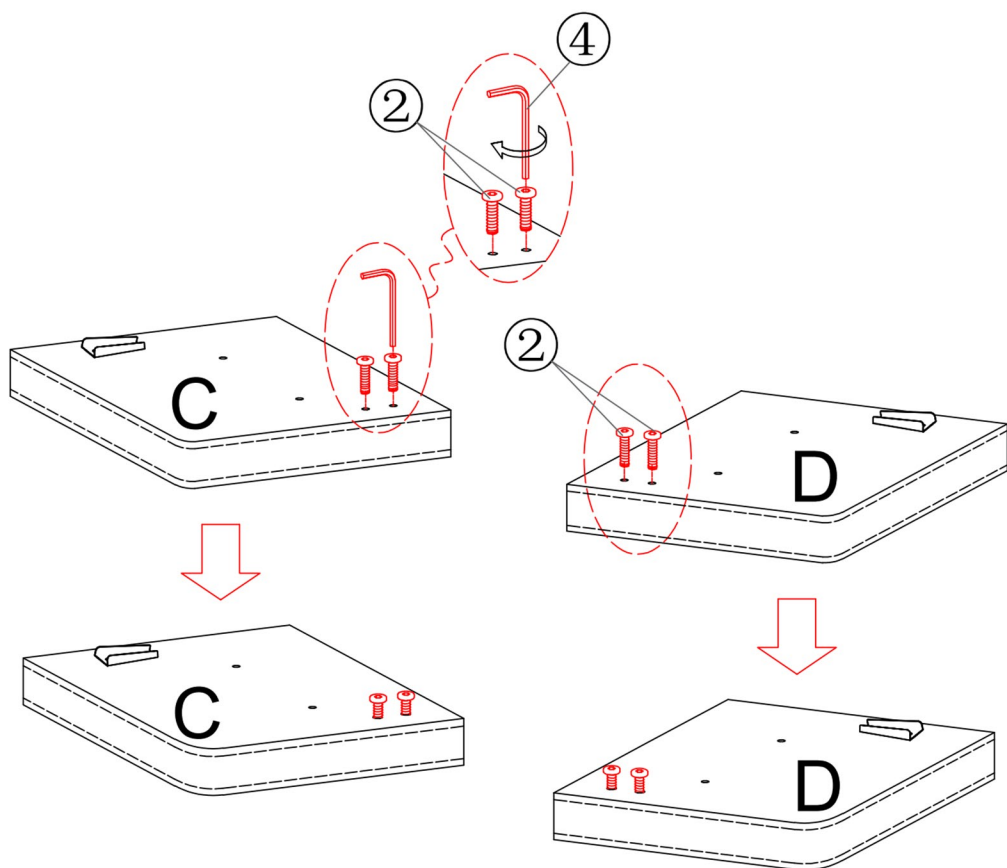

# step 3

To install the front panel (A) to the installed parts, place the front panel (A) at desired place and align the pre-drilled holes on the panel and both armrests as shown. Use the allen wrench provided to tighten all bolts for 2/3 of their length, do not tighten the bolts completely for future assembly.

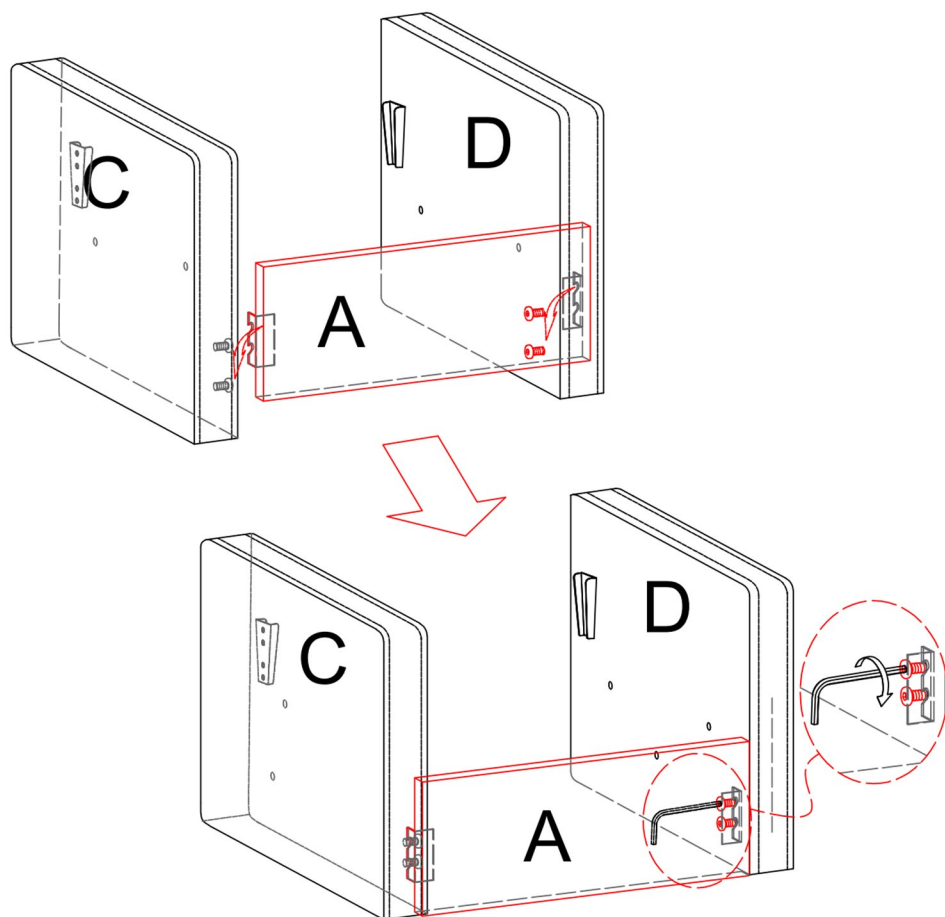

# step 4

Lift the installed parts up, and place the seat frame (T) inside the installed parts as shown. Align the bolt holes on both sides of the frame to the pre-drilled holes on the armrests, then use the allen wrench (4) provided to tighten all the bolts, including the bolts from previous steps.

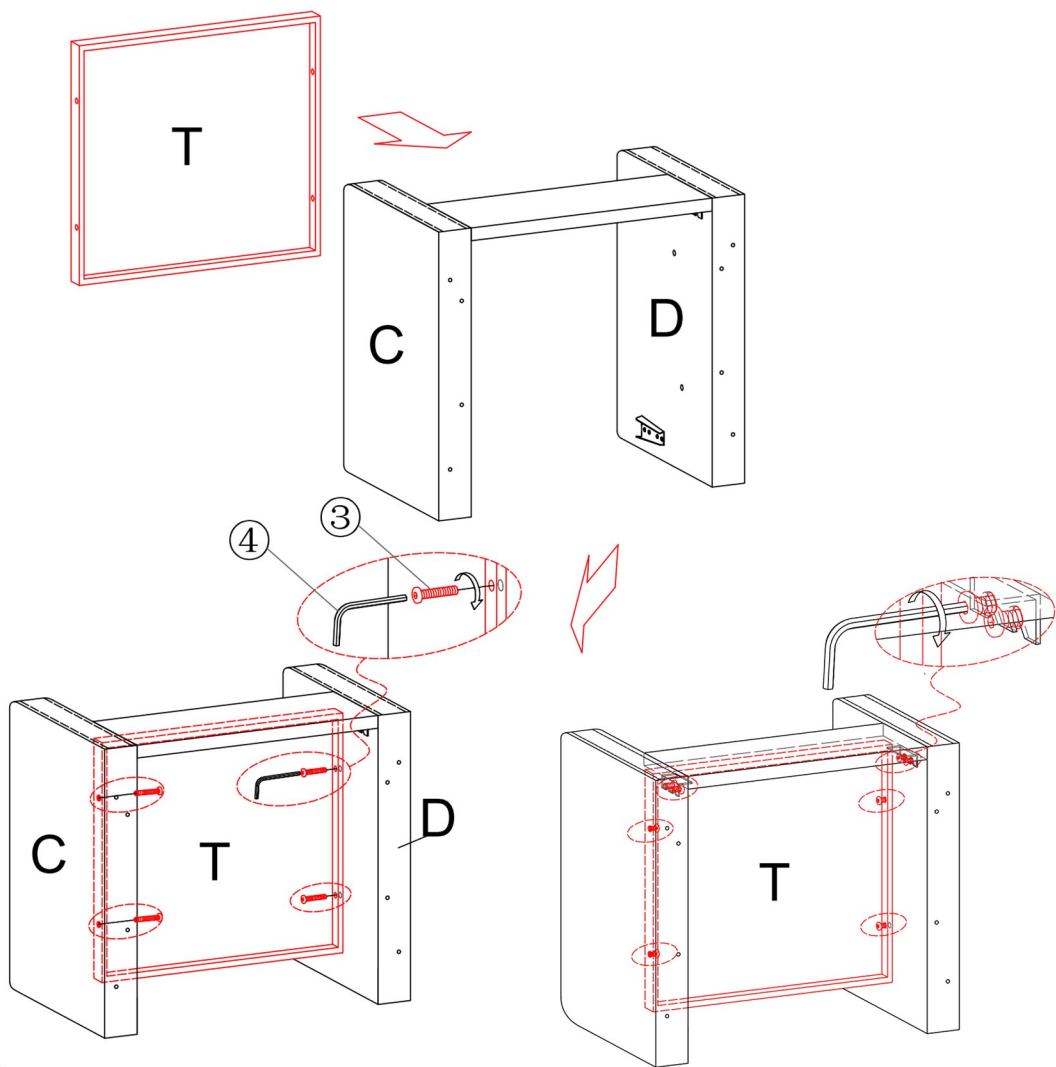



# step 5

To install the backrest (F), align the connectors on each side of the backrest with the slots on the armrest as shown, make sure both connectors are correctly aligned, then push down the backrest to fix.

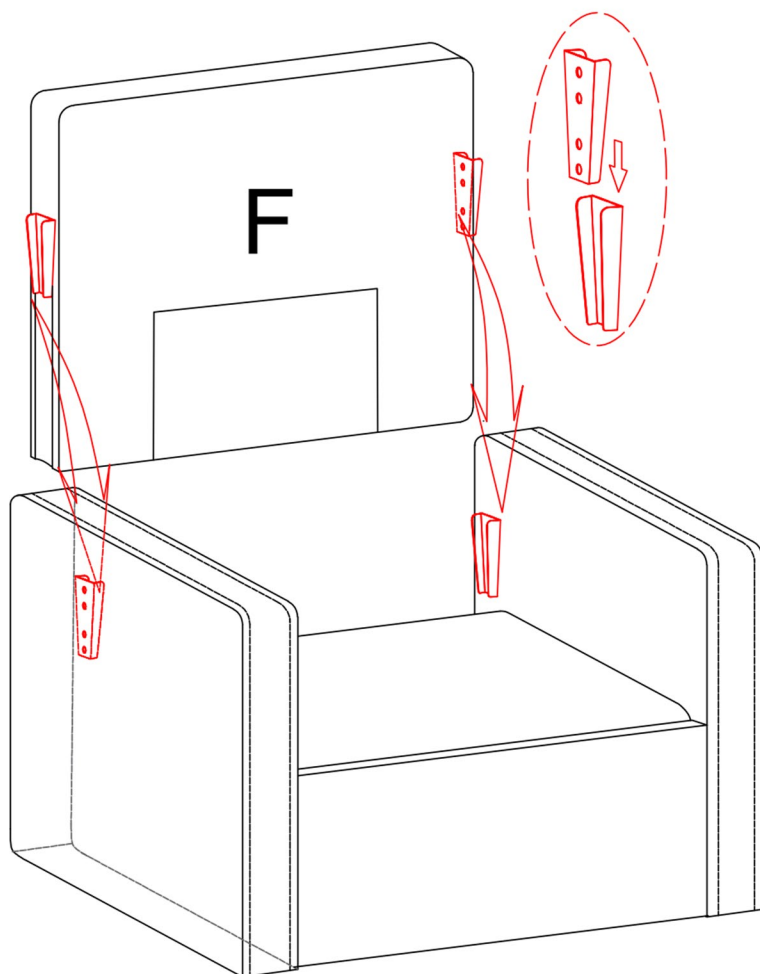

# step 6

Use the L-shaped connectors (J) to connect the long bars (K) and short bars (I) into a frame as shown, use the allen wrench(4) provided to tighten all the bolts.

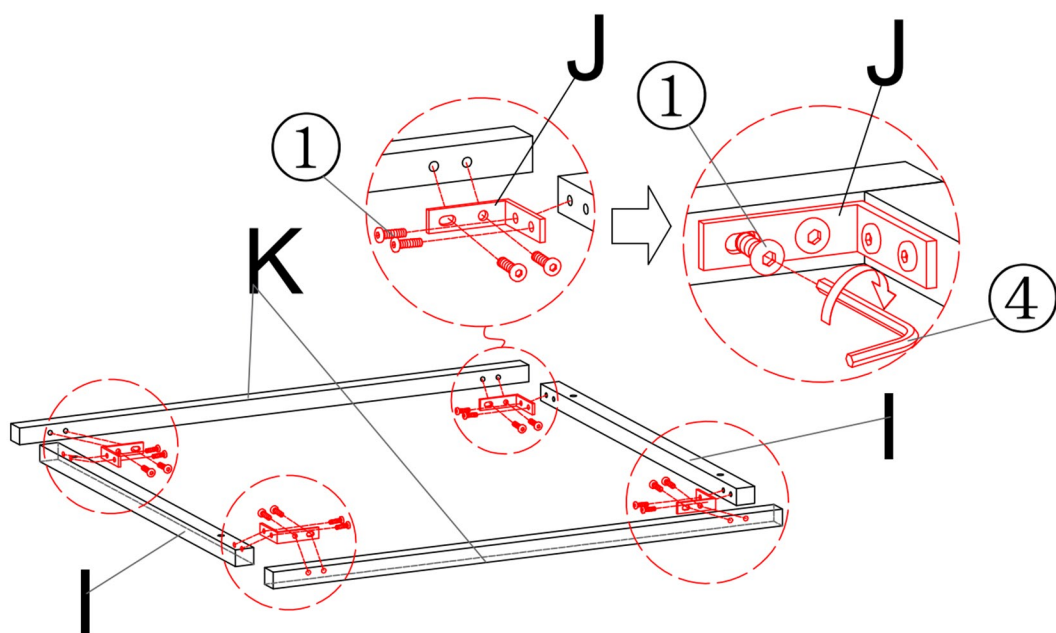

# step 7

Place the frame assembled from the previous step to the bottom of the chair as shown, fix it with the bolts. Use the allen wrench provided to tighten all the bolts.

Please make sure the direction of the assembly holes are correctly positioned.

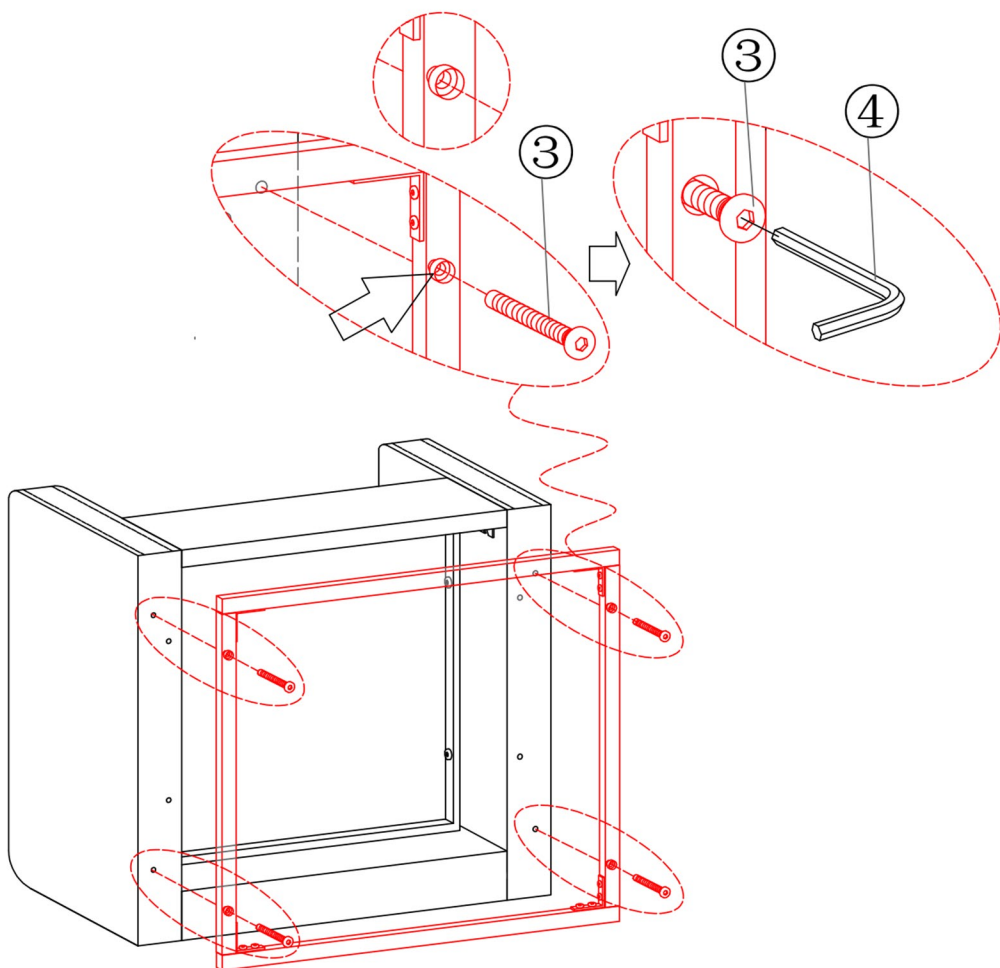

# step 8

Install the connecting frame (H) to the bottom of the chair as shown, use the allen wrench (4) provided to tighten the bolts. Make sure all the bolt holes are correctly aligned before tightening all the bolts.

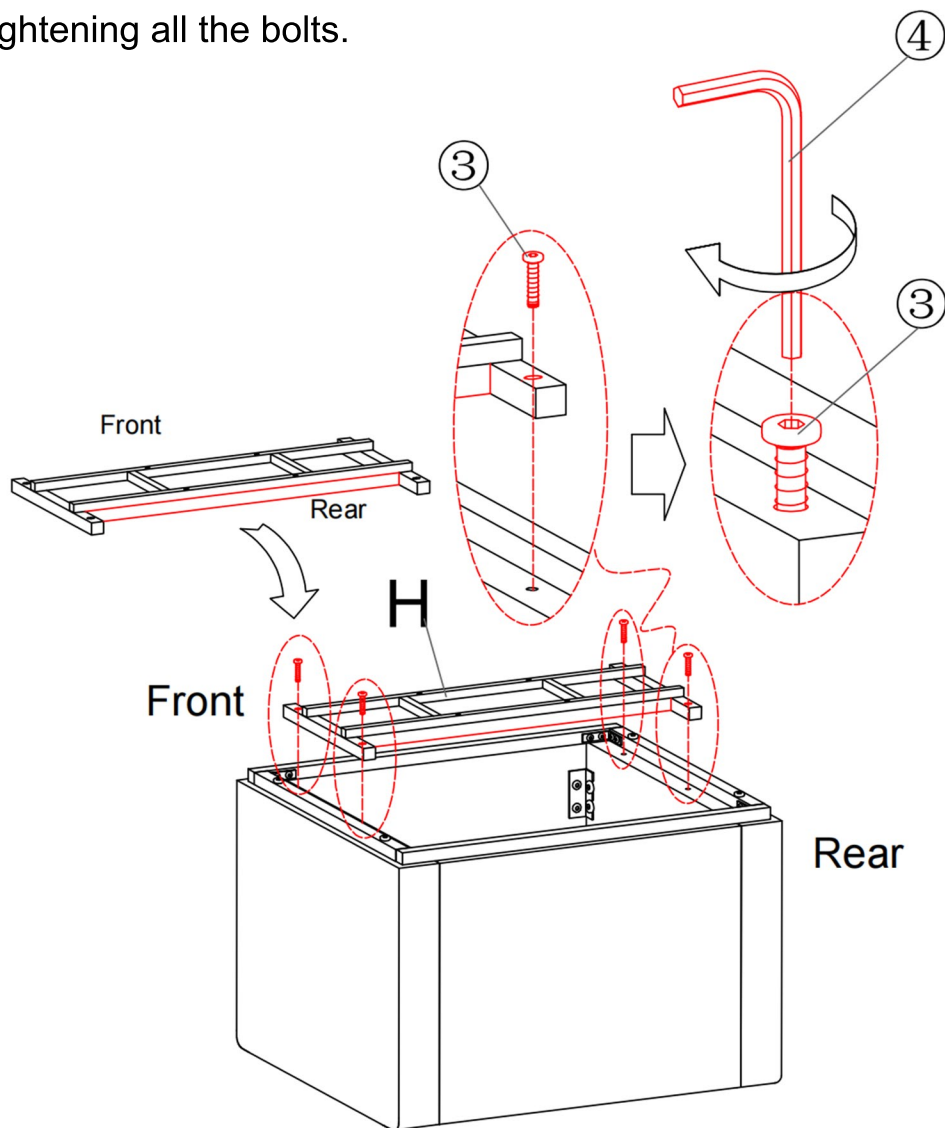

# step 9

Align the mounting holes of the square turntable with the four screw holes on the swivel base. Use the allen wrench provided to tighten the bolts.

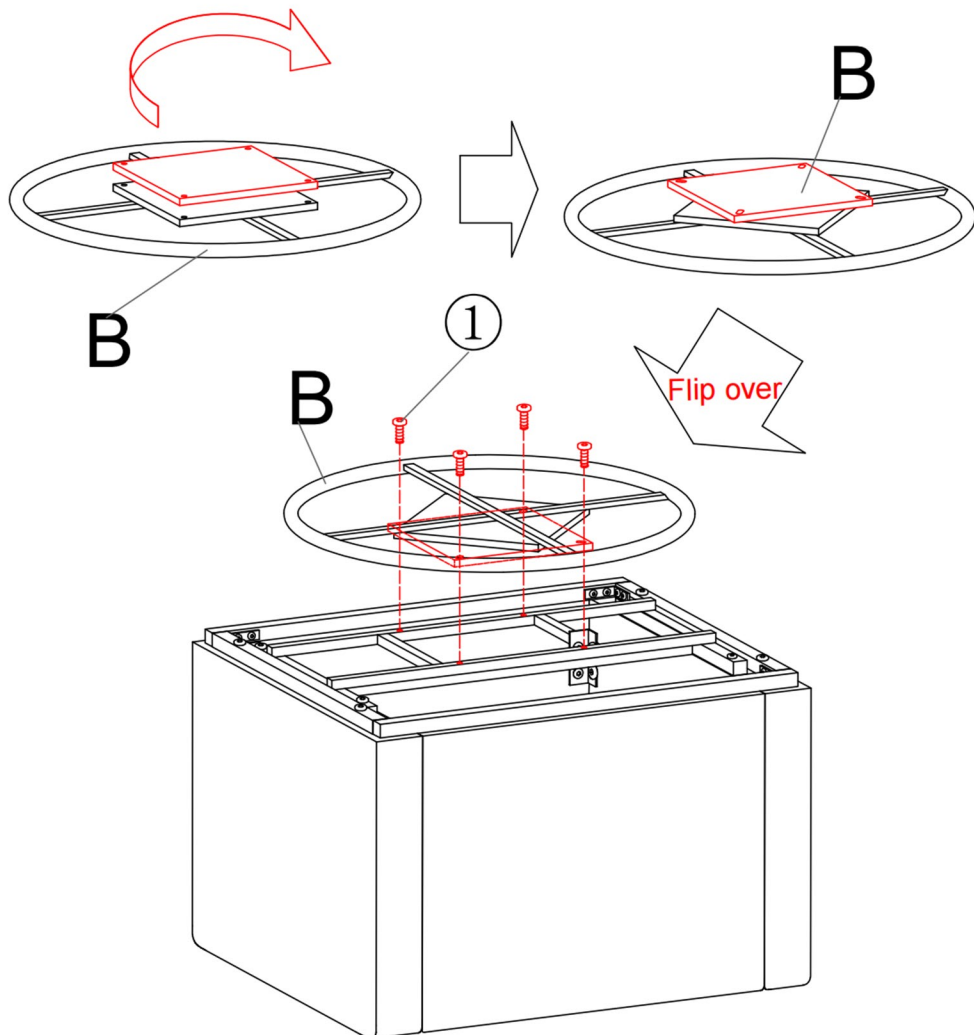

# step 10

Please the seat cushion (G) on it,  
then please the back cushion (E) on it.

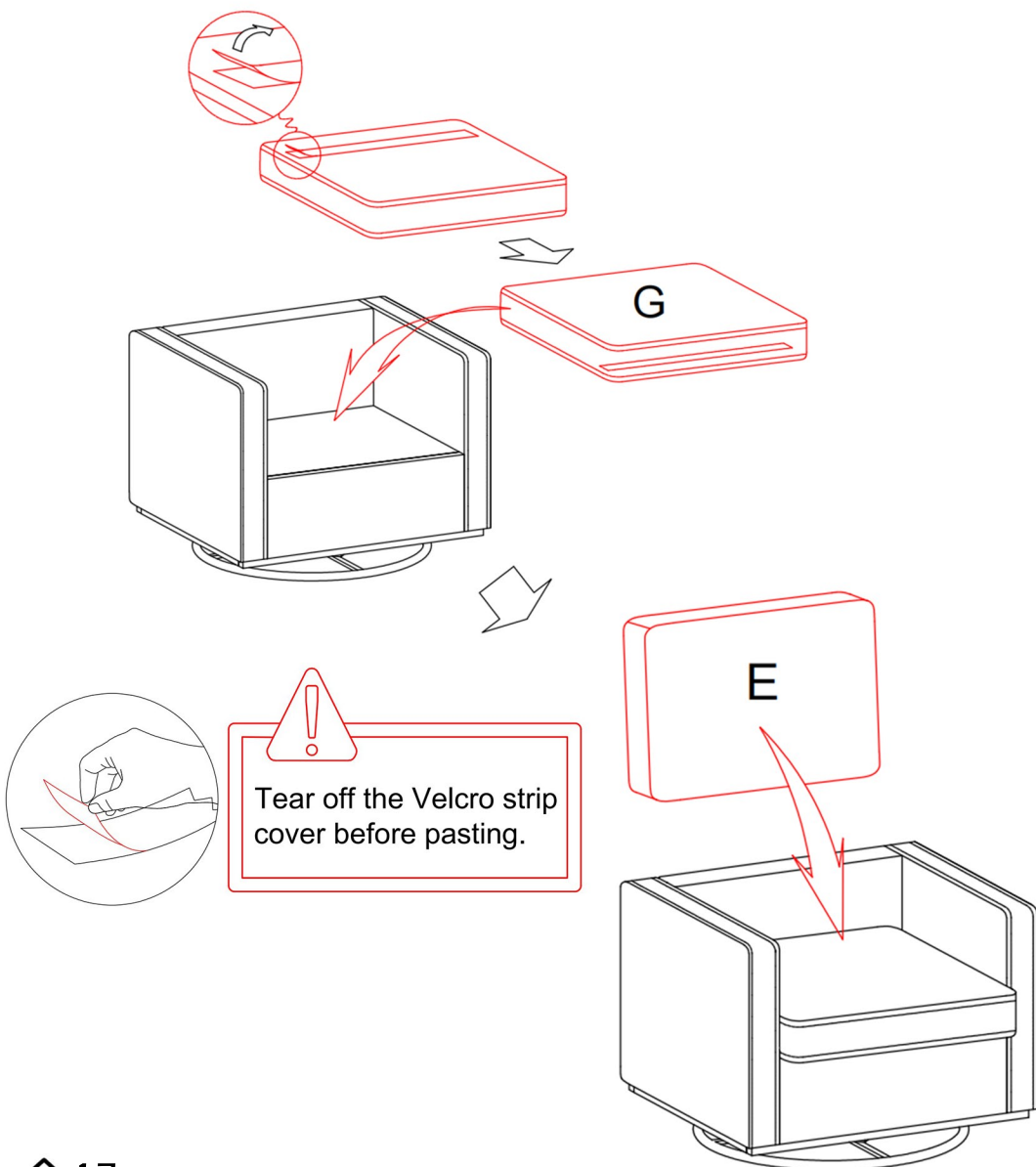

# step 11

The chair has a swivel base which allows for 360 degree smooth swivel. Congratulations! You have finished the assembly, thank you again for choosing our product! Please enjoy!

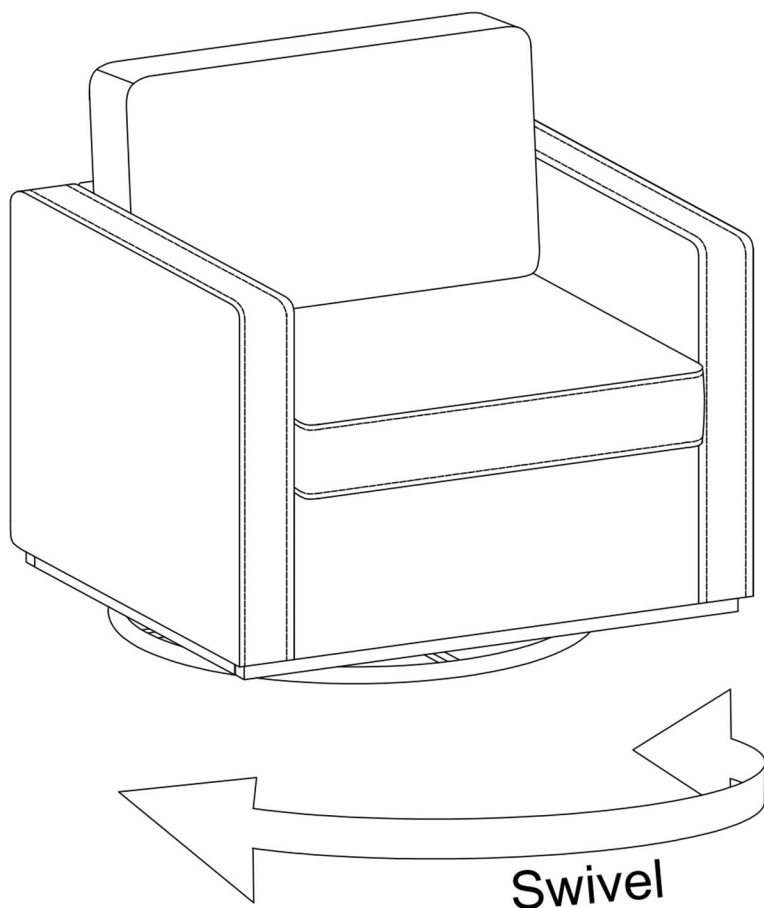



## ASSEMBLY INSTRUCTIONS

Tel.(562)-781-3327

Please contact us:[info@firstopintl.com](mailto:info@firstopintl.com)

<https://www.dreamsidea.com>