

Let's build the

Chuck Bar Stool

SKU 21420

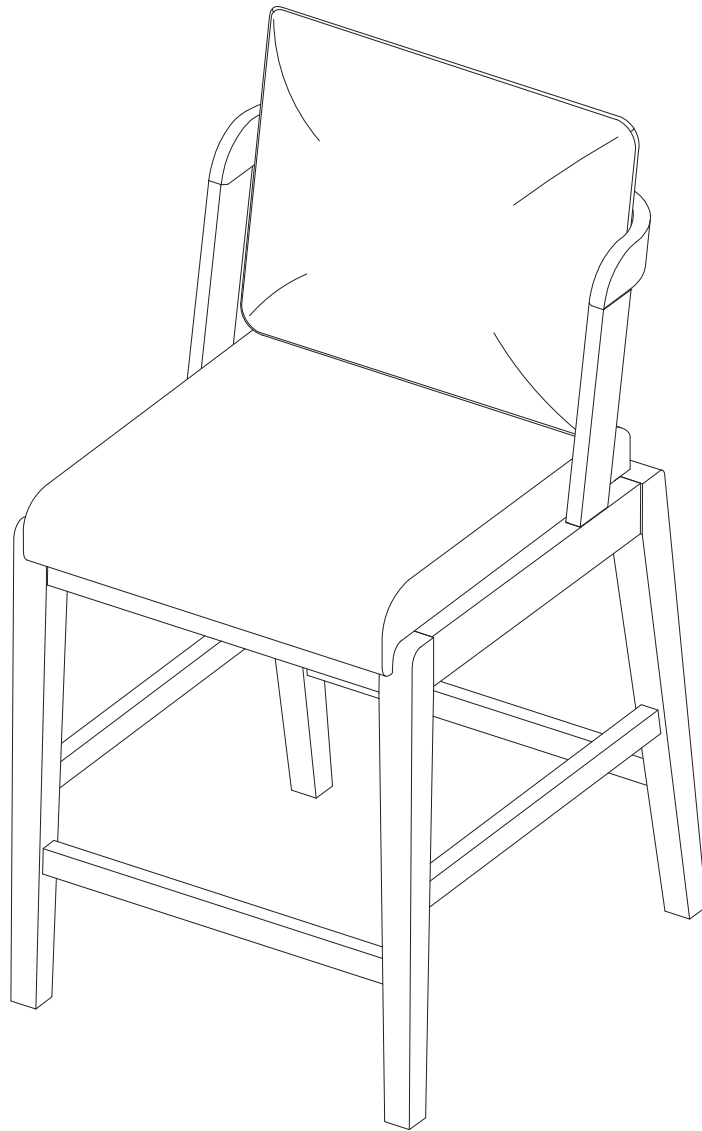

Scan me!

Free Lifetime
Guarantee

 **nathan james**

25-0801-VN

Ok, let's get rolling

This should be easy, just follow our instructions and you will be back to Netflix in no time.

Estimated time for assembly



25:00

What you need

- Some of your favourite bubbly or your preferred relaxant
- Use the packaging carton as a working surface to prevent product damage during assembly
- Phillips screwdriver

Weight Limitation



275
lbs

Toll-free at 1-866-619-1004
Help@nathanjames.com
Nathanjames.com/help

What's included

Description		Qty
A	Seat Assembly	1
B	Front Leg (Right)	1
C	Front Leg (Left)	1
D	Back Leg (Right)	1
E	Back Leg (Left)	1
F	Side Stretcher	2
G	Footrest	2
H	Back Cushion	1
1	Ø1/4" x 60mm Hex Button Head Bolt	8
2	Ø1/4" x 10mm Lock Washer	8
3	Ø1/4" x 19mm Flat Washer	8
4	Allen Key	1
5	M4 x 38mm Phillips Head Screw	8
6	Ø14 x 40 Wooden Toggle (Extra 1pc)	3
7	Plastic Nailhead Foot (Extra)	2
8	Adjustable Leveler (Extra)	2

Scan me!

Free Lifetime
Guarantee



The goods

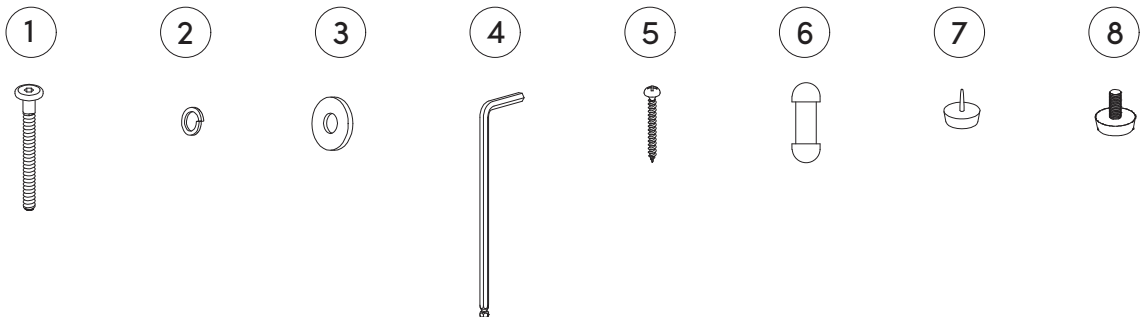
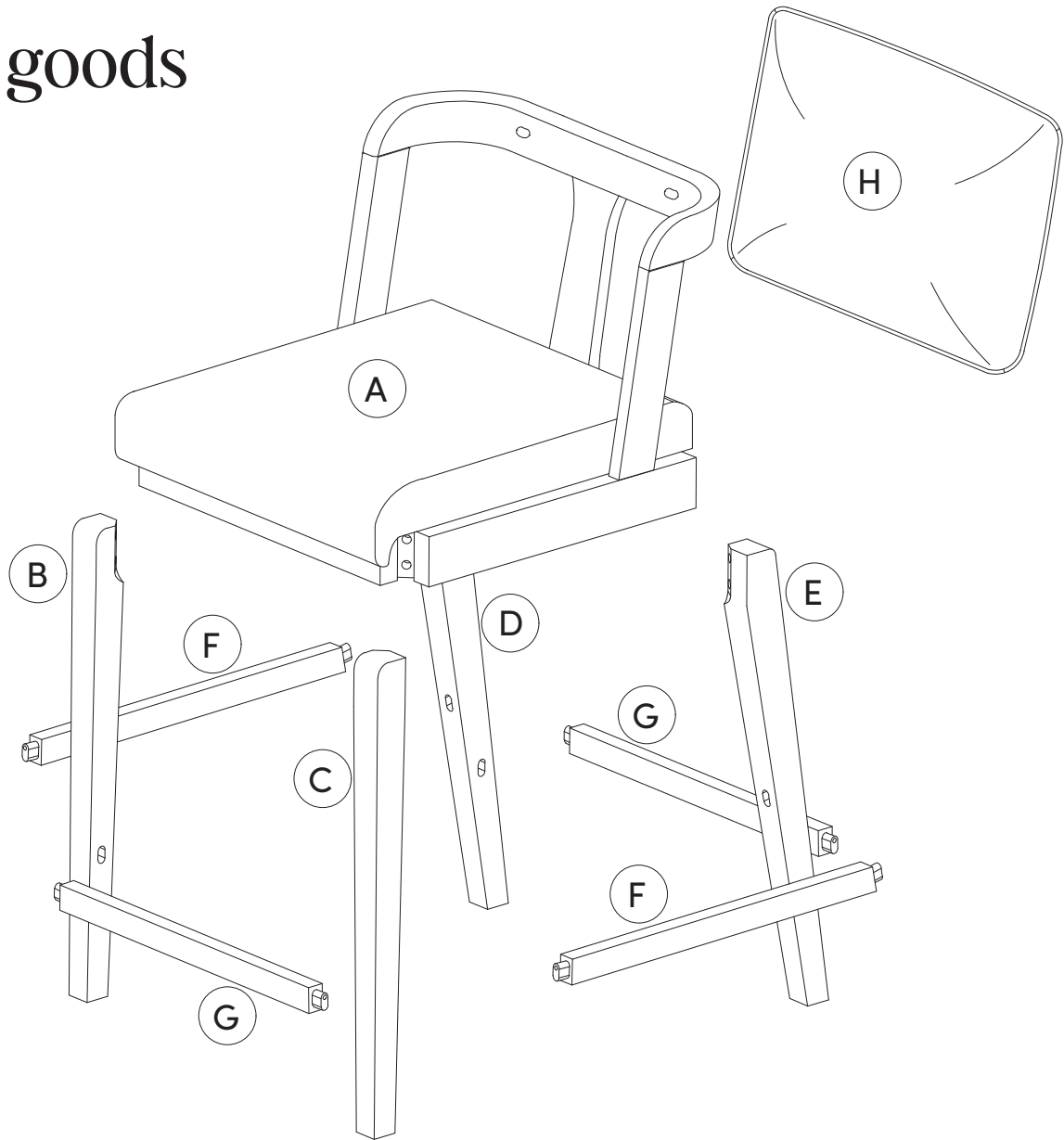

IMPORTANT

1. Do not tighten bolts / screws completely until all bolts / screws are lined up and inserted into holes.
2. Do not over tighten screws and bolts to avoid stripping.
3. Please use hand tools to assemble this product.

Step 1

Let's get this thing fired up!

Secure the Back Leg Left (E) and the Back Leg Right (D) to the Seat Assembly (A) using four sets of 1/4" x 10mm Lock Washers (2), 1/4" x 19mm Flat Washers (3) and 1/4" x 60mm Hex Button Head Bolts (1).

See, we told you this was going to be easy!

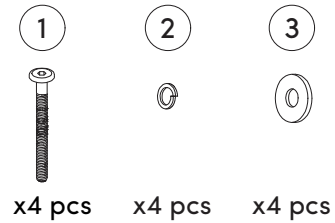

Do NOT overtighten hardware.
Tighten only to 75% for now.

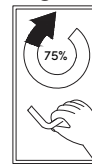

IMPORTANT NOTE:
⚠ Back Legs are not interchangeable.

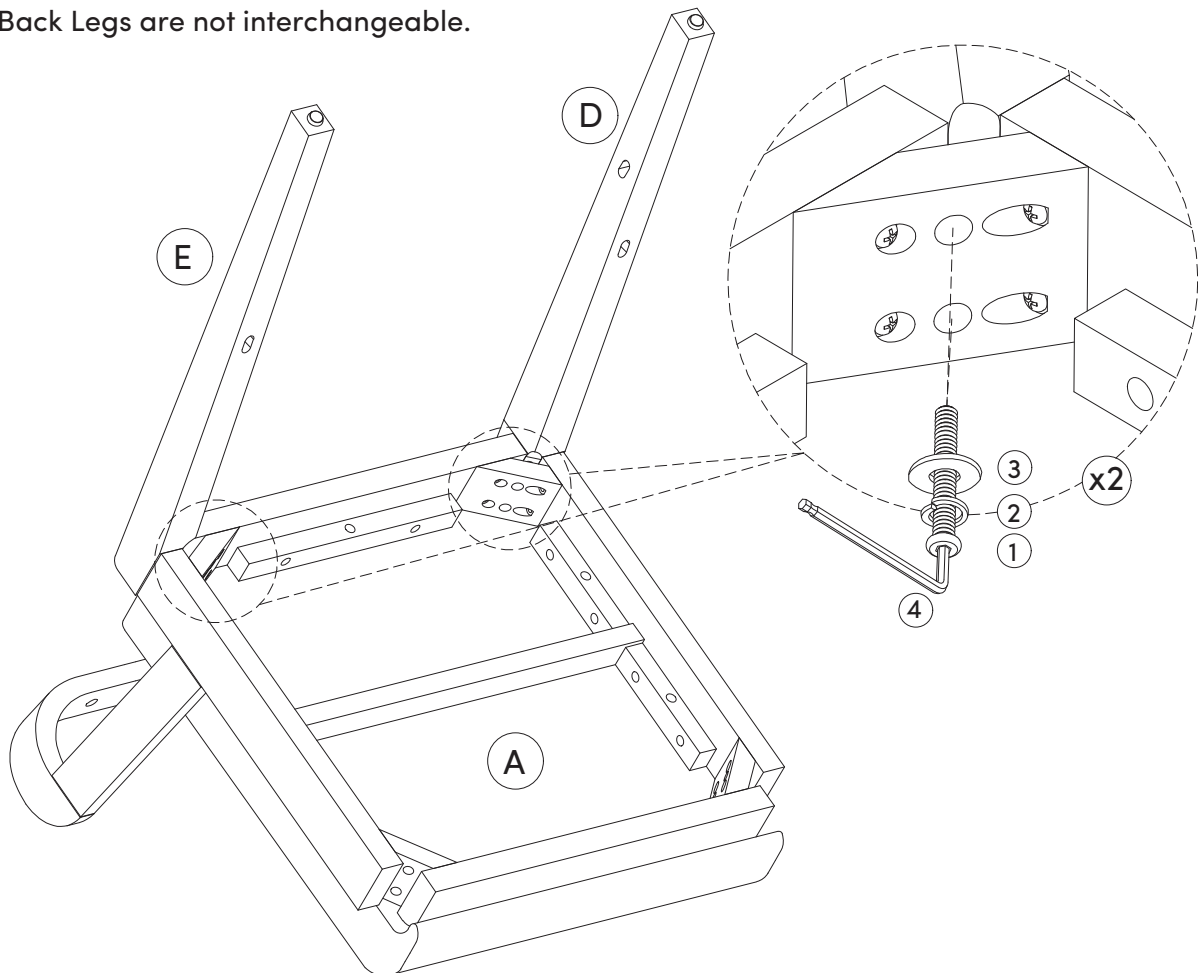

Step 2

Continue securing the Front Leg Left (C) and Front Leg Right (B) to the Seat Assembly (A) using another four sets of 1/4" x 10mm Lock Washers (2), 1/4" x 19mm Flat Washers (3), and 1/4" x 60mm Hex Button Head Bolts (1).

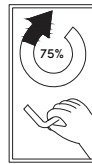
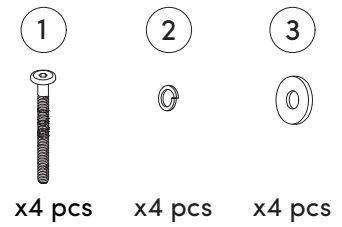

IMPORTANT NOTE:
Front Legs are not interchangeable.

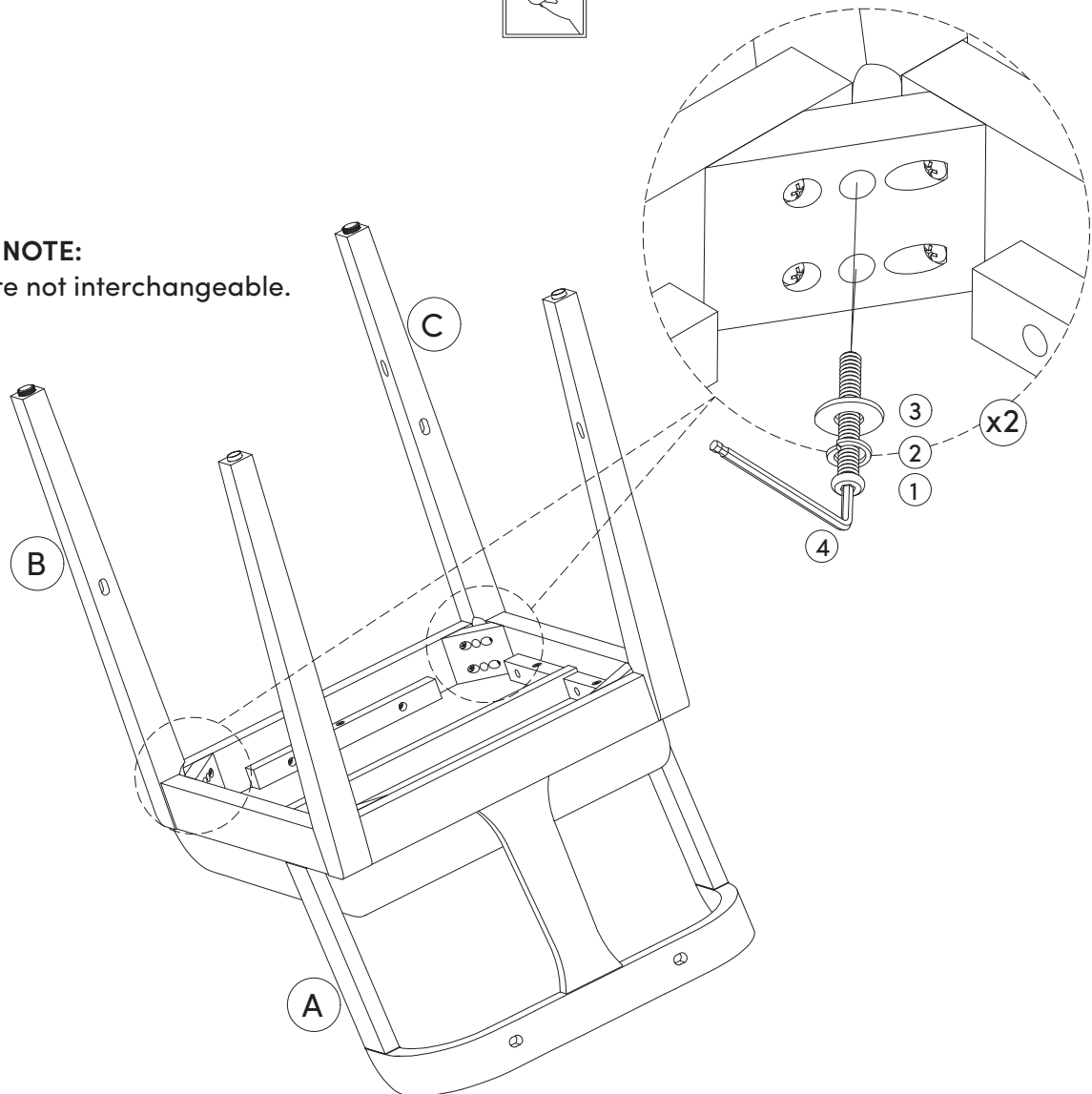

Step 3

Secure the Footrests (G) and the Side Stretchers (F) to the legs using a screwdriver and M4 x38mm Phillips Head Screws (5).

We told you this was going to be easy!

5



x8 pcs

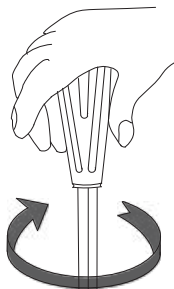

If you are having trouble getting the screws to catch, it is recommended to carefully use an electric screwdriver or drill with necessary bit for this step.

Do not over-tighten; holes may become stripped.



IMPORTANT NOTE:

Screws are installed through the footrest and stretchers at an angle.

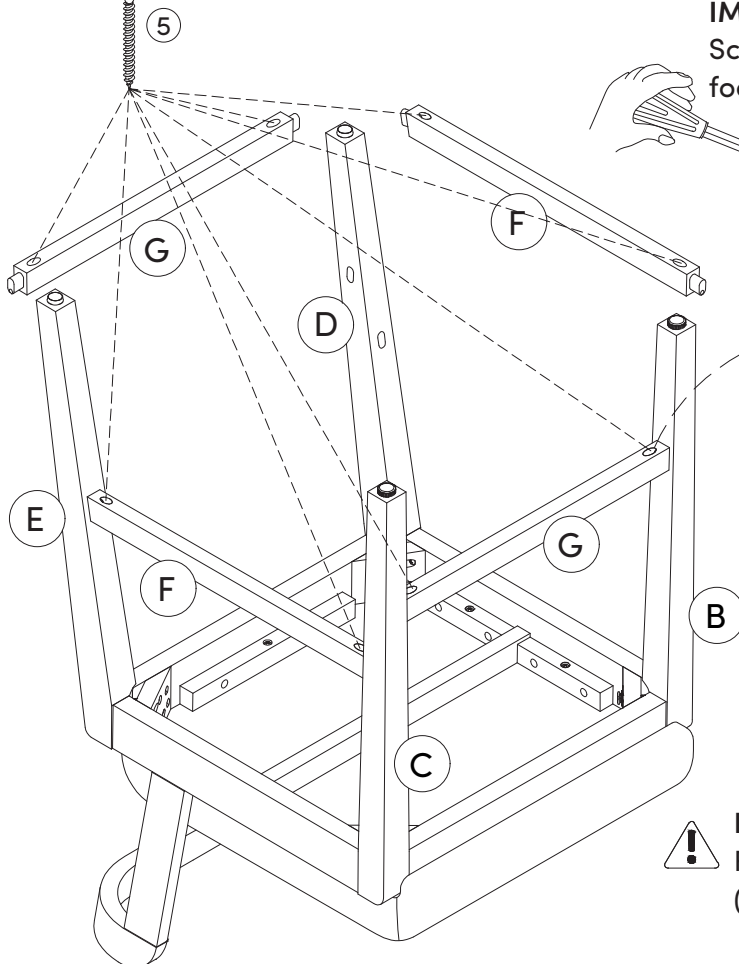
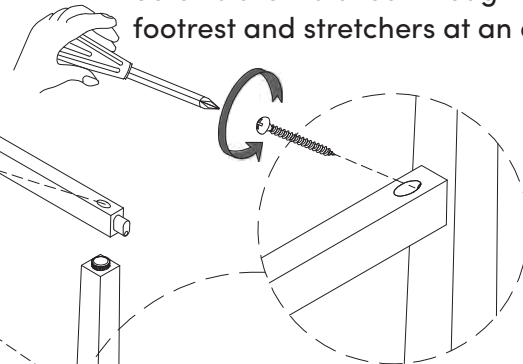

IMPORTANT NOTE:

Front Legs are not interchangeable.
(see following page)

Issues with stretchers aligning at an angle?

If the stretchers are set at an angle when you are aligning them with their respective holes on the front & back legs, **you have likely assembled the front legs incorrectly.**

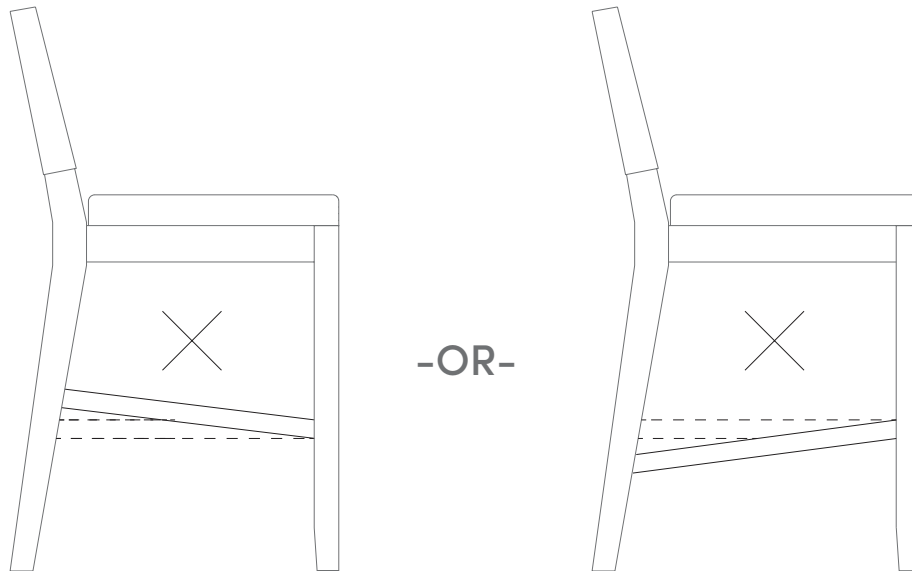

Re-check to confirm that the proper legs are installed in their intended position on the proper side of the stool.

The front legs are not interchangeable; therefore they may need to be rotated and swapped to the opposite side.

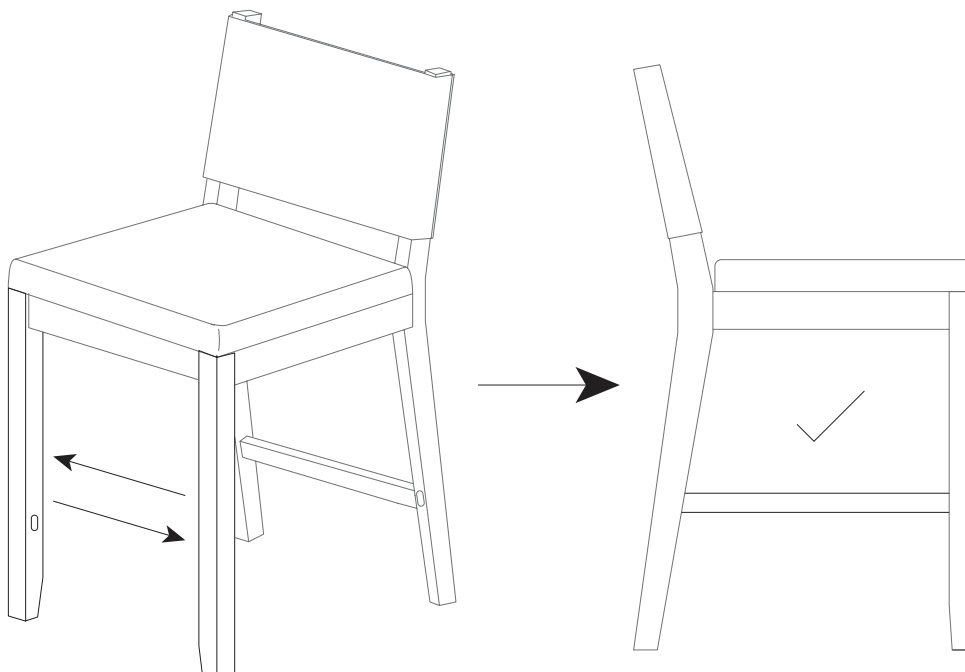

Step 4

Time to install the Back Cushion!

First, insert the ears of the Back Cushion (H) through the holes in the Seat Assembly. Then, secure it in place using the Wooden Toggle (6), as shown below.

6

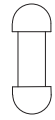

x2 pcs

Step 1

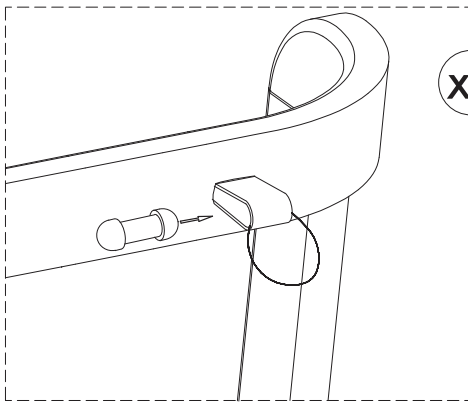

Step 2

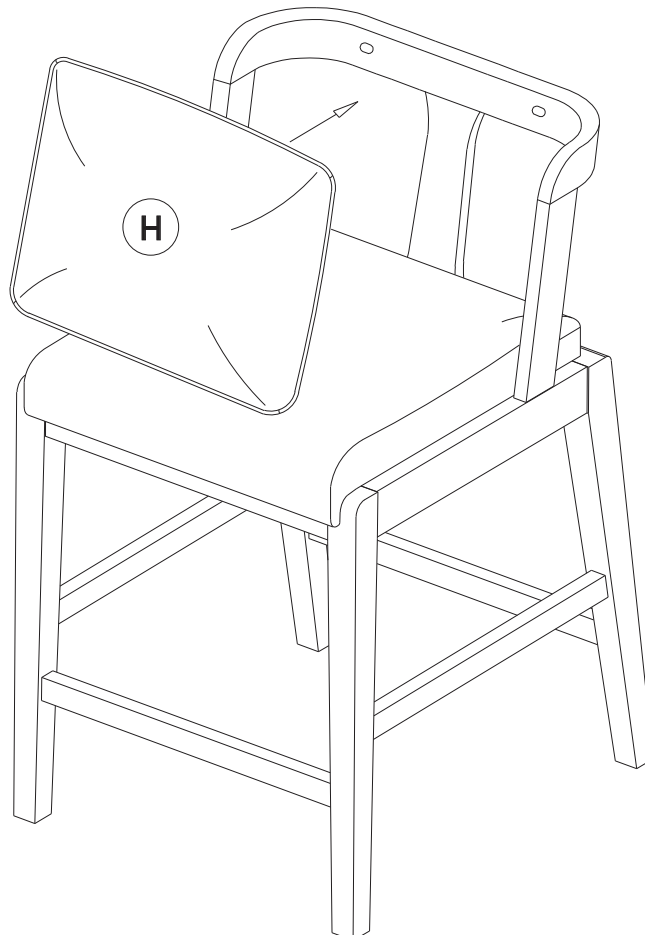
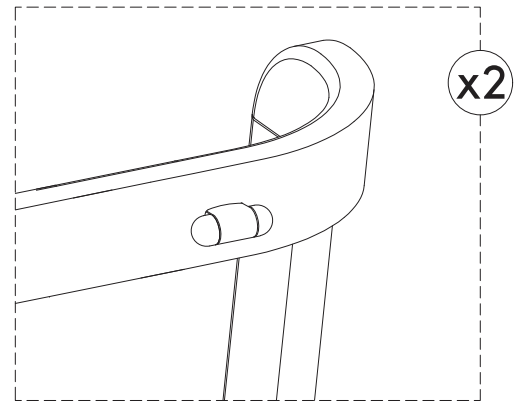

Step 5

Carefully flip the stool over on a flat surface and make sure that the legs are touching the ground evenly before tightening everything to 100%.

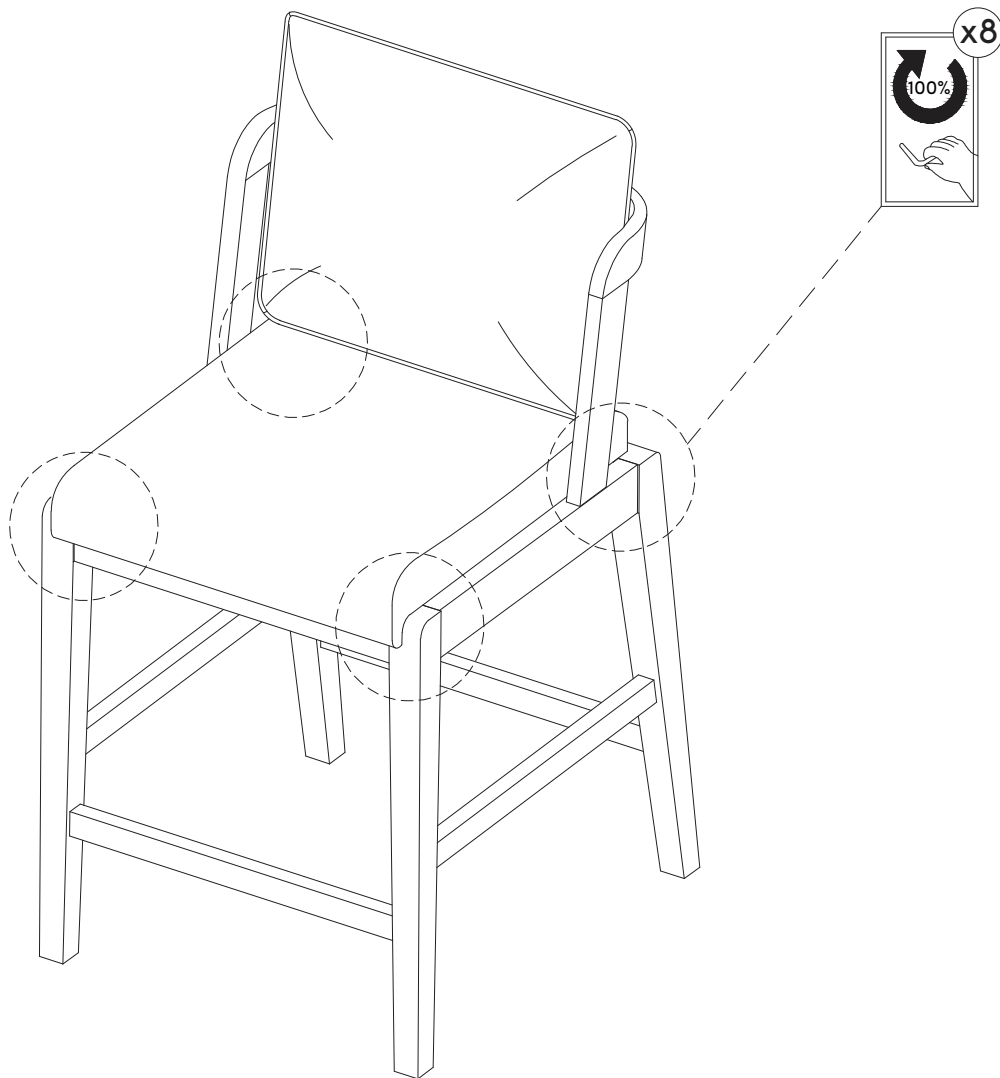

Step 6

Now, for some final fine tuning, if your stool needs it. If it's still looking a little unlevel, adjust the levelers on the feet until it's nice and level.

You did it! Time to pull up a bar stool and celebrate with some pizza!

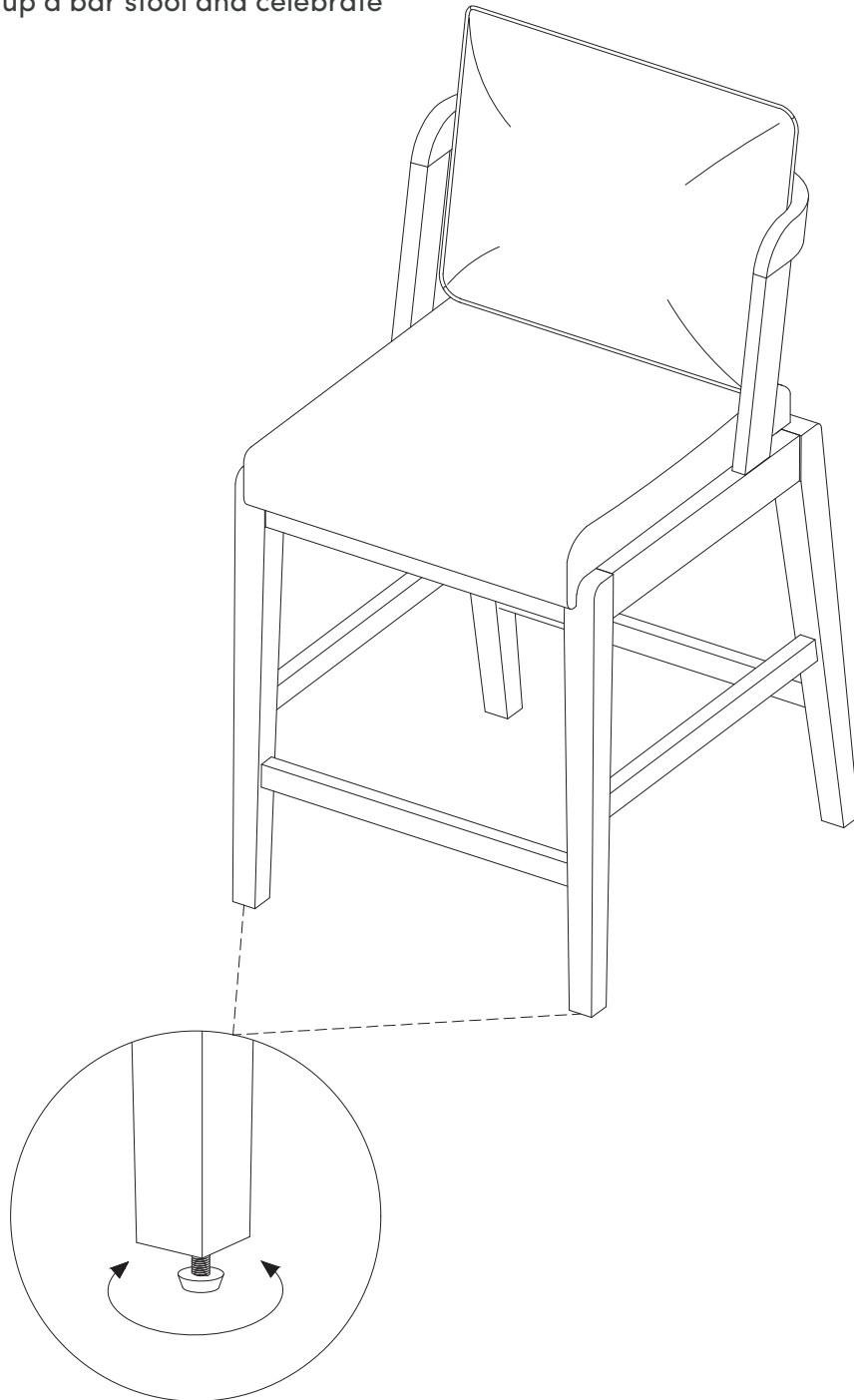

HELPFUL TIP:
Adjust the levelers to help further level the bar stool, if need be.

No heartburn, when we handle the return

Give us a call **1-866-619-1004** or shoot us a message
at **help@nathanjames.com** we will issue you a free
replacement with **zero hassle**.

Our way



Give us a call



Replacement



You

Their way



Re-package item



Schedule pick up



Track package



Replacement



You

We really don't want you to go through the hassle of re-packaging your item
and sending it back, because let's be honest...nobody has time for that.

Safety first, fun later

We want your product to last as long as possible, so we recommend that you tighten the screws 2 weeks after assembly and for added safety check the tightness of all screws every 2 months.

For proper care and treatment, please check our website at NathanJames.com/products

Safe use of this product starts with you.

Use this product responsibly with the primary concern for your safety. Follow assembly instructions carefully and inspect product upon receipt and each use.

Nathan James and its parent companies cannot be held legally responsible for any injuries or death resulted from failure to follow instructions or improper use of this product.

Do not modify the structure of this product in any way.

Our products have been tested to meet specific safety measures as they were originally intended to be sold. Any modifications will present the risk of creating significant safety issues which NJ will not be responsible for.

Proper use

DO NOT	use for commercial purposes
DO NOT	frolic on bar stool
DO NOT	use bar stool as foot stool
DO NOT	leave spilled liquid on seat
DO NOT	use bar stool if damaged
DO NOT	make temporary repairs
DO NOT	use outdoors

We are only in business if you're happy

For starters, thanks for being you.

☎ Toll-free at 1-866-619-1004

✉ Help@nathanjames.com

🌐 NathanJames.com/help

We do our best to ensure your furniture arrives without any problems, but occasionally mistakes happen—as humans we are imperfect beings. In the event that a part is damaged or missing, we will be more than happy to provide you with replacement part(s) for free.

Lifetime Guarantee

We believe in making things that last. That's why every product is backed by our Lifetime Guarantee. No hidden clauses. No runaround. If it breaks, we'll replace it—plain and simple. This isn't just a promise—it's our commitment to quality, and to you.

This product comes with a Lifetime Guarantee from the date of purchase. Please use your phone to scan the QR code on the cover of this booklet to register your product or visit <https://goo.gl/i9dk3q>



Did we do alright? Please spread the love!

If you are happy with your product, tell your friends and family about us or even better leave us a review online. Spreading the word gives us the opportunity to make more people happy and keep our prices low for your next purchase.

Brooke Burdon

Founder, Nathan James