

ALBERTI WOOD SIDEBOARD

DESIGN #SFV4254

Assembly Instructions

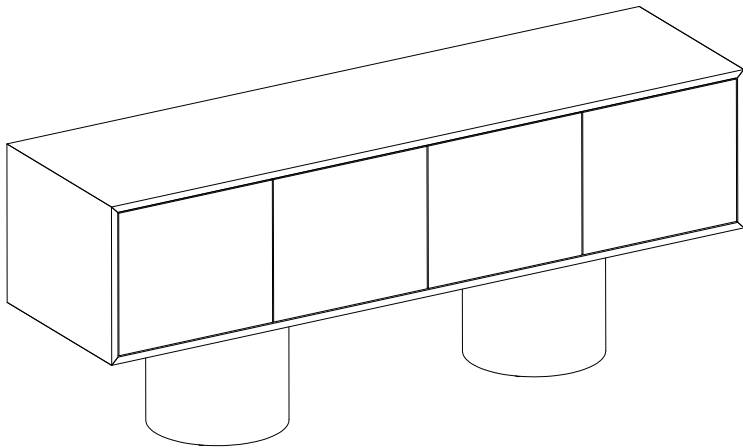

SAFAVIEH
C O U T U R E

Thanks for bringing Safavieh Couture into your home

Everything we make is incredibly simple to set up, including your new sideboard. You won't need any additional tools.

Parts List

A x 1
SIDEBOARD

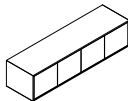

B x 2
LEGS



Hardware List

HW1 x 8
Bolt M6x30mm



HW2 x 1
Allen key



HW3 x 4
Plastic Brackets



HW4 x 2
Restraint straps



HW5 x 4
Screws 4x20mm



HW6 x 4
Plastic anchors



HW57 x 4
Screws 4x40mm



1

Place the Sideboard (A) upside down on a soft surface. Align the screw holes on the bottom of the Sideboard (A) to the screw holes on the Legs (B). Attach them by using the Allen Key (HW2) to screw in the Bolts (HW1).

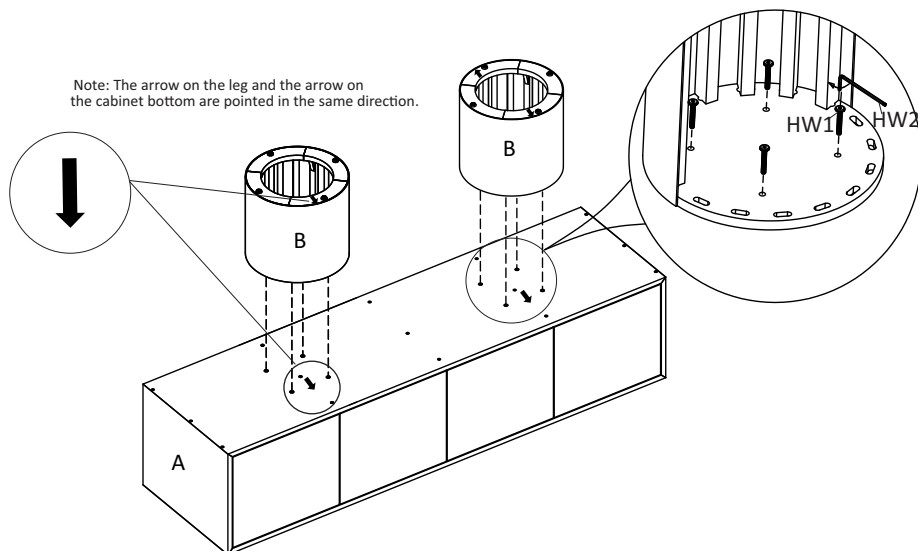

2

To help prevent the possibility of tipping over, install the tipover restraint kit provided.

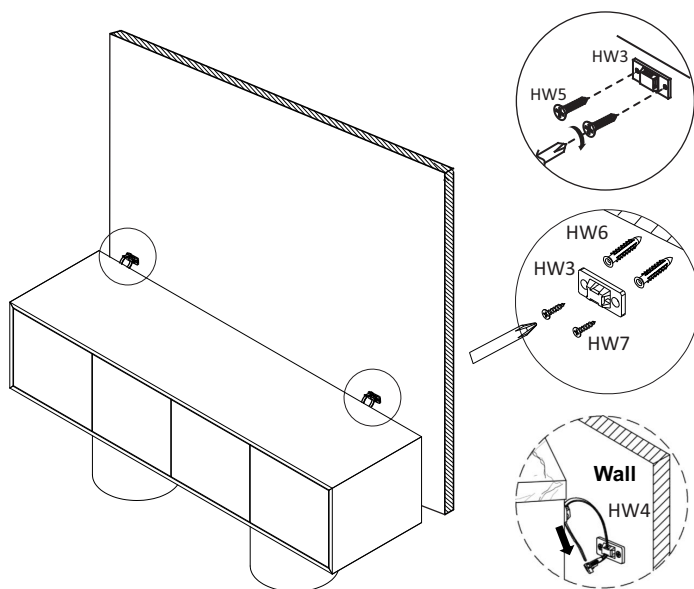

Place the sideboard in the place where you will use it. We'd love to see it – just tag us (we're @safavieh) and use the hashtag #safavieh on Instagram!

@safavieh

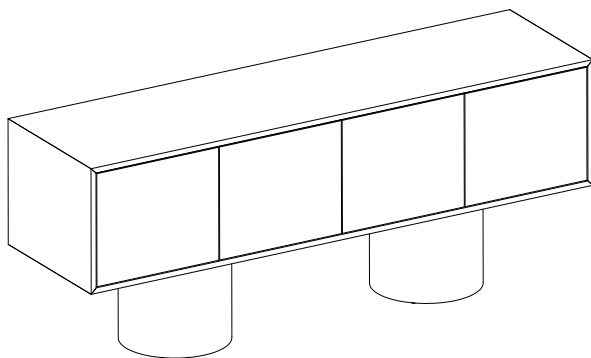

Need help?

Feel free to contact us via email or call
if you have any specific questions!

contact us:

cs@safavieh.com

866-422-9070