

ELLADORA RIBBED FRONT WOOD BOOKCASE

DESIGN# SFV4240

Assembly Instructions

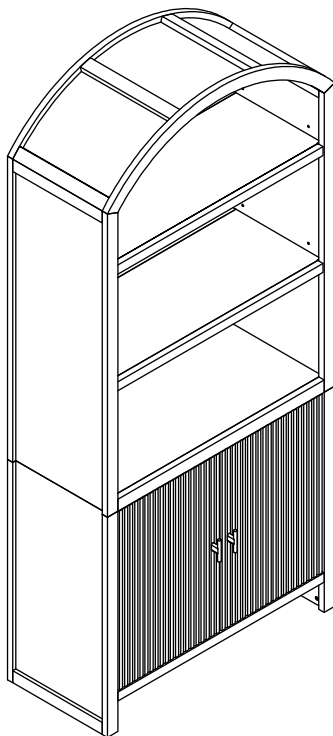

SAFAVIEH
C O U T U R E

Thanks for bringing Safavieh Couture into your home

Everything we make is incredibly simple to set up, including your new bookcase. You won't need any additional tools.

Parts List

A x 1
Hutch



B x 1
Cabinet

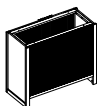

Hardware List

HW1 x 4
Bolt M6x30mm



HW2 x 4
Flat Washer M6x16mm



HW3 x 4
Spring washer M6x10mm



HW4 x 1
Allen key



HW5 x 2
Handle



HW6 x 2
Bolt M4x25



HW7 x 4
Plastic Brackets



HW8 x 2
Restraint straps



HW9 x 4
Screws 4x20mm



HW10 x 4
Plastic anchors

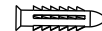

HW11 x 4
Screws 4x40mm



1

Place the Spring Washers (HW3) and the Flat Washers (HW2) on the Bolts (HW1) in the order shown below. Align the screw holes on the Hutch (A) to the screw holes on the Cabinet (B). Attach them by using the Allen Key (HW4) to screw in the bolts (HW1) with the washers.

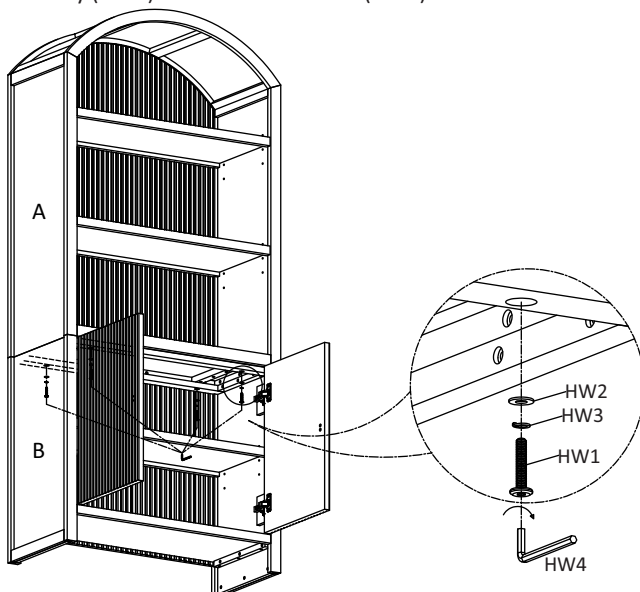

2

Attach the Handles (HW5) to the doors by using a Philips Head Screwdriver to screw in the Bolts (HW6).

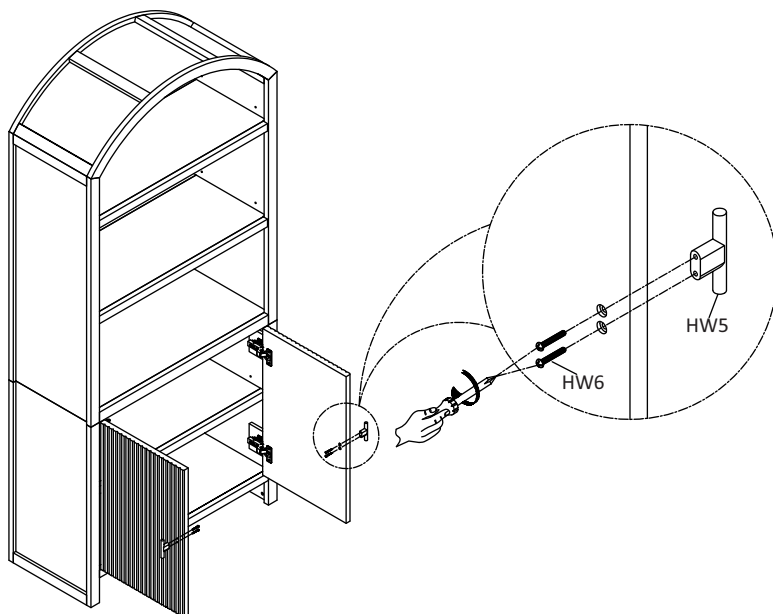

3

To help prevent the possibility of tipping over, install the tip over restraint kit provided.

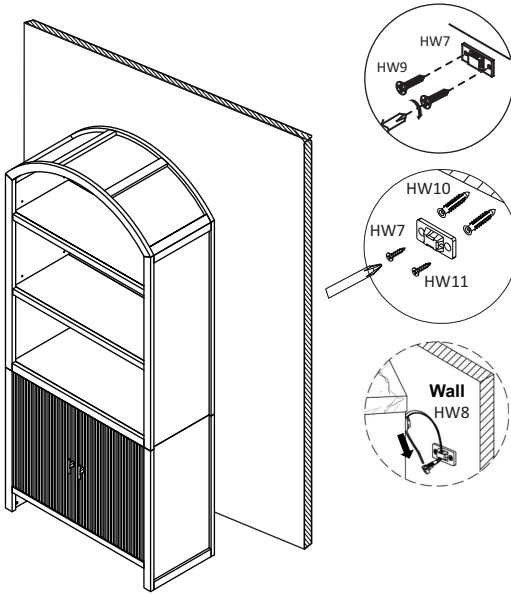

4

Place the bookcase in the place where you will use it. We'd love to see it – just tag us (we're @safavieh) and use the hashtag #safavieh on Instagram!

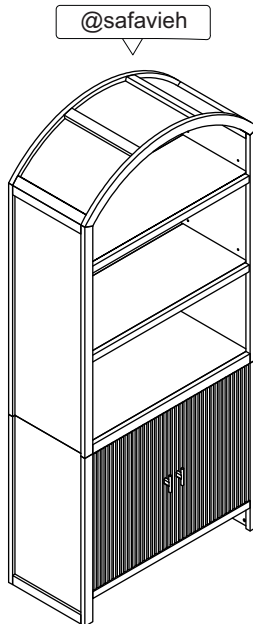

Need help?

Feel free to contact us via email or call
if you have any specific questions!

contact us:

cs@safavieh.com

866-422-9070