

FRANCESCO 4 SHELF WOOD BOOKCASE

DESIGN# SFV4238

Assembly Instructions

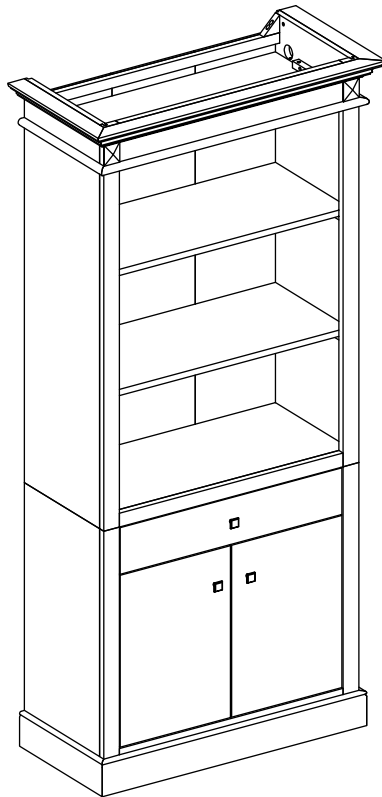



SAFAVIEH
C O U T U R E

Thanks for bringing Safavieh Couture into your home

Everything we make is incredibly simple to set up, including your new bookcase. You won't need any additional tools.

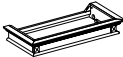
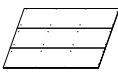
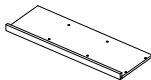
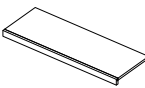
Parts List

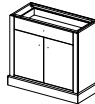
A x 1 Top panel	
B x 1 Back panel	
C x 1 Left side panel	
D x 1 Right side panel	
E x 2 Shelves	
F x 1 Bottom panel	
G x 1 Base	

Hardware List

HW1 x 12 Bolt M6x30mm	
HW2 x 4 Bolt M6x40mm	
HW3 x 4 Bolt M8x35mm	
HW4 x 4 Semicircle washer	
HW5 x 1 Allen key	
HW6 x 4 Wooden dowel	
HW7 x 24 Screws 4x20mm	
HW8 x 4 Flat Washer M8x16mm	
HW9 x 4 Spring washer M8x14mm	
HW10 x 4 Plastic Brackets	
HW11 x 2 Restraint straps	
HW12 x 4 Screws 4x20mm	
HW13 x 4 Plastic anchors	
HW14 x 4 Screws 4x40mm	

1

Align the screw holes on the Left side panel (C) to the screw holes on the Shelves (E) and Bottom panel (F). Attach them by using the Allen key (HW5) to screw in the Bolts (HW1).

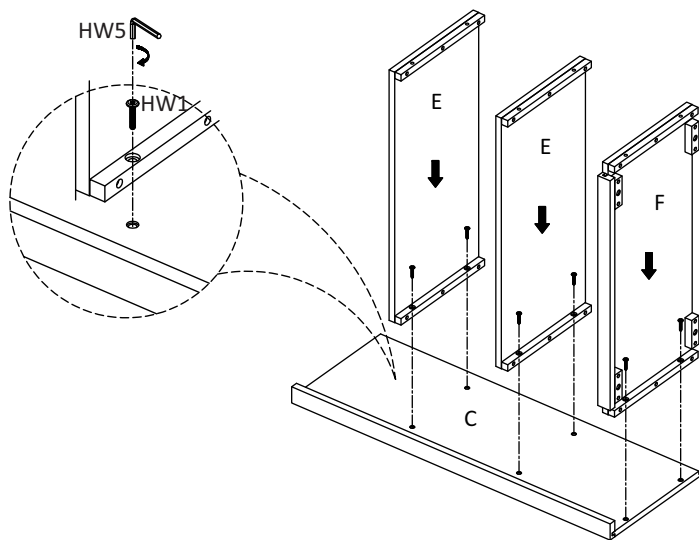

2

Repeat steps 1 to attach the Right side panel (D) to the other side of the Shelves (E) and the Bottom panel (F).

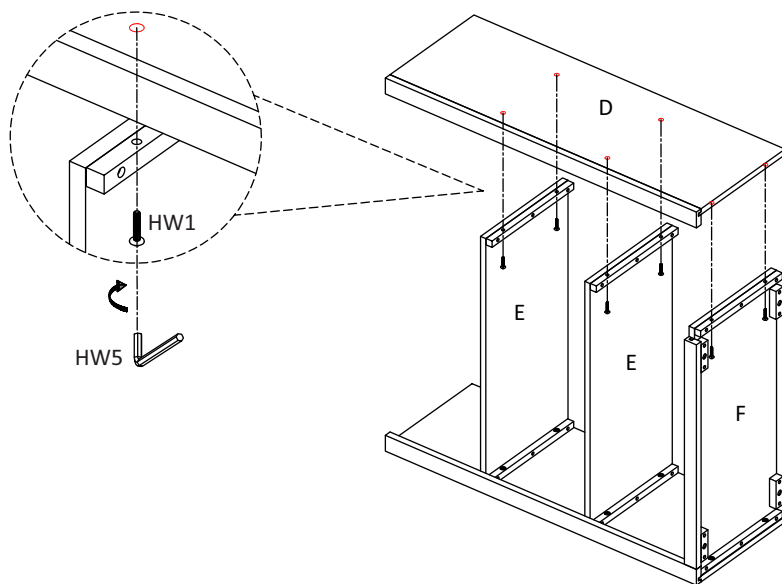

3

Insert one end of the dowels (HW6) into the top of the assembled shelves and the other end into the top panel (A) as shown below.

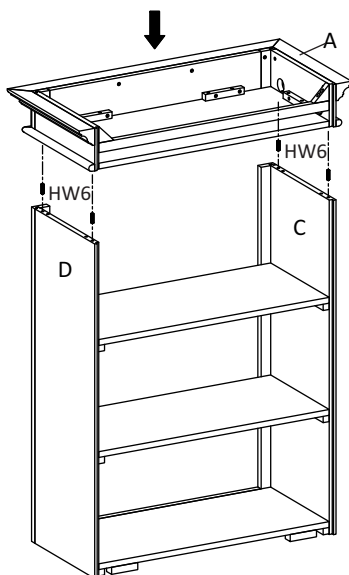

4

Place the Semicircle washer (HW4) on the Bolts (HW2). Insert the Bolts (HW2) with the Semicircle washers (HW4) into the holes in the Top panel (A) as shown below. Attach them by using the Allen key (HW5) to screw in the Bolts (HW2) with the washers.

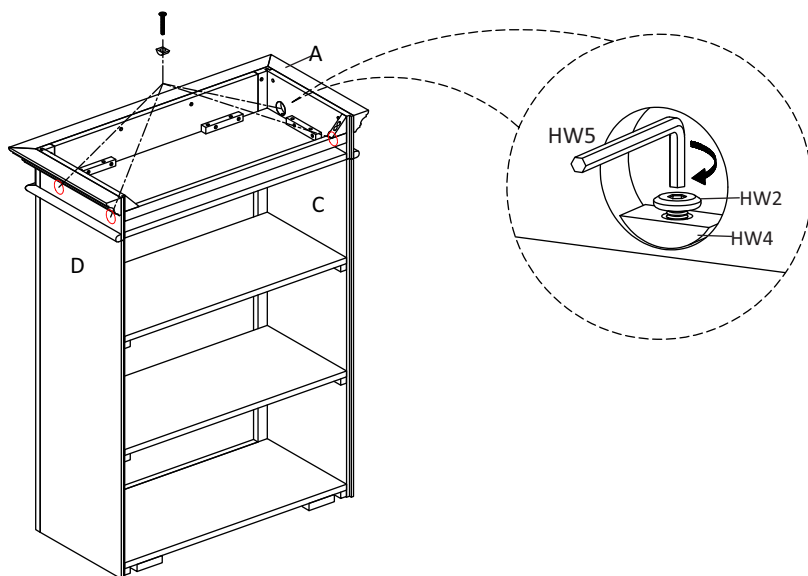

5

Attach the Back panel (B) to the assembled shelves by using a Philips Head screwdriver to screw in the Screws (HW7) in the spots shown below.

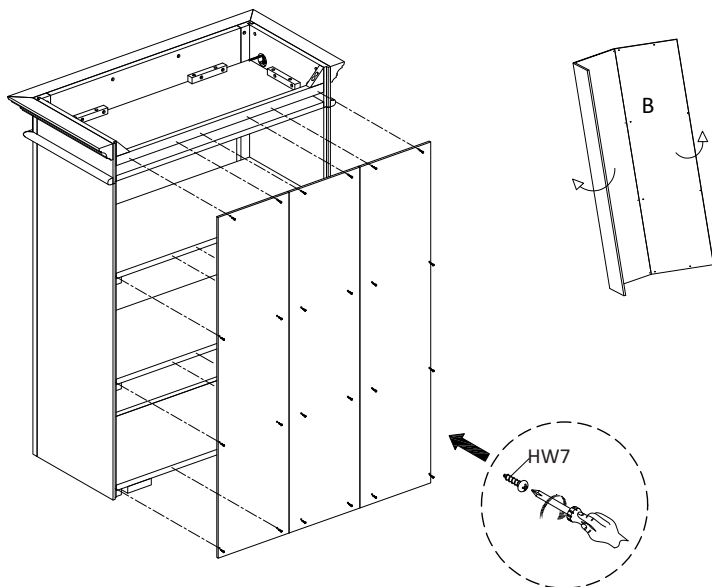

6

Remove the drawers from the Base (G). To remove the drawer, pull the latch on the left up while pushing the latch on the right down. Slide out the drawer. Remove the handles on the inside of the door then assemble on the outside of the door.

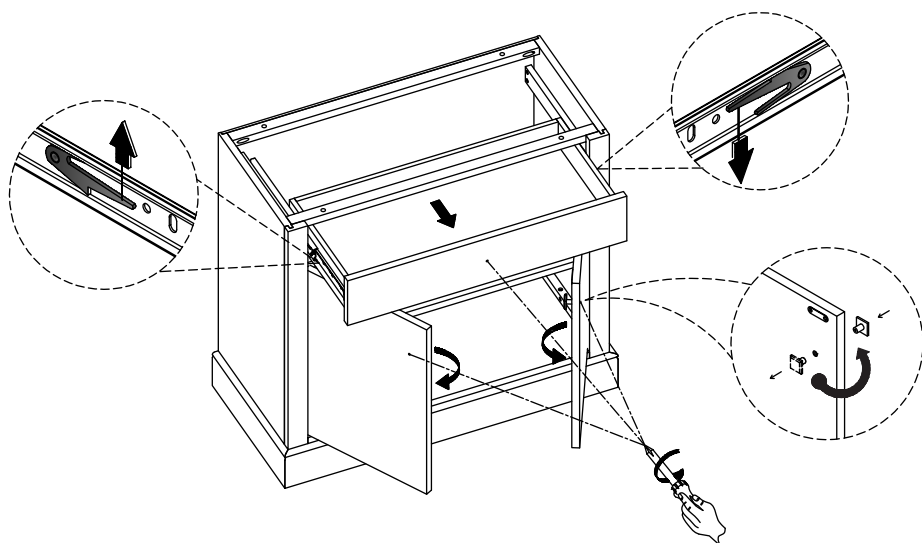

7

Place the Spring Washer (HW9) and Flat Washer (HW8) on the bolts (HW3) as shown. Attach the base (G) to the assembled upper bookcase by using the Allen Key (HW5) to screw in the bolts (HW3) with the washers as shown.

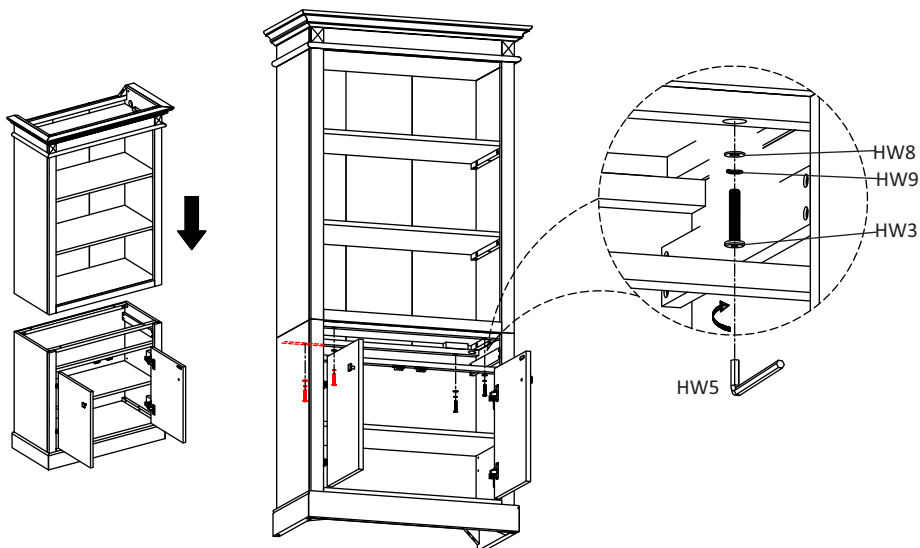

8

Slide the drawers back into the Base (G) by aligning the drawer glides and pushing them in.

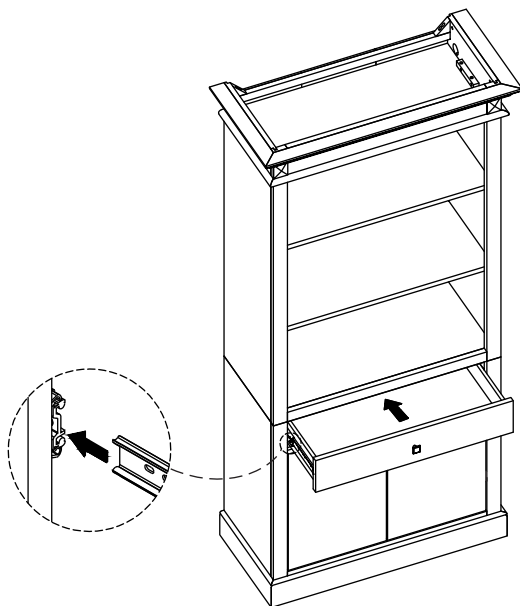

To help prevent the possibility of tipping over, install the tip over restraint kit provided.

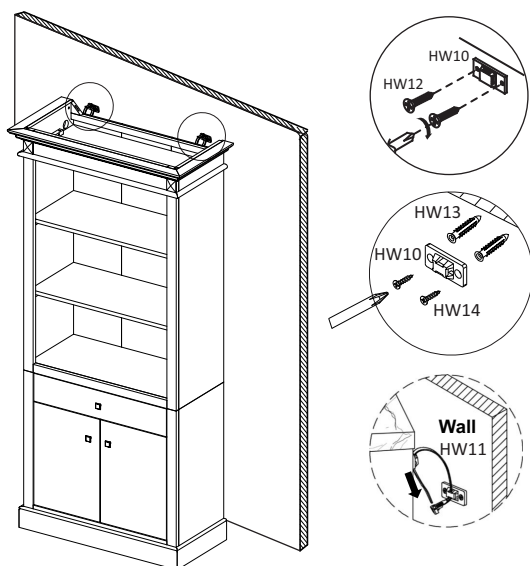

10

Place the bookcase in the place where you will use it. We'd love to see it – just tag us (we're @safavieh) and use the hashtag #safavieh on Instagram!

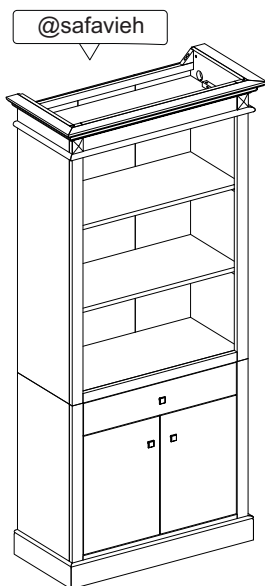

Need help?

Feel free to contact us via email or call
if you have any specific questions!

contact us:

cs@safavieh.com

866-422-9070