

HAYLINA 4 SHELF WOOD BOOKCASE

DESIGN# SFV4237

Assembly Instructions

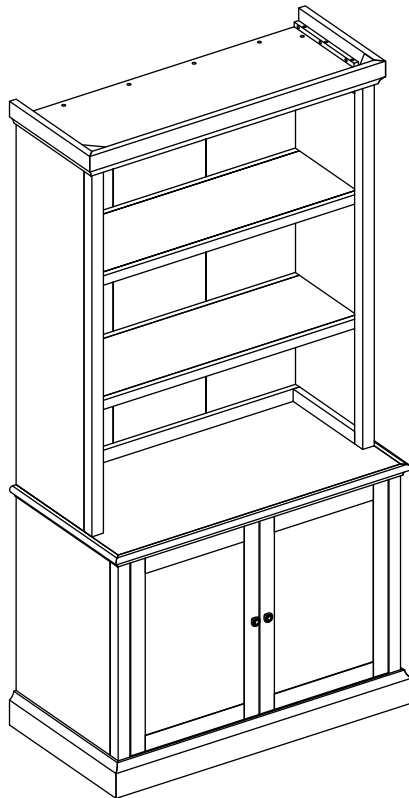

SAFAVIEH
C O U T U R E

Thanks for bringing Safavieh Couture into your home

Everything we make is incredibly simple to set up, including your new bookcase. You won't need any additional tools.

Parts List

A x 1

Top panel



B x 1

Back panel



C x 2

Side panel (L&R)



Dx 2

Shelves



Ex 1

Base

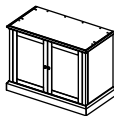

F x 2

Rail



Hardware List

HW1 x 4

Bolt M6x35mm



HW2 x 4

Bolt M8x70mm



HW3 x 12

Bolt M8x30mm



HW4 x 4

Semicircle washer



HW5 x 1

Allen key



HW6 x 16

Wooden dowel



HW7 x 24

Screws 4x20mm

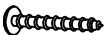

HW8 x 4

Plastic Brackets



HW9 x 2

Restraint straps



HW10 x 4

Screws 4x20mm



HW11 x 4

Plastic anchors



HW12 x 4

Screws 4x40mm



1

Insert one end of the dowels (HW6) into the side panel (C) and the other end into the rails (F). Place the semicircle washer (HW4) on the bolts (HW1). Insert the Bolts (HW1) with the washers (HW4) into the holes in the rails (F) as shown below. Attach them by using the Allen Key (HW5) to screw in the bolts (HW1) with the washers.

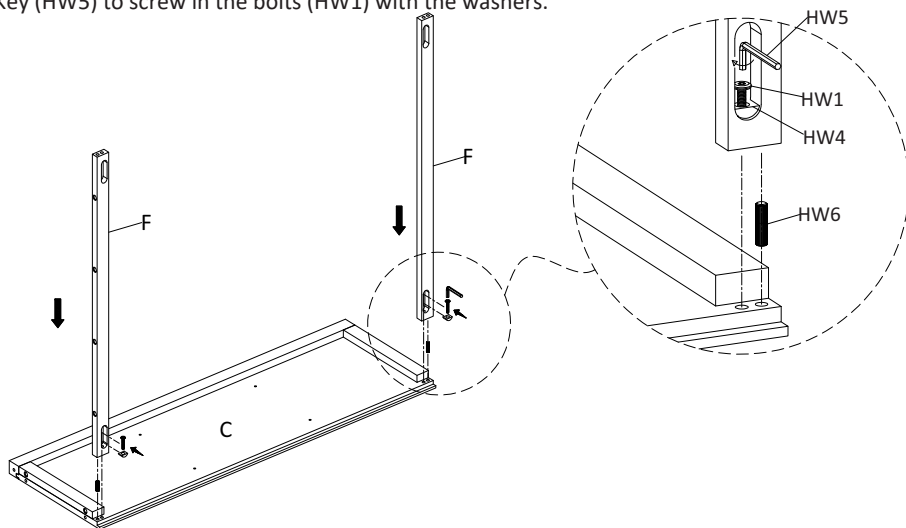

2

Insert the pegs underneath the shelves (D) into the holes in the side panel (C).

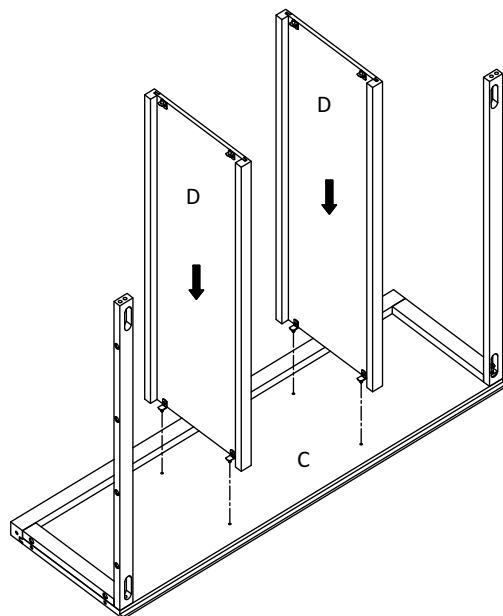

3

Repeat steps 1-2 to attach the second side panel (C) to the other side of the shelves (D) and the rails (F).

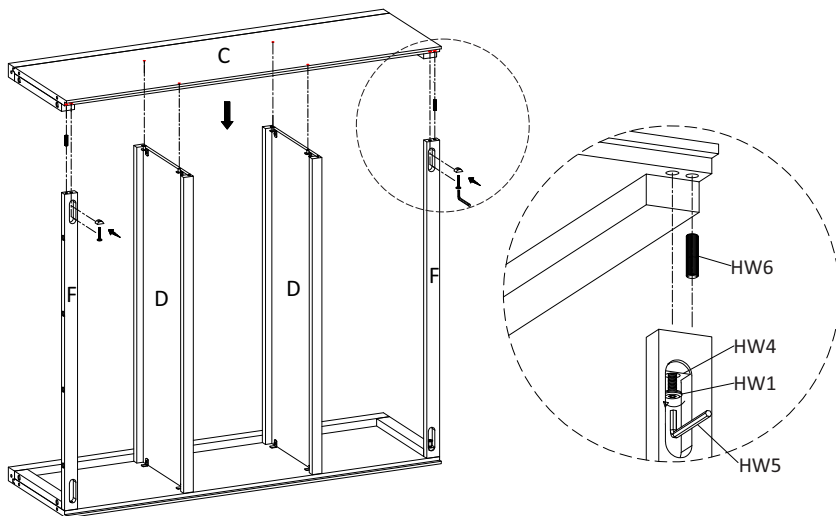

4

Insert one end of the dowels (HW6) into the top of the assembled shelves and the other end into the top panel (A) as shown below. Attach the top panel (A) by using the Allen Key (HW5) to screw in the Bolts (HW3) in the spots shown below.

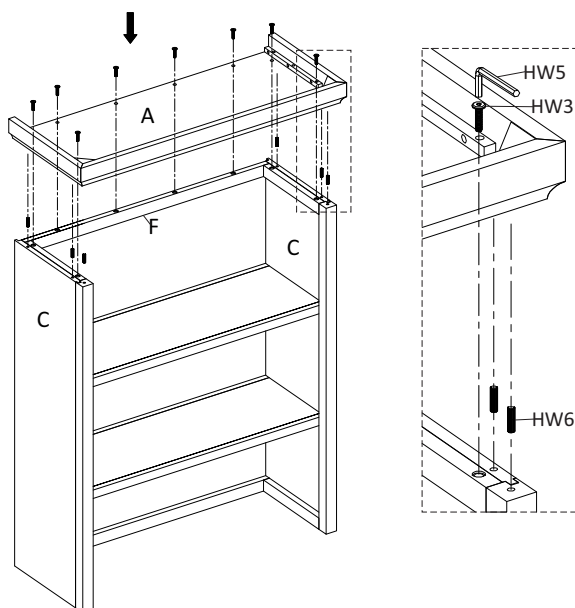

5

Attach the back panel (B) to the assembled shelves by using a Philips Head screwdriver to screw in the screws (HW7) in the spots shown below.

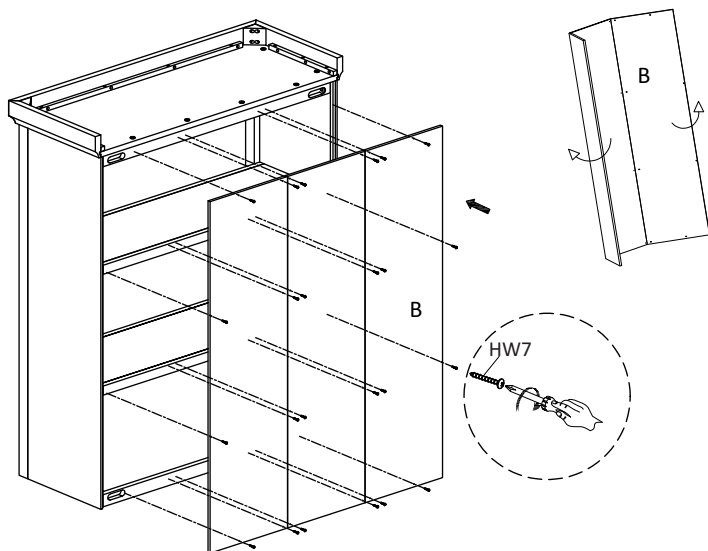

6

Insert one end of the dowels (HW6) into the top of the base (E). Insert the other end into the bottom of the assembled shelves.

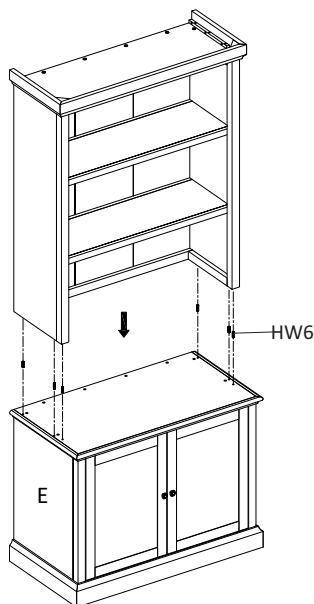

7

Attach them by using the Allen Key (HW5) to screw in the Bolts (HW3) in the spots shown below.

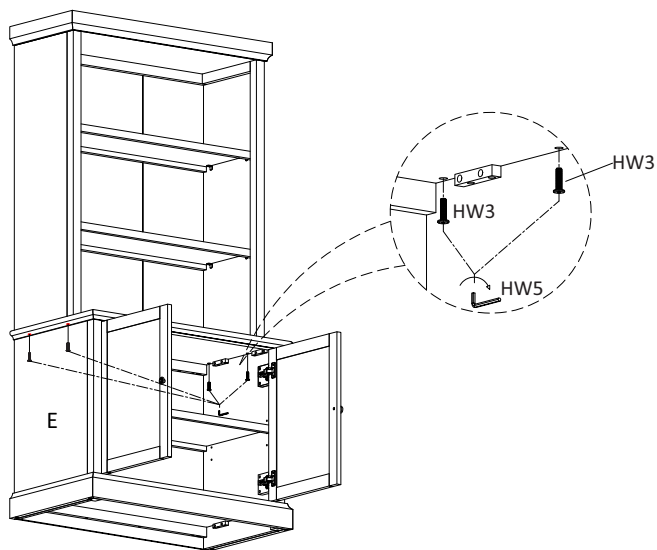

8

Attach them by using the Allen Key (HW5) to screw in the Bolts (HW2) in the spots shown below.

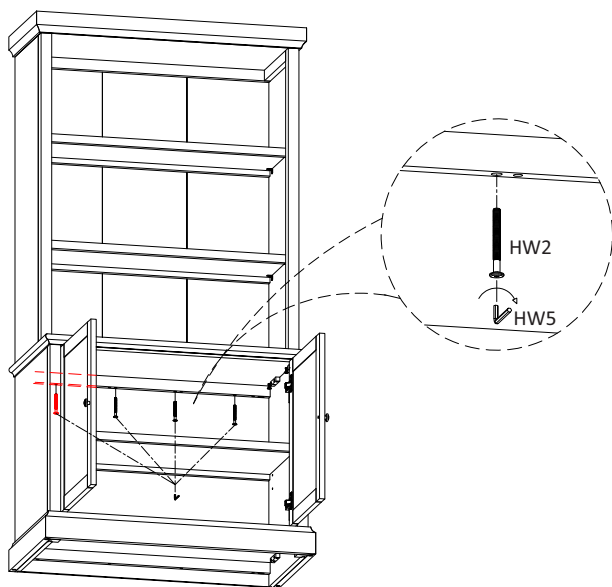

To help prevent the possibility of tipping over, install the tip over restraint kit provided.

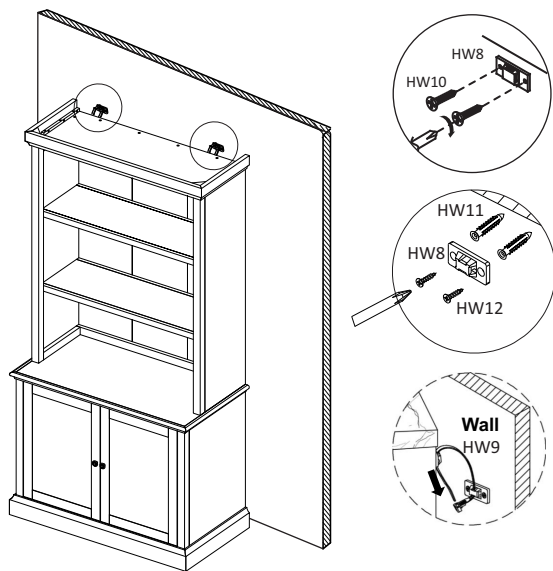

10

Place the bookcase in the place where you will use it. We'd love to see it – just tag us (we're @safavieh) and use the hashtag #safavieh on Instagram!

@safavieh

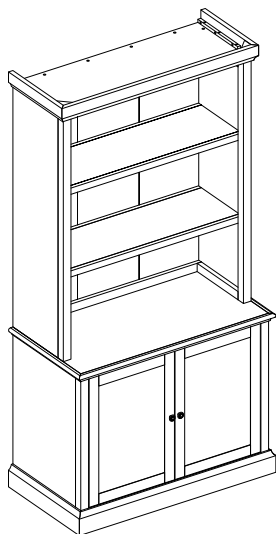

Need help?

Feel free to contact us via email or call
if you have any specific questions!

contact us:

cs@safavieh.com

866-422-9070