











## Assembly Instructions

Caution: You must read this before you proceed

## Care & Maintenance

	• Not for commercial use. For residential use only.
	• Do not put hot items directly on furniture surface.
	• Do not clean furniture with harsh cleansers or polish.
	• Do not place furniture under direct sunlight.
	• Do not place furniture near heating or cooling vents.
	• Do not write on furniture without a padded barrier to protect the surface.
	• Do not place furniture outside . For indoor use only.
	• Stains may be removed with mild soap solution and damp cloth.
	• Children should not climb or jump on the furniture.
	• Dust and pick-up spills using a clean, non-colored, lint-free cloth.

Please look in Box for hardware packs and legs.

Sets often ship in multiple boxes and may arrive a day or two apart.

ASSEMBLY INSTRUCTION  
ITEM NO. N776P340272E / N776P340272A

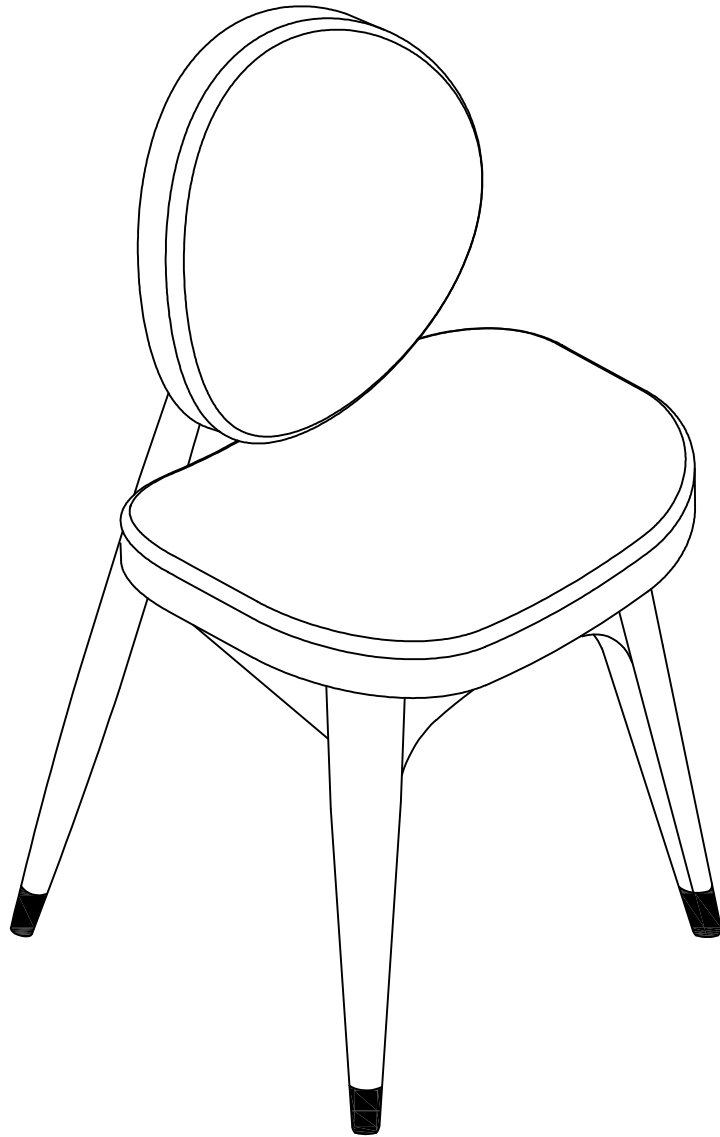

2 - People

ASSEMBLY INSTRUCTION  
ITEM NO. N776P340272E / N776P340272A

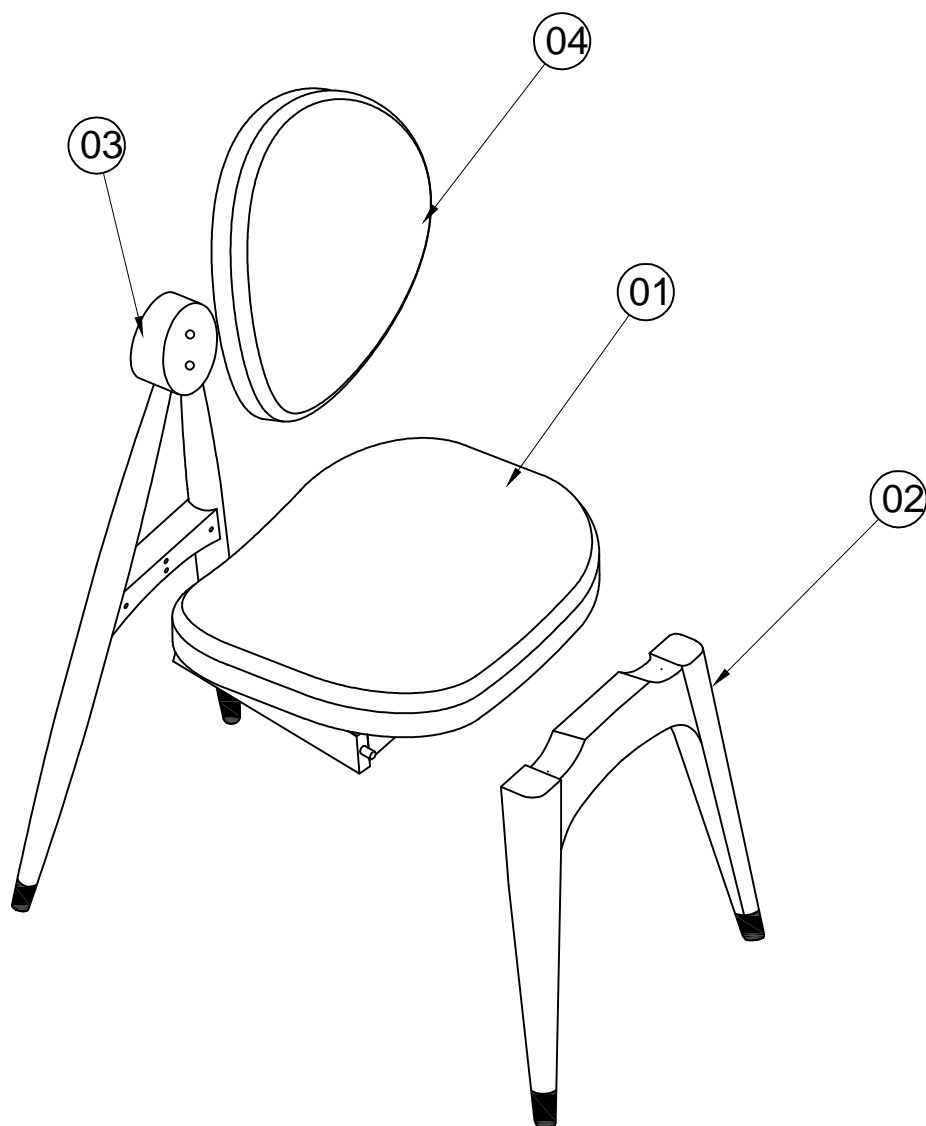

# ASSEMBLY INSTRUCTION

## ITEM NO. N776P340272E / N776P340272A

### PACK LIST

01

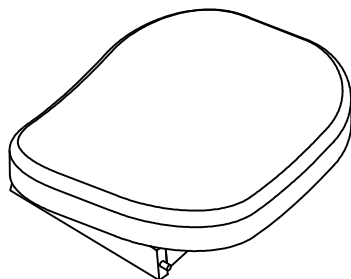

SEAT =1PC

02

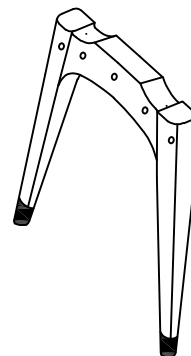

FRONT LEG =1PC

03



BACK LEG =1PC

04

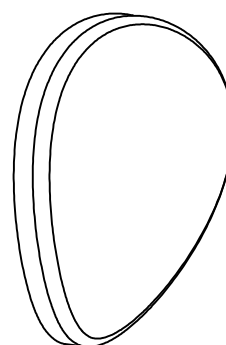

BACKREST =1PC

### HARDWARE LIST

A



ALLEN BOLT (M8\*40MM) = 4PCS

B



ALLEN BOLT (M8\*50MM) = 5PCS

C



ALLEN BOLT (M8\*30MM) = 2PCS

D



SPRING WASHER (M8) = 7PCS

E



FLAT WASHER (M8\*19\*1.5MM) =7PCS

F



ALLEN WRENCH (M5\*68mm)=1PC

## Assembly Preparation Before Beginning Assembly:



- Read instructions, cover to cover-



- Have 2 adults on hand for assembly-



- Do not assemble on flooring or carpet-



- Assemble on a clean non-marring surface (packing foam)-



- Save all packaging until finished-

## Assembly Steps Overview

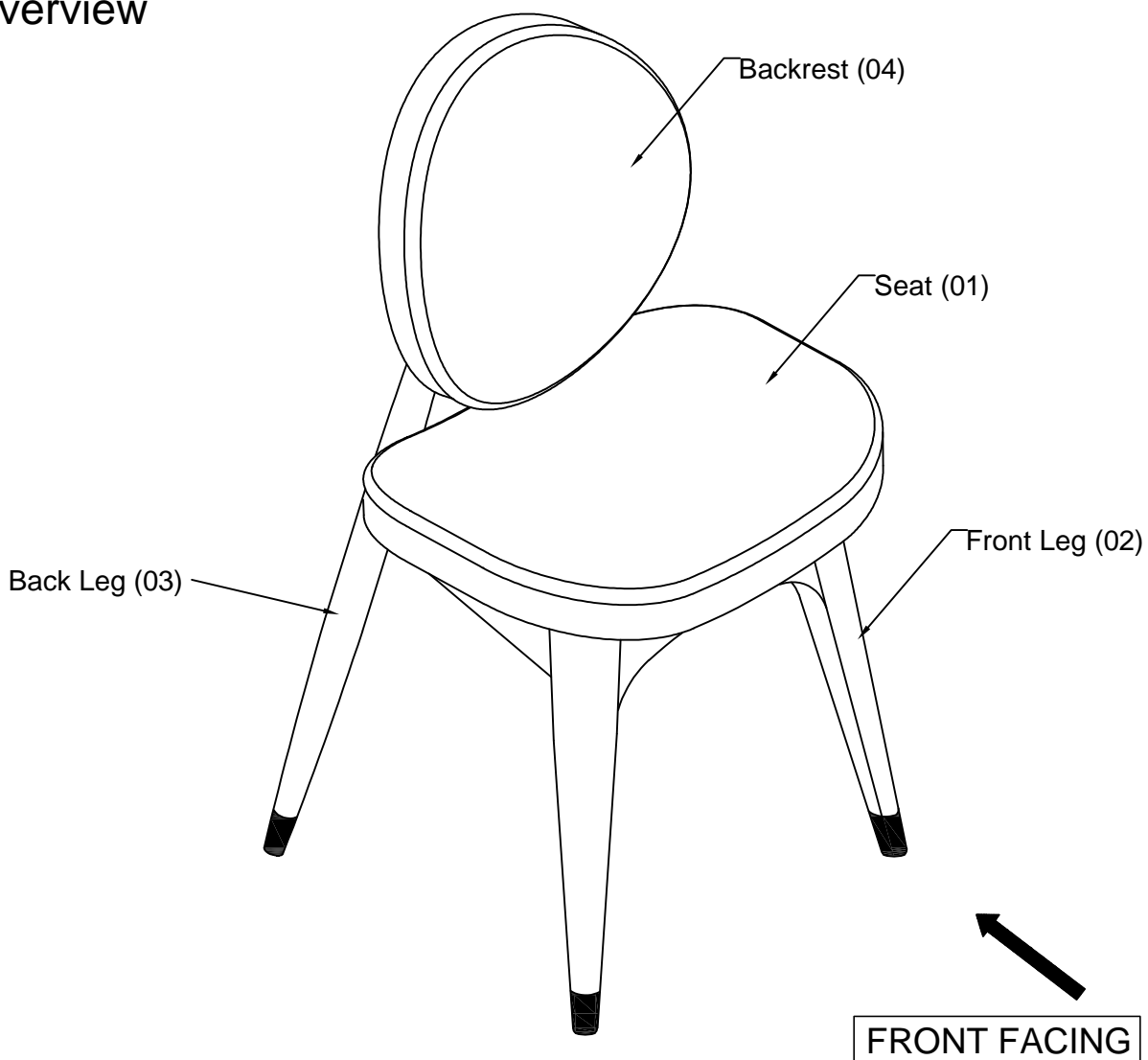

This Sideboard has multiple parts and may require up to some 30 minutes to assemble To give you an overview of the Sideboard parts , the above picture is to help you the various parts into perspective Please read through the instructions below to familiarise yourself with the parts and steps before assembly .

ASSEMBLY INSTRUCTION  
ITEM NO. N776P340272E / N776P340272A

STEP 1

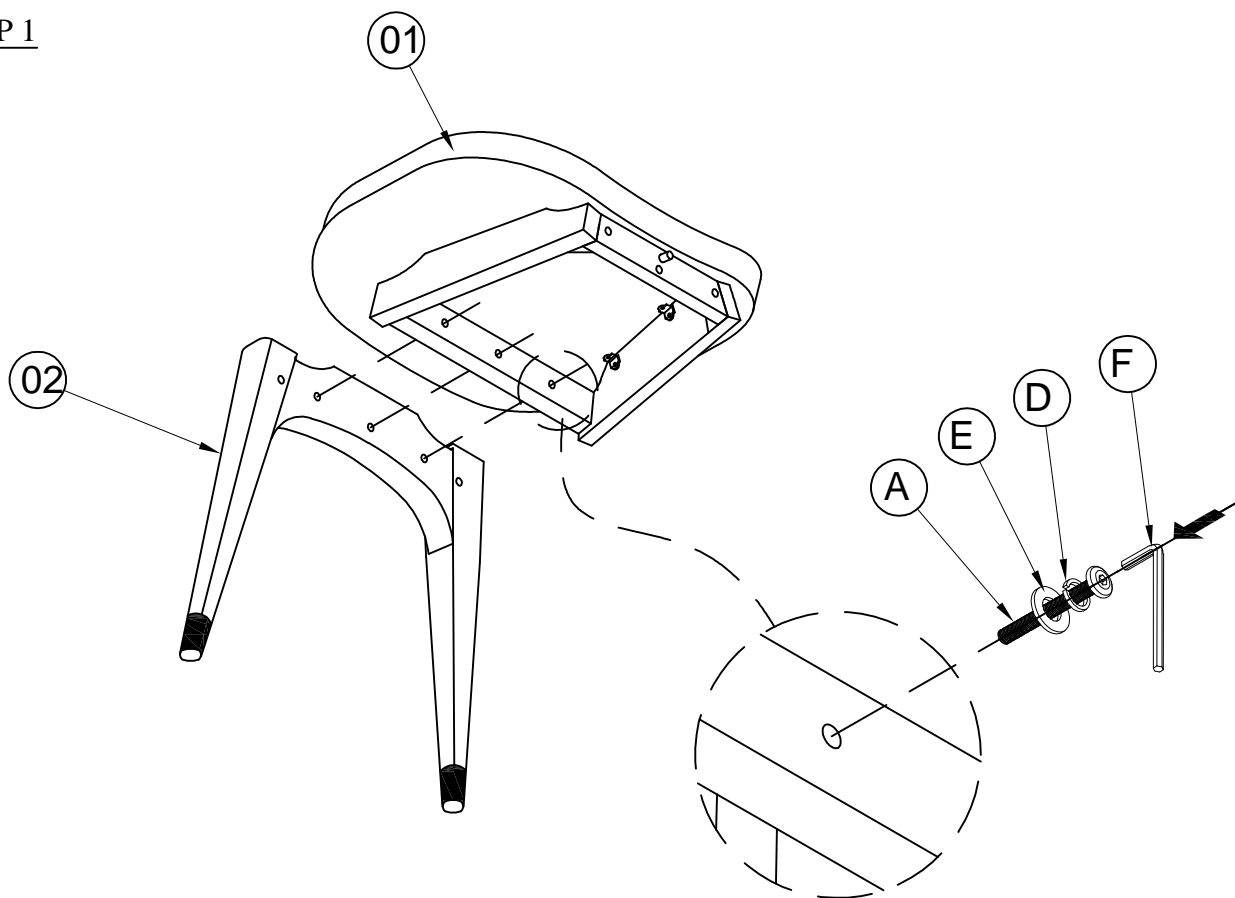

STEP 2

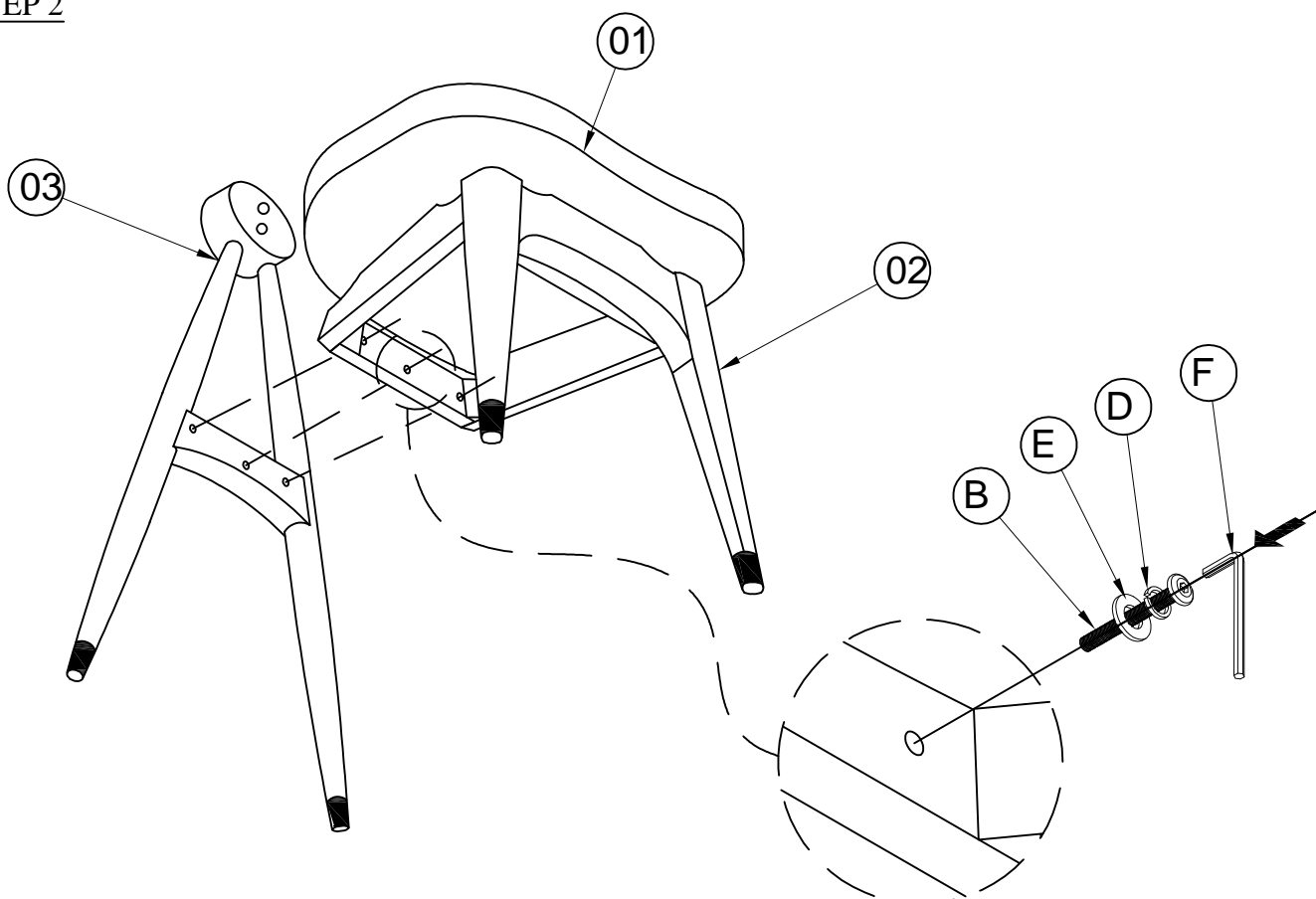

ASSEMBLY INSTRUCTION  
ITEM NO. N776P340272E / N776P340272A

STEP 3:

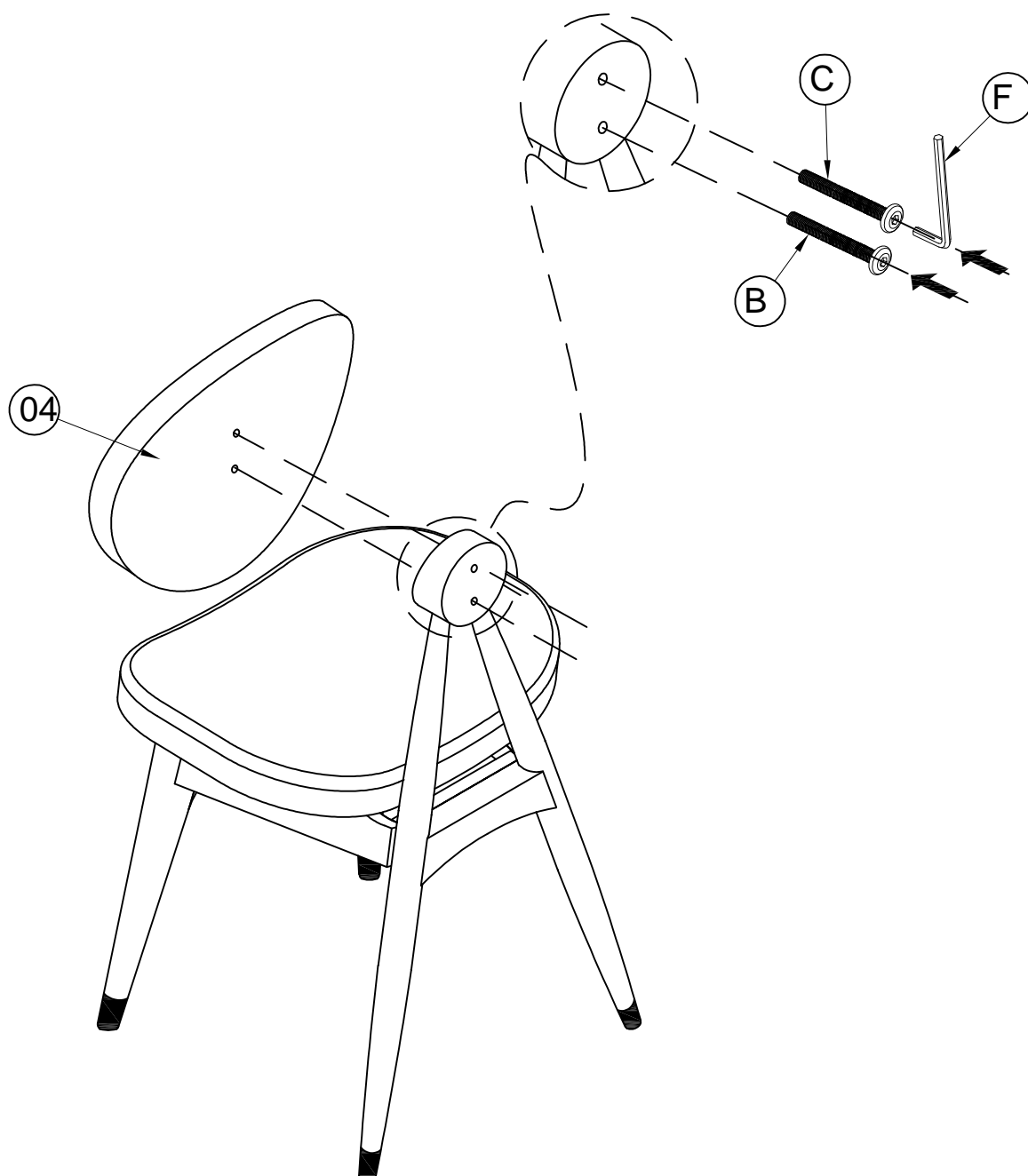

ASSEMBLY INSTRUCTION  
ITEM NO. N776P340272E / N776P340272A

COMPLETE

