

HEADBOARD SET ASSEMBLY INSTRUCTION (TOTAL 1 BOX)

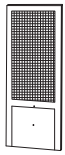

A x 1 pc



B x 2 pcs

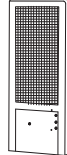

C x 1 pc



D x 1 pc

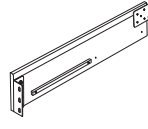

F1 x 1 pc

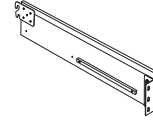

F2 x 1 pc

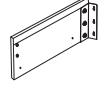

J1 x 1 pc



J2 x 1 pc



E x 2 pcs



G x 1 pc



K x 2 pcs

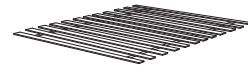

I x 1 pc

Please read over the instructions, it will be a time-saver in the long run.

Note: Before assembly, please be sure to work on a soft flat surface to avoid any damage to the finish.

Please leave bolts loosened until all bolts are placed before tightening completely.

Part#	Picture	Description	QTY	Location	Part#	Picture	Description	QTY	Location
H		Center leg	1	Embossed film wrap	S		Spring Washer Ø8	38	Hardware Pack
L		Legs	2	Embossed film wrap			Spring Washer Ø8	4	Already in Place
M		Bolt Ø8x70mm	11	Hardware Pack	T		Spring Washer Ø6	12	Already in Place
N		Bolt Ø8x50mm	16	Hardware Pack	U		Nut Ø8	11	Hardware Pack
O		Bolt Ø8x25mm	8	Already in Place	V		Screws 4x30mm	24	Hardware Pack
P		Bolt Ø6x25mm	12	Already in Place	W		"L" Wrenches Ø4	1	Hardware Pack
Q		Flat Washer Ø8x22mm	38	Hardware Pack	X		"L" Wrenches Ø5	1	Hardware Pack
		Flat Washer Ø8x22mm	4	Already in Place	Y		Spanner Ø14	1	Hardware Pack
R		Flat Washer Ø6x16mm	12	Already in Place					

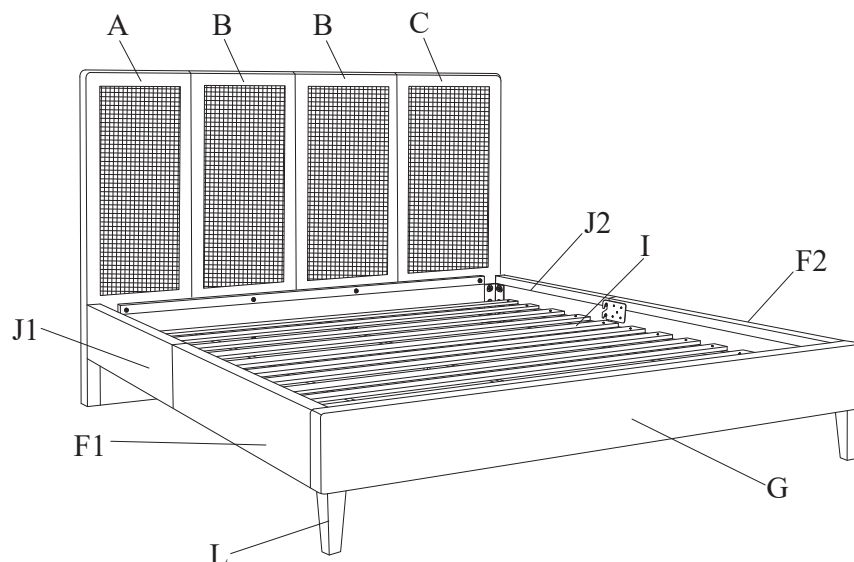

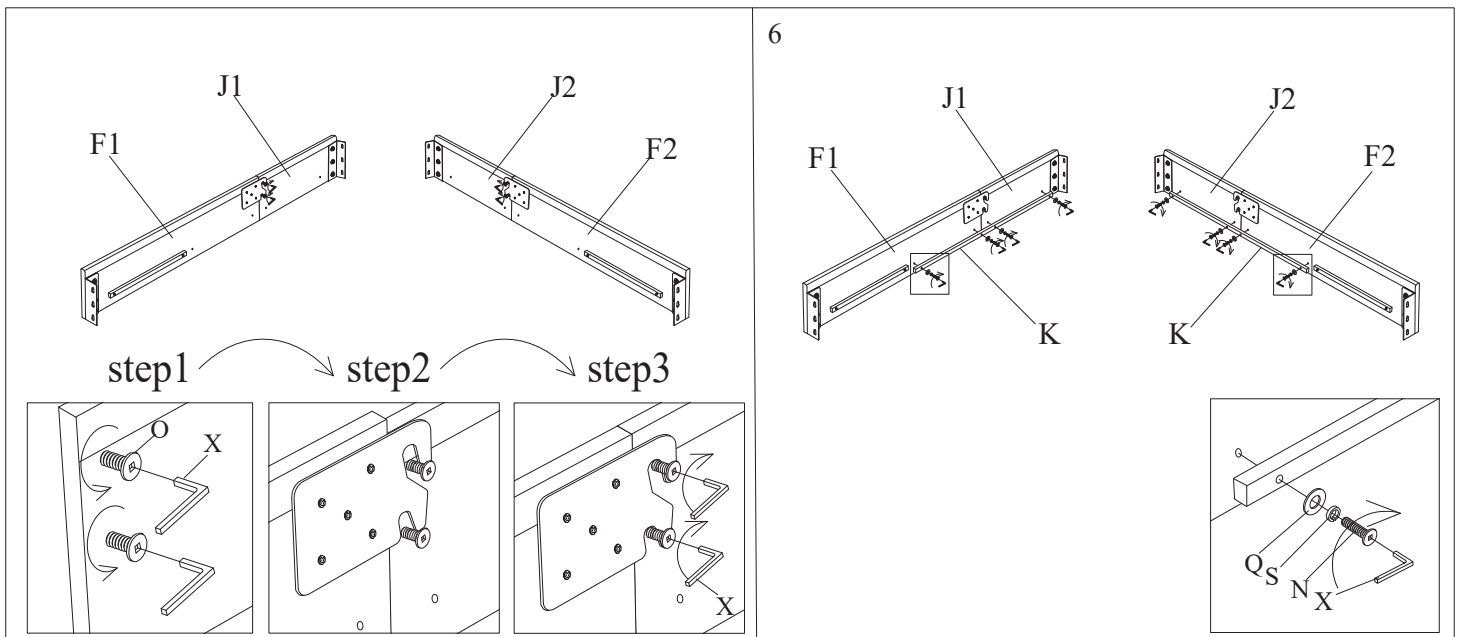
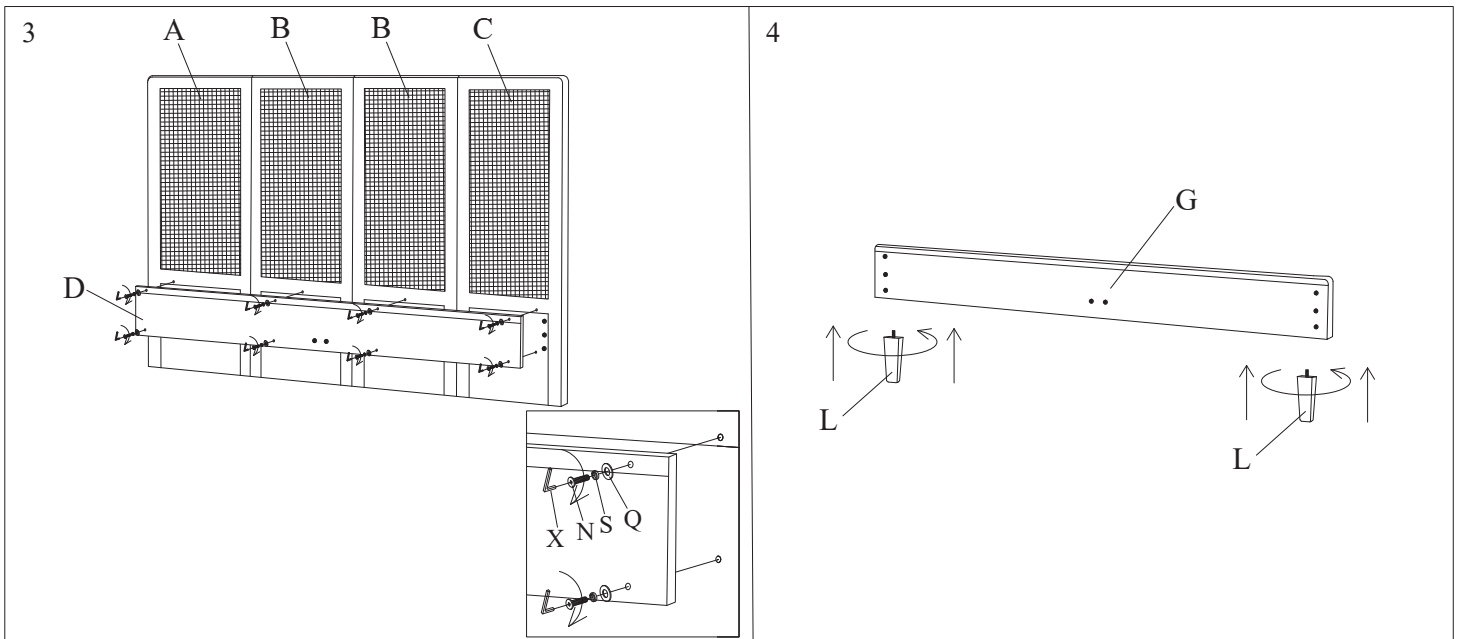
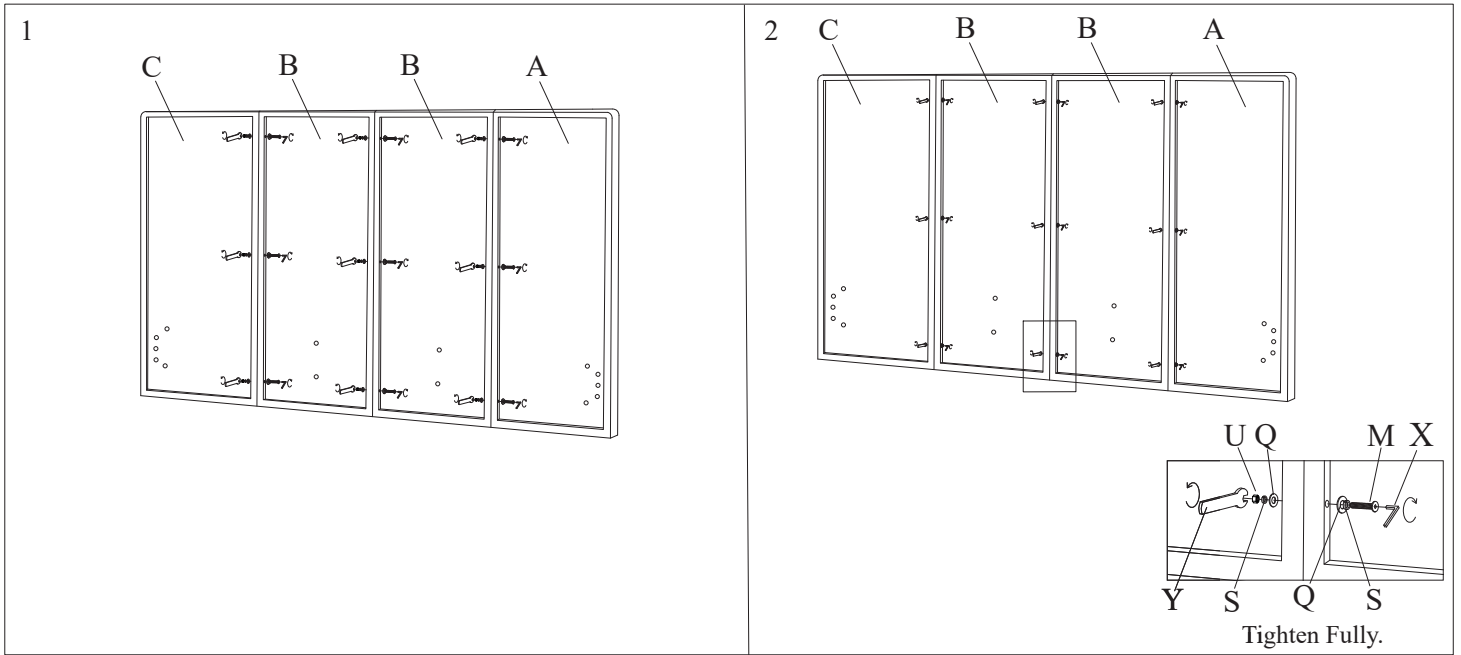

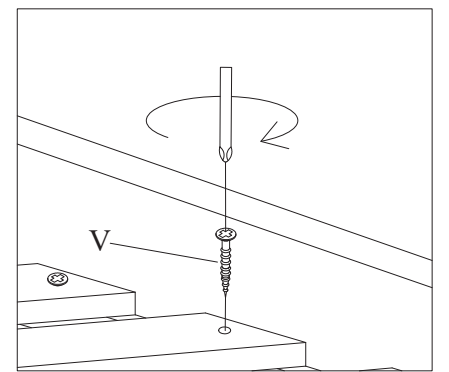
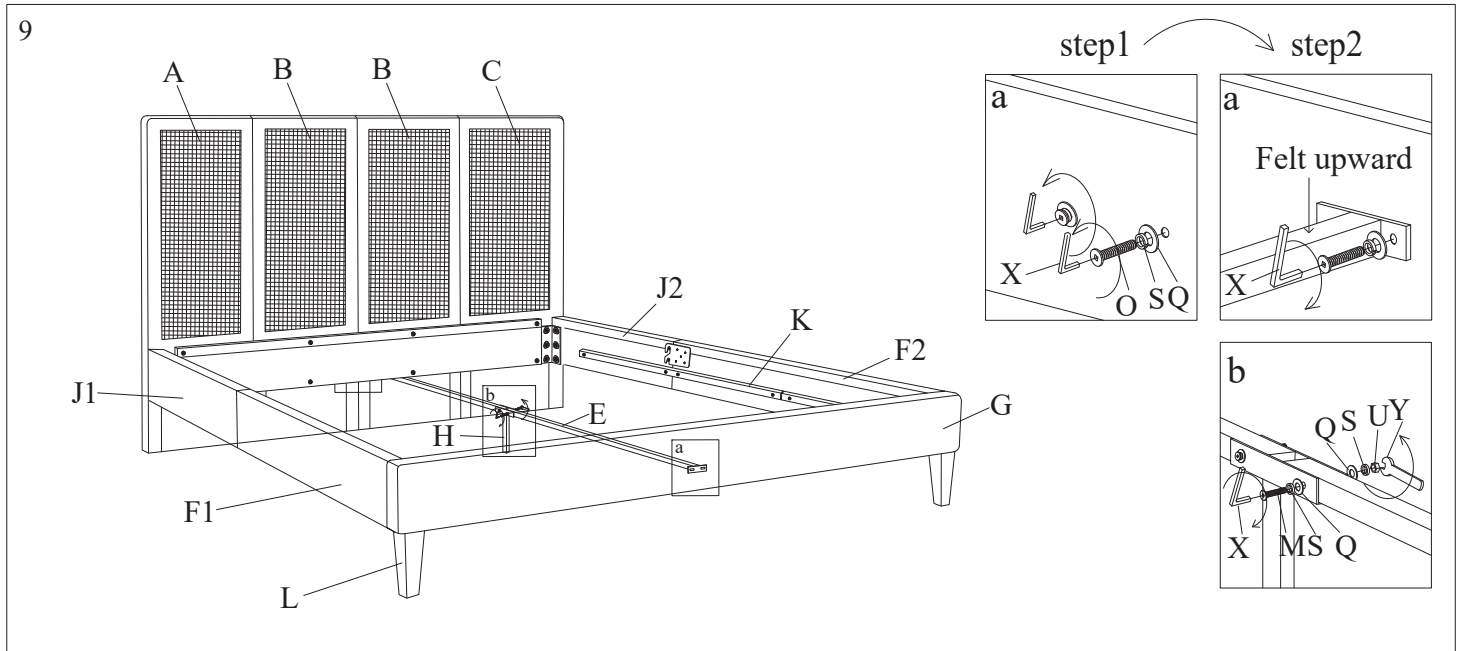
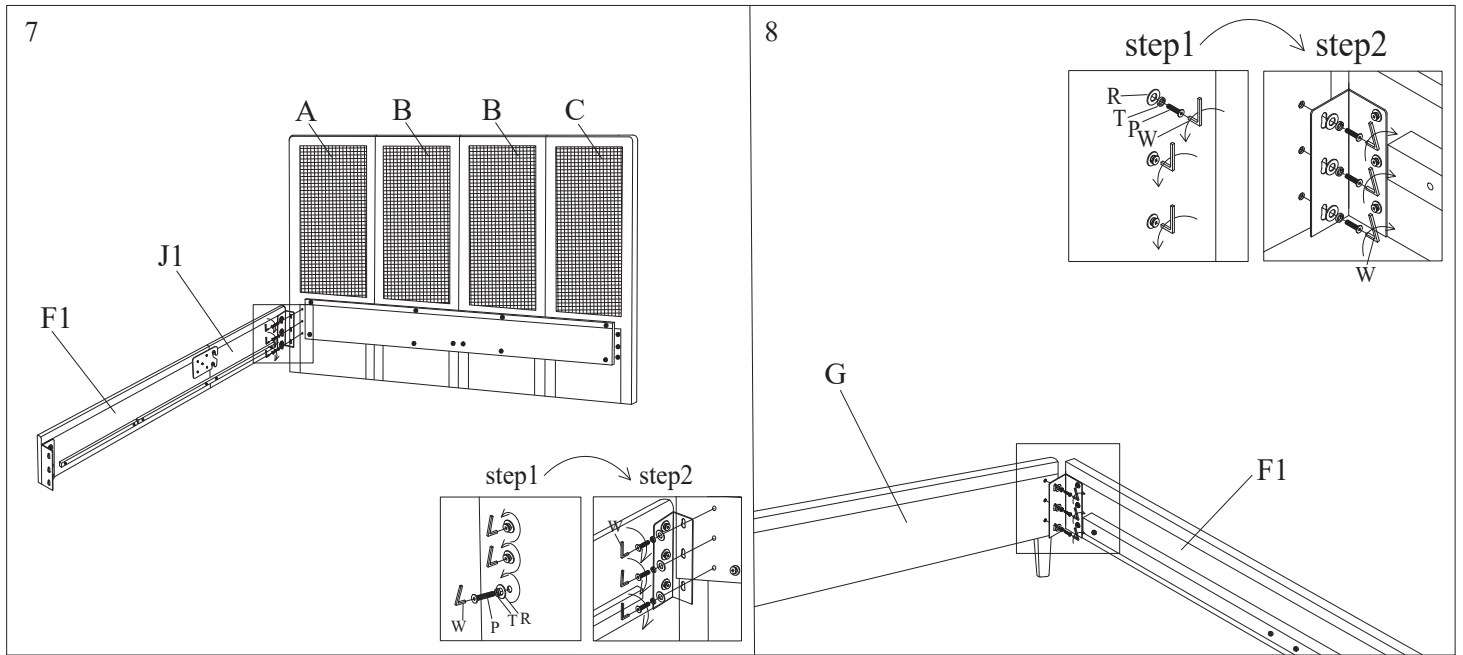

Screwdriver required, not included