

Warning: Not suitable for children under 36 months.

This product is assembled by adults. Do not get close to the fire!

When using the product, the caregiver must not leave.

This product is not allowed to be used on roads unless it is a means of transportation.

When the electric stroller is not used for a long time, it should be charged at least once a month.

For the safety of children's use, the guardian must read the instructions before use, and keep the important information contained in this package properly.

Children electric car

Installation instructions

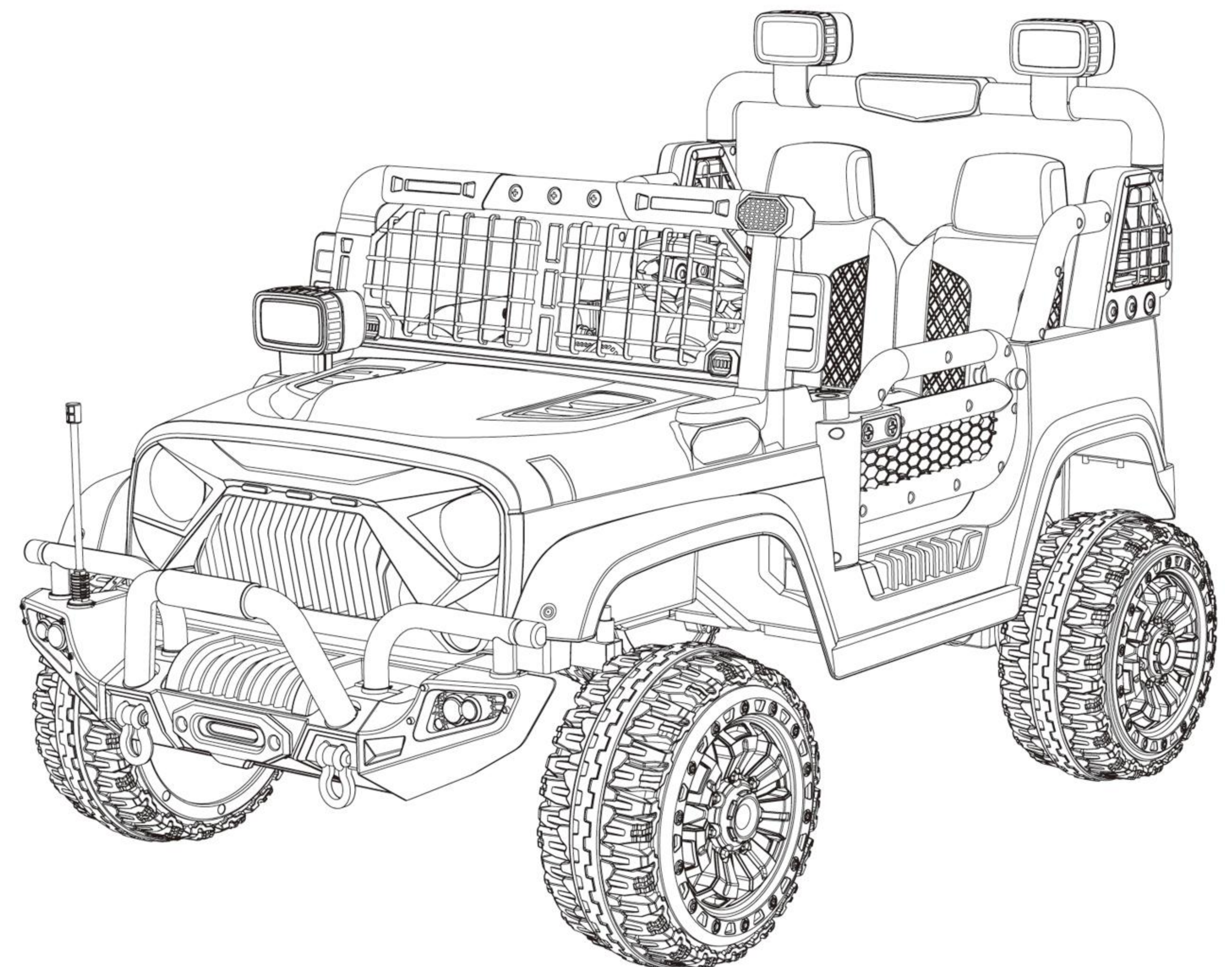

If you have any question, please contact at
L843485741@outlook.com directly.

components and parts

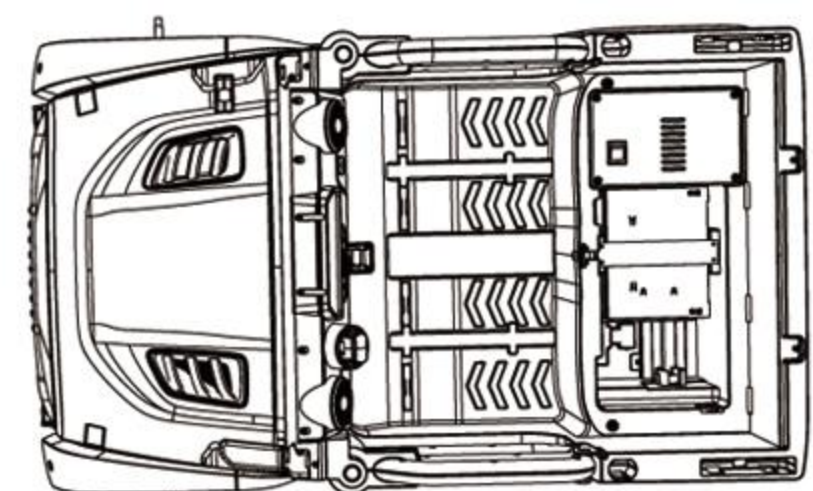

① Car body

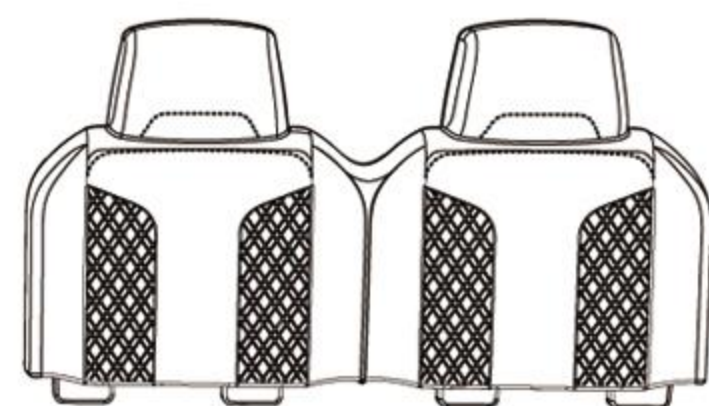

② Backrest

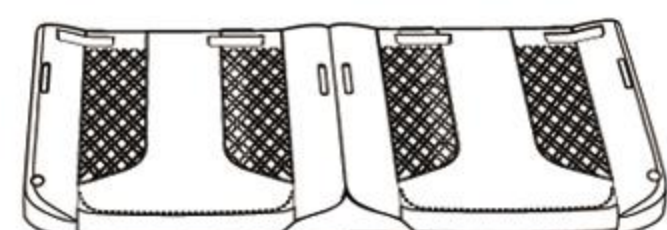

③ Seat plate

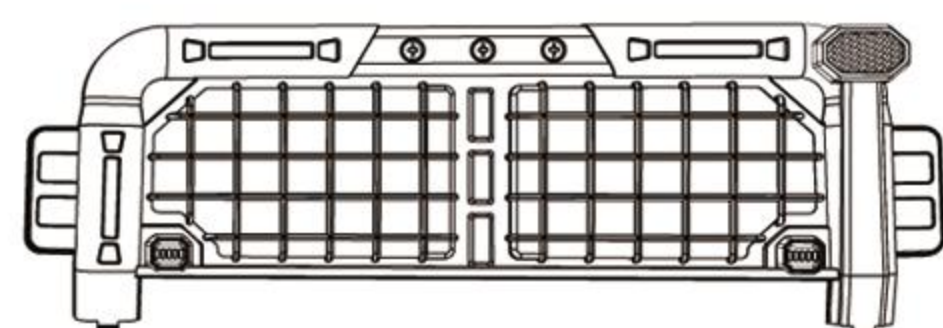

④ Block the wind



⑤ Rear guardrail



⑥ Wheel * 4



⑦ Wheel piece * 4

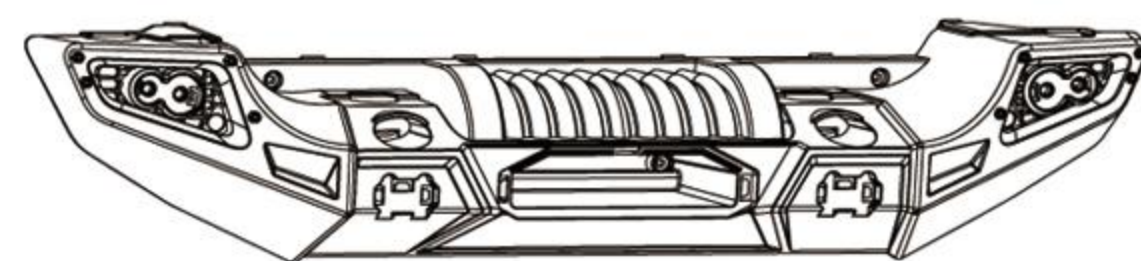

⑧ Bumper



⑨ Hood light



⑩ Insurance pole decorative pole

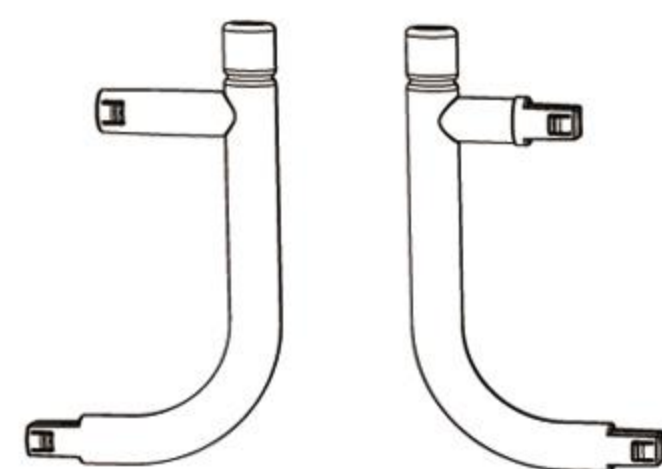

⑪ Decoration on the safety pole

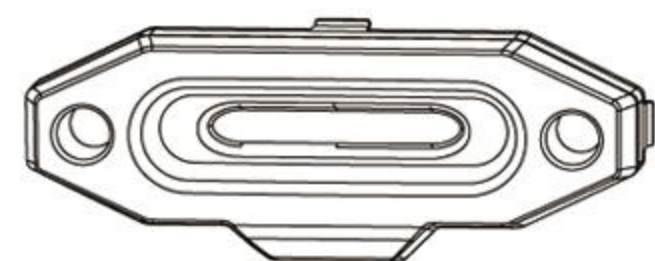

⑫ Decoration in the middle of the safety pole

components and parts

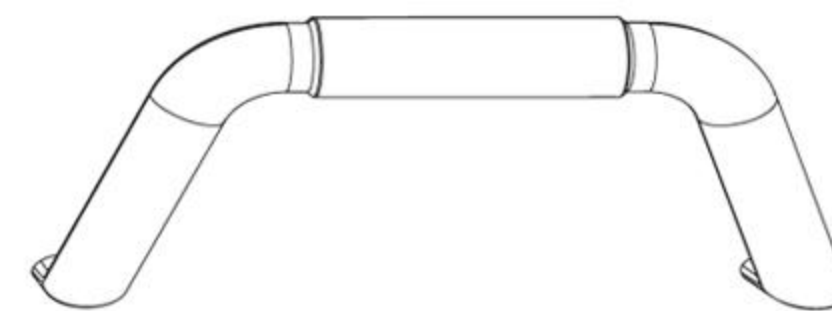

⑬ Pull ahead



⑭ Trailer Ring*2

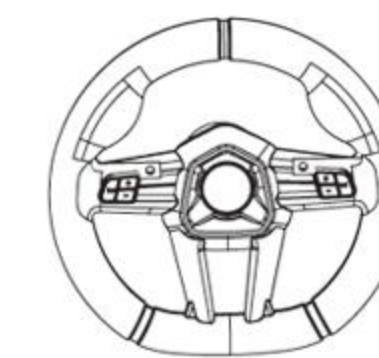

⑮ Steering wheel

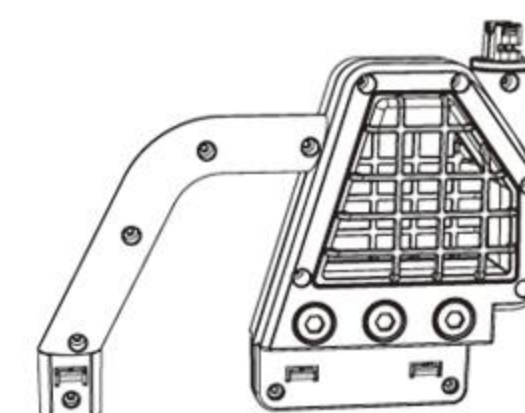

⑯ Handrail*2



⑰ Rear axle base*2



⑱ A rear axle



⑲ Bogie frame

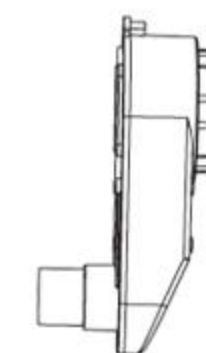

⑳ Electrical machinery*2



㉑ Shim

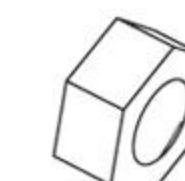

㉒ Nut

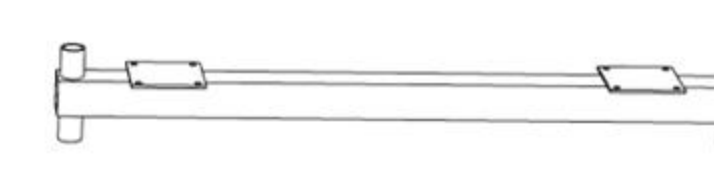

㉓ Turning square tube



㉔ Rear support of the vehicle body



Screw package
4 * 14 black flat



Screwdriver

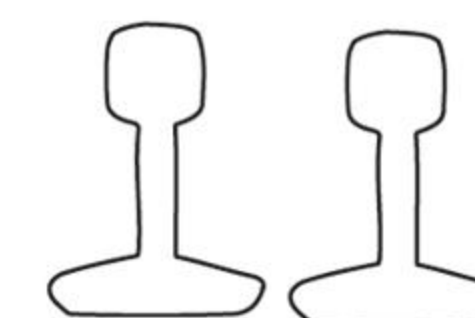

Plastic long
wrench

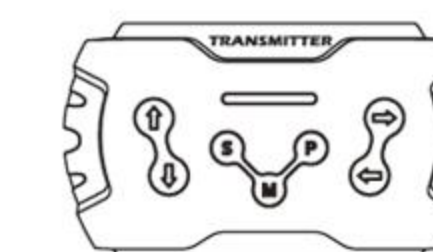

Remote control



Charger

Installation steps

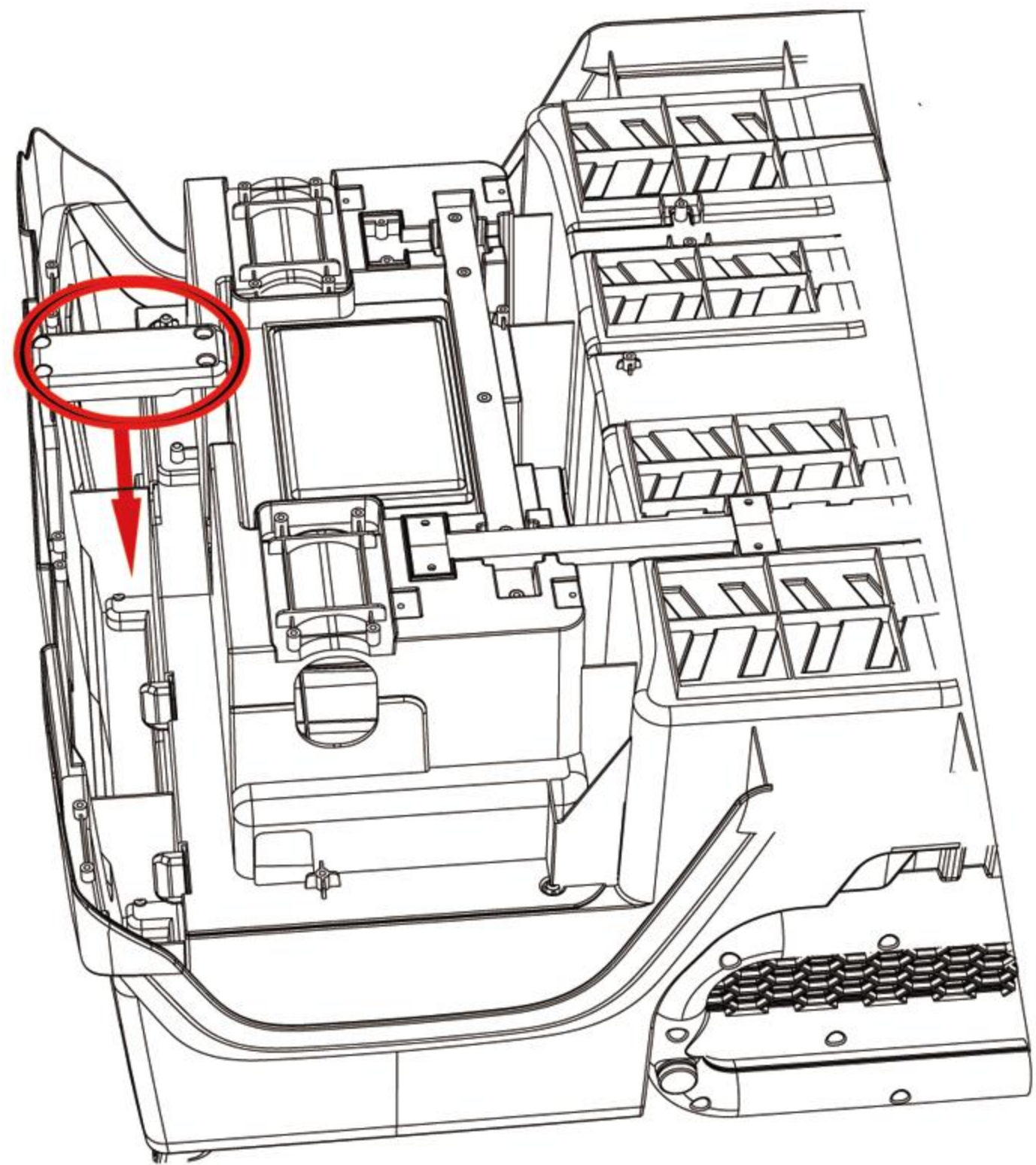
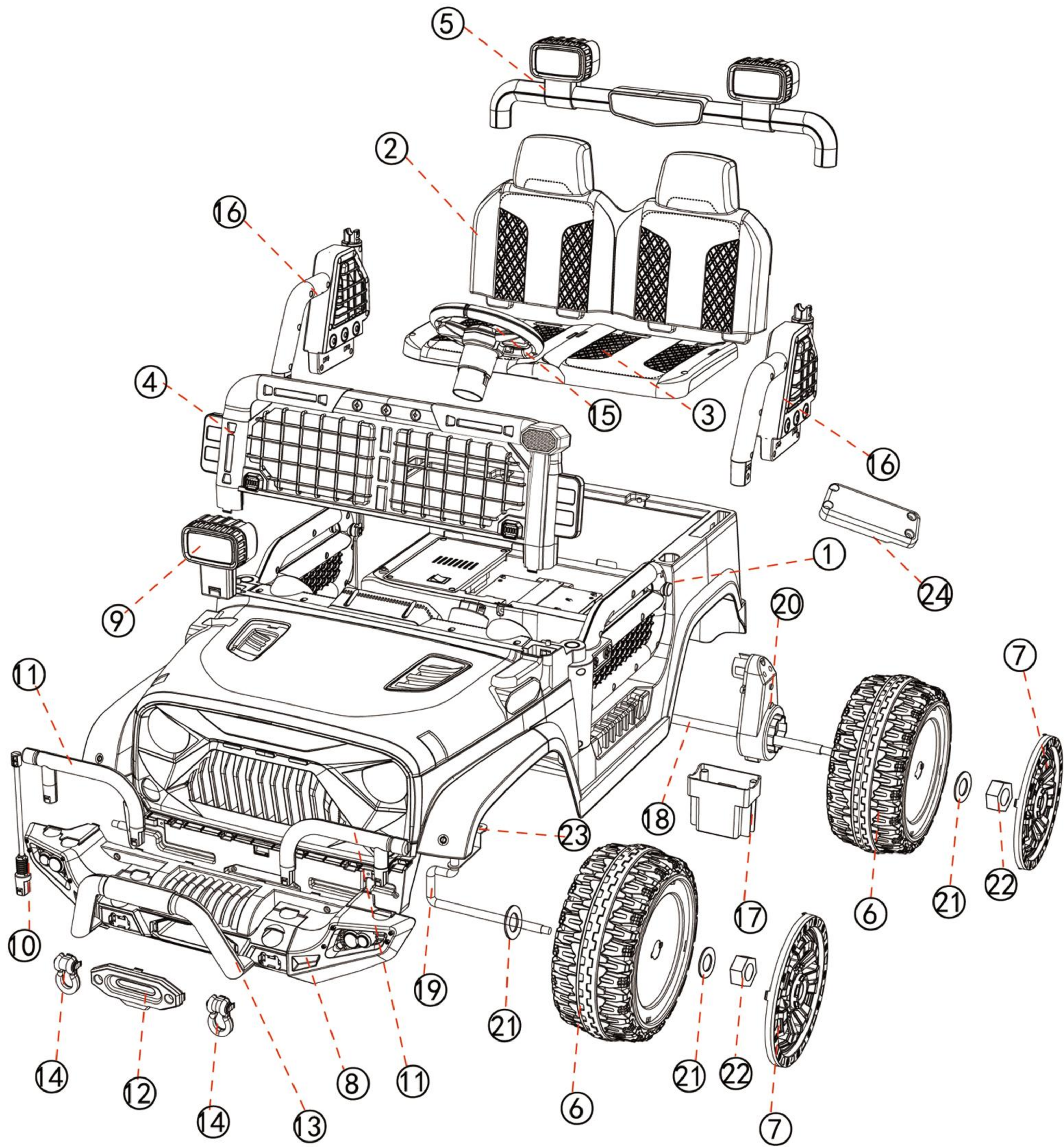

Installation step 01: Align the rear support of the vehicle with the screw holes at the rear of the vehicle, and tighten it with four black screws;

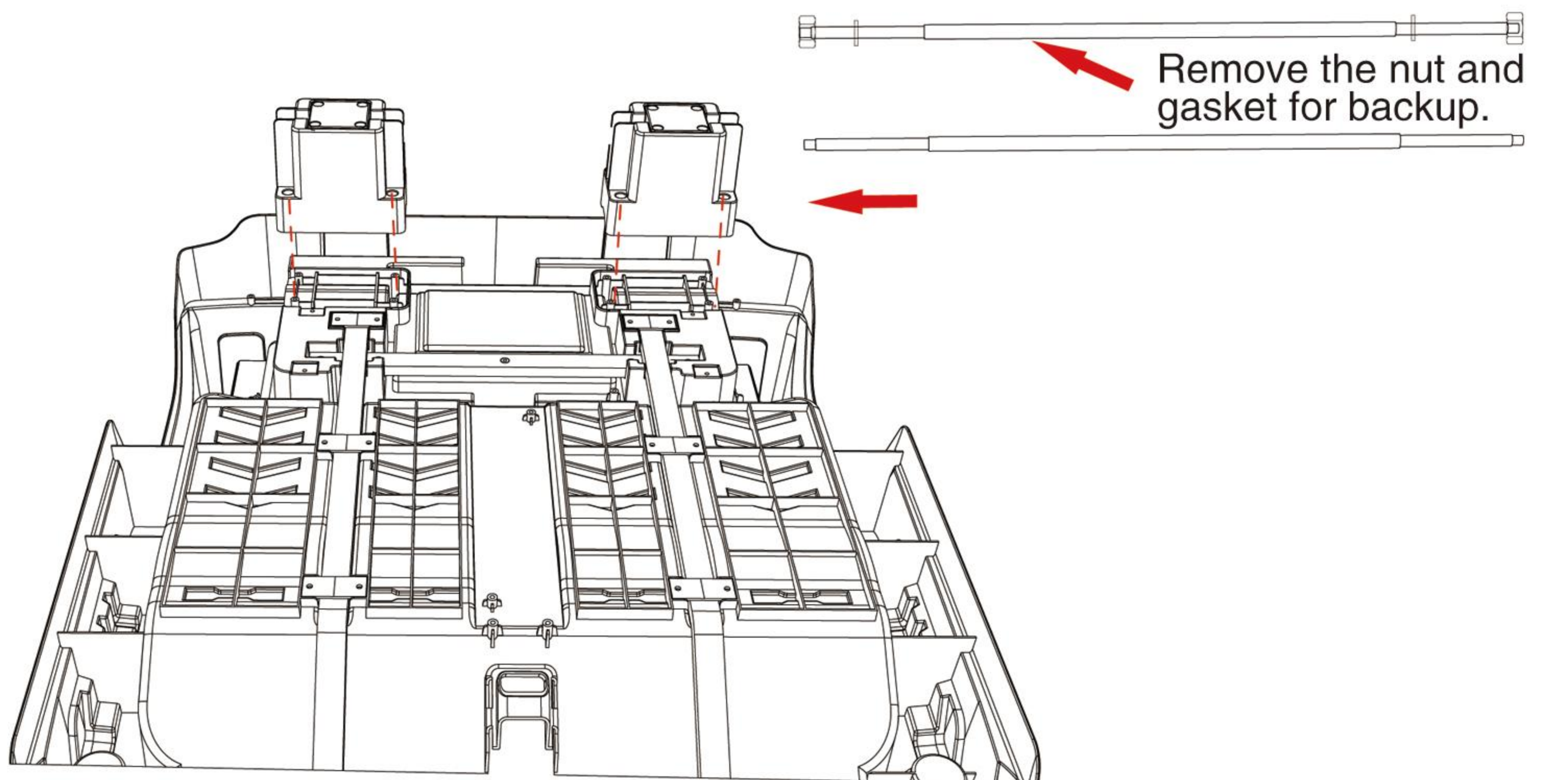

Installation step 02: Place the bottom of the car body facing up and the rear axle base in the corresponding position. Use 8 black screws to tighten the rear axle and insert it

Installation steps

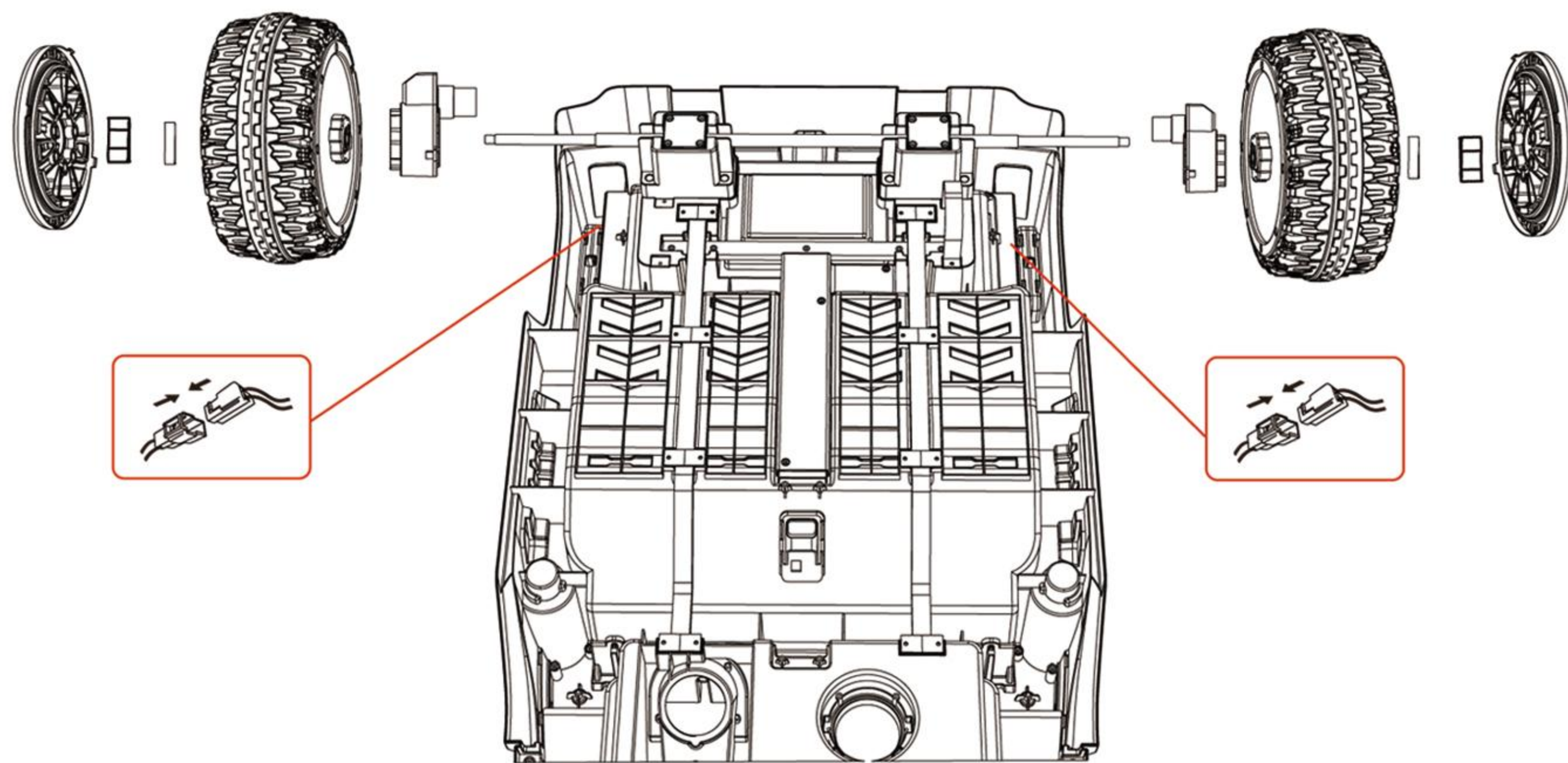

Installation step 03: Thread the two motors into the rear axle separately, plug the motor terminals into the exposed terminals of the vehicle body, then thread them into the wheels and washers in sequence, tighten the nuts with a wrench, and finally tighten the wheel discs;

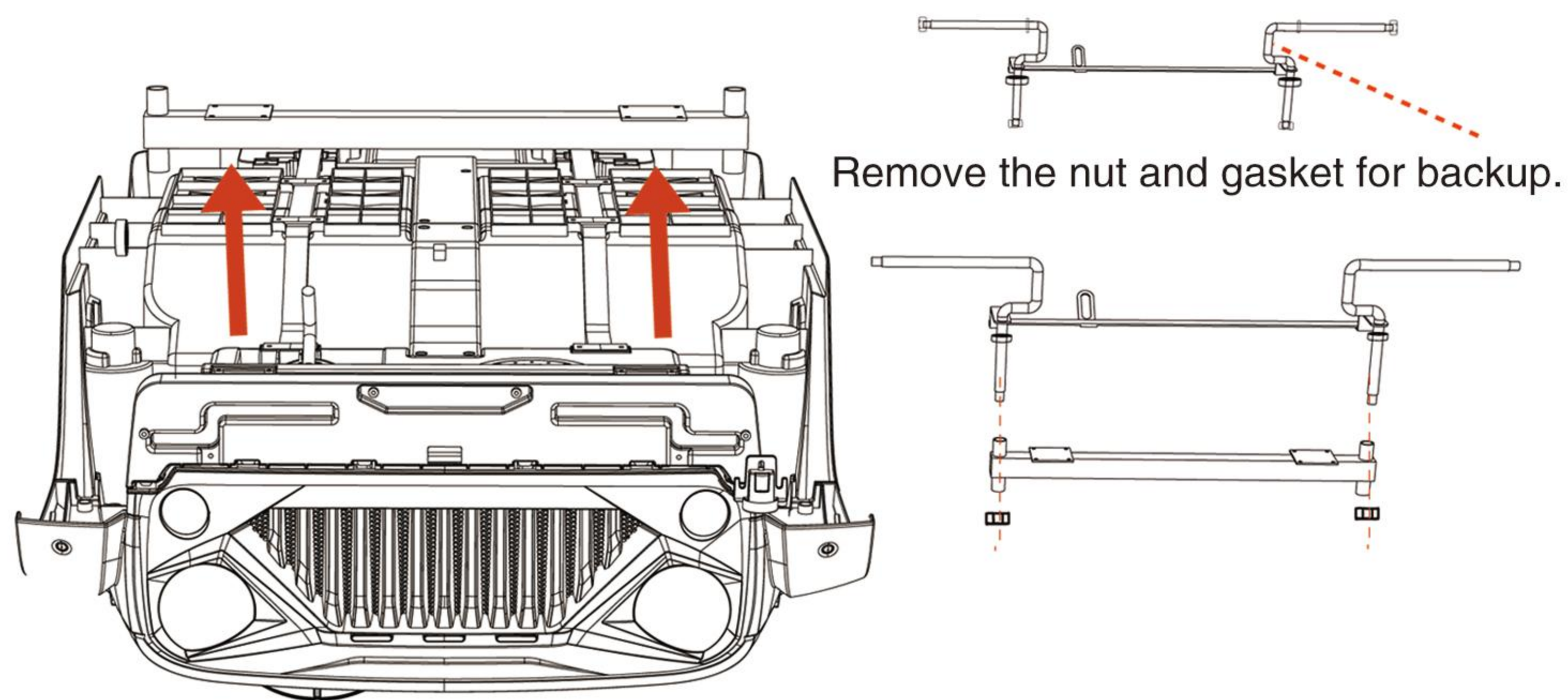

Installation step 04: Remove the steering square tube from the vehicle body, install the steering plate onto the steering square tube (as indicated in the diagram), and tighten the nut (fixed with a wrench)

Installation steps

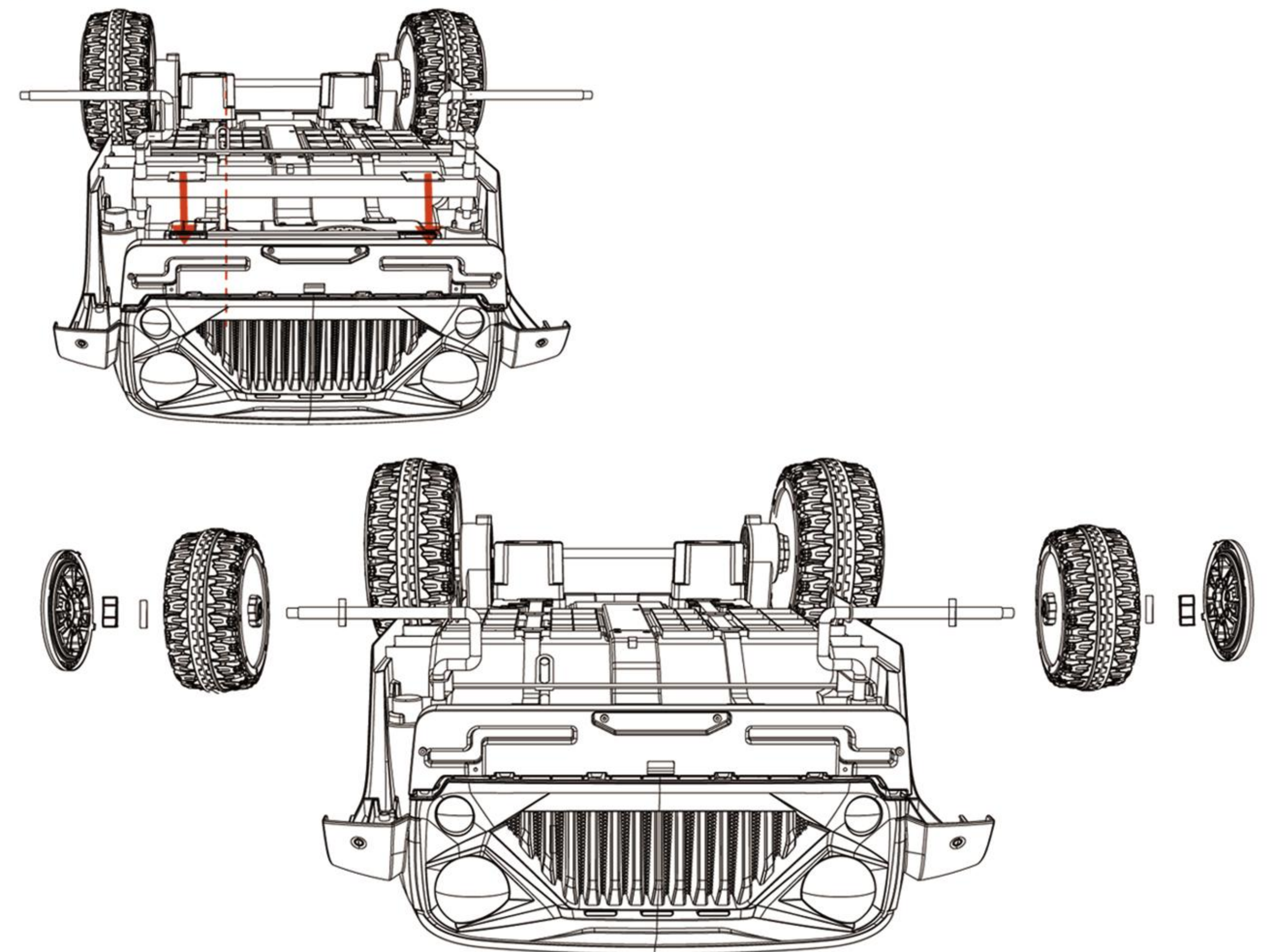

Installation step 05: Align the assembled bogie with the vehicle body, insert it into the steering shaft, tighten it with 8 screws, and then insert the gasket, wheel, and gasket in sequence. Use a wrench to tighten the nut, and finally tighten the wheel plate;

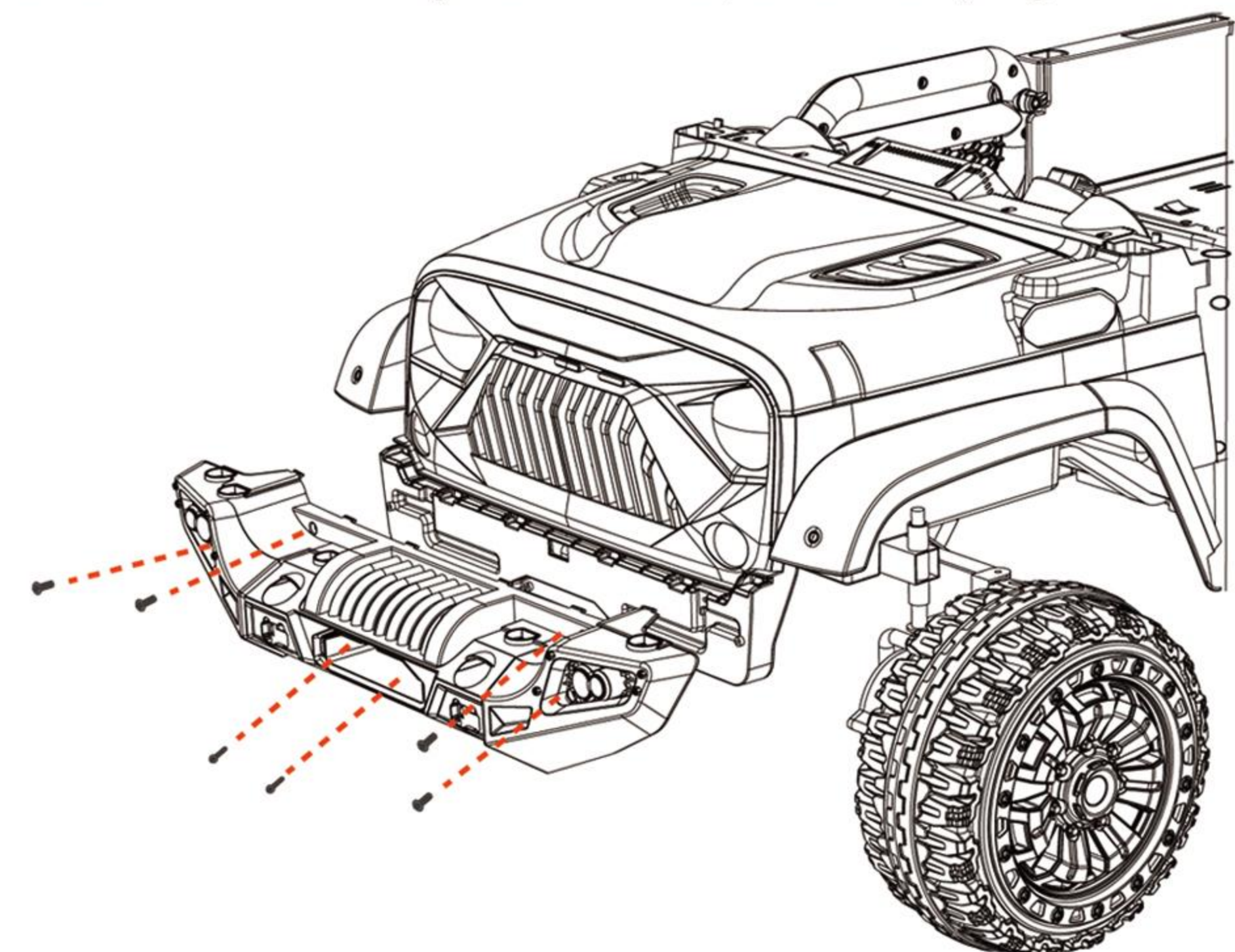

Installation step 06: Align the bumper with the car body slot and tighten it, then fix it with 6 black screws;

Installation steps

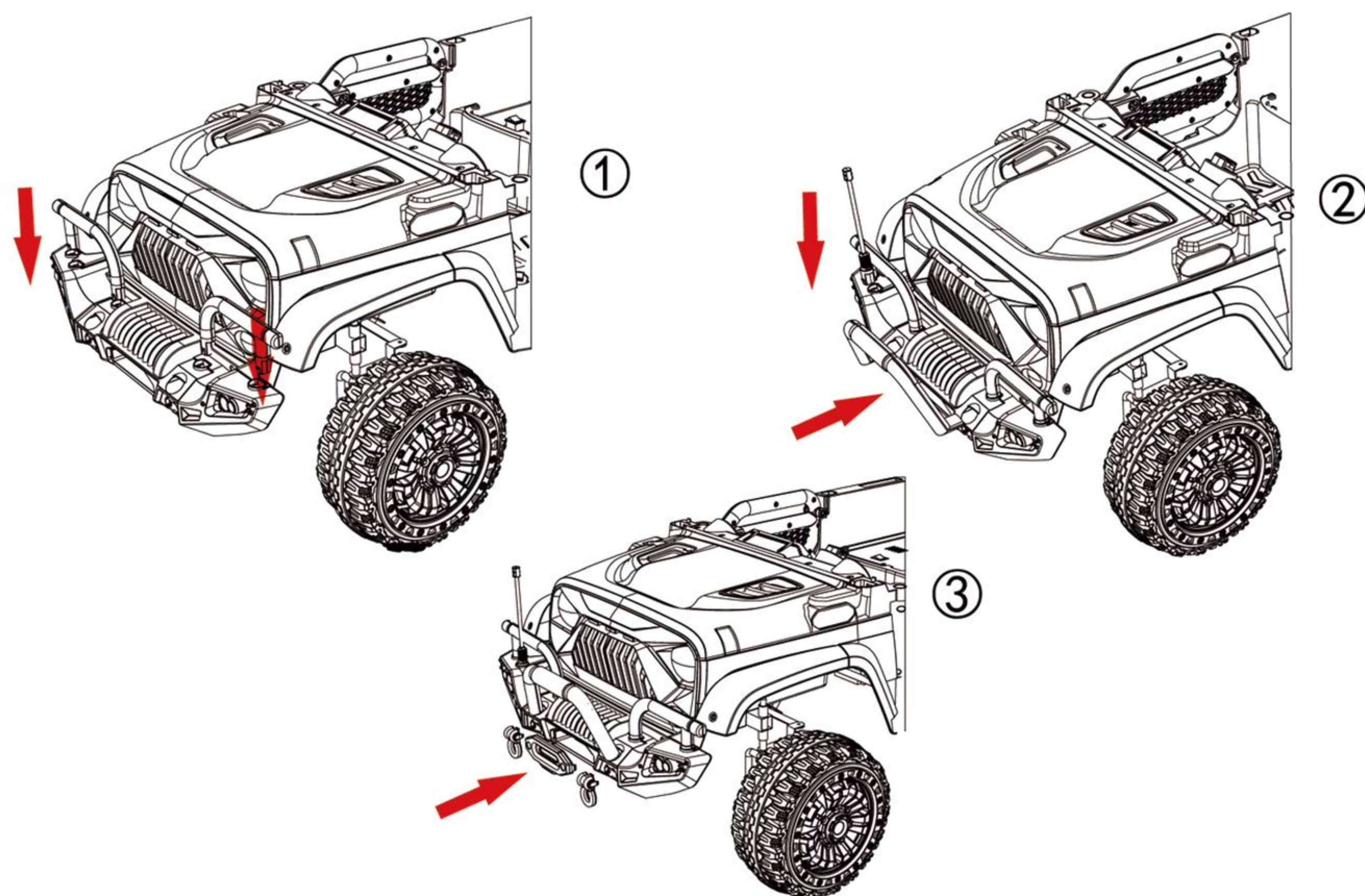

Installation step 07: ① Align the bumper decoration with the bumper slot and tighten it;
 ② Align the bumper decorative rod with the front pull and secure it in the bumper slot;
 ③ Align the middle decorative rod of the insurance with the two trailer rings and secure them in the bumper slot;

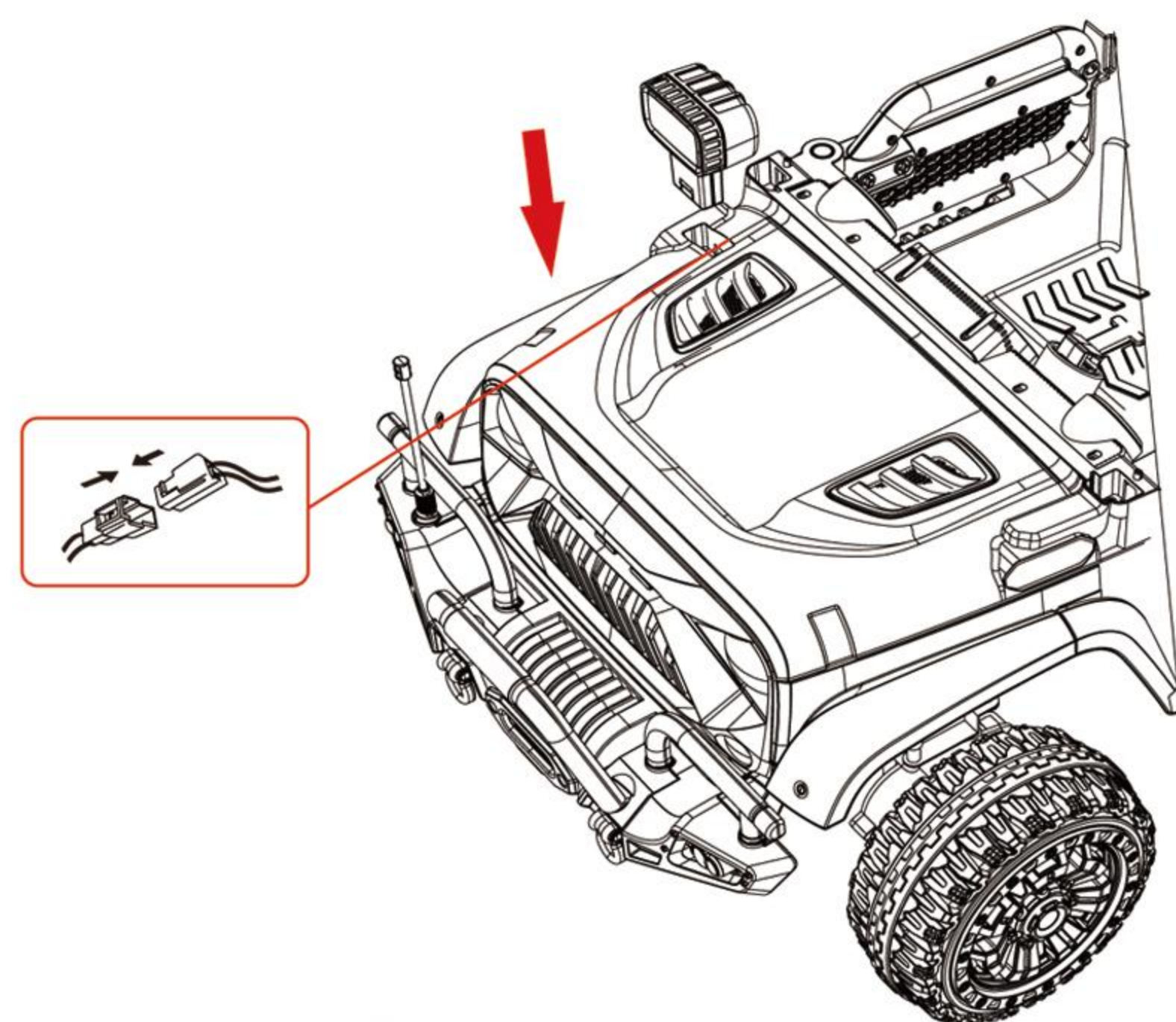

Installation step 08: Connect the hood light to the exposed terminals on the vehicle body, plug the excess wires back into the vehicle body, and finally align the hood light with the vehicle body slot and tighten it;

Installation steps

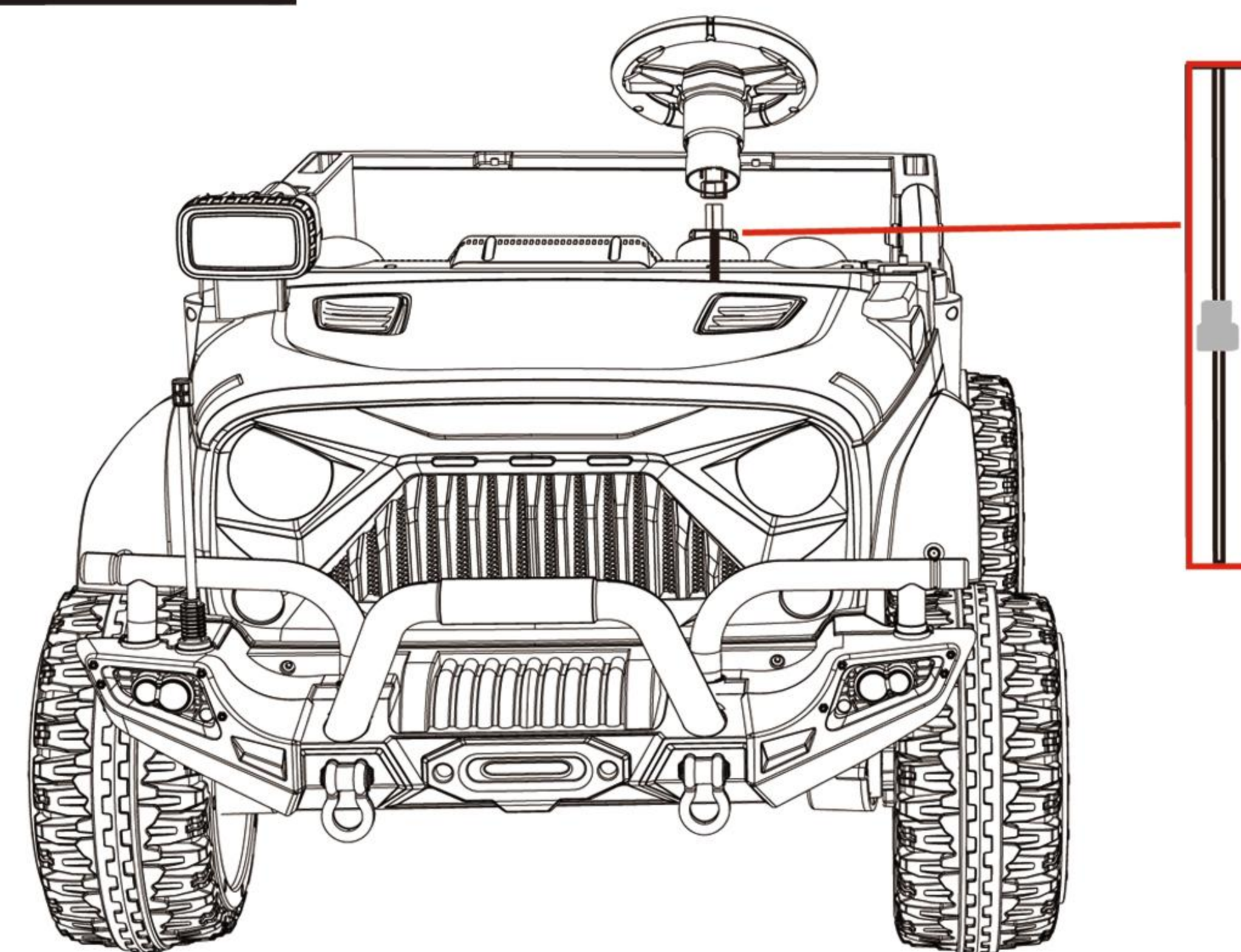

Installation step 09: Remove the adhesive tape on the steering wheel base, plug the terminals together, and insert the excess wire into the car's internal buckle to tighten it;

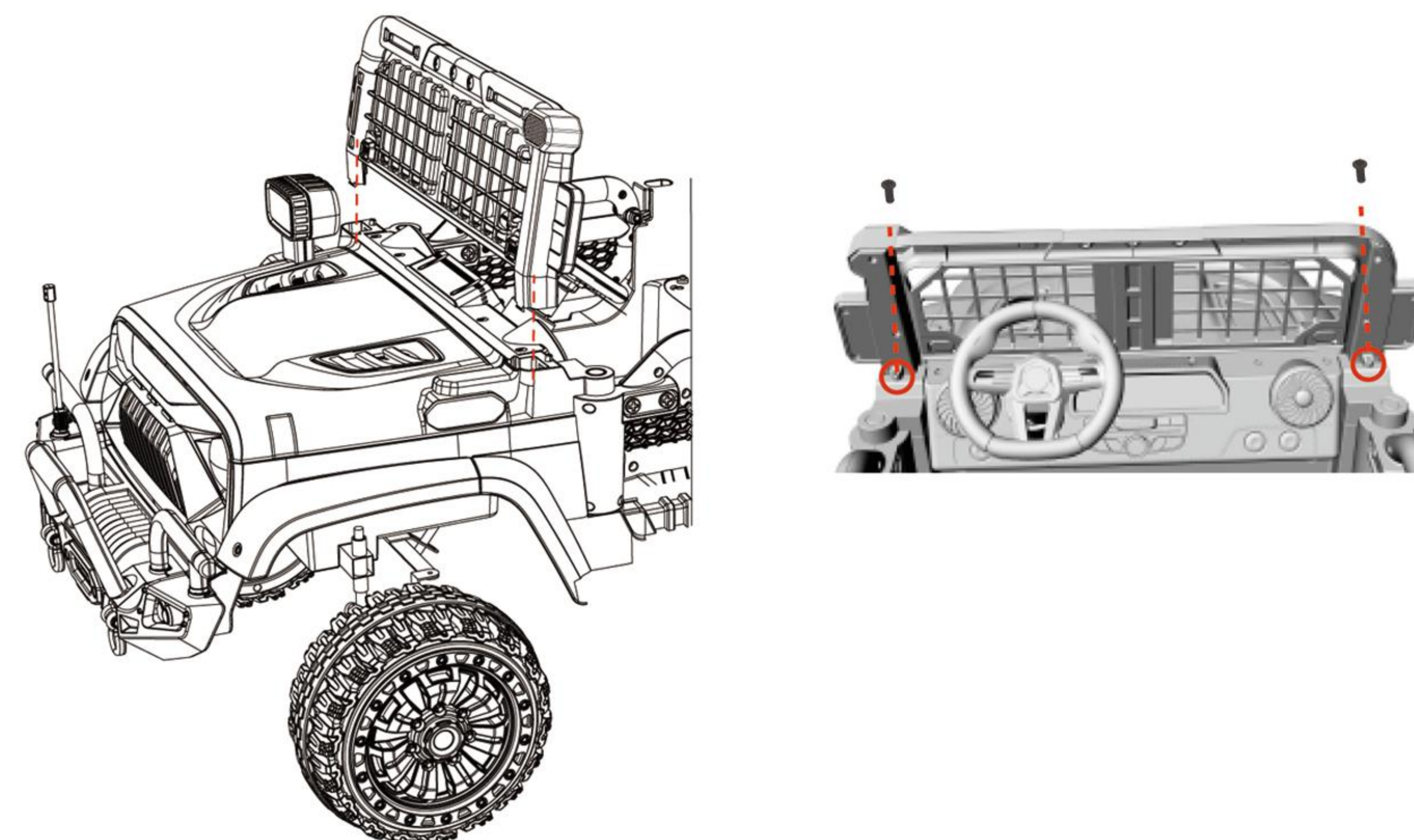

Installation step 10: Align the windshield with the car body slot, fasten the buckle, and fix it with two black screws;

Installation steps

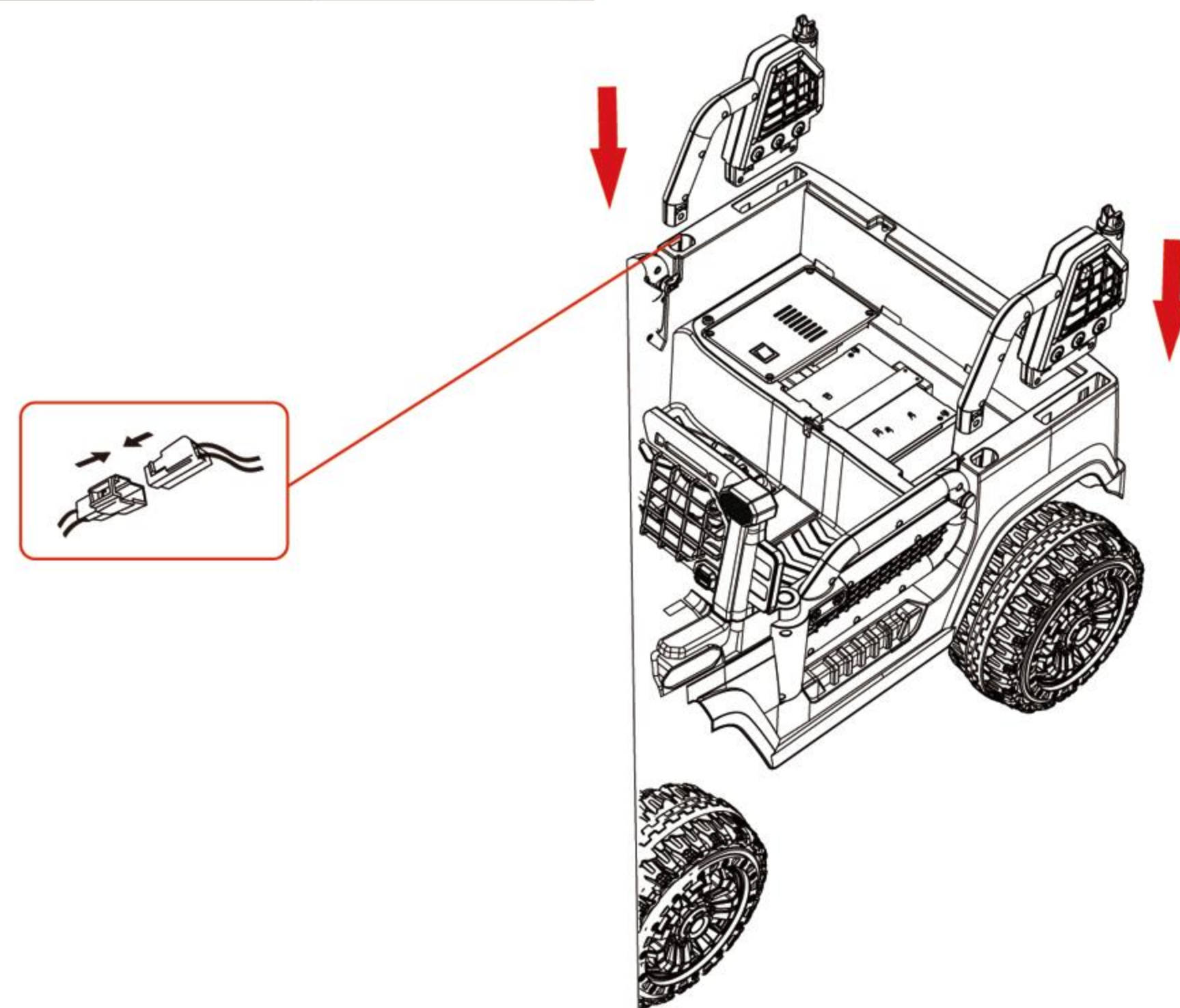

Installation step 11: Insert the terminals of the armrest into the exposed terminals of the vehicle body, and then align the two armrests with the vehicle body slot and insert them downwards;

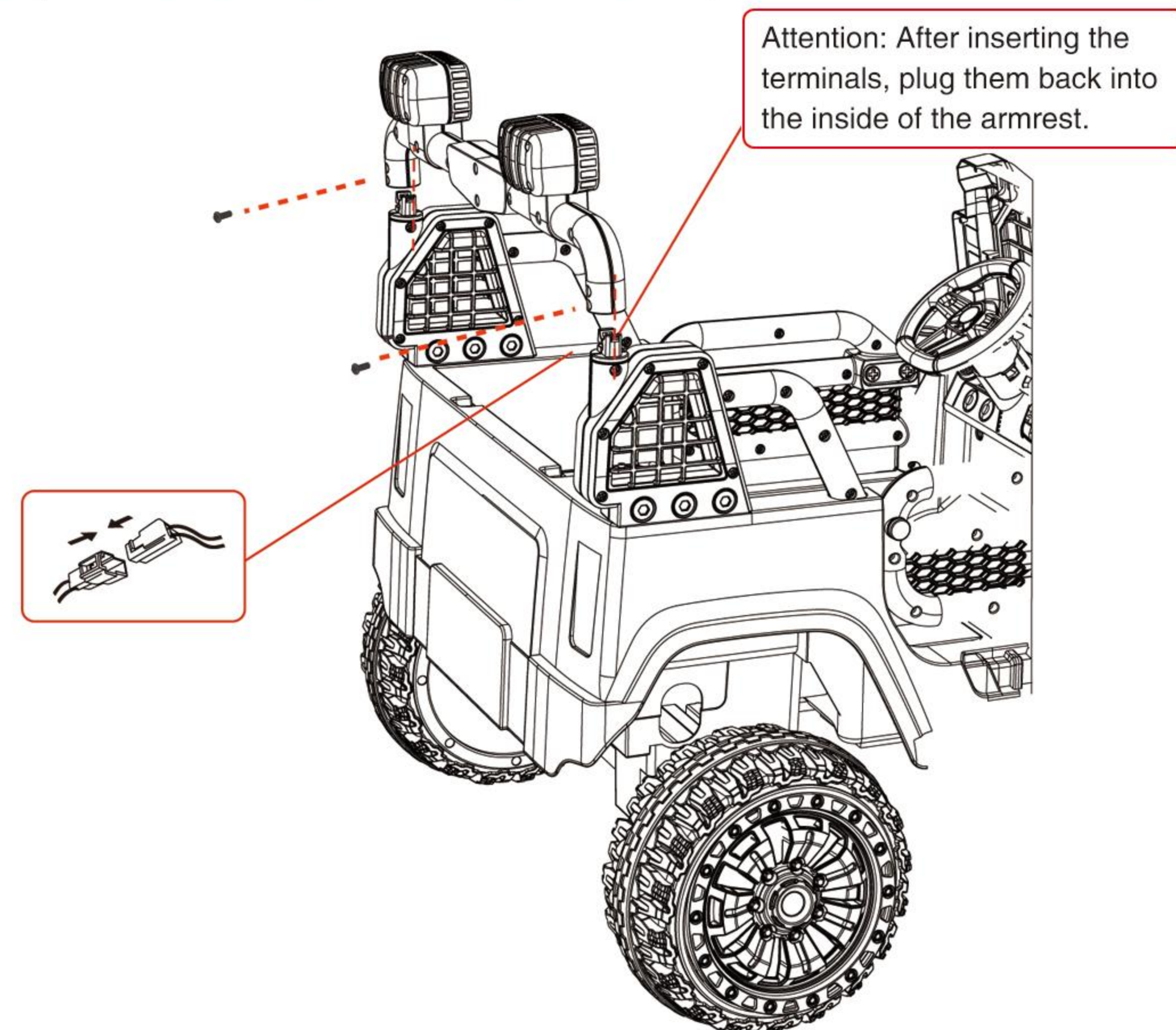

Installation step 12: Insert the terminals of the rear guardrail into the exposed terminals of the armrest, then align the rear guardrail with the armrest slot and insert it downwards. Tighten both ends with a black screw;

Installation steps

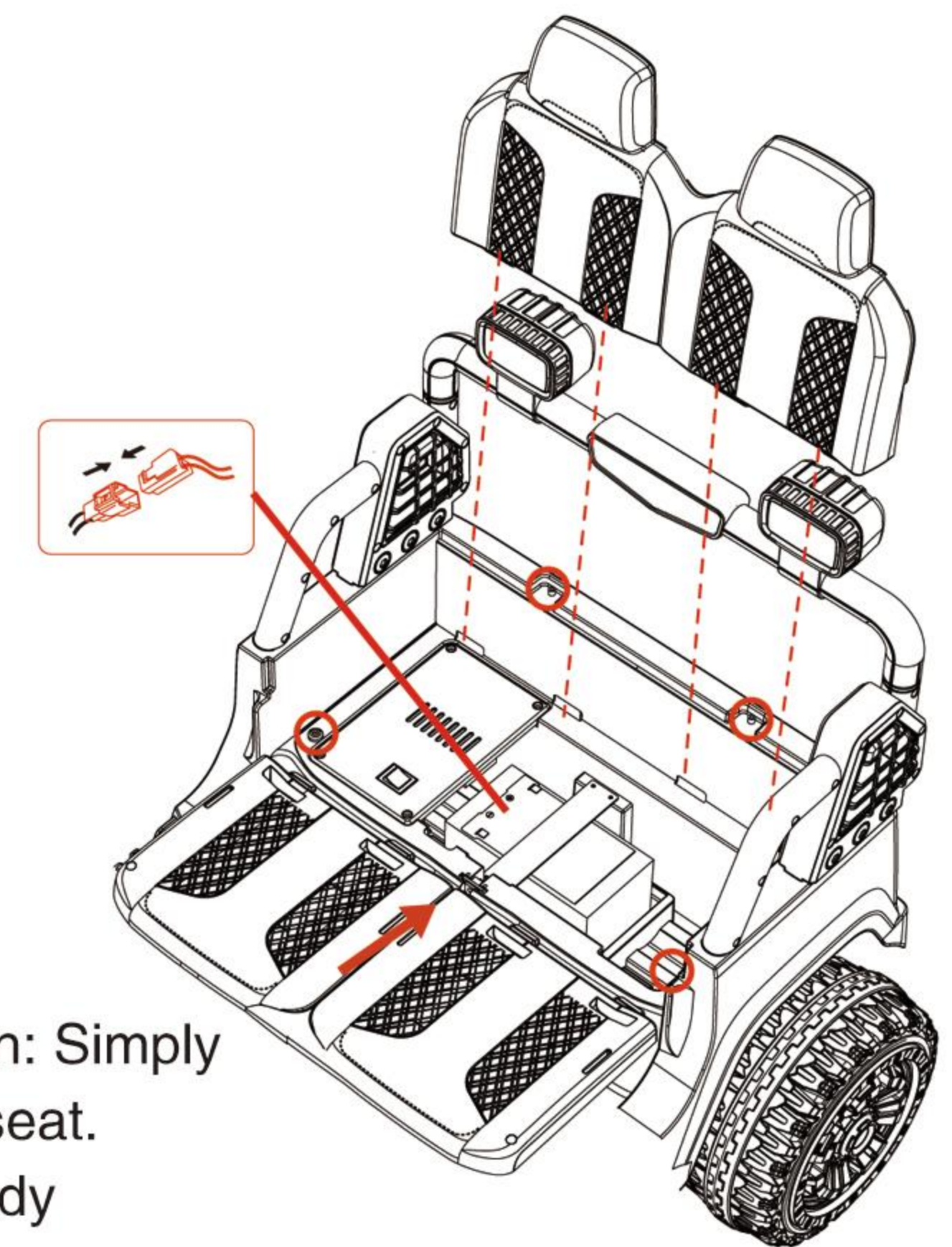

Installation step 13: Power connection: Simply plug in the red terminal to install the seat. First, align the seat board with the body buckle and tighten it with 2 black screws. Finally, align the backrest with the seat board buckle and tighten it with 2 black screws;

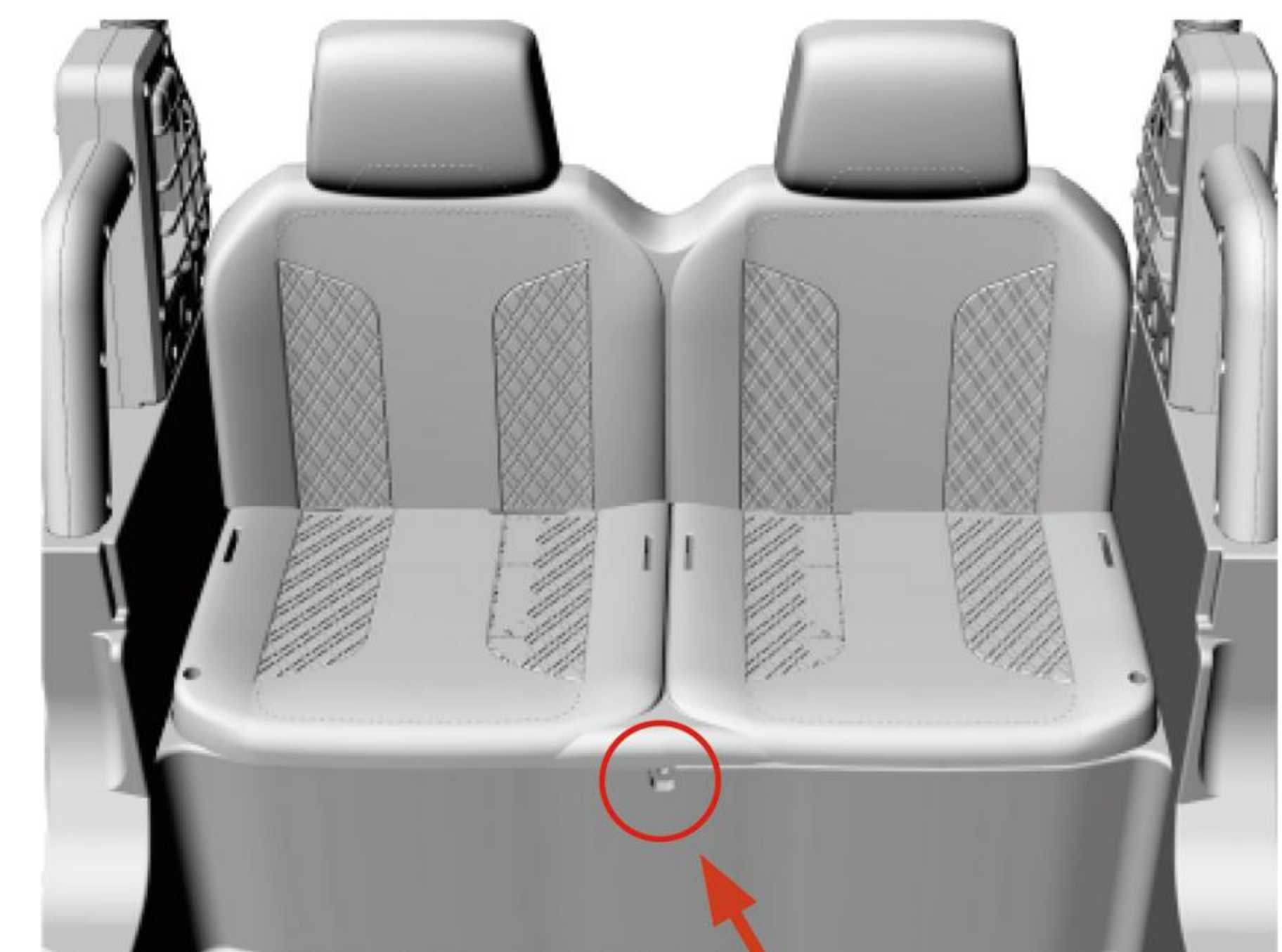

AC adaptor

Remote Control Instructions

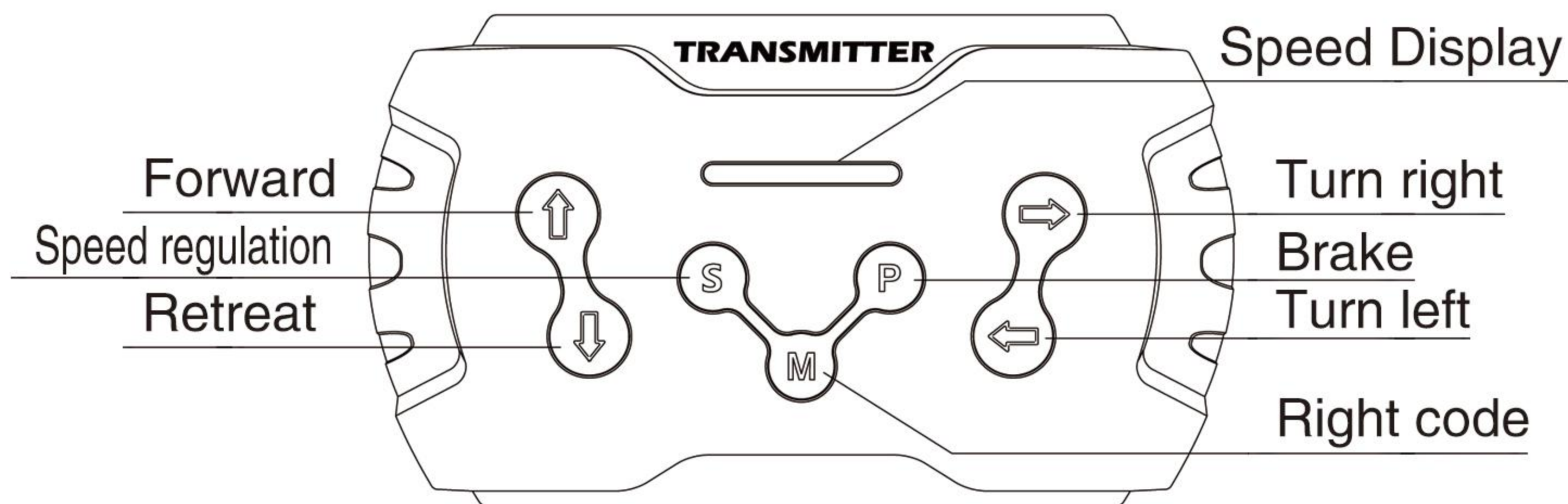

2.4G Remote Control Manual

The first use requires code matching. This product has a built-in memory, and there is no need to code it again when replacing the battery in the future.

1. Turn off the vehicle power and hold down the "m" button on the remote control. After 3 seconds, the first indicator light starts flashing, and then release the button.
2. At this time, turn on the vehicle power switch, and the first indicator light on the remote control will become constantly on, indicating successful code matching.
3. The remote control will enter sleep mode after 10 seconds when not in use. Press any key to wake it up.
4. Button Description: "△" Forward, "▽" Backward, "◁" Left Turn, "▷" Right Turn, "S" Speed Control, "p" Brake, "m" Press the "S" key to set the vehicle speed, with one light on for low speed, two lights on for medium speed, and all three lights on for high speed. When reversing, press the "P" key only for medium speed to enter the braking state, and all indicator lights will flash. Press the "p" key again to exit the braking state.

! Warn!

- Not suitable for children under 3 years old, there are small parts inside, and there is a risk of suffocation
- -Install two AAA/7 (1.5V) dry batteries according to the instructions in the diagram
- -When the battery is depleted, it should be promptly removed from this product
- -Using non rechargeable batteries, the battery cannot be charged
- -The positive and negative terminals of the power supply must not be short circuited
- -Different types of batteries or old and new batteries cannot be mixed together
- -The packaging of this product contains important information, please make sure to keep it
- -The battery must be installed according to the positive and negative polarities indicated in the diagram
- -Rechargeable batteries should be removed from toys before charging
- -Note: Only applicable to remote control

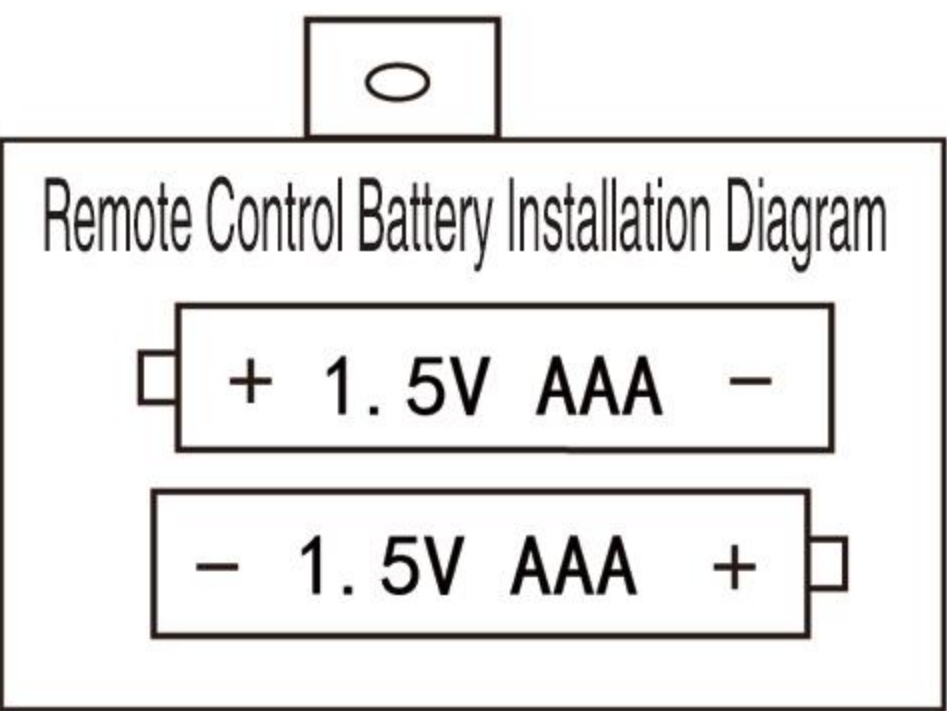

Fault Type

Adverse conditions	Key inspection points
The car doesn't move	Are the various function switches of the electric vehicle turned on Does the fuse provide jump protection Is the battery connection cable detached Is the DC plug of the charger plugged into the charging dock
The car is driving slowly	Is the battery sufficient? Is the electric vehicle overloaded
The battery cannot be fully charged	Is the charger or battery broken

Description

Name	Specifications
Storage battery	12V/24V
Electrical machinery	12V/24V
Use age	37-108 months
Maximum load	50KG
Product size	1220X790X820mm
Charging time	Charging for 8-12 hours
Charger	Input: 110-240V

Maintenance

To ensure that your baby is protected from accidental injuries, please regularly inspect and maintain this car. Before assembly, please check if the packing components are complete. If there are any missing items, please contact our company as soon as possible.

Regularly check for loose screws and damaged parts.

When installing or using various components, please regularly check whether they are in good condition. Please clean this product regularly and be careful not to damage the electrical components.

When disassembling and assembling, please carefully read the user manual to avoid unnecessary damage. Please regularly inspect the product and the charger used to see if the wires, plugs, casing, and other components are damaged.

When damage is found, it should be stopped from use until it is repaired.



Warn

- The assembly and adjustment of the product must be carried out by adults, please keep children away from moving parts.
- Warning! Not suitable for children under 36 months old! Contains small parts.
- Children must use this product under adult guidance, and caregivers must not leave or approach fire during use!
- Do not allow children to stand or play on pedals (or inside electric bikes).
- Battery charging must be completed by adults, please charge before using this product.
- To avoid harm to children, please keep plastic bags and other packaging materials away from children! There is a risk of suffocation!
- Prohibit the use of any accessories not provided by the manufacturer.
- All batteries should be installed with the correct polarity.
- Do not use the charger as a toy for children.



Warn

- The maximum load capacity of this vehicle is 30KG, and overloading is not allowed.
- Toys cannot be connected to more than the recommended number of power sources.
- Non rechargeable batteries cannot be charged.
- The power terminal cannot be short circuited.
- The age range for using this car is 37–96 months.
- Rechargeable batteries can only be charged under adult supervision.
- Different types of batteries or old and new batteries cannot be mixed.

Charging precautions!

- When using an electric vehicle for the first time, it is necessary to ensure that the battery is fully charged for 12 hours, otherwise it will permanently damage the battery and cannot be repaired.
- When charging, first insert the charger plug into the charging port, and then plug the charger into the power outlet.
- When the vehicle is charging, the toy (whole vehicle) cannot be operated. It is normal for the charger and battery to generate heat (below 60 °C) during the charging process.
- If there is water accumulation in the connector, it cannot be charged, otherwise it may cause a short circuit.
- This electric vehicle must use the charger and battery equipped with the vehicle to avoid damaging the charger, battery or circuit.

Precautions for use!

- Before use, please check if all components are installed properly and connected securely.
- Not allowed to be used in dangerous areas such as streets, public transportation roads, slopes, and ditches.
- Please do not use on smooth surfaces such as marble, floor tiles, etc.
- Do not switch the forward/reverse switch during the operation of the electric vehicle.
- Be careful not to let the child stand in the seat.
- Do not modify the wiring of this vehicle or add live devices.
- The remote control and electric vehicle must not be exposed to water or used in water. Try to stay away from sources of fire to avoid damaging the circuit.
- When encountering obstacles, the electric vehicle stops running. Please leave the obstacle before moving forward.
- When the remote control battery is low, the whole vehicle will only be able to move forward and backward remotely, and cannot move left and right remotely. Please replace the battery!
- When not in use, please turn off the power switch; When not in long-term use, please unplug the battery connector.



Warn

1. This machine uses high-quality lead-acid batteries. Please use them with confidence and do not drop, touch, disassemble or puncture them on your own;
2. Do not expose this product to fire, high temperature, or water: If you notice any other adverse effects such as swelling on the body, please stop using this machine.
3. This device is not suitable for individuals with low physiological, perceptual, and mental abilities (including children) unless there is someone specifically responsible for their personal safety to supervise and guide them in using this device. Children should be taken care of to ensure that they use this device properly.