

WALKER EDISON™

Chantelle Upholstered Bench

SKU# WECHA27554

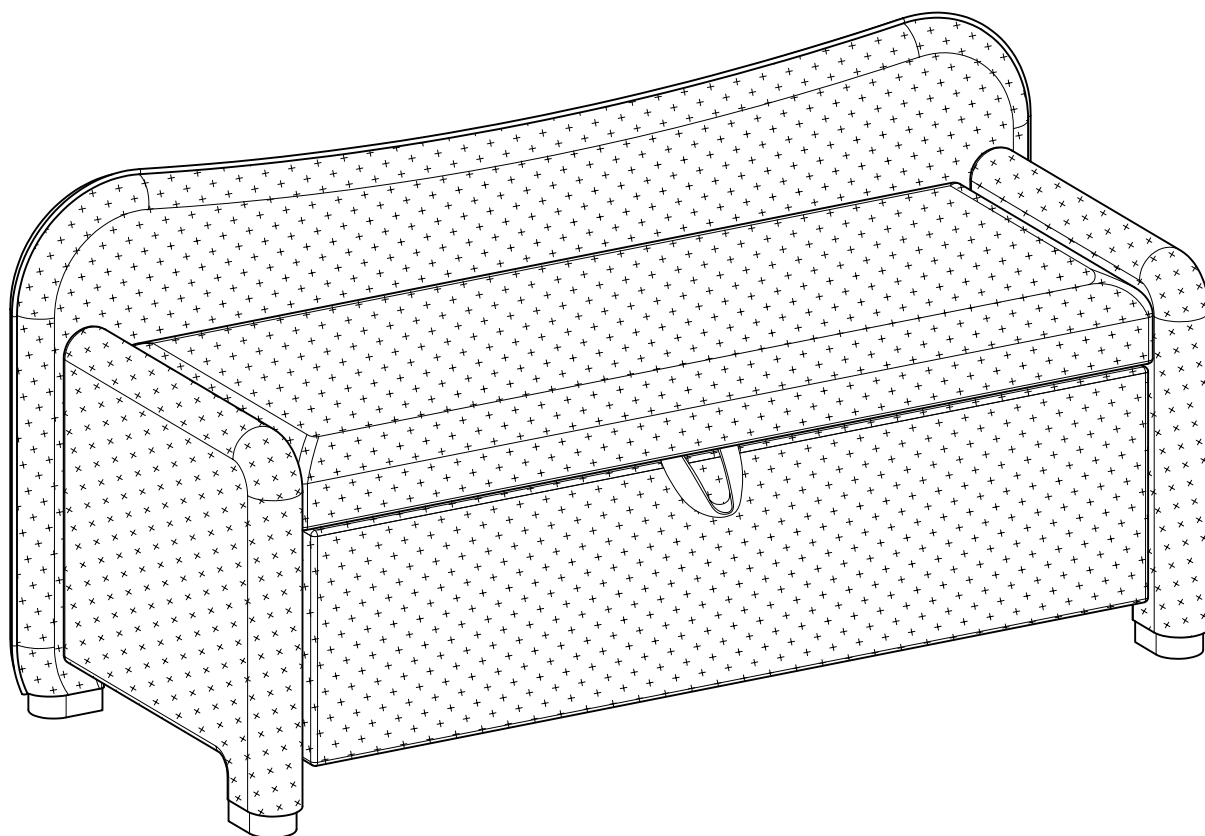

For Residential Use Only

Please visit our website for the most current instructions, assembly tips, report damage, or request parts. www.walkeredison.com



Time to get started

Set up a clean and soft workplace to get started and avoid damage during the assembly. It also helps to double-check that you've got all the pieces and parts before diving in to assembly.

Estimated time for assembly

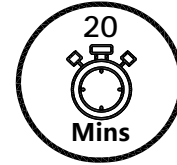

People recommended for assembly

Make it a team effort! Grab a friend for quicker, easier assembly.

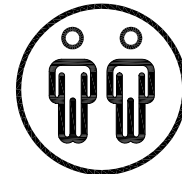

2 People Build



Chantelle

Scan to get assembly tips and help!

WE Parts List

Part Number	Description	Quantity
1	Back Cushion	1
2	Left Side Frame	1
3	Right Side Frame	1
4	Front Frame	1
5	Seat cushion	1
6	Left Bottom Panel	1
7	Right Bottom Panel	1

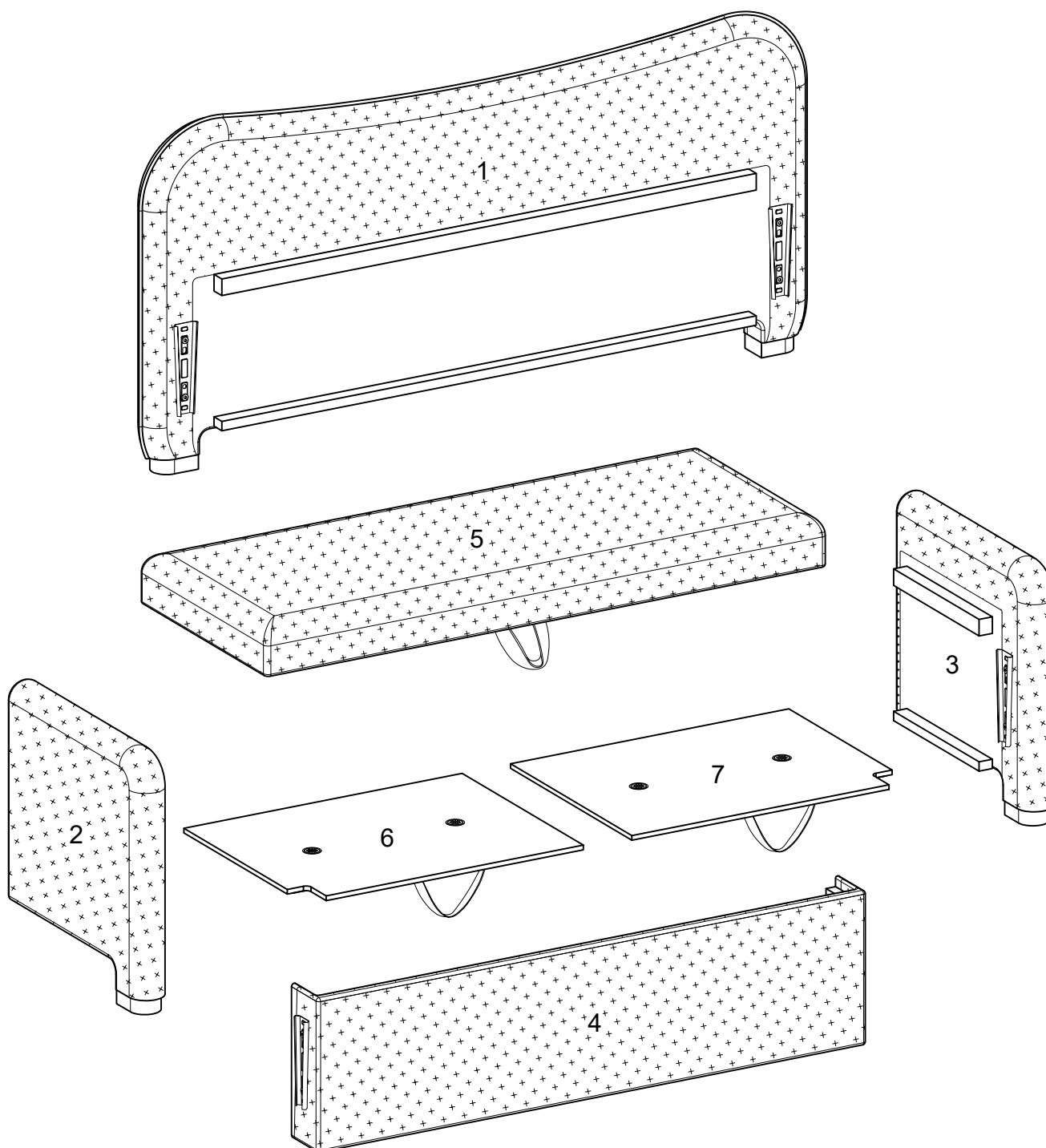

Step 1

Connect the Left Side Frame (2) to the Back Cushion (1) by sliding it into place with the attached hardware.

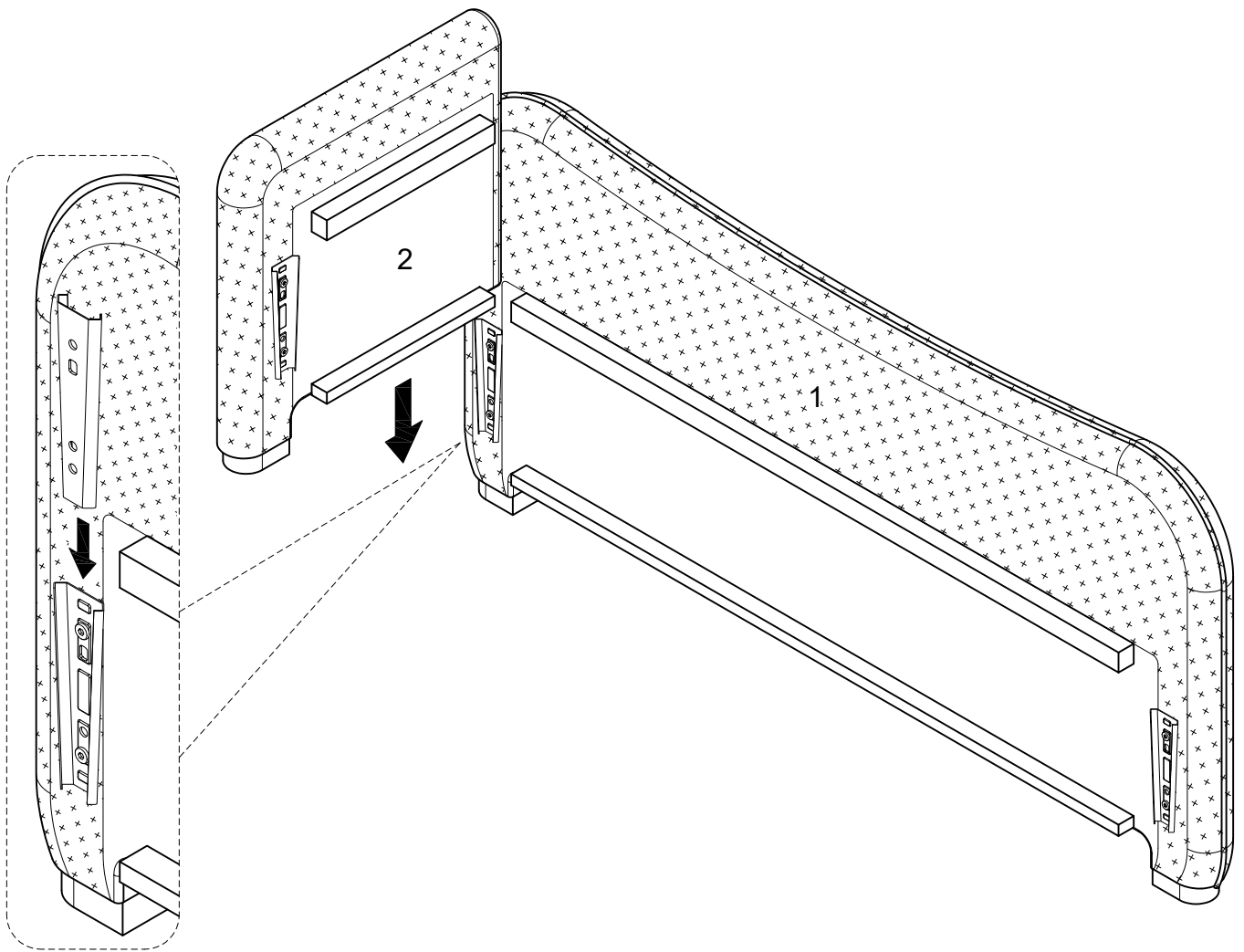

Step 2

Connect the Right Side Frame (3) to the Back Cushion (1) by sliding it into place with the attached hardware.

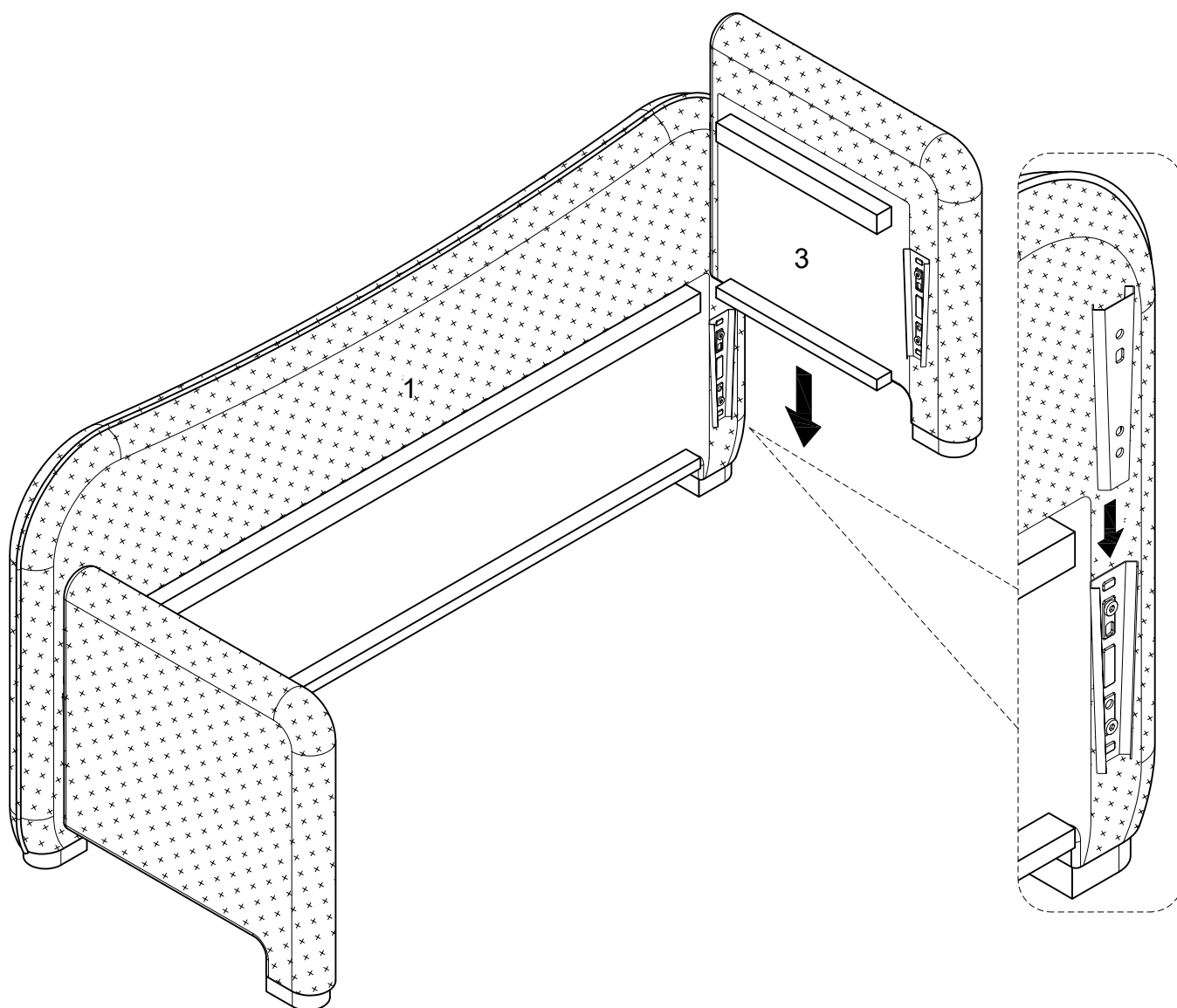

Step 3

Slide the Front Frame (4) into place, attaching it to the Left Side Frame (2) and the Right Side Frame (3).

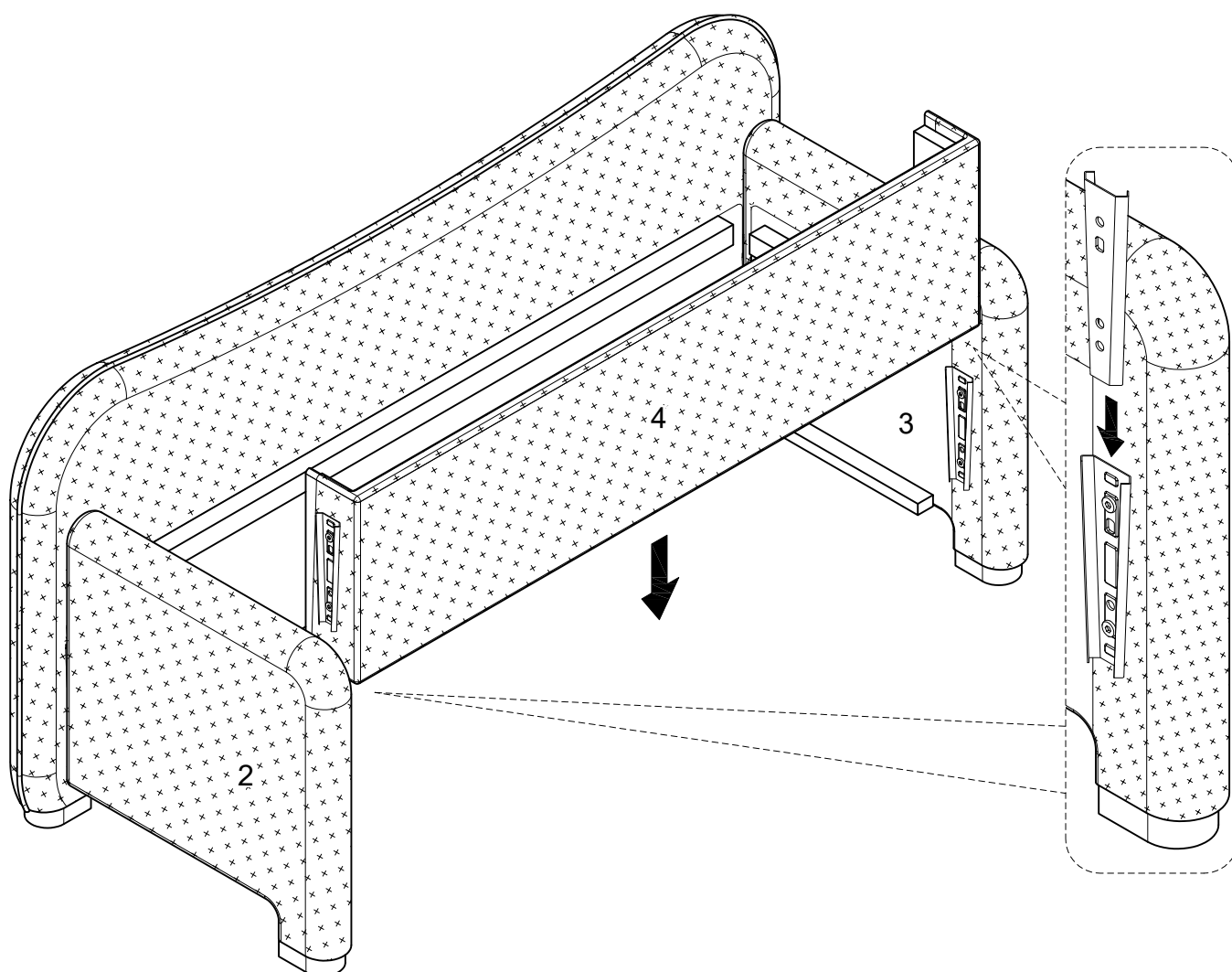

Step 4

Place the Left Bottom Panel (6) and the Right Bottom Panel (7) into the bench.

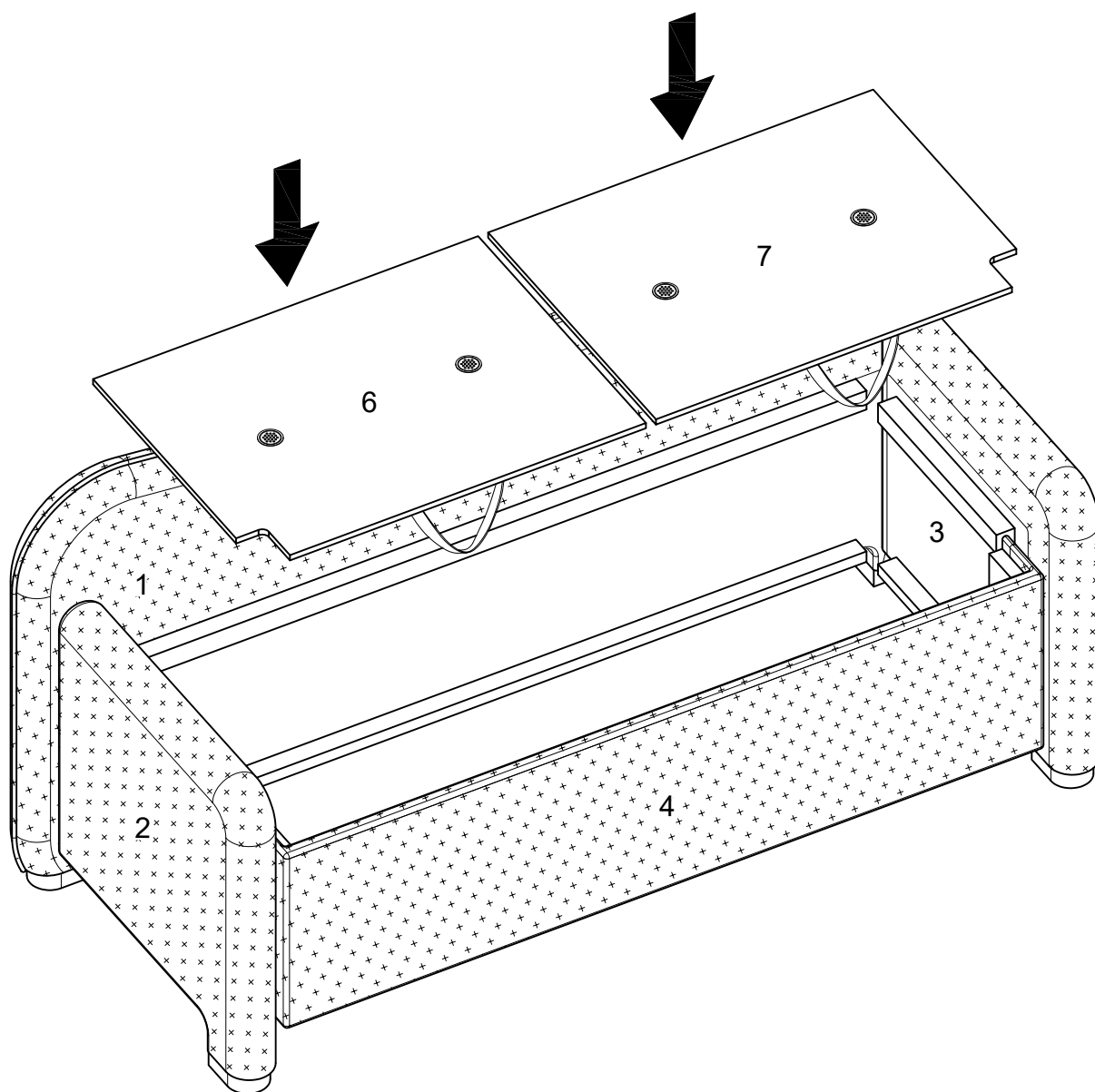

Step 5

Place the Seat Cushion (5) onto the bench.

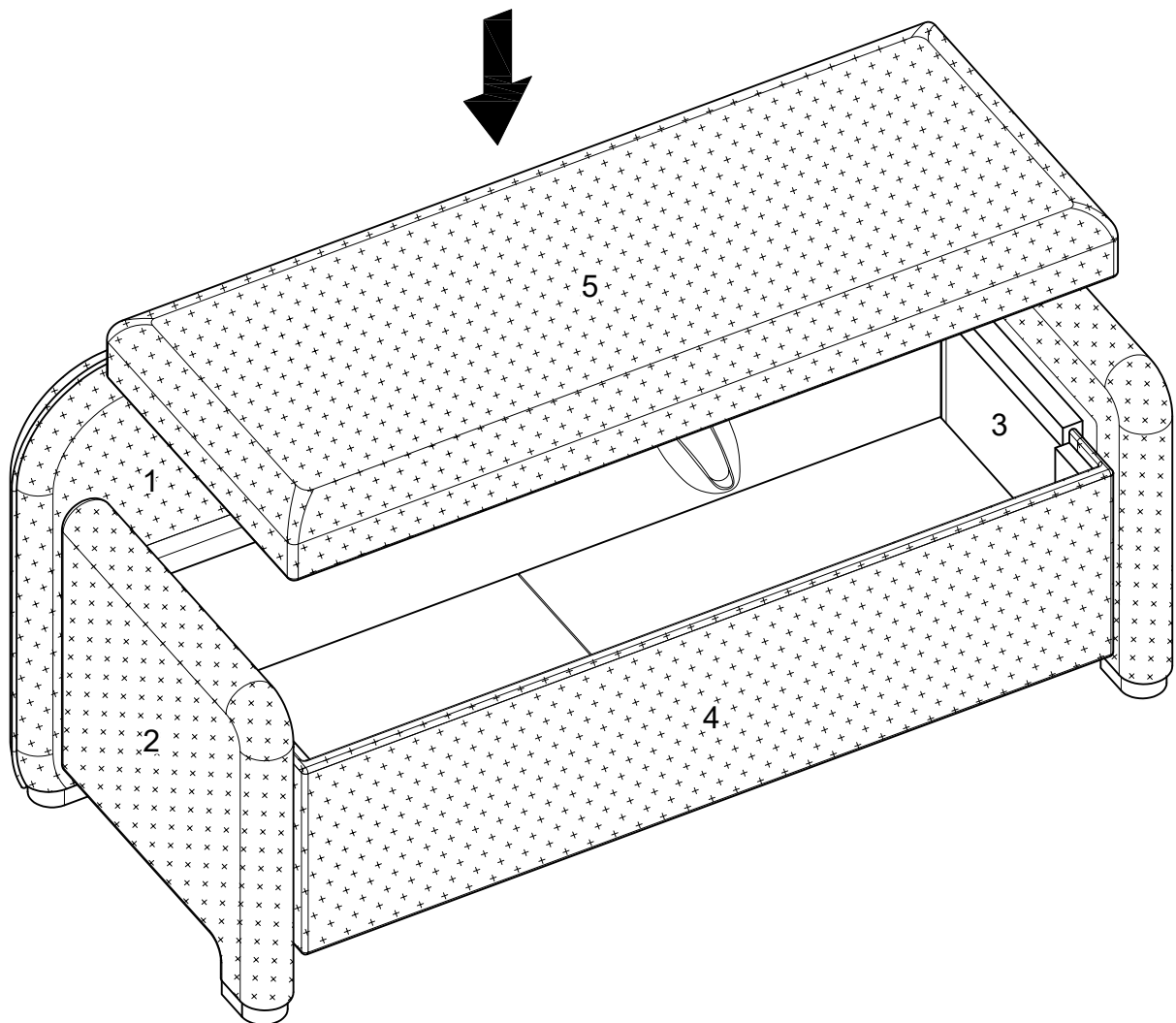

Final Assembly

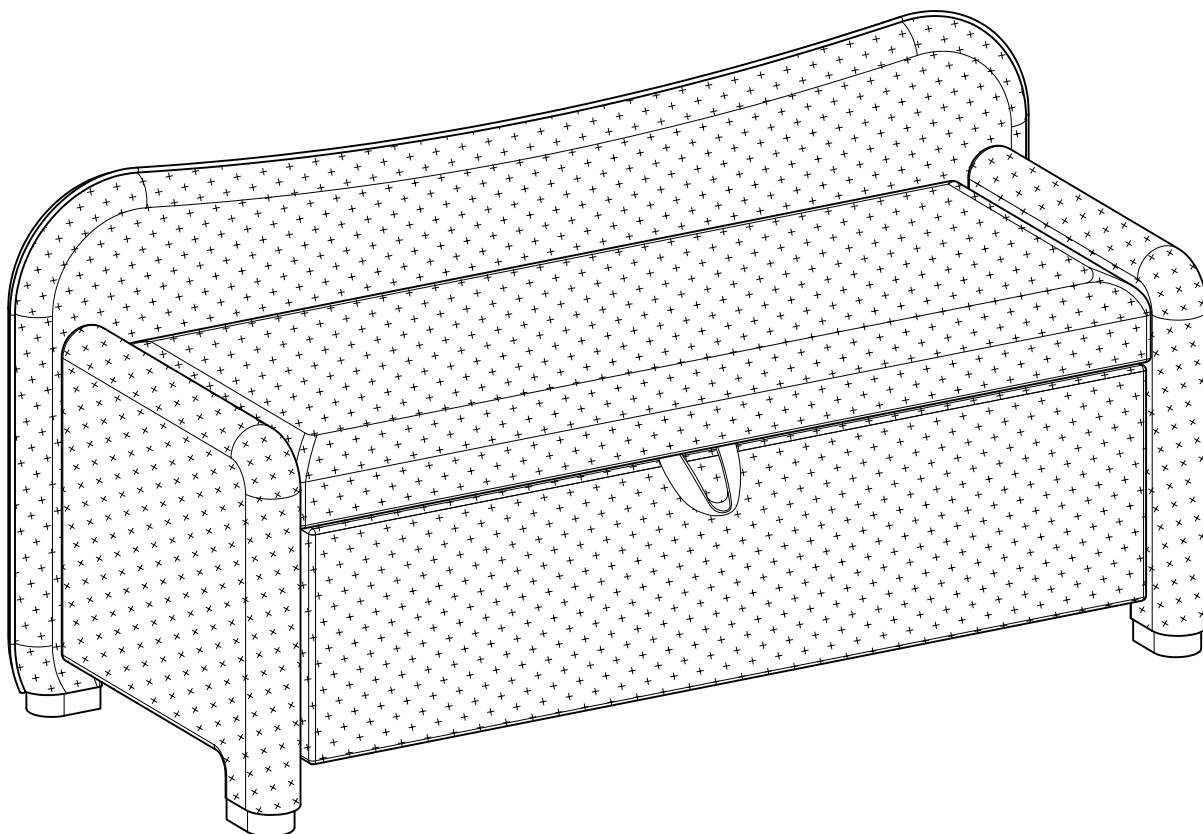

Congratulations on your new piece of furniture!

We would love to hear about it and see it.
Please leave us a review or post a picture with
#mywalkeredisonhome

Assembling furniture can be tricky sometimes.

Our customer service team, located in Utah, is here for product information, help assembling a product, or for any other customer support issue

Call us at **801-433-3008**

Email us at [**service@walkeredison.com**](mailto:service@walkeredison.com)

Visit our Customer Service website at
[**walkeredison.com/pages/customer-service**](https://walkeredison.com/pages/customer-service)

We are available to help Monday -Thursday 8am-5pm, Friday
8am-3pm MST

For details on Assembly Videos, Assembly Instructions,
Replacement Parts, and Customer service,
SCAN HERE

