

ASSEMBLY INSTRUCTION

1. -2PCS



A. -12PCS



B. -1PC



C. -12PCS



2. -2PCS

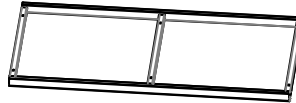

D. 12PCS*MB*40MM

MBSCREWS



3. -2PCS

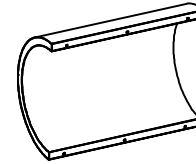

1 6HOLES

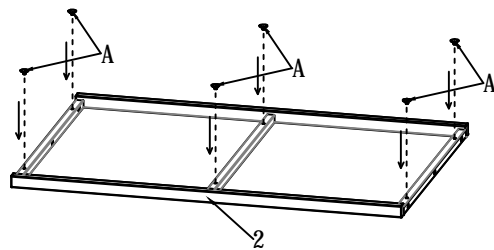

2 6HOLES

Screws: 6PCS*MB*40MM

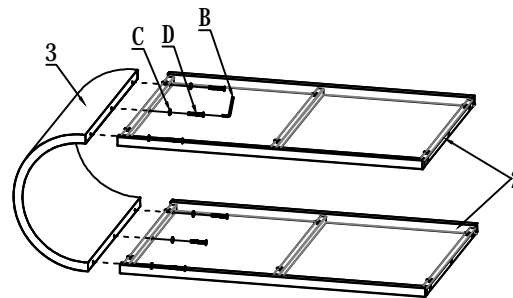

3 6HOLES

Screws: 6PCS*MB*40MM

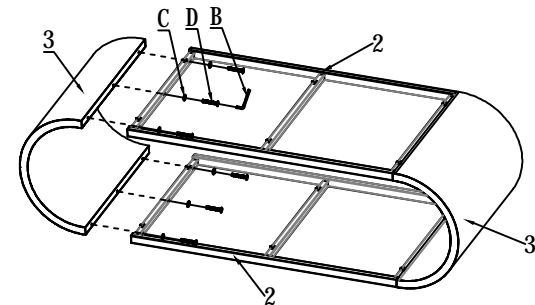

4

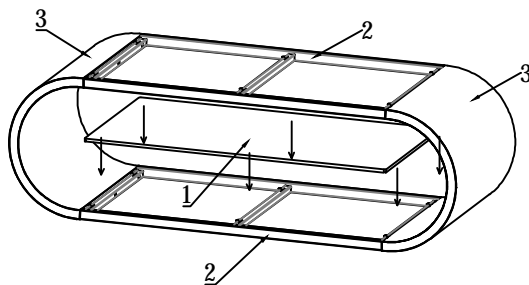

5

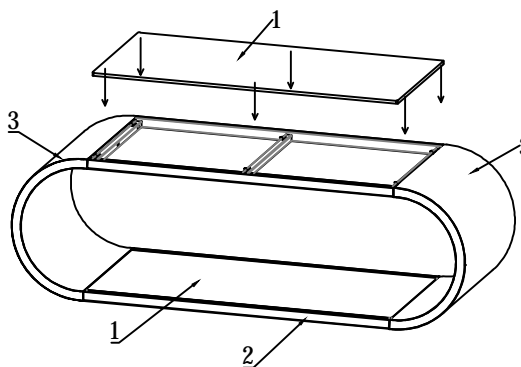

6

COMPLETE



Note: Make sure all screws attached placing into right places before install tightly!!