

ASSEMBLY INSTRUCTION

BAR STOOL LUANDA

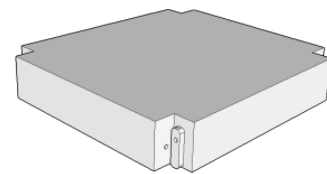

Components



SEATING PART

A [1x]



FRONT LEGS

B [2x]

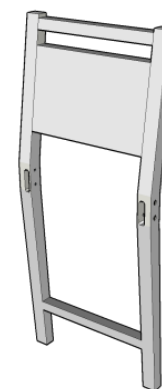

BACK REST PART

C [1x]

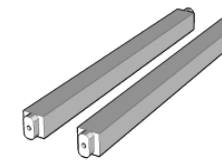

SIDE
FOOT CROSS

D [2x]

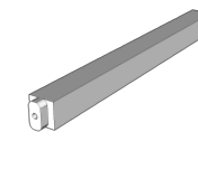

FRONT
FOOT CROSS

E [1x]

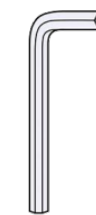

HEX L KEY

F [1x]



SKREW

G [16x]

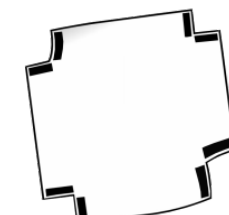

MICRO FABRIC

H [1x]



Make sure all bolts and screws are fully tightened before using chair.

Before Assembly

- Remove all wrapping materials, staples and packing straps
- Read the Parts List and Hardware List carefully, make sure all parts and hardware are intact
- Place all parts on a clean and smooth surface, such as rug or carpet, to prevent the parts from being scratched
- Do Not cross-thread screws
- Do Not use electric tools

1

ASSEMBLE
FRONT FOOT CROSS

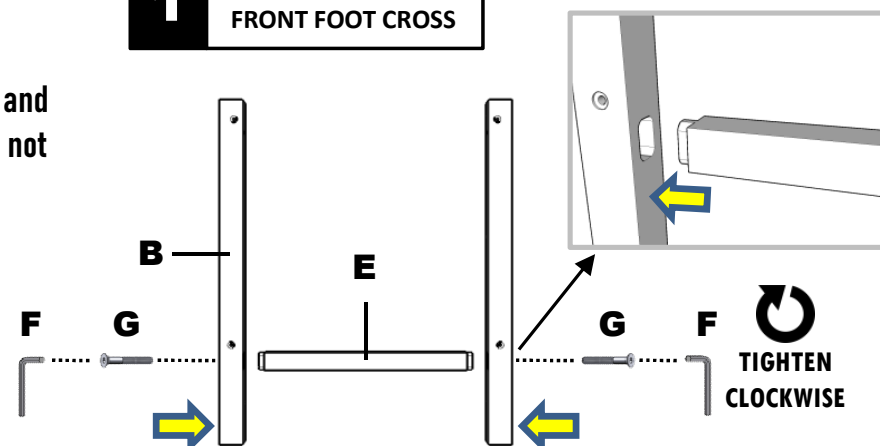

2

ASSEMBLE
SEATING PART

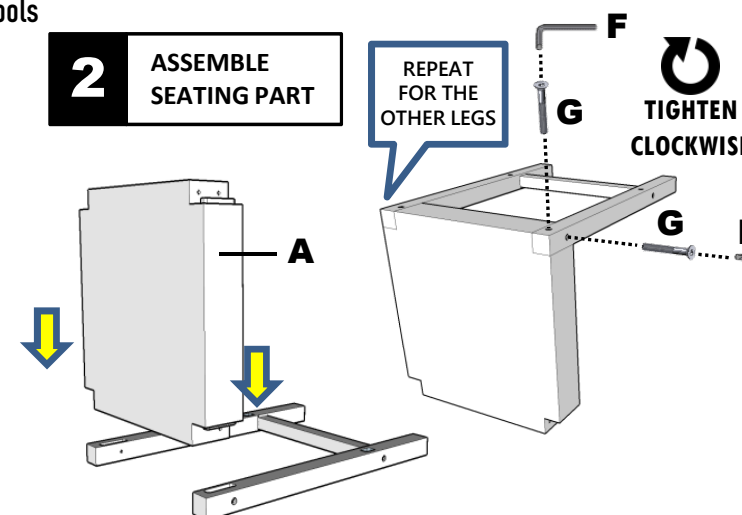

3

ASSEMBLE
SIDE FOOT CROSS

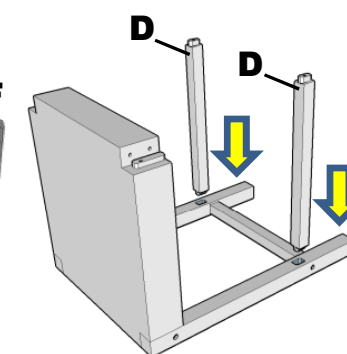

4

ASSEMBLE
BACK PART

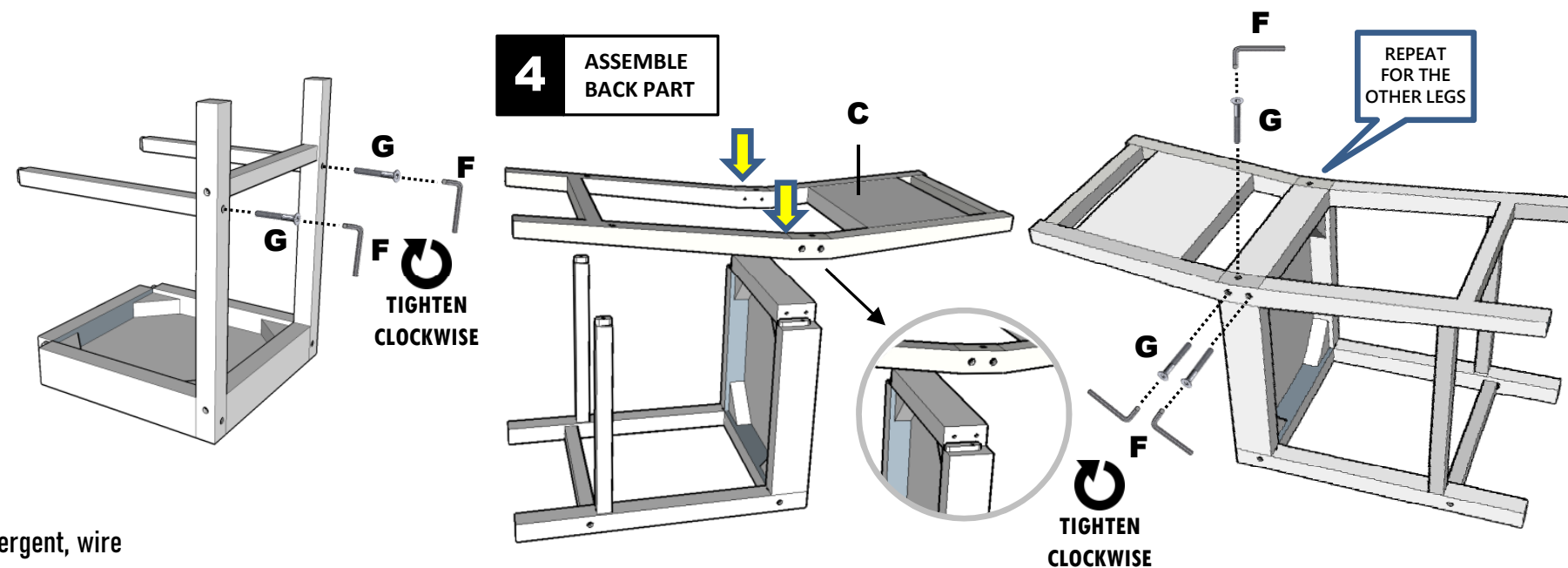

5

COVER UP THE
BOTTOM OF CHAIR

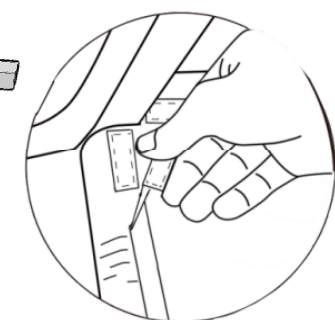

THANK YOU FOR PURCHASING OUR PRODUCTS

This furniture is designed for indoor application. Please read this instruction carefully and Use all the items correctly as described. And please kindly note that the warranty does not Apply to any product that has been improperly used

THIS INSTRUCTION SHEET CONTAINS
IMPORTANT INFORMATION
PLEASE READ AND KEEP IT FOR FUTURE REFERENCE



Safety and Care Advice

Warnings



- Use on level surface only
- Do Not stand on the chair or use it as a ladder
- Only one person sitting on the chair at a time is permitted
- Do Not use the chair if parts are damaged or screws are loose or missing only
- Do Not sit on the edge of the seat only
- Do Not allow kids to play with the chair only
- Never leave children alone with the chair only
- Severe injuries will occur, if these warnings are ignored

Cleaning & Maintenance

CLEANING • Wipe with a soft, slightly moist cloth • Never use corrosive detergent, wire brushes, abrasive scourers, metal or sharp tools

MAINTENANCE • Check and tighten all parts regularly • if this chair in damage or seem unsafe, immediately contact us for after sales services