

1 x 1

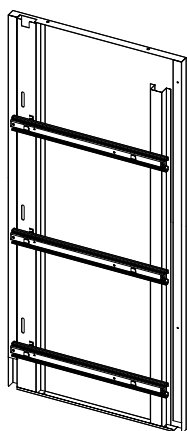

2x1

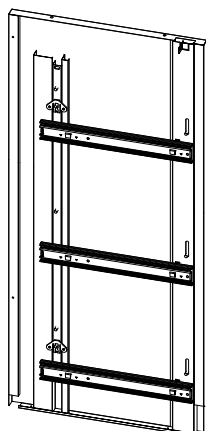

3x1

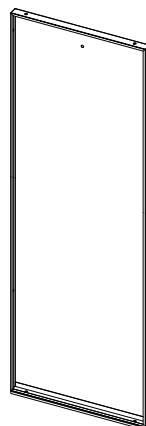

4x1

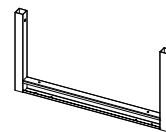

5x1

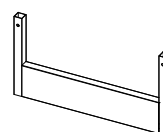

6x1

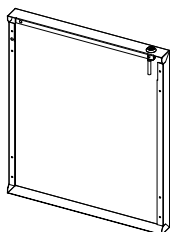

7x3

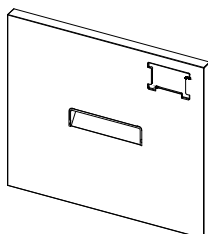

8x3

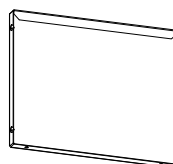

9x3

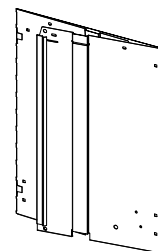

10x3



A×30



M4x $\frac{8\text{mm}}{0.3\text{inch}}$

Bx16



M4x $\frac{16\text{mm}}{0.6\text{inch}}$

Cx1



M8



M5x $\frac{30\text{mm}}{1.18\text{inch}}$



M5

E×4

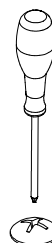
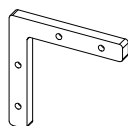

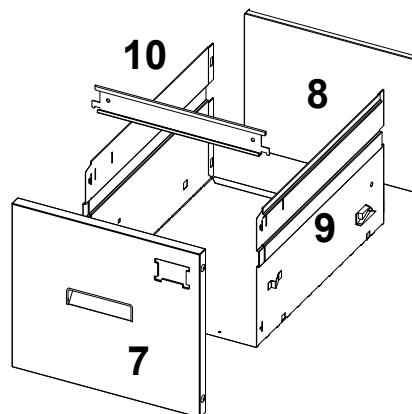
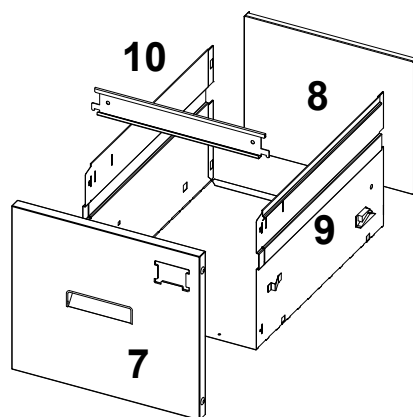
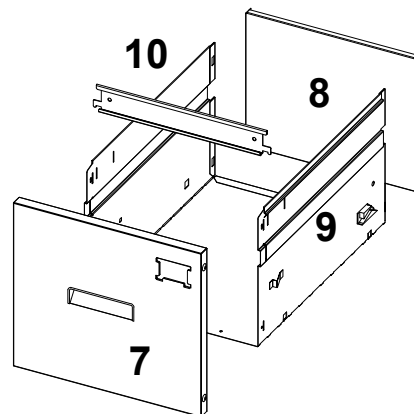
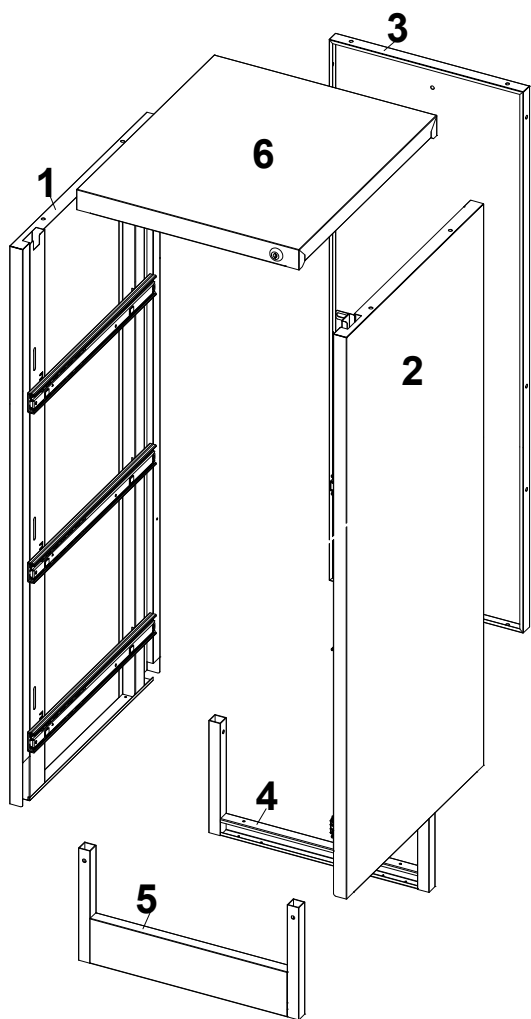

Step 1

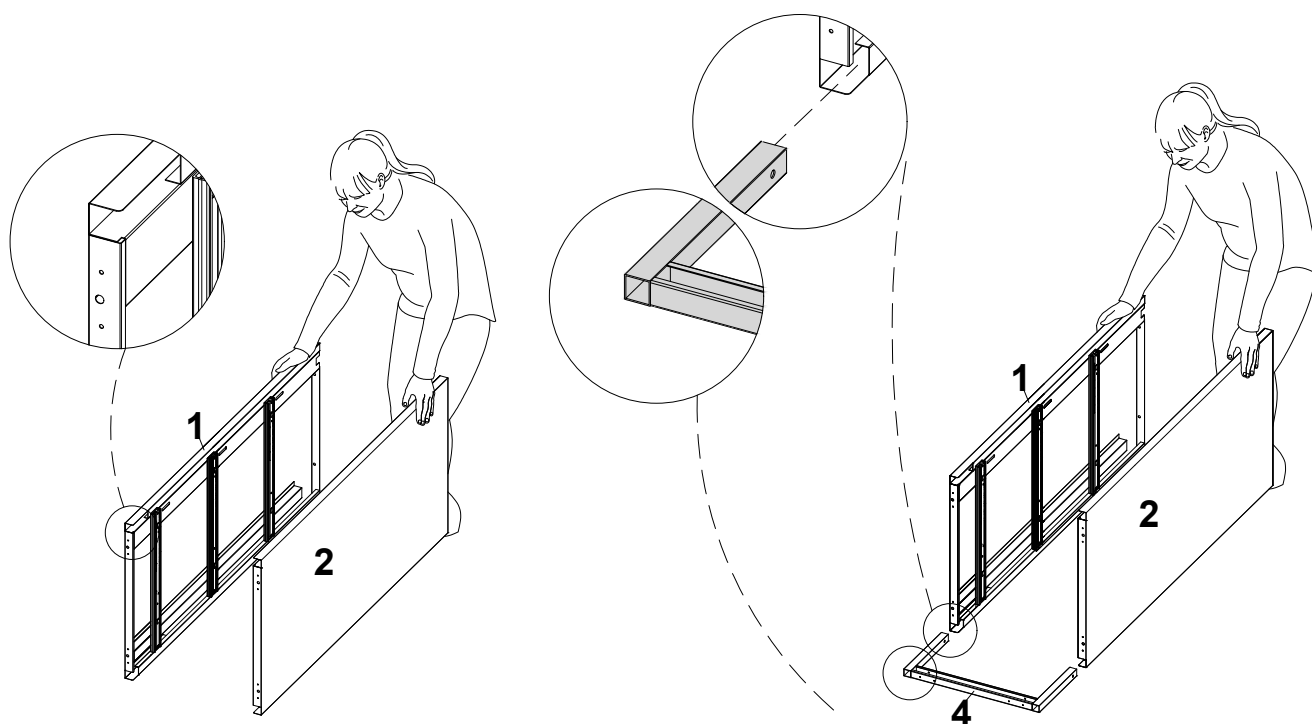

Step 2

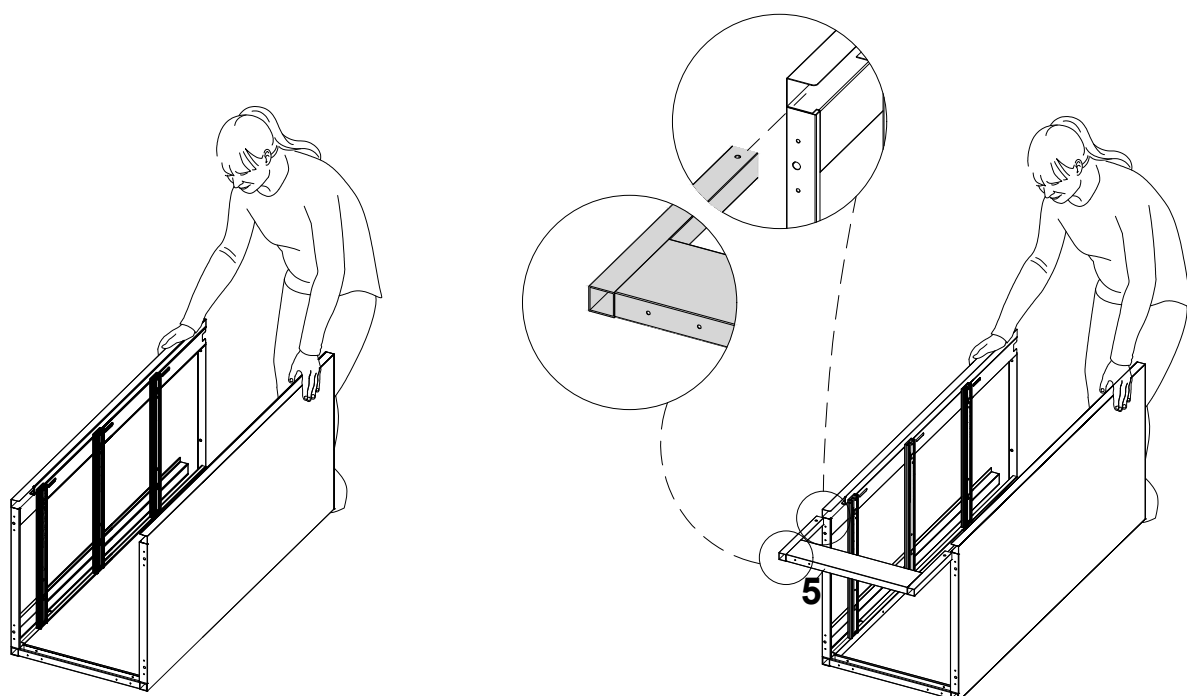

Step 3

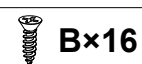
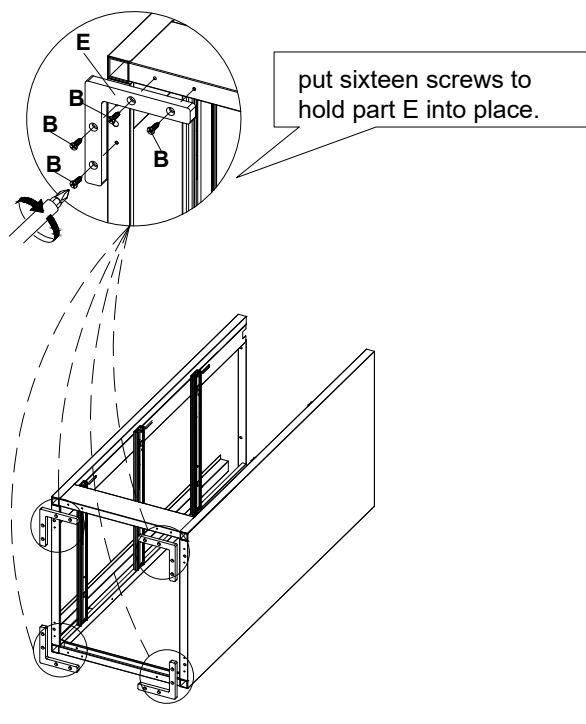

Step 4

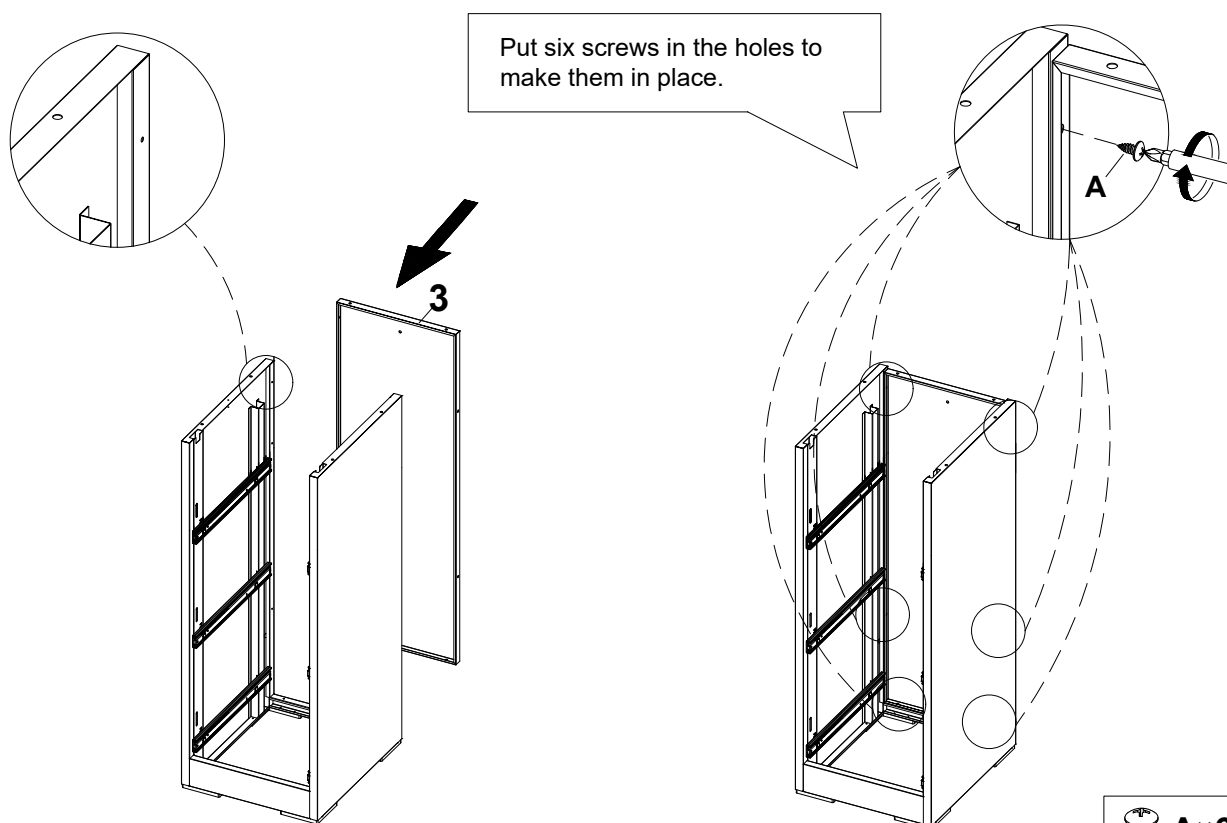

Step 5

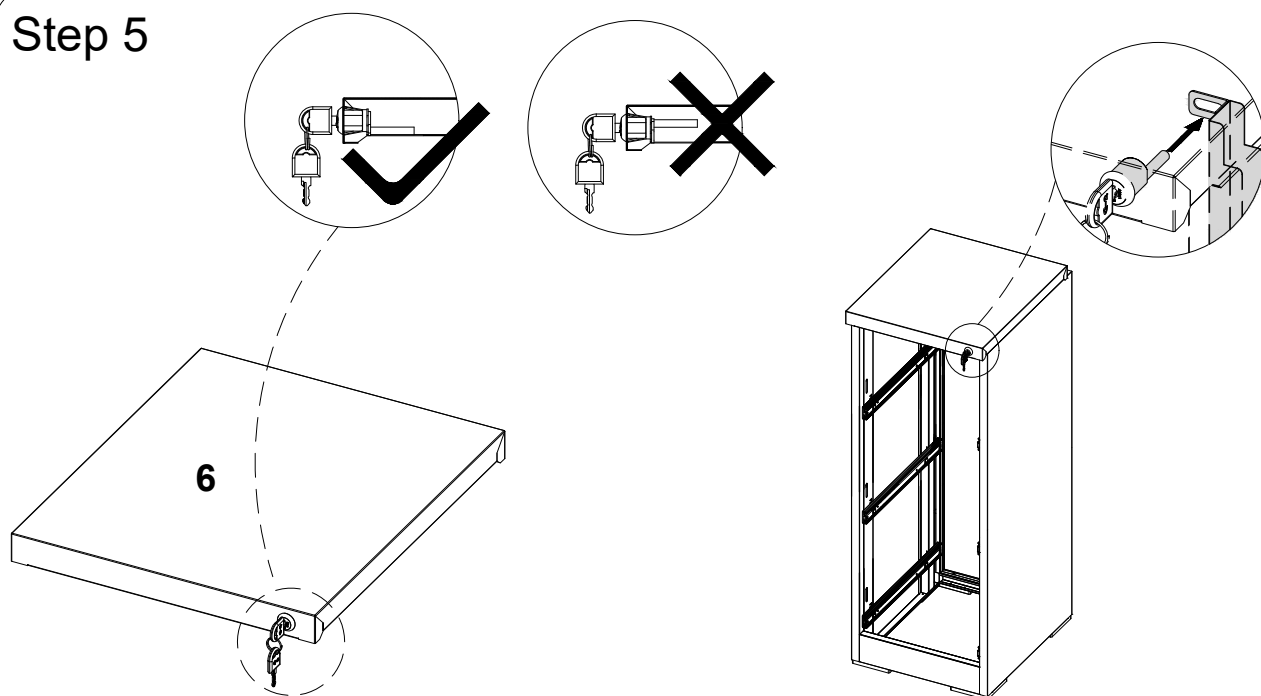

Install the top panel: Fix part 6 into place (Note: as the picture shows--The lock should be in a state where the back round locking rod is downward, and the round locking rod needs to be inserted into the hole of the vertical locking rod on the right side plate.)

Step 6

Fix the part 6 by 6 pcs A screws.

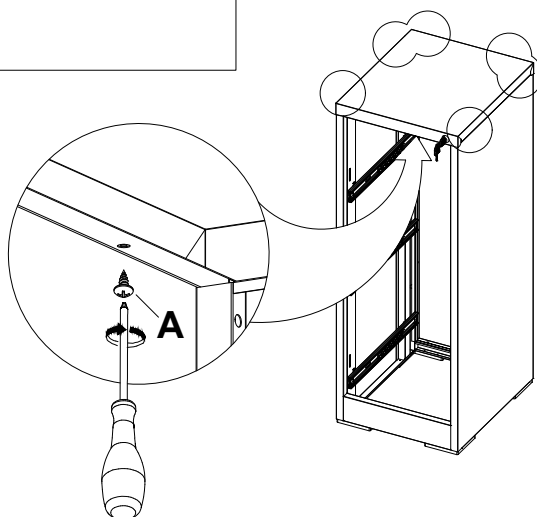

Step 7



Suggest Fix the Cabinet to the Wall
by following Step, more Stable

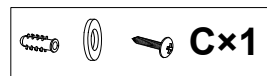
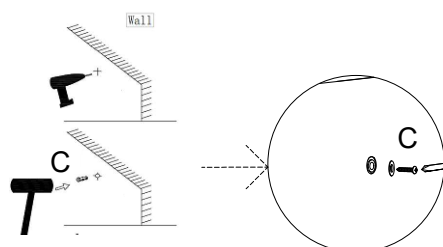
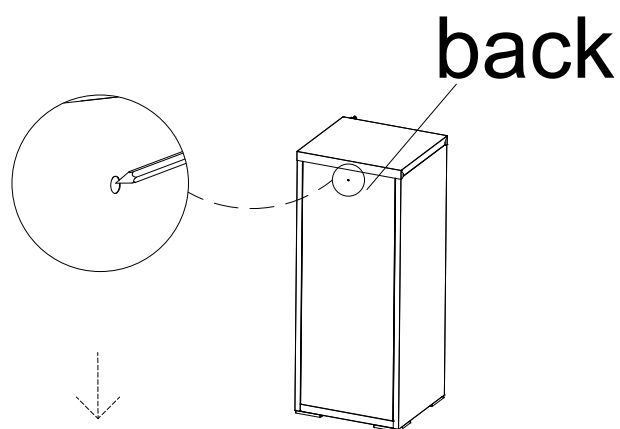

Step 8

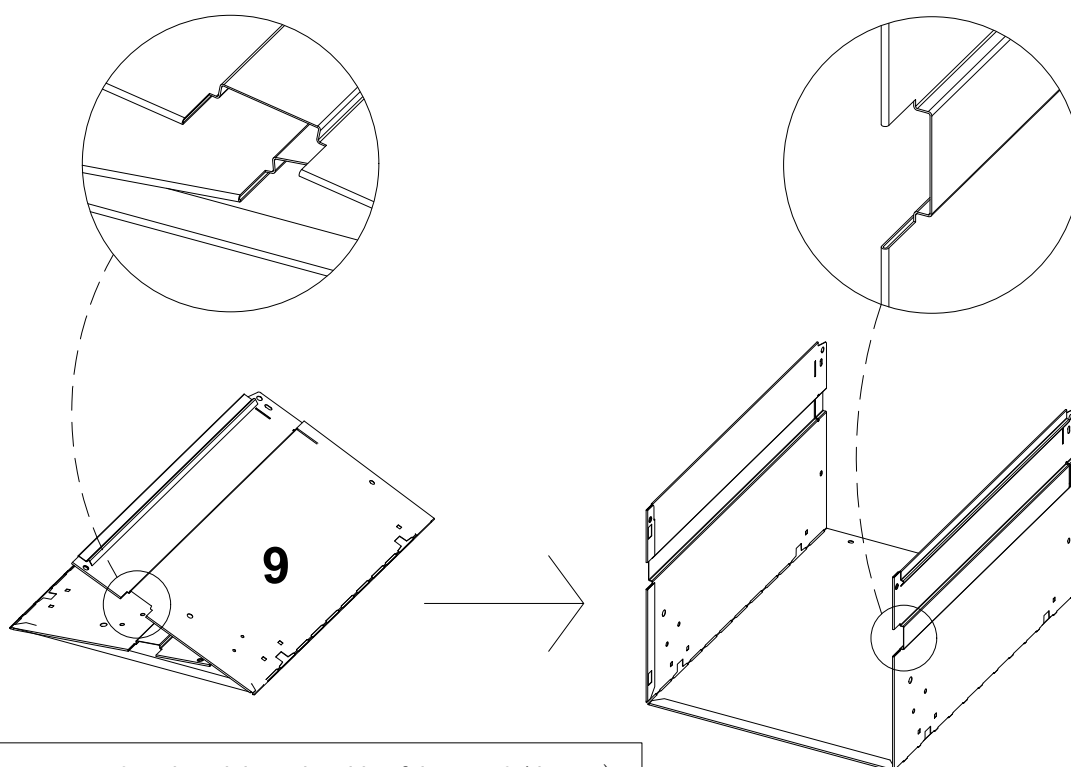

Please open part 9 and straighten the side of the part 9 (drawer)

Step 9

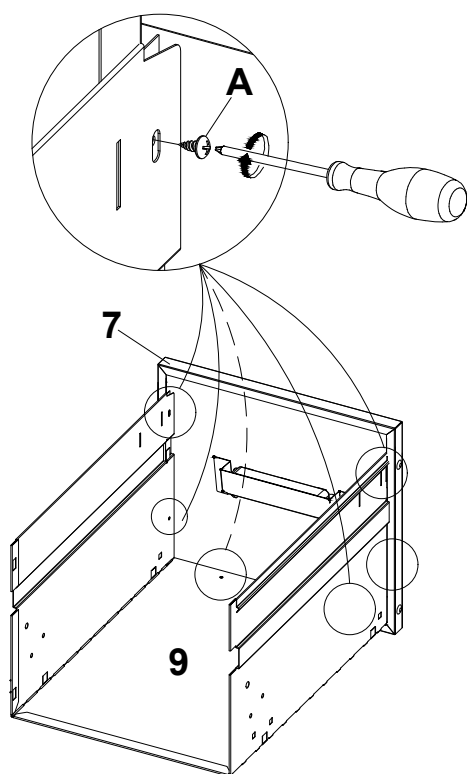

Connecting 7 and 9 together with 6pcs A screws.

Tap part 8 backwards until the edge protrusion snaps into the hole in part 9

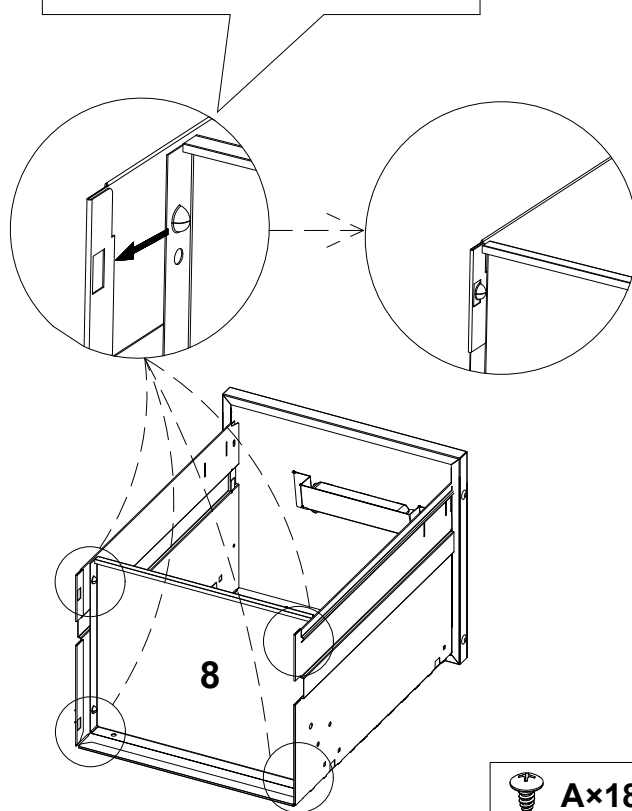

 **A×18**

Step 10

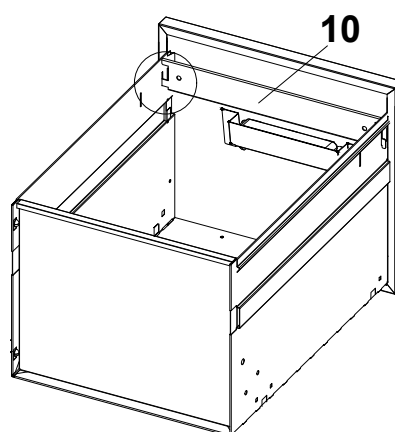
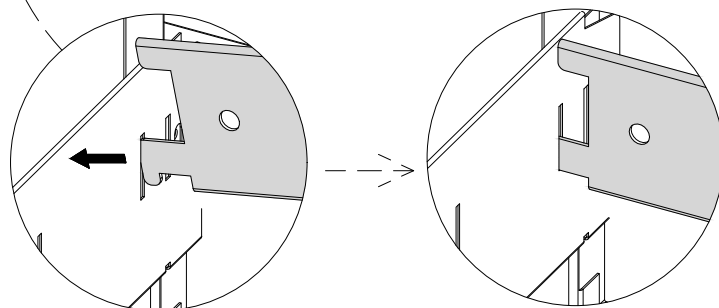
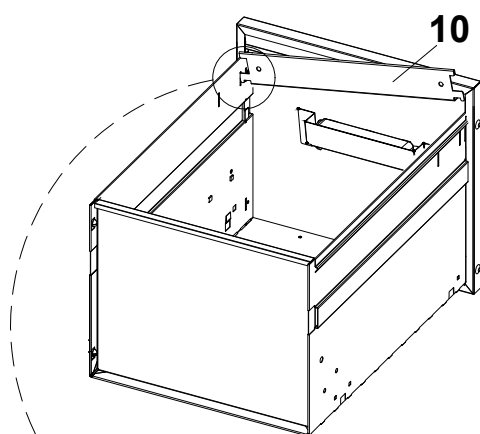

Step 11

Pull out the two drawers on the side wall for easy installation of the drawers

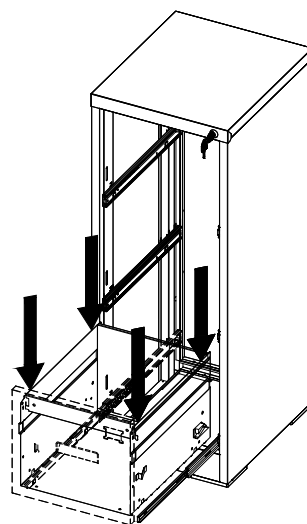
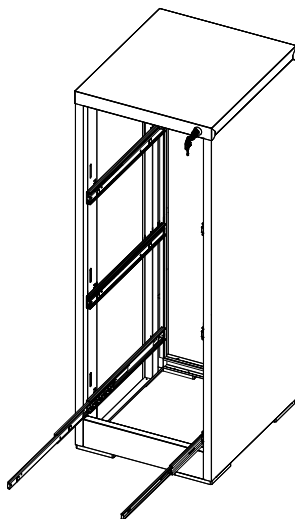

Step 12

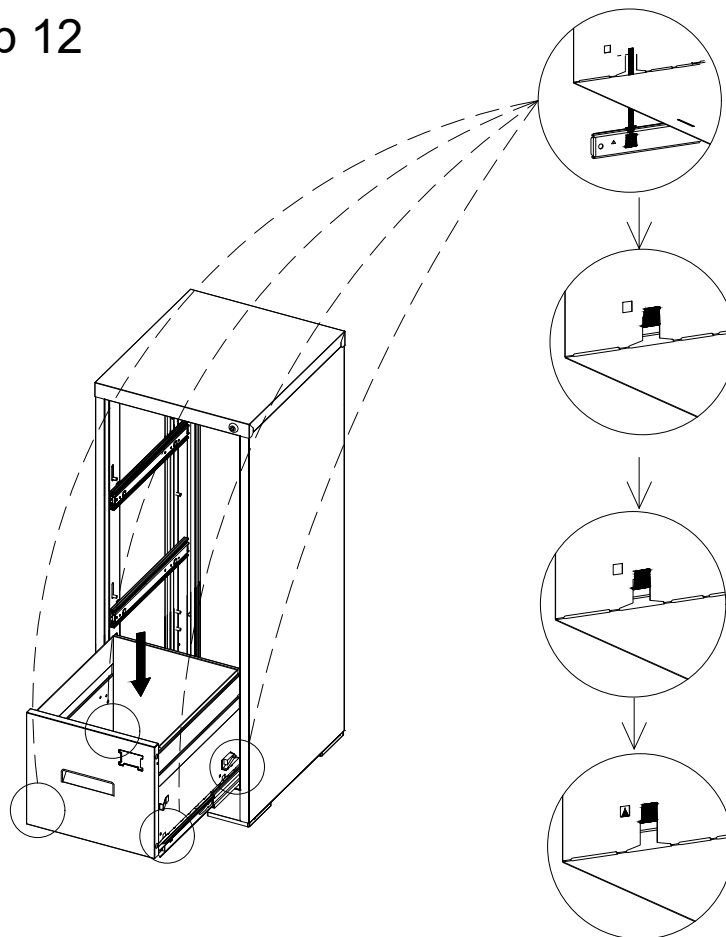

1. 2 people needed: Align the buckles on the inner small rail with the buckle holes on the drawer. Press the drawer down and lift the slide rail upward simultaneously. Install the four drawers on the slide rails in sequence

2. Fix the notch hook on the inner slide rail into the hole of drawer: After placing the drawer on the rail slide, press down the drawer base hard enough, when the notch hook next to the slide rail snaps into the hole of the drawer and you hear "click" for 4 times, then means all were installed successfully

Step 13

