

Bookshelf

Installation Process

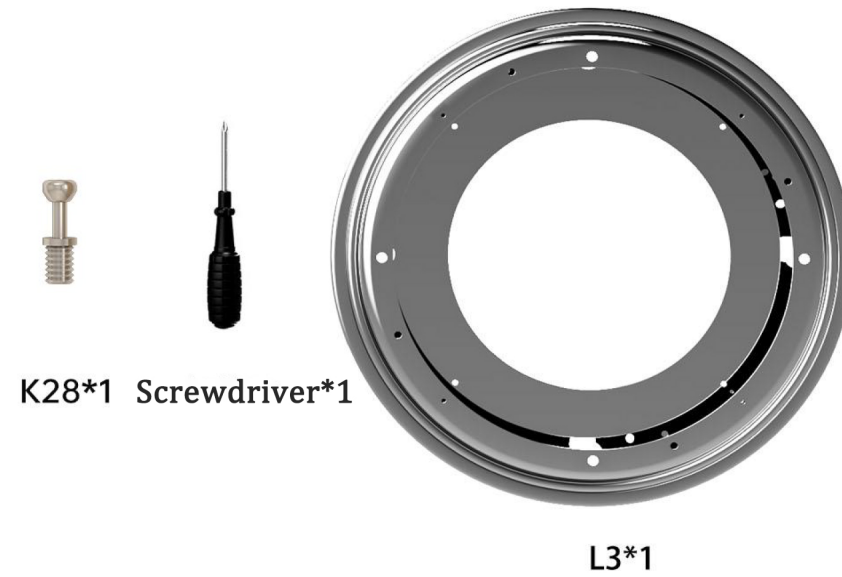

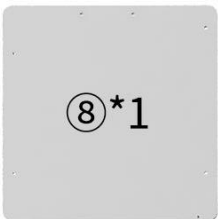

$$⑧ * 1$$

$$④ * 1$$

$$⑤ * 5$$

$$⑦ * 5$$

$$① * 1$$

$$③ * 1$$

$$② * 4$$

$$⑨ * 2$$

$$⑪ * 1$$



$$⑩ * 1$$

$$⑥ * 20$$

Presentation of finished product

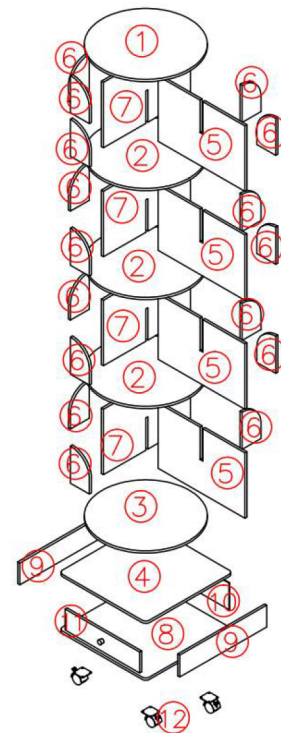

Product Split Diagram



1

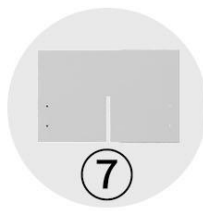
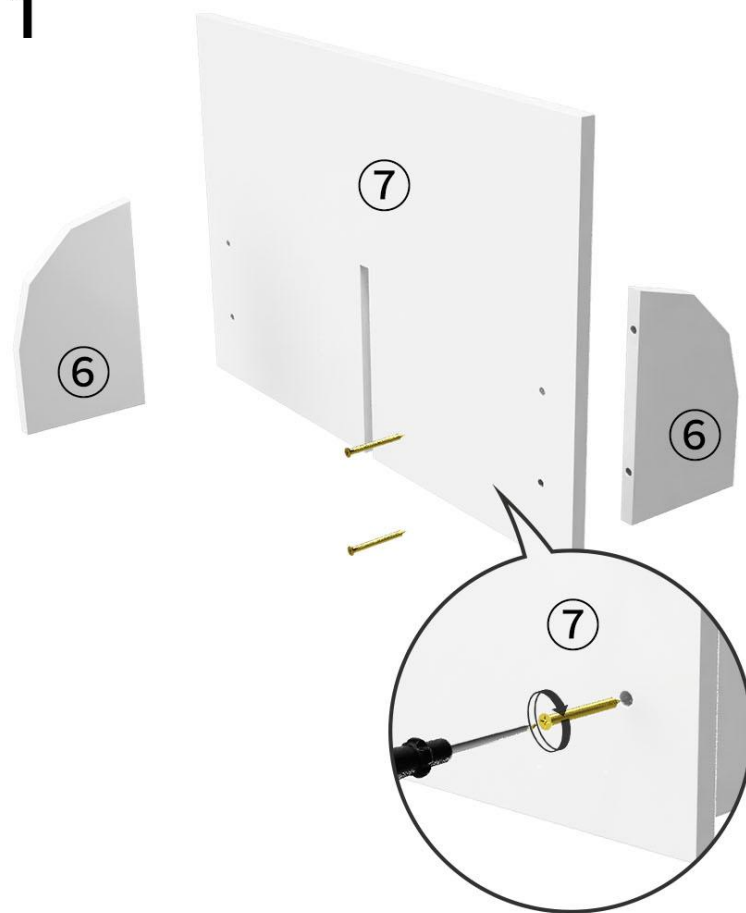

2

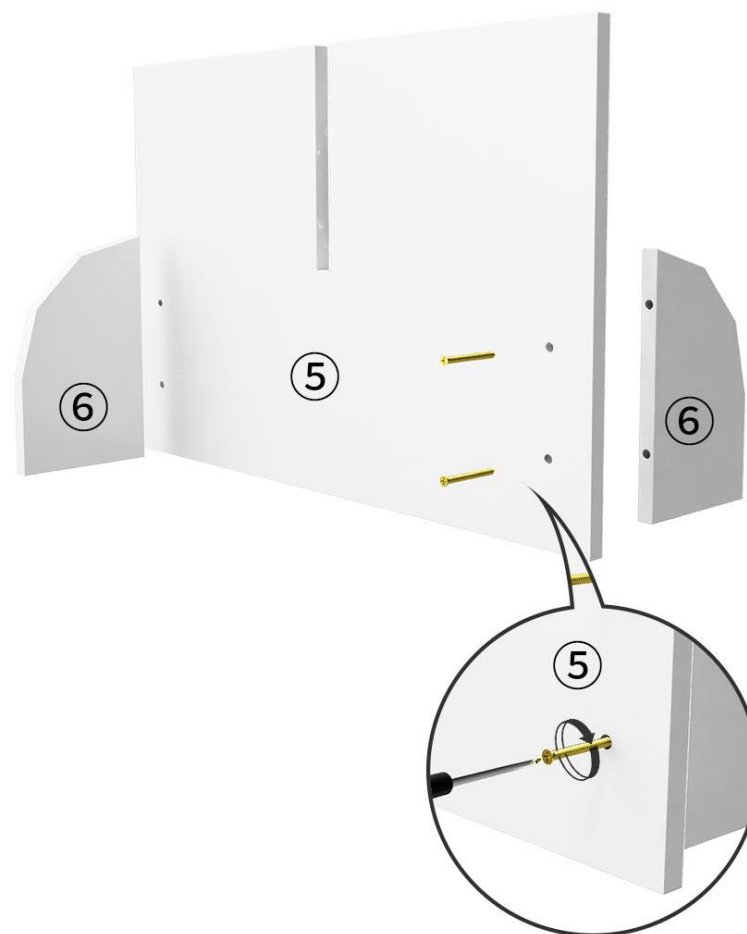

3

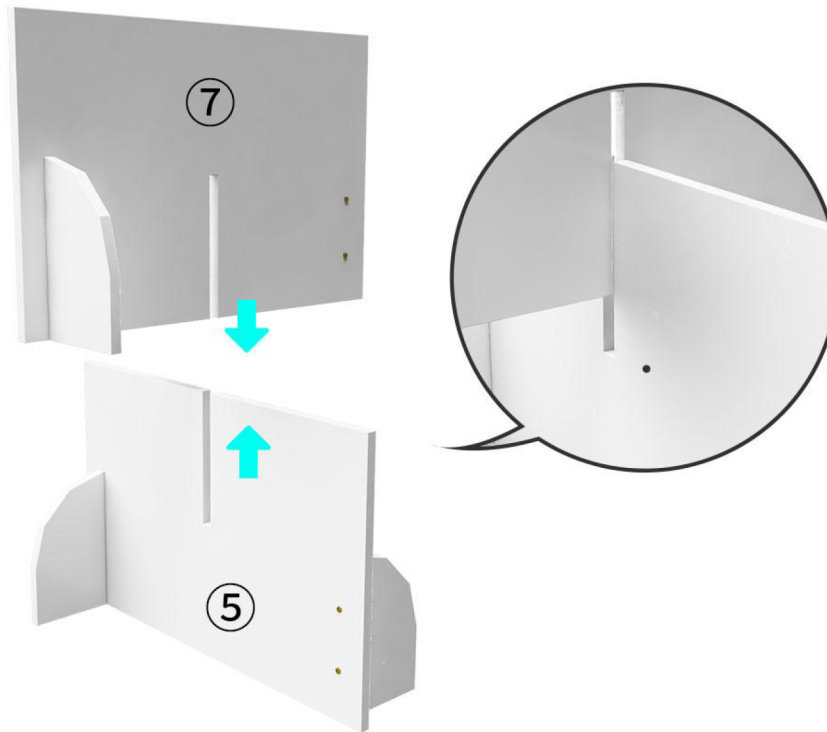

Put the plates from step 1 and 2 together to get a shelf.

4

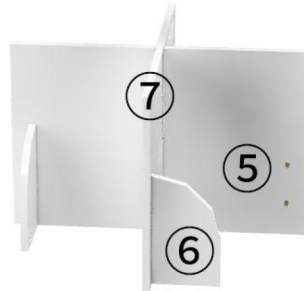

Repeat steps 1, 2, and 3 to
get three racks.

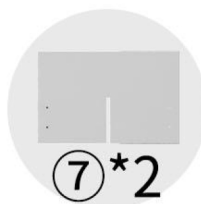

5

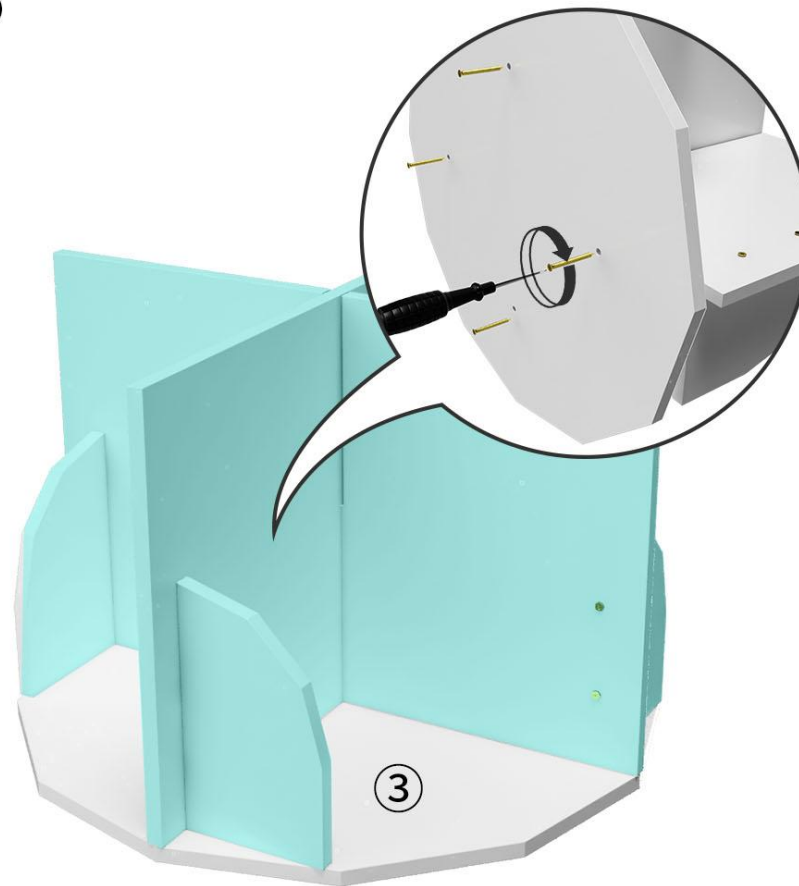

6



Align the large holes in the turntable with the large holes in the ④ board, then screw the small screws into the small holes to lock them in place



7



Reverse the ④ bottom board, Align the ③ ④ two boards

Rotate the turntable and find the small holes at the large
holes to screw in the screws



A16*2

8

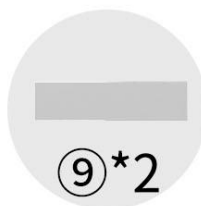
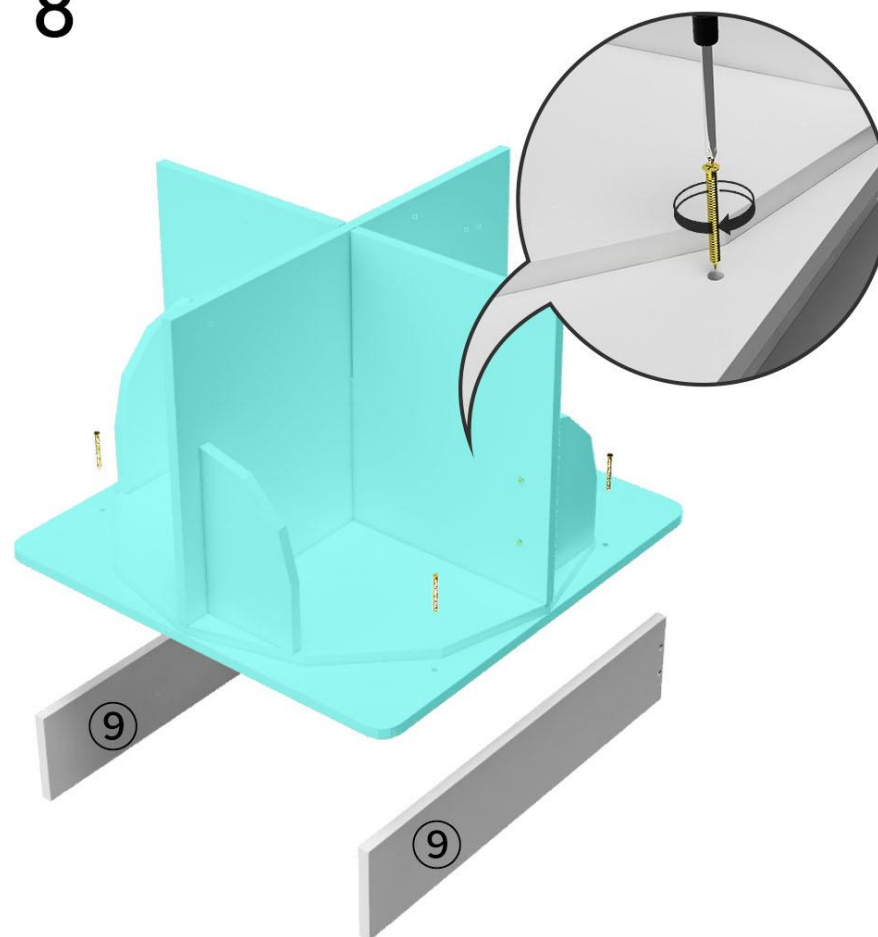

9

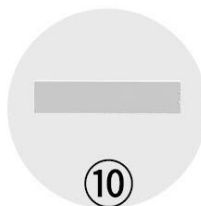
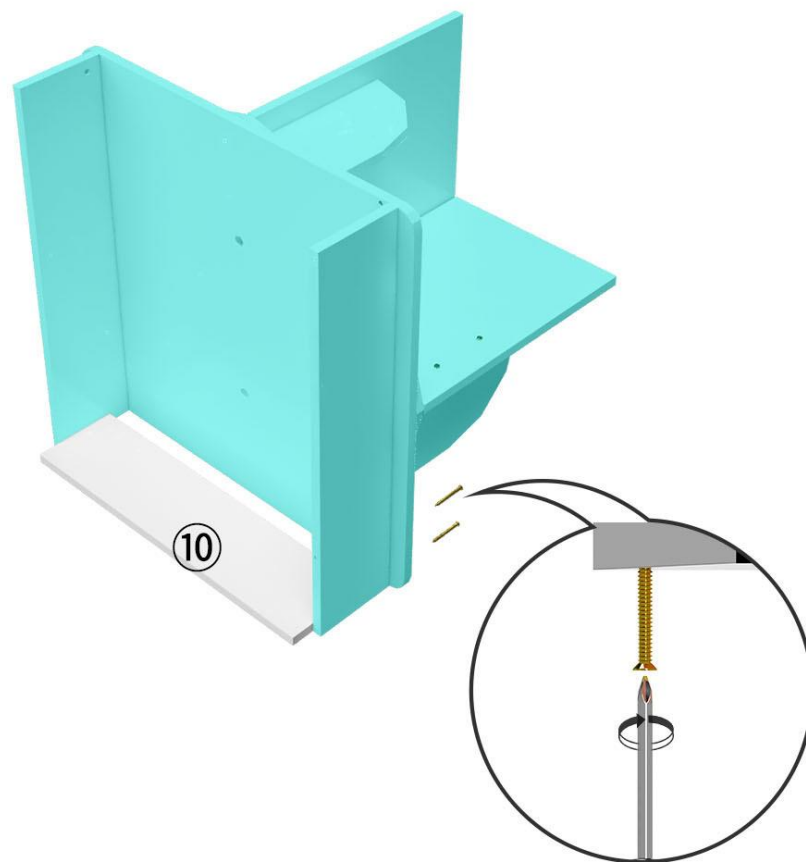

10

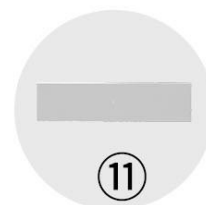
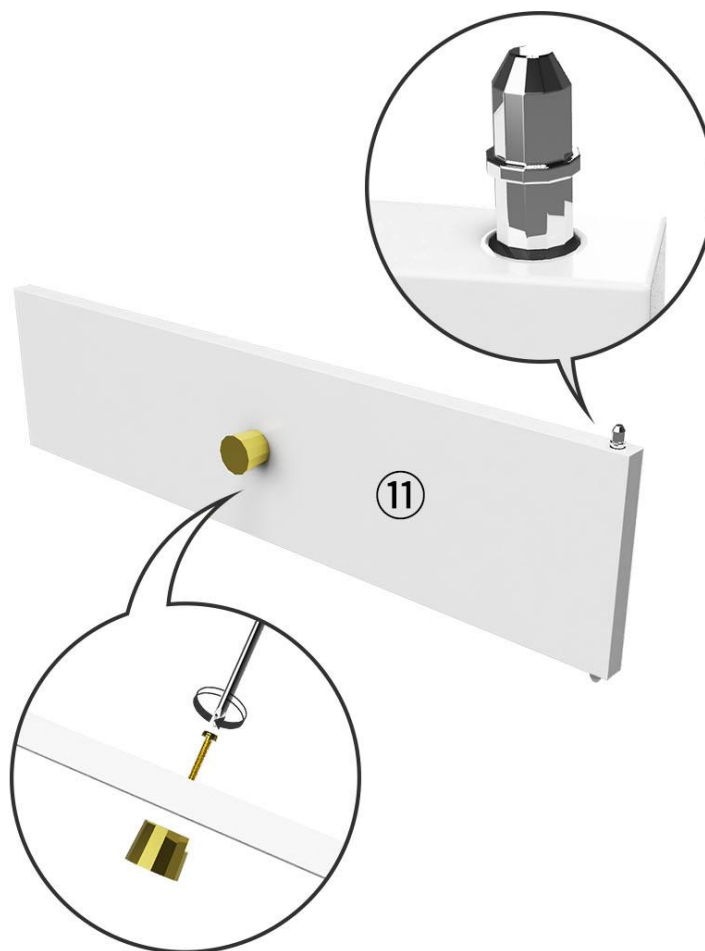

11

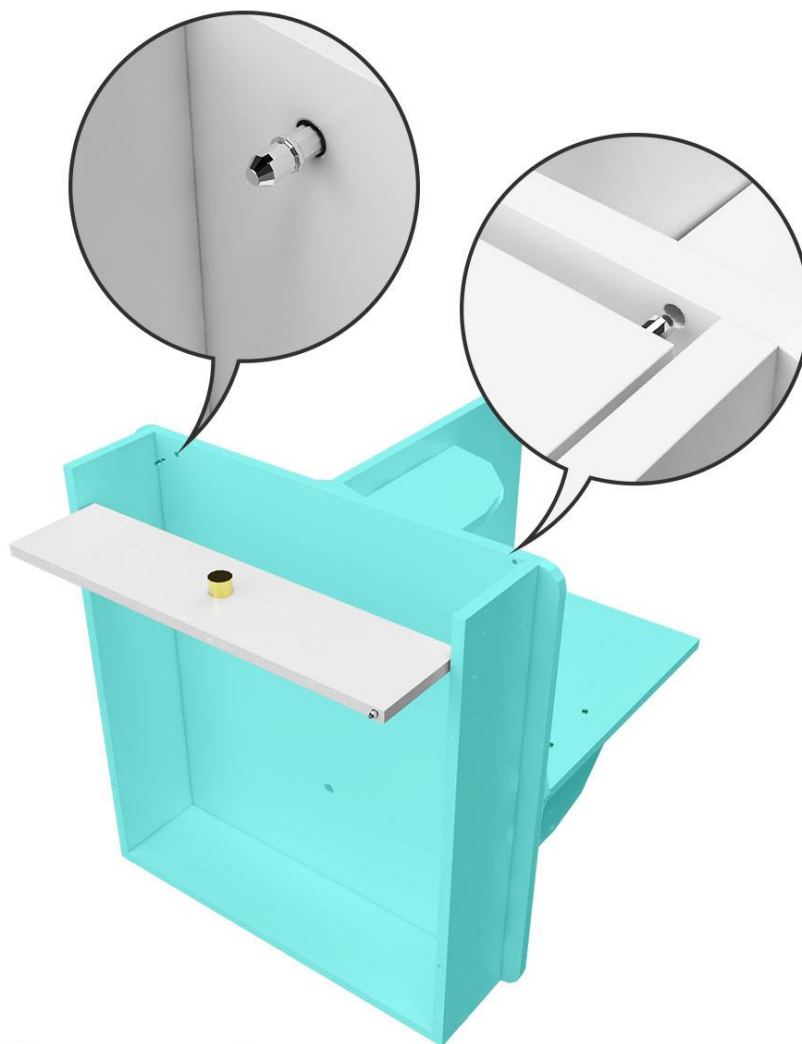

K0*1



K28*1

12

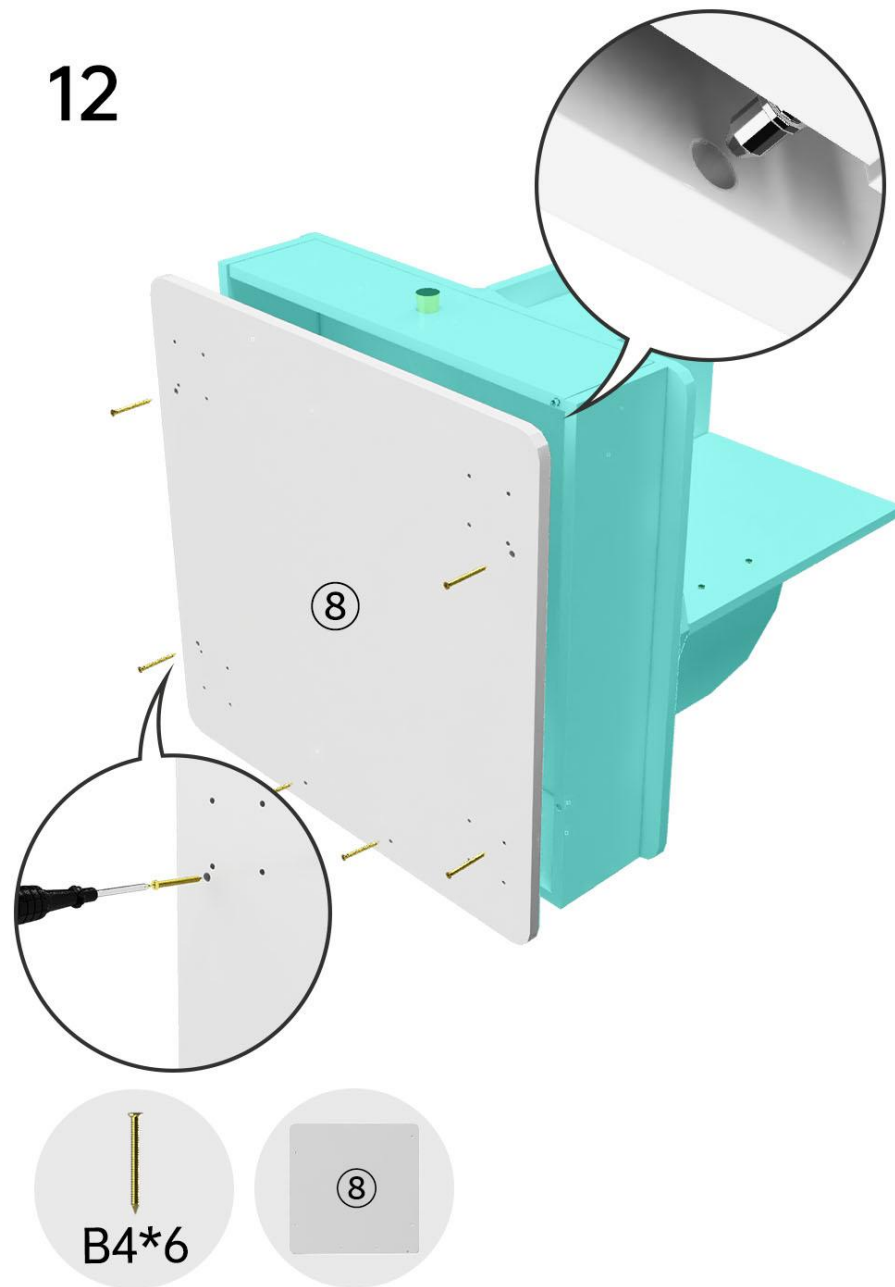

13

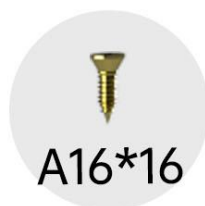
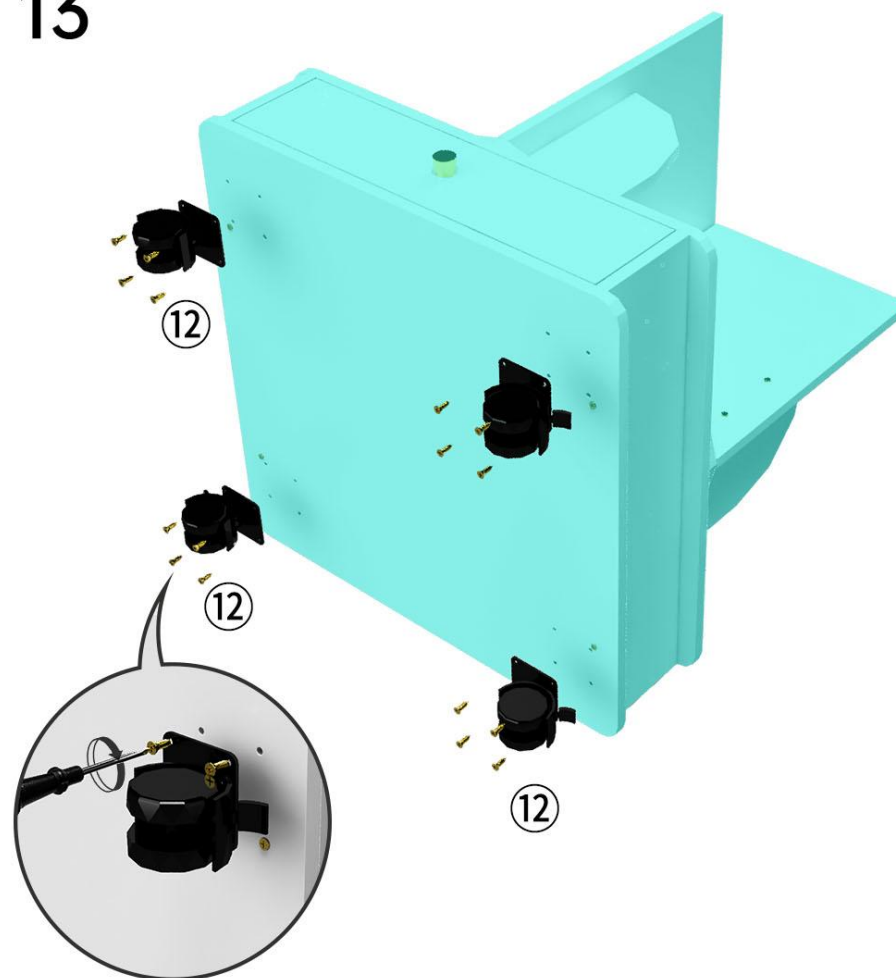

14

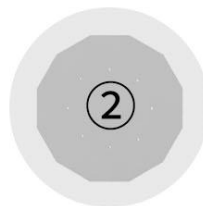
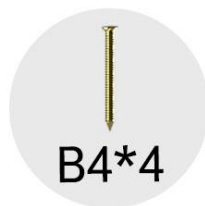
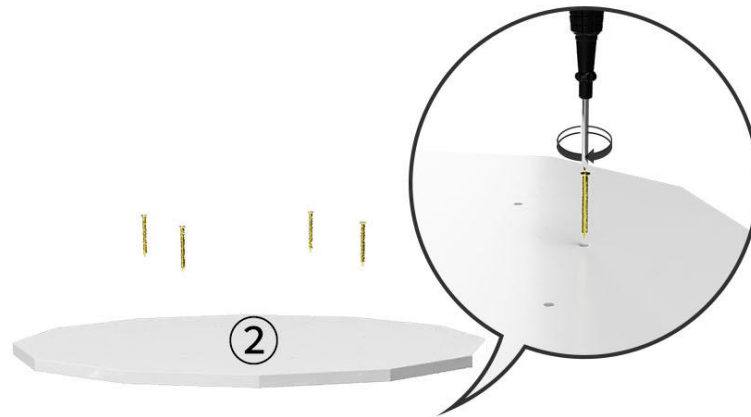

15

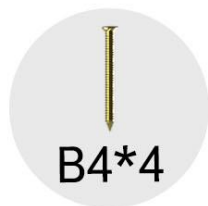
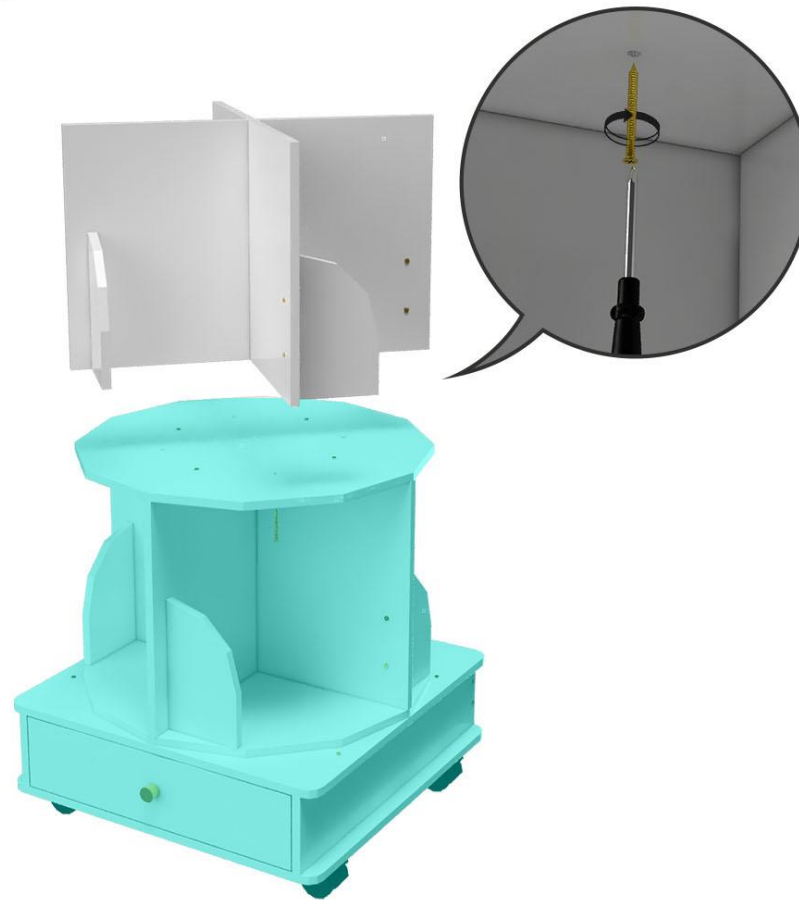

16

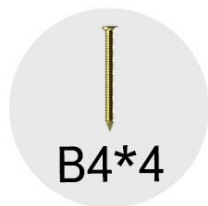
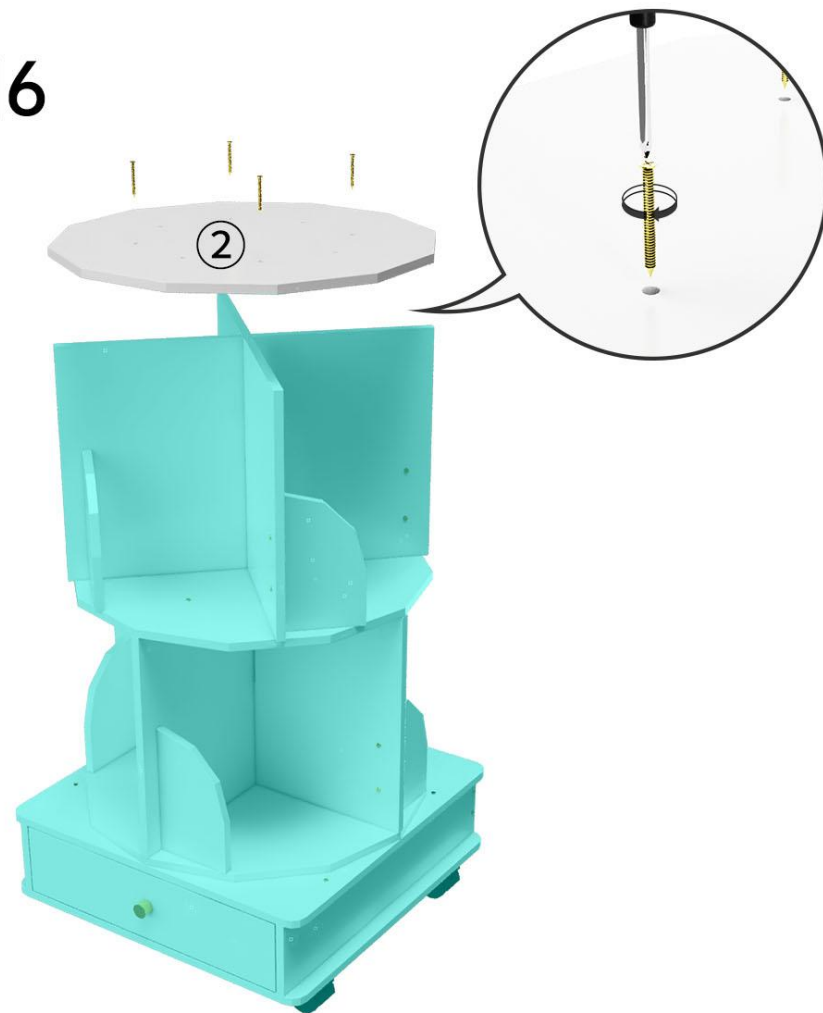

17

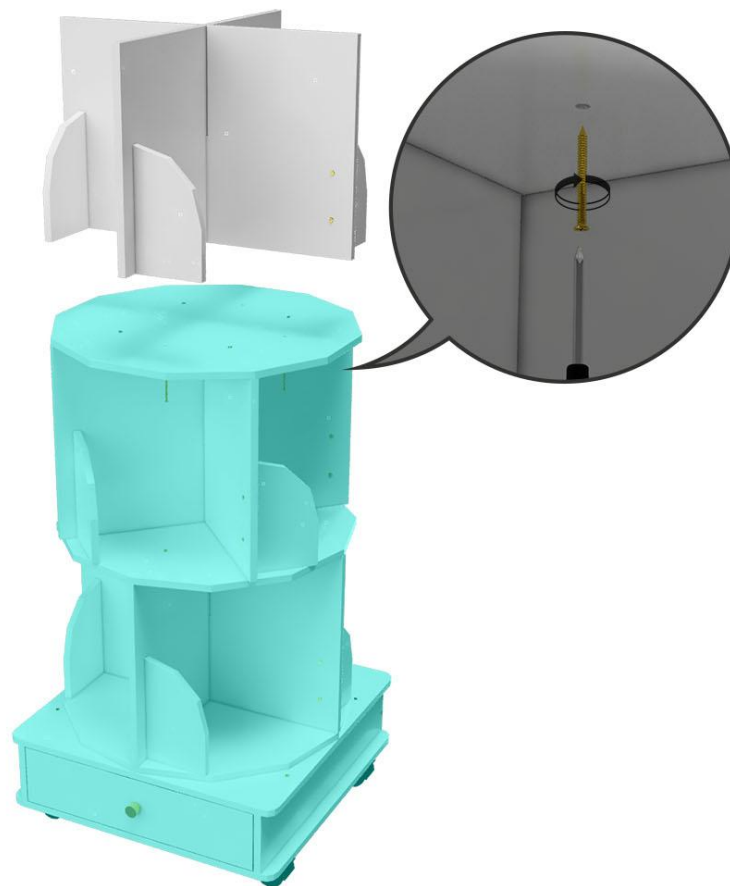

18

