

Let's build the

# Cove Dining Chair

SKU 24220

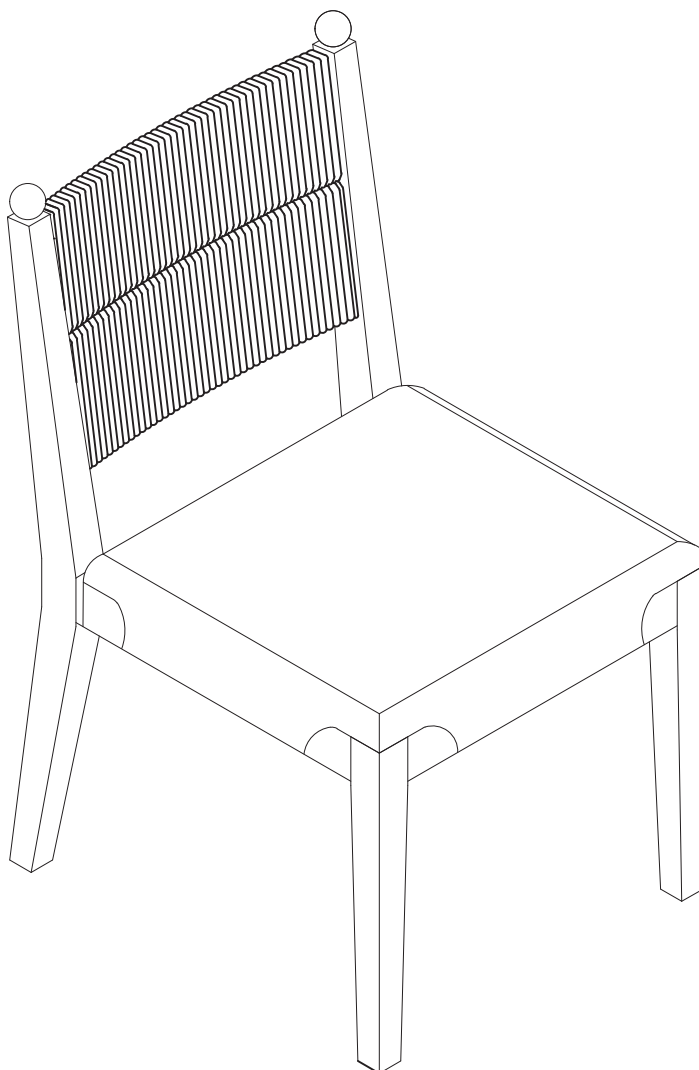

**Scan me!**

Free Lifetime  
Warranty

nathan james

25-0528-VN

# Ok, let's get rolling

This should be easy, just follow our instructions and you will be back to Netflix in no time.

## Estimated time for assembly



15:00

## What you need

- Some of your favourite bubbly or your preferred relaxant
- Use the packaging carton as a working surface to prevent product damage during assembly
- Phillips head screwdriver

## Weight Limitation



275  
lbs

Toll-free at 1-866-619-1004  
Help@nathanjames.com  
Nathanjames.com/help

## What's included

Description		Qty
A	Chair Back Sub-assembly	1
B	Seat Assembly	1
C	Front Leg	2
1	Ø1/4" x 38mm Hex Button Head Bolt	2
2	Ø1/4" x 60mm Hex Button Head Bolt	4
3	Ø1/4" x 80mm Hex Button Head Bolt	4
4	Ø1/4" x 10mm Spring Washer	10
5	Ø1/4" x 19mm Flat Washer	10
6	Allen Key	1
7	Plastic Nailhead Feet (Extra)	2
8	Leveler Feet (Extra)	2
9	Ø10 x 30m Wooden Dowel (Extra 1pc)	2

Scan me!

Free Lifetime  
Warranty



# The goods

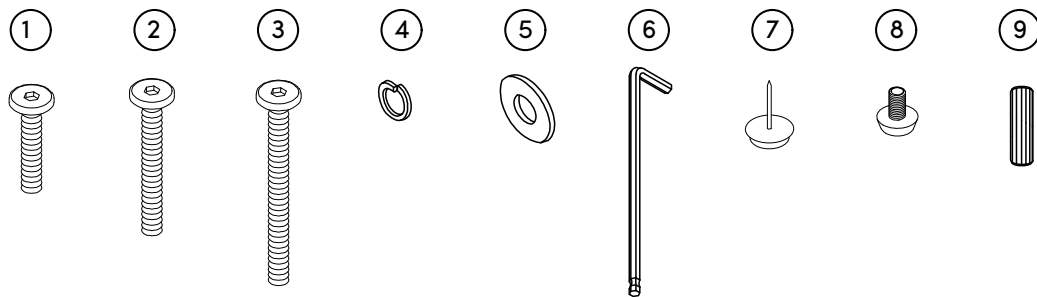
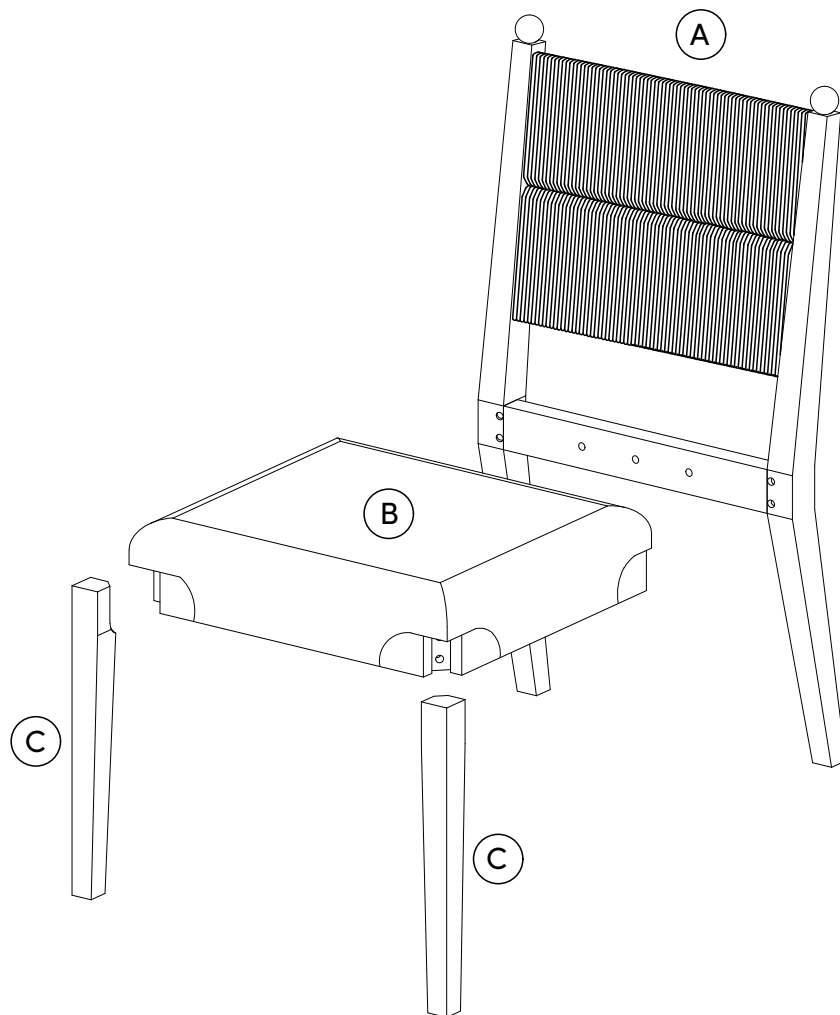

## IMPORTANT

1. Do not tighten bolts / screws completely until all bolts / screws are lined up and inserted into holes.
2. Do not over tighten screws and bolts to avoid stripping.
3. Please use hand tools to assemble this product.

# Step 1

Let's get this thing fired up!

Secure the Seat Assembly (B) and the Front Legs (C) together using the 1/4" x 60mm Hex Button Head Bolts (2), 1/4" x 10mm Spring Washers (4) and 1/4" x 19mm Flat Washers (5).

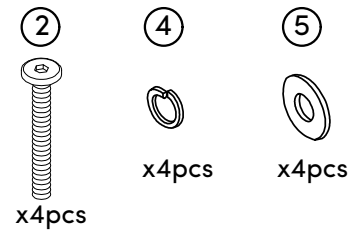

See, we told you this was going to be easy!



Do NOT overtighten hardware.  
Tighten only to 75% for now.

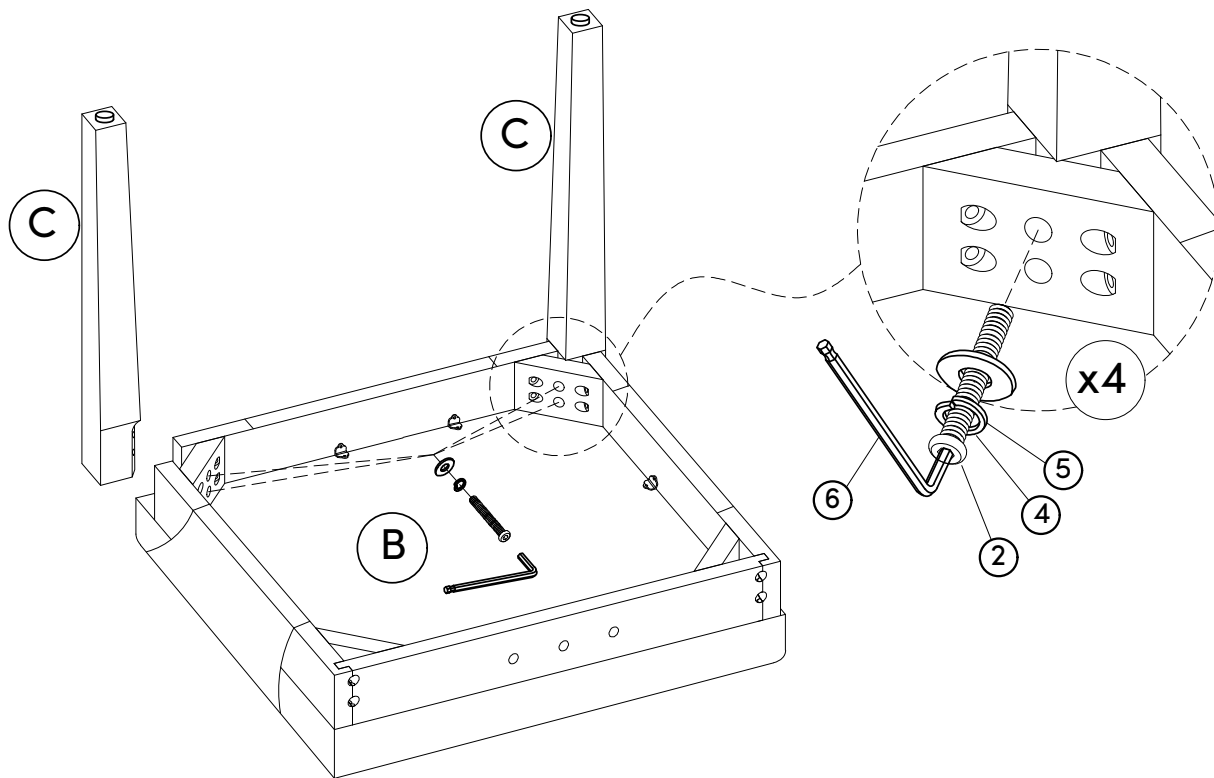

# Step 2

Begin securing the Chair Back (A) and Seat Assembly (B) using the 1/4" x 38mm Hex Button Head Bolts (1), 1/4" x 10mm Spring Washers (4) and 1/4" x 19mm Flat Washers (5)

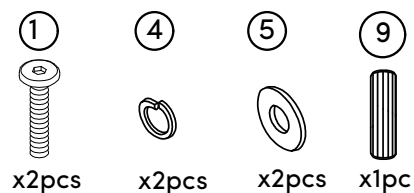

Do NOT overtighten hardware.  
Tighten only to 75% for now.

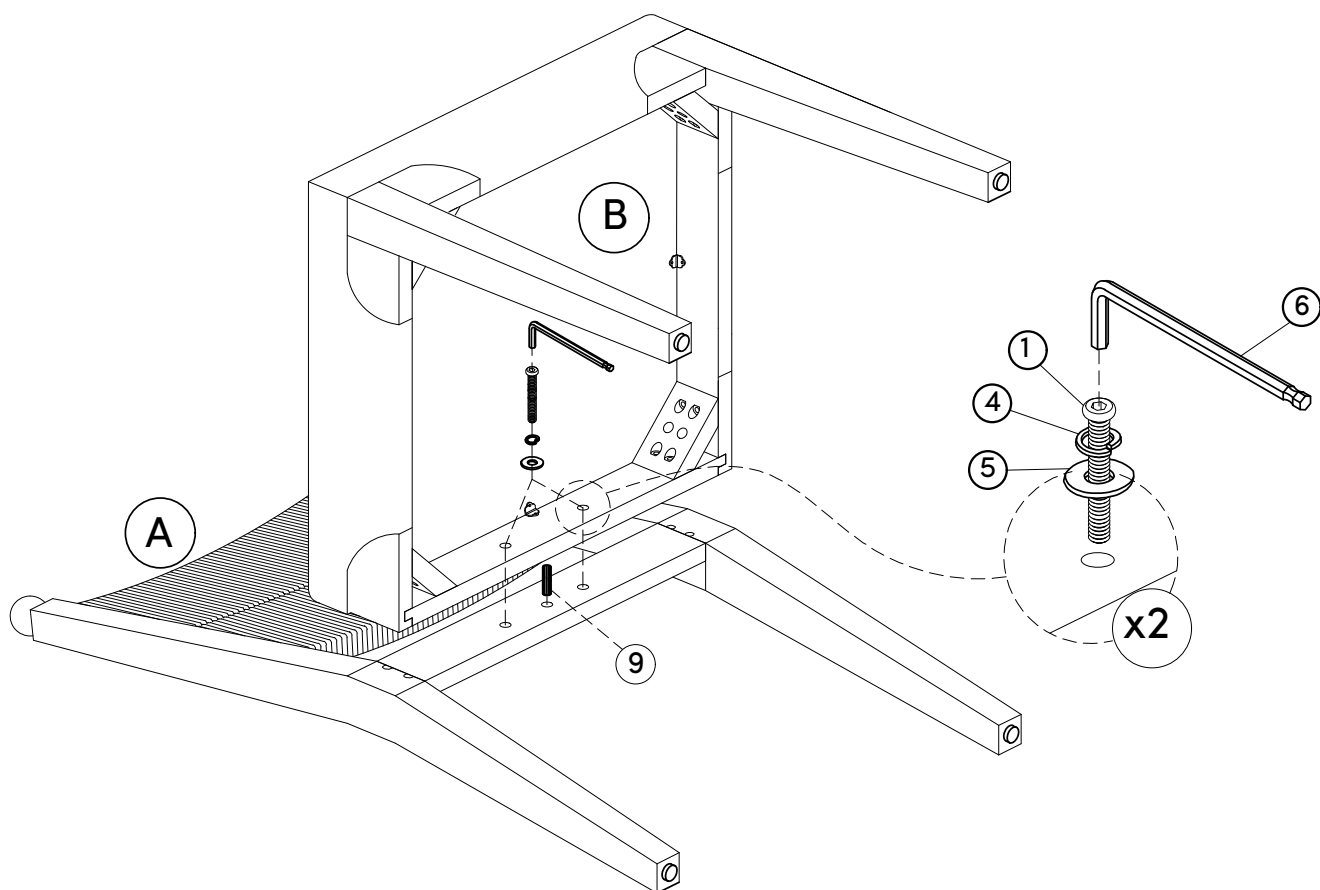

# Step 3

Continue securing the Chair Back (A) and Seat Assembly (B) using the 1/4" x 80mm Hex Button Head Bolts (3), 1/4"x 10mm Spring Washer (4) and 1/4" x 19mm Flat Washers (5)

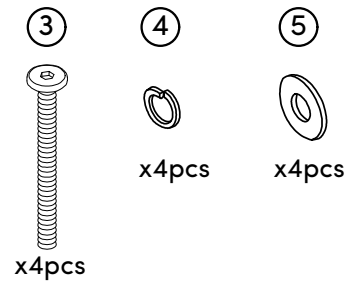

Do NOT overtighten hardware.  
Tighten only to 75% for now.

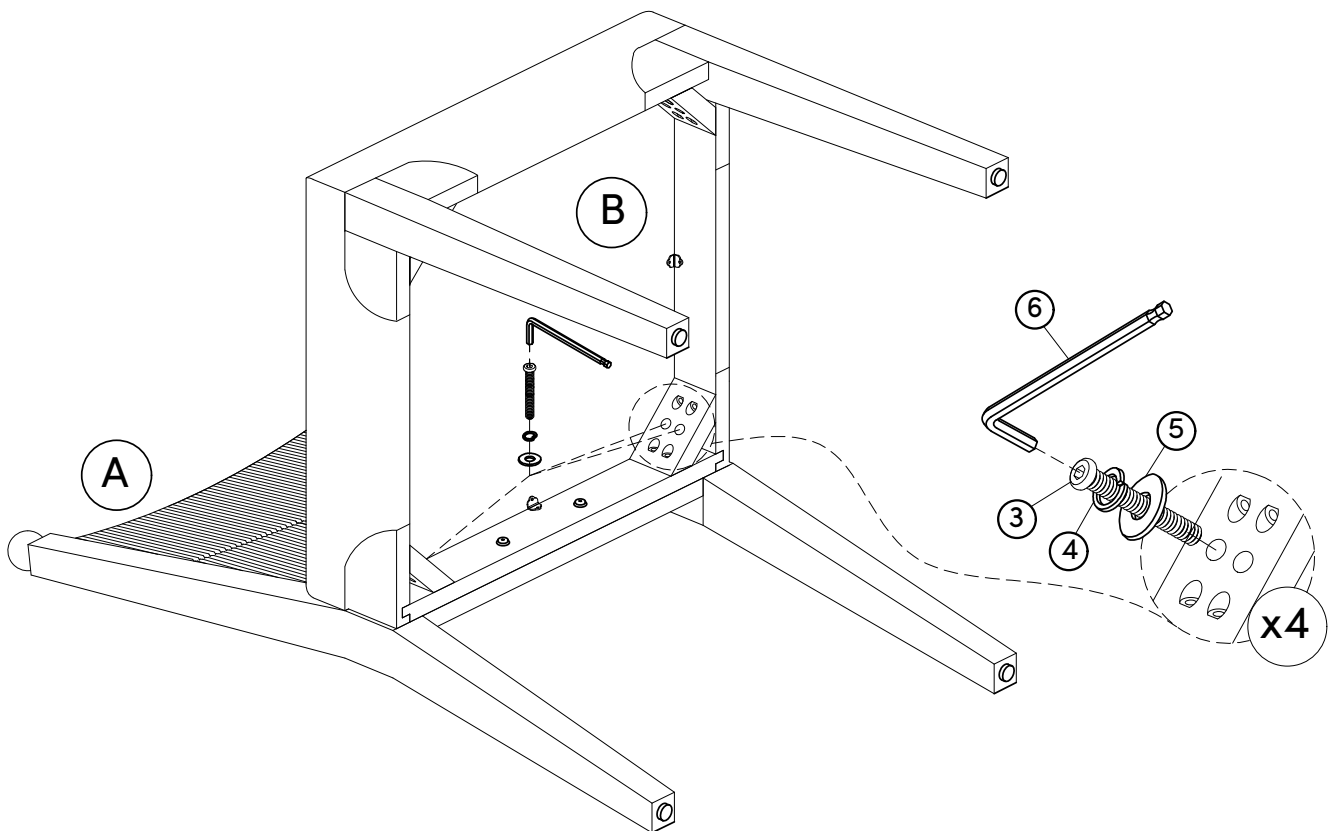

# Step 4

Carefully flip the chair over on a flat surface and make sure that the legs are touching the ground evenly before tightening everything to 100%.

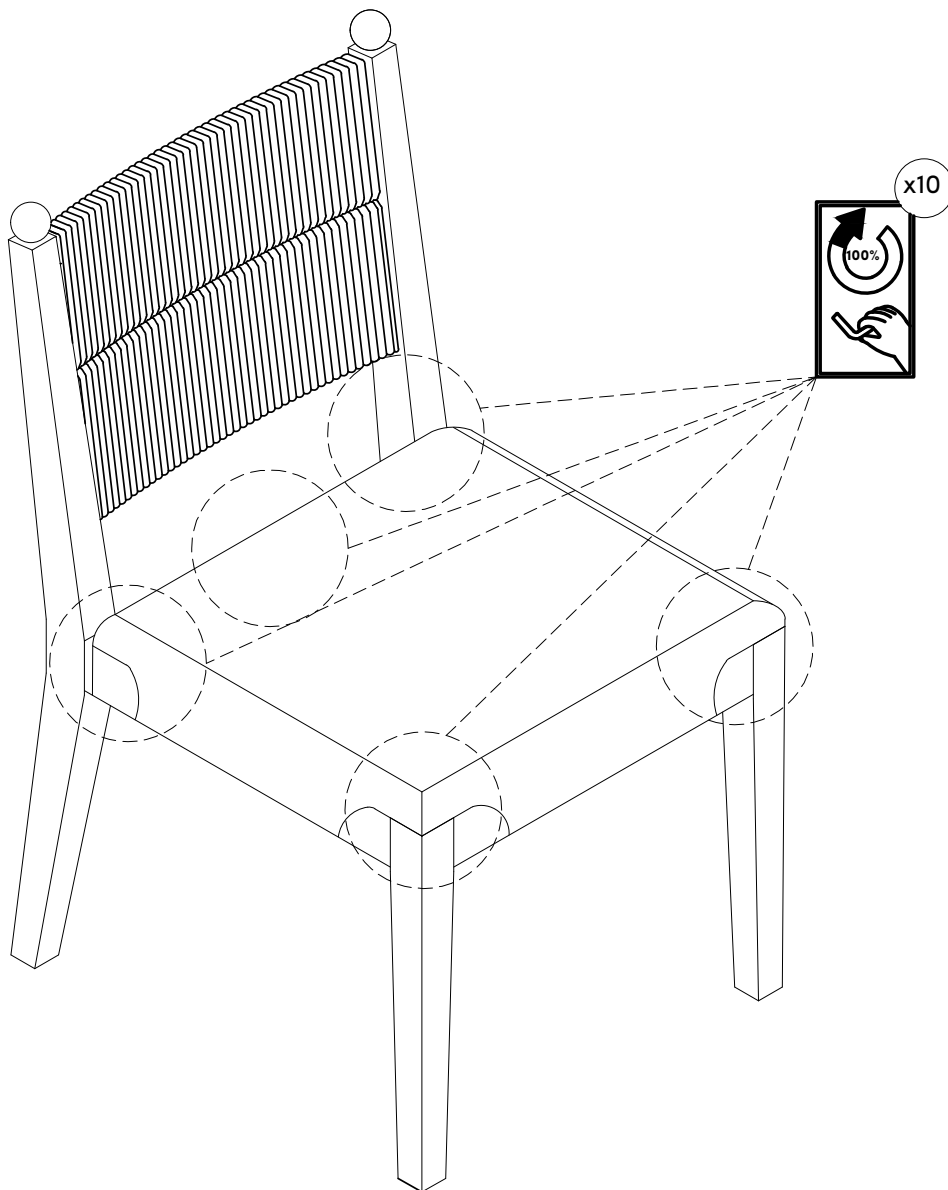

# Step 5

Now, for some final fine tuning, if your chair needs it. If it's still looking a little unlevel, adjust the levelers on the feet until it's nice and level.

You did it! Time to pull up a chair and celebrate with some pizza!

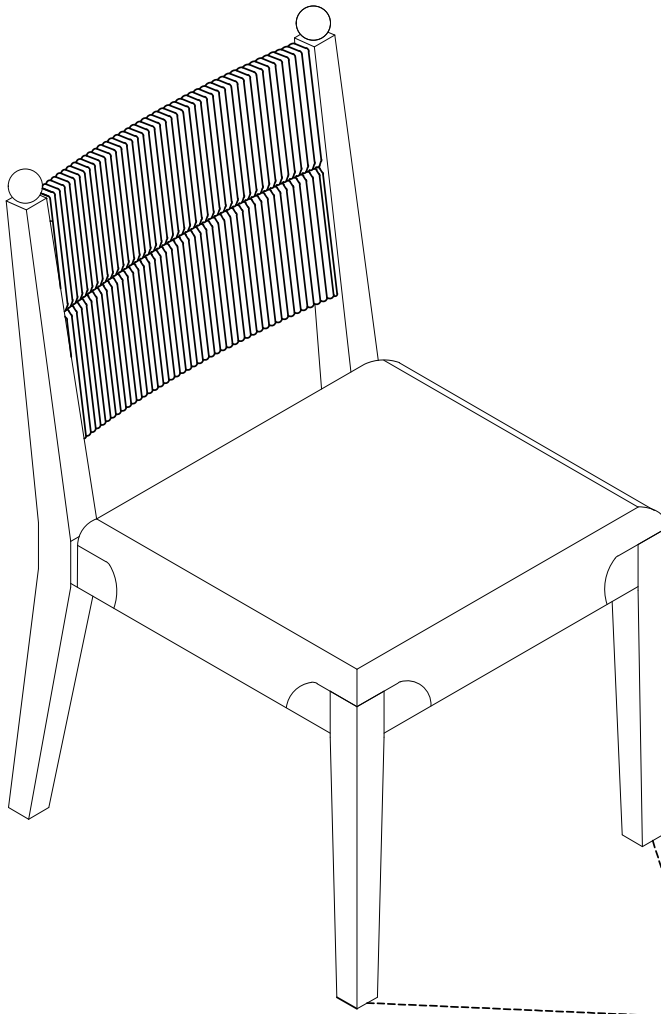

**HELPFUL TIP:**  
Adjust the levelers to help further level the Dining Chair, if need be.

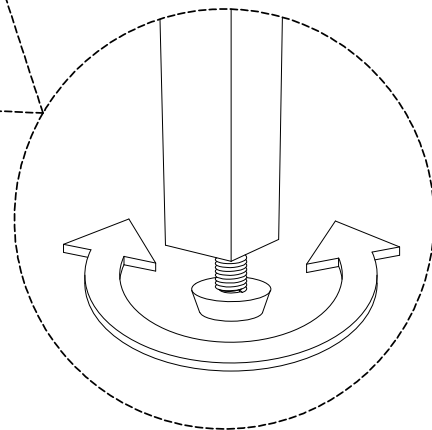



# No heartburn, when we handle the return

Give us a call **1-866-619-1004** or shoot us a message at **help@nathanjames.com** we will issue you a free replacement with **zero hassle**.

## Our way



Give us a call



Replacement



You

## Their way



Re-package item



Schedule pick up



Track package



Replacement



You

We really don't want you to go through the hassle of re-packaging your item and sending it back, because let's be honest...nobody has time for that.

# Safety first, fun later

We want your product to last as long as possible, so we recommend that you tighten the screws 2 weeks after assembly and for added safety check the tightness of all screws every 2 months.

For proper care and treatment of fabric & metal please check our website at [NathanJames.com/products](http://NathanJames.com/products)

## Safe use of this product starts with you.

Use this Cove Bar Stool responsibly with the primary concern for your safety. Follow assembly instructions carefully and inspect product upon receipt and each use.

Nathan James and its parent companies cannot be held legally responsible for any injuries or death resulted from failure to follow instructions or improper use of this product.

## Do not modify the structure of this product in any way.

Our products have been tested to meet specific safety measures as they were originally intended to be sold. Any modifications will present the risk of creating significant safety issues which NJ will not be responsible for.

## Proper use

- DO NOT** use for commercial purposes
- DO NOT** place on uneven floor
- DO NOT** use as a step-stool or stand on
- DO NOT** put hot serving liquid directly on the chair
- DO NOT** leave spilled liquid on chair
- DO NOT** use if damaged or broken
- DO NOT** make temporary repairs
- DO NOT** use outdoors

# We are only in business if you're happy

For starters, thanks for being you.

☎ Toll-free at 1-866-619-1004

✉ Help@nathanjames.com

🌐 NathanJames.com/help

We do our best to ensure your furniture arrives without any problems, but occasionally mistakes happen—as humans we are imperfect beings. In the event that a part is damaged or missing, we will be more than happy to provide you with replacement part(s) for free.

## Warranty

This product comes with a lifetime warranty from the date of purchase. Please use your phone to scan the QR code to register your product or visit <https://goo.gl/i9dk3q>

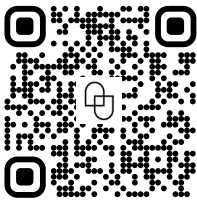

### Did we do alright? Please spread the love!

If you are happy with your product, tell your friends and family about us or even better leave us a review online. Spreading the word gives us the opportunity to make more people happy and keep our prices low for your next purchase.

*Brooke Burden*

Founder, Nathan James